

SECTION THRU INTEGRAL END BENT

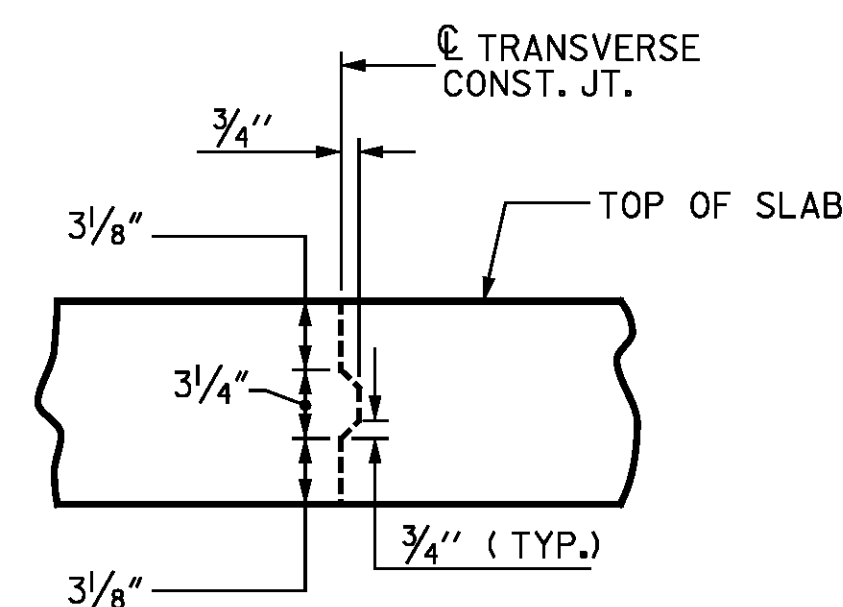

TRANSVERSE CONSTRUCTION JOINT DETAIL

NOTE: REINFORCING STEEL IN SLAB NOT SHOWN.
LONGITUDINAL REINFORCING STEEL SHALL BE
CONTINUOUS THRU JOINT

PROJECT NO. R-2514D

JONES COUNTY

STATION: 363+38.90 -L-

SHEET 2 OF 2

STATE OF NORTH CAROLINA
DEPARTMENT OF TRANSPORTATION
RALEIGH

**SUPERSTRUCTURE
TYPICAL SECTION**

LEFT LANE STR-#3

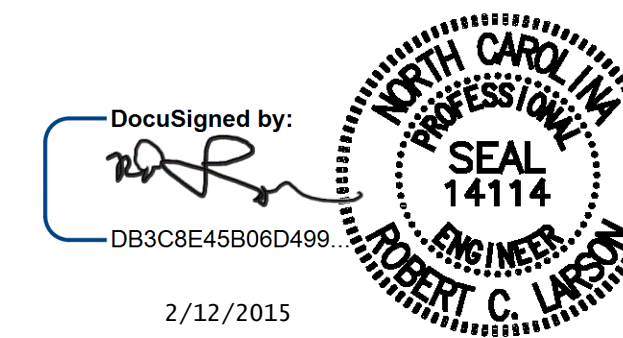

DocuSigned by:

DB3C8E45B06D499...

2/12/2015

DocuSigned by:
DB3C8E45B06D499...

DESIGN ENGINEER OF RECORD: DATE : 2/12/2015

DRAWN BY : R. C. LARSON DATE : 8/22/13

CHECKED BY : DATE :

REVISIONS						SHEET NO. S03-6
NO.	BY:	DATE:	NO.	BY:	DATE:	
1			3			TOTAL SHEETS S03-23
2			4			

KCI Associates
of North Carolina, P.A.
DWG. REF. NO. 6 OF 23