

BENCHMARK: BM15 RR SPIKE IN POWER POLE -L- STATION 323+74.00 940' LEFT ELEVATION 28.34' NAVD 88

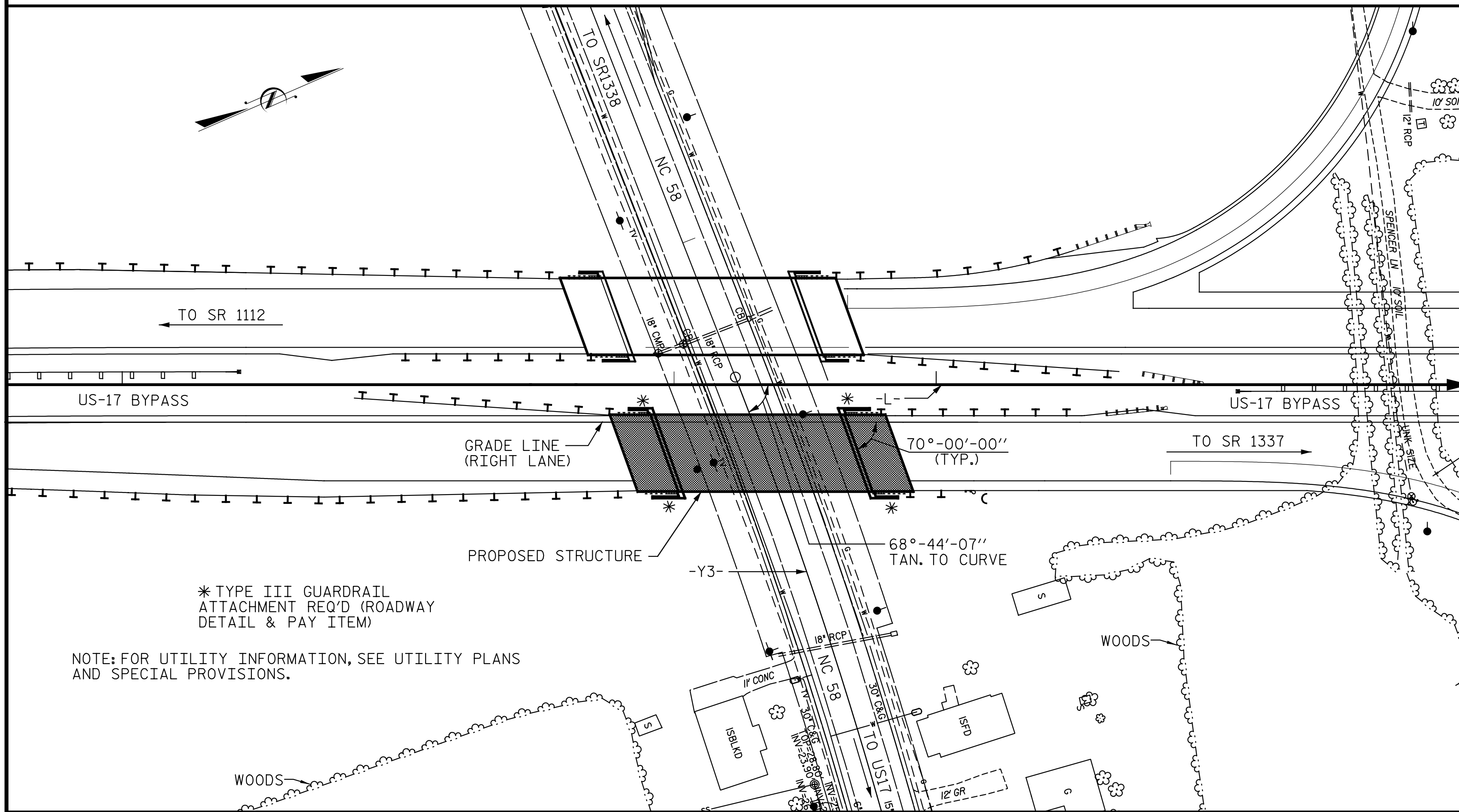

LOCATION SKETCH

**NOTES:**

- ASSUMED LIVE LOAD = HL-93 OR ALTERNATE LOADING.
- THIS BRIDGE HAS BEEN DESIGNED IN ACCORDANCE WITH THE AASHTO LRFD BRIDGE DESIGN SPECIFICATIONS
- THIS BRIDGE IS LOCATED IN SEISMIC ZONE 1
- FOR OTHER DESIGN DATA AND GENERAL NOTES, SEE SHEET SN.
- FOR SUBMITTAL OF WORKING DRAWINGS, SEE SPECIAL PROVISIONS.
- FOR FALSEWORK AND FORMWORK, SEE SPECIAL PROVISIONS.
- FOR CRANE SAFETY, SEE SPECIAL PROVISIONS.
- FOR GROUT FOR STRUCTURES, SEE SPECIAL PROVISIONS.
- THE ELEVATION(S) AND CLEARANCE(S) SHOWN ON THE PLANS AT THE POINT(S) OF MINIMUM CLEARANCE ARE FROM THE BEST INFORMATION AVAILABLE. PRIOR TO BEGINNING BRIDGE CONSTRUCTION, VERIFY THE ELEVATION(S) ON THE EXISTING PAVEMENT AND CHECK THE CLEARANCE. REPORT ANY VARIATIONS TO THE ENGINEER. ANY PLAN REVISIONS NECESSARY TO ACHIEVE THE REQUIRED MINIMUM VERTICAL CLEARANCE WILL BE PROVIDED BY THE DEPARTMENT.
- FOR MAINTENANCE AND PROTECTION OF TRAFFIC BENEATH PROPOSED STRUCTURE, SEE SPECIAL PROVISIONS.
- PRESTRESSED CONCRETE DECK PANELS MAY BE USED IN LIEU OF METAL STAY-IN-PLACE FORMS IN ACCORDANCE WITH ARTICLE 420-3 OF THE STANDARD SPECIFICATIONS.
- REMOVABLE FORMS MAY BE USED IN LIEU OF METAL STAY-IN-PLACE FORMS IN ACCORDANCE WITH ARTICLE 420-3 OF THE STANDARD SPECIFICATIONS.
- NEEDLE BEAMS WILL NOT BE ALLOWED UNLESS OTHERWISE CALLED FOR ON THE PLANS OR APPROVED BY THE ENGINEER.
- FOR EROSION CONTROL MEASURES SEE EROSION CONTROL PLANS.
- FOR PLACING LOAD ON STRUCTURE MEMBERS, SEE SPECIAL PROVISIONS.

**TOTAL BILL OF MATERIAL**

	PDA TESTING	REINFORCED CONCRETE DECK SLAB	GROOVING BRIDGE FLOORS	CLASS A CONCRETE	BRIDGE APPROACH SLABS	REINFORCING STEEL	MODIFIED 72" PRESTRESSED CONCRETE GIRDERS		12" PRESTRESSED CONCRETE PILES		PILE REDRIVES	CONCRETE BARRIER RAIL	4" SLOPE PROTECTION	ELASTOMERIC BEARINGS
	EA	SQ.FT.	SQ.FT.	CU.YDS.	LUMP SUM	LBS.	NO.	LIN.FT.	NO.	LIN.FT.	EA.	LIN.FT.	SQ. YD.	LUMP SUM
SUPERSTRUCTURE		5,959	7,184		LUMP SUM		5	592.08				238.46		LUMP SUM
END BENT 1				35.6		6,140			11	550	5		510	
END BENT 2				35.9		6,194			11	605	5		325	
TOTAL	1	5,959	7,184	71.5	LUMP SUM	12,334	5	592.08	22	1155	10	238.46	835	LUMP SUM

PROJECT NO. R-2514D  
JONES COUNTY  
 STATION: 320+39.56 -L-

SHEET 3 OF 4

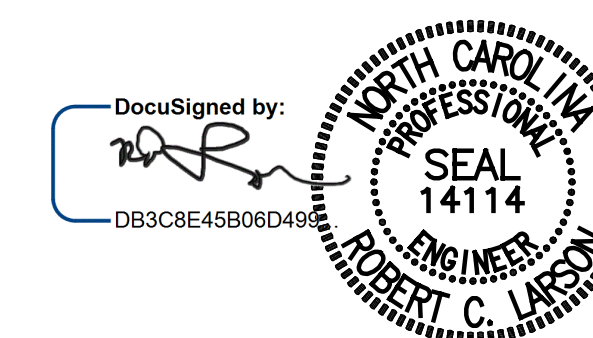

3/10/2015

STATE OF NORTH CAROLINA  
 DEPARTMENT OF TRANSPORTATION  
 RALEIGH  
 GENERAL DRAWING  
 FOR BRIDGE ON US 17 BYPASS  
 OVER NC 58 BETWEEN  
 SR 1112 AND SR 1337  
 RIGHT LANE

DESIGN ENGINEER OF RECORD: R. J. FLORY DATE: 06/28/13  
 CHECKED BY: R. C. LARSON DATE: 04/28/14

REVISIONS		SHEET NO.	
NO.	DATE	NO.	DATE
1		3	
2		4	

TOTAL SHEETS: S02-24

STR-#2