

319+00 319+50 320+00 320+50 321+00 321+50 322+00

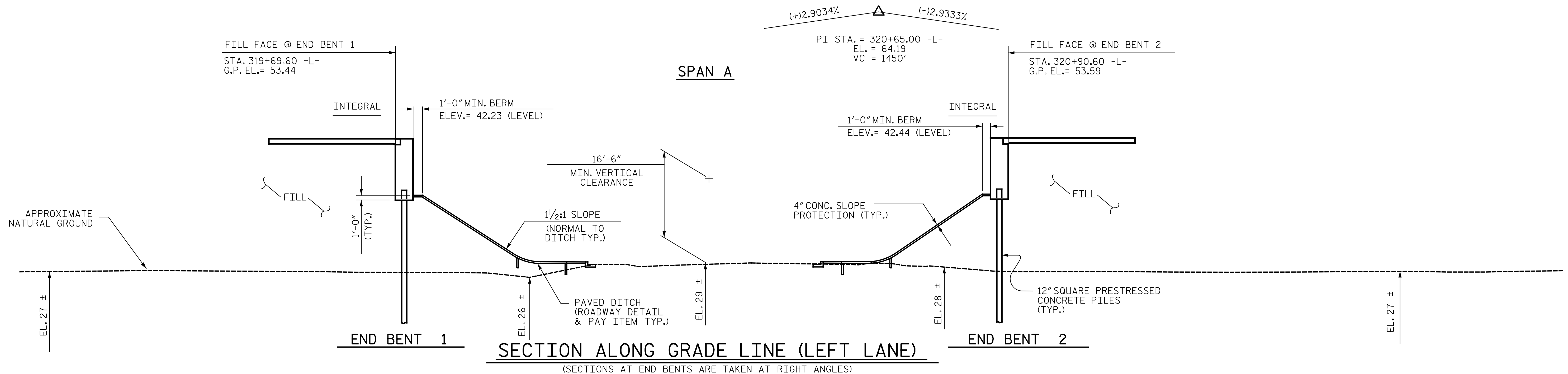

SECTION ALONG GRADE LINE (LEFT LANE)
(SECTIONS AT END BENTS ARE TAKEN AT RIGHT ANGLES)

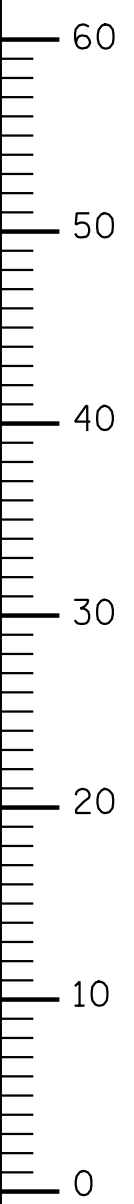
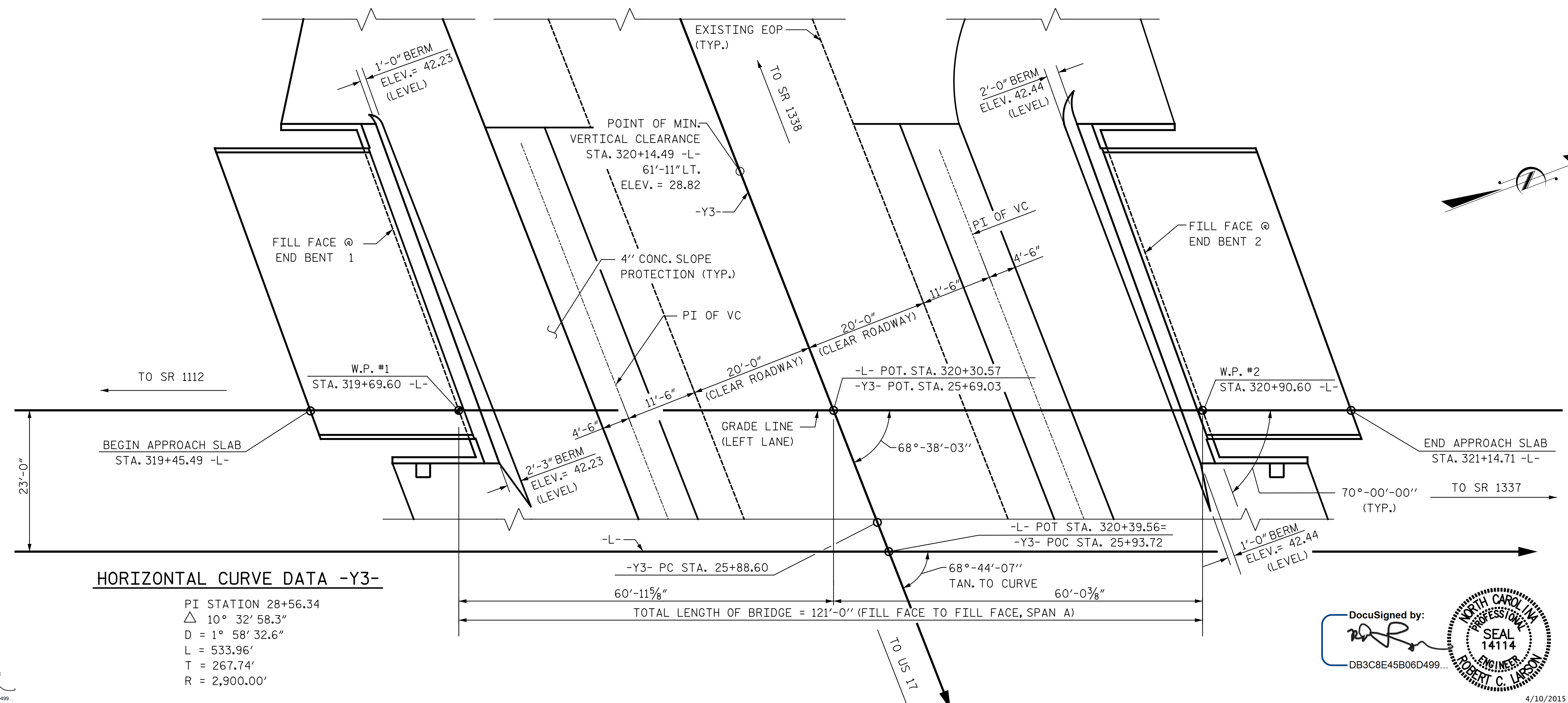

HORIZONTAL CURVE DATA -Y3-

PI STATION 28+56.34
 Δ 10° 32' 58.3"
 D = 1° 58' 32.6"
 L = 533.96'
 T = 267.74'
 R = 2,900.00'

PLAN
(PILES NOT SHOWN FOR CLARITY)

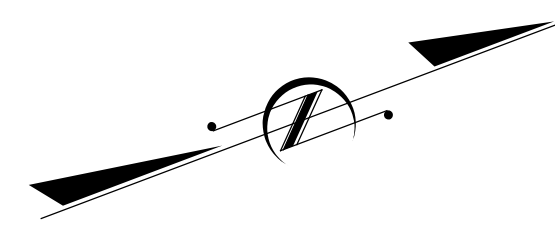

PROJECT NO. R-2514D
JONES COUNTY
 STATION: 320+39.56 -L-
=25+93.72 -Y3-
 SHEET 1 OF 4 BRIDGE NO. 95

STATE OF NORTH CAROLINA
 DEPARTMENT OF TRANSPORTATION
 RALEIGH
 GENERAL DRAWING
 FOR BRIDGE ON US 17 BYPASS
 OVER NC 58 BETWEEN
 SR 1112 AND SR 1337
 LEFT LANE

DESIGN ENGINEER OF RECORD:	DATE :	4/10/2015
DRAWN BY :	DATE :	6/28/13
CHECKED BY :	DATE :	5/1/14

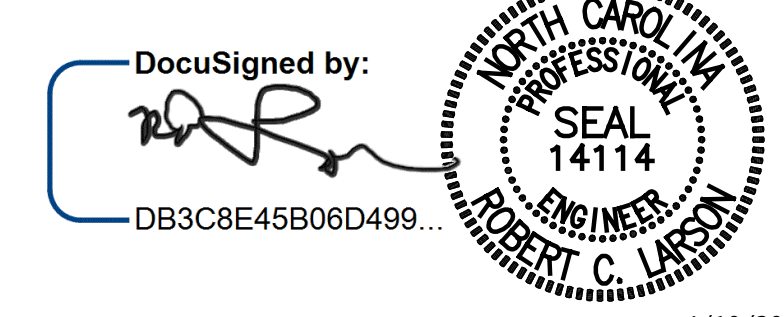

KCI Associates
 of North Carolina, P.A.
 DWG. REF. NO. 1 OF 24

REVISIONS						SHEET NO.
NO.	BY:	DATE:	NO.	BY:	DATE:	SOI-I
1			3			TOTAL SHEETS
2			4			SOI-24

STR-#1