

UTILITIES BY OTHERS

NOTE:  
ALL PROPOSED UTILITY WORK SHOWN ON THIS SHEET WILL BE DONE BY OTHERS. NO PAYMENT WILL BE MADE TO THE CONTRACTOR FOR PROPOSED UTILITY WORK SHOWN ON THIS SHEET.

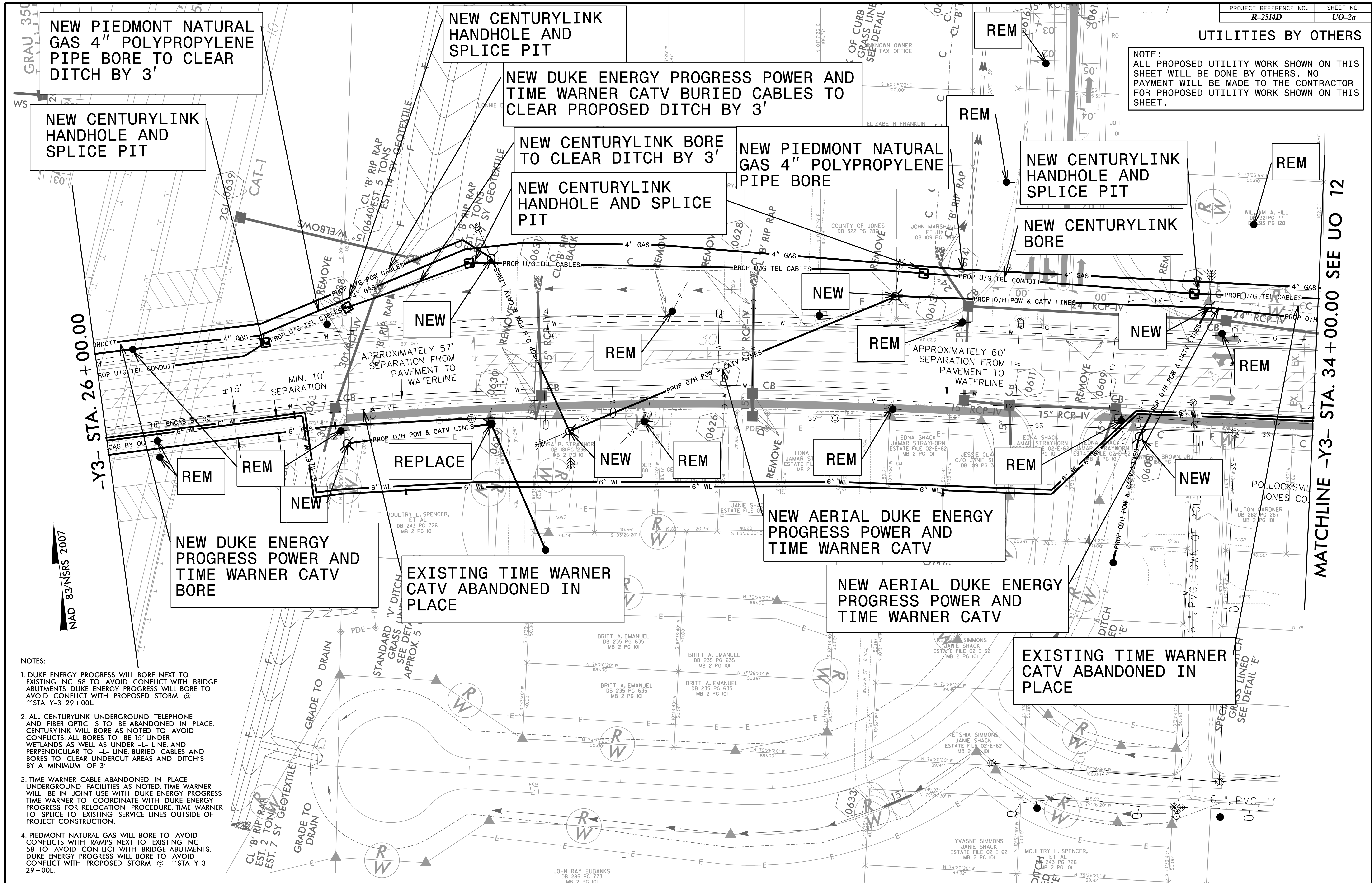

- NOTES:
- DUKE ENERGY PROGRESS WILL BORE NEXT TO EXISTING NC 58 TO AVOID CONFLICT WITH BRIDGE ABUTMENTS. DUKE ENERGY PROGRESS WILL BORE TO AVOID CONFLICT WITH PROPOSED STORM @ STA Y-3 29+00L.
  - ALL CENTURYLINK UNDERGROUND TELEPHONE AND FIBER OPTIC IS TO BE ABANDONED IN PLACE. CENTURYLINK WILL BORE AS NOTED TO AVOID CONFLICTS. ALL BORES TO BE 15' UNDER WETLANDS AS WELL AS UNDER L-LINE AND PERPENDICULAR TO L-LINE. BURIED CABLES AND BORES TO CLEAR UNDERCUT AREAS AND DITCH'S BY A MINIMUM OF 3'.
  - TIME WARNER CABLE ABANDONED IN PLACE UNDERGROUND FACILITIES AS NOTED. TIME WARNER WILL BE IN JOINT USE WITH DUKE ENERGY PROGRESS TIME WARNER TO COORDINATE WITH DUKE ENERGY PROGRESS FOR RELOCATION PROCEDURE. TIME WARNER TO SPLICE TO EXISTING SERVICE LINES OUTSIDE OF PROJECT CONSTRUCTION.
  - PIEDMONT NATURAL GAS WILL BORE TO AVOID CONFLICTS WITH RAMP NEXT TO EXISTING NC 58 TO AVOID CONFLICT WITH BRIDGE ABUTMENTS. DUKE ENERGY PROGRESS WILL BORE TO AVOID CONFLICT WITH PROPOSED STORM @ STA Y-3 29+00L.

PLANS PREPARED BY:

RUMMEL, KLEPPER & KAHL, LLP  
900 RIDGEFIELD DRIVE SUITE 350  
RALEIGH, NORTH CAROLINA 27609-3960  
NC LICENSE NO. F-0112 • (919) 878-9560

UTILITY OWNERS ON THIS SHEET

DUKE ENERGY PROGRESS - POWER  
CENTURYLINK - TELEPHONE AND FIBER OPTIC  
TIME WARNER - CATV  
PIEDMONT NATURAL GAS - NATURAL GAS

MATCHLINE -Y3- STA. 34 + 00.00 SEE UO 12