

UTILITIES BY OTHERS

NOTE: ALL PROPOSED UTILITY WORK SHOWN ON THIS SHEET WILL BE DONE BY OTHERS. NO PAYMENT WILL BE MADE TO THE CONTRACTOR FOR PROPOSED UTILITY WORK SHOWN ON THIS SHEET.

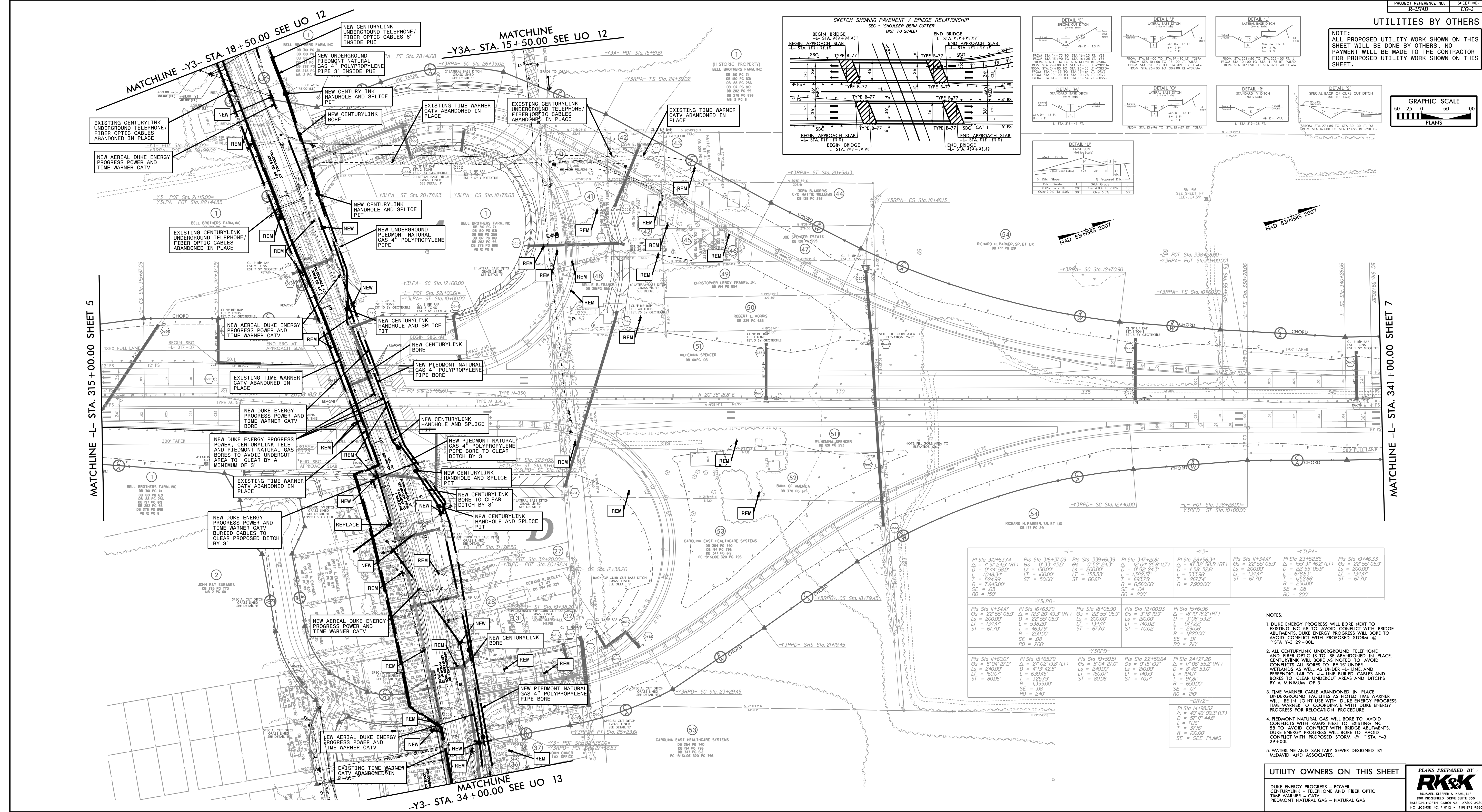
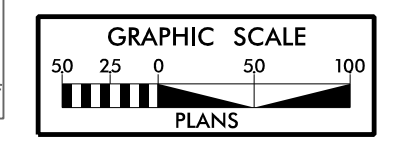

-Y3-		-Y3PA-		-Y3PD-		-Y3RPD-	
PI Sta 310+63.74 Δ = 7°51'24.5" (RT) D = 0'14" 50.0' L = 1048.34' T = 524.95' R = 7256.00' SE = 03 RO = 150'	PI Sta 316+37.09 Δ = 0°33'43.5" D = 150.00' L = 1800.00' T = 500.00' R = 2500.00' SE = 08 RO = 200'	PI Sta 339+61.39 Δ = 12°04'24.3" (RT) D = 133.33' L = 1386.37' T = 633.79' R = 6360.00' SE = 04 RO = 200'	PI Sta 347+20.81 Δ = 12°04'24.3" (RT) D = 133.33' L = 1386.37' T = 633.79' R = 6360.00' SE = 04 RO = 200'	PI Sta 28+56.34 Δ = 17°32'58.3" (RT) D = 152°58'52" (LT) L = 533.96' T = 267.74' R = 2200.00' SE = 07 RO = 210'	PI Sta 11+34.47 Δ = 22°55'05.9" (RT) D = 22°55'05.9" (RT) L = 134.47' T = 67.70' R = 2500.00' SE = 08 RO = 200'	PI Sta 23+52.96 Δ = 155°31'46.2" (LT) D = 22°55'05.9" (RT) L = 678.63' T = 134.47' R = 67.70' SE = 08 RO = 200'	PI Sta 14+46.33 Δ = 22°55'05.9" (RT) D = 22°55'05.9" (RT) L = 134.47' T = 67.70' R = 2500.00' SE = 08 RO = 200'

- NOTES:
- DUKE ENERGY PROGRESS WILL BORE NEXT TO EXISTING NC 88 TO AVOID CONFLICT WITH BRIDGE ABUTMENTS. DUKE ENERGY PROGRESS WILL BORE TO AVOID CONFLICT WITH PROPOSED STORM @ STA Y-3 29+00.
 - ALL CENTURYLINK UNDERGROUND TELEPHONE AND FIBER OPTIC IS TO BE ABANDONED IN PLACE. CENTURYLINK WILL BORE AS NOTED TO AVOID CONFLICT ALL BORES TO BE 18" UNDER WETLANDS AS WELL AS UNDER ALL LINE AND PERPENDICULAR TO ALL LINE BURIED CABLES AND BORES TO CLEAR UNDERCUT AREAS AND DITCHES BY A MINIMUM OF 3'.
 - TIME WARNER CABLE ABANDONED IN PLACE UNDERGROUND FACILITIES AS NOTED. TIME WARNER WILL BE IN JOINT USE WITH DUKE ENERGY PROGRESS TIME WARNER TO COORDINATE WITH DUKE ENERGY PROGRESS FOR RELOCATION PROCEDURE.
 - PIEDMONT NATURAL GAS WILL BORE TO AVOID CONFLICTS WITH RAMPS NEXT TO EXISTING NC 88 TO AVOID CONFLICT WITH BRIDGE ABUTMENTS. DUKE ENERGY PROGRESS WILL BORE TO AVOID CONFLICT WITH PROPOSED STORM @ STA Y-3 29+00.
 - WATERLINE AND SANITARY SEWER DESIGNED BY McDAVID AND ASSOCIATES.

UTILITY OWNERS ON THIS SHEET

DUKE ENERGY PROGRESS - POWER
CENTURYLINK - TELEPHONE AND FIBER OPTIC
TIME WARNER - CATV
PIEDMONT NATURAL GAS - NATURAL GAS

