

UTILITIES BY OTHERS

NOTE:
 ALL PROPOSED UTILITY WORK SHOWN ON THIS SHEET WILL BE DONE BY OTHERS. NO PAYMENT WILL BE MADE TO THE CONTRACTOR FOR PROPOSED UTILITY WORK SHOWN ON THIS SHEET.

-Y10RPC-		-Y10RPD-		-Y9-	
PI Sta 18+99.65	PIs Sta 24+08.13	PI Sta 18+07.15	PIs Sta 23+12.00	PI Sta 20+60.71	
$\Delta = 74' 11" 00.0"$ (RT)	$\Theta s = 6' 59" 14.2"$	$\Delta = 73' 02' 03.1"$ (LT)	$\Theta s = 6' 59" 14.2"$	$\Delta = 0' 39' 21.1"$ (LT)	
D = 6' 59' 14.2"	Ls = 200.00'	D = 6' 59' 14.2"	Ls = 200.00'	D = 0' 14' 59.4"	
L = 1,061.69'	LT = 133.44'	L = 1,045.24'	LT = 133.44'	L = 262.51'	
T = 619.97'	ST = 66.76'	T = 607.15'	ST = 66.76'	T = 131.26'	
R = 820.00'		R = 820.00'		R = 22,933.03'	
SE = .08		SE = .08			
RO = 200'		RO = 200'			

MATCHLINE -Y10- STA. 22 + 50.00
SEE UO 11

MATCHLINE -Y8- STA. 33 + 40.00
SEE UO 11

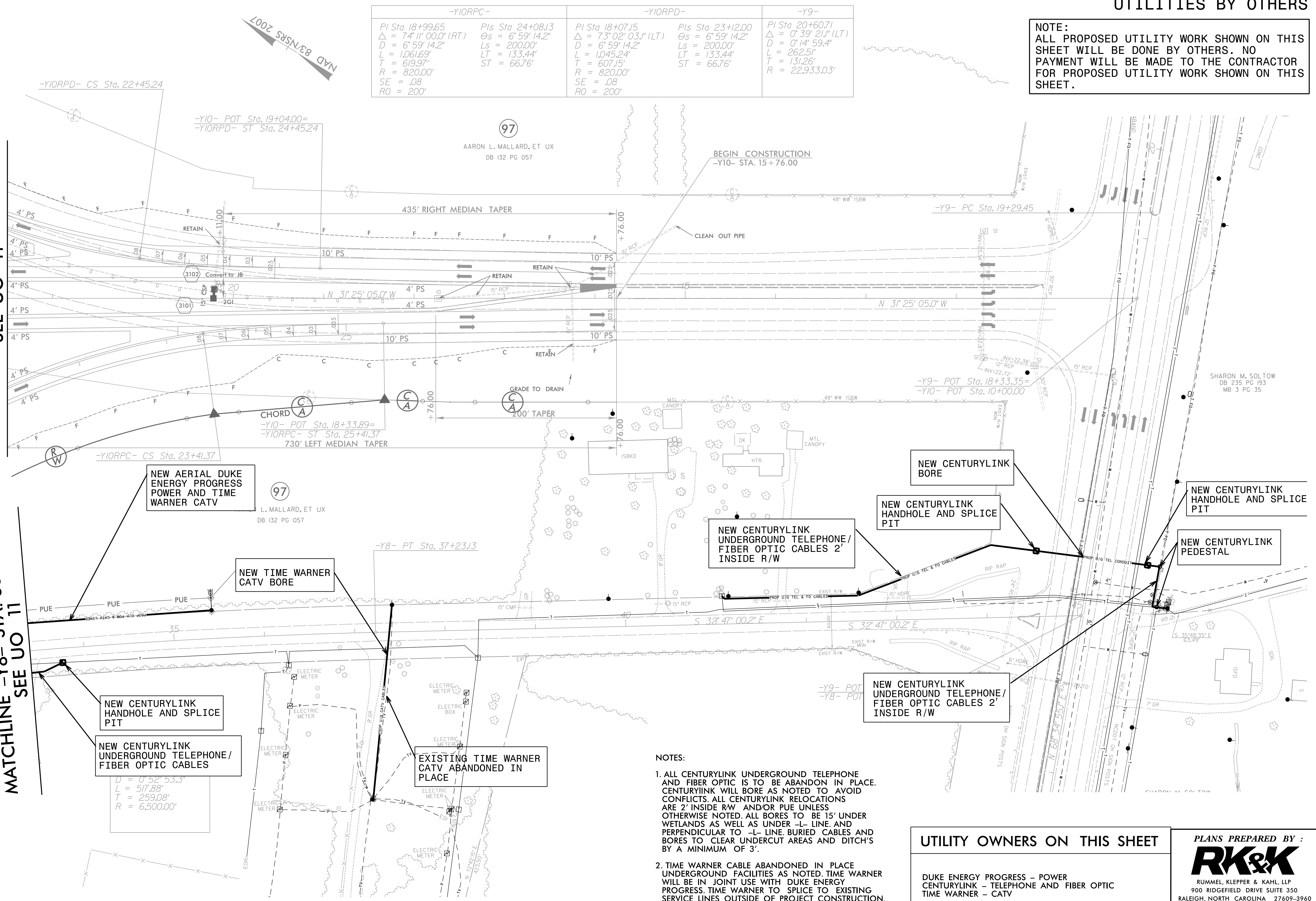

- NOTES:**
1. ALL CENTURYLINK UNDERGROUND TELEPHONE AND FIBER OPTIC IS TO BE ABANDON IN PLACE. CENTURYLINK WILL BORE AS NOTED TO AVOID CONFLICTS. ALL CENTURYLINK RELOCATIONS ARE 2' INSIDE RW AND/OR PUE UNLESS OTHERWISE NOTED. ALL BORES TO BE 15' UNDER WETLANDS AS WELL AS UNDER -L- LINE AND PERPENDICULAR TO -L- LINE. BURIED CABLES AND BORES TO CLEAR UNDERCUT AREAS AND DITCH'S BY A MINIMUM OF 3'.
 2. TIME WARNER CABLE ABANDONED IN PLACE UNDERGROUND FACILITIES AS NOTED. TIME WARNER WILL BE IN JOINT USE WITH DUKE ENERGY PROGRESS. TIME WARNER TO SPLICE TO EXISTING SERVICE LINES OUTSIDE OF PROJECT CONSTRUCTION.

<p>UTILITY OWNERS ON THIS SHEET</p> <p>DUKE ENERGY PROGRESS - POWER CENTURYLINK - TELEPHONE AND FIBER OPTIC TIME WARNER - CATV</p>	<p>PLANS PREPARED BY :</p> <p>RK&K</p> <p>RUMMEL, KLEPPER & KAHL, LLP 900 RIDGEFIELD DRIVE SUITE 350 RALEIGH, NORTH CAROLINA 27609-3960 NC LICENSE NO. F-0112 • (919) 878-9560</p>
---	---