

STATE OF NORTH CAROLINA  
DIVISION OF HIGHWAYS

**TRANSPORTATION MANAGEMENT PLAN**

**JONES - CRAVEN COUNTY**

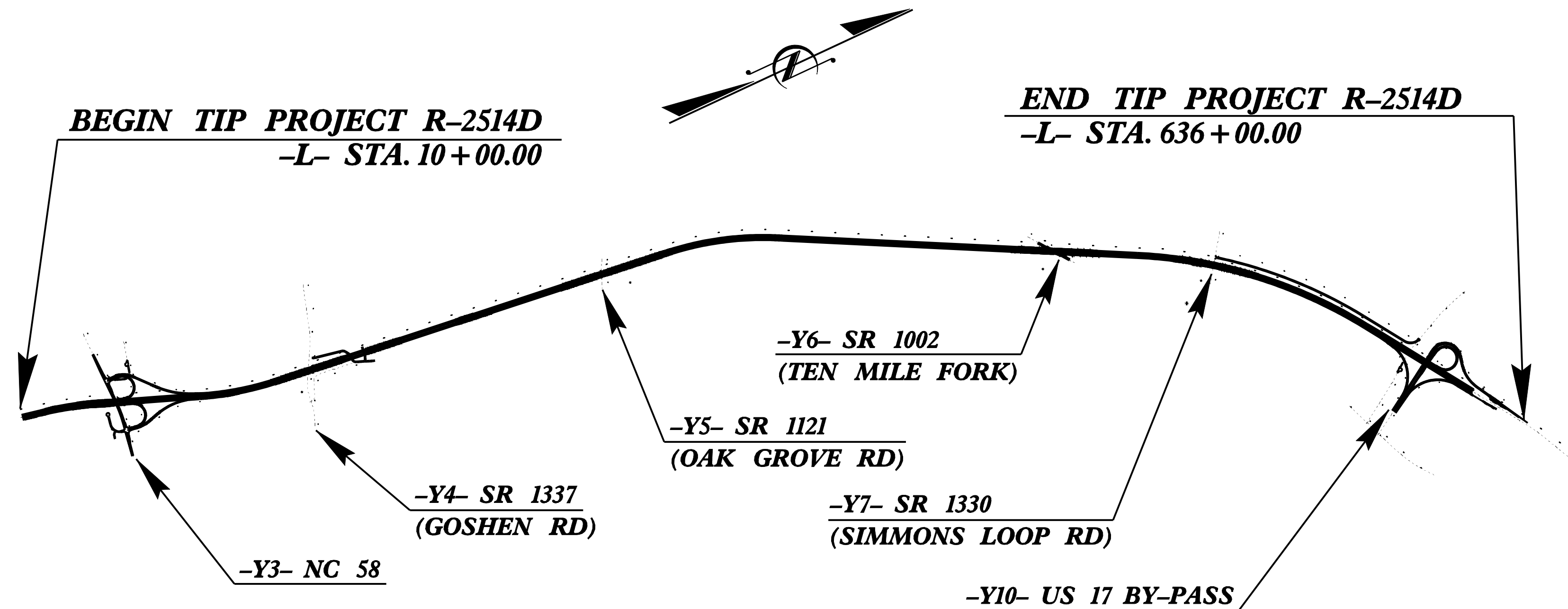

**INDEX OF SHEETS**

SHEET NO.	TITLE
TMP-1	TITLE SHEET, VICINITY MAP AND INDEX OF SHEETS
TMP-1A	LIST OF APPLICABLE ROADWAY STANDARD DRAWINGS, AND LEGEND
TMP-1B	TRANSPORTATION OPERATIONS PLAN: (MANAGEMENT STRATEGIES, GENERAL NOTES)
TMP-1C	PCB TYPICALS
TMP-2	US 17 BY-PASS OFFSITE DETOUR ROUTE
TMP-2A	US 17 BY-PASS OFFSITE DETOUR DETAILS
TMP-2B	US 17 BY-PASS OFFSITE DETOUR DETAILS
TMP-3	TRANSPORTATION OPERATIONS PLAN: (WRITTEN PHASING)
TMP-4 THRU TMP-11	TEMPORARY TRAFFIC CONTROL PHASE I DETAILS
TMP-12 THRU TMP-14	TEMPORARY TRAFFIC CONTROL PHASE II DETAILS
TMP-15	TEMPORARY TRAFFIC CONTROL PHASE III OVERVIEW
TMP-16	TEMPORARY TRAFFIC CONTROL PHASE III DETAIL

SHEET NO.  
TMP-1

**R-2514D**

**TIP PROJECT:**

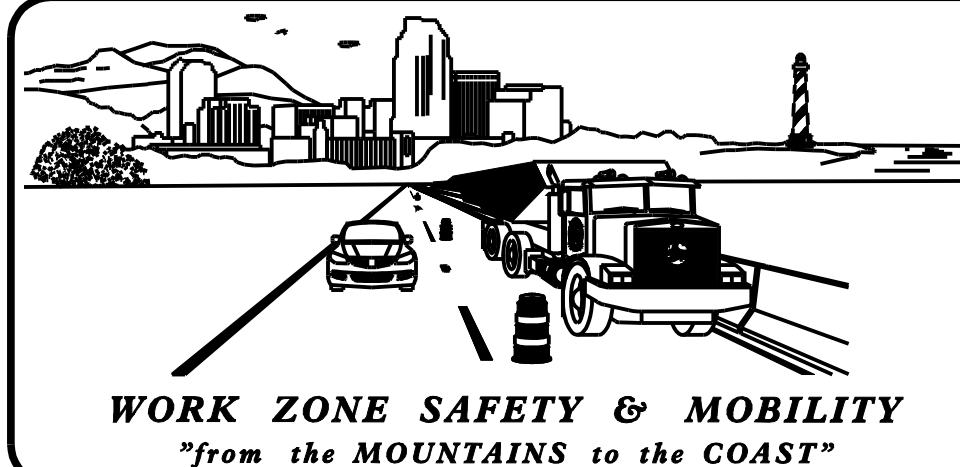

**N.C.D.O.T. WORK ZONE TRAFFIC CONTROL**  
1561 MAIL SERVICE CENTER (MSC) RALEIGH, NC 27699-1561  
750 N. GREENFIELD PARKWAY, GARNER, NC 27529 (DELIVERY)  
PHONE: (919) 773-2800 FAX: (919) 771-2745

J. S. BOURNE, P.E. STATE TRAFFIC MANAGEMENT ENGINEER  
STEVE KITE, P.E. TRAFFIC CONTROL PROJECT ENGINEER  
DON PARKER TRAFFIC CONTROL PROJECT DESIGN ENGINEER  
TRAFFIC CONTROL DESIGN ENGINEER

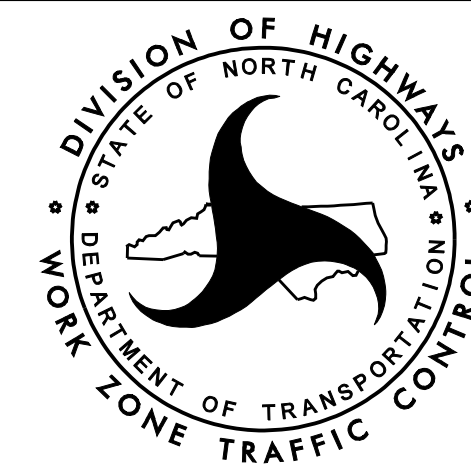

Prepared in the Office of:  
**PROGRESSIVE DESIGN GROUP, INC.**  
ENGINEERS • CONSULTANTS

APPROVED: Tim Arrey  
DATE: 3/27/2013

SEAL