

WEYERHAEUSER COMPANY  
FORMERLY BATE LUMBER COMPANY  
DB 105 PG 564  
MB 2 PG 80  
DIVISION BOOK G-7 PG 475

NOTE: A PERMANENT SOIL REINFORCEMENT MAT (PSRM) SHALL BE PLACED ON SLOPES STEEPER THAN 3:1 (H:V) FROM STA. 527+00 ± -L- TO STA. 532+50 ± -L-. SEE PERMANENT SOIL REINFORCEMENT MAT SPECIAL PROVISION.

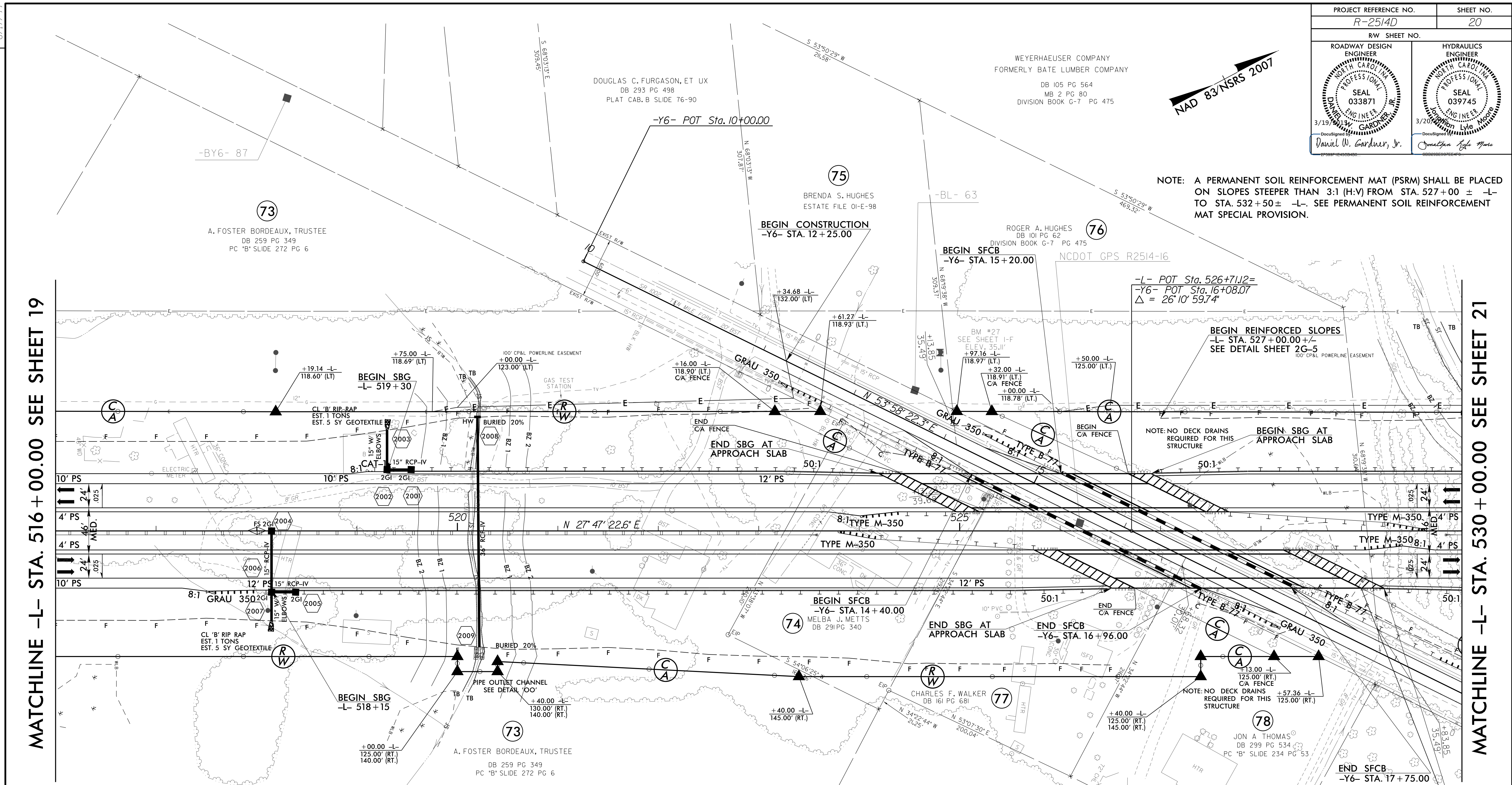

MATCHLINE -L- STA. 516 + 00.00 SEE SHEET 19

MATCHLINE -L- STA. 530 + 00.00 SEE SHEET 21

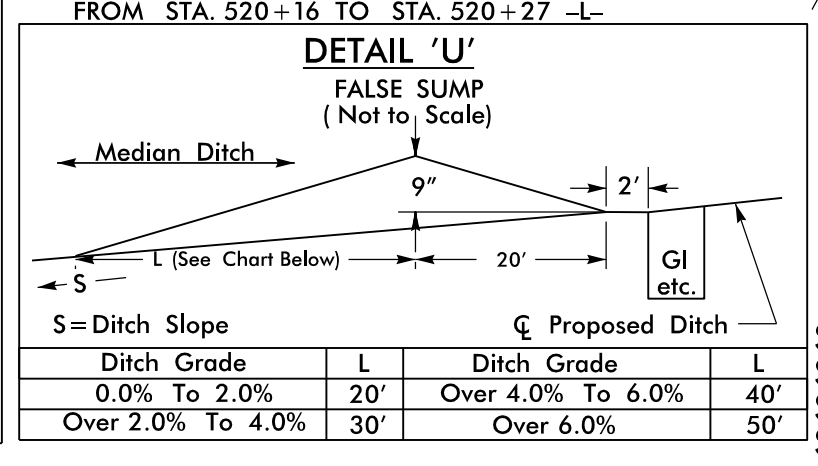
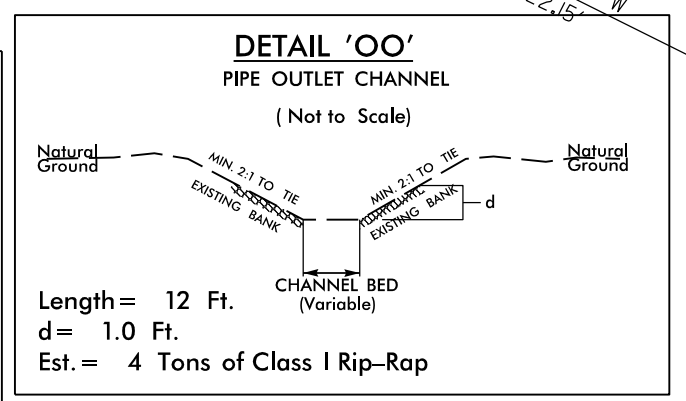
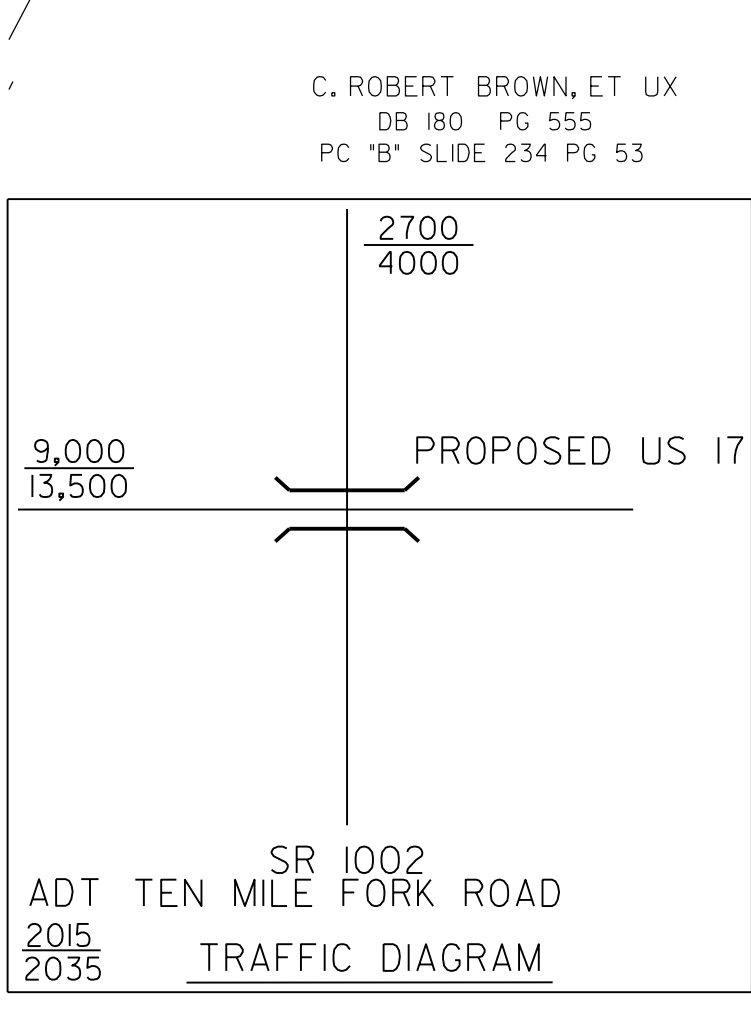
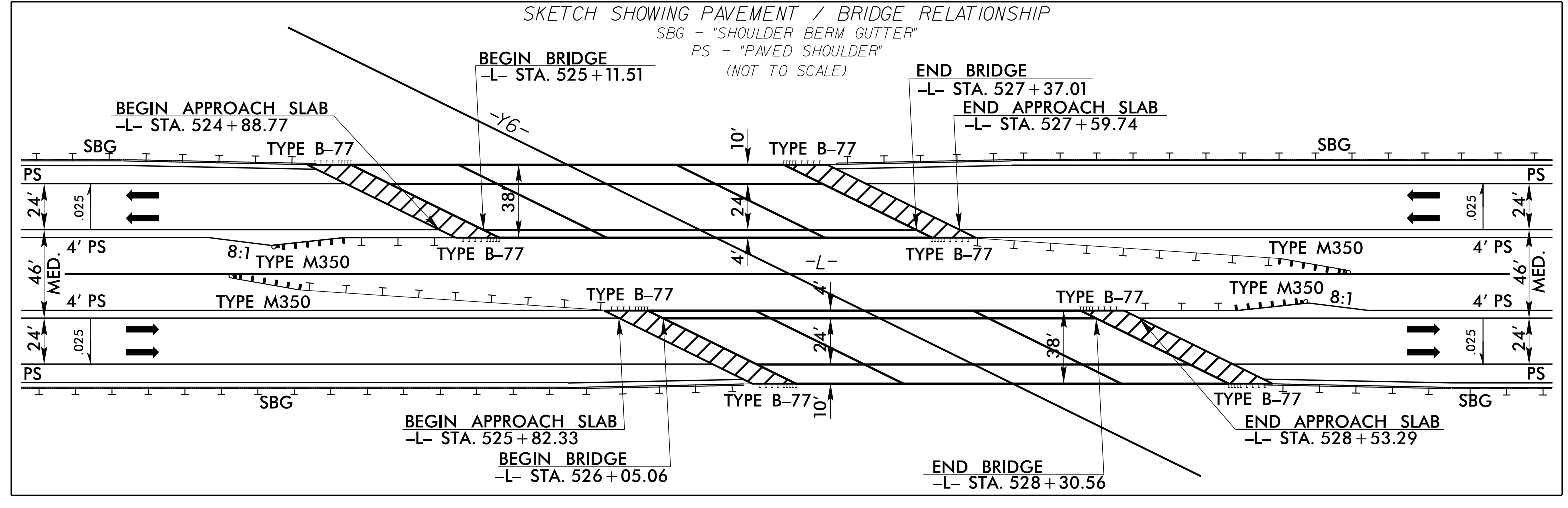

C. ROBERT BROWN, ET UX  
DB 186 PG 906  
PC 'B' SLIDE 234 PG 53

SBG - "SHOULDER BERM GUTTER"  
SFCB - "SINGLE FACED CONCRETE BARRIER"

SEE SHEET 40 FOR -L- PROFILE  
SEE SHEET 53 FOR -Y6- PROFILE  
SEE SHEETS S11-001 THRU S11-038 FOR STRUCTURE PLANS  
SEE SHEETS S12-001 THRU S12-038 FOR STRUCTURE PLANS

REVISIONS

3/16/2015 10:52:21 AM C:\cadd\2514D\Roadway\Proj\R2514D\_RBy\_psh\_20.dgn