

NAD 83/NSRS 2007

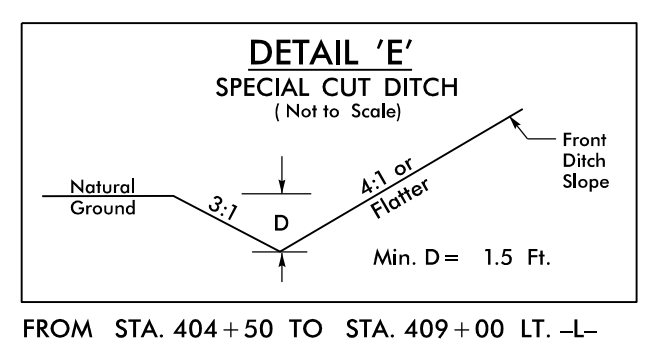

FROM STA. 404+50 TO STA. 409+00 LT. -L-

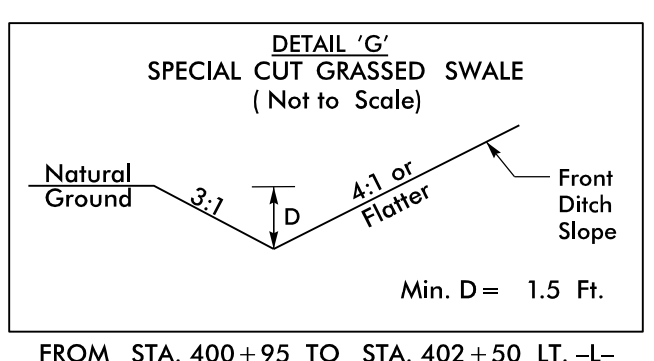

FROM STA. 400+95 TO STA. 402+50 LT. -L-
FROM STA. 404+50 TO STA. 408+50 RT. -L-
FROM STA. 399+70 TO STA. 400+95 LT. -L-

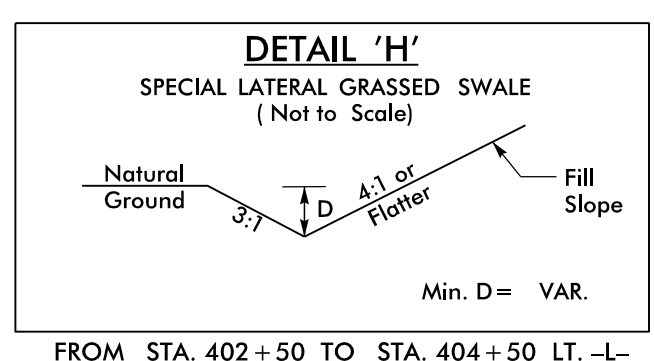

FROM STA. 402+50 TO STA. 404+50 LT. -L-

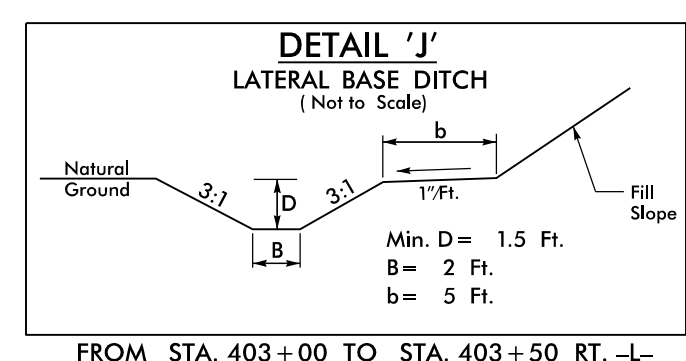

FROM STA. 403+00 TO STA. 403+50 RT. -L-

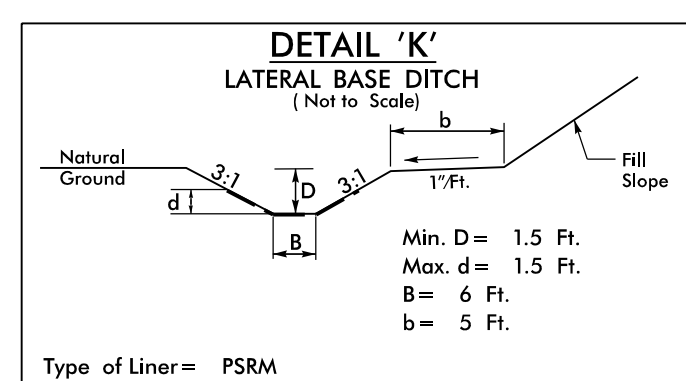

Type of Liner = PSRM
FROM STA. 398+50 TO STA. 399+18 RT. -L-
FROM STA. 399+18 TO STA. 403+00 RT. -L-
STACIA ANN HARRIS
DB 319 PG 129

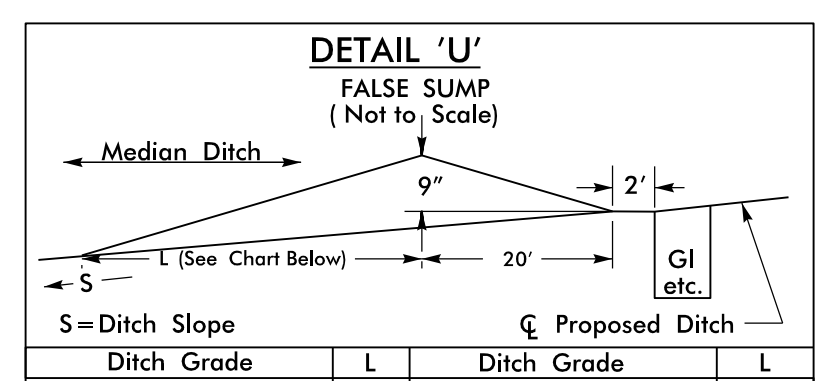

Ditch Grade	L	Ditch Grade	L
0.0% To 2.0%	20'	Over 4.0% To 6.0%	40'
Over 2.0% To 4.0%	30'	Over 6.0%	50'

57
C. E. WILLIE, SR, HEIRS
DB 110 PG 221
MB 6 PG 26

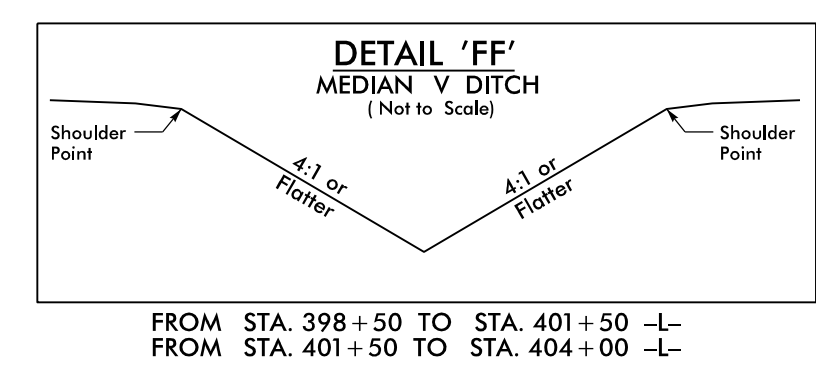

FROM STA. 398+50 TO STA. 401+50 -L-
FROM STA. 401+50 TO STA. 404+00 -L-

MATCHLINE -L- STA. 396 + 00.00 SEE SHEET 10

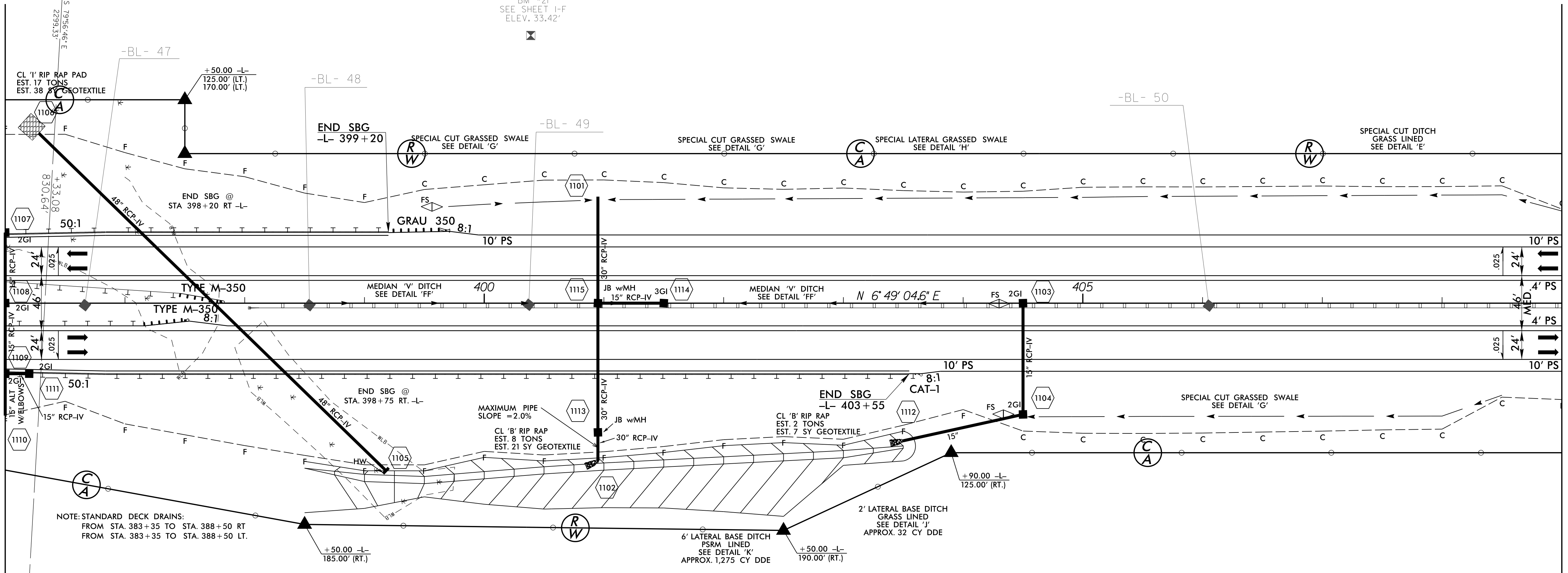

NOTE: STANDARD DECK DRAINS:
FROM STA. 383+35 TO STA. 388+50 RT
FROM STA. 383+35 TO STA. 388+50 LT.

57
C. E. WILLIE, SR, HEIRS
DB 110 PG 221
MB 6 PG 26

MATCHLINE -L- STA. 409 + 00.00 SEE SHEET 12

SBG - "SHOULDER BERM GUTTER"

SEE SHEET 36 FOR -L- PROFILE

REVISIONS

8/17/99
P:\62201\Cadd\2514D\Roadway\Proj\NR2514D_Roadway\psh_11.dgn