

5/14/99
69
68
67
66
65
64
63
62
61
60
59
58
57
56
55
54
53
52
51
50
49
48
47
46
45
44
43
42
41
40
39
38
37
36
35
34
33
32
31
30
29
28
27
26
25
24
23
22
21
20
19
18
17
16
15
14
13
12
11
10
9
8
7
6
5
4
3
2
1

PROJECT REFERENCE NO. <i>R-3622B</i>	SHEET NO. <i>21</i>
ROADWAY DESIGN ENGINEER	HYDRAULICS ENGINEER

-L-

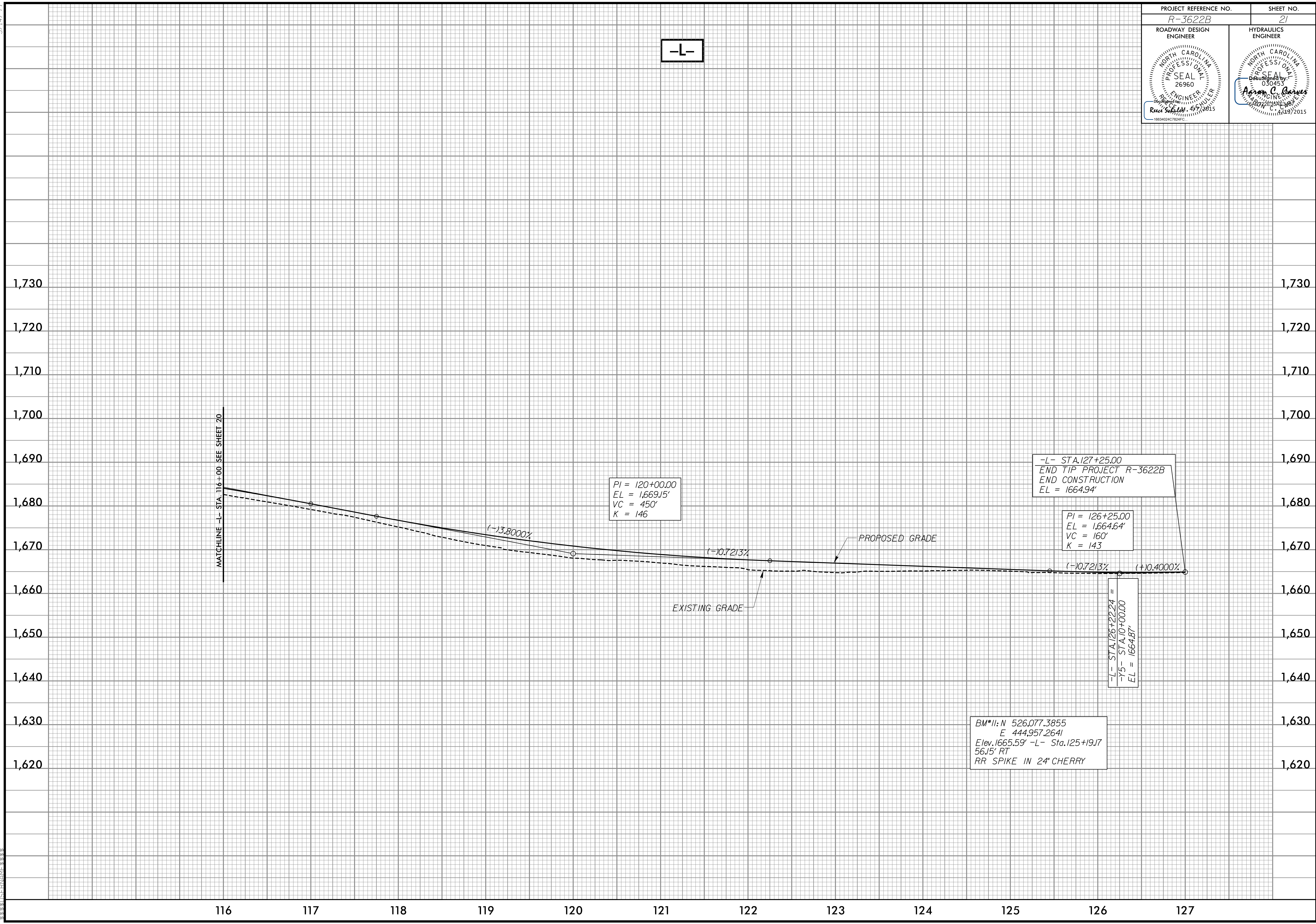

PI = 120+00.00
 EL = 1,669.15'
 VC = 450'
 K = 146

-L- STA. 127+25.00
 END TIP PROJECT R-3622B
 END CONSTRUCTION
 EL = 1664.94'

PI = 126+25.00
 EL = 1,664.64'
 VC = 160'
 K = 143

BM#11: N 526,077.3855
 E 444,957.2641
 Elev. 1665.59' -L- Sta. 125+19.17
 56.15' RT
 RR SPIKE IN 24" CHERRY

-L- STA. 126+22.24 =
 -75- STA. 10+00.00
 EL = 1664.87'

MATCHLINE -L- STA. 116+00 SEE SHEET 20

(-13.8000%)

(-10.7213%)

PROPOSED GRADE

EXISTING GRADE

(-10.7213%)

(+10.4000%)

116

117

118

119

120

121

122

123

124

125

126

127

1,730

1,720

1,710

1,700

1,690

1,680

1,670

1,660

1,650

1,640

1,630

1,620

1,730

1,720

1,710

1,700

1,690

1,680

1,670

1,660

1,650

1,640

1,630

1,620