

Kimley-Horn
and Associates, Inc.
P.O. BOX 33068
RALEIGH, N.C. 27636-3068

| | |
|----------------------------------|---------------------------|
| PROJECT REFERENCE NO. U-3609A | SHEET NO. EC-5/CONST.5 |
| ROADWAY DESIGN ENGINEER | HYDRAULICS ENGINEER |
| | |

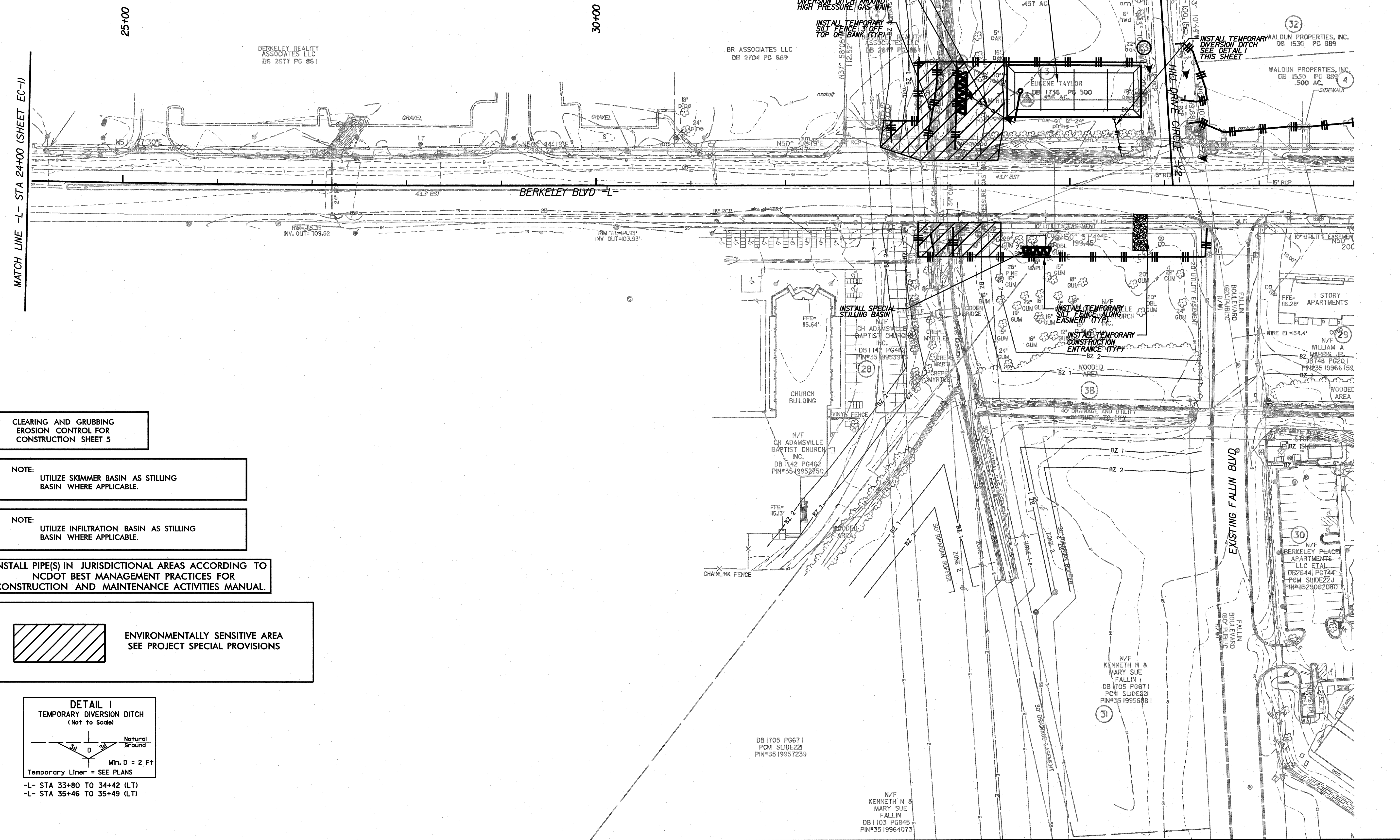

CLEARING AND GRUBBING
EROSION CONTROL FOR
CONSTRUCTION SHEET 5

NOTE:
UTILIZE SKIMMER BASIN AS STILLING
BASIN WHERE APPLICABLE.

NOTE:
UTILIZE INFILTRATION BASIN AS STILLING
BASIN WHERE APPLICABLE.

INSTALL PIPE(S) IN JURISDICTIONAL AREAS ACCORDING TO
NCDOT BEST MANAGEMENT PRACTICES FOR
CONSTRUCTION AND MAINTENANCE ACTIVITIES MANUAL.

ENVIRONMENTALLY SENSITIVE AREA
SEE PROJECT SPECIAL PROVISIONS

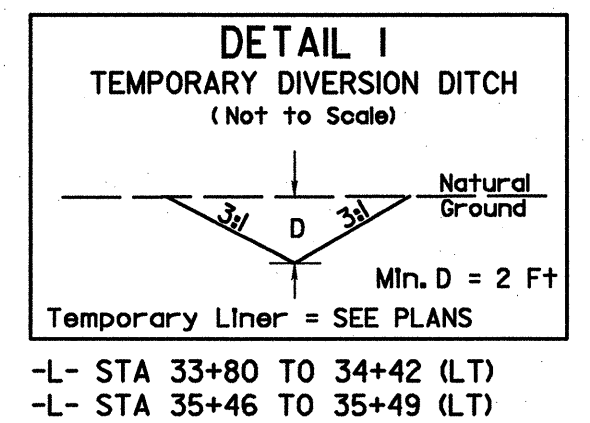

-L- STA 33+80 TO 34+42 (LT)
-L- STA 35+46 TO 35+49 (LT)

K:\RAL_Roadway\011746003 (Berkeley Blvd)\Plan\Erosion\011746003.ec05.dgn 1/26/2015