

BEGIN CONSTRUCTION
-Y2- STA. 17+44

SEE SHEET TMP-8 -Y1- STA 19+00.00

SEE INSET THIS SHEET -L- STA. 10+00.00

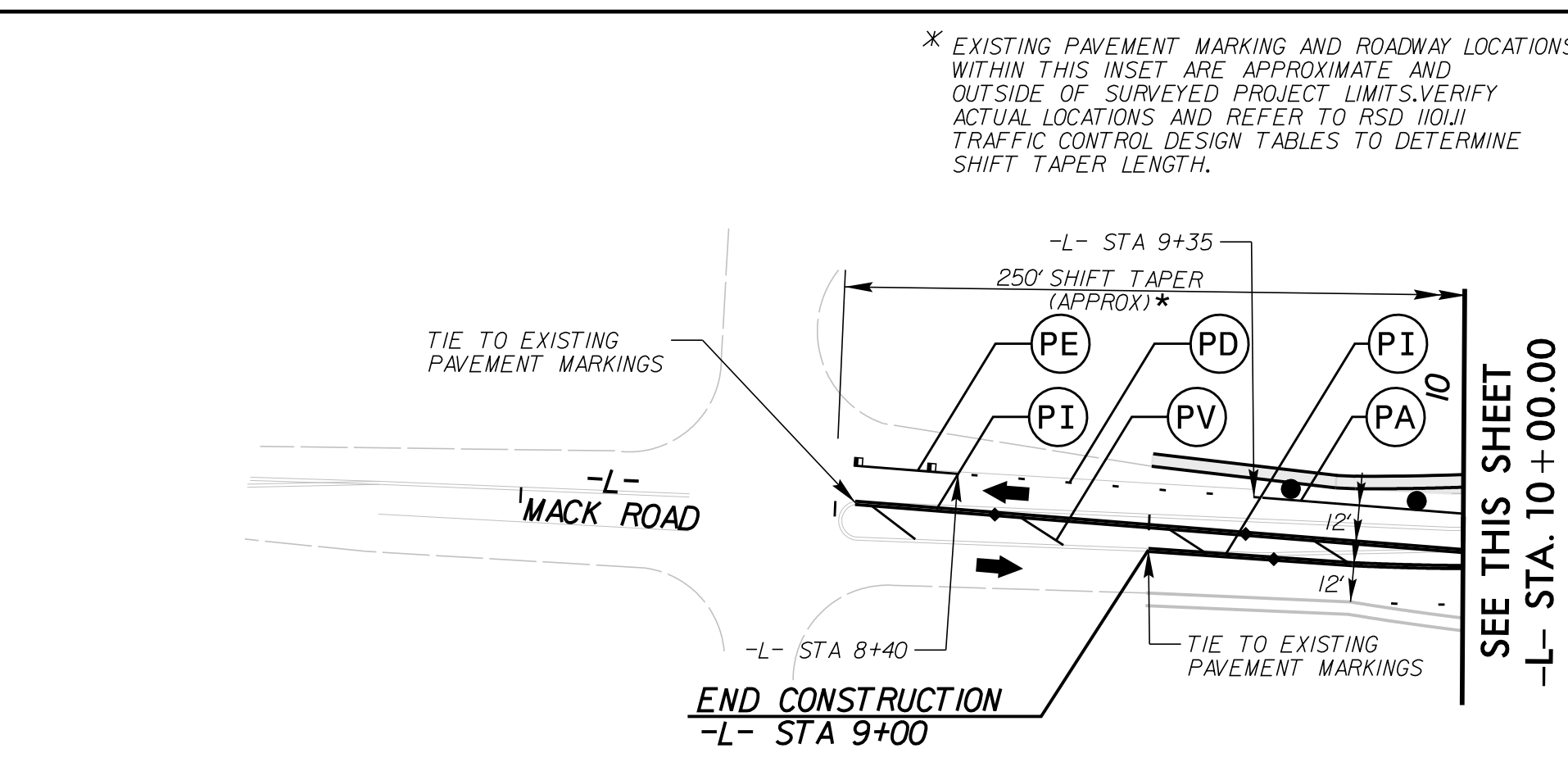
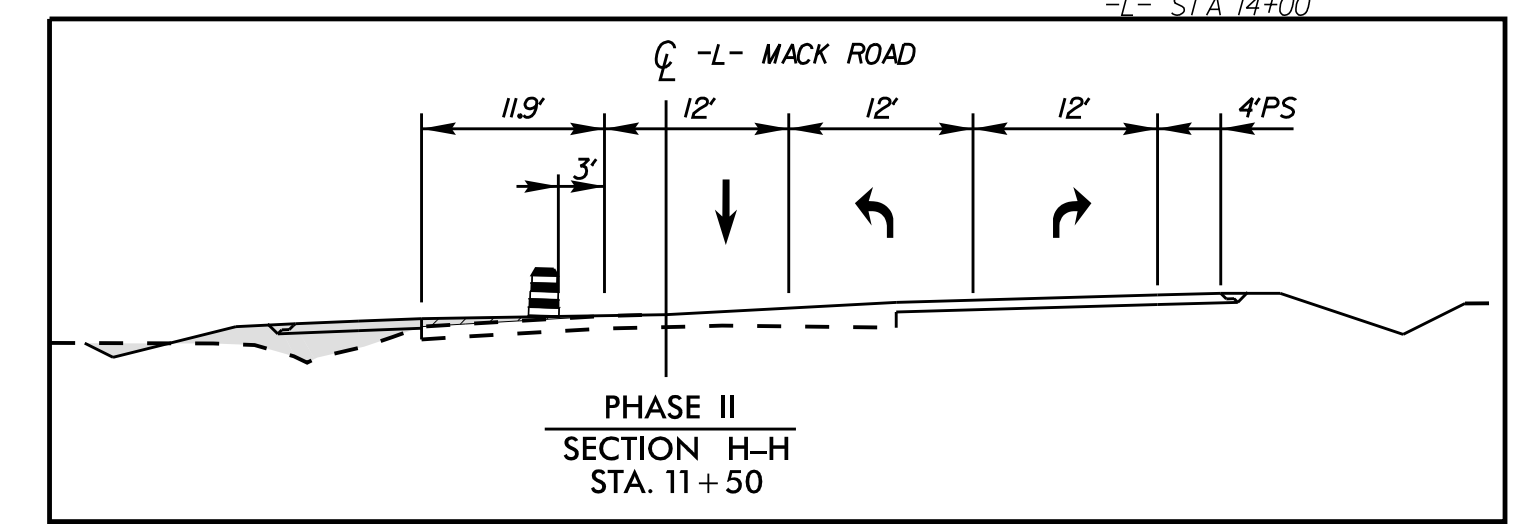

INSTALL DRAINAGE STRUCTURES WITHIN THE ROAD WHILE MAINTAINING TRAFFIC AND USING TEMPORARY LANE CLOSURES (TYP)



MACK ROAD EXTENSION

BEGIN CONSTRUCTION
-Y2- STA. 23+50

END CONSTRUCTION
-Y1- STA. 25+82

BEGIN CONSTRUCTION
-Y2- STA. 23+50

SEE SHEET TMP-9 -Y2- STA 24+30.00

SEE SHEET TMP-9 -Y1- STA 29+00.00

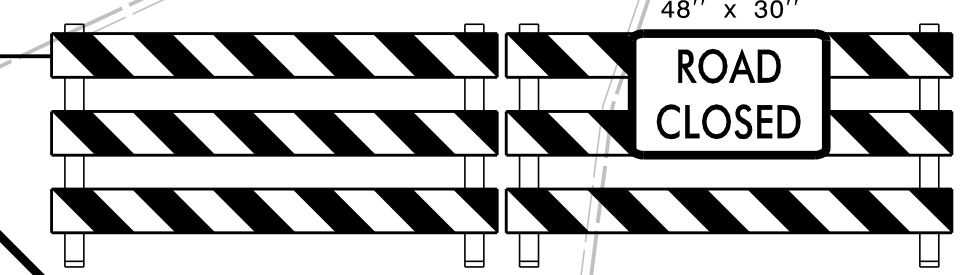
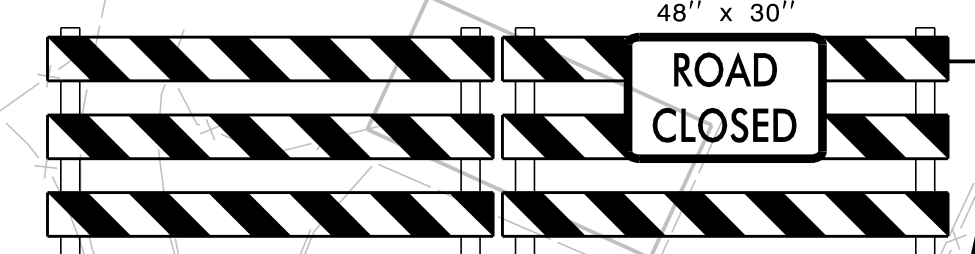
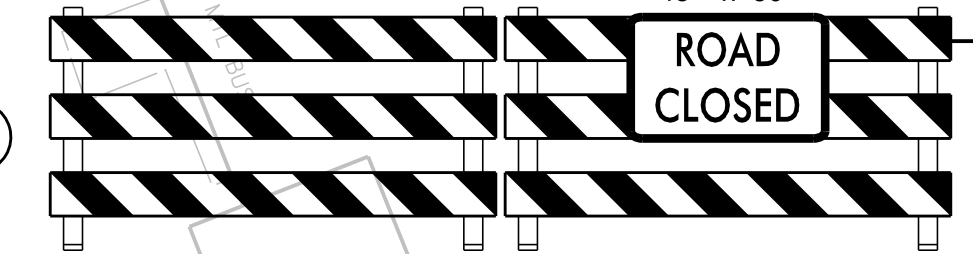

- WORK AREA
- PAVEMENT REMOVAL
- WEDGING

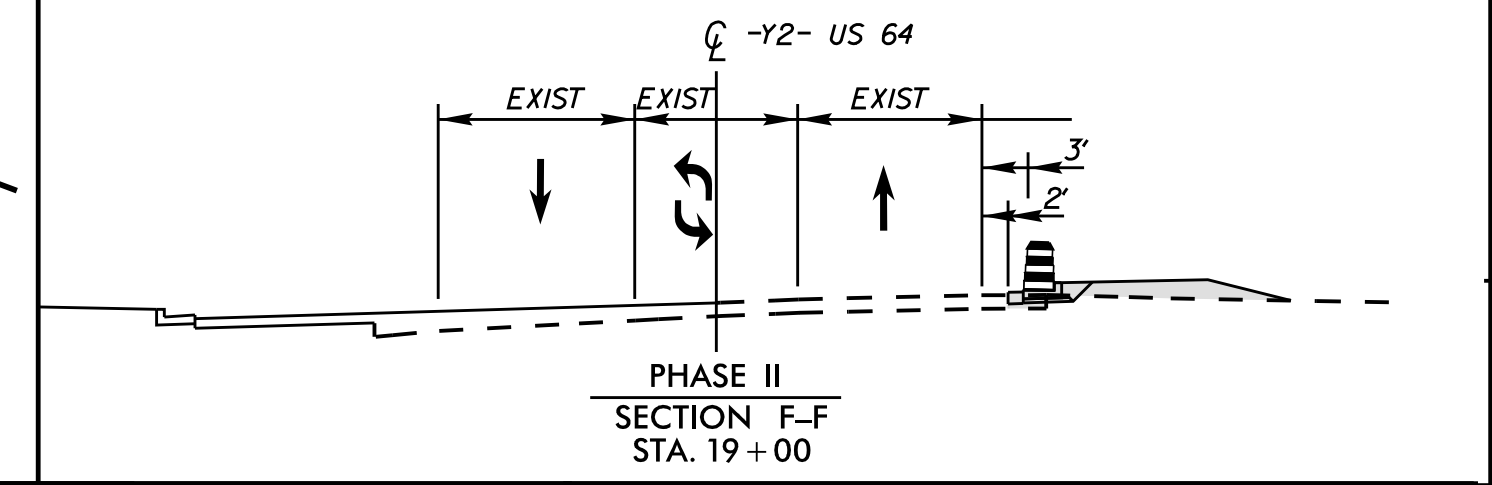
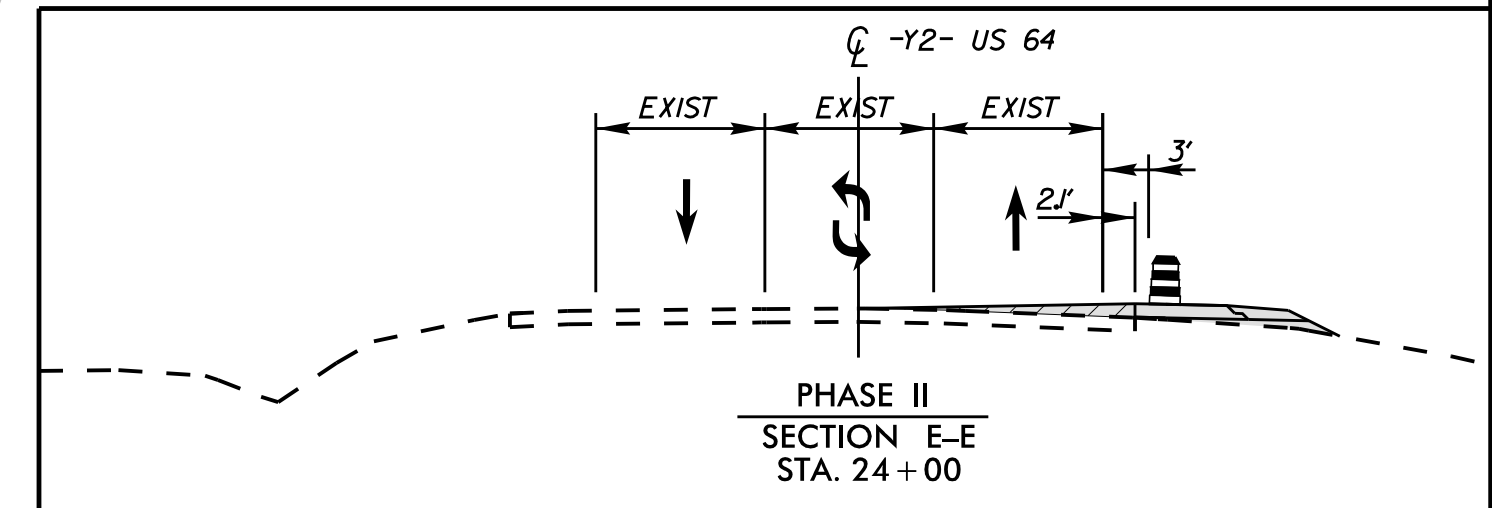

3/24/2015 K:\RAL_Roadway\01036234 - U-5305 TMP\Plan\Plan Sheets\U5305 TMP_PSH_07.dgn

APPROVED: _____ DATE: _____

DocuSigned by:
Matt West
AC71A1D079E9A25
4/6/2015

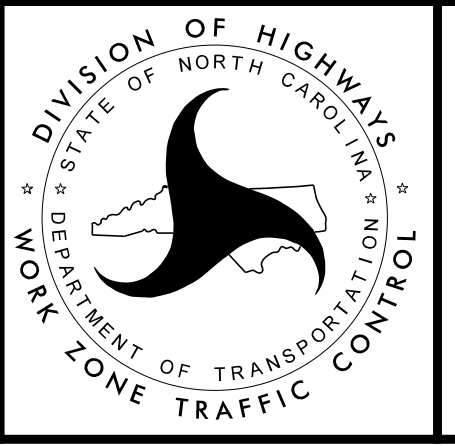

TRAFFIC CONTROL PHASE II