

SURVEY CONTROL SHEET U-5305

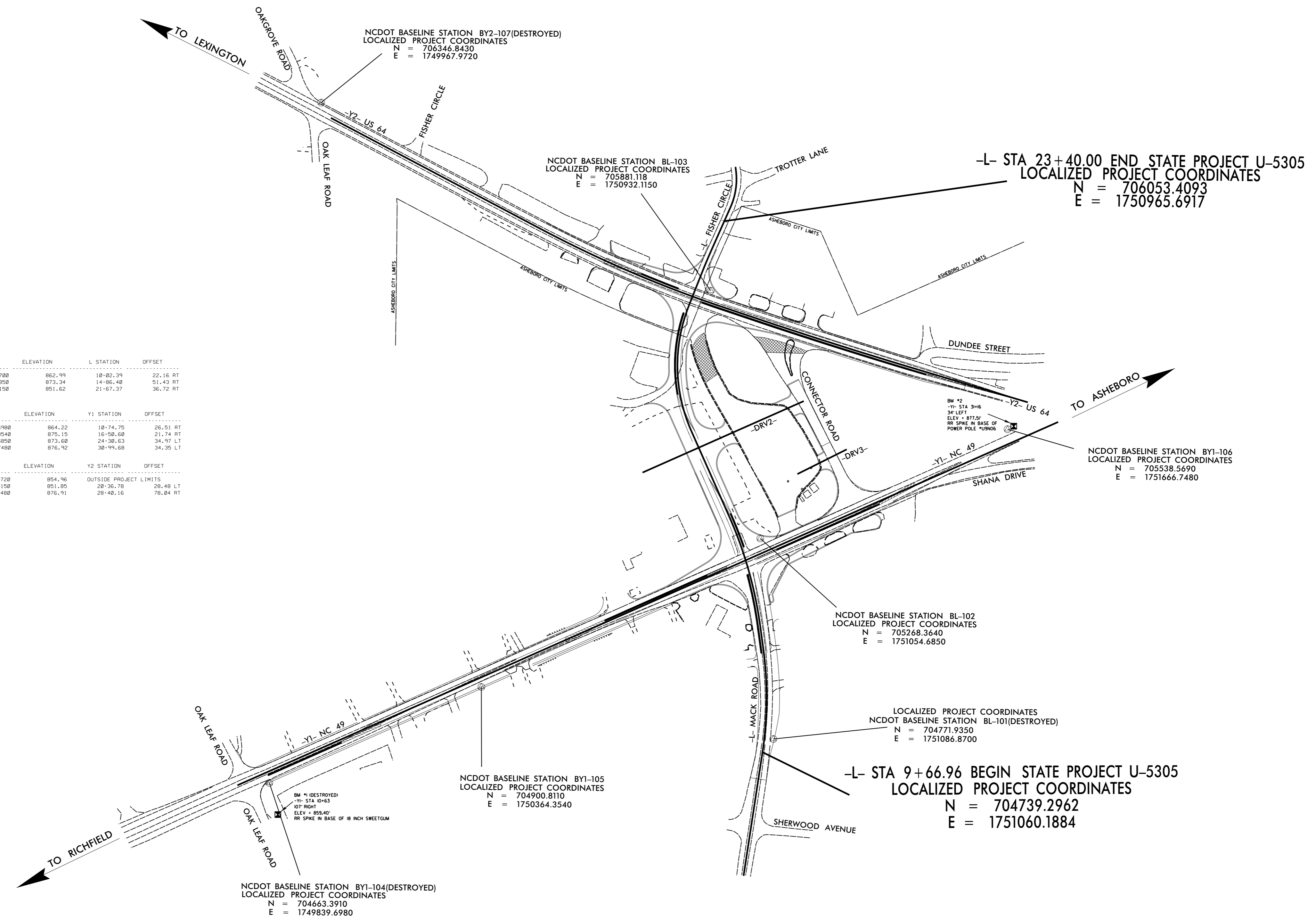

BL POINT	DESC.	NORTH	EAST	ELEVATION	L STATION	OFFSET
101(DESTROYED)	BL-101	704771.9350	1751086.8700	862.99	10+82.39	22.16 RT
102	BL-102	705268.3640	1751054.6850	873.34	14+86.48	51.43 RT
103	BL-103	705881.7180	1750932.1150	851.62	21+67.37	36.72 RT

BY1 POINT	DESC.	NORTH	EAST	ELEVATION	Y1 STATION	OFFSET
104(DESTROYED)	BY1-104	704663.3910	1749839.6980	864.22	10+74.75	26.51 RT
105	BY1-105	704900.8110	1750364.3540	875.15	16+58.08	21.74 RT
102	BL-102	705268.3640	1751054.6850	873.68	24+30.63	34.97 LT
106	BY1-106	705538.5690	1751666.7480	876.92	30+99.68	34.35 LT

BY2 POINT	DESC.	NORTH	EAST	ELEVATION	Y2 STATION	OFFSET
107(DESTROYED)	BY2-107	706346.8430	1749967.9720	854.96	OUTSIDE PROJECT LIMITS	
103	BL-103	705881.7180	1750932.1150	851.65	20+35.78	28.48 LT
106	BY1-106	705538.5690	1751666.7480	876.91	28+40.16	78.84 RT

BM1 ELEVATION = 859.40(DESTROYED)
N 704955 E 174980
Y1 STATION 10+63.00 107 RIGHT
RR SPIKE IN BASE OF 18 INCH SWEETGUM

BM2 ELEVATION = 877.51
N 705545 E 1751682
Y1 STATION 31+16.00 34 LEFT
RR SPIKE IN BASE OF POWER POLE *UPN06

DATUM DESCRIPTION

THE LOCALIZED COORDINATE SYSTEM DEVELOPED FOR THIS PROJECT IS BASED ON THE STATE PLANE COORDINATES ESTABLISHED BY NCDOT FOR MONUMENT "TL6A"

WITH NAD 83/95 STATE PLANE GRID COORDINATES OF
NORTHING: 720780.4317(ft) EASTING: 1722528.0049(ft)
ELEVATION: 454.894(ft)

THE AVERAGE COMBINED GRID FACTOR USED ON THIS PROJECT (GROUND TO GRID) IS: 0.99988402

THE N.C. LAMBERT GRID BEARING AND LOCALIZED HORIZONTAL GROUND DISTANCE FROM "TL6A" TO -L- STATION 9+66.96 IS
S 60° 39' 17.2" E 32,732.301'

ALL LINEAR DIMENSIONS ARE LOCALIZED HORIZONTAL DISTANCES
VERTICAL DATUM USED IS NAVD 88

NOTES:

1. THE CONTROL DATA FOR THIS PROJECT CAN BE FOUND ELECTRONICALLY BY SELECTING PROJECT CONTROL DATA AT:
[HTTP://WWW.NCDOT.ORG/DOH/PRECONSTRUCTION/HIGHWAY/LOCATION/PROJECT/](http://www.ncdot.org/doh/preconstruction/highway/location/project/)

THE FILES TO BE FOUND ARE AS FOLLOWS:
U5305_LS_CONTROL.TXT

SITE CALIBRATION INFORMATION HAS NOT BEEN PROVIDED FOR THIS PROJECT. IF FURTHER INFORMATION IS NEEDED, PLEASE CONTACT THE LOCATION AND SURVEYS UNIT.

⊙ INDICATES GEODETIC CONTROL MONUMENTS USED OR SET FOR HORIZONTAL PROJECT CONTROL BY THE NCDOT LOCATION AND SURVEYS UNIT.
PROJECT CONTROL ESTABLISHED USING GLOBAL POSITIONING SYSTEM.
NETWORK ESTABLISHED FROM EXISTING HARN MONUMENTATION

NOTE: DRAWING NOT TO SCALE

6/2/99

05-MAR-2015 12:03 U5305_1s_1c-1.dgn
1433015871416