

DRAWING 1

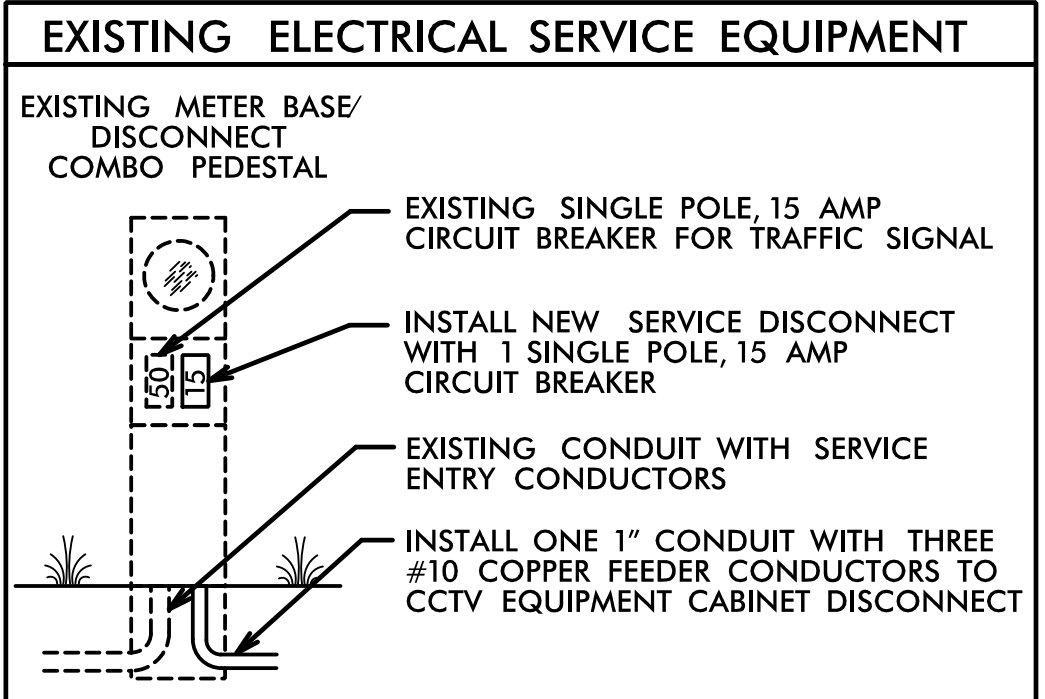

DRAWING 2

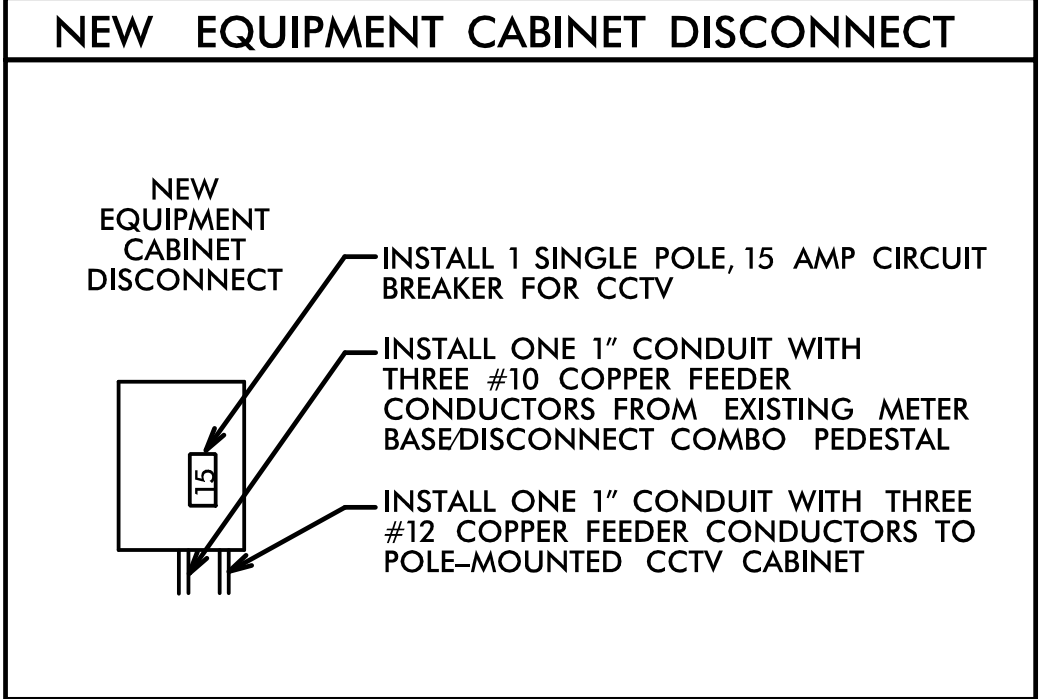

CCTV-7 GPS COORDINATES

N 35° 21.725'
W 80° 44.928'

MATCHLINE - SEE SHEET ITS-26

MATCHLINE - SEE SHEET ITS-28

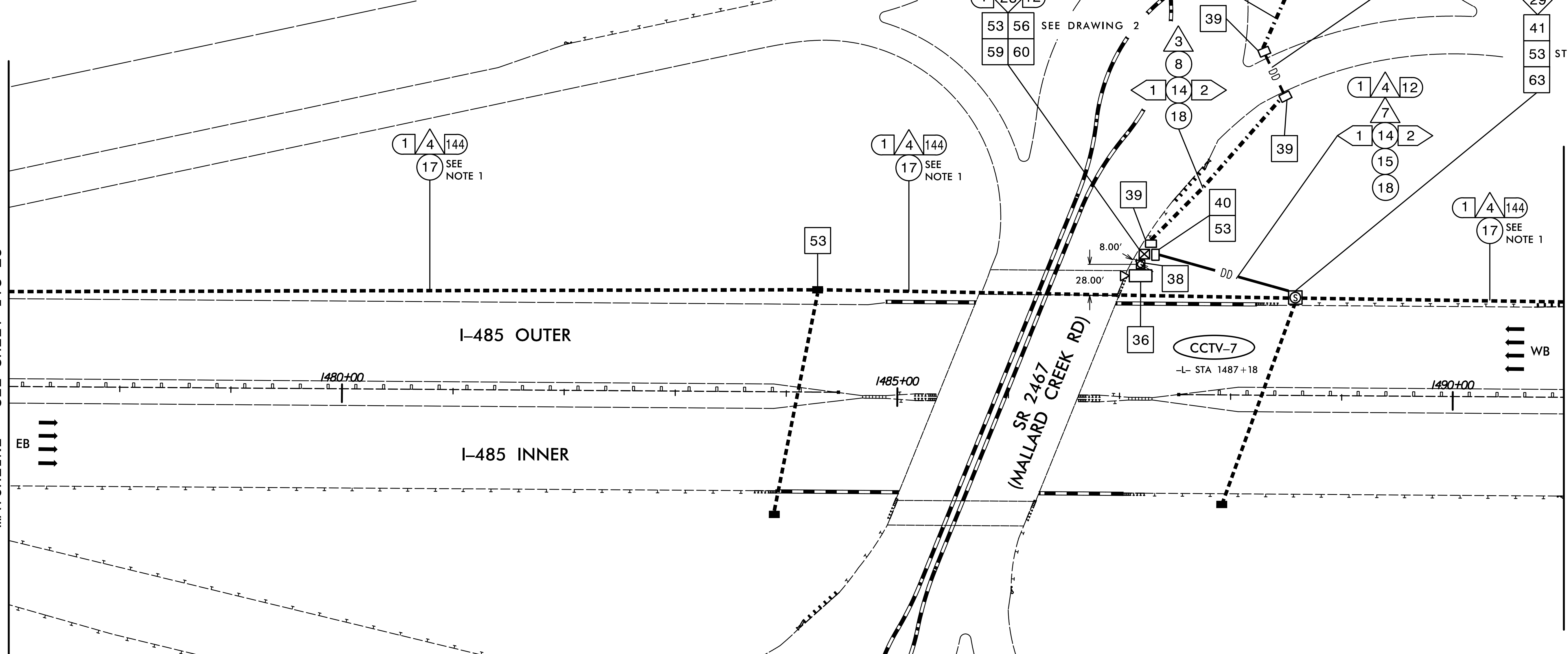

NOTES:

1. INSTALL FIBER-OPTIC CABLE INTO THE EXISTING BLACK DUCT.
2. CONTACT THE REGIONAL ITS ENGINEER AT (704) 347-6601 TO CONFIRM THE LOCATION OF THE CCTV.
3. MOUNT THE CCTV CAMERA 45' ABOVE GRADE.
4. INSTALL A LEVEL CONCRETE TECHNICIAN PAD MEASURING A MINIMUM OF 4 INCHES THICK, 24 INCHES WIDE AND 36 INCHES LONG AT THE FRONT DOOR OF THE CCTV EQUIPMENT CABINET. SEE TYPICAL DETAILS SHEET.
5. CONTACT CHARLES ABEL (CITY OF CHARLOTTE) AT (704) 336-3945 TO COORDINATE ANY TRAFFIC SIGNAL SERVICE MODIFICATIONS.

NOTE:
ELECTRICAL SERVICE DETAILS AND CONSTRUCTION METHODS DEPICT FIELD CONDITIONS AT THE TIME OF DESIGN. CONTRACTOR IS TO VERIFY ACTUAL CONDITIONS AT THE TIME OF CONSTRUCTION AND OBTAIN APPROVAL FROM THE ENGINEER PRIOR TO MAKING ANY CHANGES.

HNTB HNTB NORTH CAROLINA, P.C.
343 E. Six Forks Road, Suite 200
Raleigh, North Carolina 27609
NC License No: C-1554

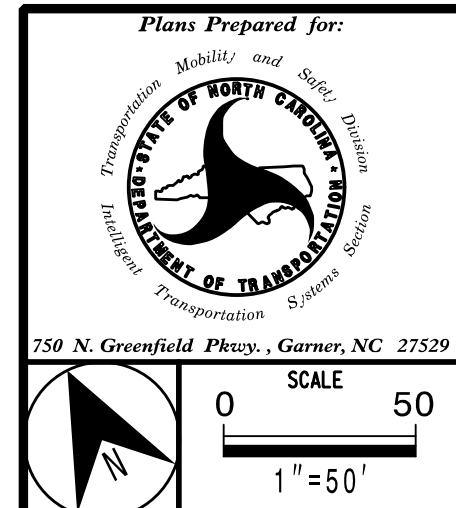

Plans Prepared for:
Transmission Mobility and Safety Division
DEPARTMENT OF TRANSPORTATION
STATE OF NORTH CAROLINA

750 N. Greenfield Place, Garner, NC 27529

SCALE 50
1" = 50'

REVISIONS	INIT.	DATE

SEAL
NORTH CAROLINA
PROFESSIONAL
ENGINEER
H.L. WINSTEAD, JR.
07983

DocuSigned by:
H.L. Winstead, Jr. 02-04-2015

F02917C3CE07429
SIGNATURE DATE

CADD File Name: R2248EA ITS-27.dgn