

DRAWING 1

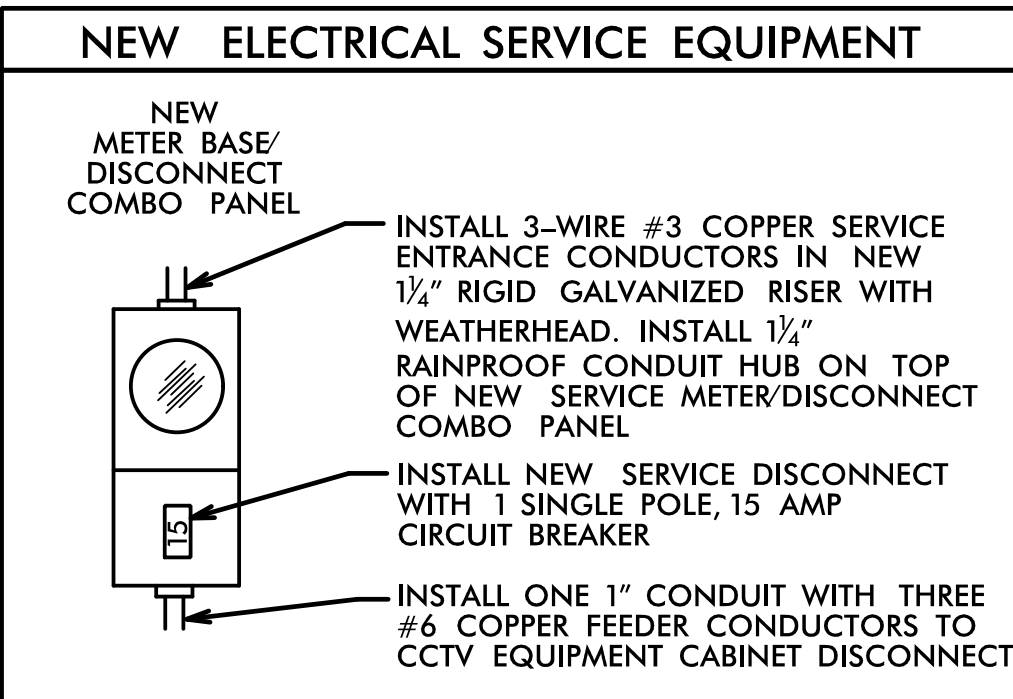

DRAWING 2

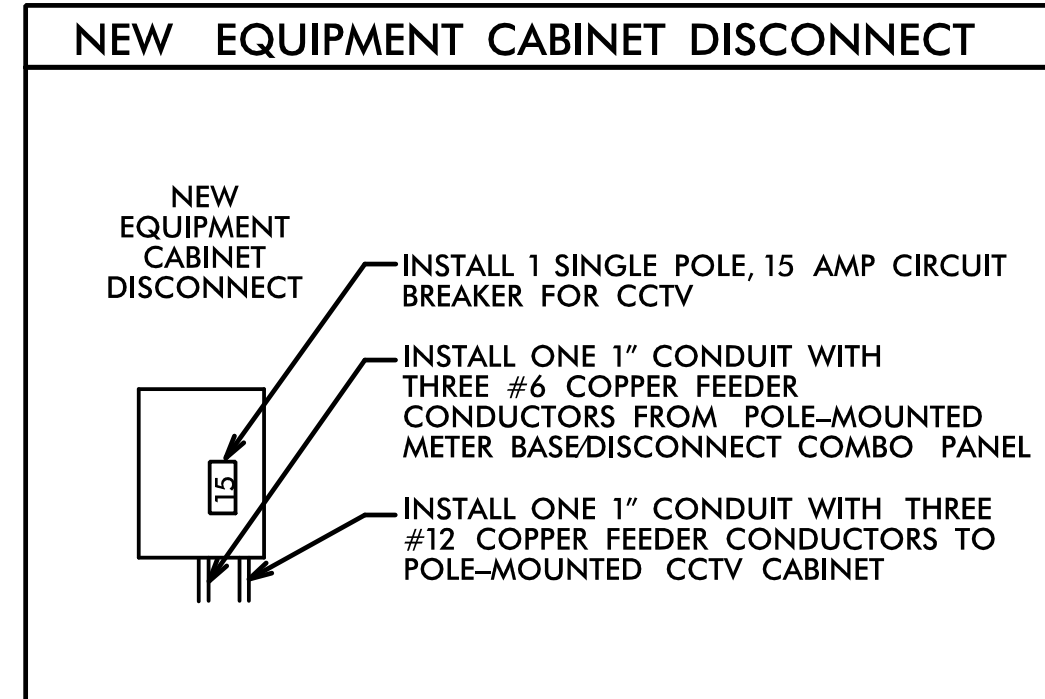

**CCTV-6 GPS COORDINATES**

N 35° 22.099'  
W 80° 45.920'

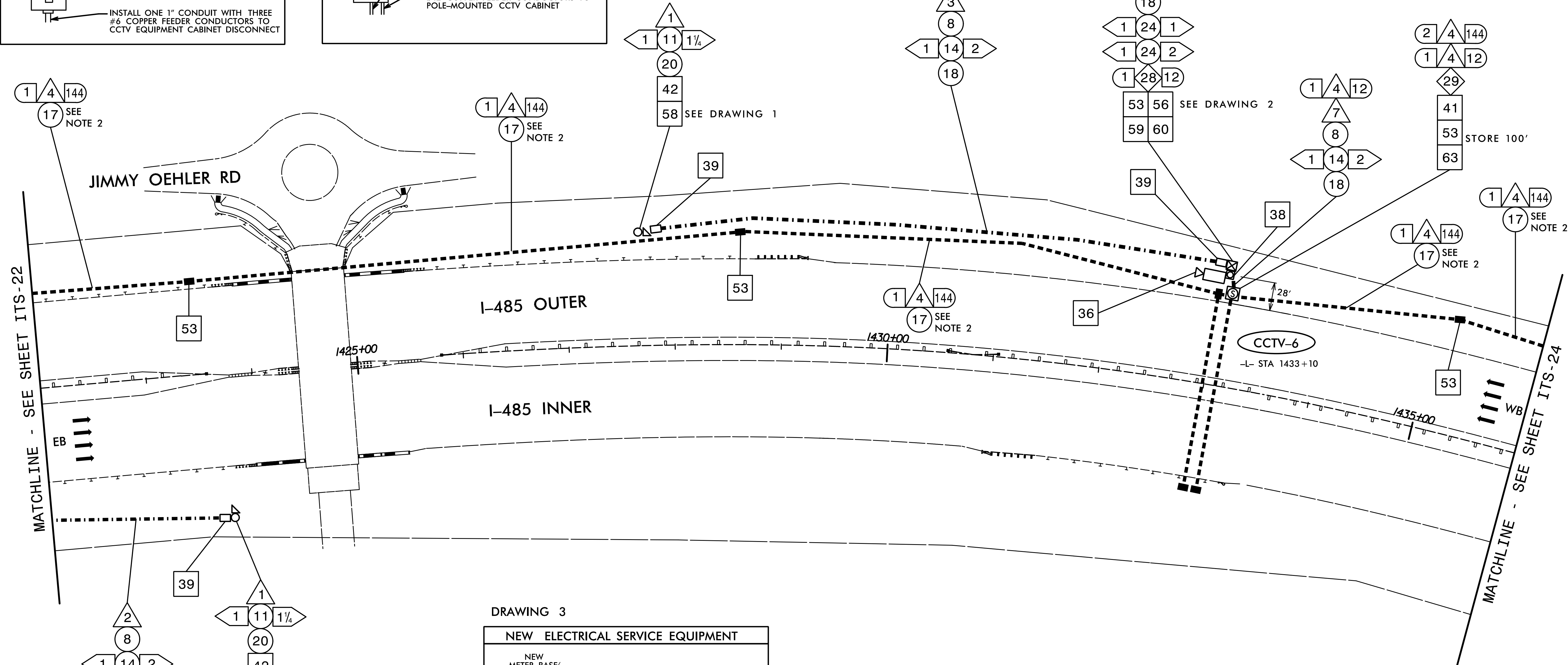

DRAWING 3

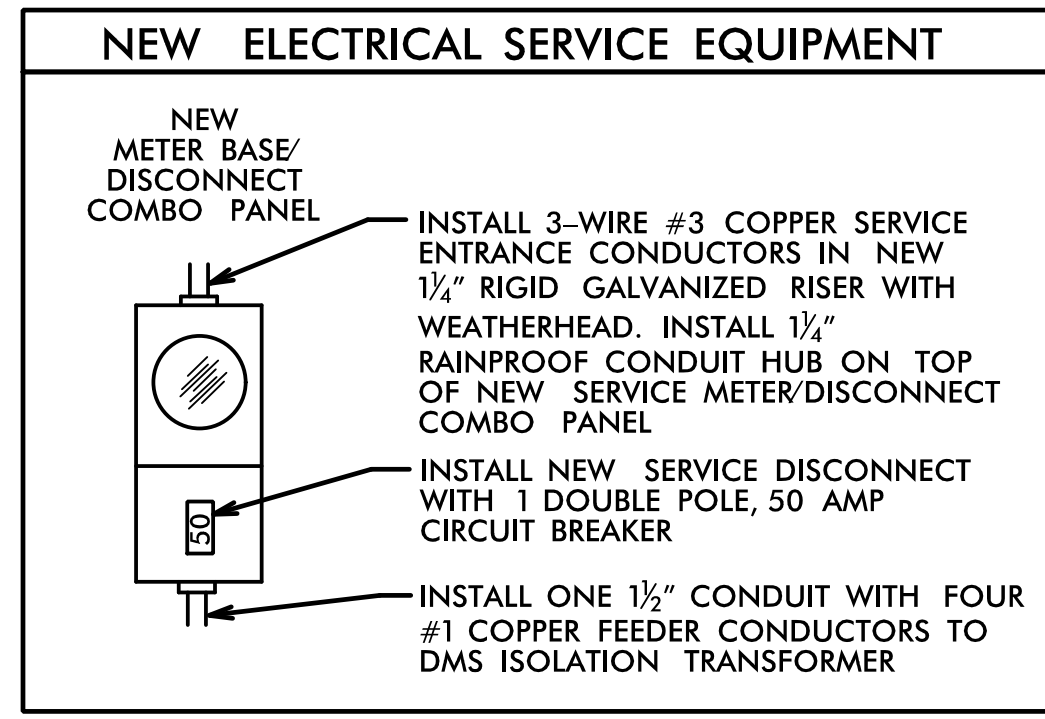

- NOTES:**
1. MAINTAIN A MINIMUM OF SIX (6) FEET FROM THE EDGE OF PAVEMENT WHEN TRENCHING PARALLEL TO THE ROADWAY.
  2. INSTALL FIBER-OPTIC CABLE INTO THE EXISTING BLACK DUCT.
  3. CONTACT THE REGIONAL ITS ENGINEER AT (704) 347-6601 TO CONFIRM THE LOCATION OF THE CCTV.
  4. MOUNT THE CCTV CAMERA 45' ABOVE GRADE.
  5. INSTALL A LEVEL CONCRETE TECHNICIAN PAD MEASURING A MINIMUM OF 4 INCHES THICK, 24 INCHES WIDE AND 36 INCHES LONG AT THE FRONT DOOR OF THE CCTV EQUIPMENT CABINETS. SEE TYPICAL DETAILS SHEET.
  6. CONTACT TOM EDELEN (DUKE ENERGY) AT (704) 582-8070 TO OBTAIN POWER TO ELECTRICAL SERVICE.

**NOTE:**  
ELECTRICAL SERVICE DETAILS AND CONSTRUCTION METHODS DEPICT FIELD CONDITIONS AT THE TIME OF DESIGN. CONTRACTOR IS TO VERIFY ACTUAL CONDITIONS AT THE TIME OF CONSTRUCTION AND OBTAIN APPROVAL FROM THE ENGINEER PRIOR TO MAKING ANY CHANGES.

<p>Plans Prepared for: Department of Transportation Division of Transportation Planning</p> <p>250 N. Greenfield Place, Garner, NC 27529</p>	<b>CABLE ROUTING PLAN</b>		
	DIVISION 10 MECKLENBURG CO., CHARLOTTE PLAN DATE: FEBRUARY 2015 REVIEWED BY: A.D. KLINSIEK PREPARED BY: T.R. TERRELL REVIEWED BY: H.L. WINSTEAD		
SCALE 0 50 1" = 50'	REVISIONS INIT. DATE	SIGNATURE DATE	DocuSigned by: H.L. Winstead, Jr. 02-04-2015 F82917C3CE07429 CADD File Name: R2248EA ITS-23.dgn