

DRAWING 1

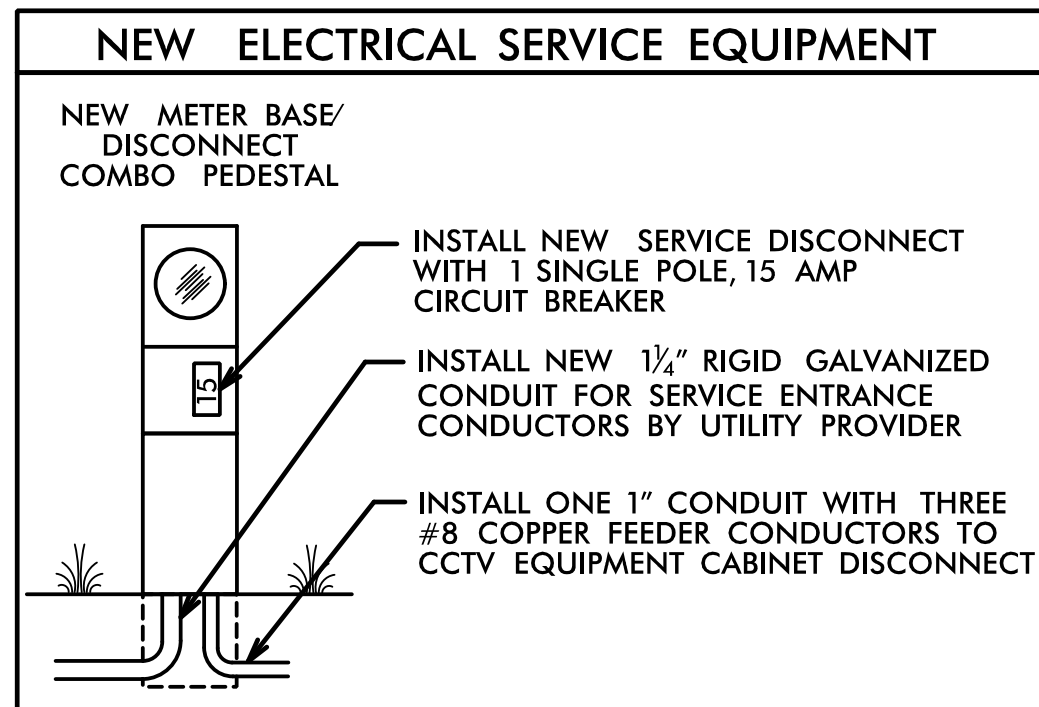

DRAWING 2

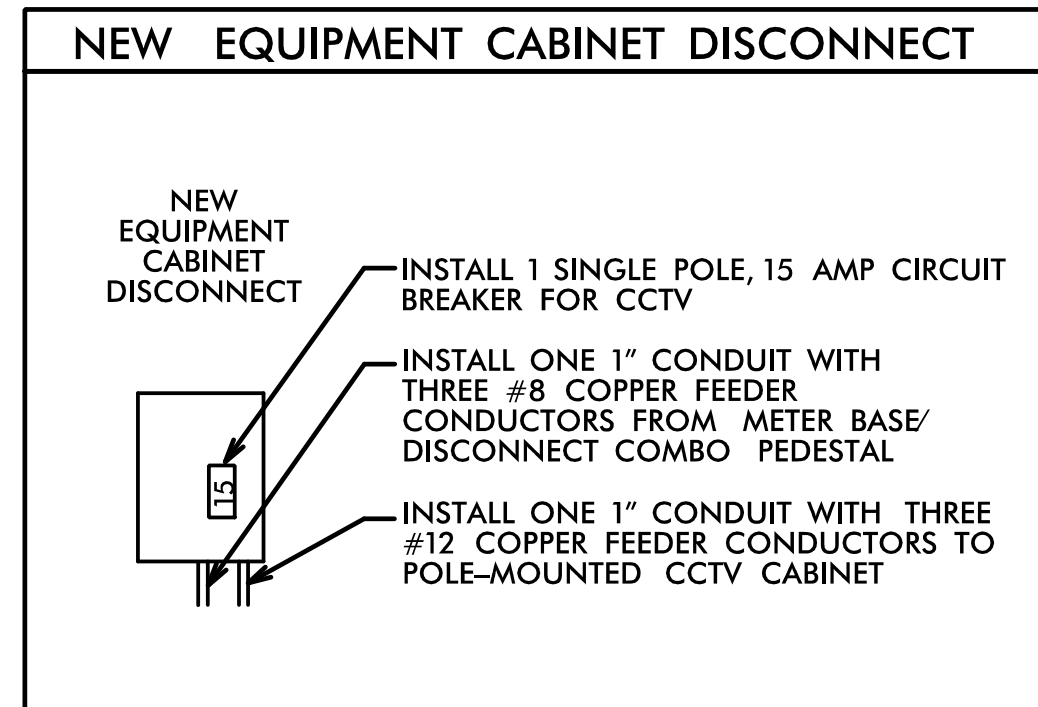

CCTV-5 GPS COORDINATES

N 35° 22.106'
W 80° 46.795'

MATCHLINE - SEE SHEET ITS-19

MATCHLINE - SEE SHEET ITS-21

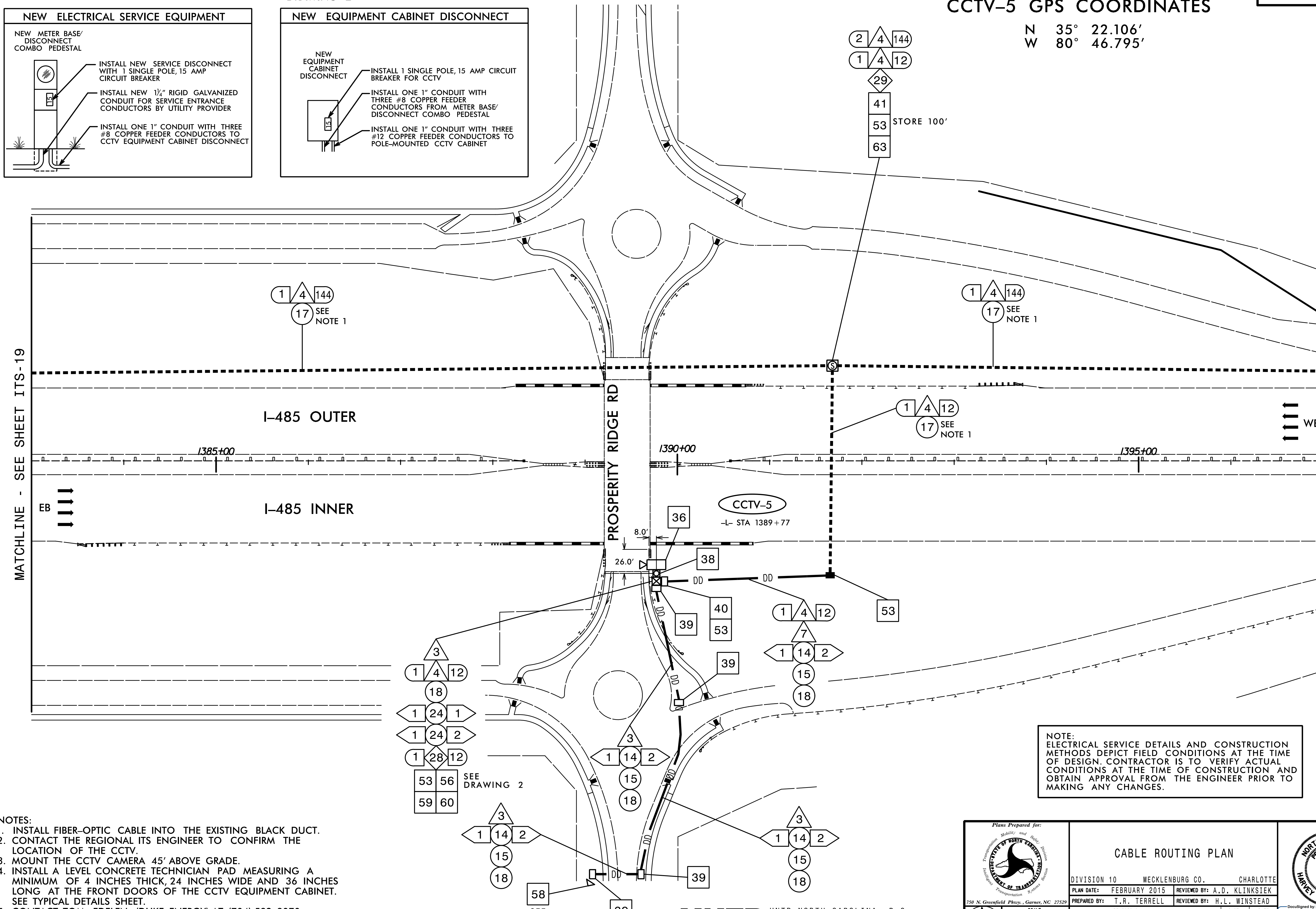

- NOTES:**
1. INSTALL FIBER-OPTIC CABLE INTO THE EXISTING BLACK DUCT.
 2. CONTACT THE REGIONAL ITS ENGINEER TO CONFIRM THE LOCATION OF THE CCTV.
 3. MOUNT THE CCTV CAMERA 45' ABOVE GRADE.
 4. INSTALL A LEVEL CONCRETE TECHNICIAN PAD MEASURING A MINIMUM OF 4 INCHES THICK, 24 INCHES WIDE AND 36 INCHES LONG AT THE FRONT DOORS OF THE CCTV EQUIPMENT CABINET. SEE TYPICAL DETAILS SHEET.
 5. CONTACT TOM EDELEN (DUKE ENERGY) AT (704) 582-8070 TO OBTAIN POWER TO ELECTRICAL SERVICE.

NOTE:
ELECTRICAL SERVICE DETAILS AND CONSTRUCTION METHODS DEPICT FIELD CONDITIONS AT THE TIME OF DESIGN. CONTRACTOR IS TO VERIFY ACTUAL CONDITIONS AT THE TIME OF CONSTRUCTION AND OBTAIN APPROVAL FROM THE ENGINEER PRIOR TO MAKING ANY CHANGES.

<p>HNTB NORTH CAROLINA, P.C. 343 E. Six Forks Road, Suite 200 Raleigh, North Carolina 27609 NC License No: C-1554</p>	<p>CABLE ROUTING PLAN</p>										
	<p>Division 10 MECKLENBURG CO., CHARLOTTE</p> <p>PLAN DATE: FEBRUARY 2015 REVIEWED BY: A.D. KLINSIEK</p> <p>PREPARED BY: T.R. TERRELL REVIEWED BY: H.L. WINSTEAD</p>	<table border="1"> <thead> <tr> <th>REVISIONS</th> <th>INIT.</th> <th>DATE</th> </tr> </thead> <tbody> <tr> <td> </td> <td> </td> <td> </td> </tr> <tr> <td> </td> <td> </td> <td> </td> </tr> </tbody> </table>		REVISIONS	INIT.	DATE					
REVISIONS	INIT.	DATE									