

09/08/09

TIP PROJECT: W-5206AG

See Sheet 1-A For Index of Sheets
See Sheet 1-B For Conventional Symbols

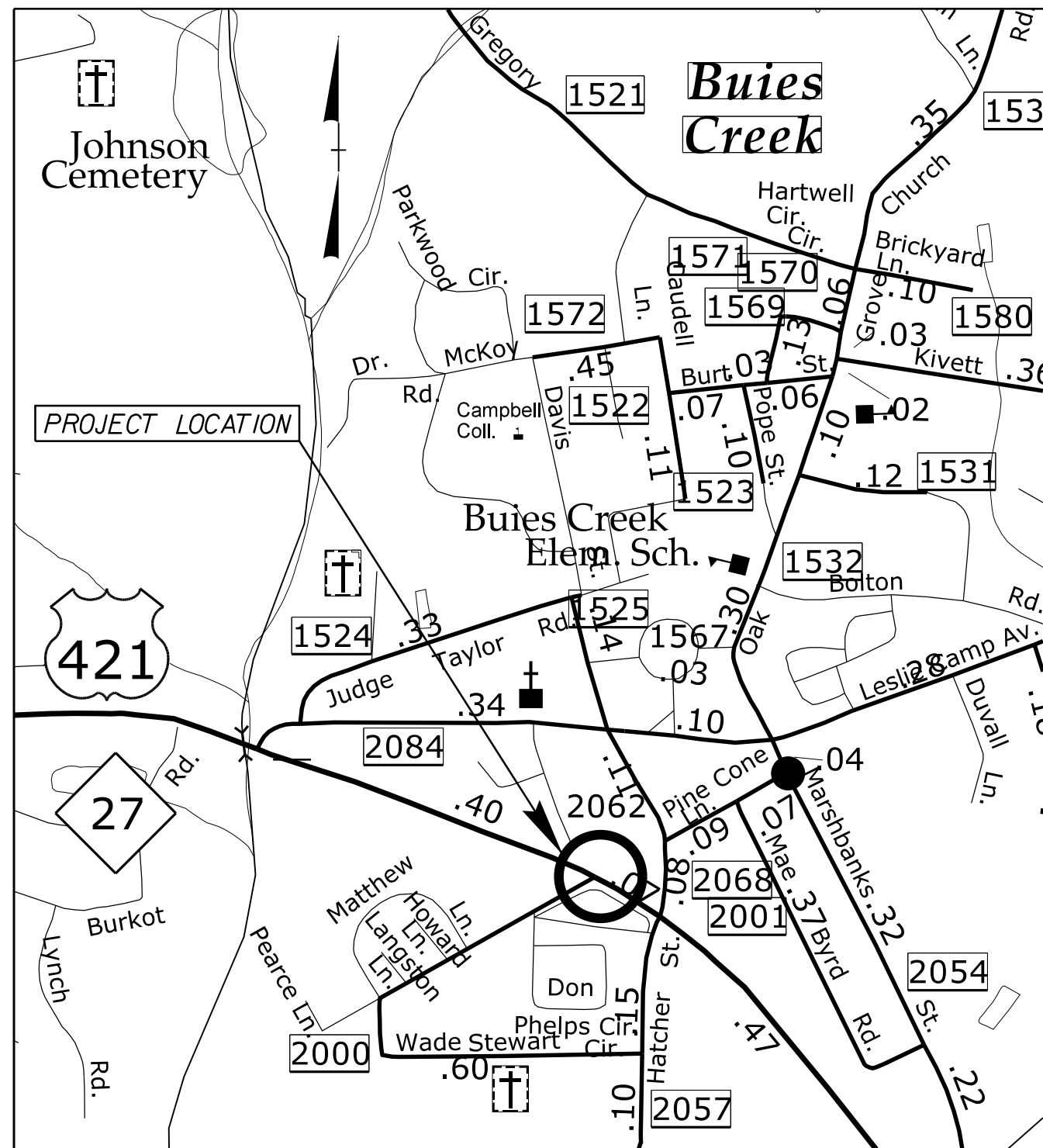

VICINITY MAP (NOT TO SCALE)

PROJECT LENGTH
LENGTH ROADWAY TIP PROJECT W-5206AG = 0.22 MILES
LENGTH STRUCTURE TIP PROJECT W-5206AG = 0.11 MILES
TOTAL LENGTH OF TIP PROJECT W-5206AG = 0.33 MILES

BEGIN TIP PROJECT W-5206AG
POT STA. -L- 23+12.00

END TIP PROJECT W-5206AG
POT STA. -L- 34+65.71

STATE OF NORTH CAROLINA DIVISION OF HIGHWAYS **HARNETT COUNTY** PLAN FOR PROPOSED HIGHWAY EROSION CONTROL

**LOCATION: CAMPBELL UNIVERSITY PEDESTRIAN TUNNEL
UNDER US 421/NC 27 IN BUIES CREEK**

**TYPE OF WORK: GRADING, DRAINAGE, PAVING, EXISTING SIGNAL
FLASHER REMOVAL, RETAINING WALLS, AND CULVERT.**

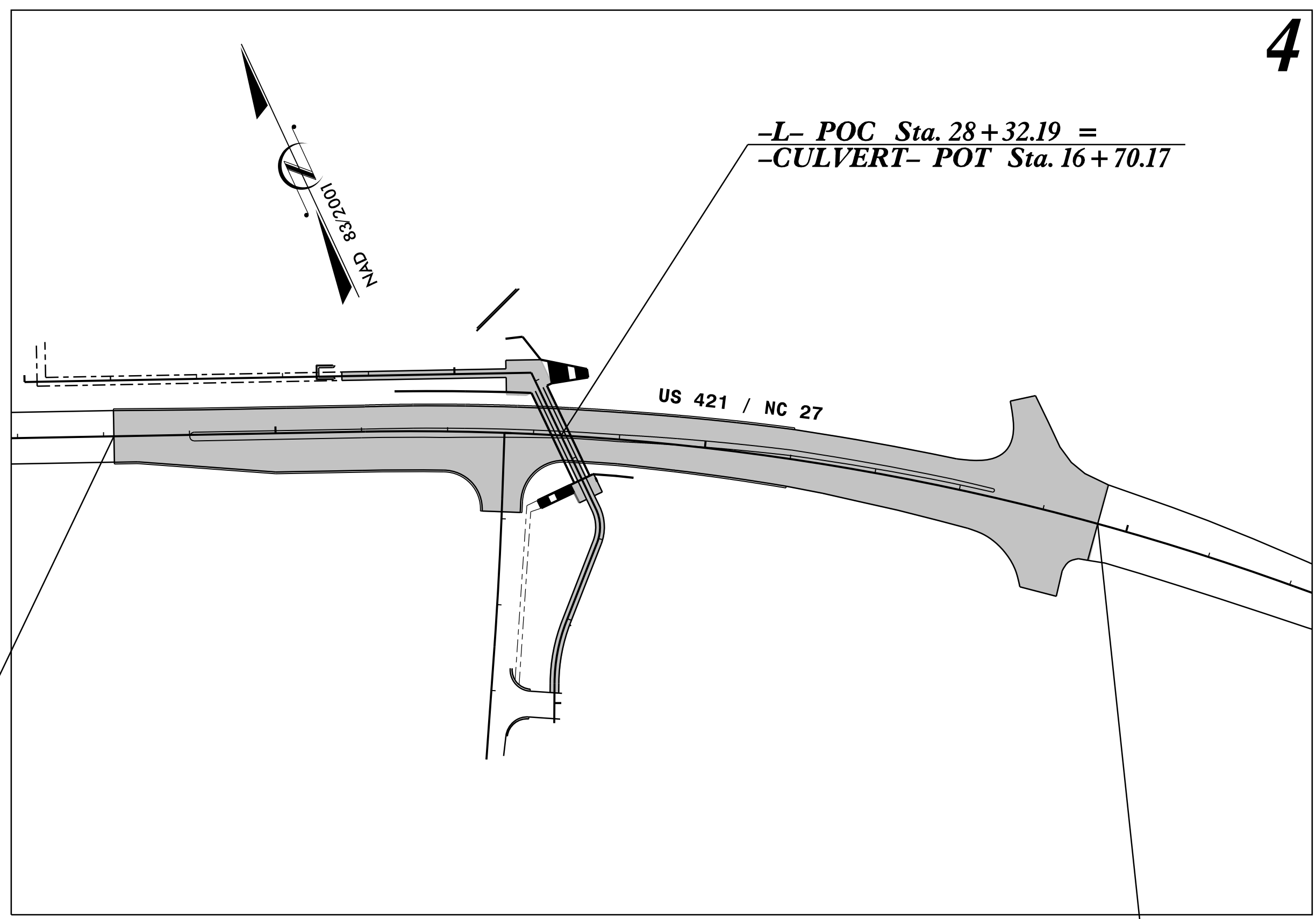

4

STATE	STATE PROJECT REFERENCE NO.	SHEET NO.	TOTAL SHEETS
N.C.	W-5206AG	EC-1	
STATE PROJ. NO.	F.A. PROJ. NO.	DESCRIPTION	
45336.1.FR33	HSIP-0421(79)	P.E.	
45336.2.FR33	HSIP-0421(79)	R.O.W./UTILITY	
45336.3.FR33	HSIP-0421(79)	CONSTR.	

EROSION AND SEDIMENT CONTROL MEASURES

Std. #	Description	Symbol
1630.03	Temporary Silt Ditch	---
1650.05	Temporary Diversion	---
1605.01	Temporary Silt Fence	
1606.01	Special Sediment Control Fence	---X---
1622.01	Temporary Berms and Slope Drains	---X---
1650.02	Silt Basin Type B	---X---
1633.01	Temporary Rock Silt Check Type-A	---X---
	Temporary Rock Silt Check Type-A with Matting and Polyacrylamide (PAM)	---X---
1633.02	Temporary Rock Silt Check Type-B	---X---
	Wattle / Coir Fiber Wattle	---X---
	Wattle / Coir Fiber Wattle with Polyacrylamide (PAM)	---X---
1634.01	Temporary Rock Sediment Dam Type-A	---X---
1634.02	Temporary Rock Sediment Dam Type-B	---X---
1635.01	Rock Pipe Inlet Sediment Trap Type-A	---X---
1635.02	Rock Pipe Inlet Sediment Trap Type-B	---X---
1630.04	Stilling Basin	---X---
1630.06	Special Stilling Basin	---X---
	Rock Inlet Sediment Trap:	
1632.01	Type A	A
1632.02	Type B	B
1632.03	Type C	C
	Skimmer Basin	---X---
	Tiered Skimmer Basin	---X---
	Infiltration Basin	---X---

**THIS PROJECT CONTAINS
EROSION CONTROL PLANS
FOR CLEARING AND
GRUBBING PHASE OF
CONSTRUCTION.**

RANDAL C. HOWARD, EI, PLS
LEVEL III NAME

3491
LEVEL III CERTIFICATION NO.

PRELIMINARY PLANS
DO NOT USE FOR CONSTRUCTION

CONTRACT:

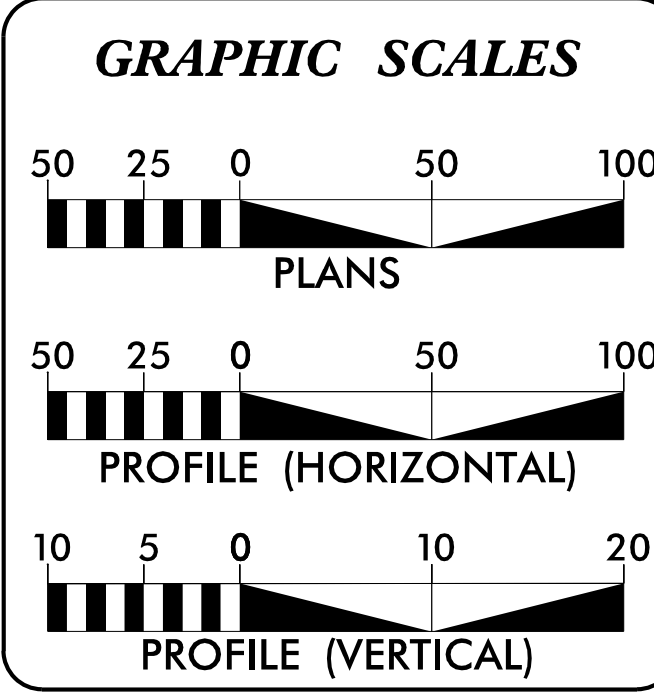

ROADSIDE ENVIRONMENTAL UNIT
DIVISION OF HIGHWAYS
STATE OF NORTH CAROLINA

THESE EROSION AND SEDIMENT CONTROL PLANS COMPLY WITH THE REGULATIONS SET FORTH BY THE NCG-010000 GENERAL CONSTRUCTION PERMIT EFFECTIVE AUGUST 3, 2011 ISSUED BY THE NORTH CAROLINA DEPARTMENT OF ENVIRONMENT AND NATURAL RESOURCES DIVISION OF WATER QUALITY.

Prepared for the North Carolina Department of Transportation in the office of:

SUNGATE DESIGN GROUP, P.A.
915 JONES FRANKLIN ROAD
RALEIGH, NORTH CAROLINA 27606
TEL (919) 855-2243 FAX (919) 855-8258
ENG FIRM LICENSE NO. C-890

Roadway Standard Drawings

The following roadway english standards as appear in "Roadway Standard Drawings"- Roadway Design Unit - N. C. Department of Transportation - Raleigh, N. C., dated January 2012 and the latest revision thereto are applicable to this project and by reference hereby are considered a part of these plans.

1604.01 Railroad Erosion Control Detail	1632.01 Rock Inlet Sediment Trap Type A
1605.01 Temporary Silt Fence	1632.02 Rock Inlet Sediment Trap Type B
1606.01 Special Sediment Control Fence	1632.03 Rock Inlet Sediment Trap Type C
1607.01 Gravel Construction Entrance	1633.01 Temporary Rock Silt Check Type A
1622.01 Temporary Berms and Slope Drains	1633.02 Temporary Rock Silt Check Type B
1630.01 Riser Basin	1634.01 Temporary Rock Sediment Dam Type A
1630.02 Silt Basin Type B	1634.02 Temporary Rock Sediment Dam Type B
1630.03 Temporary Silt Ditch	1635.01 Rock Pipe Inlet Sediment Trap Type A
1630.04 Stilling Basin	1635.02 Rock Pipe Inlet Sediment Trap Type B
1630.05 Temporary Diversion	1640.01 Coir Fiber Baffle
1630.06 Special Stilling Basin	1645.01 Temporary Stream Crossing
1631.01 Matting Installation	

02-MAR-2015 14:07
J:\W-5206AG_Dr\img\Sungate Erosion ControlFiles 10-29-2014\W-5206AG-EC_PSH_01.dgn
\$\$\$\$\$SERVNAME\$\$\$\$\$