

09/08/15

TIP PROJECT: W-5206AG

CONTRACT: C203647

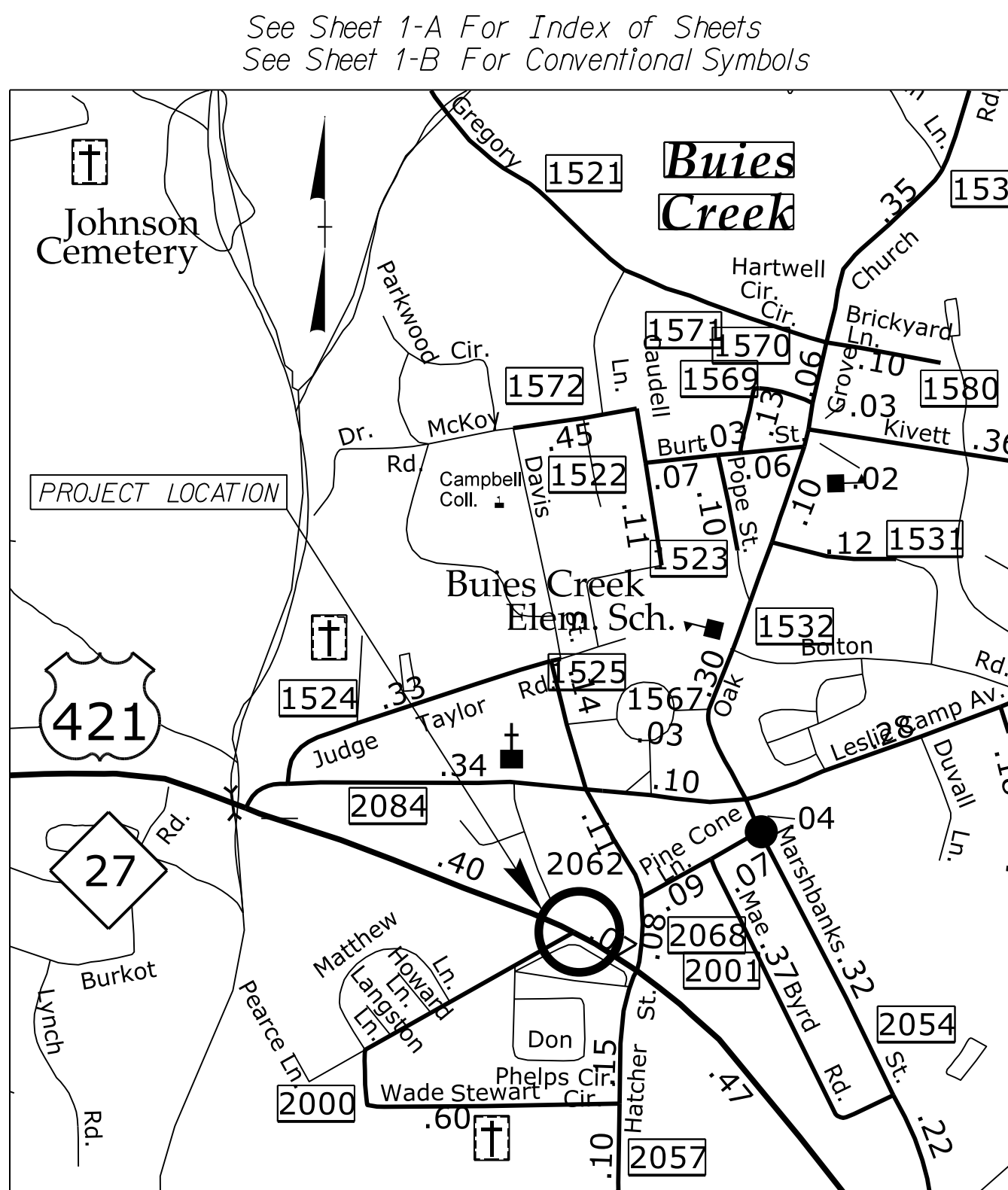

VICINITY MAP (NOT TO SCALE)

SEE SHEET TMP-2 FOR TEMPORARY OFFSITE DETOUR

NOTE: OVERLAY EXISTING PAVEMENT THROUGHOUT THE LIMITS OF PERMANENT MARKINGS SHOWN ON PMP PLAN. (-L- STA. 16+40---SEE PMP-03)

**BEGIN TIP PROJECT W-5206AG
POT STA. -L- 23+12.00**

STATE OF NORTH CAROLINA
DIVISION OF HIGHWAYS

HARNETT COUNTY

**LOCATION: CAMPBELL UNIVERSITY PEDESTRIAN TUNNEL
UNDER US 421/NC 27 IN BUIES CREEK**

**TYPE OF WORK: GRADING, DRAINAGE, PAVING,
RETAINING WALLS, AND CULVERT.**

STATE	STATE PROJECT REFERENCE NO.	SHEET NO.	TOTAL SHEETS
N.C.	W-5206AG	1	
STATE PROJ. NO.	F.A. PROJ. NO.	DESCRIPTION	
45336.1.FR33	HSIP-0421(79)	P.E.	
45336.2.FR33	HSIP-0421(79)	R.O.W./UTILITY	
45336.3.FR33	HSIP-0421(79)	CONSTR.	

NOTE: OVERLAY EXISTING PAVEMENT THROUGHOUT THE LIMITS OF PERMANENT MARKINGS SHOWN ON PMP PLAN. (-L- STA. 42+30---SEE PMP-04)

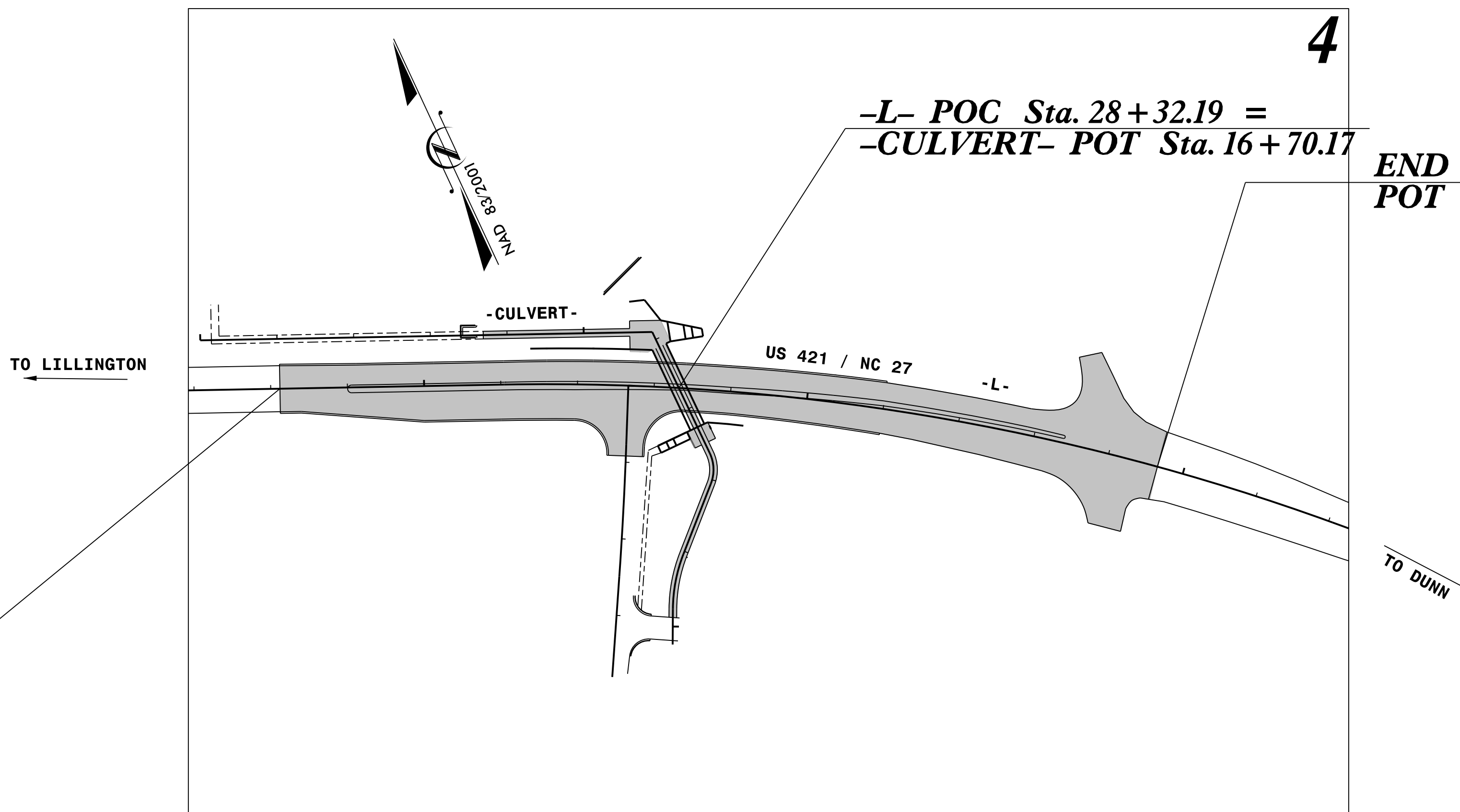

**END TIP PROJECT W-5206AG
POT STA. -L- 34+65.71**

GRAPHIC SCALES

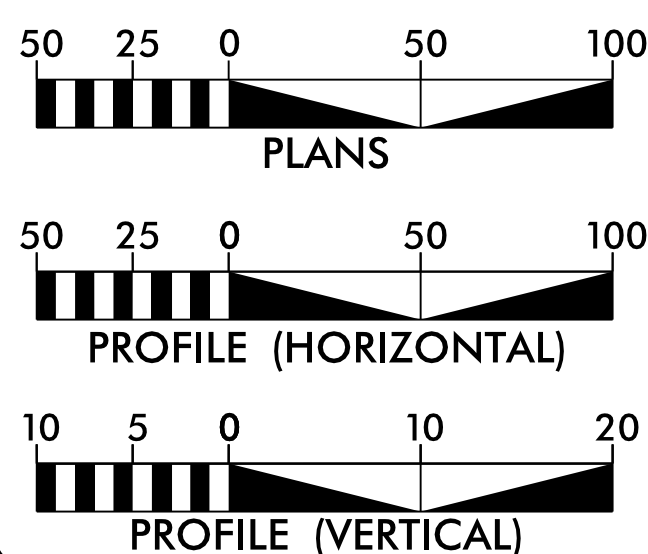

DESIGN DATA

AADT 2012 = 18,000
V = 50 MPH
FUNC CLASS = RURAL ARTERIAL
REGIONAL TIER

PROJECT LENGTH

LENGTH ROADWAY TIP PROJECT W-5206AG = 0.491 MILES
TOTAL LENGTH OF TIP PROJECT W-5206AG = 0.491 MILES

Prepared for the North Carolina Department of Transportation in the office of:

PLANS PREPARED BY **PARSONS**

2012 STANDARD SPECIFICATIONS

RIGHT OF WAY DATE: **AUGUST 27, 2014**

LETTING DATE: **MAY 19, 2015**

DAVID L. WILVER, P.E.
PROJECT ENGINEER

TIM D. GOINS, P.E.
PROJECT DESIGN ENGINEER

HYDRAULICS ENGINEER

DocuSigned by: **Josh Dalton**
SEAL 026971
4/3/2015
P.E.

ROADWAY DESIGN ENGINEER

DocuSigned by: **Tim D. Goins**
SEAL 37874
4/8/2015
P.E.

