

PROJ. REFERENCE NO.	SHEET NO.
W-5512	TMP-17

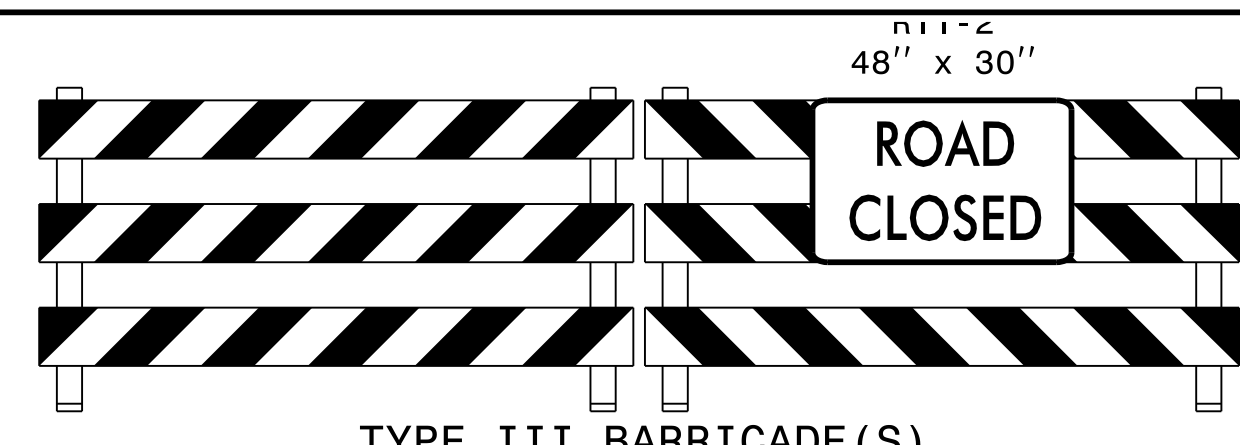

TYPE III BARRICADE(S)

(C)

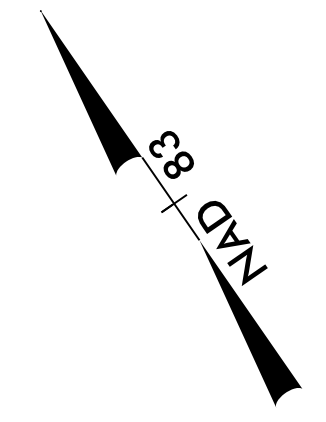

SEE SHEET TMP-20  
FOR -L- OFF-SITE  
DETOUR SIGNING

ICT  
USING OFF-SITE DETOUR, INSTALL 60" RCP & 95"x67" CSPA  
CULVERT THEN COMPLETE -L- CONSTRUCTION FROM STA.  
127+00 TO 130+00 AND FROM STA. 135+00 TO 137+00

INSTALL PROPOSED  
60" RCP

BREAK LINE SEE SHEET TMP-16

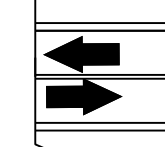

-L- (TOM STARLING RD)

-L- STA. 127+00 +/-

(C)

-DRIVE 7-

MATCH LINE -L- STA 129+00 SEE SHEET TMP-18

25 MAR 2015 15:37  
C:\Users\jpickens\Documents\TrafficControl\TCP\W-5512-TC-TMP-17.dgn  
\$\$\$\$\$USERNAME\$\$\$\$\$

APPROVED: Jason M. Pickens DATE: 3/31/2015

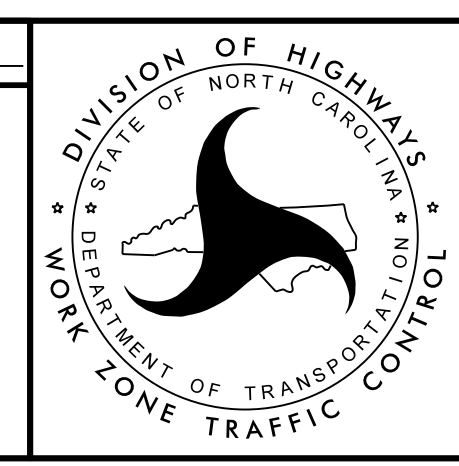
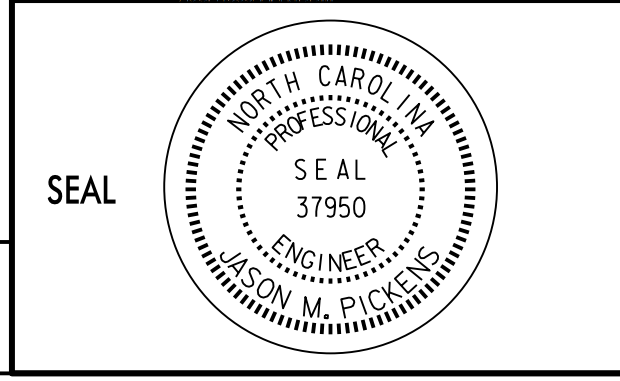

TRANSPORTATION  
MANAGEMENT PLAN

PHASE II  
DETAIL 5

PLANS PREPARED BY  
**PARSONS**  
5540 CENTERVIEW DR., SUITE 201  
RALEIGH, NORTH CAROLINA 27606  
NO. LICENSE NO. F-52346  
FOR NORTH CAROLINA DEPT. OF TRANSPORTATION