

09/08/15

**TIP PROJECT: W-5512**

**CONTRACT: C203623**

See Sheet 1-A For Index of Sheets  
See Sheet 1-B For Conventional Symbols

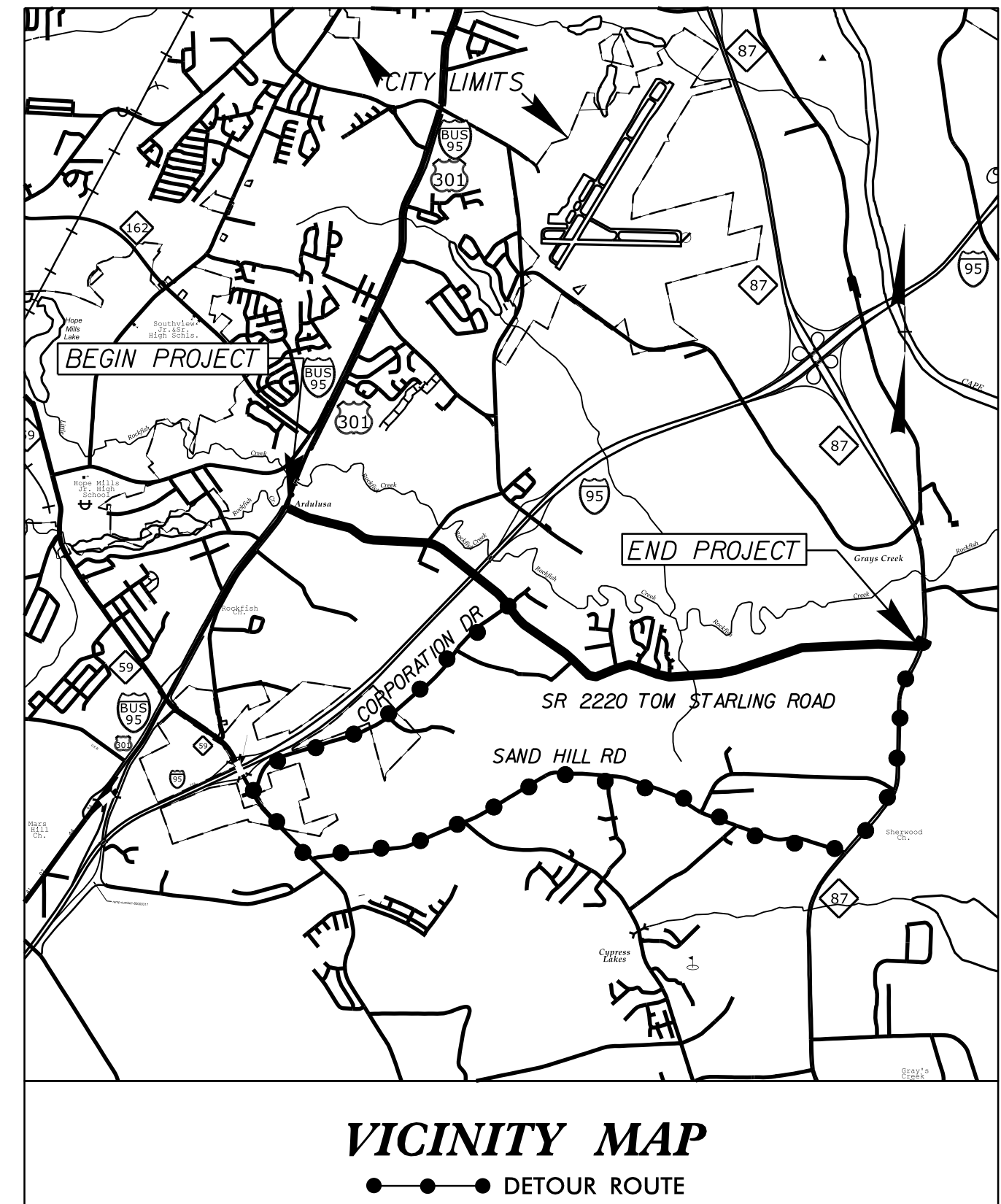

STATE OF NORTH CAROLINA  
DIVISION OF HIGHWAYS

**CUMBERLAND COUNTY**

**LOCATION: SR 2220 (TOM STARLING ROAD) FROM US 301 TO NC 87.**

**TYPE OF WORK: GRADING, DRAINAGE, AND PAVING.**

STATE	STATE PROJECT REFERENCE NO.	SHEET NO.	TOTAL SHEETS
N.C.	W-5512	1	
STATE PROJ. NO.	F.A. PROJ. NO.	DESCRIPTION	
50079.1.1	HSIP-2220(5)	P.E.	
50079.2.FD1	HSIP-2220(5)	R.O.W./UTILITY	
50079.3.FD1	HSIP-2220(5)	CONSTR.	

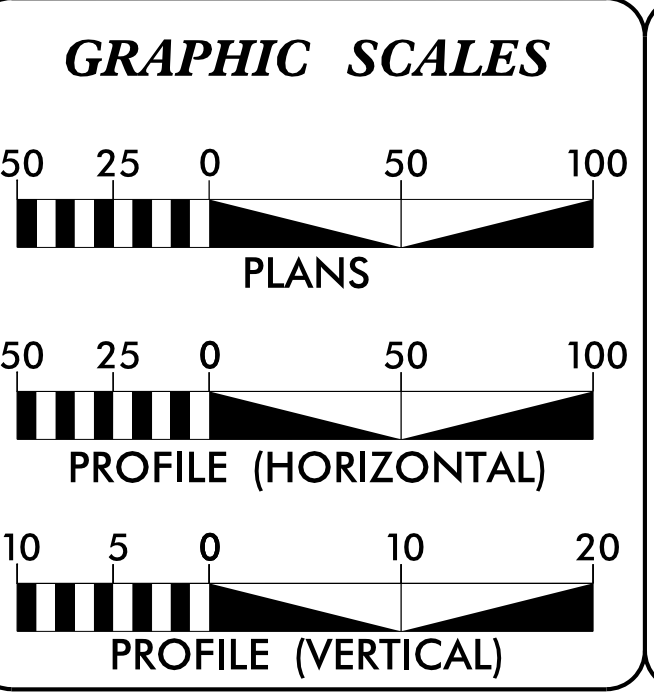
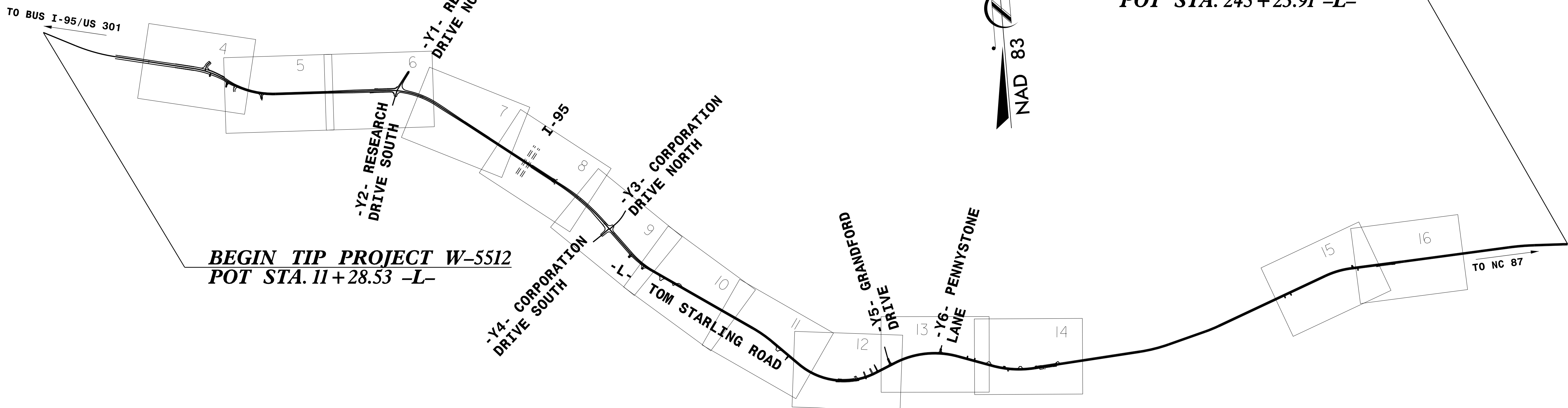

**DESIGN DATA**

ADT 2014 = 3,651

DHV = 4 %  
D = 51 %  
T = 4 %  
V = 60 MPH

FUNC CLASS =  
LOCAL, RURAL  
\*SUBREGIONAL TIER

**PROJECT LENGTH**

LENGTH ROADWAY TIP PROJECT W-5512 = 4.431 MILES

TOTAL LENGTH OF TIP PROJECT W-5512 = 4.431 MILES

Prepared in the Office of:

**PARSONS**  
2012 STANDARD SPECIFICATIONS

RIGHT OF WAY DATE:  
JULY 30, 2014

LETTING DATE:  
MAY 19, 2015

MI ENGINEERING  
1011 SCHAUß DRIVE, SUITE 100  
RALEIGH, NC 27606  
(919) 851-6606  
FIRM PE NUMBER: P-0671

**DAVID L. WILVER, P.E.**  
PROJECT ENGINEER

**TIM D. GOINS, P.E.**  
PROJECT DESIGN ENGINEER

**HYDRAULICS ENGINEER**

3/26/2015  
P.E.

**ROADWAY DESIGN ENGINEER**

3/26/2015  
P.E.

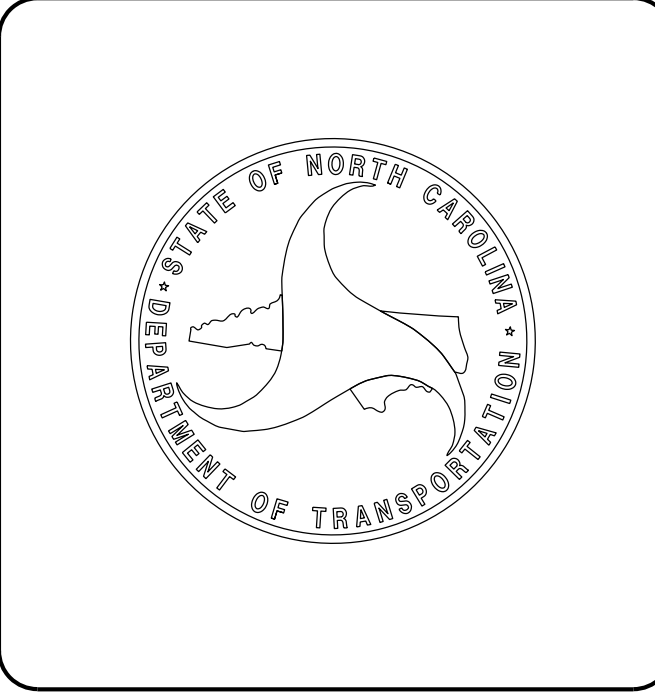

09-MAR-2015 11:40  
J:\W-5512\Roadway\Proj\W5512\_Rdy\_TSH.dgn  
\$\$\$\$\$USERNAME\$\$\$\$\$