

UTILITY BY OTHERS

NOTE:  
 ALL PROPOSED UTILITY WORK SHOWN ON THIS SHEET WILL BE DONE BY OTHERS. NO PAYMENT WILL BE MADE TO THE CONTRACTOR FOR PROPOSED UTILITY WORK SHOWN ON THIS SHEET.

ZEB V. GAMBILL & WIFE  
 ANGE TRIBBLE GAMBLE  
 DB 304 PG 1918

-L-  
 Pls Sta 588+25.93    Pls Sta 598+87.47  
 Os = 2' 42" 59.8"    Δ = 36' 59" 04.8" (LT)  
 Ls = 275.00'        D = 1' 58" 32.6"  
 LT = 183.35'        L = 1,871.96'  
 ST = 91.69'         T = 969.90'  
                          R = 2,900.00'  
                          SE = .05  
                          RUNOFF = 275'

BREMCO TO SET NEW POLE OUTSIDE OF CUTLINE ONCE NEW SCHOOL SIGN LOCATION IS IDENTIFIED BY DOT

MATCH LINE -L- STA. 584 + 50  
 SEE ROADWAY SHEET 14

MATCH LINE -L- STA. 597 + 00  
 SEE ROADWAY SHEET 16

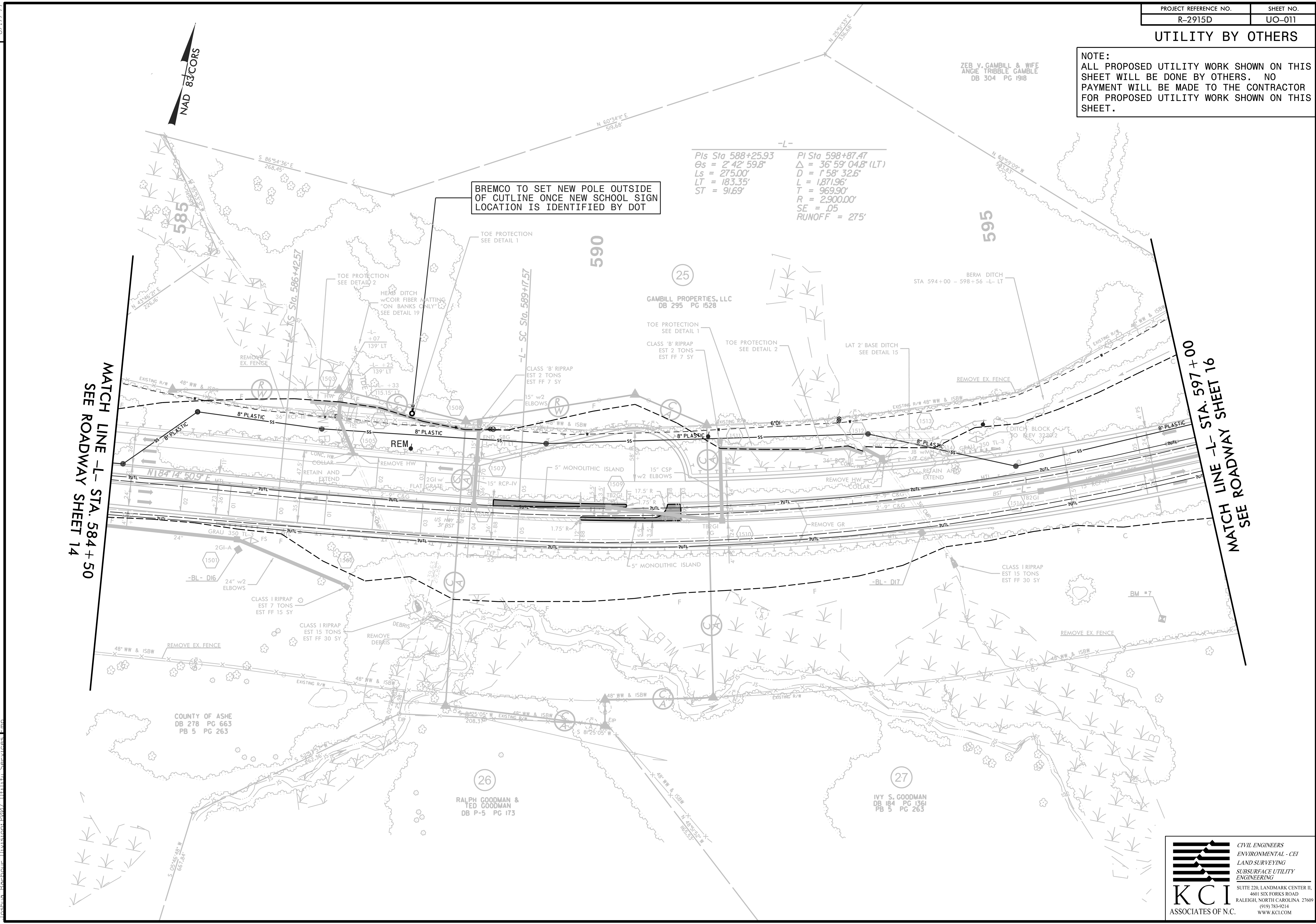

REVISIONS  
 01/09/14 - RW REVISION: REVISED TDE AT -L- STA. 587+33 LT ON PARCEL 25. - TLW

8/17/99  
 5/31/14 AM  
 5/29/15D ut\_rdu11\_U0011\_psh-dgn  
 Joshua Bohour, Division 2007, Hittell, Services, Inc.

CIVIL ENGINEERS  
 ENVIRONMENTAL - CEI  
 LAND SURVEYING  
 SUBSURFACE UTILITY  
 ENGINEERING

SUITE 220, LANDMARK CENTER II,  
 4601 SIX FORKS ROAD  
 RALEIGH, NORTH CAROLINA 27609  
 (919) 785-9214  
 WWW.KCI.COM