

**UTILITY BY OTHERS**

NOTE:  
 ALL PROPOSED UTILITY WORK SHOWN ON THIS SHEET WILL BE DONE BY OTHERS. NO PAYMENT WILL BE MADE TO THE CONTRACTOR FOR PROPOSED UTILITY WORK SHOWN ON THIS SHEET.

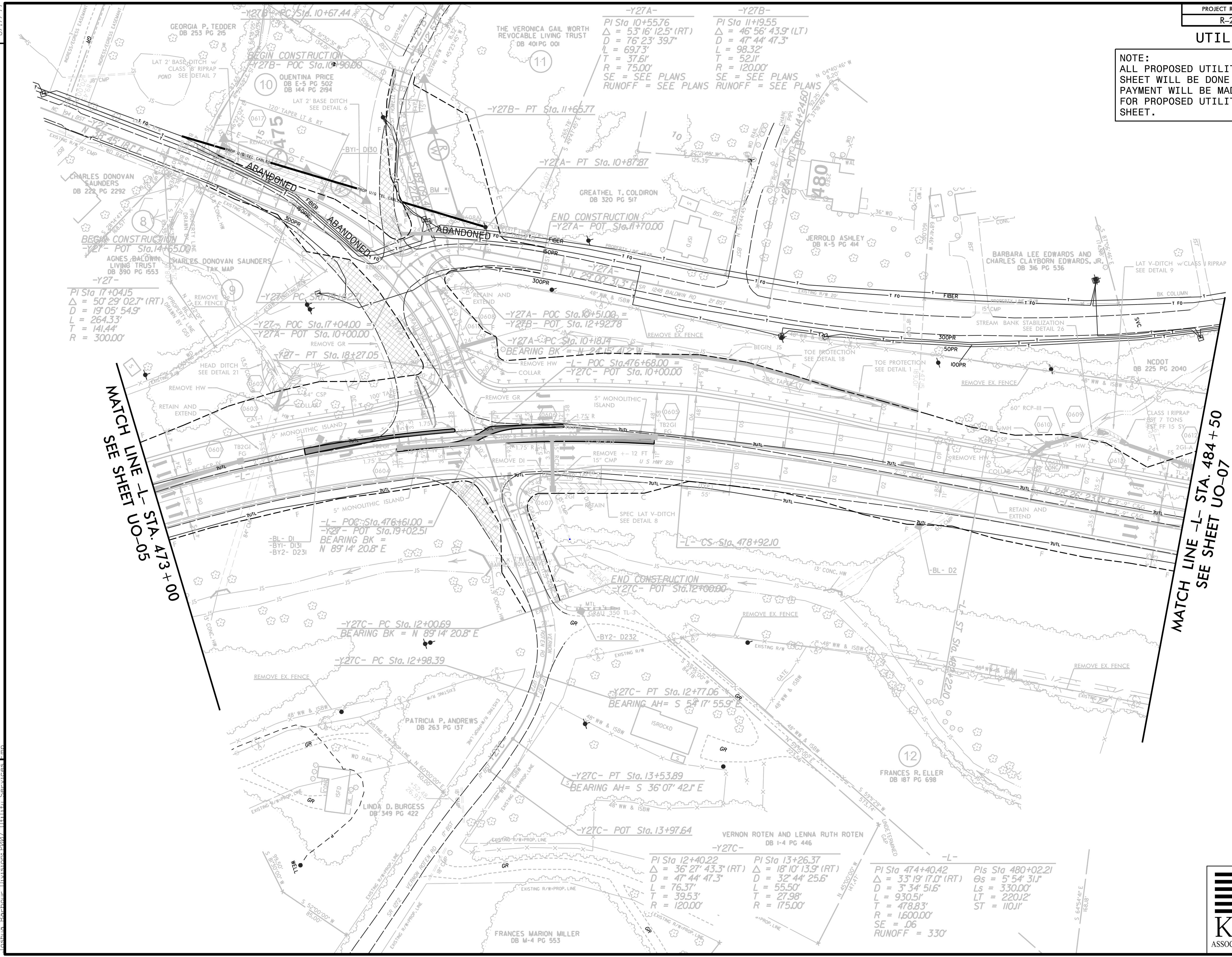
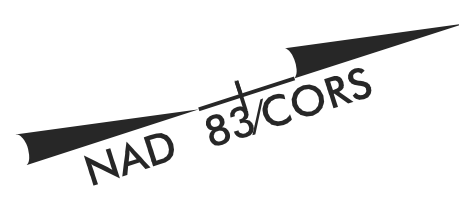

PI Sta 17+04.15  
 $\Delta = 50^{\circ} 29' 02.7''$  (RT)  
 $D = 19^{\circ} 05' 54.9''$   
 $L = 264.33'$   
 $T = 141.44'$   
 $R = 300.00'$

**-Y27A-**  
 PI Sta 10+55.76  
 $\Delta = 53^{\circ} 16' 12.5''$  (RT)  
 $D = 76^{\circ} 23' 39.7''$   
 $L = 69.73'$   
 $T = 37.61'$   
 $R = 75.00'$   
 SE = SEE PLANS  
 RUNOFF = SEE PLANS

**-Y27B-**  
 PI Sta 11+9.55  
 $\Delta = 46^{\circ} 56' 43.9''$  (LT)  
 $D = 47^{\circ} 44' 47.3''$   
 $L = 98.32'$   
 $T = 52.11'$   
 $R = 120.00'$   
 SE = SEE PLANS  
 RUNOFF = SEE PLANS

**-L-** POC Sta. 476+61.00 =  
 -Y27- POT Sta. 19+02.51  
 BEARING BK =  
 $N 89^{\circ} 14' 20.8'' E$

**-Y27C-** PC Sta. 12+00.69  
 BEARING BK =  $N 89^{\circ} 14' 20.8'' E$

**-Y27C-** PC Sta. 12+98.39

**-Y27C-** PT Sta. 12+77.06  
 BEARING AH =  $S 53^{\circ} 17' 55.9'' E$

**-Y27C-** PT Sta. 13+53.89  
 BEARING AH =  $S 36^{\circ} 07' 42.1'' E$

**-Y27C-** POT Sta. 13+97.64

**-Y27C-**  
 PI Sta 12+40.22  
 $\Delta = 36^{\circ} 27' 43.3''$  (RT)  
 $D = 47^{\circ} 44' 47.3''$   
 $L = 76.37'$   
 $T = 39.53'$   
 $R = 120.00'$

**-Y27C-**  
 PI Sta 13+26.37  
 $\Delta = 18^{\circ} 10' 13.9''$  (RT)  
 $D = 32^{\circ} 44' 25.6''$   
 $L = 55.50'$   
 $T = 27.98'$   
 $R = 175.00'$

**-L-**  
 PI Sta 474+40.42  
 $\Delta = 33^{\circ} 19' 17.0''$  (RT)  
 $D = 3^{\circ} 34' 51.6''$   
 $L = 930.51'$   
 $T = 478.83'$   
 $R = 1,600.00'$   
 SE = .06  
 RUNOFF = 330'

**PIs Sta 480+02.21**  
 $\Delta s = 5^{\circ} 54' 31.1''$   
 $L s = 330.00'$   
 $LT = 220.12'$   
 $ST = 110.11'$

MATCH LINE -L- STA. 473+00  
 SEE SHEET UO-05

MATCH LINE -L- STA. 484+50  
 SEE SHEET UO-07

REVISIONS

8/17/99  
 5/17/03 AM R-2915D ut\_r.dwg U006\_psh.dgn  
 5/17/06 R-2915D ut\_r.dwg U006\_psh.dgn  
 Joshua Barber, Division 2007, 11/11/11, Services