

PROJECT REFERENCE NO. <b>R-2915D</b>	SHEET NO. <b>22</b>
RW SHEET NO.	
ROADWAY DESIGN ENGINEER	HYDRAULICS ENGINEER
Engineers • Planners • Scientists • Construction Managers 4601 Six Forks Road, Landmark Center II, Suite 220 Raleigh, NC 27609-5210 Phone (919) 783-9214 • Fax (919) 783-9266	
915 JONES FRANKLIN ROAD RALEIGH, NORTH CAROLINA 27608 TEL. (919) 859-2245 FAX (919) 859-6259 ENG FIRM LICENSE NO. C-890	

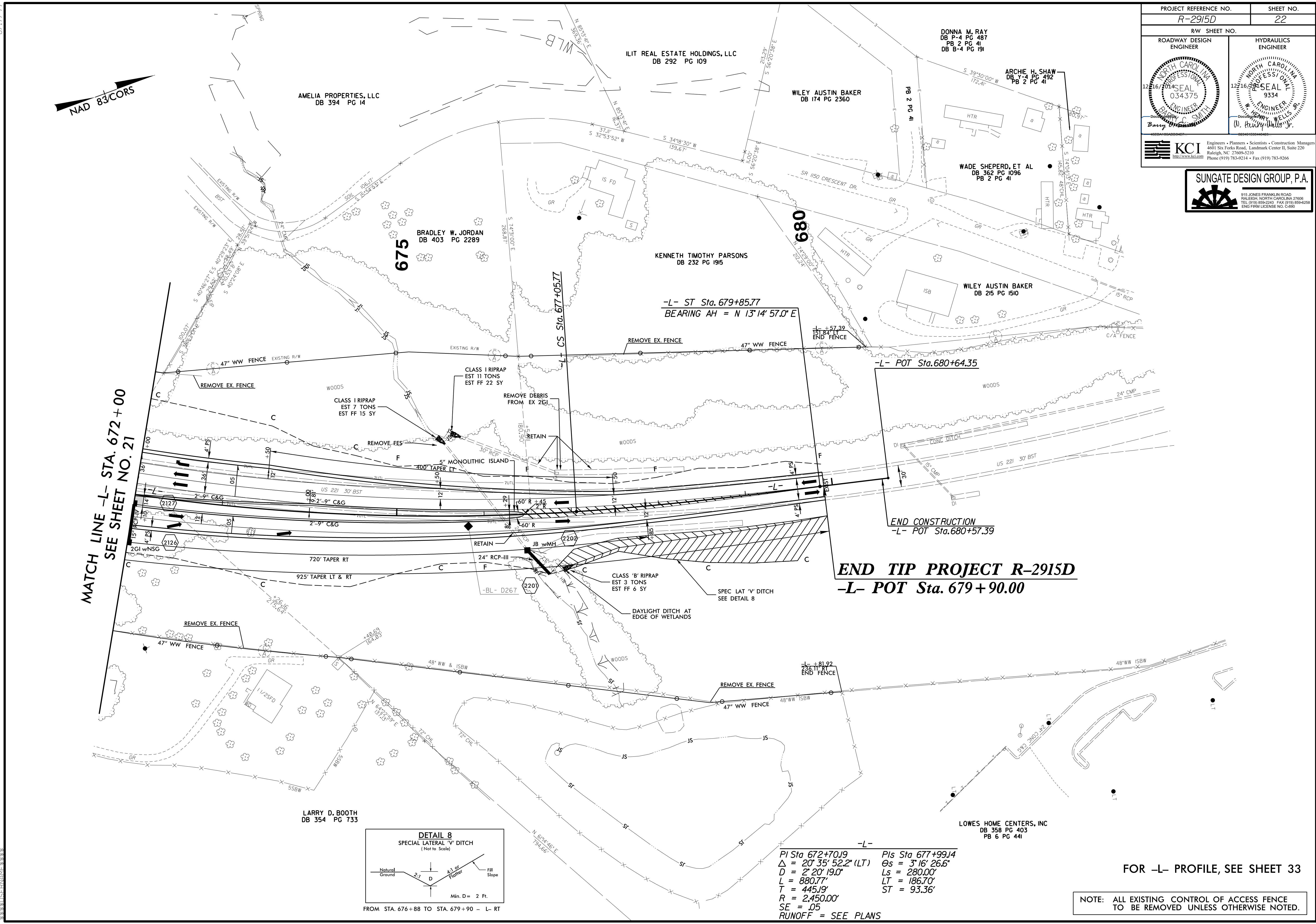

MATCH LINE -L- STA. 672+00  
 SEE SHEET NO. 21

**END TIP PROJECT R-2915D**  
**-L- POT Sta. 679+90.00**

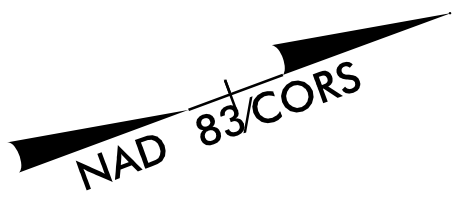
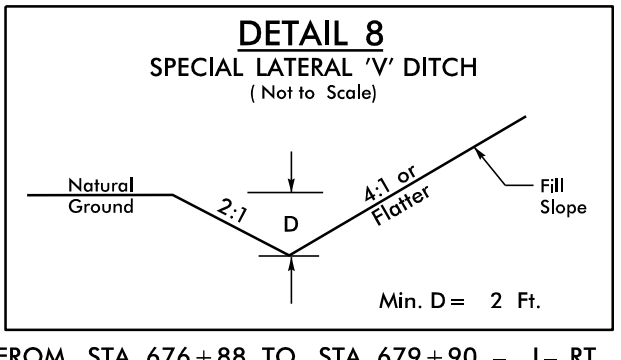

-L-  
 PI Sta 672+70.19      Pls Sta 677+99.4  
 $\Delta = 20' 35' 52.2''$  (LT)       $\Theta_s = 3' 16' 26.6''$   
 $D = 2' 20' 19.0''$        $L_s = 280.00'$   
 $L = 880.77'$        $LT = 186.70'$   
 $T = 445.19'$        $ST = 93.36'$   
 $R = 2,450.00'$   
 $SE = .05$   
 RUNOFF = SEE PLANS

FOR -L- PROFILE, SEE SHEET 33  
 NOTE: ALL EXISTING CONTROL OF ACCESS FENCE TO BE REMOVED UNLESS OTHERWISE NOTED.

8.17.799  
 I:\DEC-2014\1613\MA\2014111015-R2915D-Roadway\Proj\R2915D\_Rdy\_psh\_22.dgn  
 \$\$\$\$\$\$USERNAME\$\$\$\$\$\$