

CLEVELAND COUNTY
NORTH CAROLINA

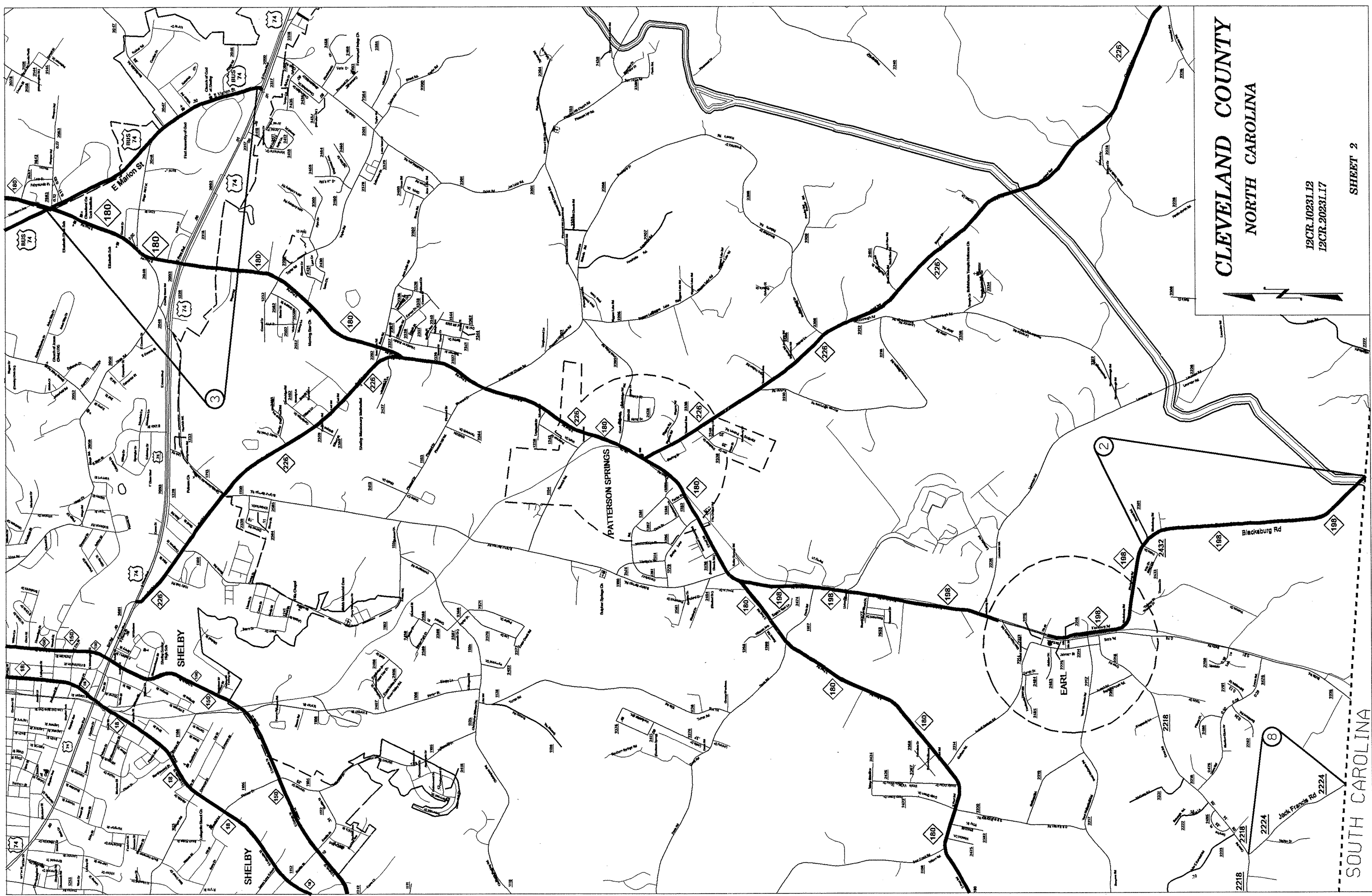

12CR.10231.12
12CR.20231.17

SHEET 1



CLEVELAND COUNTY
NORTH CAROLINA

12CR.10231.12
12CR.20231.17

SHEET 2

SOUTH CAROLINA

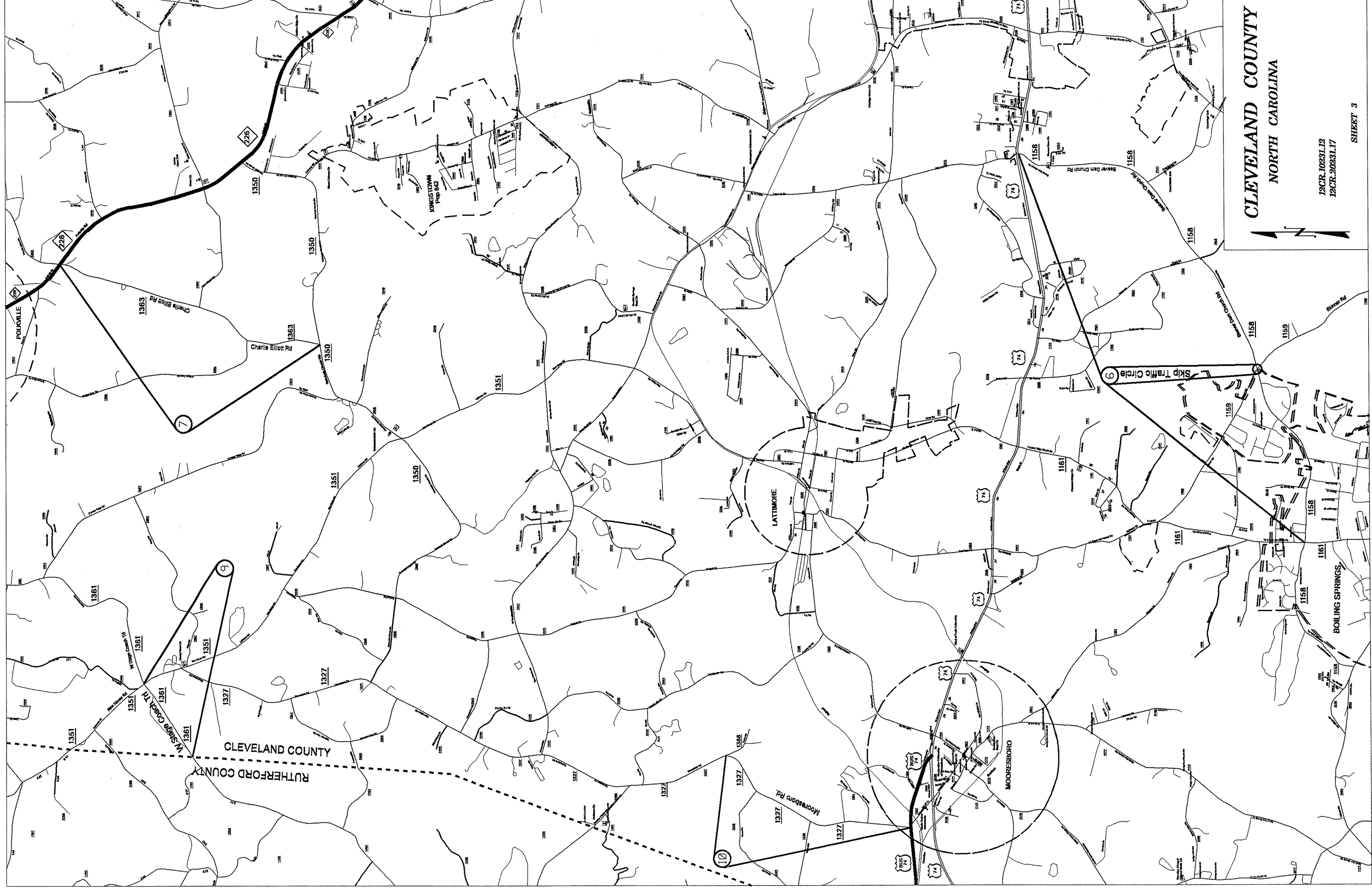

CLEVELAND COUNTY
NORTH CAROLINA

19CR.10231.12
19CR.20231.17

SHEET 3

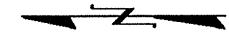

CLEVELAND COUNTY
RUTHERFORD COUNTY

Charlie Elliott Rd

Mooresboro Rd

LATTIMORE

MOORESBORO

BOILING SPRINGS

Skip Traffic Circle

7

9

10

226

1350

1350

1363

1350

1351

1350

1351

1361

1361

1361

1361

1327

1327

1327

1327

1327

1327

74

74

74

74

74

74

1158

1158

1158

1158

1159

1161

1158

1158

1158

1159

1161

1158

1158

1158

19CR.10231.12
19CR.20231.17

SHEET 3

PAVEMENT SCHEDULE	
Y	SHOULDER RECONSTRUCTION
C1	PROP. APPROX. 1½" ASPHALT CONCRETE SURFACE COURSE, TYPE S9.5B, AT AN AVERAGE RATE OF 168 LBS. PER SQ. YD.
E1	PROP. APPROX. 5.5" ASPHALT CONCRETE BASE COURSE, TYPE B25.0B, AT AN AVERAGE RATE OF 627 LBS. PER SQ. YD.
V1	MILL ASPHALT PAVEMENT APPROX. 1½" TO 3" AS DIRECTED BY THE ENGINEER.
V2	MILL ASPHALT PAVEMENT APPROX. 1½" AS DIRECTED BY THE ENGINEER.

NOTE: PAVEMENT EDGE SLOPES ARE 1:1 UNLESS SHOWN OTHERWISE.
MILL BRIDGE APPROACHES 100' TO PROVIDE A SMOOTH TRANSITION AS DIRECTED.
MILL INTO GUTTER LINE WHERE SHOWN AND AS DIRECTED.
MAINTAIN PROPER CROWN FOR DRAINAGE OF THE ROAD SURFACE.

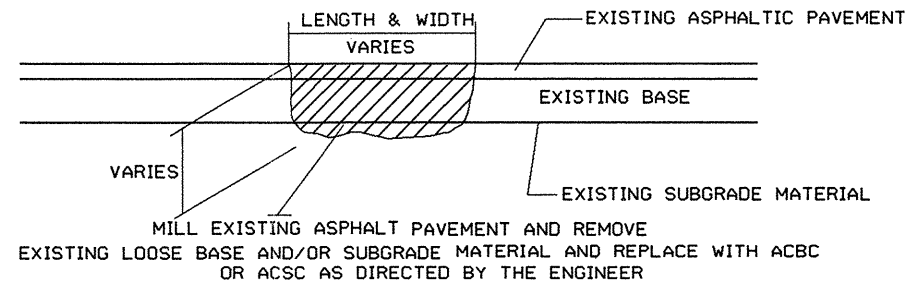
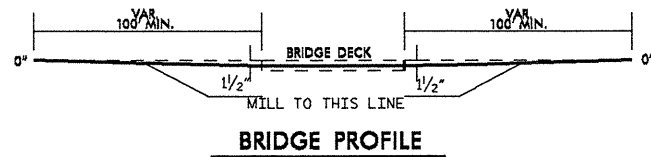

PATCHING EXISTING PAVEMENT

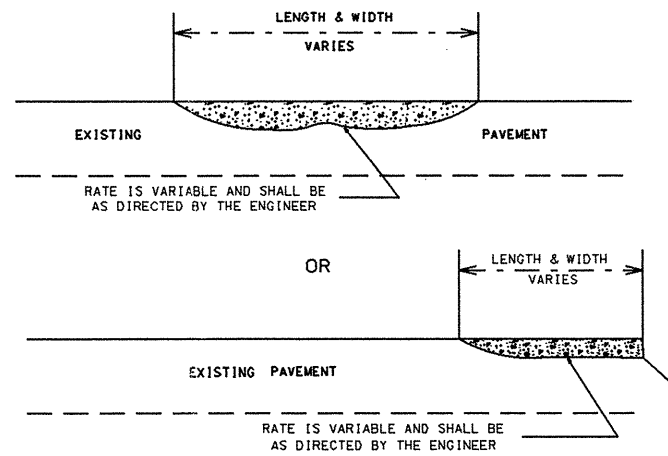

**ASPHALT CONCRETE SURFACE COURSE
TYPE S9.5B. (LEVELING COURSE)**

PROJ. REFERENCE NO.	SHEET NO.	TOTAL SHEETS
CLEVELAND CO. 2013-2014	4	
STATE PROJ. NO.	F. A. PROJ. NO.	DESCRIPTION
12CR.10231.12		
12CR.20231.17		

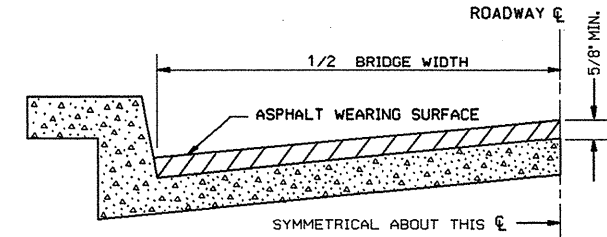

BRIDGE HALF TYPICAL SECTION

FOR BRIDGES WITH FLOOR DRAINS, CARE SHALL BE EXERCISED IN PLACING THE WEARING SURFACE AROUND FLOOR DRAINS SO AS NOT TO HINDER EFFECTIVE DRAINAGE. ALL DRAINS SHALL BE LEFT OPEN.

THE PROPOSED WEARING SURFACE SHALL VARY IN THICKNESS AS NECESSARY TO PROVIDE A SMOOTH RIDING SURFACE. A THICKNESS OF NOT LESS THAN 5/8" SHALL BE PROVIDED. THE MAXIMUM THICKNESS SHALL PREFERABLY BE 1-1/2" UNLESS IT IS IMPRACTICAL TO PROVIDE A SMOOTH RIDING SURFACE OTHERWISE.

NOTES

ALL UNPAVED S.R. ROADS TO BE SURFACED 50' FROM EDGE OF PAVEMENT OF MAIN PROJECT.
ALL PAVED S.R. ROADS TO BE RESURFACED TO THE ENDS OF THE RADII, OR AS DIRECTED BY THE ENGINEER.
EDGES, PAVEMENT WIDENING, INTERSECTIONS AND BRIDGE FLARES ARE INCLUDED IN THE TABLE OF QUANTITIES.
SHOULDERS AND DITCHES ARE TO BE CONSTRUCTED BY OTHERS UNLESS OTHERWISE NOTED.
BRIDGES TO BE RESURFACED AT LOCATIONS AND TO DEPTH AS DIRECTED BY THE ENGINEER.

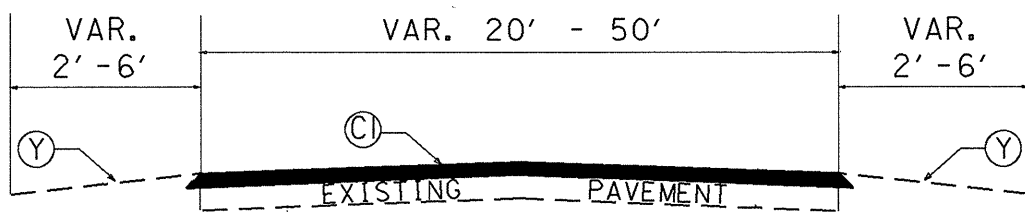

TYPICAL SECTION NO. 1
(MAPS 1, 3, 4, 6, 8)

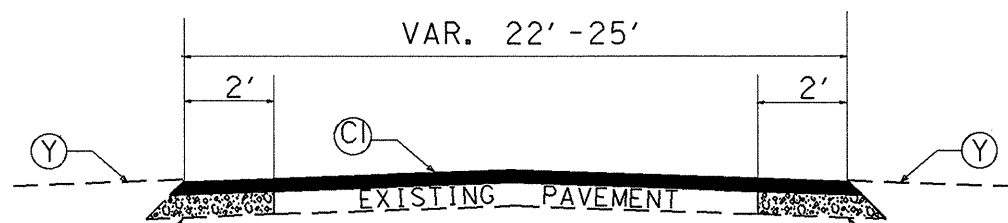

TYPICAL SECTION NO. 2
(MAPS 2, 5, 10)

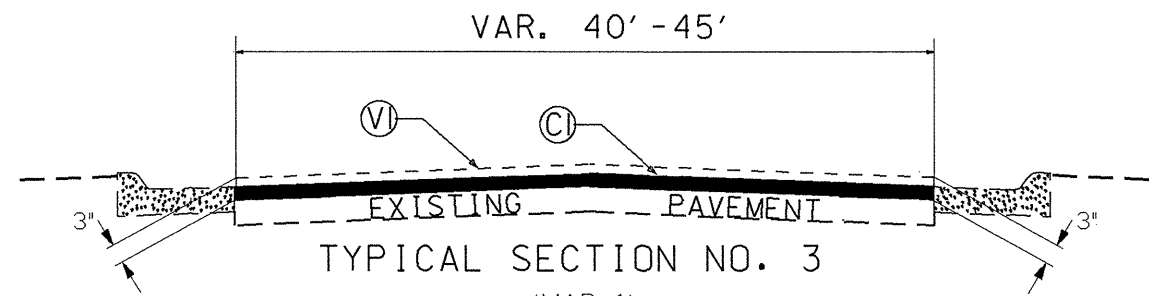

TYPICAL SECTION NO. 3
(MAP 1)

PROJ. REFERENCE NO.	SHEET NO.	TOTAL SHEETS
CLEVELAND CO. 2013-2014	5	
STATE PROJ. NO.	F. A. PROJ. NO.	DESCRIPTION
12CR.10231.12		
12CR.20231.17		

PAVEMENT SCHEDULE	
Y	SHOULDER RECONSTRUCTION
C1	PROP. APPROX. 1½" ASPHALT CONCRETE SURFACE COURSE, TYPE S9.5B, AT AN AVERAGE RATE OF 168 LBS. PER SQ. YD.
E1	PROP. APPROX. 5.5" ASPHALT CONCRETE BASE COURSE, TYPE B25.0B, AT AN AVERAGE RATE OF 627 LBS. PER SQ. YD.
V1	MILL ASPHALT PAVEMENT APPROX. 1½" to 3" AS DIRECTED BY THE ENGINEER.
V2	MILL ASPHALT PAVEMENT APPROX. 1½" AS DIRECTED BY THE ENGINEER.

NOTE: PAVEMENT EDGE SLOPES ARE 1:1 UNLESS SHOWN OTHERWISE.
MILL BRIDGE APPROACHES 100' TO PROVIDE A SMOOTH TRANSITION AS DIRECTED.
MILL INTO GUTTER LINE WHERE SHOWN AND AS DIRECTED.
MAINTAIN PROPER CROWN FOR DRAINAGE OF THE ROAD SURFACE.

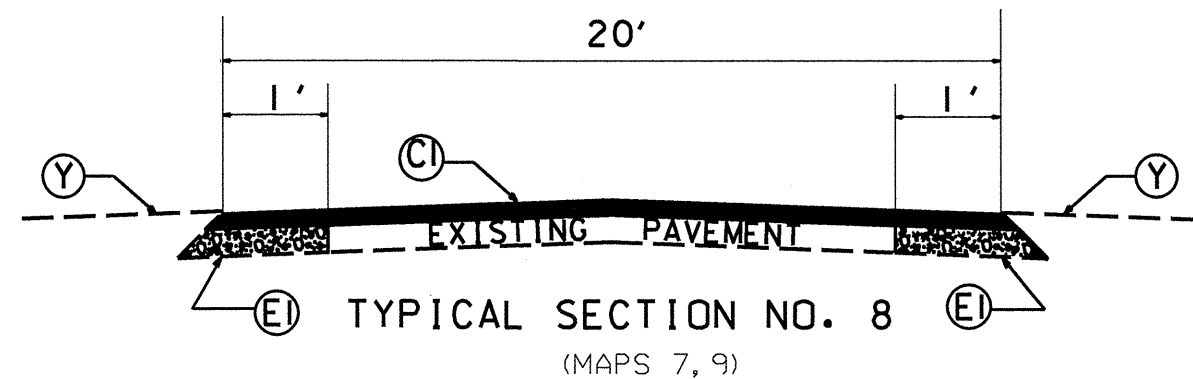
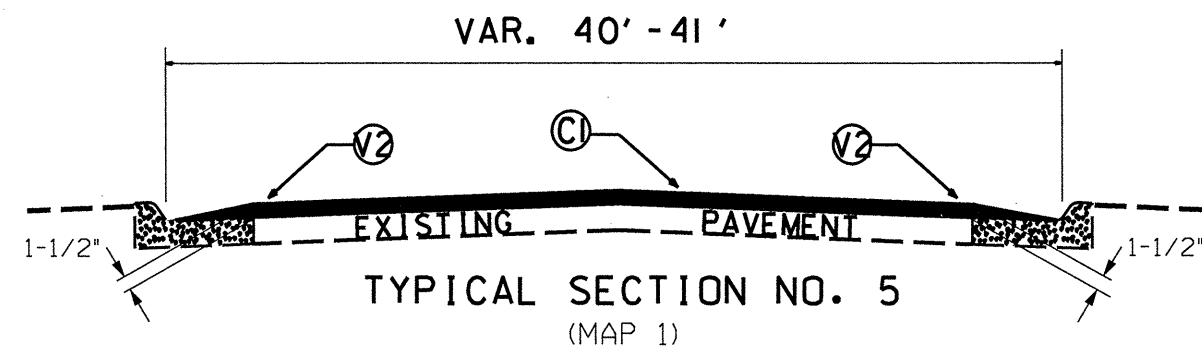
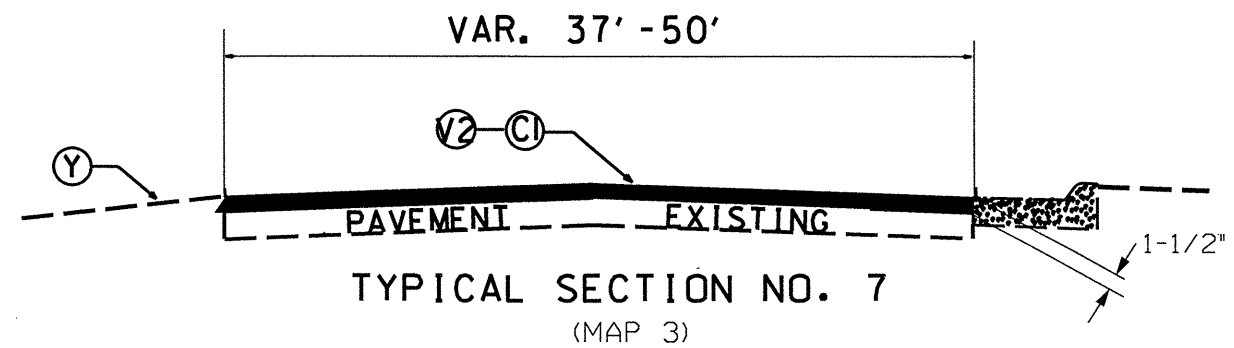
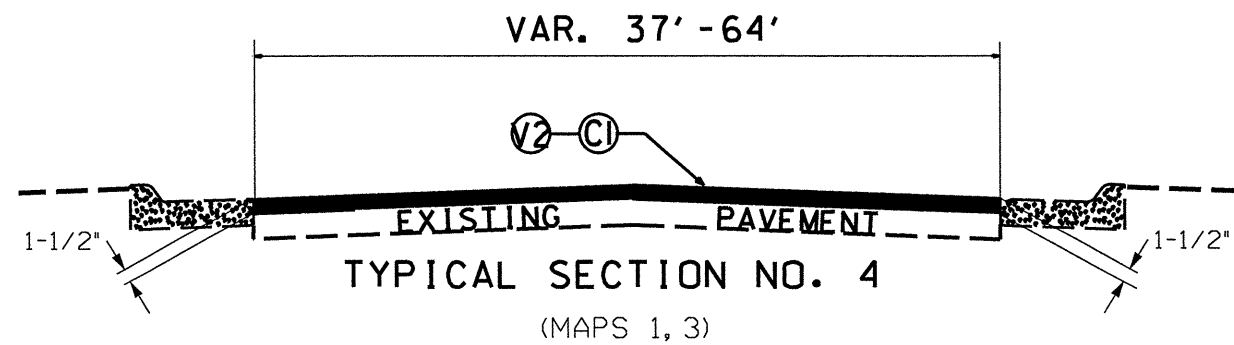
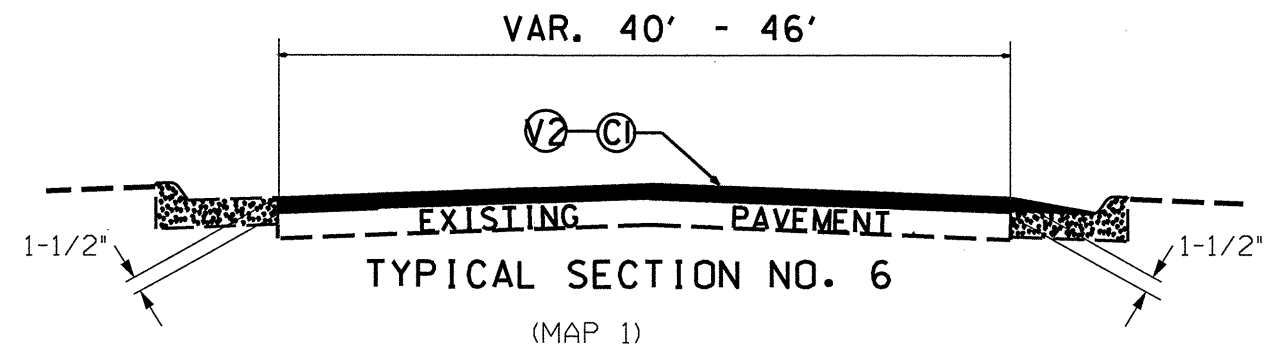

PROJECT NO. 12CR.10231.12, 12CR.20231.17	SHEET NO. 6	TOTAL NO.
--	----------------	-----------

SUMMARY OF QUANTITIES

std. 848.06

PROJECT NO	COUNTY	MAP NO	ROUTE	DESCRIPTION	TYP NO	FINAL SURFACE TESTING REQUIRED	WARM MIX ASPHALT REQUIRED	LENGTH MI	WIDTH FT	AGGREGATE SHOULDER BORROW TON	INCIDENTAL STONE BASE TONS	SHOULDER RECONSTRUCTION SMI	1.5" MILLING SY	1.5" TO 3" MILLING SY	INCIDENTAL MILLING SY	BASE COURSE, B25.0B TONS	SURFACE COURSE, S9.5B TONS	LEVELING COURSE, S9.5B TONS	ASPHALT BINDER FOR PLANT MIX TONS	PATCHING EXISTING PAVEMENT TONS	RETROFIT EXISTING CURB RAMP EA	ADJ. OF DROP INLET EA	ADJ. OF MAN-HOLES EA	ADJ. OF METER OR VALVE BOX EA
12CR.10231.12	Cleveland	1	NC-161 (YORK RD)	SC STATE LINE TO PVMT CHG	1 3 4 5 6	NO	NO	4.21 0.32 0.59 0.65 0.03	VAR. 32-33 VAR. 40-45 VAR. 45-64 VAR. 40-41 VAR. 40-46	842	265	8.42	41,536	9,322			11,832	909	769	2,092	2	1	12	14
12CR.10231.12	Cleveland	2	NC-198 (BLACKSBURG RD)	SC STATE LINE TO SR-2432	2	NO	NO	1.46	VAR. 23-25	300	90	2.92			230	1,197	1,909	288	186	380				
12CR.10231.12	Cleveland	3	US-74 BUS (E. MARION ST.)	PVMT CHG 600' W OF NC-180 TO PVMT CHG 528' W OF US-74	4 7 1	NO	NO	0.88 0.22 0.38	VAR. 37-50 VAR. 37-50 VAR. 24-50	100	20	0.98	27,700				2,986	375	204	565				
TOTAL FOR PROJ NO. 12CR.10231.12								8.74		1,242	375	12.32	69,236	9,322	230	1,197	16,727	1,572	1,159	3,037	2	1	12	14
12CR.20231.17	Cleveland	4	SR-2036 (COUNTRYSIDE RD)	US-74BUS TO SR 2034	1	NO	NO	1.97	VAR. 25-30	394	100	3.94					2,766	496	198	820				
12CR.20231.17	Cleveland	5	SR-2034 (PATTERSON RD)	I-74 BRIDGE TO SR-2026	2	NO	NO	1.1	VAR. 22-23	220	35	2.20				902	1,423	190	137	210				
12CR.20231.17	Cleveland	6	SR-1158 (BEAVER DAM RD)	US-74 TO SR-1161	1	NO	NO	4.2	VAR. 22-43	840	90	8.40			500		5,758	520	379	1,700				
12CR.20231.17	Cleveland	7	SR-1363 (CHARLIE ELLIOT RD)	SR-1350 TO NC-226	8	NO	NO	2.22	20	444	60	4.44				1,004	2,422	548	225	366				
12CR.20231.17	Cleveland	8	SR-2224 (JACK FRANCIS RD)	SC LINE TO SR-2218	1	NO	NO	0.72	20	144	100	1.44					785	40	50	130				
12CR.20231.17	Cleveland	9	SR-1361 (STAGE COACH TRL)	SR-1351 TO RUTHERFORD CL	8	NO	NO	0.7	20	140	30	1.40				316	764	138	69	210				
12CR.20231.17	Cleveland	10	SR-1327 (MOORESBORO RD)	US-74 BUS TO SR-1388	2	NO	NO	1.66	22	332	90	3.32				1,361	1,991	360	203	450				
TOTAL FOR PROJ NO. 12CR.20231.17								12.57		2,514	505	25.14			500	3,583	15,909	2,292	1,261	3,886				
GRAND TOTAL								21.31		3,756	880	37.46	69,236	9,322	730	4,780	32,636	3,864	2,420	6,923	2	1	12	14

THERMOPLASTIC AND PAINT QUANTITIES

PROJECT NO	COUNTY	MAP NO	ROUTE	DESCRIPTION	TYP NO	LANES	LANE TYPE	LENGTH	WIDTH	4413000000-E	4457000000-N	4510000000-C	46970000	4695000000-E	47100000	4721000000-E	4725000000-E					4810000000-E	483500	4847000000-E		4905000000-N			
										WORK ZONE ADVANCE/GENERAL WARNING SIGNING SF	TEMPORARY TRAFFIC CONTROL LS	LAW ENFORCEMENT HR	8" X 120 M WHITE THERMO LF	8" X 90 M YELLOW THERMO LF	8" X 90 M WHITE THERMO LF	24" X 120 M WHITE THERMO LF	THERMO MSG ONLY 120 M EA	THERMO MSG SCHOOL 120 M EA	THERMO LT ARROW 90 M EA	THERMO STR ARROW 90 M EA	THERMO RT ARROW 90 M EA	THERMO STR & LT ARROW 90 M EA	THERMO STR & RT ARROW 90 M EA	4" WHITE PAINT LF	4" YELLOW PAINT LF	24" WHITE PAINT LF	4" WHITE POLYUREA (HIGHLY REFLECTIVE) LF	4" YELLOW POLYUREA (HIGHLY REFLECTIVE ELEMENTS) LF	SNOW PLOWABLE MARKERS EA
12CR.10231.12	Cleveland	1	NC-161 (YORK RD)	SC STATE LINE TO PVMT CHG	1 3 4 5 6	2		4.21 0.32 0.59 0.65 0.03	VAR. 32-33 VAR. 40-45 VAR. 45-64 VAR. 40-41 VAR. 40-46	300	*	60	80	330	110	290	16		52	17	3	1	4	2,000	21,000	290	46,700	58,100	600
12CR.10231.12	Cleveland	2	NC-198 (BLACKSBURG RD)	SC STATE LINE TO SR-2432	2	2		1.46	VAR. 23-25	250		45														15,710	14,010	99	
12CR.10231.12	Cleveland	3	US-74 BUS (E. MARION ST.)	PVMT CHG 600' W OF NC-180 TO PVMT CHG 528' W OF US-74	4 7 1	2		0.88 0.22 0.38	VAR. 37-50 VAR. 37-50 VAR. 24-50	250		45	160	60	200	200			36	4	10		3	1,500	20,300	200	6,300	20,300	230
TOTAL FOR PROJ NO. 12CR.10231.12								8.74		800	1	150	240	390	310	490	16		88	21	13	1	7	3,500	41,300	490	68,710	92,410	929
													700		16		130		44,800		161,120								
12CR.20231.17	Cleveland	4	SR-2036 (COUNTRYSIDE RD)	US-74BUS TO SR 2034	1	2	2WU	1.97	VAR. 25-30	232		30			24				2			2	42,394	42,394					
12CR.20231.17	Cleveland	5	SR-2034 (PATTERSON RD)	I-74 BRIDGE TO SR-2026	2	2	2WU	1.1	VAR. 22-23	232		30											23,672	23,672					
12CR.20231.17	Cleveland	6	SR-1158 (BEAVER DAM RD)	US-74 TO SR-1161	1	2	2WU	4.2	VAR. 22-43	232		30		120	100	4	12	6			3				45,192	45,192			
12CR.20231.17	Cleveland	7	SR-1363 (CHARLIE ELLIOT RD)	SR-1350 TO NC-226	8	2	2WU	2.22	20	232	*	30											47,774	47,774					
12CR.20231.17	Cleveland	8	SR-2224 (JACK FRANCIS RD)	SC LINE TO SR-2218	1	2	2WU	0.72	20	232		30											15,494	15,494					
12CR.20231.17	Cleveland	9	SR-1361 (STAGE COACH TRL)	SR-1351 TO RUTHERFORD CL	8	2	2WU	0.7	20	232		30											15,064	15,064					
12CR.20231.17	Cleveland	10	SR-1327 (MOORESBORO RD)	US-74 BUS TO SR-1388	2	2	2WU	1.66	22	232		30											35,723	35,723					
TOTAL FOR PROJ NO. 12CR.20231.17								12.57		1,624	1	210		120	124	4	12	8		3	2	180,121	180,121		45,192	45,192			
													120		16		13		360,242		90,384								
GRAND TOTAL								21.31		2,424	1	360	240	390	430	614	20	12	96	21	16	1	9	183,621	221,421	490	113,902	137,602	929
													820		32		143		405,042		251,504								