

8/5/2013 10:00:05 AM C:\Users\jbeard\Documents\NCDOT Division On Call 2009\609005.1402.Div.14.W-5315\W-5315.PMP\W-5315.PMP\_01\_TSH.dgn User: jbeard

**CONTRACT:**

**T.I.P.: W-5315**

**STATE OF NORTH CAROLINA  
DEPARTMENT OF TRANSPORTATION**

**PAVEMENT MARKING PLAN  
HAYWOOD COUNTY**

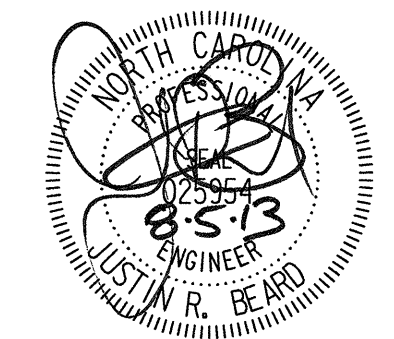
<small>TIP NO.</small> W-5315	<small>SHEET NO.</small> PMP - 1
<small>APPROVED:</small> _____	
<small>DATE:</small> _____	
<small>SEAL</small>	
	
<small>SEAL NOT VALID UNLESS SIGNED AND DATED</small>	

<b>INDEX</b>	
<u>SHEET NO.</u>	<u>DESCRIPTION</u>
PMP-1	PAVEMENT MARKING PLAN COVER SHEET AND PAVEMENT MARKING SCHEDULE
PMP-2 THRU 12	PAVEMENT MARKING DETAIL SHEETS

<b>FINAL PAVEMENT MARKING SCHEDULE</b>			
<u>SYMBOL</u>	<u>DESCRIPTION</u>	<u>PAY ITEM</u>	<u>PAY ITEM</u>
V8	2 FT. -6 FT./SP WHITE MINISKIP	(4")	POLYUREA
V9	2 FT. -6 FT./SP YELLOW MINISKIP	(4")	POLYUREA
VB	YELLOW EDGELINE	(4")	POLYUREA
VD	3 FT. -9 FT./ SP WHITE MINISKIP	(4")	POLYUREA
VE	WHITE SOLID LANE LINE	(4")	POLYUREA
UA	LEFT TURN ARROW	(90 MIL)	THERMOPLASTIC
UT	U-TURN ARROW	(90 MIL)	THERMOPLASTIC
MB	CRYSTAL & RED		SNOWPLOWABLE MARKERS

**GENERAL NOTES**

THE FOLLOWING GENERAL NOTES APPLY AT ALL TIMES FOR THE DURATION OF THE CONSTRUCTION PROJECT, EXCEPT WHEN OTHERWISE NOTED IN THE PLAN, OR DIRECTED BY THE ENGINEER.

A) INSTALL PAVEMENT MARKINGS AND PAVEMENT MARKERS ON THE FINAL SURFACE AS FOLLOWS:

ROAD NAME	MARKING	MARKER
US 74	POLYUREA, THERMOPLASTIC	PERMANENT, SNOWPLOWABLE

B) TIE PROPOSED PAVEMENT MARKING LINES TO EXISTING PAVEMENT MARKING LINES.

C) REMOVE/REPLACE ANY CONFLICTING/DAMAGED PAVEMENT MARKINGS AND MARKERS.

D) STOP BAR LOCATION AT NON -SIGNALIZED INTERSECTIONS MAY BE ADJUSTED AS DIRECTED BY THE ENGINEER.

E) MARKERS SHALL BE INSTALLED ACCORDING TO THE NC DOT ROADWAY STANDARD DRAWING 1250.01.

F) UNLESS OTHERWISE SPECIFIED, HEATED-IN-PLACE THERMOPLASTIC MAY BE USED IN LIEU OF EXTRUDED THERMOPLASTIC FOR STOP BARS, SYMBOLS, CHARACTERS AND DIAGONALS. IF HEATED-IN-PLACE IS USED, IT SHALL BE PAID FOR USING THE THE EXTRUDED THERMOPLASTIC PAY ITEM.

**ROADWAY STANDARD DRAWING**

THE FOLLOWING ROADWAY STANDARDS AS APPEAR IN "ROADWAY STANDARD DRAWINGS" - PROJECT SERVICES UNIT - N.C. DEPARTMENT OF TRANSPORTATION - RALEIGH, N.C., DATED JANUARY 2012 ARE APPLICABLE TO THIS PROJECT AND BY REFERENCE HEREBY ARE CONSIDERED A PART OF THESE PLANS:

<u>STD. NO.</u>	<u>TITLE</u>
1205.01	PAVEMENT MARKINGS - LINE TYPES AND OFFSETS
1205.02	PAVEMENT MARKINGS - DIVIDED AND UNDIVIDED
1205.04	PAVEMENT MARKINGS - INTERSECTIONS
1205.05	PAVEMENT MARKINGS - TURN LANES
1205.08	PAVEMENT MARKINGS - SYMBOLS AND WORD MESSAGES
1205.09	PAVEMENT MARKINGS - PAINTED ISLANDS
1250.01	RAISED PAVEMENT MARKERS - INSTALLATION SPACING
1253.01	RAISED PAVEMENT MARKERS - SNOWPLOWABLE
1261.01	GUARDRAIL AND BARRIER DELINEATORS - INSTALLATION SPACING
1261.02	GUARDRAIL AND BARRIER DELINEATORS - TYPES AND MOUNTING
1262.01	GUARDRAIL END DELINEATION
1264.01	OBJECT MARKERS - TYPES
1264.02	OBJECT MARKERS - INSTALLATION

**PLAN REVIEWED BY: N.C.D.O.T. SIGNING AND DELINEATION UNIT**

<u>KELVIN JORDAN</u> SIGNING & DELINEATION STANDARDS ENGINEER
<u>MATTHEW TRACEY</u> SIGNING & DELINEATION PROJECT DESIGN ENGINEER

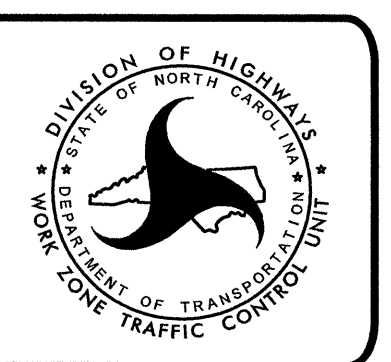

**PLAN PREPARED BY: ARCADIS**

<u>STEVE SMALLWOOD, P.E.</u> PROJECT MANAGER
<u>JUSTIN BEARD, P.E.</u> PROJECT ENGINEER

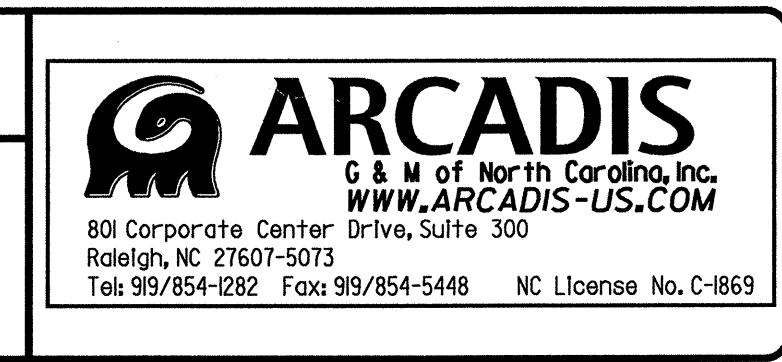

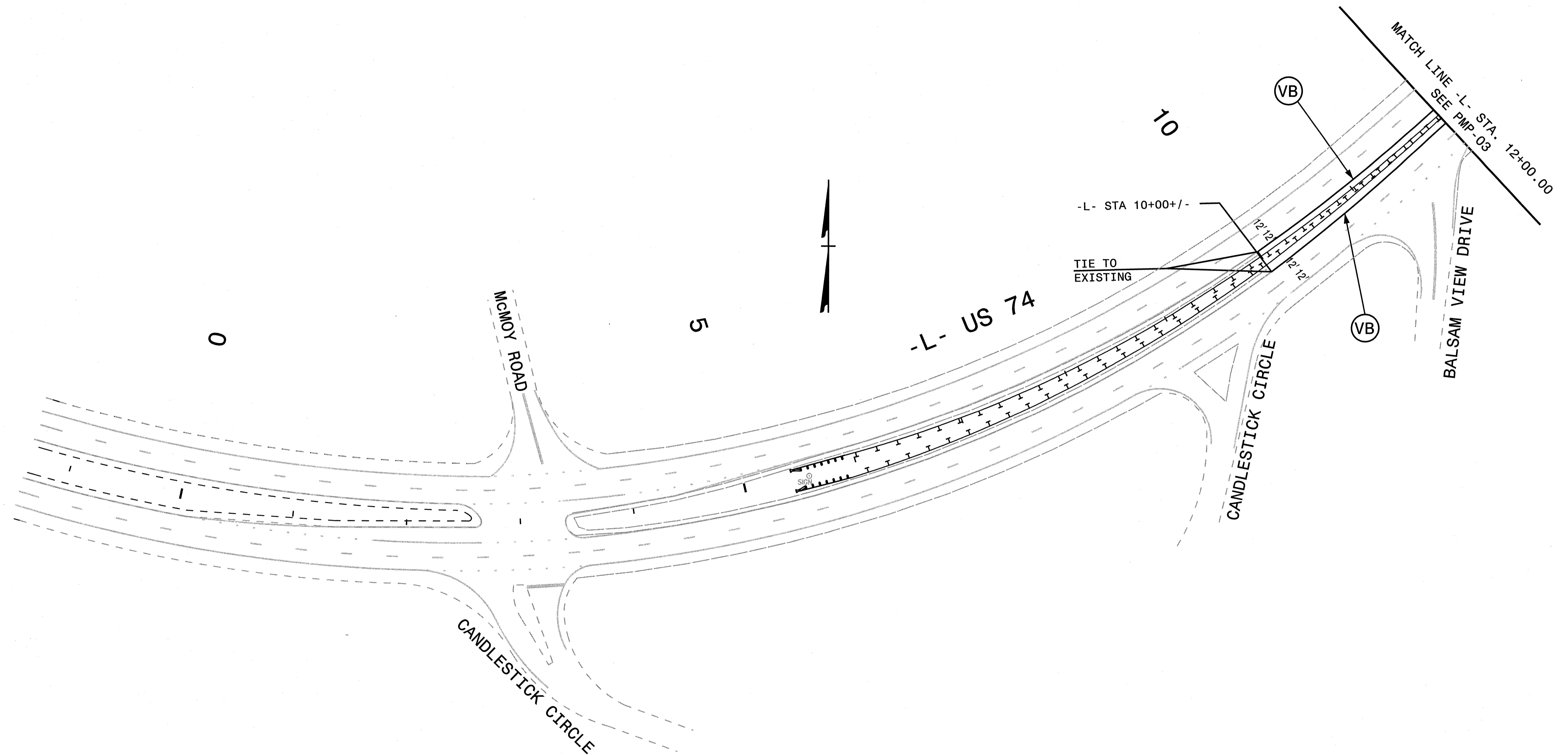

7/15/2013  
 R:\Traffic\Pavement Marking\W5315\_PM\_PMP\_02.dwg  
 User: jbeard

APPROVED:	DATE:
SEAL NOT VALID UNLESS SIGNED AND DATED	

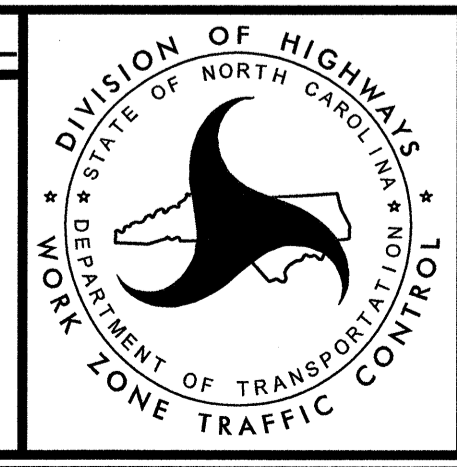

**PAVEMENT MARKINGS**  
 STA. 5+07.23 TO STA. 12+00  
 US 74 -L-

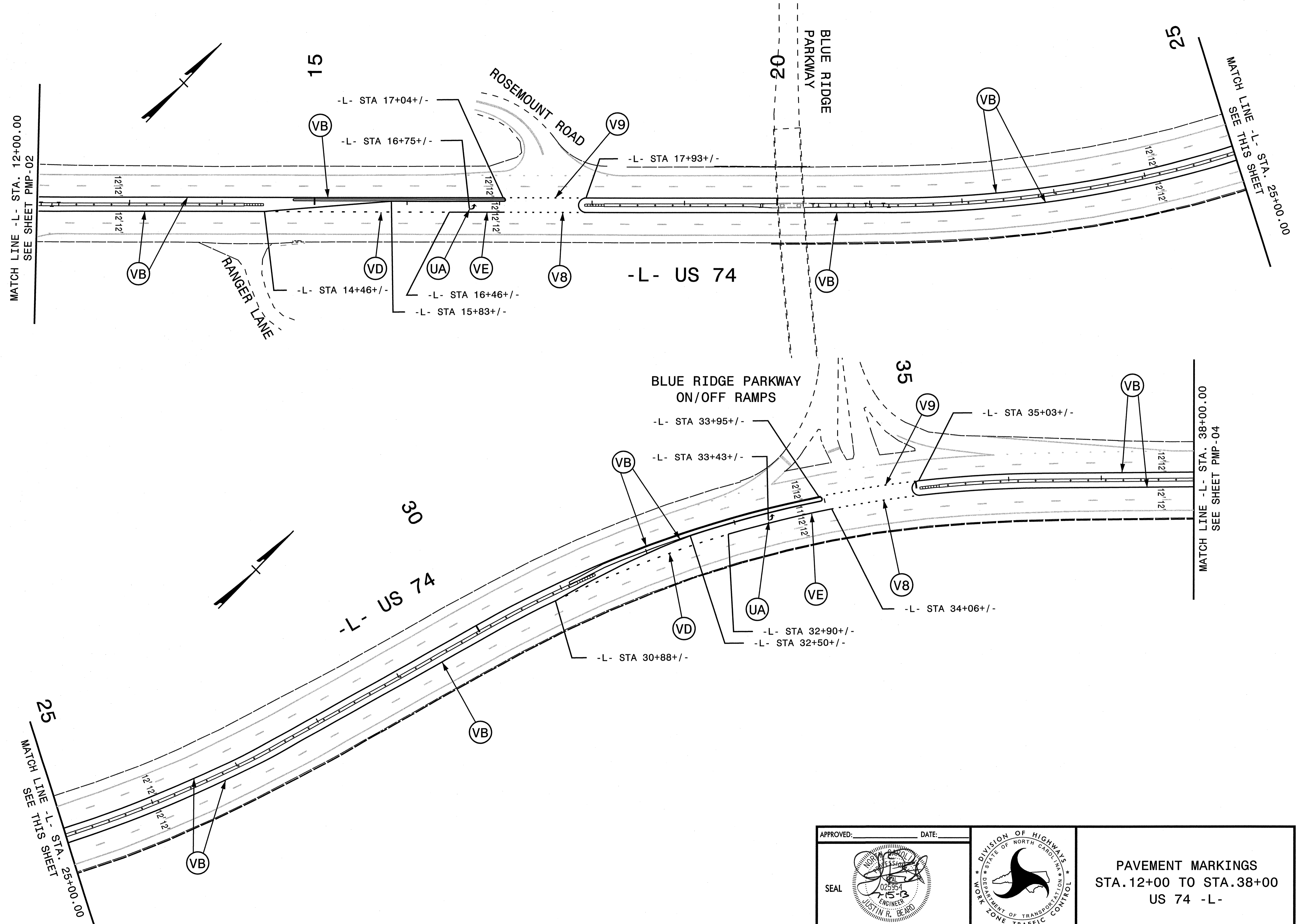

7/15/2013  
 R:\Tg\Tg\Fic\Pavement Marking\W5315\_PM\_PMP-03\_detail.dgn  
 User: jbeard

APPROVED: \_\_\_\_\_ DATE: \_\_\_\_\_

SEAL

SEAL NOT VALID UNLESS SIGNED AND DATED

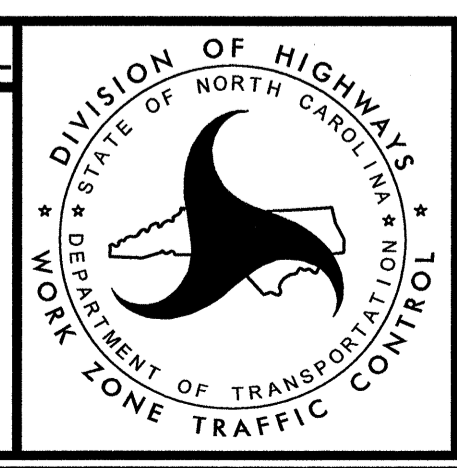

PAVEMENT MARKINGS  
 STA. 12+00 TO STA. 38+00  
 US 74 -L-

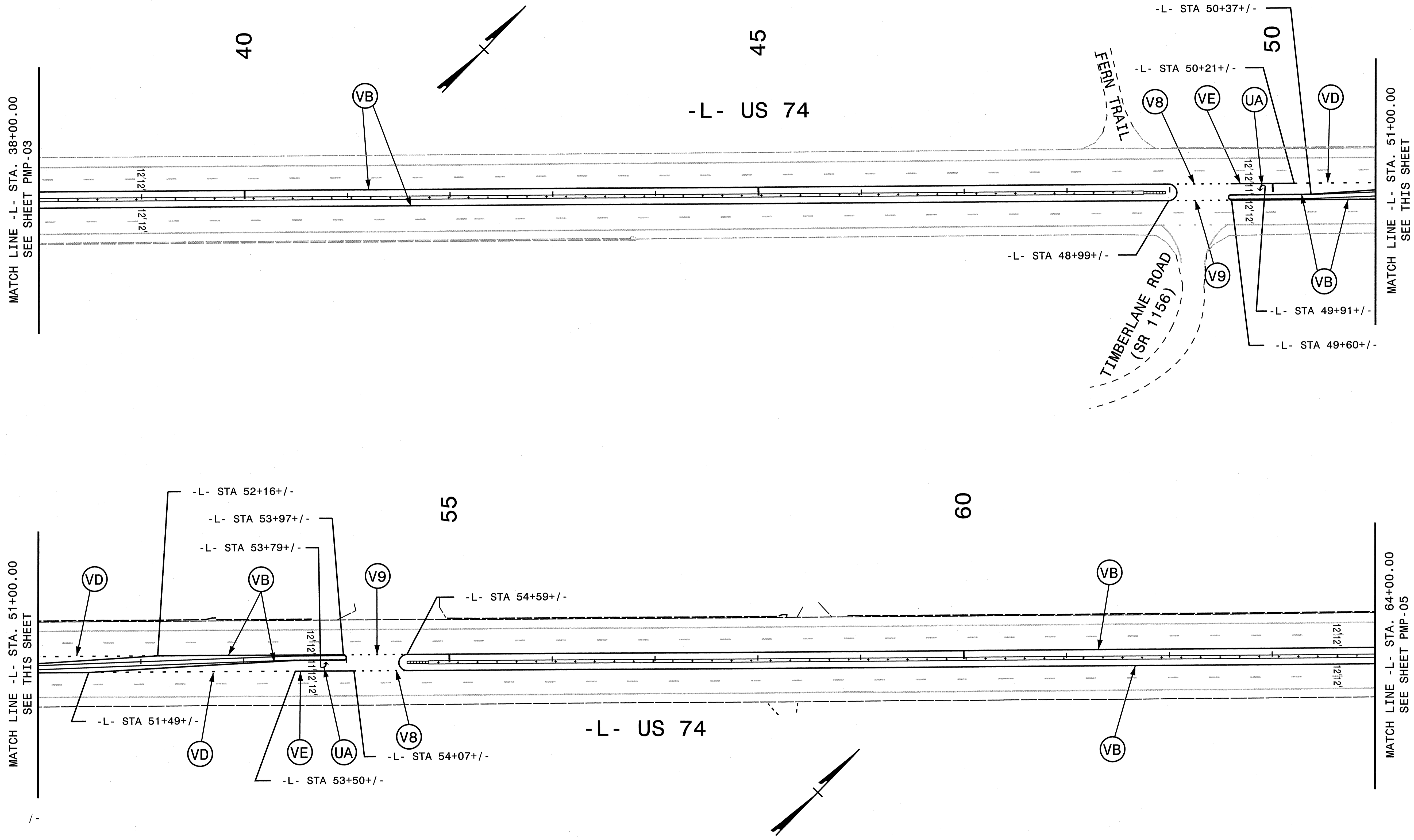

MATCH LINE -L- STA. 38+00.00  
SEE SHEET PMP-03

MATCH LINE -L- STA. 51+00.00  
SEE THIS SHEET

MATCH LINE -L- STA. 51+00.00  
SEE THIS SHEET

MATCH LINE -L- STA. 64+00.00  
SEE SHEET PMP-05

7/15/2013  
R:\Traffic\ Pavement Marking\ PMP\ W5315\_PM\_PMP\_04\_detail.dgn  
User: jbeard

APPROVED: \_\_\_\_\_ DATE: \_\_\_\_\_

SEAL

SEAL NOT VALID UNLESS SIGNED AND DATED

DIVISION OF HIGHWAYS  
STATE OF NORTH CAROLINA  
DEPARTMENT OF TRANSPORTATION  
WORK ZONE TRAFFIC CONTROL

PAVEMENT MARKINGS  
STA. 38+00 TO STA. 64+00  
US 74 -L-



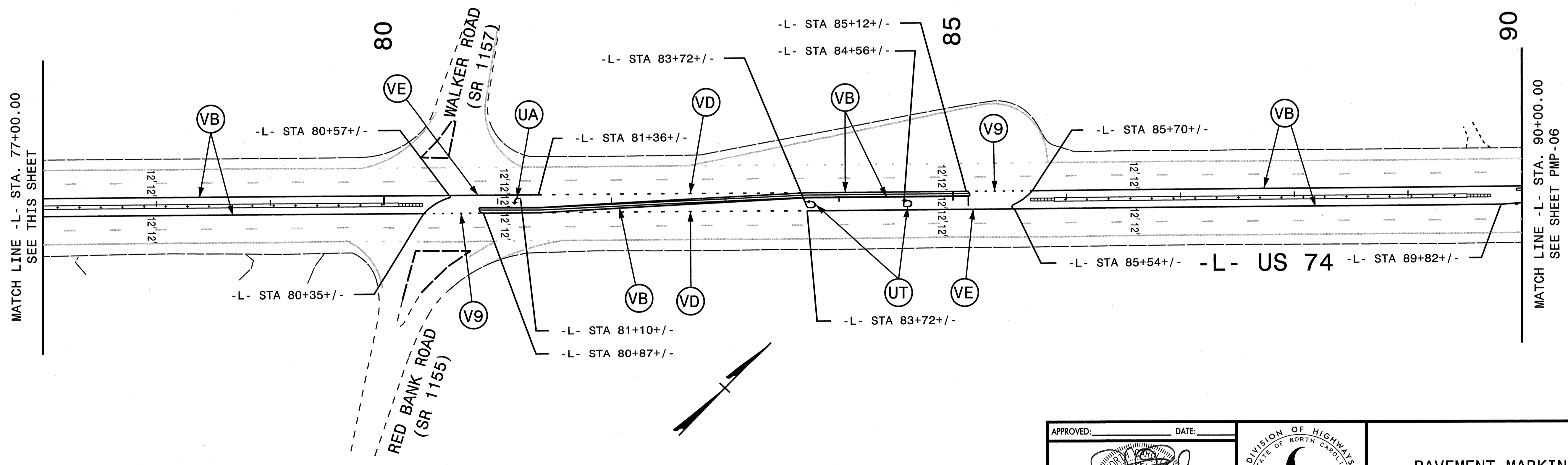
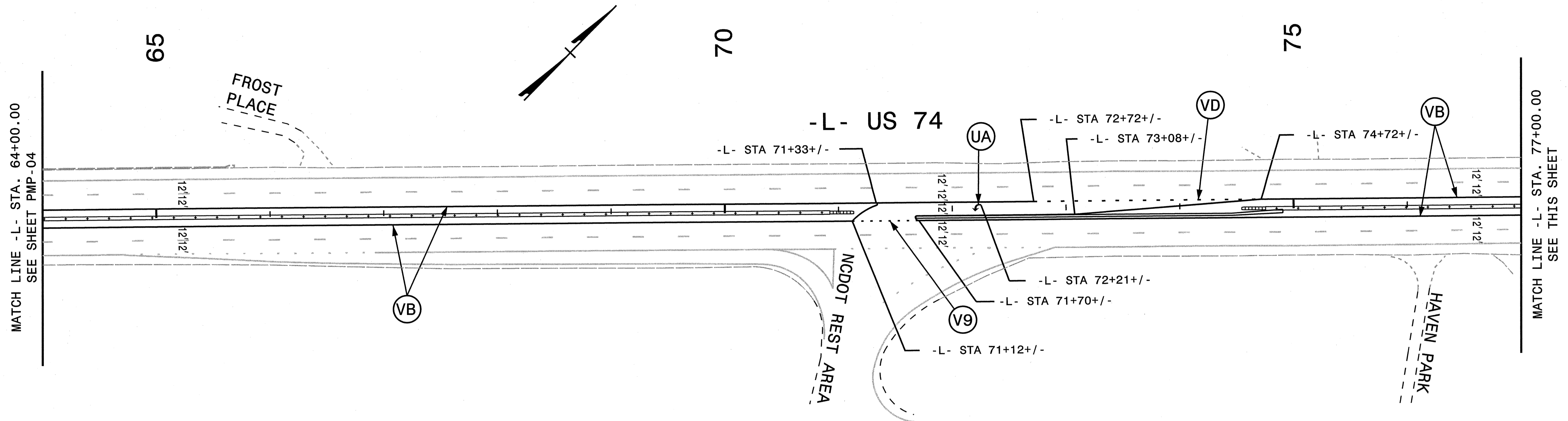

7/15/2013  
 R:\Trg\office\Pavement Marking\W5315\_PM\_PMP\_05\_detail.dgn  
 User: jbeard

APPROVED: \_\_\_\_\_ DATE: \_\_\_\_\_

SEAL

SEAL NOT VALID UNLESS SIGNED AND DATED

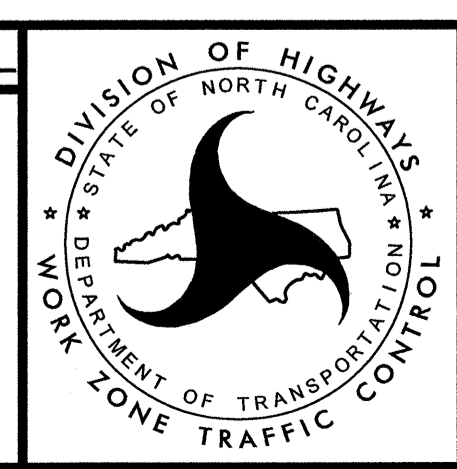

**PAVEMENT MARKINGS**  
 STA. 64+00 TO STA. 90+00  
 US 74 -L-

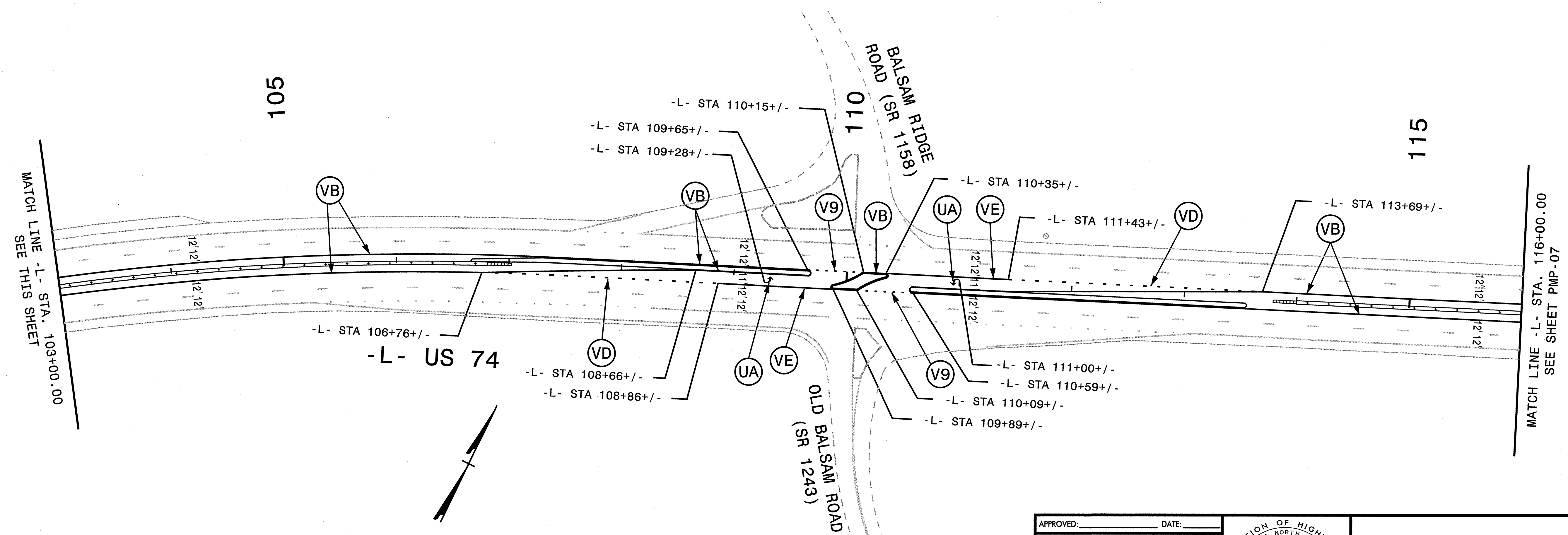
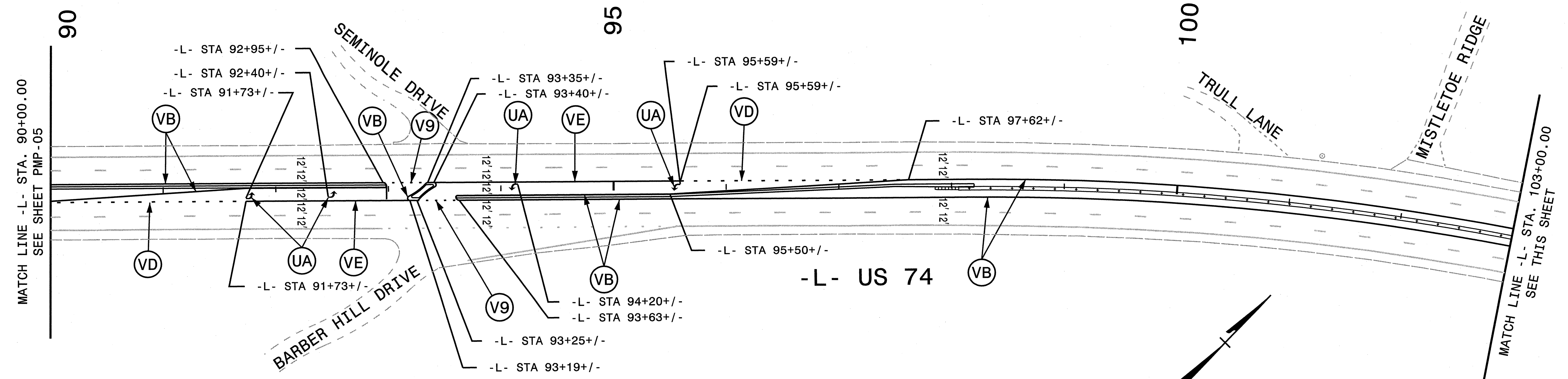

7/15/2013  
 R:\Traffic\Pavement Marking\W5315\_PM\_PMP\_06\_detail.dgn  
 User:ibeard

APPROVED: \_\_\_\_\_ DATE: \_\_\_\_\_

SEAL

JUSTIN R. BEARD  
ENGINEER  
025954  
STATE OF NORTH CAROLINA

SEAL NOT VALID UNLESS SIGNED AND DATED

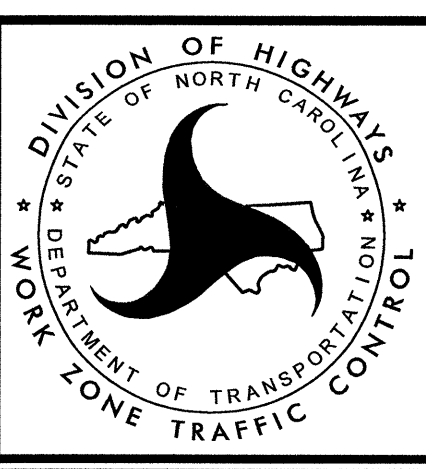

PAVEMENT MARKINGS  
 STA. 90+00 TO STA. 116+00  
 US 74 -L-

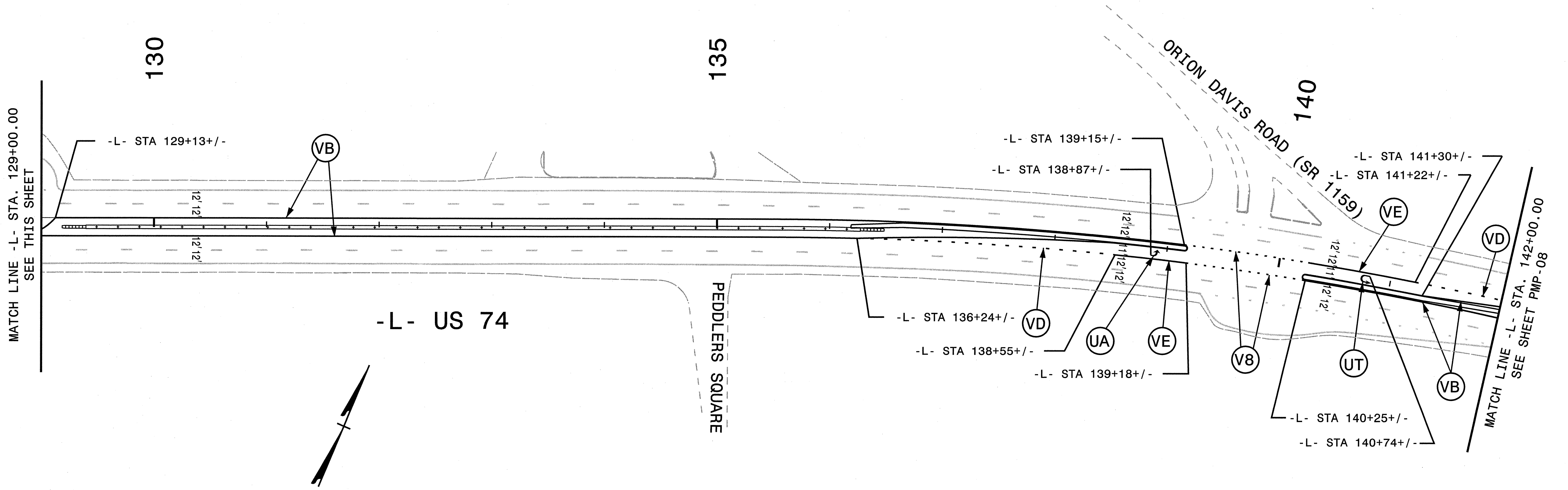
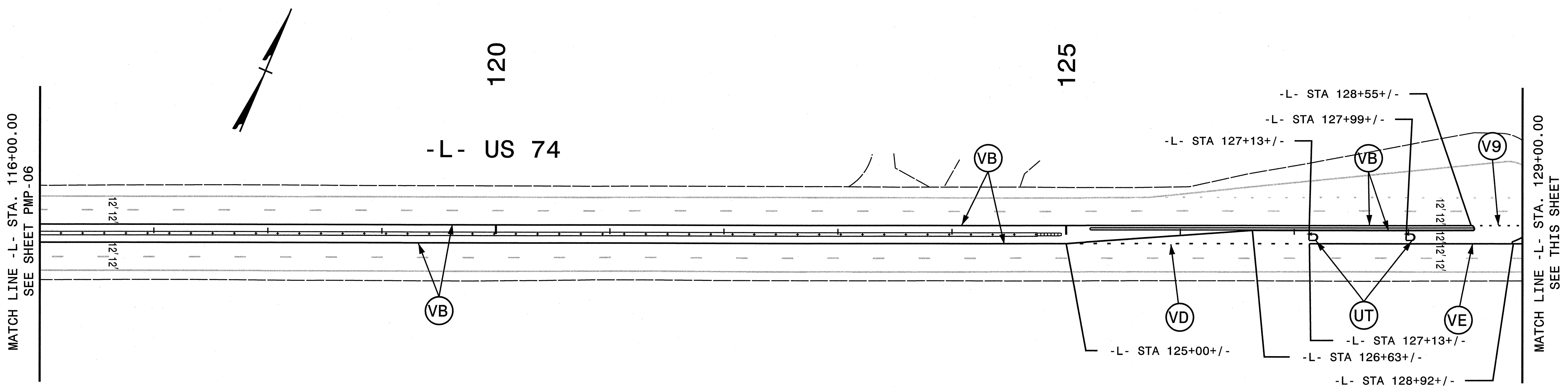

7/15/2013  
 R:\Traffic\Pavement Marking\PM\W5315-PM-PMP-07-detail.dgn  
 User: jbeard

APPROVED: \_\_\_\_\_ DATE: \_\_\_\_\_

SEAL

SEAL NOT VALID UNLESS SIGNED AND DATED

PAVEMENT MARKINGS  
 STA. 116+00 TO STA. 142+00  
 US 74 -L-



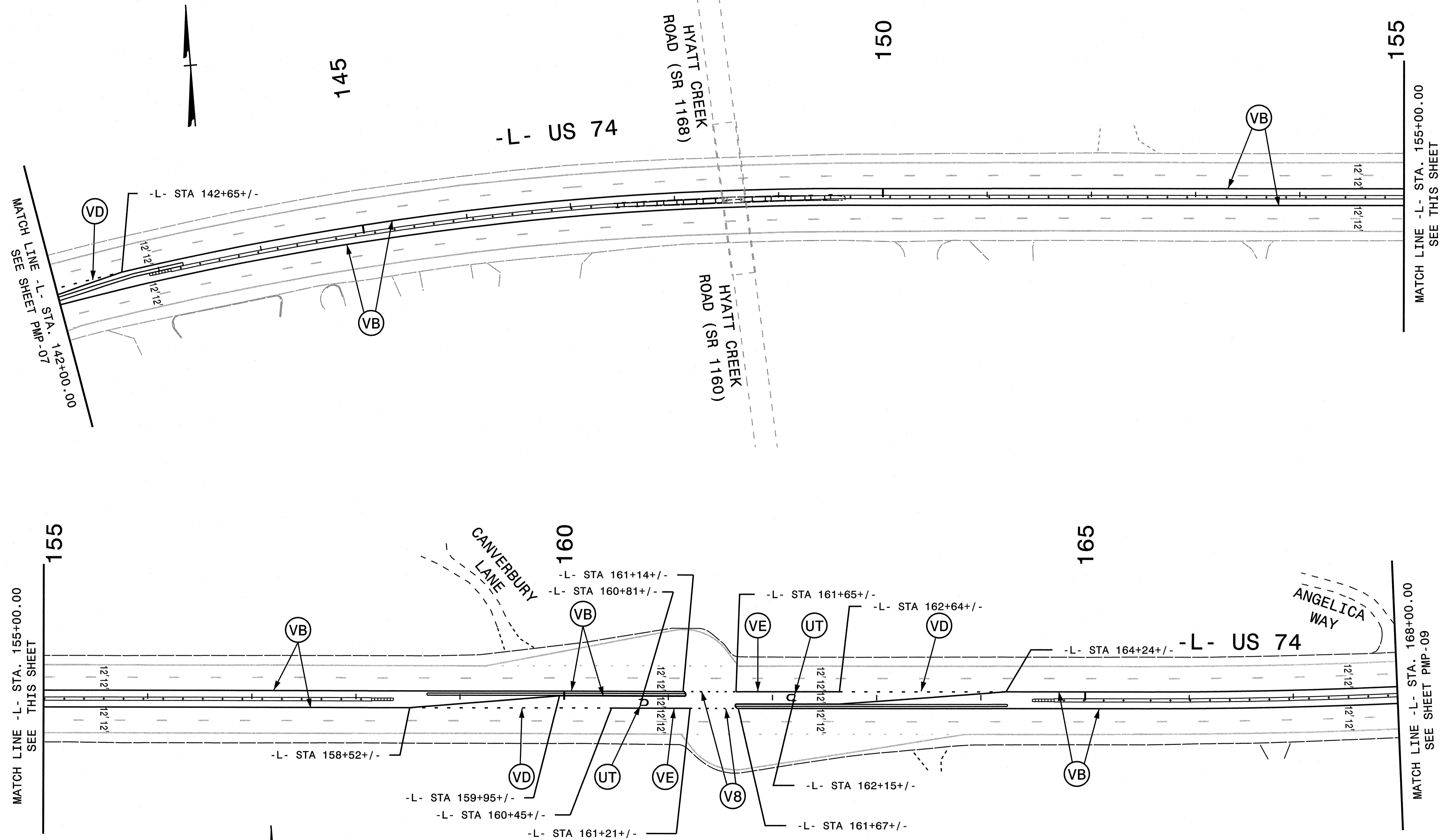

7/15/2013  
 R:\Traffic\Pavement Marking\W5315\_PM\_PMP\_08\_detail.dgn  
 User: jbeard

APPROVED: \_\_\_\_\_ DATE: \_\_\_\_\_

SEAL

SEAL NOT VALID UNLESS SIGNED AND DATED

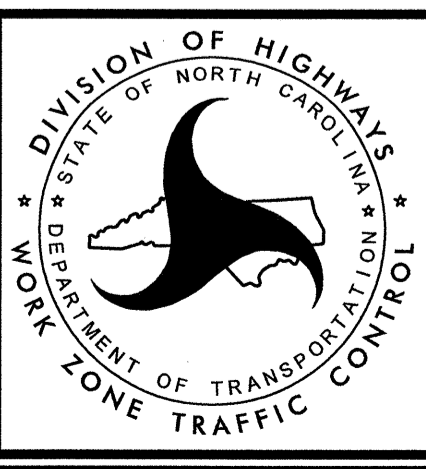

PAVEMENT MARKINGS  
 STA. 142+00 TO STA. 168+00  
 US 74 -L-



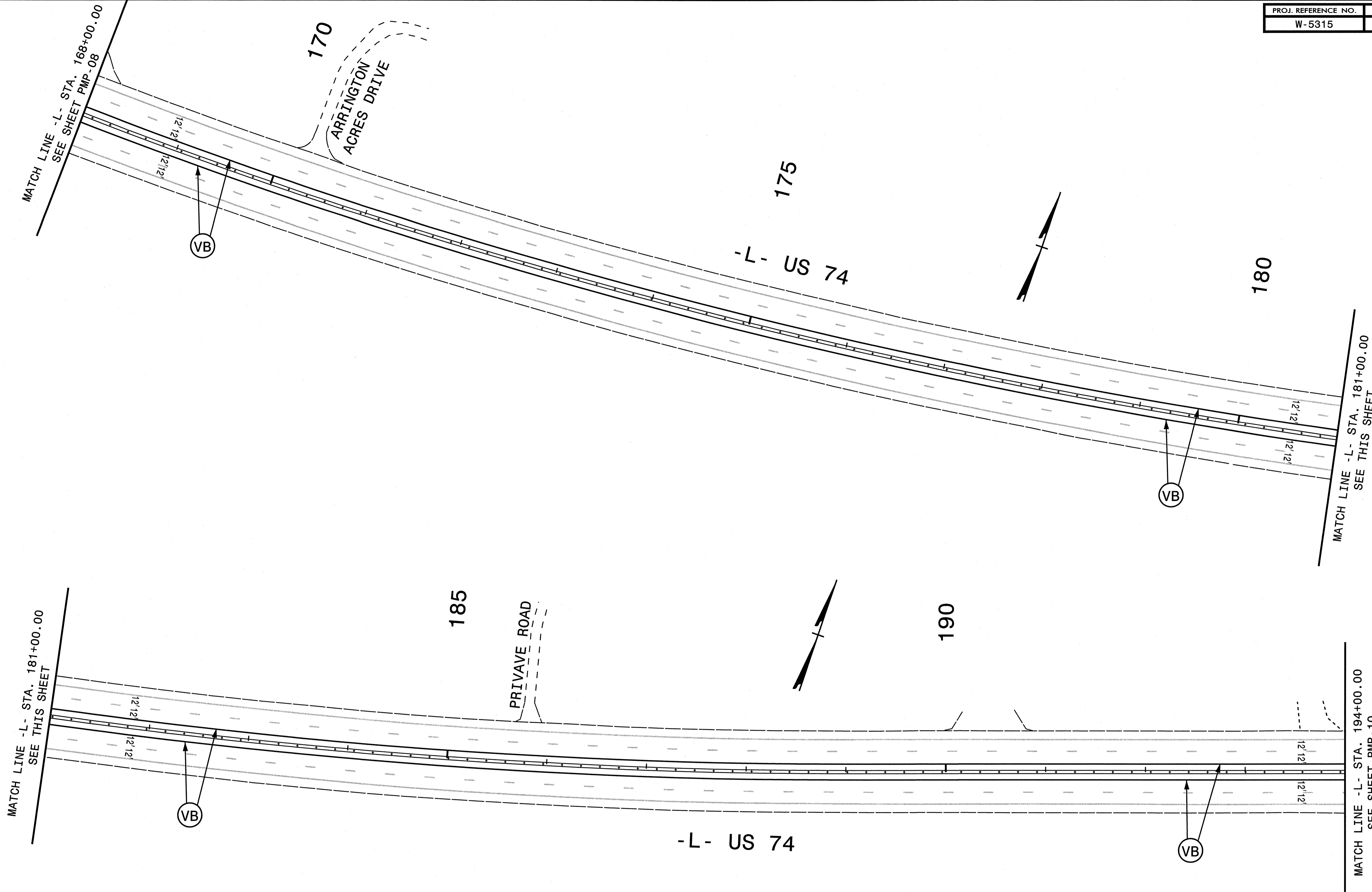

7/15/2013  
 R:\Tr\office\Pavement Marking\PM\W5315\_PM\_PMP\_09\_detail.dgn  
 User: jbeard

APPROVED: \_\_\_\_\_ DATE: \_\_\_\_\_

SEAL

SEAL NOT VALID UNLESS SIGNED AND DATED

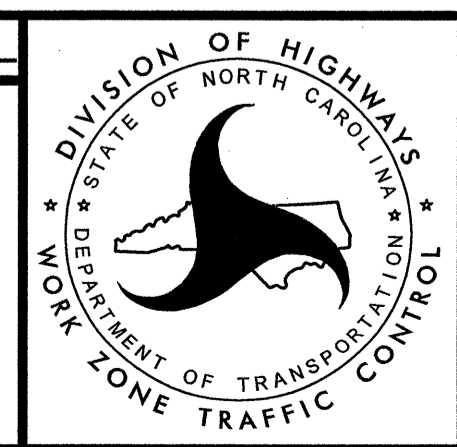

PAVEMENT MARKINGS  
 STA. 168+00 TO STA. 194+00  
 US 74 -L-

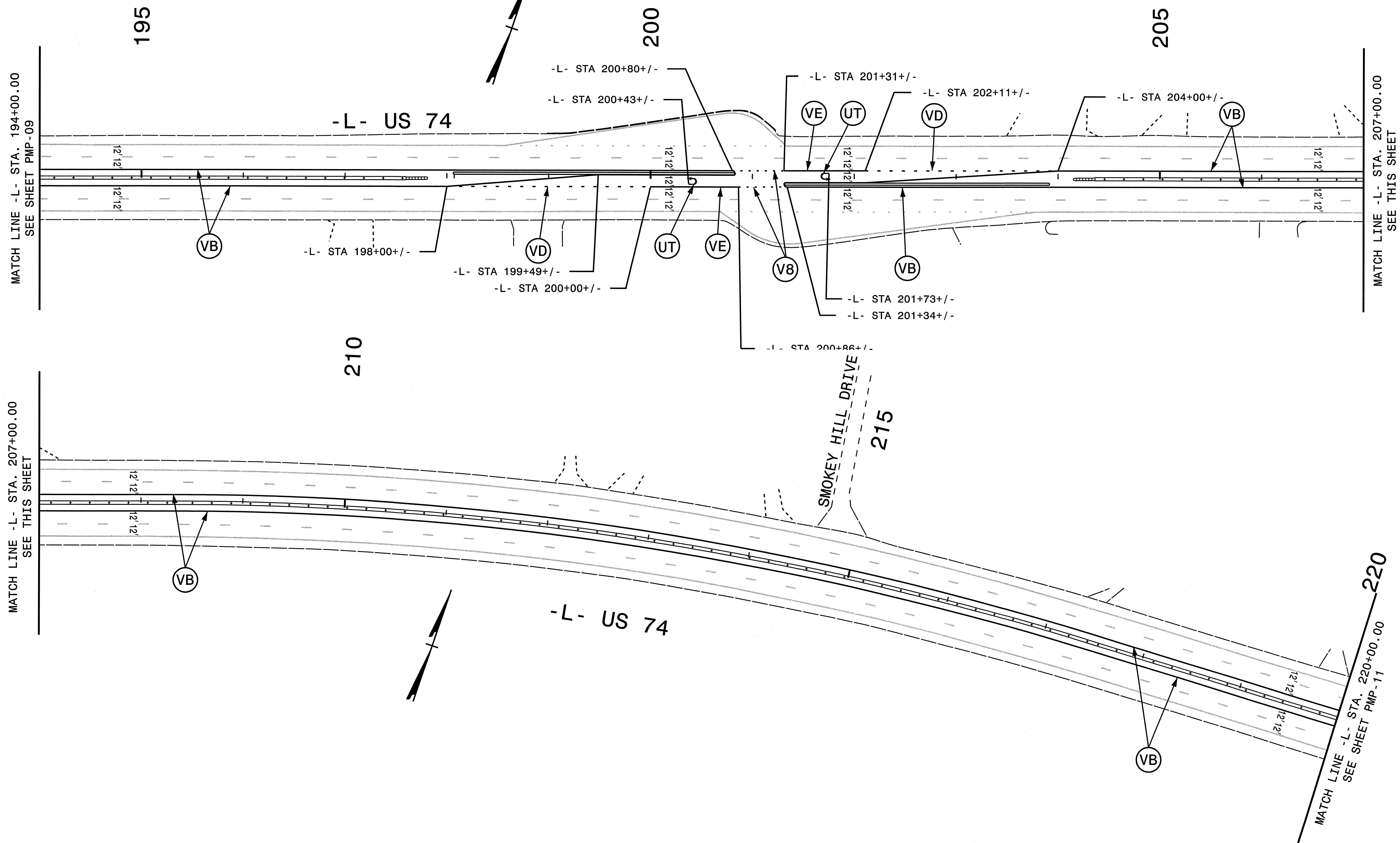

7/15/2013  
 R:\Traffic\Pavement Marking\PM\W5315\_PM\_PMP\_10\_detail.dgn  
 User: jbeard

APPROVED: \_\_\_\_\_ DATE: \_\_\_\_\_

SEAL

SEAL NOT VALID UNLESS SIGNED AND DATED

PAVEMENT MARKINGS  
 STA. 194+00 TO STA. 220+00  
 US 74 -L-

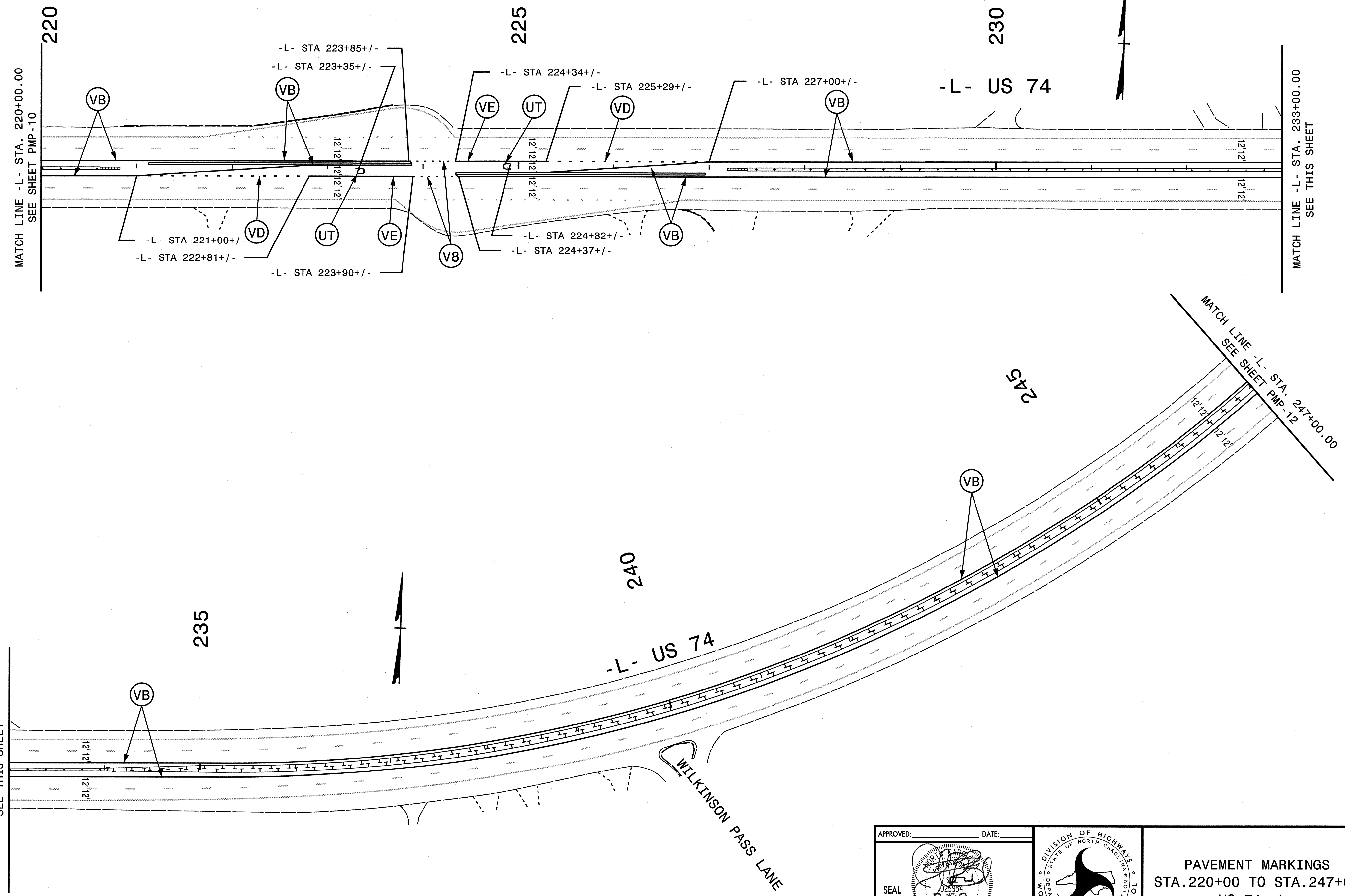

7/15/2013  
 R:\Traffic\Pavement Marking\PM\W5315\_PM\_PMP-11\_detail.dgn  
 User: jbeard

APPROVED: \_\_\_\_\_ DATE: \_\_\_\_\_

SEAL

SEAL NOT VALID UNLESS SIGNED AND DATED

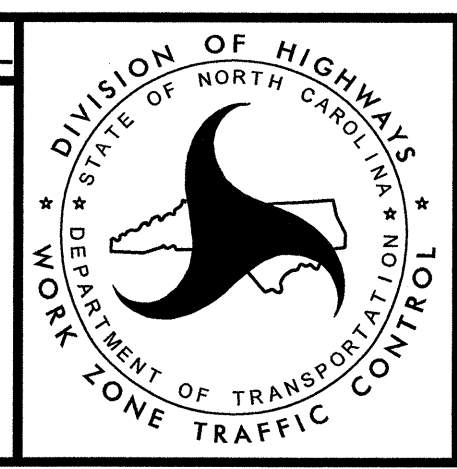

PAVEMENT MARKINGS  
 STA. 220+00 TO STA. 247+00  
 US 74 -L-



MATCH LINE -L- STA. 247+00.00  
SEE SHEET PMP-11

MATCH LINE -L- STA. 261+00.00  
SEE THIS SHEET

MATCH LINE -L- STA. 261+00.00  
SEE THIS SHEET

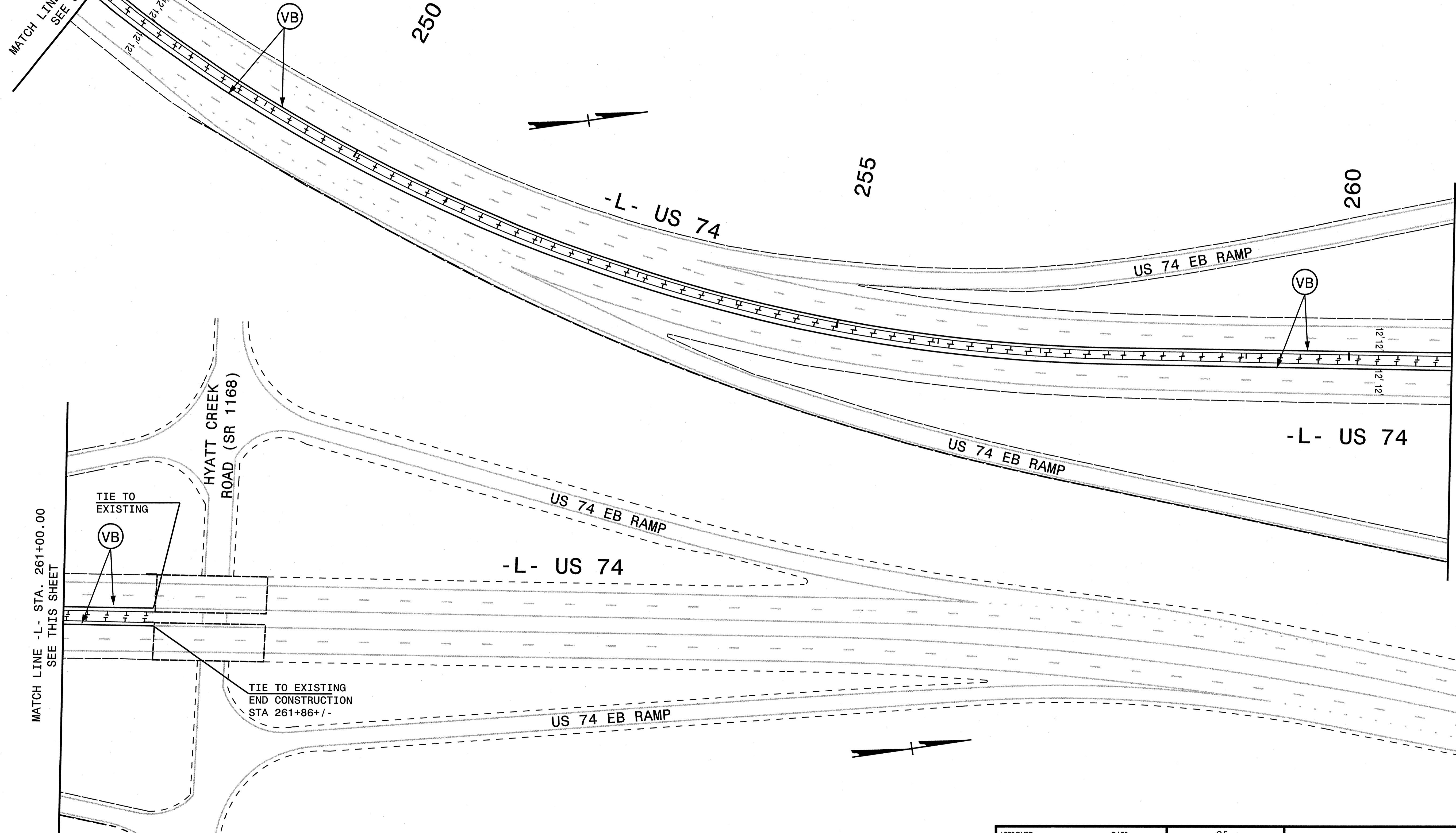

TIE TO EXISTING

TIE TO EXISTING  
END CONSTRUCTION  
STA 261+86+/-

APPROVED: \_\_\_\_\_ DATE: \_\_\_\_\_

SEAL

JUSTIN R. BEARD  
ENGINEER  
25954  
7-15-13  
NORTH CAROLINA

SEAL NOT VALID UNLESS SIGNED AND DATED

DIVISION OF HIGHWAYS  
STATE OF NORTH CAROLINA  
DEPARTMENT OF TRANSPORTATION  
WORK ZONE TRAFFIC CONTROL

PAVEMENT MARKINGS  
STA. 247+00 TO STA. 261+86.38  
US 74 -L-