

## STATE OF NORTH CAROLINA DIVISION OF HIGHWAYS

NOTE: EMBANKMENT COLUMN DOES NOT INCLUDE BACKFILL FOR UNDERCUT

### CROSS-SECTION SUMMARY

Station	Uncl. Exc.	Embt		Station	Uncl. Exc.	Embt		Station	Uncl. Exc.	Embt								
SERVDREV	(cu. yd.)	(cu. yd.)		RAMPREV	(cu. yd.)	(cu. yd.)		DRIVE	(cu. yd.)	(cu. yd.)								
10+00.00	0	0		14+00.00	0	0		10+75.00	0	0								
10+50.00	0	0		14+50.00	208	12		11+00.00	11	8								
11+00.00	0	827		15+00.00	237	27		11+25.00	13	24								
11+50.00	54	508		15+50.00	294	24		11+50.00	24	41								
12+00.00	140	233		16+00.00	342	19		11+75.00	42	83								
12+50.00	138	87		16+50.00	370	11		12+00.00	48	103								
13+00.00	73	31		17+00.00	263	0		<b>TOTAL</b>	<b>138</b>	<b>259</b>								
13+50.00	128	9		17+50.00	120	0												
14+00.00	314	0		18+00.00	76	0												
14+50.00	506	0		18+50.00	46	0												
15+00.00	702	0		19+00.00	33	0												
15+50.00	811	0		19+50.00	30	0												
16+00.00	774	0		20+00.00	28	0												
16+50.00	631	0		20+50.00	28	0												
17+00.00	561	0		21+00.00	29	0												
17+50.00	626	0		21+50.00	30	0												
18+00.00	490	0		22+00.00	30	0												
18+50.00	292	8		22+50.00	30	0												
19+00.00	207	8		23+00.00	30	0												
19+50.00	119	0		23+50.00	30	0												
20+00.00	49	0		24+00.00	30	0												
<b>TOTAL</b>	<b>6615</b>	<b>1711</b>		24+50.00	30	0												
				25+00.00	29	0												
				25+50.00	29	0												
				<b>TOTAL</b>	<b>2372</b>	<b>93</b>												

Quantities are approximate only. Unclassified excavation, borrow excavation, fine grading, clearing and grubbing, removal of existing asphalt pavement, and removal of existing concrete pavement will be paid for at the lump sum price for "Grading".

8/23/99

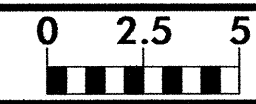

PROJ. REFERENCE NO.  
R-4750

SHEET NO.  
X-1

75 70 65 60 55 50 45 40 35 30 25 20 15 10 5 0 5 10 15 20 25 30 35 40 45 50 55 60 65 70 75

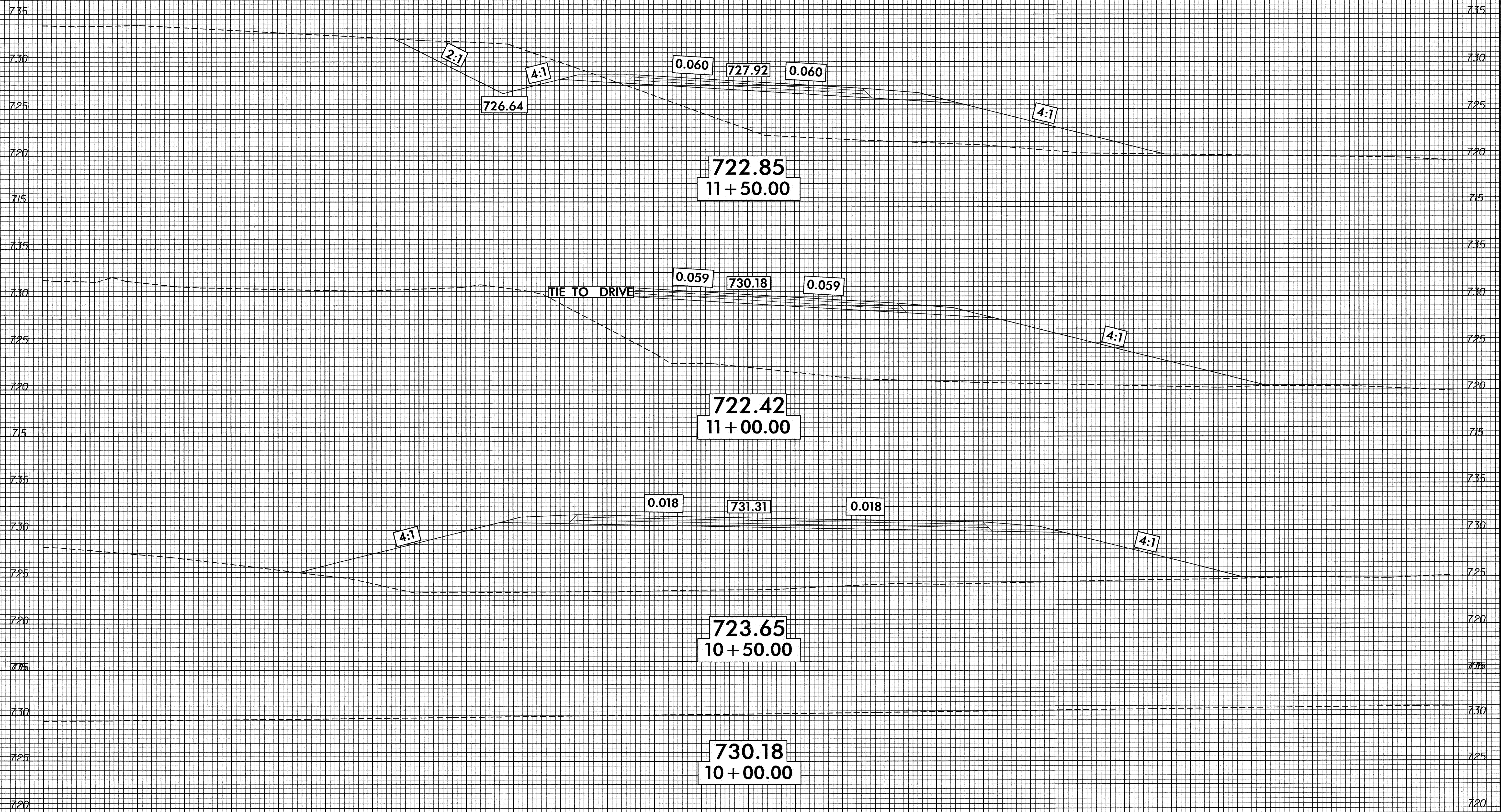

-SERVVDREV-

05-JUL-2015 13:00  
S:\00C\174750\AT\_D\3\CAD\25638  
r\_ines.dwg

8/23/99

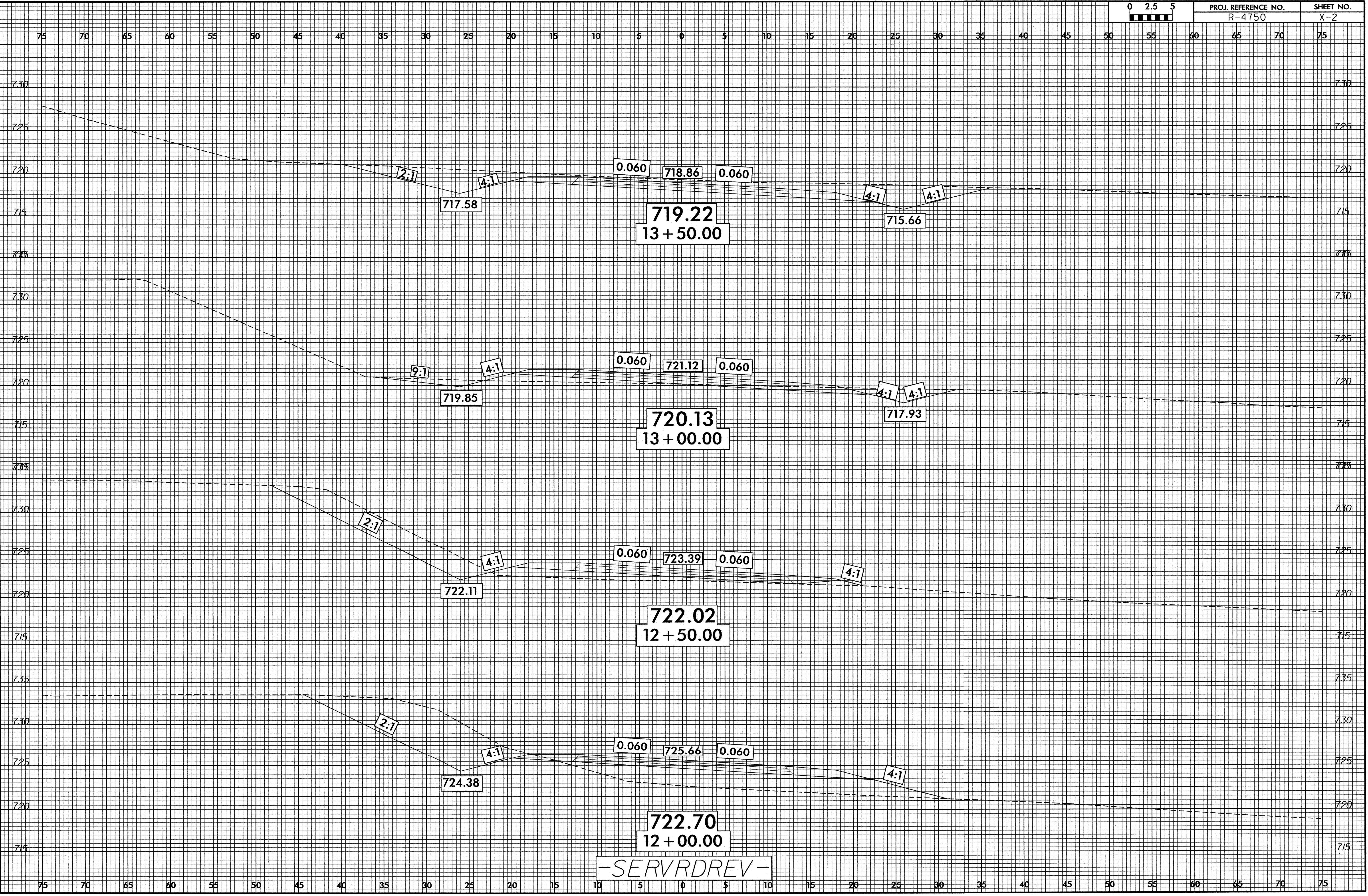

05-JUL-2013 13:08  
S:\DOC\R4750\1-4750-RSH\881-SERVDREV.dgn  
R:\line\dom

8/23/99

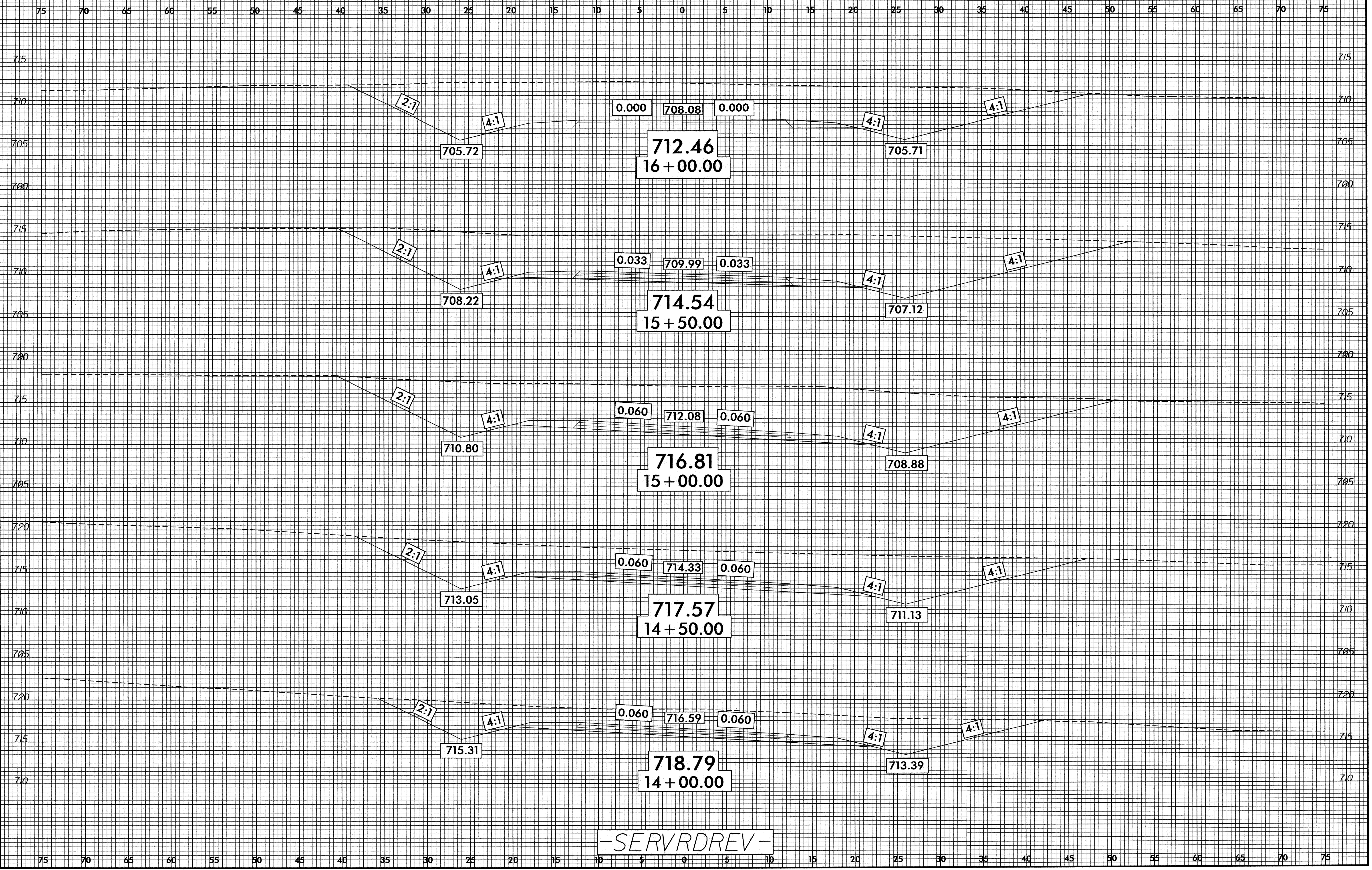

-SERVRDREV-

05-JUL-2013 13:07  
S:\00C\R4750\14-4750\_Roadway\SERVRDREV.dgn  
r:\esdham

8/23/99

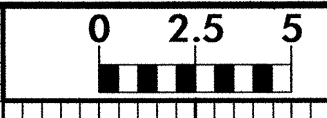

PROJ. REFERENCE NO.	SHEET NO.
R-4750	X-4

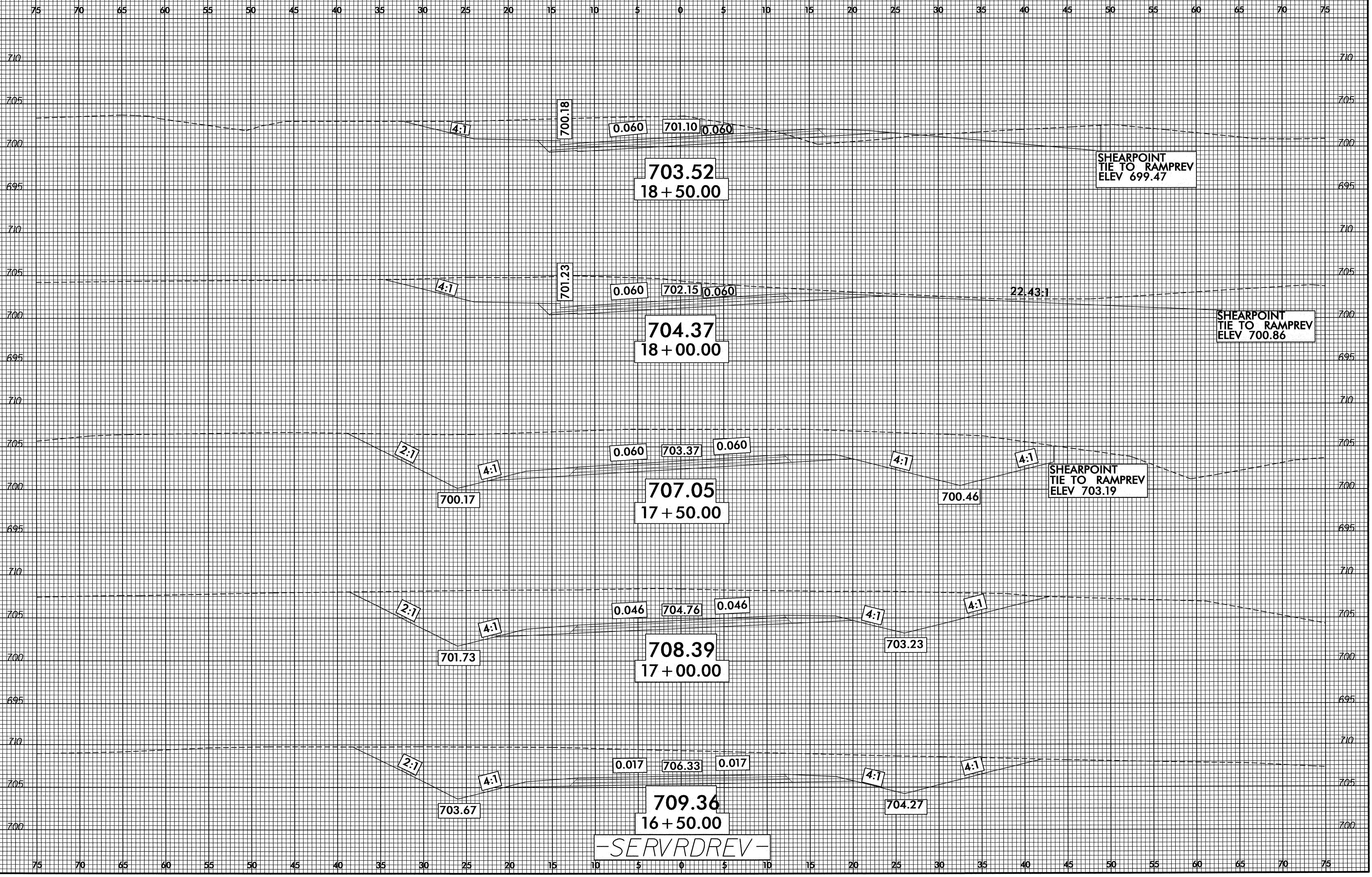

-SERVRDREV-

05-JUL-2013 13:06 S:\DDC\R4750\A1-D9CAD288638\_SERRDREV.dgn P:\medham

8/23/99

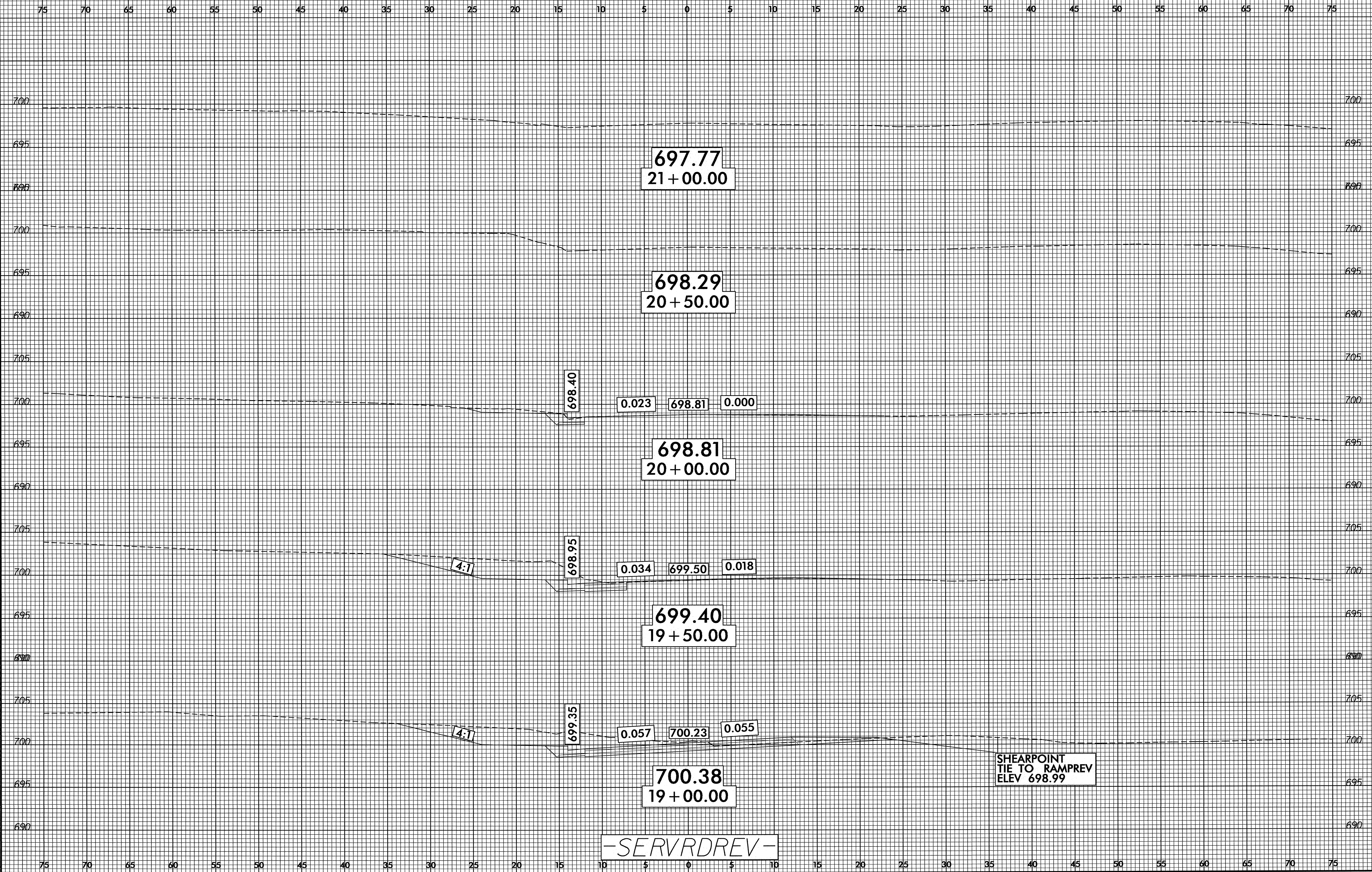

05-JUL-2013 13:05  
 S:\DDC\R4750\A1-D9\CA2238638  
 SERVRDREV.dgn  
 P:\medham

8/23/99

0 2.5 5	PROJ. REFERENCE NO.	SHEET NO.
	R-4750	X-6

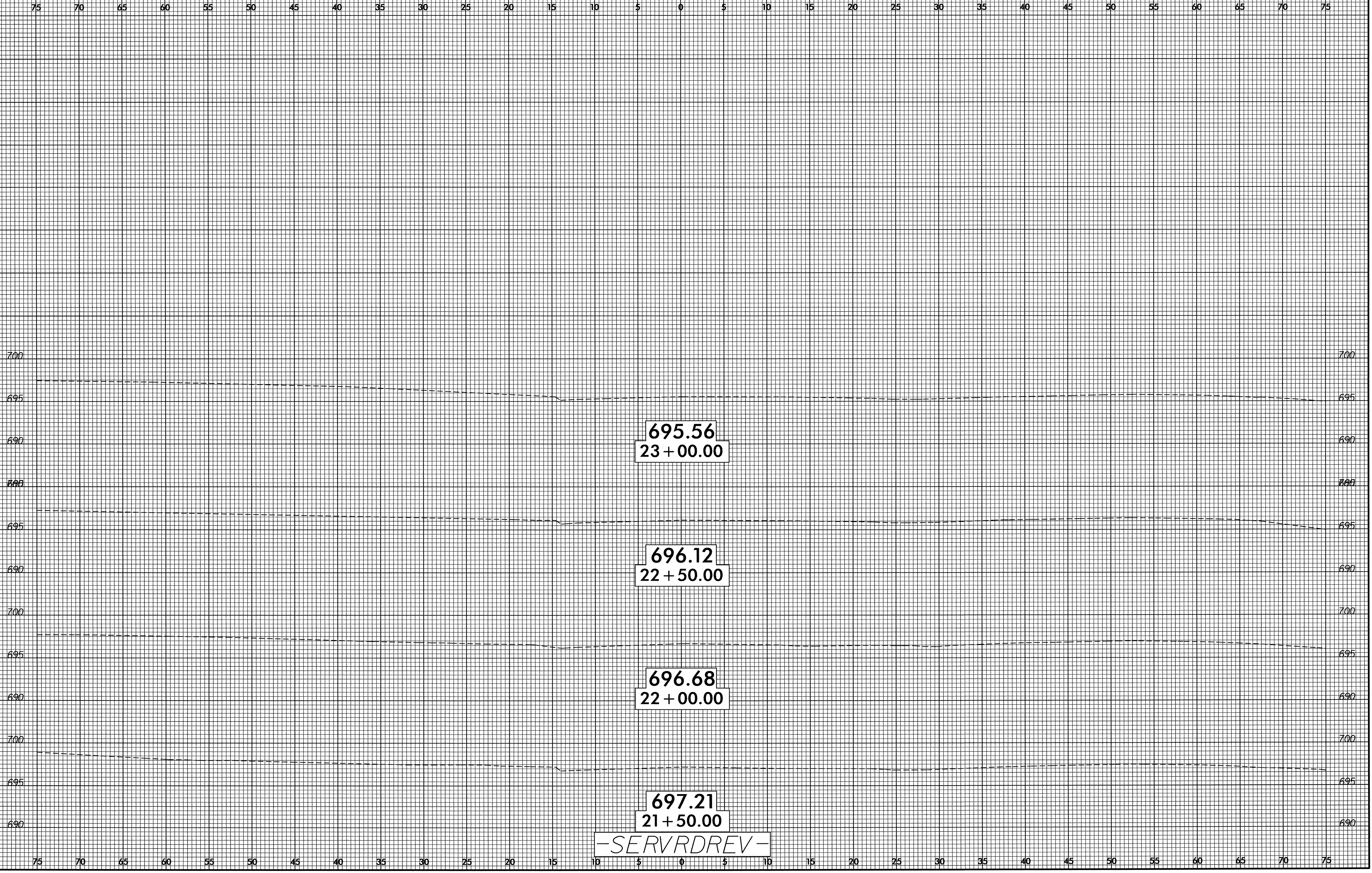

-SERVVDREV-

05-JUL-2013 13:04  
S:\DOC\14750\1-4750\_R24\281\_SERVVDREV.dgn  
P:\neecham AT D:\CAD\288838

8/23/99

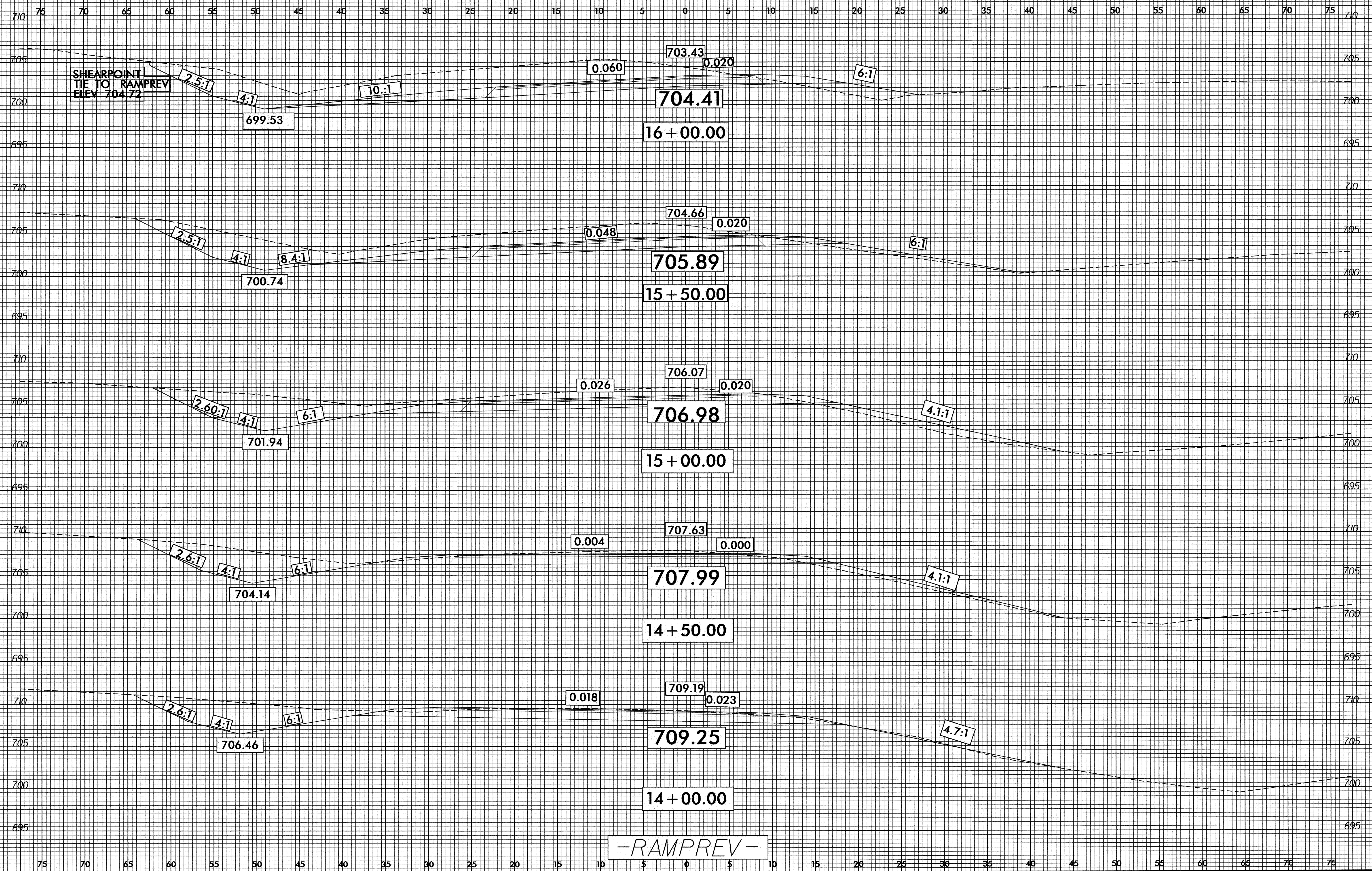

-RAMPREV-

05-JUL-2003 11:32 S:\UCR\4750\AT-D\0506238333.RAMPREV.dgn





8/23/99

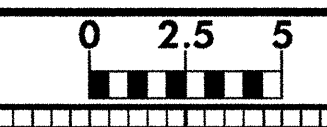

PROJ. REFERENCE NO.	SHEET NO.
R-4750	X-9

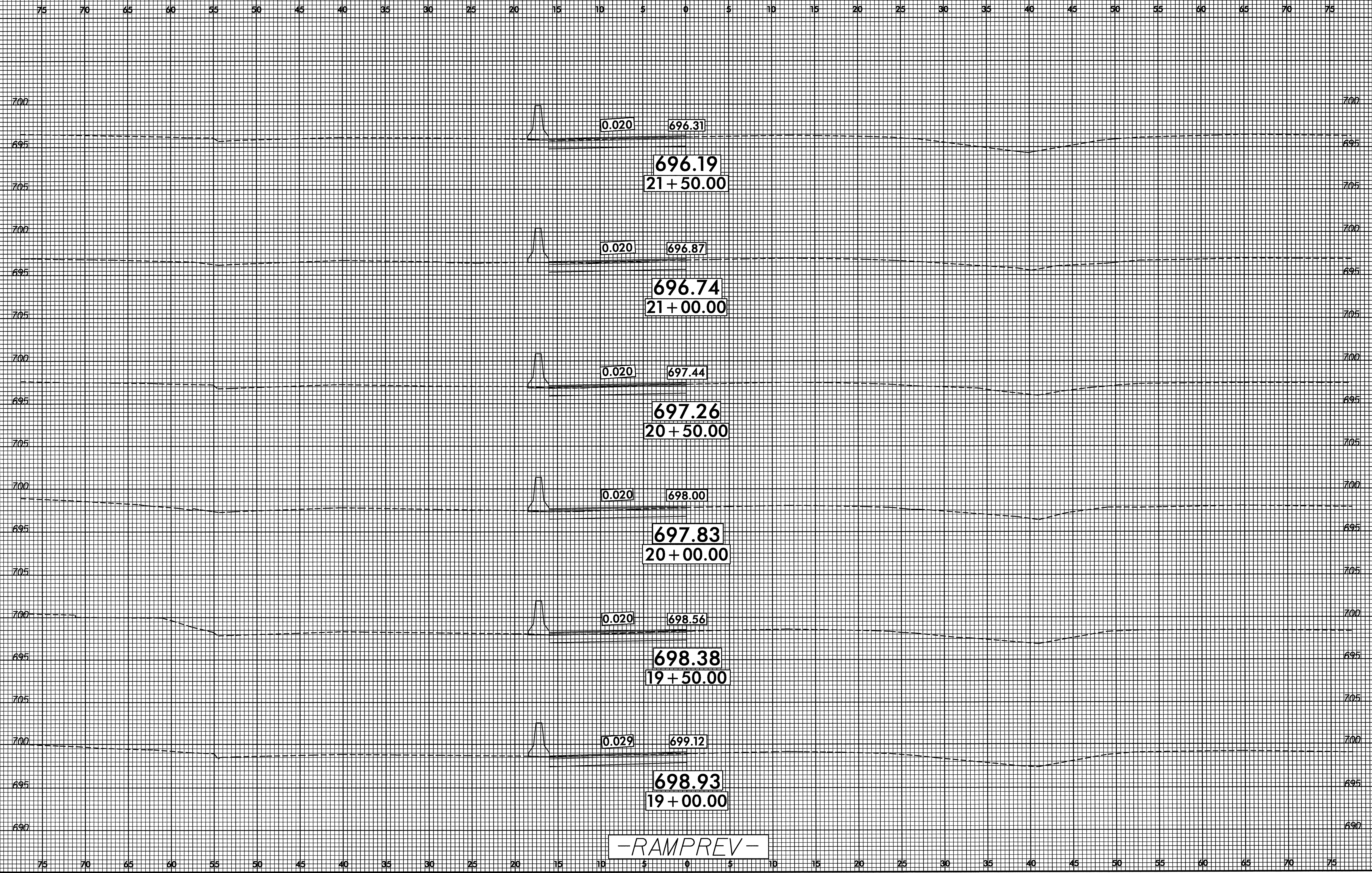

-RAMPREV-

16-JUL-2013 12:59  
 S:\DUC\AR4750\AT-DUC\0230338  
 RampREV.dgn

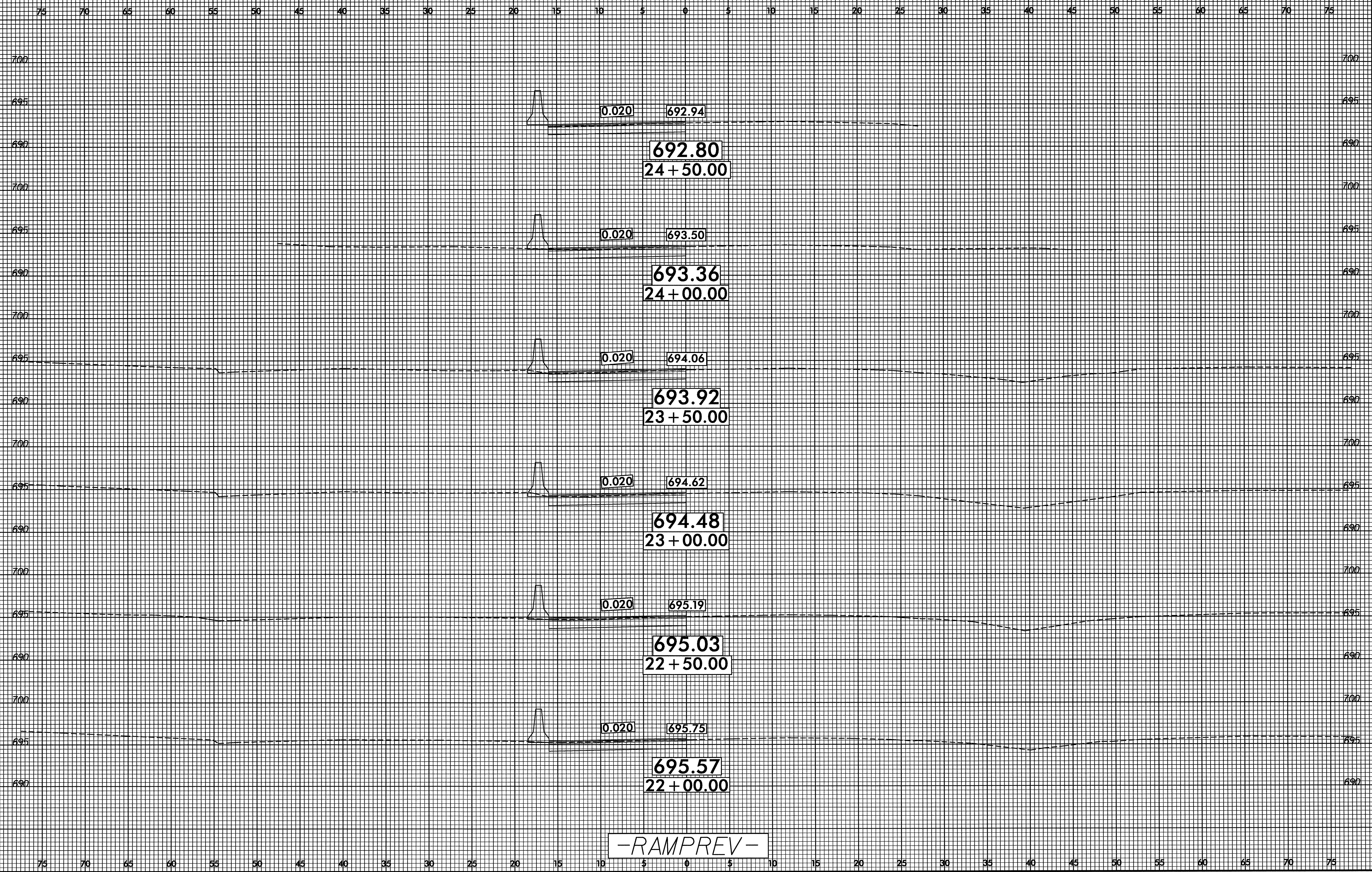

16-JUL-2013 12:31  
S:\DDC\AR4750\1-730651.dwg  
J:\redham

8/23/99

75 70 65 60 55 50 45 40 35 30 25 20 15 10 5 0 5 10 15 20 25 30 35 40 45 50 55 60 65 70 75

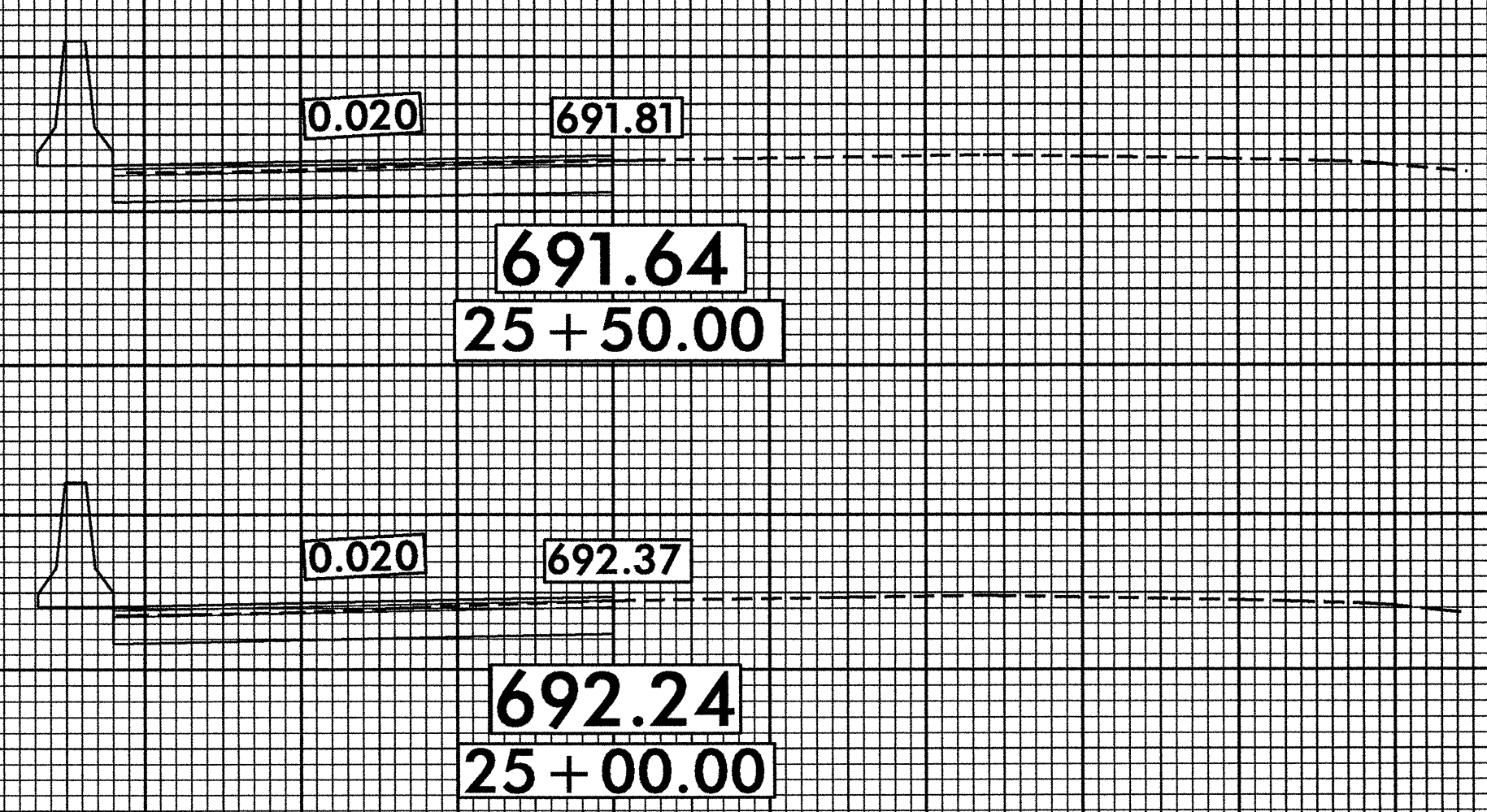

-RAMPREV-

700  
695  
690  
700  
695  
690  
685

700  
695  
690  
700  
695  
690  
685

75 70 65 60 55 50 45 40 35 30 25 20 15 10 5 0 5 10 15 20 25 30 35 40 45 50 55 60 65 70 75

8/23/99

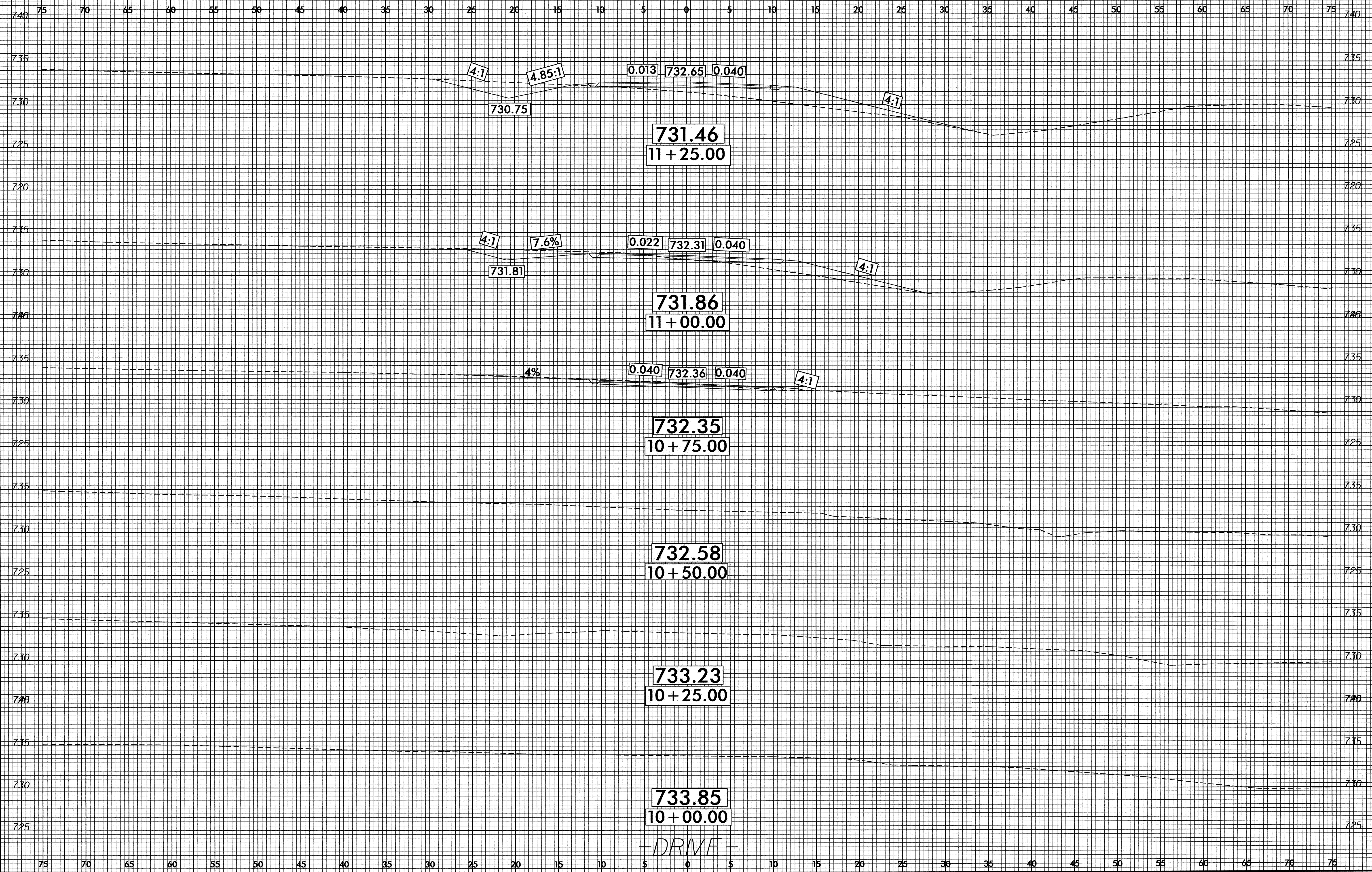

05-JUL-2013 13:25  
S:\DOC\R4750\1-1750\108888.dgn  
jmecham

8/23/98

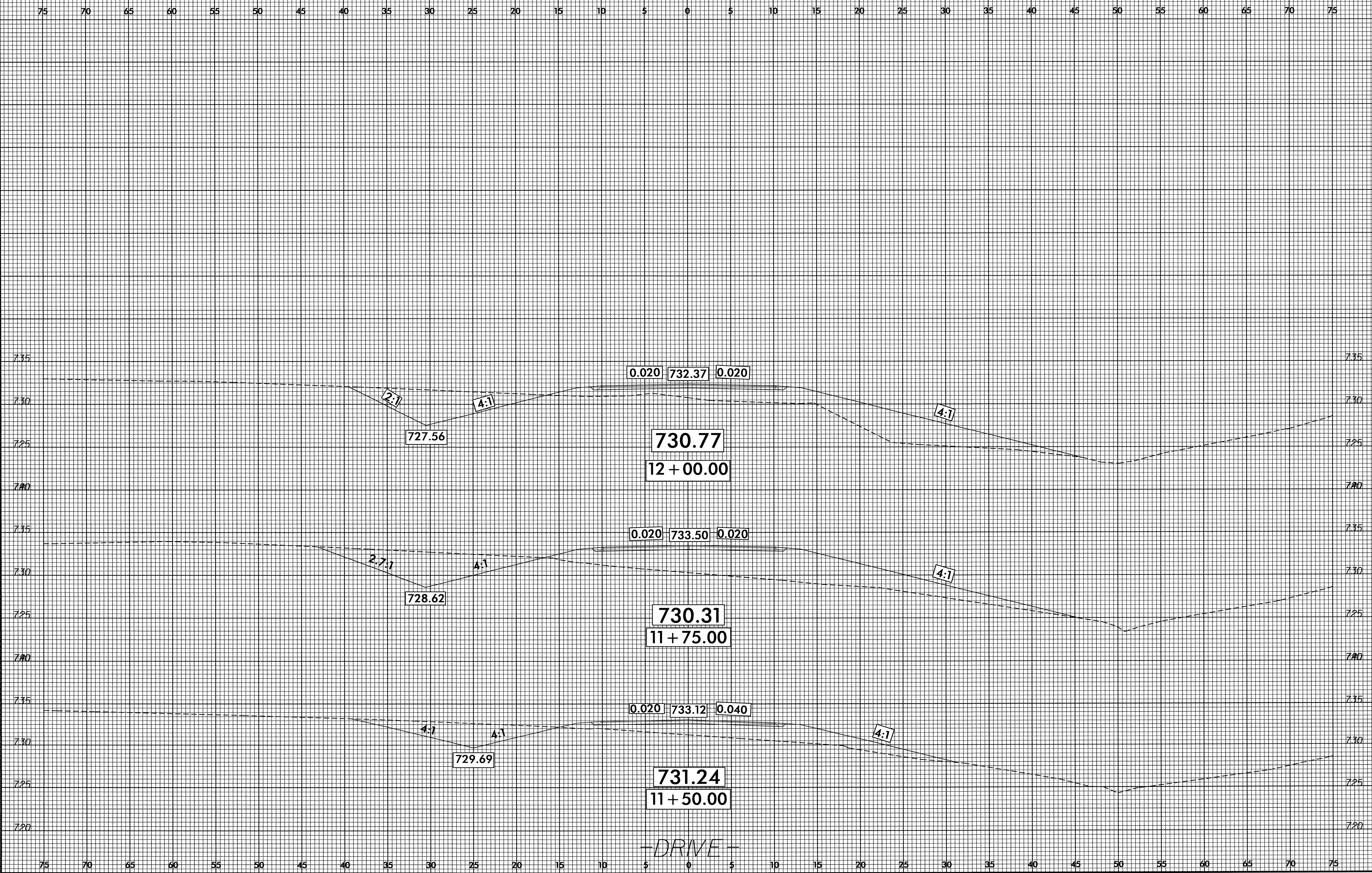

—DRIVE—

05-JUL-2013 13:24  
S:\DOC\R4750\11-4750\_894883.DRIVE.dgn  
r:\medham