

0041DEL_P10a1

CONTRACT: C203206 T.I.P.: P-5208G

**STATE OF NORTH CAROLINA
DEPARTMENT OF TRANSPORTATION**



TIP NO. P-5208G	SHEET NO. PMP-1
APPROVED: <i>Neil J. Dean</i>	
DATE: 01 May 2013	

**PAVEMENT MARKING PLAN
CABARRUS AND
MECKLENBURG COUNTIES**

INDEX

SHEET NO.	DESCRIPTION
PMP-1	PAVEMENT MARKING PLAN TITLE
PMP-2	DETAILS TO USE IN LIEU OF STANDARDS
PMP-3	CROSSWALK AND STOP BAR PAVEMENT MARKING DETAIL
PMP-4	PAVEMENT MARKING DETAILS

GENERAL NOTES

THE FOLLOWING GENERAL NOTES APPLY AT ALL TIMES FOR THE DURATION OF THE CONSTRUCTION PROJECT, EXCEPT WHEN OTHERWISE NOTED IN THE PLAN, OR DIRECTED BY THE ENGINEER.

- A) INSTALL PAVEMENT MARKINGS AND PAVEMENT MARKERS ON THE FINAL SURFACE AS FOLLOWS:
- | ROAD NAME | MARKING | MARKER |
|------------------------|---------------|--------|
| BACK CREEK CHURCH ROAD | THERMOPLASTIC | NONE |
| MCLEAN ROAD | THERMOPLASTIC | NONE |
| ORR STREET | THERMOPLASTIC | NONE |
- B) TIE PROPOSED PAVEMENT MARKING LINES TO EXISTING PAVEMENT MARKING LINES.
- C) REMOVE/REPLACE ANY CONFLICTING/DAMAGED PAVEMENT MARKINGS AND MARKERS.
- E) LOCATE THE RAIL ROAD CROSSING STOPBAR IN COMPLIANCE WITH ROADWAY STANDARD DRAWING 1205.11, SHEET 1 OF 4. CONFIRM ALL REVISIONS WITH THE ENGINEER PRIOR TO PLACING ANY PAVEMENT MARKINGS.

ROADWAY STANDARD DRAWING

THE FOLLOWING ROADWAY STANDARDS AS APPEAR IN "ROADWAY STANDARD DRAWINGS" - PROJECT SERVICES UNIT - N.C. DEPARTMENT OF TRANSPORTATION - RALEIGH, N.C., DATED JANUARY 2012 ARE APPLICABLE TO THIS PROJECT AND BY REFERENCE HEREBY ARE CONSIDERED A PART OF THESE PLANS:

STD. NO.	TITLE
1205.01	PAVEMENT MARKINGS - LINE TYPES AND OFFSETS
1205.02	PAVEMENT MARKINGS - TWO-LANE AND MULTILANE ROADWAYS
1205.04	PAVEMENT MARKINGS - INTERSECTIONS
1205.05	PAVEMENT MARKINGS - TURN LANES
1205.07	PAVEMENT MARKINGS - PEDESTRIAN CROSSWALKS
1205.08	PAVEMENT MARKINGS - SYMBOLS AND WORD MESSAGES
1205.11	PAVEMENT MARKINGS - RAILROAD CROSSINGS
1264.01	OBJECT MARKERS - TYPES
1264.02	OBJECT MARKERS - INSTALLATION

**FINAL PAVEMENT
MARKING SCHEDULE**

SYMBOL	DESCRIPTION
THERMOPLASTIC (16", 120 MILS)	
T1	WHITE LINE, RR X
THERMOPLASTIC (24", 120 MILS)	
T2	WHITE STOPBAR
T3	WHITE CROSSWALK LINE
THERMOPLASTIC (4", 120 MILS)	
T9	2 FT.-6 FT. YELLOW MINI-SKIP
TD	3 FT.-9 FT. WHITE MINI-SKIP
TE	WHITE SOLID LANE LINE
TH	YELLOW SINGLE CENTER
TI	YELLOW DOUBLE CENTER
THERMOPLASTIC (4", 90 MILS)	
TA	WHITE EDGELINE
THERMOPLASTIC (8", 90 MILS)	
TP	YELLOW DIAGONAL
THERMOPLASTIC PAVEMENT MARKING CHARACTER (120 MILS)	
UI	ALPHANUMERIC CHARACTER
THERMOPLASTIC PAVEMENT MARKING SYMBOLS (90 MILS)	
UA	LEFT TURN ARROW
UE	COMBINATION STRAIGHT/RIGHT ARROW

PLAN REVIEWED BY: N.C.D.O.T. SIGNING AND DELINEATION UNIT

<u>Kelvin Jordan</u>	SIGNING & DELINEATION STANDARDS ENGINEER
<u>Jose Martinez</u>	SIGNING & DELINEATION PROJECT DESIGN ENGINEER

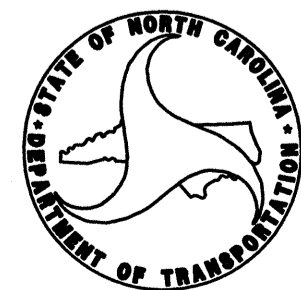

PLAN PREPARED BY

<u>Len Hill, P.E.</u>	AECOM PROJECT ENGINEER
<u>Neil J. Dean, P.E.</u>	AECOM SIGNING AND DELINEATION ENGINEER

AECOM

NC FIRM LICENSE No: F-0342
701 Corporate Center Drive, Suite 475
Raleigh, NC 27607
(919) 854-6200 - (919) 854-6259(FAX)

DCN: 0041DEL - P10a1

08-MAR-2012 12:18 S:\S&DU\Standard Drawings\Standard Drawings\8-17-11\Revised\2050803.Revised 9-14-11_Scaled.dgn AT TE24745

TIP NO. P-5208G	SHEET NO. PMP -2
APPROVED: <i>RWF</i>	DATE: 3/8/12
SEAL	
	

STATE OF NORTH CAROLINA
DEPT. OF TRANSPORTATION
DIVISION OF HIGHWAYS
RALEIGH, N.C.

ENGLISH DETAIL DRAWING FOR
PAVEMENT MARKINGS
SYMBOLS AND WORD MESSAGES

SHEET 3 OF 8
1205D08

MULTI-LANE WIDTH "SCHOOL"

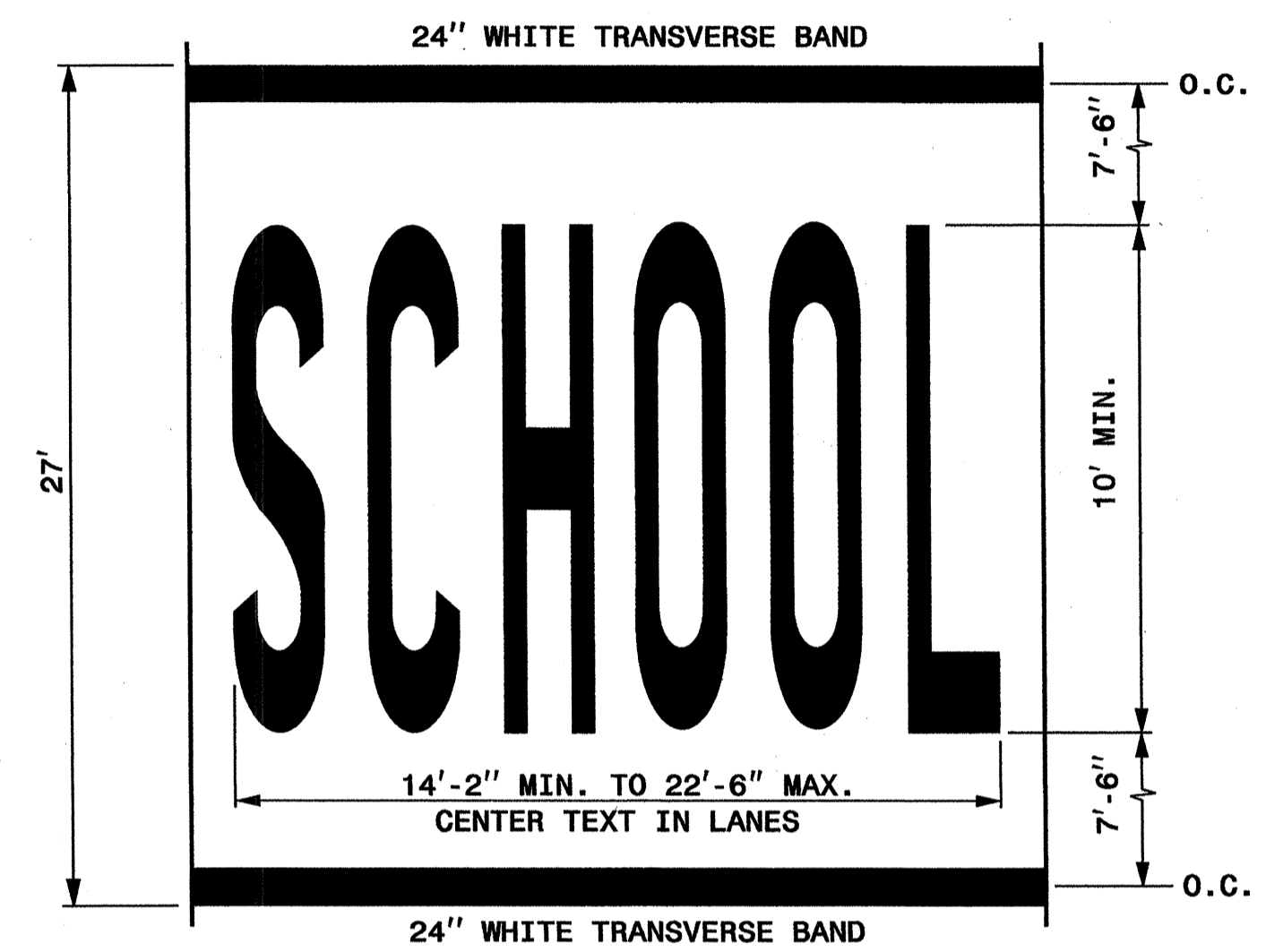

LETTER HEIGHT = 10' MIN.
LETTER WIDTH = 20"
SPACING = 10" MIN./30" MAX. (USE EQUAL SPACING BETWEEN LETTERS)
NOTE: THE TWO-LANE PAVEMENT MARKING DIMENSIONS OF "SCHOOL" SHOWN IN PART 7 OF THE MUTCD MAY ALSO BE USED.

SINGLE LANE WIDTH "SCHOOL"

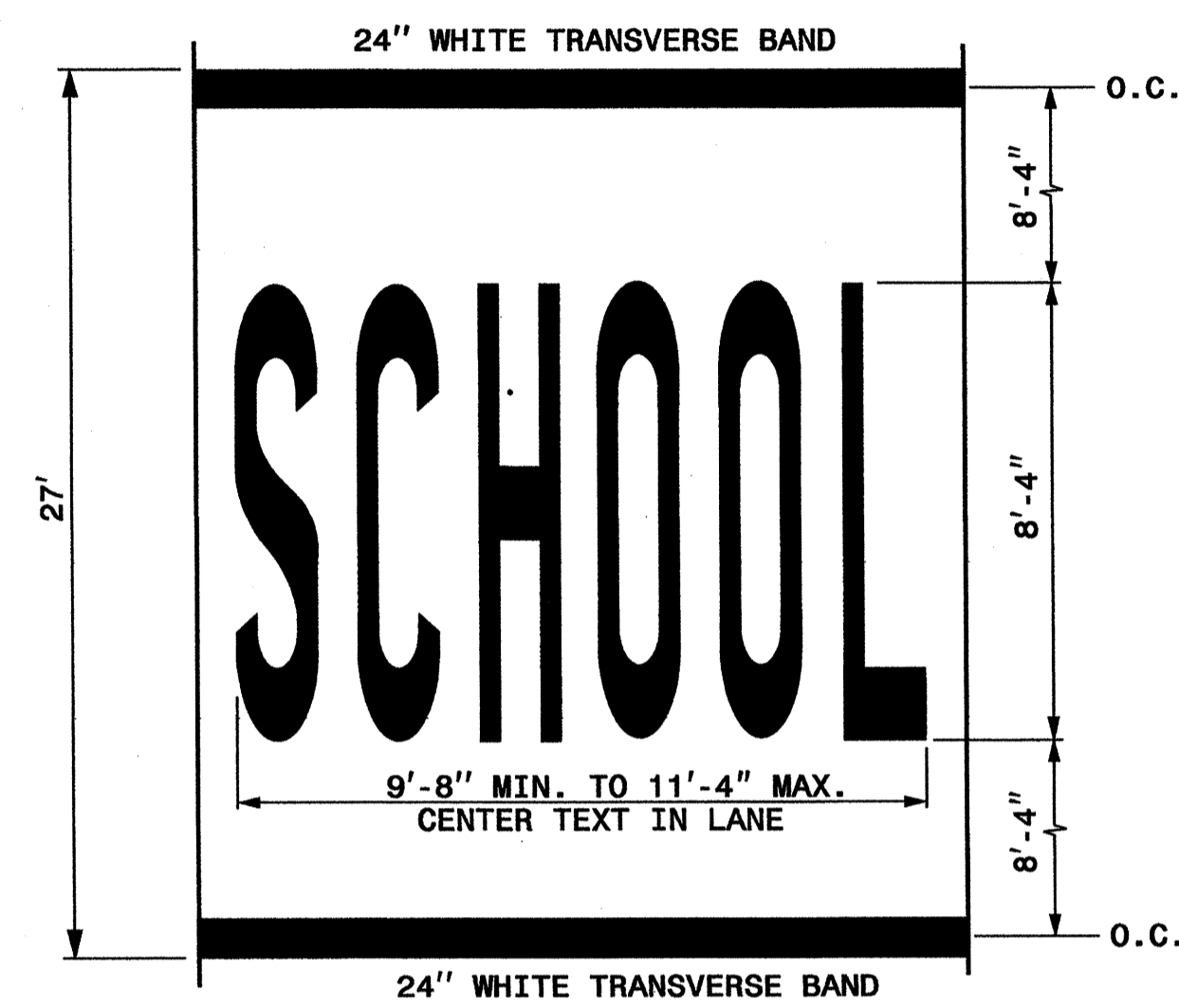

LETTER HEIGHT = 8'-4"
LETTER WIDTH = 16"
SPACING = 4" MIN./8" MAX. (USE EQUAL SPACING BETWEEN LETTERS)

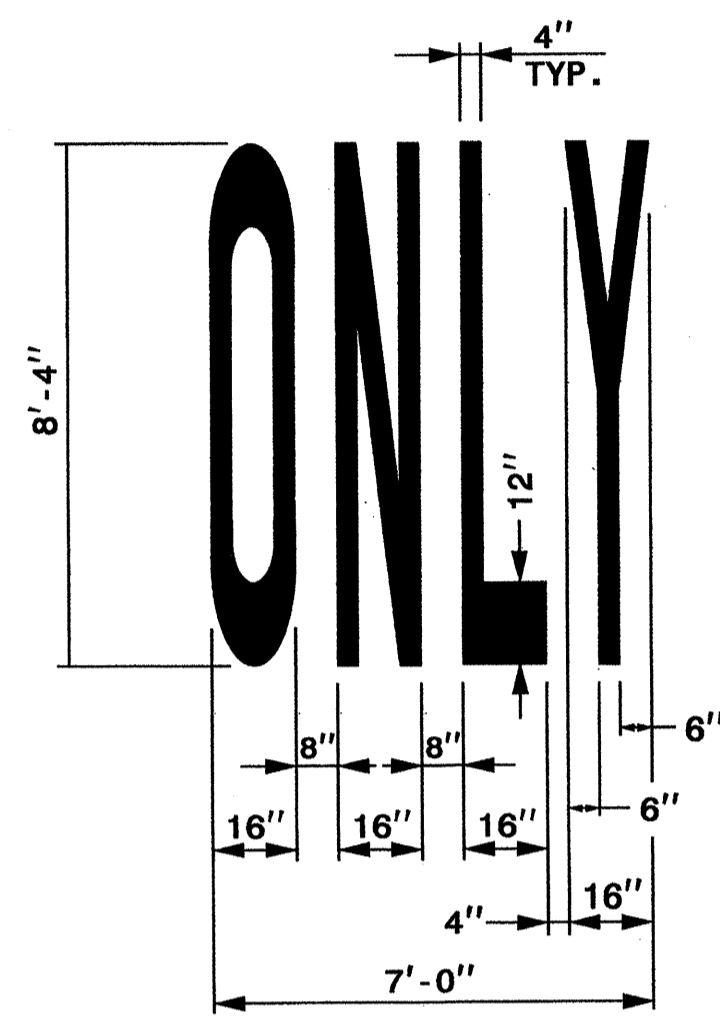

RAILROAD RXR SYMBOL

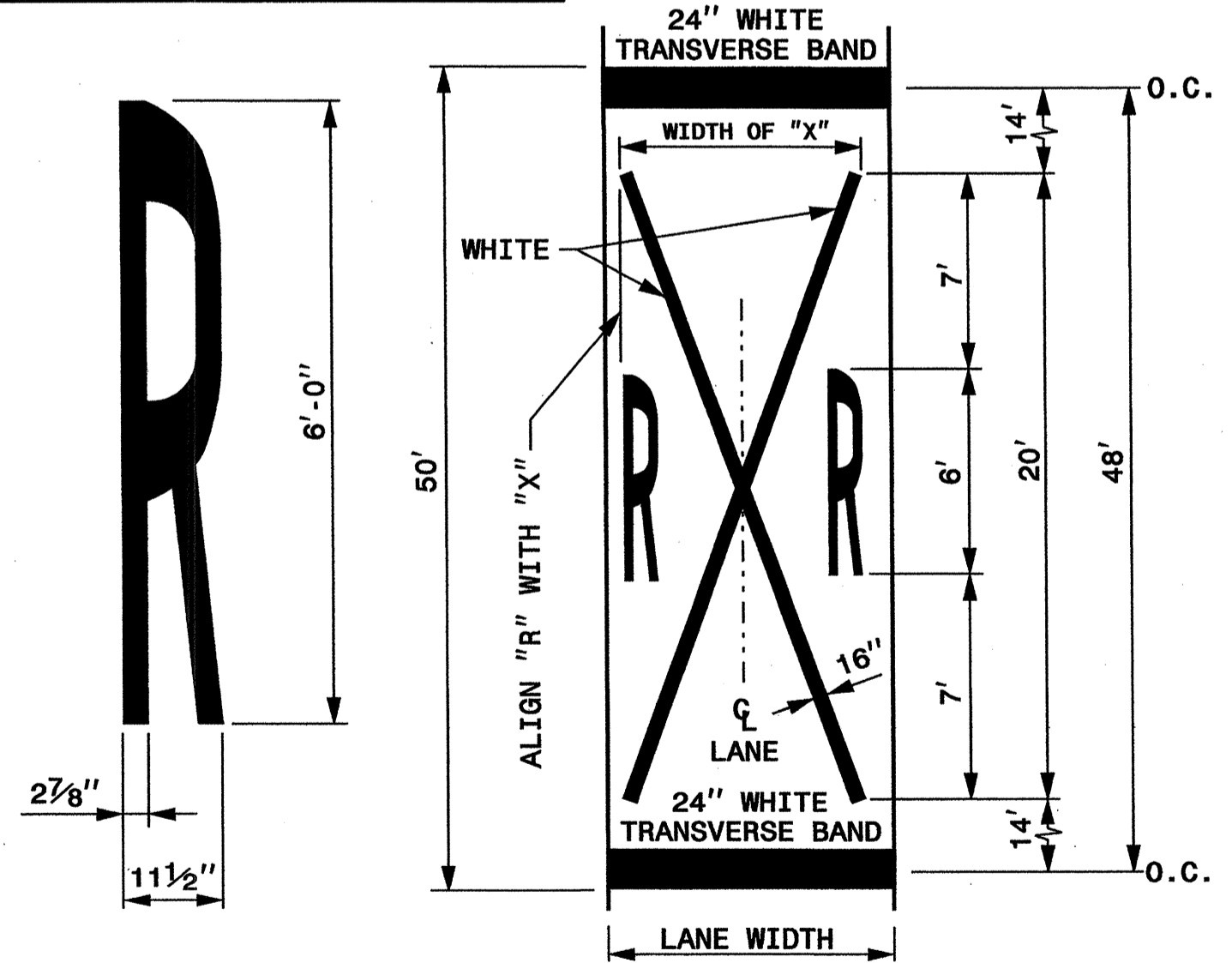

LANE WIDTH (FEET)	WIDTH OF "X" (FEET)
8' ≤ W ≤ 9'	7'
9' < W ≤ 12'	8'
W > 12'	10'

GENERAL NOTES:

- 1- THE SCHOOL PAVEMENT MARKING CONSISTS OF SIX (6) CHARACTERS. THE TWO (2) 24" TRANSVERSE BANDS WILL BE PAID FOR UNDER A SEPARATE PAY ITEM. REFER TO ROADWAY STANDARD DRAWING 1205.10 FOR ADDITIONAL PAVEMENT MARKING GUIDANCE.
- 2- PAVEMENT MARKING IN ADVANCE OF A HIGHWAY-RAIL CROSSING SHALL CONSIST OF TWO (2) CHARACTERS AND TWO (2) 16" LINES (FORMING AN X) WHICH ARE PAID FOR UNDER TWO SEPARATE PAY ITEMS. THE TWO (2) 24" TRANSVERSE BANDS WILL BE PAID FOR UNDER A SEPARATE PAY ITEM. REFER TO ROADWAY STANDARD DRAWING 1205.11 FOR ADDITIONAL PAVEMENT MARKING GUIDANCE.

STATE OF NORTH CAROLINA
DEPT. OF TRANSPORTATION
DIVISION OF HIGHWAYS
RALEIGH, N.C.

ENGLISH DETAIL DRAWING FOR
PAVEMENT MARKINGS
SYMBOLS AND WORD MESSAGES

SHEET 3 OF 8
1205D08

**REVISED PAVEMENT MARKING
ROADWAY STANDARD DRAWING**



TIP NO. P-5208G	SHEET NO. PMP-3
APPROVED: <i>[Signature]</i>	
DATE: 4/10/2013	
SEAL	

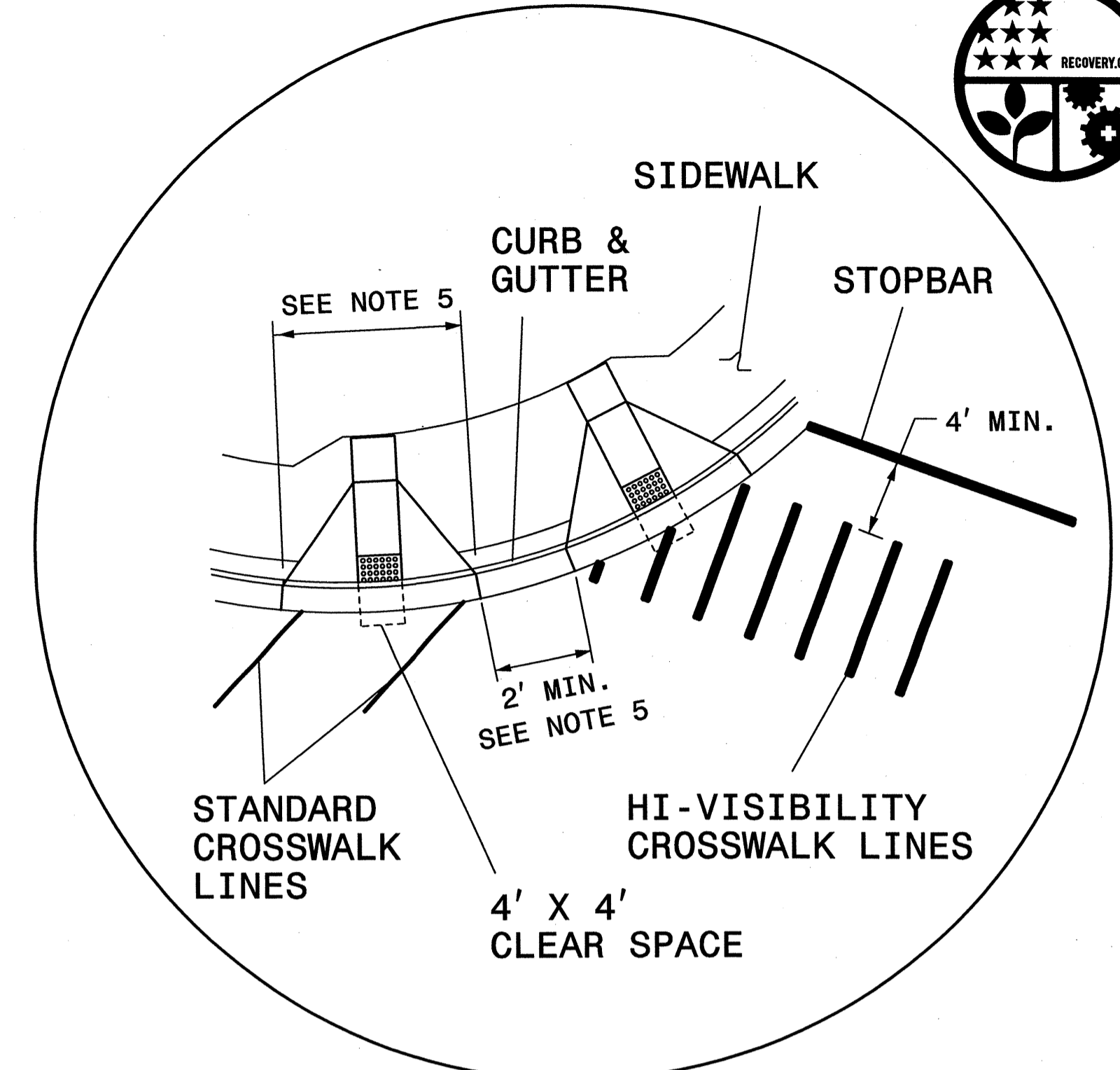
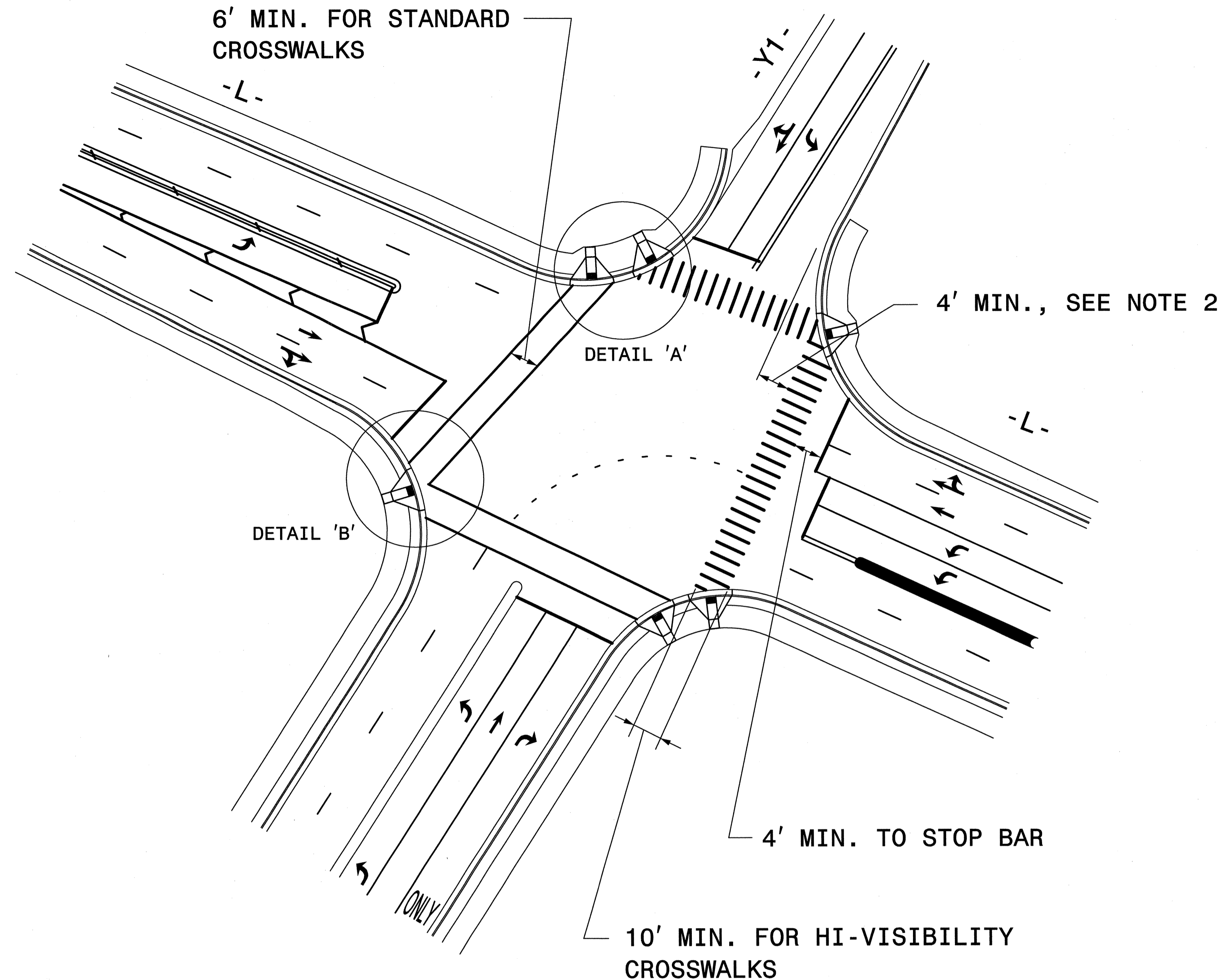
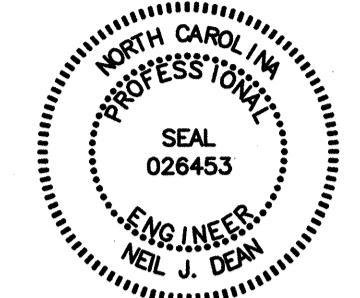

DETAIL 'A'- DUAL CURB RAMPS

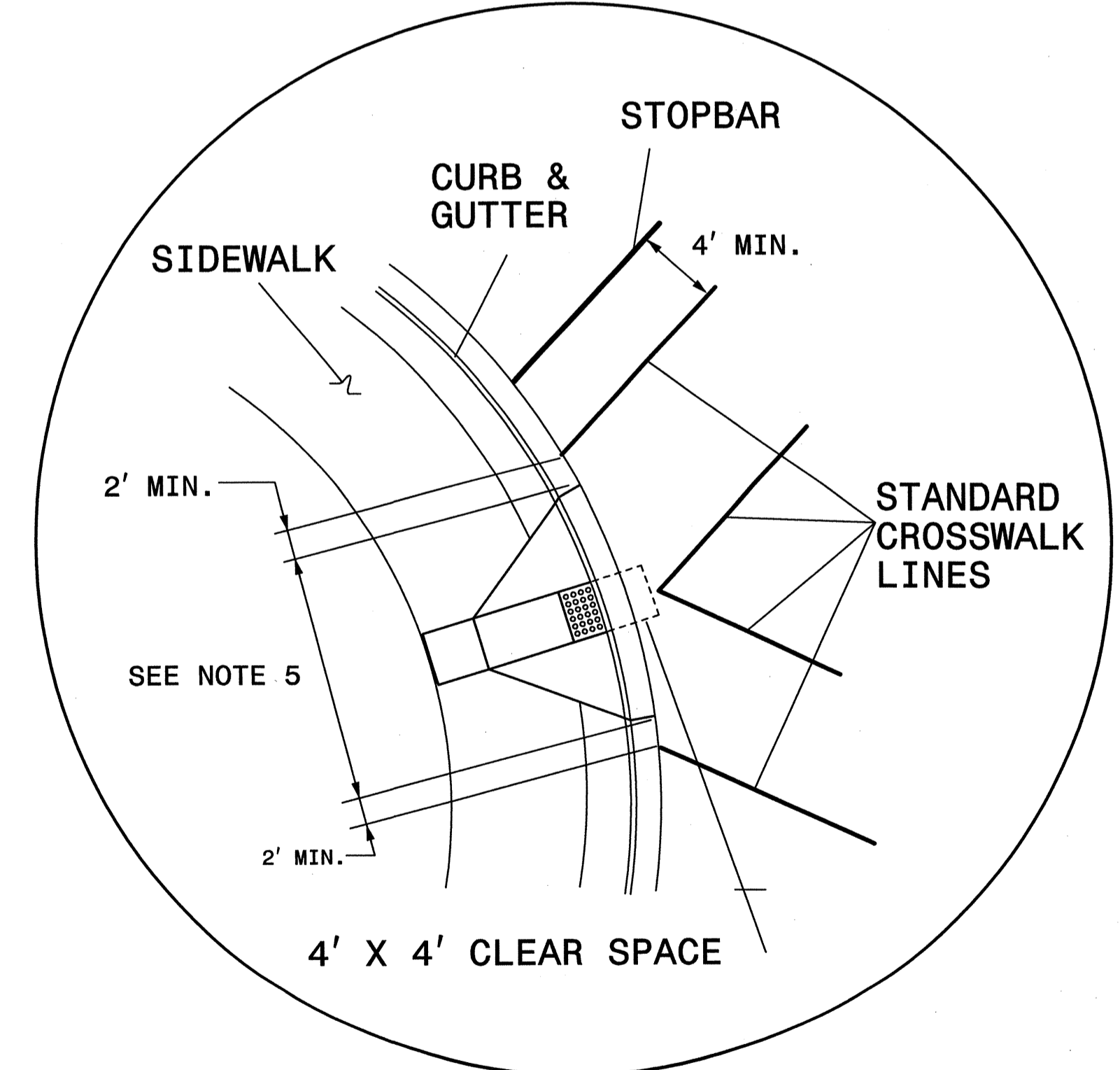

DETAIL 'B'- SINGLE DIAGONAL CURB RAMP

GUIDANCE DETAIL FOR STANDARD AND HI-VISIBILITY CROSSWALKS AT SIGNALIZED OR STOP SIGN CONTROLLED INTERSECTIONS

NOTES:

1. USE DETAILS ABOVE AND THE FOLLOWING NOTES FOR GUIDANCE IN PLACING CROSSWALKS AND STOP BARS NOT STATIONED ON THE DETAIL SHEETS OR WHEN FIELD ADJUSTMENTS REQUIRED MOVING STATIONED MARKINGS AS DIRECTED BY THE ENGINEER. REFER TO NCDOT ROADWAY STANDARD DRAWINGS, MUTCD AND ADA STANDARDS FOR ADDITIONAL GUIDANCE.
2. SET BACK DISTANCE FROM INSIDE CROSSWALK MARKING TO NEAREST EDGE OF TRAVEL IS 4' MIN.
3. BEYOND THE BOTTOM GRADE BRAKE, A CLEAR SPACE OF 4' X 4' MINIMUM SHALL BE PROVIDED WITHIN THE WIDTH OF THE CROSSWALK.
4. SINGLE DIAGONAL CURB RAMPS WITH FLARED SIDES SHALL HAVE A SEGMENT OF CURB 2 FEET LONG MINIMUM LOCATED ON EACH SIDE OF THE CURB RAMP AND WITHIN THE MARKED CROSSING, SEE DETAIL 'B'.
5. CURB RAMPS SHALL BE CONSTRUCTED IN ACCORDANCE TO THE LATEST NCDOT ROADWAY STANDARD DRAWINGS.

Prepared in the Office of: **AECOM** NC FIRM LICENSE No: F-0342
701 Corporate Center Drive, Suite 475
Raleigh, NC 27607
(919) 854-6200 - (919) 854-6259(FAX)

CROSSWALK AND STOP BAR PAVEMENT MARKING DETAIL



TIP NO. P-5208G	SHEET NO. PMP-4
APPROVED: <i>[Signature]</i>	
DATE: 5/29/2013	
SEAL	

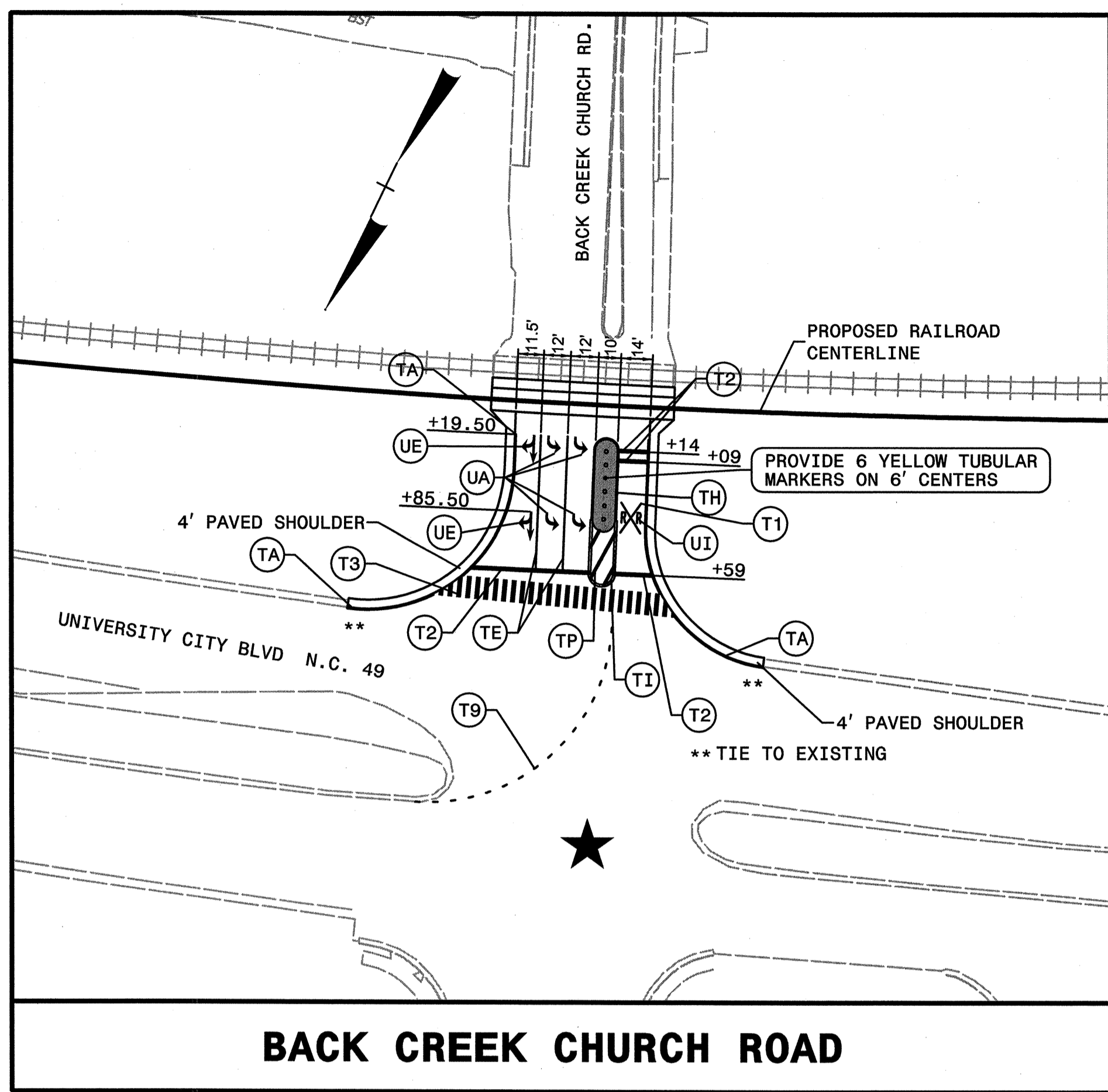

BACK CREEK CHURCH ROAD

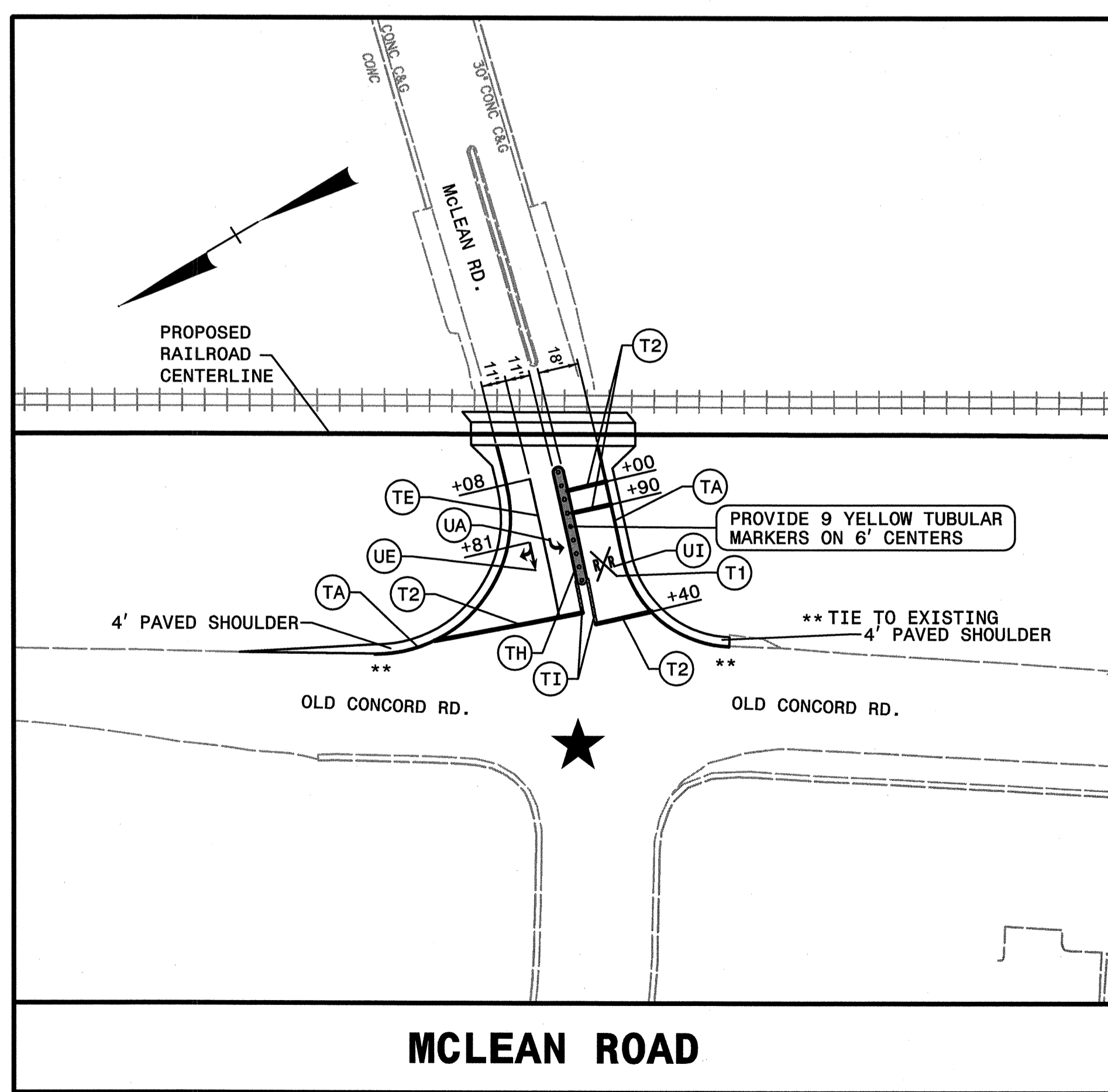

MCLEAN ROAD

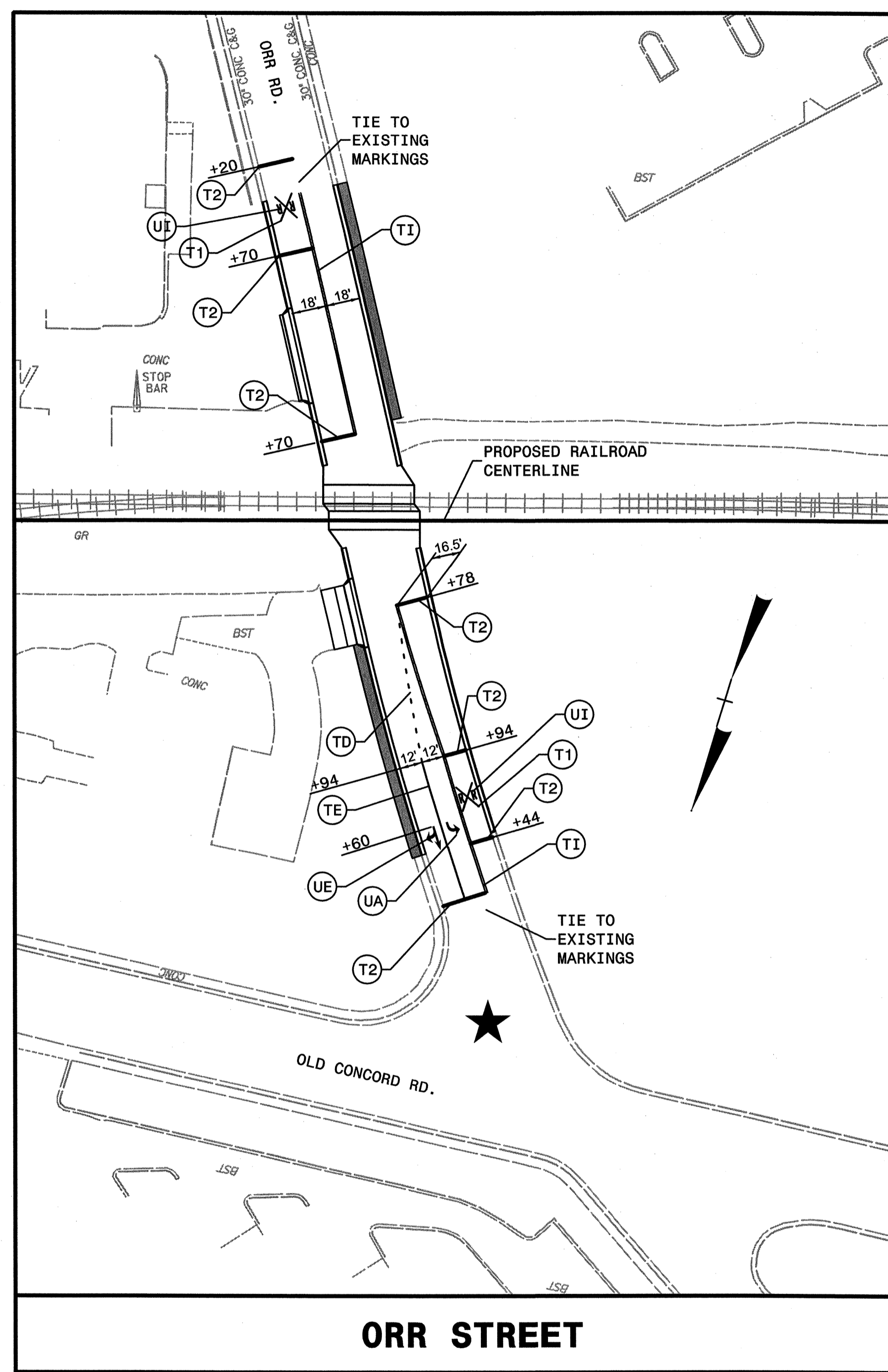

ORR STREET

- INSTALL TYPE 4 OBJECT MARKERS AT THE FOLLOWING CROSSING CLOSURES:
- 1) 2 LOCATIONS ON -Y8- (MILLBROOK ROAD) - SEE PSH 4
 - 2) 2 LOCATIONS ON -Y9- (PRIVATE ROAD) - SEE PSH 5
 - 3) 2 LOCATIONS ON -Y10- (PRIVATE ROAD) - SEE PSH 7
 - 4) 2 LOCATIONS ON -Y11- (PRIVATE ROAD) - SEE PSH 8

THE LOCATION OF STOP BARS AND CROSSWALKS AT SIGNALIZED INTERSECTIONS IS APPROXIMATE. NOTE THE LOCATION OF THESE MARKINGS AND PROVIDE NEW MARKINGS IN THE EXISTING LOCATION, OR AS DIRECTED BY THE ENGINEER.

★ **SIGNALIZED INTERSESECTION**

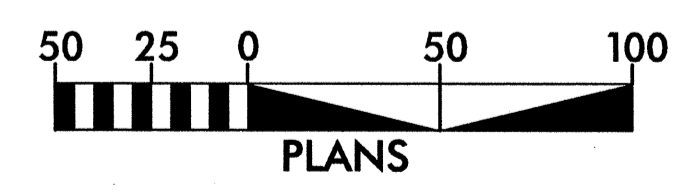

Prepared in the Office of: **AECOM** NC FIRM LICENSE No: F-0342
701 Corporate Center Drive, Suite 475
Raleigh, NC 27607
(919) 854-6200 - (919) 854-6259(FAX)

PAVEMENT MARKING DETAILS