

0248DEL_P10C1

HNTB HNTB NORTH CAROLINA, P.C.
343 E. Six Forks Road, Suite 200
Raleigh, North Carolina 27609
NC License No: C-1554

PROJECT REFERENCE NO. SHEET NO.
C-4901A CP-01

DATE: MARCH 12, 2013

RAILROAD DESIGN ENGINEER

NOT IN CONTRACT

THESE PLANS ARE PROVIDED TO THE NCDOT CONTRACTOR TO PROVIDE CONTEXT FOR COORDINATION WITH NORFOLK SOUTHERN AND ITS CONTRACTOR.

← TO GREENSBORO

TO CHARLOTTE →

← TO CP "VARNER" (MP 303.5)

TO CP "MAYBELLE" (MP 319.4) →

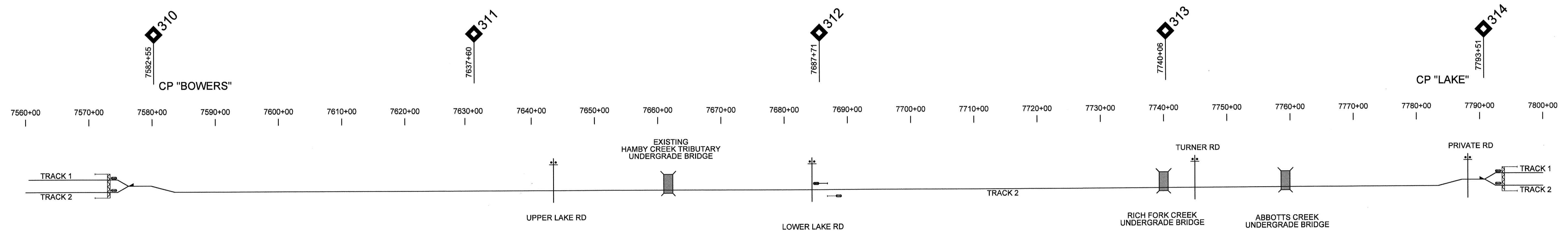

LEGEND

EXISTING	EXISTING (BEING REMOVED)	PROPOSED (UNDER CONSTRUCTION)	
			TRACK
			TURNOUT
			GRADE CROSSING
			RAILROAD SIGNALS (MAST OR BRIDGE)
			BRIDGE (OVERHEAD OR UNDERGRADE)

11:49:22 AM
I:\Projects\4901\ed_cp01.dgn
\$\$\$\$\$

DCN
0248DEL_P10c1
0001ADD_P10c1

REVISIONS

REVISION #1 DATED 6/6/13: PRIVATE CROSSING TO REMAIN.

9:43:16 AM
\\server1\c4901ad_cp02.dgn
C:\Users\jgibson\Documents

HNTB HNTB NORTH CAROLINA, P.C.
343 E. Six Forks Road, Suite 200
Raleigh, North Carolina 27609
NC License No. C-1554

DATE: MARCH 12, 2013

PROJECT REFERENCE NO. SHEET NO.
C-4901A CP-02

R/W SHEET NO.

RAILROAD DESIGN ENGINEER
CORBY P. YENNER
6/6/13

NOT IN CONTRACT

THESE PLANS ARE PROVIDED TO THE NCDOT CONTRACTOR TO PROVIDE CONTEXT FOR COORDINATION WITH NORFOLK SOUTHERN AND ITS CONTRACTOR.

← TO GREENSBORO

TO CHARLOTTE →

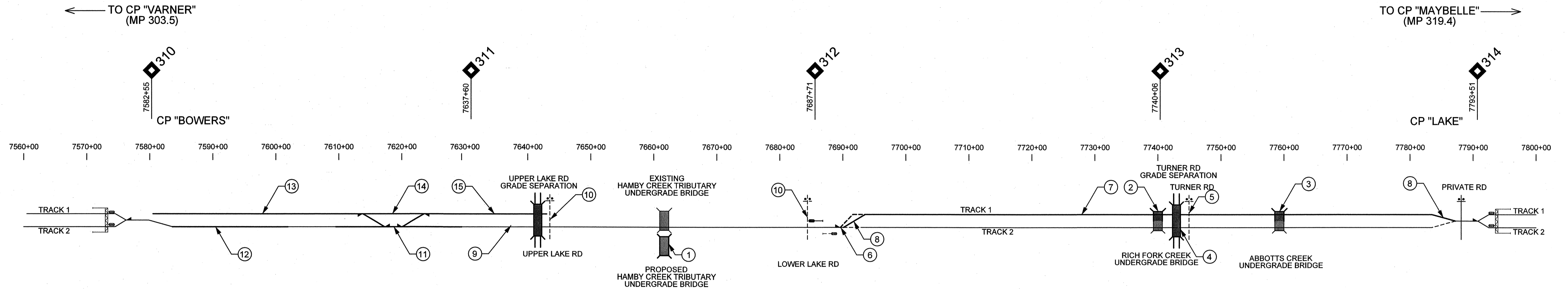

Phase 1 - Construct proposed track 1 from Lower Lake Rd to CP Lake

1. Begin construction of Hamby Creek Tributary undergrade bridge (by project C-4901A).
2. Undercut existing subgrade on Rich Fork Creek bridge (Track 1 only by project C-4901A).
3. Complete superstructure replacement of Abbotts Creek undergrade bridge (Track 1 only by project C-4901A).
4. Complete Turner Rd grade separation overpass (by project C-4901A).
5. Close and remove existing Turner Rd grade crossing.
6. Install temporary No. 10 LH turnout in track 2 at Sta. 7690+45 to provide access for southward track construction of Track 1.
7. Construct proposed track 1 from Sta. 7691+56 to Sta. 7785+30.
8. Remove temporary No. 10 LH turnout in track 2 at Sta. 7690+45 then cut and throw existing track 2 into proposed track 1 on temporary alignment 1 from Sta. 7691+56 to Sta. 7702+78. Cut and throw existing track 2 into proposed track 1 from Sta. 7785+30 to Sta. 7789+34 on temporary alignment 2.
9. Complete Upper Lake Rd grade separation overpass (by project C-4901A).
10. Close and remove existing Upper Lake Rd grade crossing and Lower Lake Rd grade crossing.
11. Construct asphalt underlayment, concrete tie track, timber tie transition track, and No. 24 turnouts; Sta. 7613+97 and Sta. 7623+38. Surface track 2 from Sta. 7609+50 to Sta. 7630+00.
12. Shift existing main track 2 from Sta. 7579+52 to Sta. 7602+70.
13. Construct proposed track 1 from Sta. 7579+11 to Sta. 7611+68.
14. Construct concrete tie track, timber tie transition track and No. 24 turnouts Sta. 7611+68 to Sta. 7625+57.
15. Construct proposed track 1 from Sta. 7625+57 to Sta. 7643+00.

At the end of this phase, trains will operate on existing main track 2 from existing CP "Bowers" to south of Lower Lake Rd and proposed main track 1 between south of Lower Lake Road and existing CP "Lake".

LEGEND

EXISTING	EXISTING (BEING REMOVED)	PROPOSED (UNDER CONSTRUCTION)	
			TRACK
			TURNOUT
			GRADE CROSSING
			RAILROAD SIGNALS (MAST OR BRIDGE)
			BRIDGE (OVERHEAD OR UNDERGRADE)

DCN
0248DEL_P10c1
0001ADD_P10c1

REVISIONS
REVISION #1 DATED 6/6/13: REVISED PHASING SO THAT CONSTRUCTION OF TRK 2 SIDE OF RICH FORK & ABBOTTS CREEK BRIDGES IS STEP 1. PRIVATE CROSSING TO REMAIN.

9:37:49 AM
\\j101\c\steeles\44901\ad_cp03.dgn
3/13/2013 9:37:49 AM

HNTB HNTB NORTH CAROLINA, P.C.
343 E. Six Forks Road, Suite 200
Raleigh, North Carolina 27609
NC License No: C-1554

DATE: MARCH 12, 2013

PROJECT REFERENCE NO. SHEET NO.
C-4901A CP-03

RW SHEET NO.

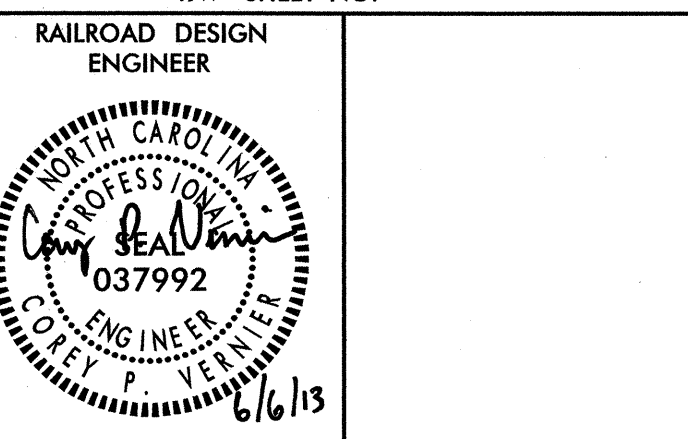

NOT IN CONTRACT

THESE PLANS ARE PROVIDED TO THE NCDOT CONTRACTOR TO PROVIDE CONTEXT FOR COORDINATION WITH NORFOLK SOUTHERN AND ITS CONTRACTOR.

← TO GREENSBORO

TO CHARLOTTE →

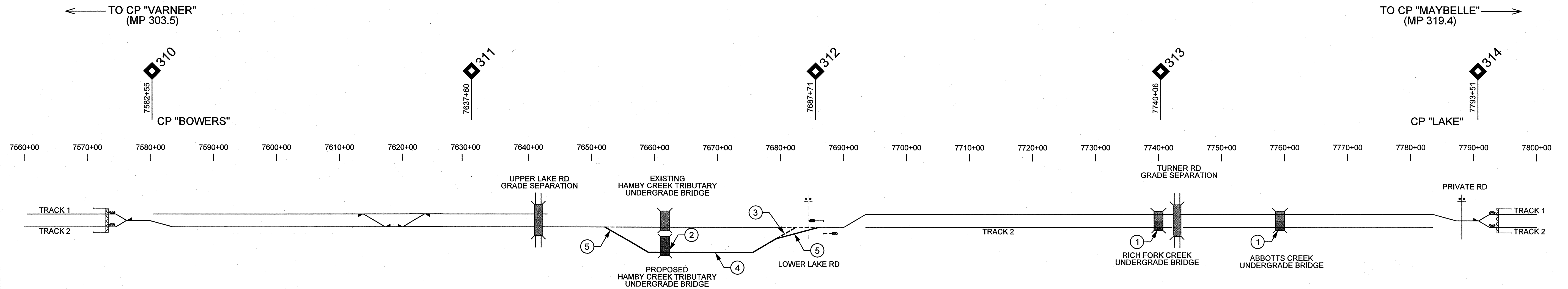

Phase 2 - Construct track 2 from Jones Creek to Upper Lake Road

1. Begin construction of track 2 side of Rich Fork Creek and Abbots Creek bridges (by project C-4901A).
2. Complete construction of Hamby Creek Tributary bridge (by project C-4901A).
3. Install temporary No. 10 LH turnout in existing track 2 at PS Sta. 7685+31 to provide access for northward track construction of proposed track 2.
4. Construct proposed main track 2 Sta. 7654+00 to Sta. 7684+71.
5. Cut and throw existing track 2 into proposed track 2 alignment Sta. 7648+83 to Sta. 7654+00. Cut and throw existing track 2 into proposed track 2 alignment Sta. 7684+71 to Sta. 7689+03 and remove temp. No. 10 LH turnout at PS Sta 7685+31.

At the end of this phase, trains will operate on existing track 2 from CP "Bowers" to south of Lower Lake Rd and proposed track 1 from south of Lower Lake Rd to CP "Lake".

LEGEND

EXISTING	EXISTING (BEING REMOVED)	PROPOSED (UNDER CONSTRUCTION)	
			TRACK
			TURNOUT
			GRADE CROSSING
			RAILROAD SIGNALS (MAST OR BRIDGE)
			BRIDGE (OVERHEAD OR UNDERGRADE)

0248DEL_P10c1
0001ADD_P10c1

REVISIONS
REVISION #1 DATED 6/6/13: UPDATED CONSTRUCTION PHASING SO THAT TRACK REMOVAL IN STEP 1 INCLUDES STA. 7759+80 TO 7775+81. PRIVATE CROSSING TO REMAIN.

9:46:16 AM
C:\projects\0248del\0001add\cp01.dgn

HNTB HNTB NORTH CAROLINA, P.C.
343 E. Six Forks Road, Suite 200
Raleigh, North Carolina 27609
NC License No: C-1554

DATE: MARCH 12, 2013

PROJECT REFERENCE NO. SHEET NO.
C-4901A CP-04

RW SHEET NO.

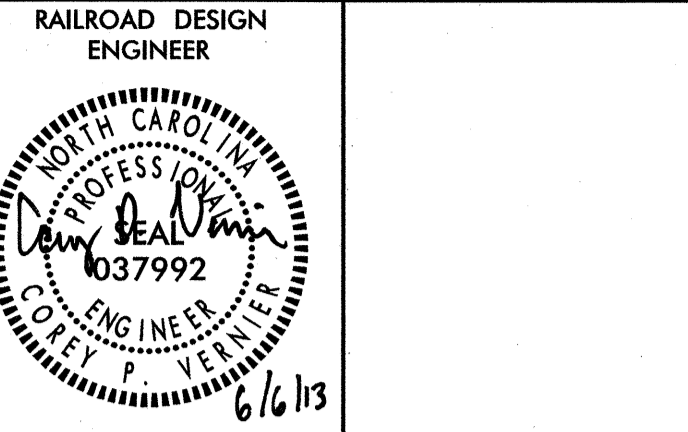

← TO GREENSBORO

NOT IN CONTRACT

THESE PLANS ARE PROVIDED TO THE NCDOT CONTRACTOR TO PROVIDE CONTEXT FOR COORDINATION WITH NORFOLK SOUTHERN AND ITS CONTRACTOR.

TO CHARLOTTE →

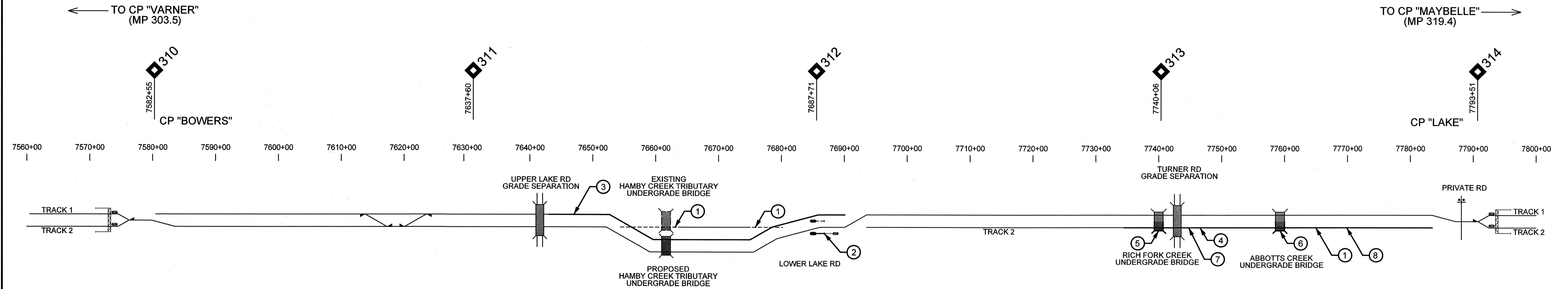

Phase 3 - Construct proposed track 1 between CP "Bowers" to CP "Lake".

1. Remove existing track Sta. 7654+00 to Sta. 7665+00, Sta. 7678+00 to Sta. 7685+00, and Sta. 7759+80 to Sta. 7775+81.
2. Temporarily relocate northbound mast signal at Sta. 7686+95 to allow for construction of proposed track 2.
3. Construct proposed track 1 from Sta. 7643+00 to Sta. 7683+30.
4. Remove existing main track 2 from Sta. 7732+33 to Sta. 7748+00 (by project C-4901A).
5. Undercut roadbed over Rich Fork Creek bridge (Track 2 only by project C-4901A).
6. Complete superstructure replacement of Abbotts Creek bridge (Track 2 only by project C-4901A).
7. Construct proposed main track 2 from Sta. 7732+33 to 7748+00.
8. Shift proposed main track 2 from Sta. 7748+00 to Sta. 7759+80, Construct proposed track 2 from Sta. 7759+80 to Sta. 7775+81 (construct 9" ballast pad prior to construction track), and shift proposed main track 2 from Sta. 7775+81 to Sta. 7785+30.

LEGEND

EXISTING	EXISTING (BEING REMOVED)	PROPOSED (UNDER CONSTRUCTION)	
			TRACK
			TURNOUT
			GRADE CROSSING
			RAILROAD SIGNALS (MAST OR BRIDGE)
			BRIDGE (OVERHEAD OR UNDERGRADE)

0248DEL_P10c1
0001ADD_P10c1

REVISIONS

REVISION #1 DATED 6/6/13: PRIVATE CROSSING TO REMAIN.

9:51:55 AM
C:\projects\0248del\0001add\0248del_p10c1.dgn

HNTB HNTB NORTH CAROLINA, P.C.
343 E. Six Forks Road, Suite 200
Raleigh, North Carolina 27609
NC License No. C-1554

DATE: MARCH 12, 2013

PROJECT REFERENCE NO. SHEET NO.
C-4901A CP-05

RW SHEET NO.

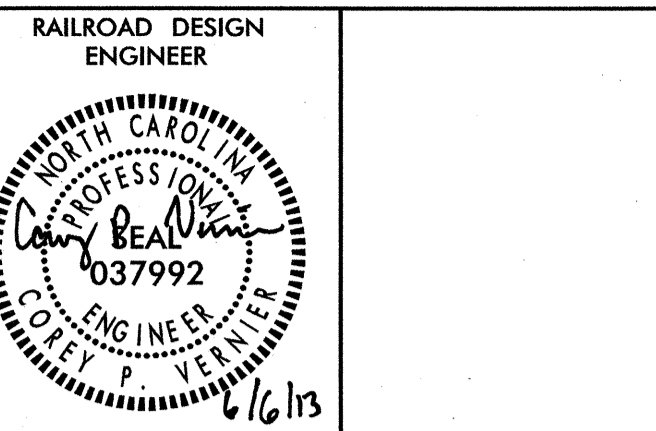

NOT IN CONTRACT

THESE PLANS ARE PROVIDED TO THE NCDOT CONTRACTOR TO PROVIDE CONTEXT FOR COORDINATION WITH NORFOLK SOUTHERN AND ITS CONTRACTOR.

← TO GREENSBORO

TO CHARLOTTE →

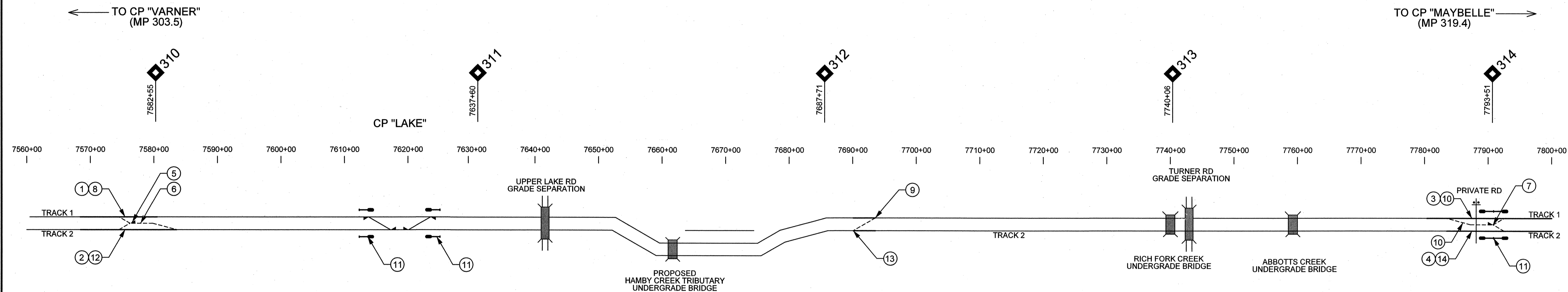

Phase 4 - Finish proposed track 1.

1. Construct proposed main track 1 from Sta. 7574+01 to Sta. 7579+11 (offline when within 10' of existing track).
2. Construct proposed main track 2 from Sta. 7574+01 to Sta. 7579+52 (offline when within 10' of existing track).
3. Construct proposed main track 1 from Sta. 7791+49 to Sta. 7793+69 (offline when within 10' of existing track).
4. Construct proposed main track 2 from Sta. 7785+30 to Sta. 7793+71 (offline when within 10' of existing track).

Steps 5-14 need to occur before trains can operate on both tracks between CP "Varner" and CP "Maybelle."

5. Remove existing equilateral turnout PS Sta. 7576+21.
6. Remove existing main track 2 from Sta. 7576+21 to Sta. 7579+52.
7. Remove existing equilateral turnout PS Sta. 7791+50.
8. Shift existing main track 1 from Sta. 7568+00 to Sta. 7574+01 and previously constructed main track 1 from Sta. 7574+01 to Sta. 7582+66 into proposed track 1 alignment.
9. Shift temporary alignment 1 into proposed track 1 to restore tangential geometry.
10. Shift temporary alignment 2 from Sta. 7780+96 to Sta. 7789+32, existing track 2 from Sta. 7789+32 to 7791+49, previously constructed main track 1 from Sta. 7791+49 to Sta. 7793+69, and existing main track 1 from Sta. 7793+69 to Sta. 7800+00 into proposed track 1 alignment.
11. Cut-in new signal system.
12. Shift existing main track 2 from Sta. 7568+00 to Sta. 7574+01, previously constructed main track 2 from Sta. 7574+01 to Sta. 7582+66 into proposed track 2 alignment.
13. Shift temporary alignment 1 into existing track 2 to restore tangential geometry.
14. Shift previously constructed main track 2 from Sta. 7786+00 to Sta. 7793+71, and existing main track 2 from Sta. 7793+71 to Sta. 7800+00 into proposed track 2 alignment.

At the end of this phase, trains will operate on both tracks through the limits of the project.

LEGEND

EXISTING	EXISTING (BEING REMOVED)	PROPOSED (UNDER CONSTRUCTION)	
			TRACK
			TURNOUT
			GRADE CROSSING
			RAILROAD SIGNALS (MAST OR BRIDGE)
			BRIDGE (OVERHEAD OR UNDERGRADE)