

09/08/99

See Sheet 1-A For Index of Sheets  
See Sheet 1-B For Symbolry

# STATE OF NORTH CAROLINA DIVISION OF HIGHWAYS

T.I.P. NO.	SHEET NO.
B-4325	UO-1

## UTILITIES BY OTHERS PLANS WILKES COUNTY

**LOCATION: BRIDGE NO. 718 OVER MIDDLE FORK REDDIES RIVER  
ON SR 1580 (KUENZEL-ELLER DRIVE)**

**TYPE OF WORK: TELEPHONE, ELECTRICAL POWER**

**TIP PROJECT: B-4325**

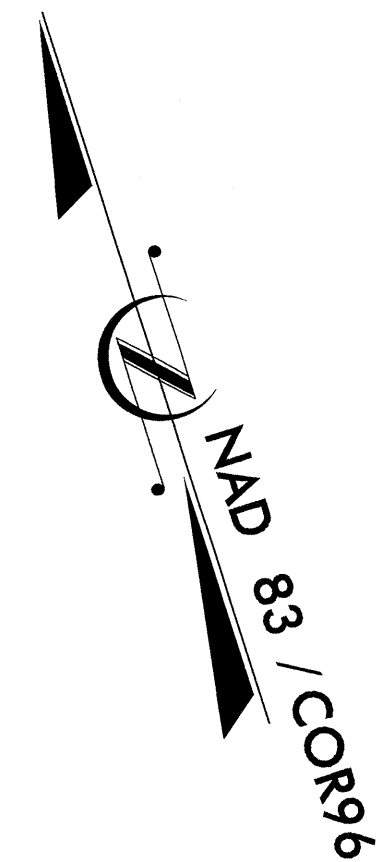
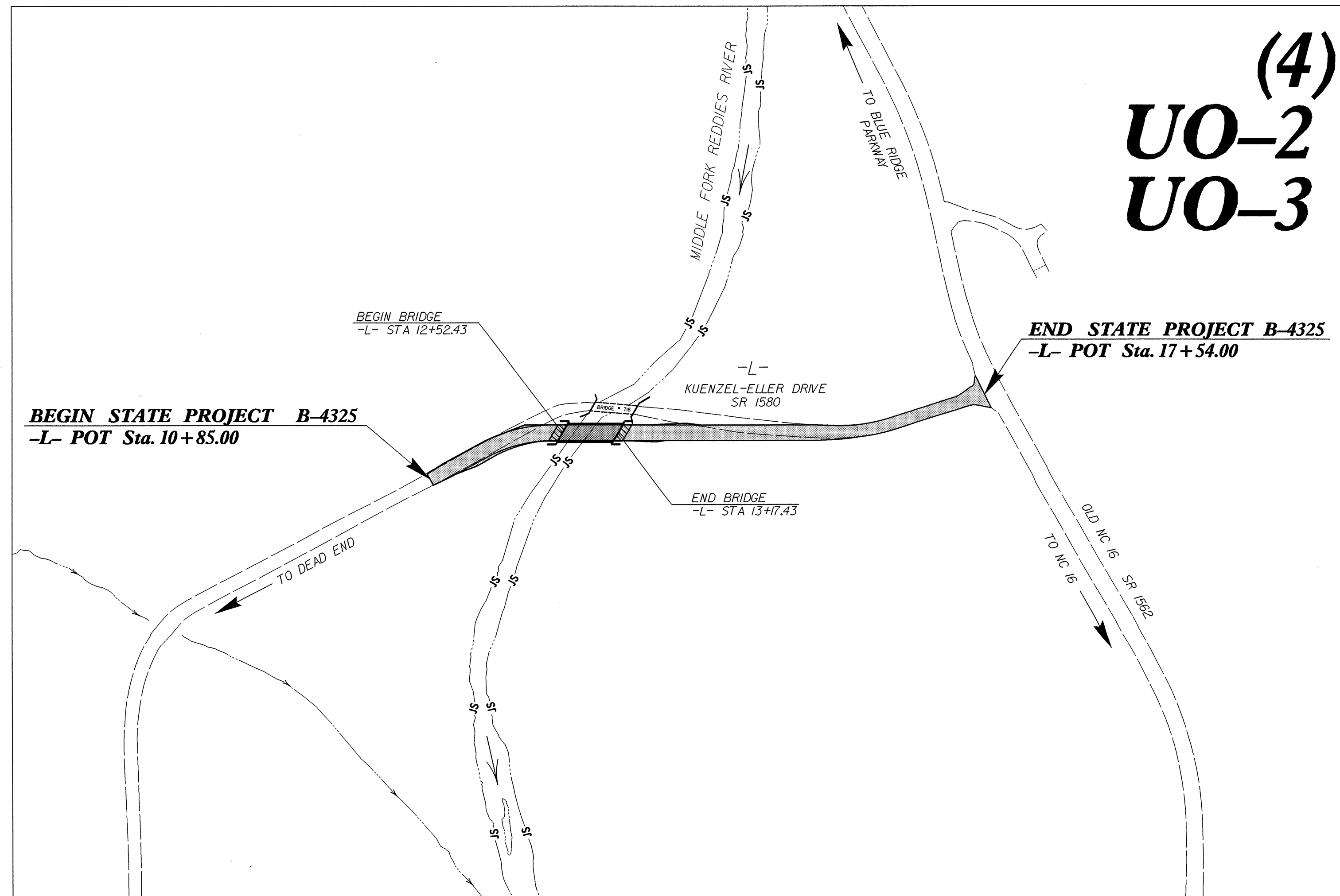
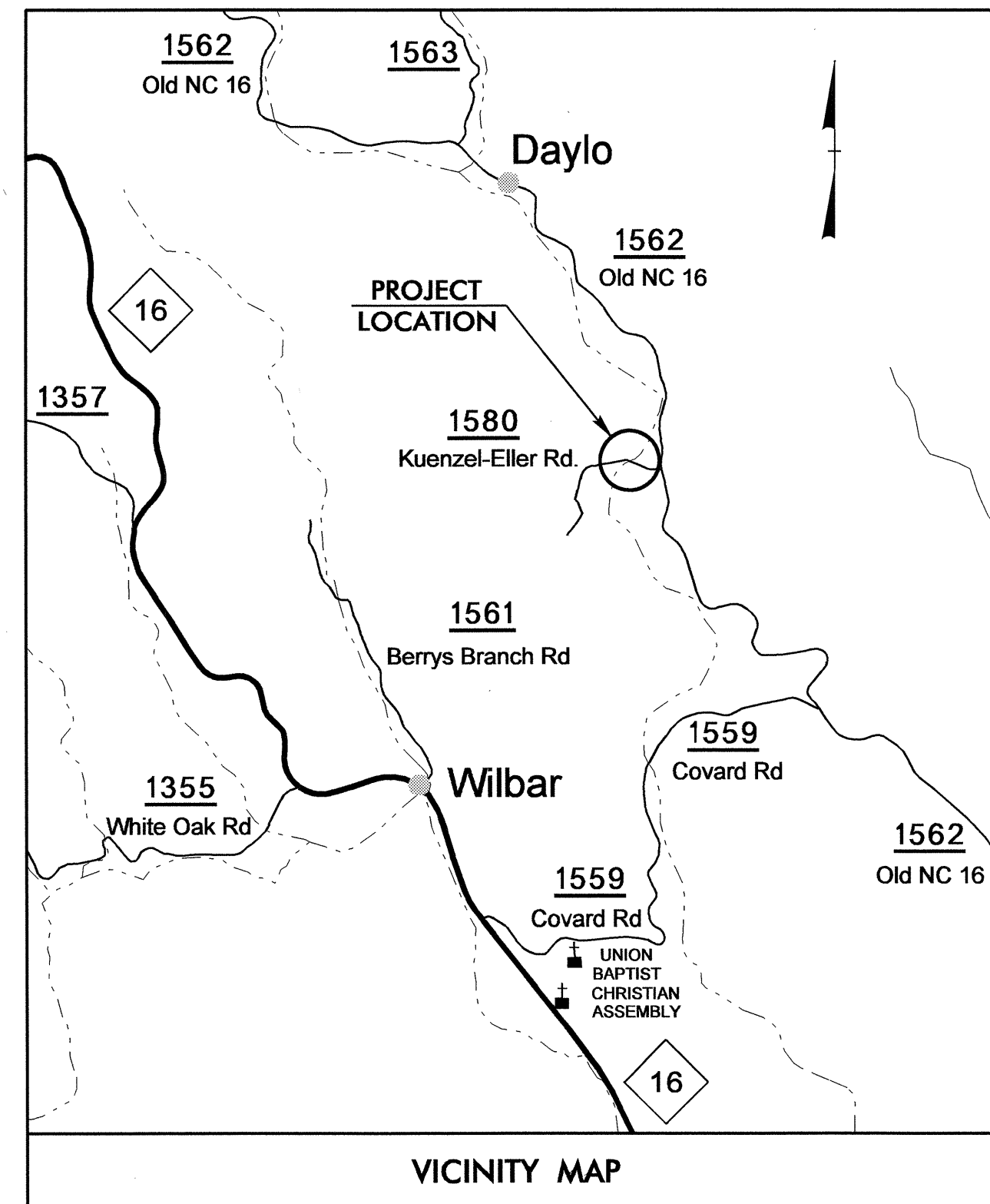

INCOMPLETE PLANS  
DO NOT USE FOR R/W ACQUISITION  
PRELIMINARY PLANS  
DO NOT USE FOR CONSTRUCTION

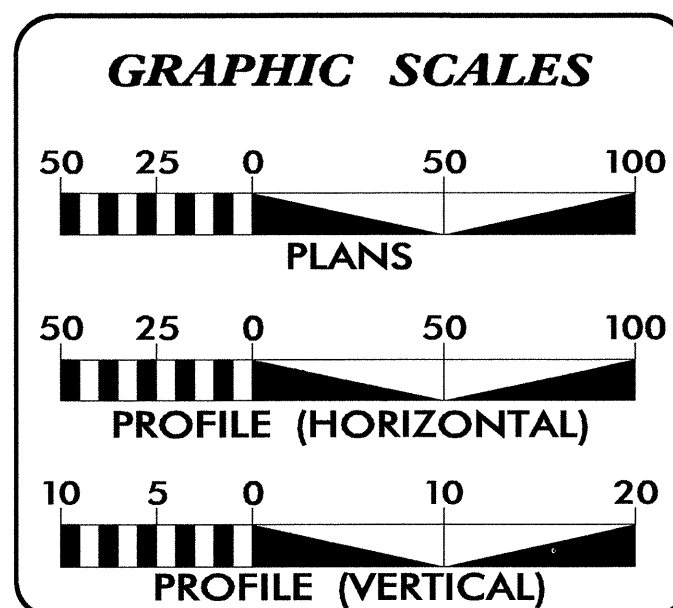

INDEX OF SHEETS	
SHEET NO.	DESCRIPTION
UO-1	TITLE SHEET
UO-2 THRU UO-3	UTILITIES BY OTHERS PLAN SHEETS

UTILITY OWNERS ON PROJECT
(1) Centurylink - Telephone
(2) Blue Ridge EMC - Power

PREPARED IN THE OFFICE OF:  
**DIVISION OF HIGHWAYS  
UTILITIES UNIT  
UTILITIES ENGINEERING**

1591 MAIL SERVICES CENTER  
RALEIGH NC 27699-1591  
PHONE (919) 767-6690  
FAX (919) 250-4151

**Roger Worthington, P.E.** UTILITIES SECTION ENGINEER  
**Carl Barclay, P.E.** UTILITIES SQUAD LEADER PROJECT ENGINEER  
**Bo Hemphill, P.E.** UTILITIES PROJECT DESIGNER

06-NOV-2012 15:35  
RA\Hjt\files\RDV\ut\Proj\B4325-ut-title.uol\_psh.dgn  
USER:RNAME

# PRE-CONSTRUCTION UTILITY RELOCATIONS

**-L- SR 1580 (KUENZEL-ELLER ROAD)**

PI Sta 11+98.53	PI Sta 16+07.29
$\Delta = 28^{\circ}13'20.7"$ (RT)	$\Delta = 17^{\circ}49'37.4"$ (LT)
$D = 32^{\circ}44'25.6"$	$D = 22^{\circ}02'12.6"$
$L = 86.20'$	$L = 80.90'$
$T = 43.99'$	$T = 40.78'$
$R = 175.00'$	$R = 260.00'$
$SE = 0.04$	$SE = 0.04$
$RO = 52'$	$RO = \text{VAR. (SEE PLANS)}$
$V = 25 \text{ MPH}$	$V = 25 \text{ MPH}$

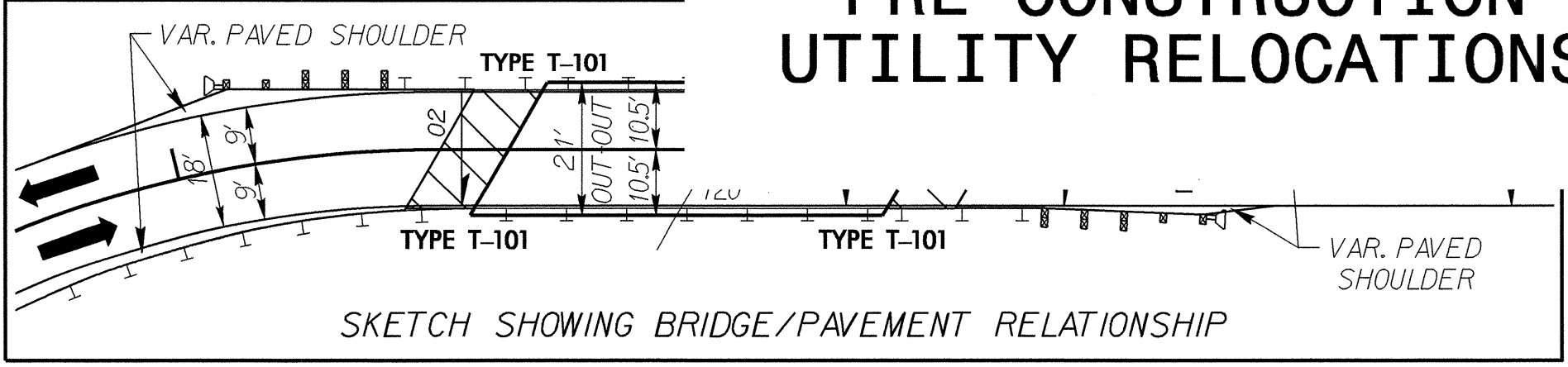

## UTILITIES BY OTHERS

**NOTE:**  
ALL PROPOSED UTILITY WORK  
SHOWN ON THIS SHEET WILL  
BE DONE BY OTHERS

SEE SHEET 5 FOR -L- PROFILE

FOR STRUCTURE PLANS, SEE SHEET S-1 THRU S-18

**BEGIN STATE PROJECT B-4325**  
**-L- POT Sta. 10+85.00**

**END STATE PROJECT B-4325**  
**-L- POT Sta. 17+54.00**

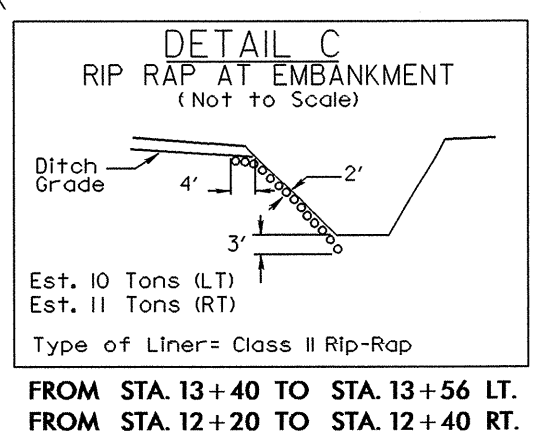
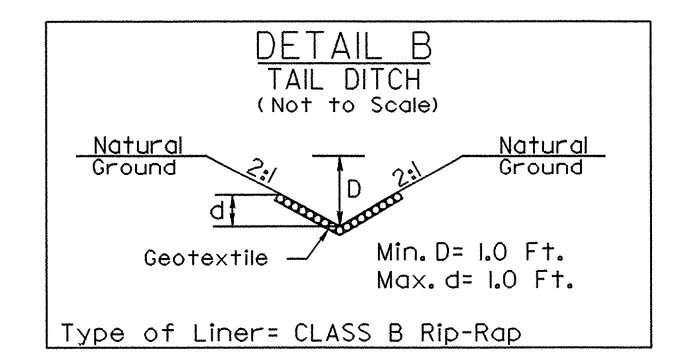
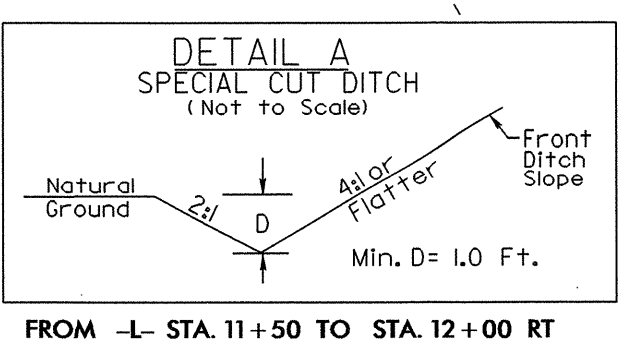
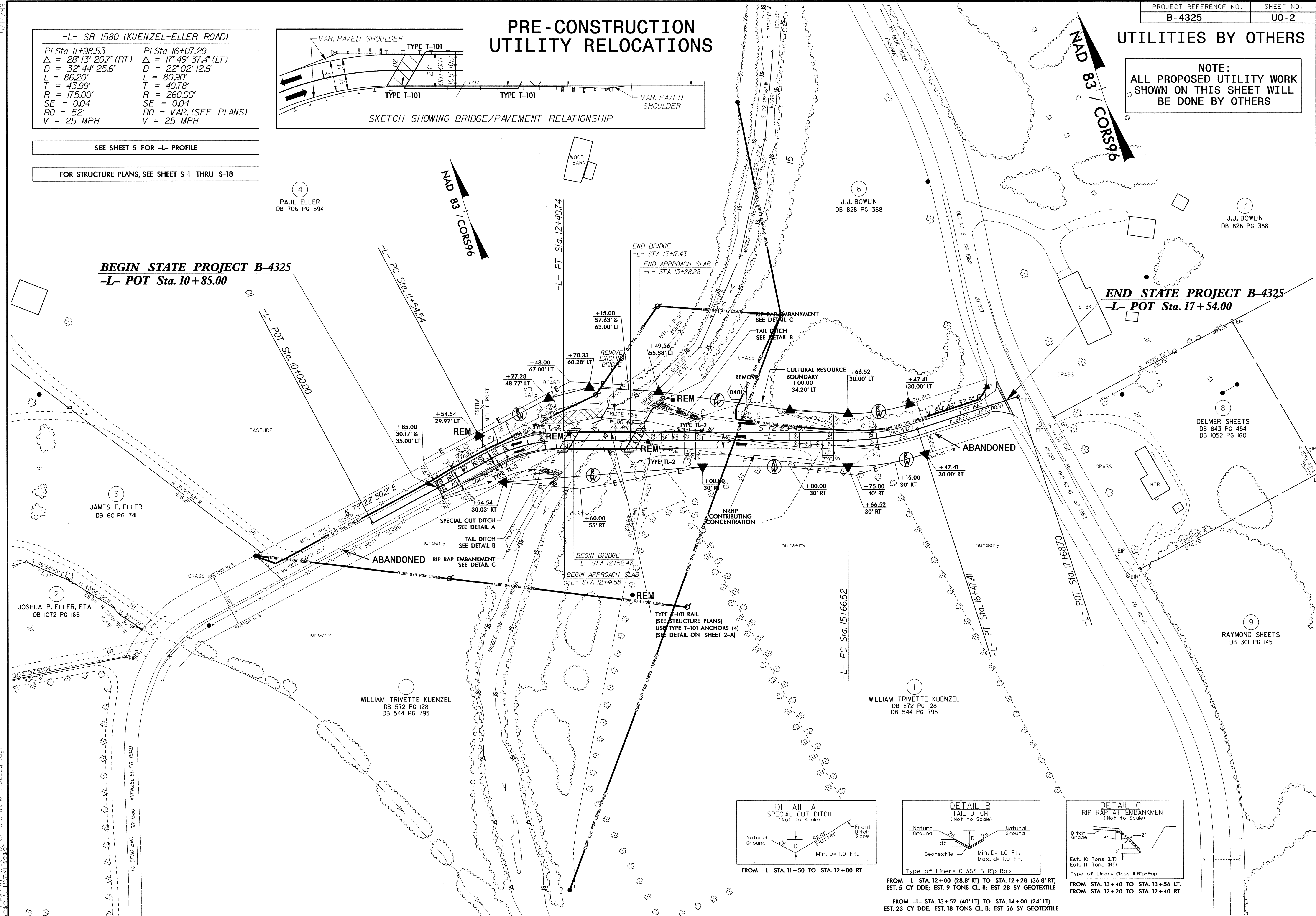

FROM -L- STA. 13+52 (40' LT) TO STA. 14+00 (24' LT)  
EST. 23 CY DDE; EST. 18 TONS CL. B; EST. 56 SY GEOTEXTILE

5/14/99  
27-NOV-2012 12:22  
N:\utilities\road\ut\_04\proj\B4325-ut\_04-uo2\_psh.dgn



**-L- SR 1580 (KUENZEL-ELLER ROAD)**  
 PI Sta 11+98.53 Δ = 28° 13' 20.7" (RT)  
 D = 32° 44' 25.6" L = 86.20'  
 T = 43.99' R = 175.00'  
 SE = 0.04 RO = 52'  
 V = 25 MPH

PI Sta 16+07.29 Δ = 17° 49' 37.4" (LT)  
 D = 22° 02' 12.6" L = 80.90'  
 T = 40.78' R = 260.00'  
 SE = 0.04 RO = VAR. (SEE PLANS)  
 V = 25 MPH

SEE SHEET 5 FOR -L- PROFILE

FOR STRUCTURE PLANS, SEE SHEET S-1 THRU S-18

# FINAL POST-CONSTRUCTION UTILITY CONFIGURATION

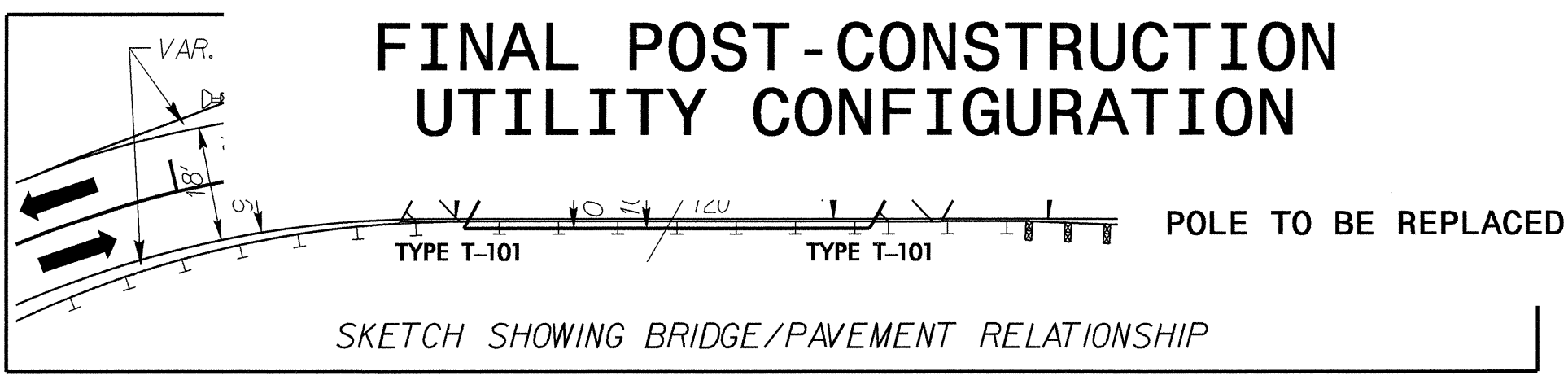

## UTILITIES BY OTHERS

NOTE:  
 ALL PROPOSED UTILITY WORK SHOWN ON THIS SHEET WILL BE DONE BY OTHERS

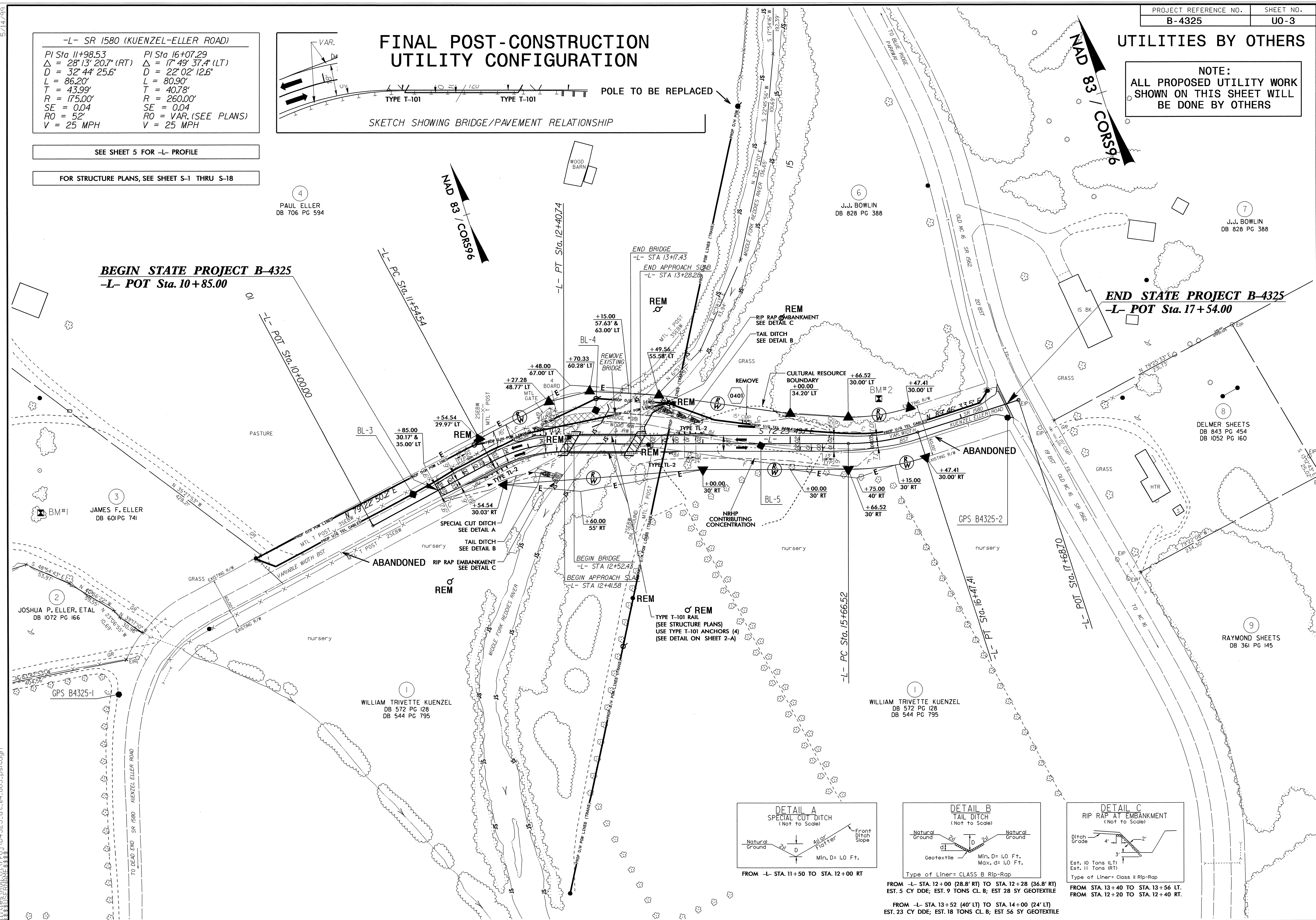

**BEGIN STATE PROJECT B-4325**  
**-L- POT Sta. 10+85.00**

**END STATE PROJECT B-4325**  
**-L- POT Sta. 17+54.00**

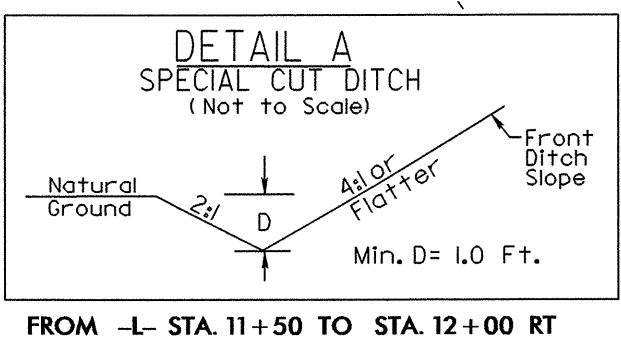

FROM -L- STA. 11+50 TO STA. 12+00 RT

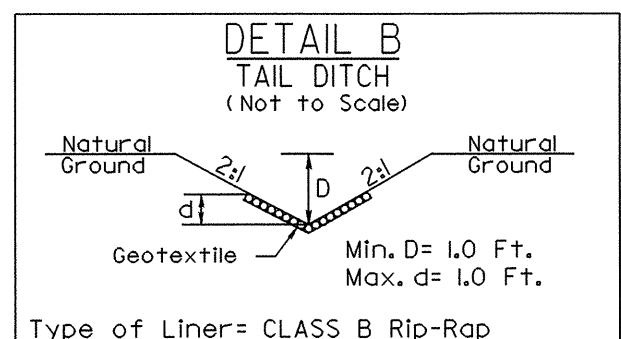

FROM -L- STA. 12+00 (28.8' RT) TO STA. 12+28 (36.8' RT)  
 EST. 5 CY DDE; EST. 9 TONS CL. B; EST. 28 SY GEOTEXTILE

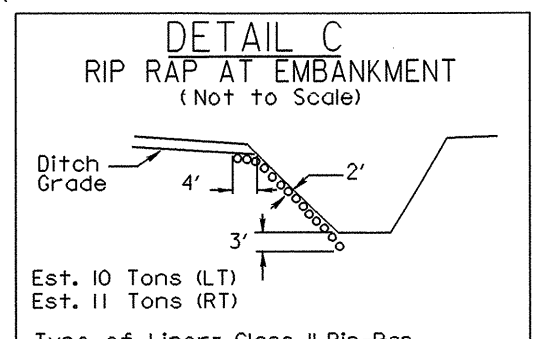

FROM -L- STA. 13+52 (40' LT) TO STA. 14+00 (24' LT)  
 EST. 23 CY DDE; EST. 18 TONS CL. B; EST. 56 SY GEOTEXTILE

5/14/99  
 27-NOV-2012 12:19  
 R:\Utilities\Projects\UO\UO-3\Proj\B4325-ut\_04\_uo3\_psh.dgn