

STATE OF NORTH CAROLINA  
DIVISION OF HIGHWAYS

PROJ. REFERENCE NO.	SHEET NO.
B-4946	X-0

Approximate quantities only. Unclassified excavation, fine grading, clearing and grubbing, and removal of existing pavement will be paid for at the lump sum price for "Grading".

NOTE: EMBANKMENT COLUMN DOES NOT INCLUDE BACKFILL FOR UNDERCUT

CROSS-SECTION SUMMARY

Station -L_EBL- (-L_EBL RT-)	Uncl. Exc. (cu. yd.)	Embt (cu. yd.)	Station -L_NBL- (-L_NBL RT-)	Uncl. Exc. (cu. yd.)	Embt (cu. yd.)
20+50.00	8	0	10+00.00	0	0
21+00.00	17	0	10+50.00	13	2
21+50.00	18	0	11+00.00	12	5
22+00.00	24	53	11+50.00	17	4
22+50.00	34	200	12+00.00	17	0
23+00.00	19	435	12+50.00	14	0
23+50.00	0	702	13+00.00	16	0
24+00.00	0	988	13+50.00	15	0
24+50.00	0	1340	14+00.00	15	0
25+00.00	0	1230	14+50.00	17	0
25+69.32	0	643	TOTAL	136	11
TOTAL	120	5591	Station -L_EBL- (-L_EBL LT-)	Uncl. Exc. (cu. yd.)	Embt (cu. yd.)
25+49.59	0	0	18+00.00	0	0
26+00.00	0	324	18+50.00	18	0
26+50.00	0	1005	19+00.00	44	0
27+00.00	0	1244	19+50.00	53	0
27+50.00	0	1106	20+00.00	83	0
28+00.00	0	1063	20+50.00	132	0
28+50.00	0	956	21+00.00	174	0
29+00.00	0	785	21+50.00	219	0
29+50.00	0	566	22+00.00	214	0
30+00.00	0	370	22+50.00	172	0
30+50.00	0	252	23+00.00	141	1
31+00.00	1	146	23+50.00	76	33
31+50.00	5	60	24+00.00	14	184
32+00.00	22	14	24+50.00	0	152
32+08.71	3	0	TOTAL	1340	370
TOTAL	31	7891	Station -L_EBL- (-L_EBL LT-)	Uncl. Exc. (cu. yd.)	Embt (cu. yd.)
20+00.00	1	3	26+50.00	0	0
20+50.00	1	3	27+00.00	0	71
TOTAL	2	6	27+50.00	0	58
20+00.00	1	3	28+00.00	0	52
TOTAL	2	6	28+50.00	0	42
10+00.00	0	0	29+00.00	40	31
10+50.00	15	2	29+50.00	71	34
11+00.00	19	1	30+00.00	55	22
11+50.00	20	0	30+50.00	52	1
12+00.00	14	0	31+00.00	54	0
12+50.00	10	0	31+50.00	44	0
13+00.00	10	1	32+00.00	33	0
13+50.00	17	1	32+21.54	6	0
14+00.00	21	0	TOTAL	355	311
14+50.00	19	0			
TOTAL	145	5			



8/23/99

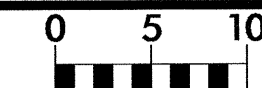

PROJ. REFERENCE NO.  
B-4946

SHEET NO.  
X-1

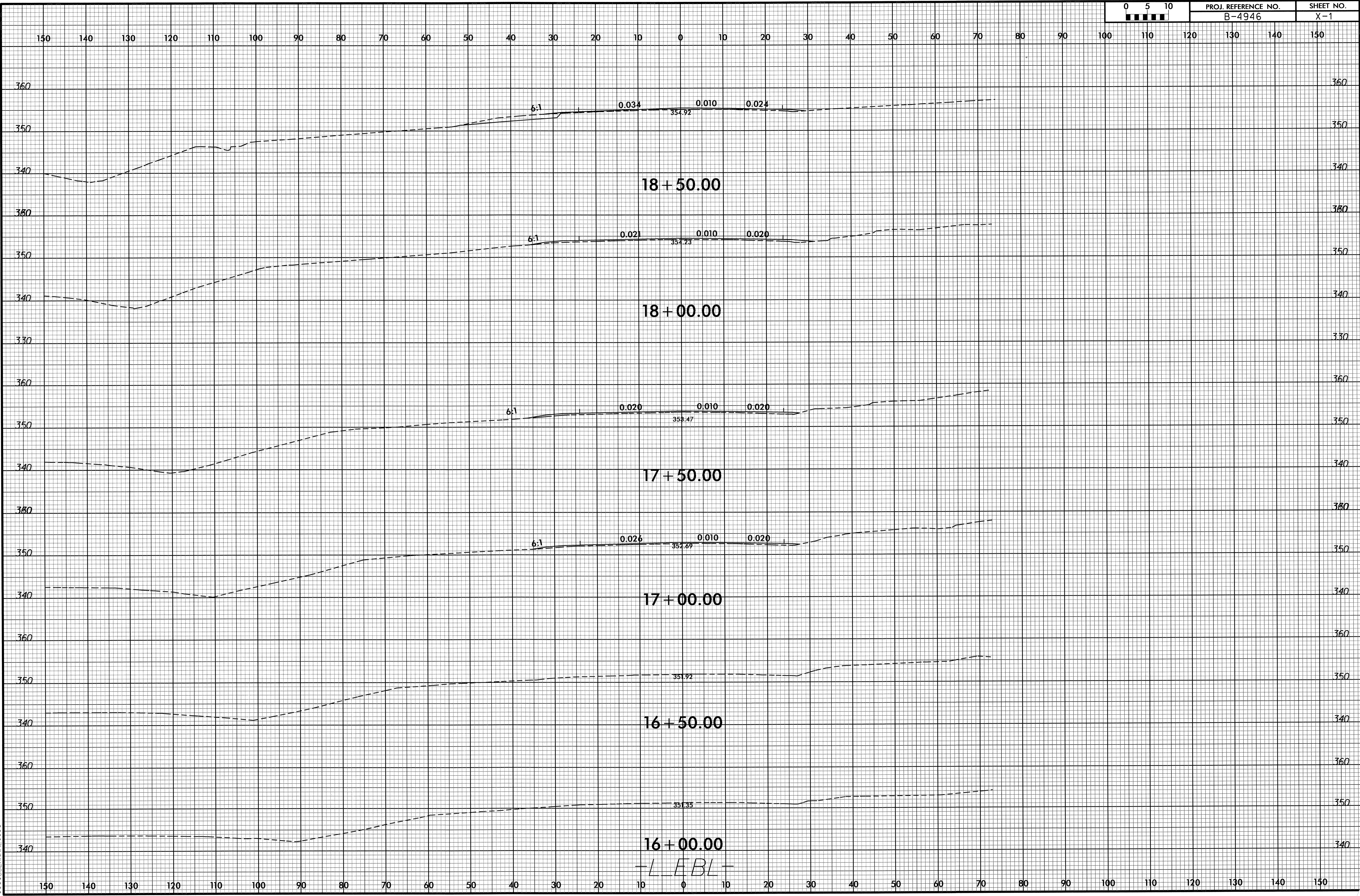

08-JAN-2013 17:07  
F:\Roadway\XSC\B4946\_Rdy\_XPL\_1\_ebl.dgn  
\$\$\$\$\$USERNAME\$\$\$\$\$



8/23/99

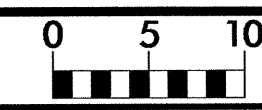

PROJ. REFERENCE NO.  
B-4946

SHEET NO.  
X-2

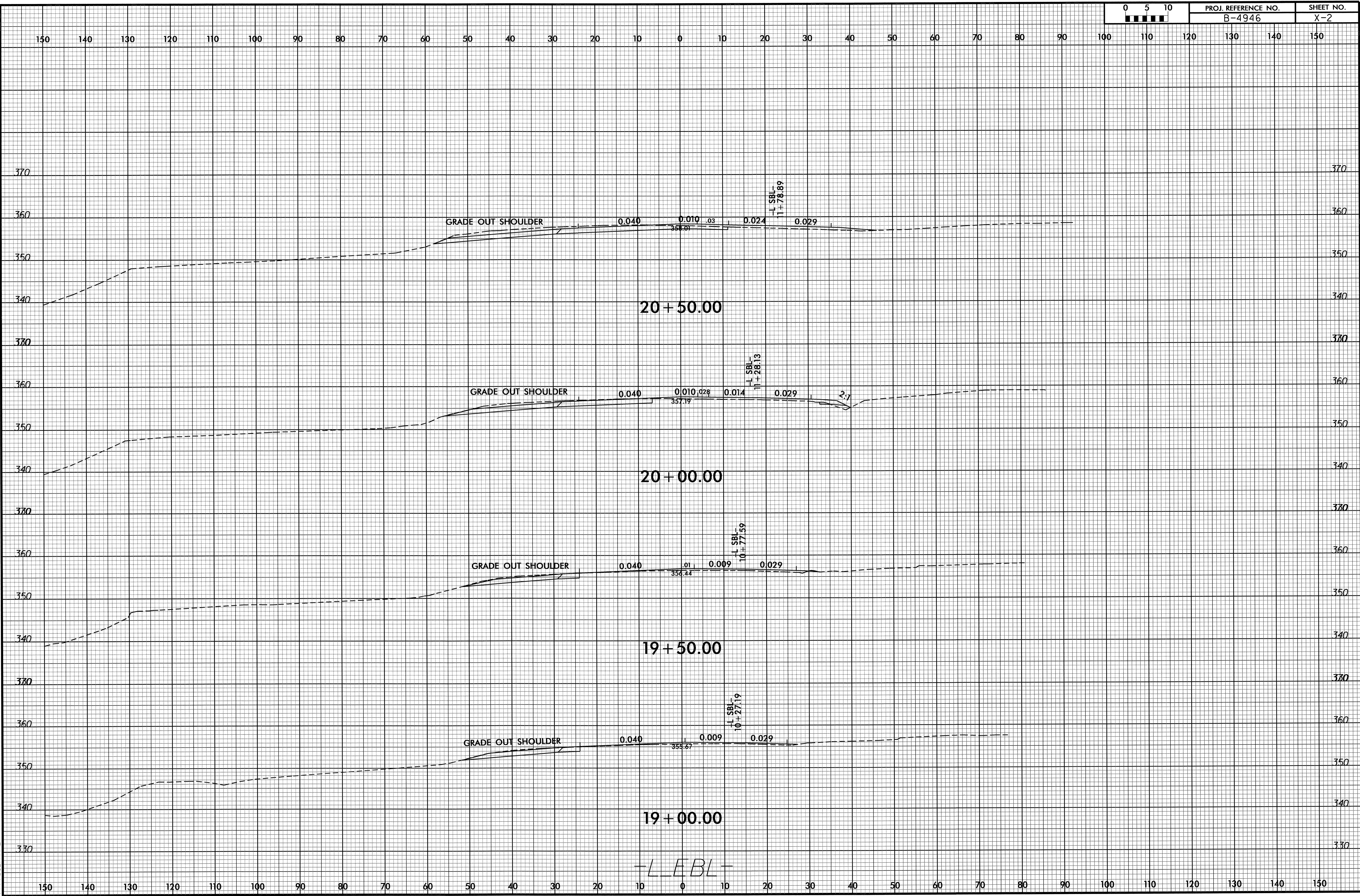

08-JAN-2013 17:07  
R:\Roads\XSC\B4946\_Rdy\_XPL\_1\_ebl.dgn  
SS#SERNAMESS

-L EBL-



8/23/99

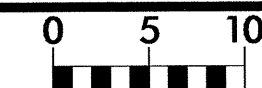

PROJ. REFERENCE NO. B-4946	SHEET NO. X-3
-------------------------------	------------------

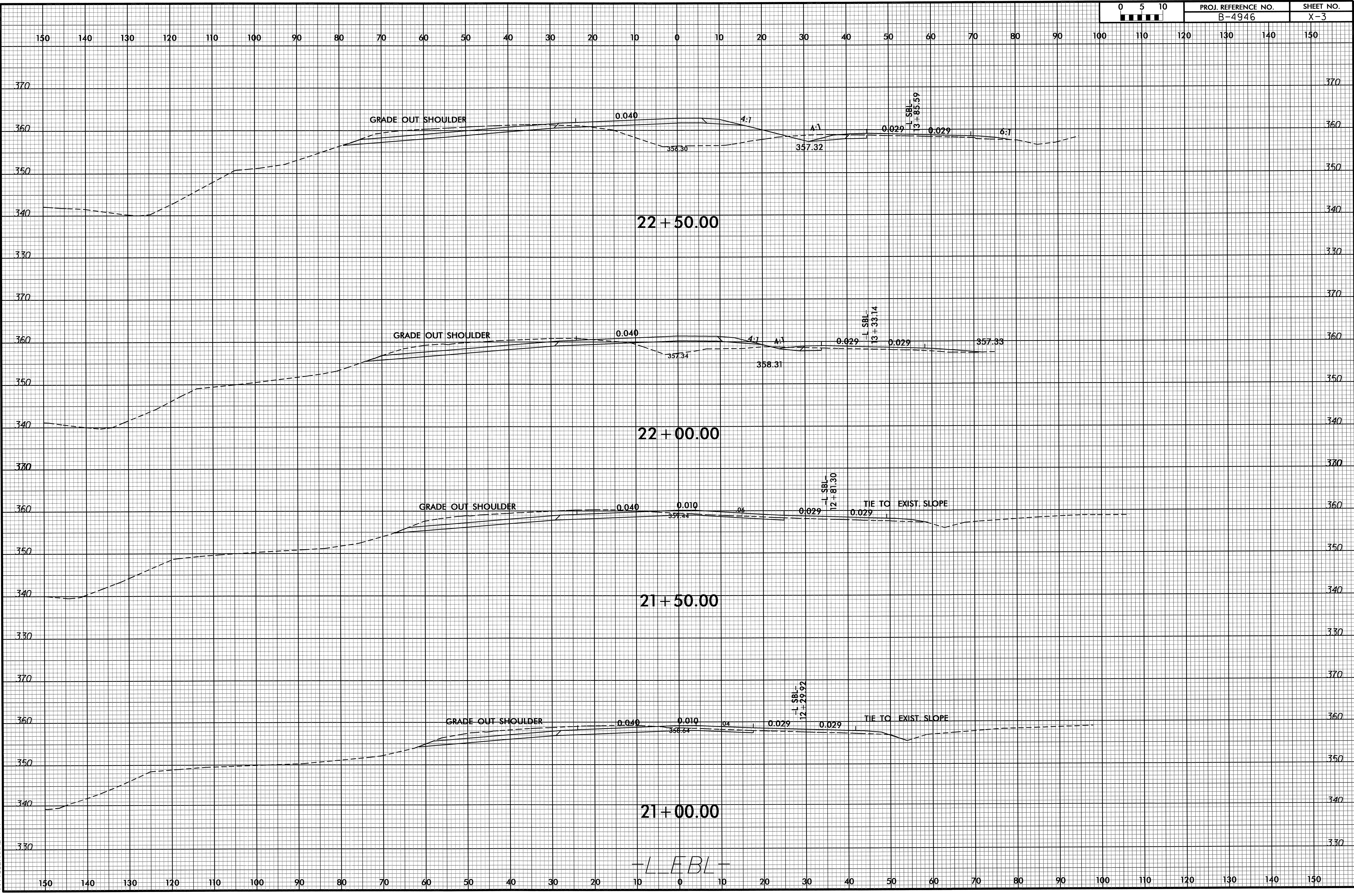

08-JAN-2013 17:07  
F:\Roadwork\XSC\B4946\_Rdy\_XPL\_1\_ebl.dgn  
\$\$\$\$\$USER\$NAME\$\$\$\$



8/23/09

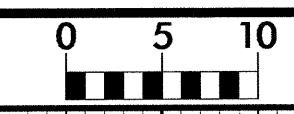

PROJ. REFERENCE NO.  
B-4946

SHEET NO.  
X-4

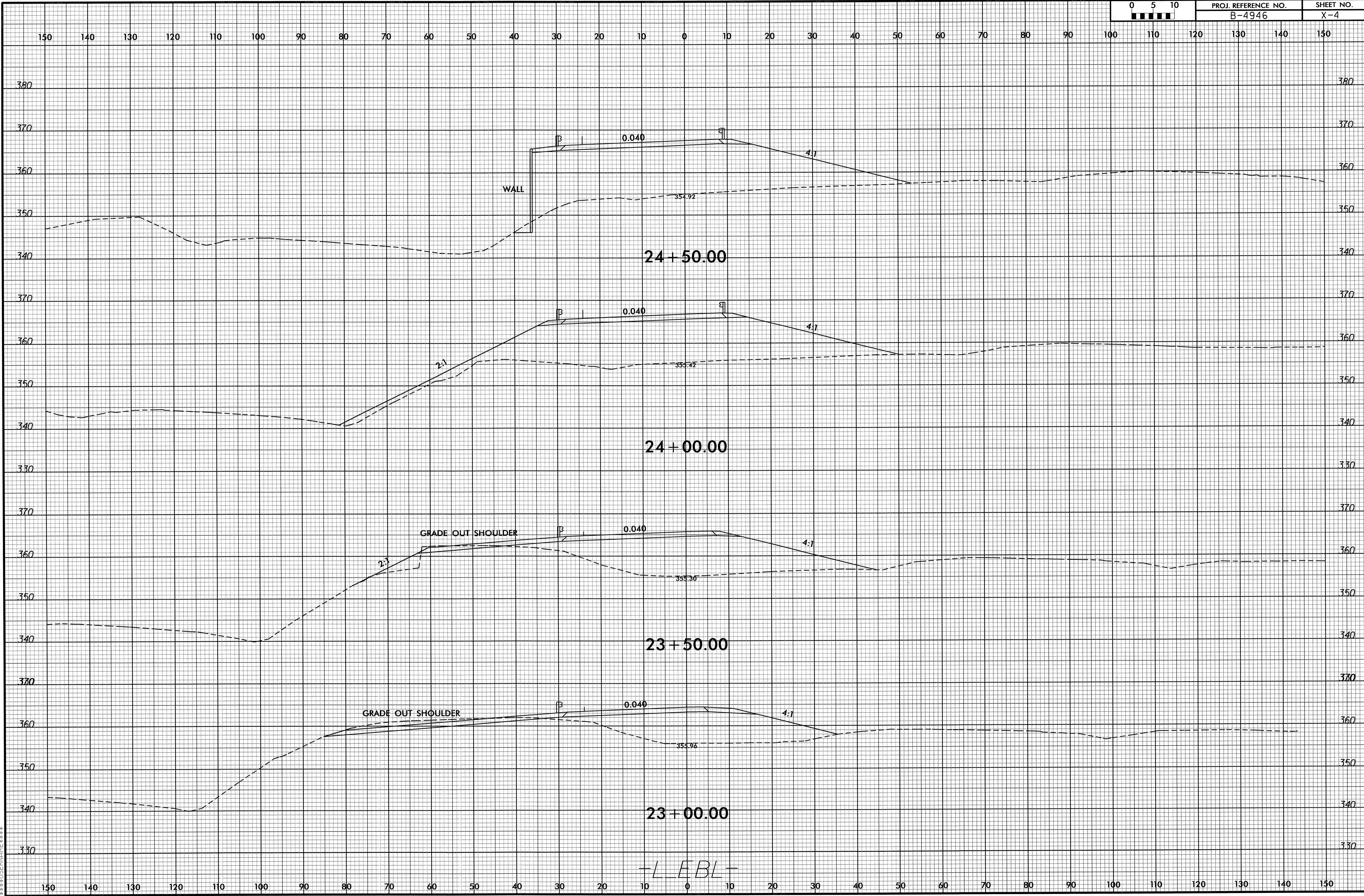

25 JAN 2013 12:52  
 C:\P2013\2306\B4946.Rd\XPL\_L\_ebl.dgn  
 638815587846233



8/23/99



PROJ. REFERENCE NO.	SHEET NO.
B-4946	X-5

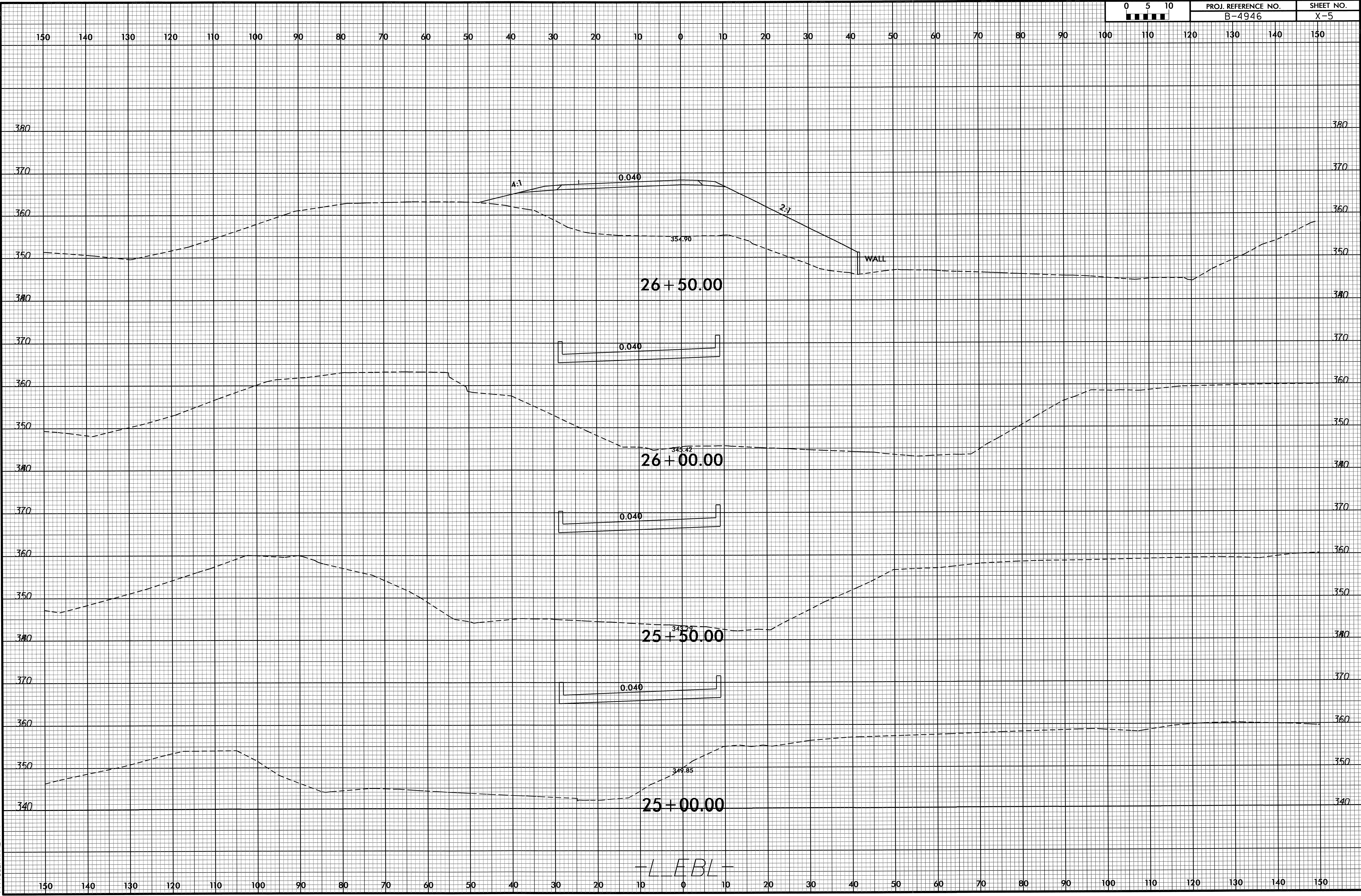

08-JAN-2013 17:07  
F:\Roadgen\XSC\B4946\_Rdy\_XPL\_1\_ebl.dgn  
###USERNAME###



8/23/99

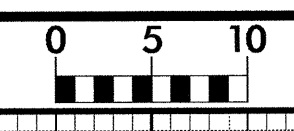

PROJ. REFERENCE NO.	SHEET NO.
B-4946	X-6

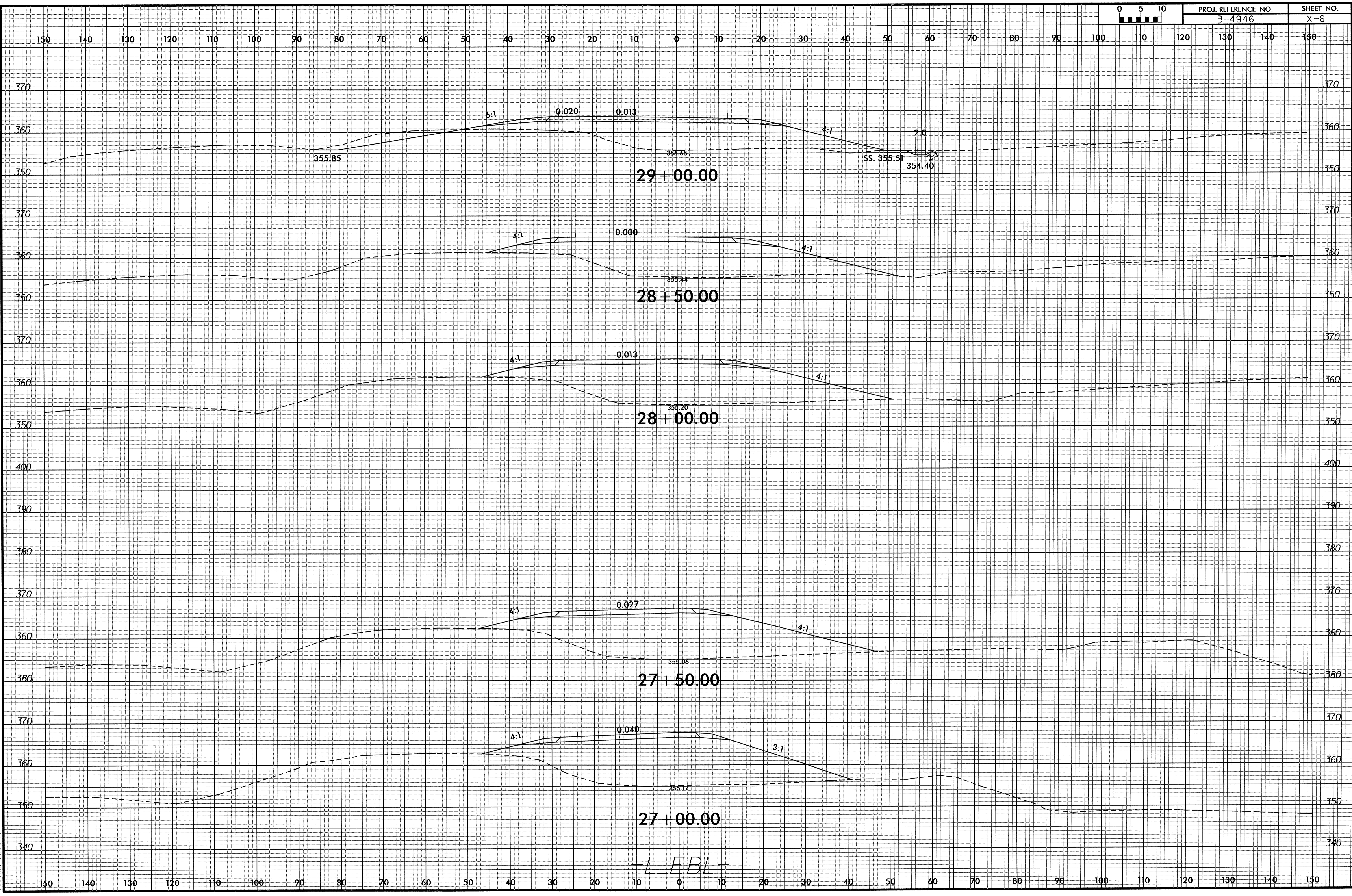

08-JAN-2013 17:07  
 P:\Reedell\XSC\B4946\_Rdy\_XPL\_1\_ebl.dgn  
 \$\$\$USERNAME\$\$\$



8/23/99

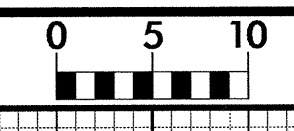

PROJ. REFERENCE NO.  
B-4946

SHEET NO.  
X-7

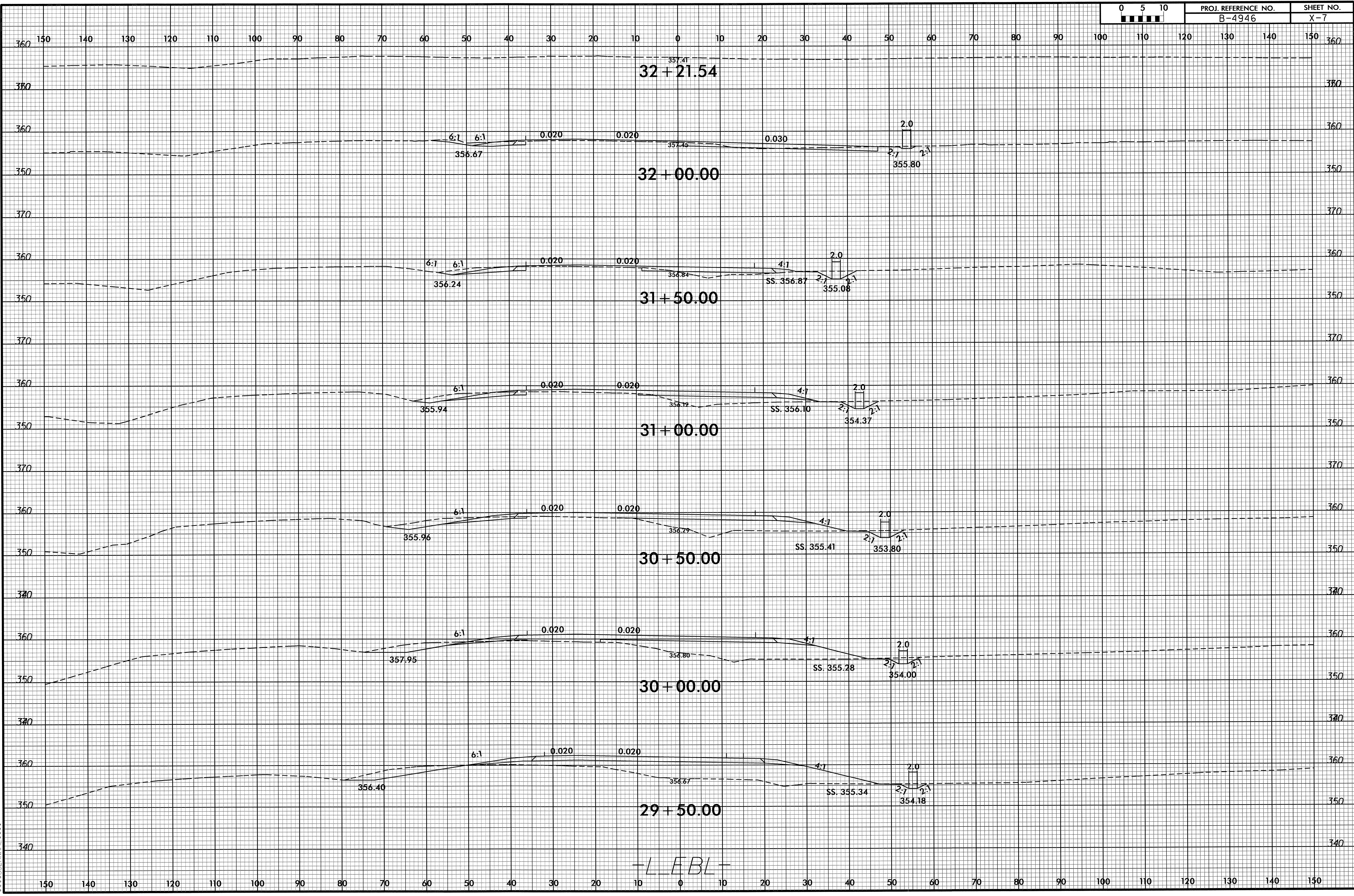

08-JAN-2013 17:07  
R:\Roadwork\XSC\B4946\_Rdy\_XPL\_1\_ebl.dgn  
\$\$\$\$\$USERNAME\$\$\$\$\$

- L E B L -



8/23/99

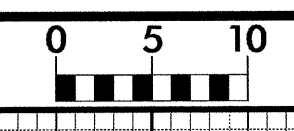

PROJ. REFERENCE NO.  
B-4946

SHEET NO.  
X-8

150 140 130 120 110 100 90 80 70 60 50 40 30 20 10 0 10 20 30 40 50 60 70 80 90 100 110 120 130 140 150

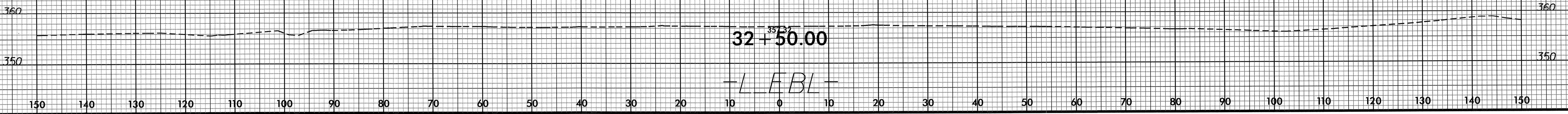

08-JAN-2013 17:07  
R:\Roadwork\XSC\B4946\_Rdy\_XPL\_1\_ebl.dgn  
\$\$\$\$\$USERNAME\$\$\$\$\$



8/23/99

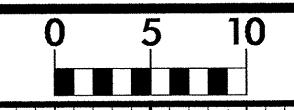

PROJ. REFERENCE NO.	SHEET NO.
B-4946	X-9

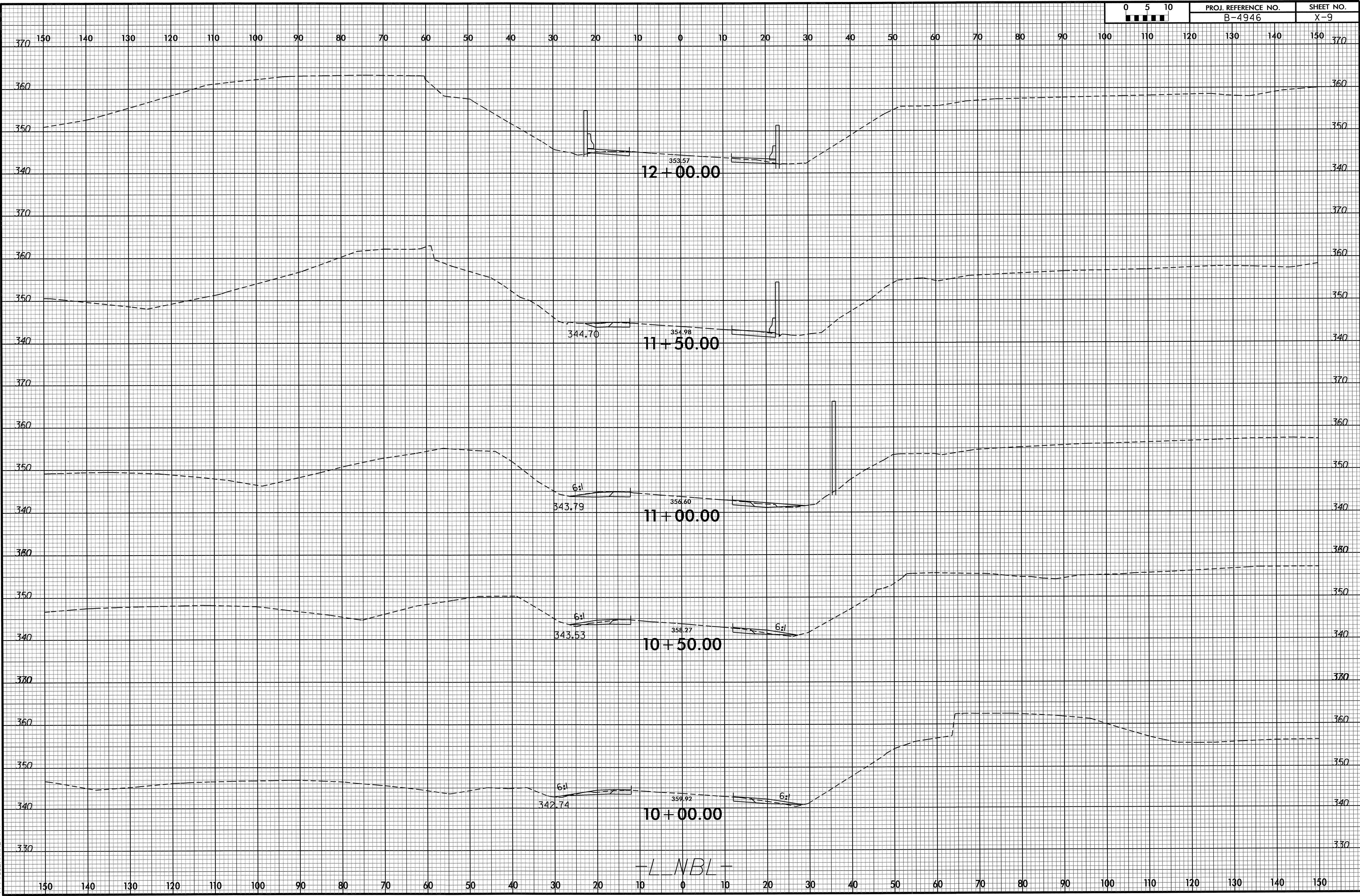

-L NBL -

08-JAN-2013 17:07  
 P:\Roads\B4946\_Rdy\_Xpl\_1\_nbl.dgn  
 5:58 PM BULSER\NAME



8/23/99

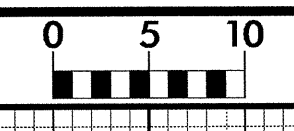

PROJ. REFERENCE NO.  
B-4946

SHEET NO.  
X-10

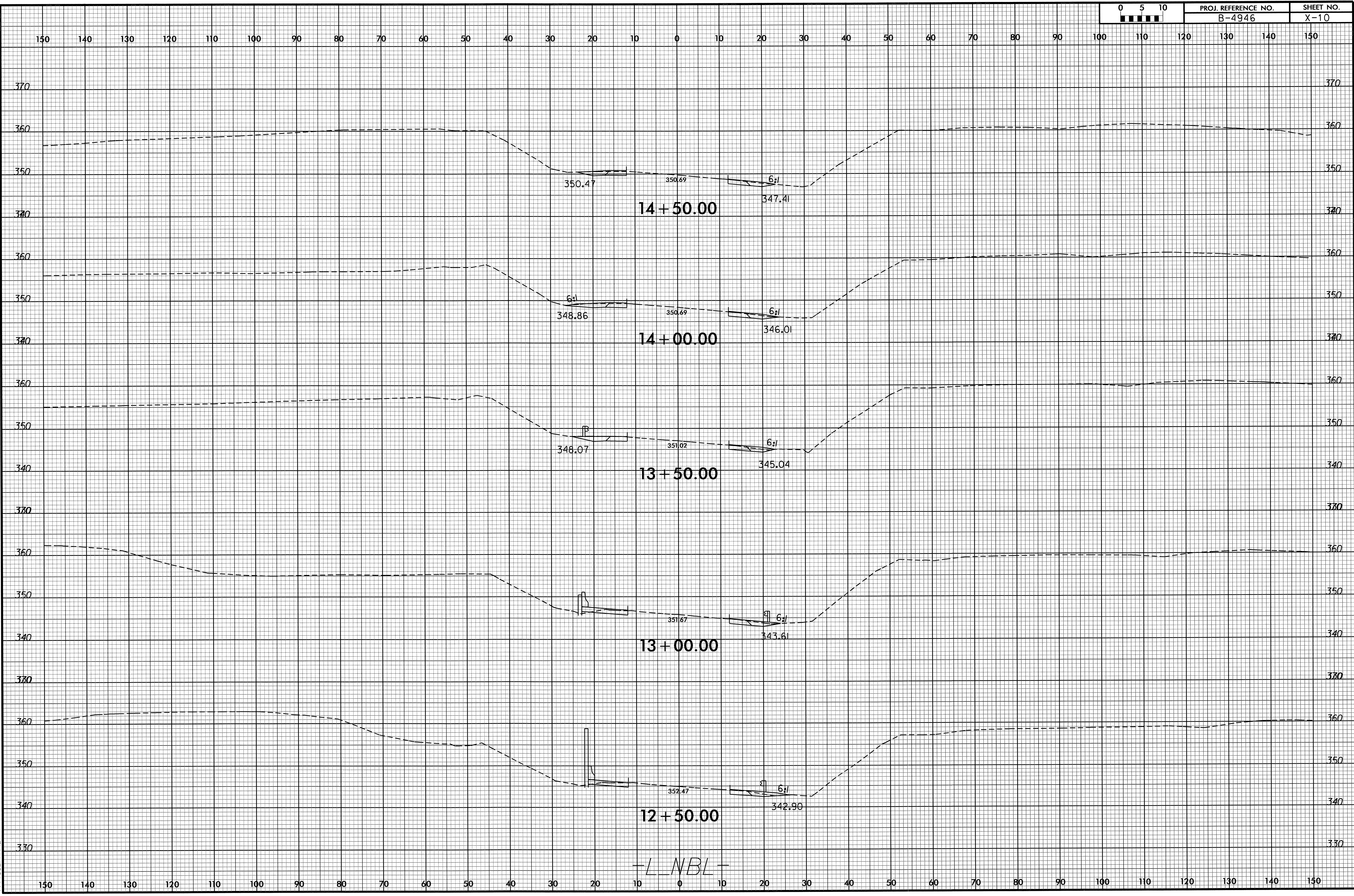

08-JAN-2013 17:07  
R:\Roadwork\X5C\B4946\_Rdy\_Xpl\_1.nbl.dgn  
USER:RDM



8/23/99



PROJ. REFERENCE NO.
B-4946

SHEET NO.
X-11

150 140 130 120 110 100 90 80 70 60 50 40 30 20 10 0 10 20 30 40 50 60 70 80 90 100 110 120 130 140 150

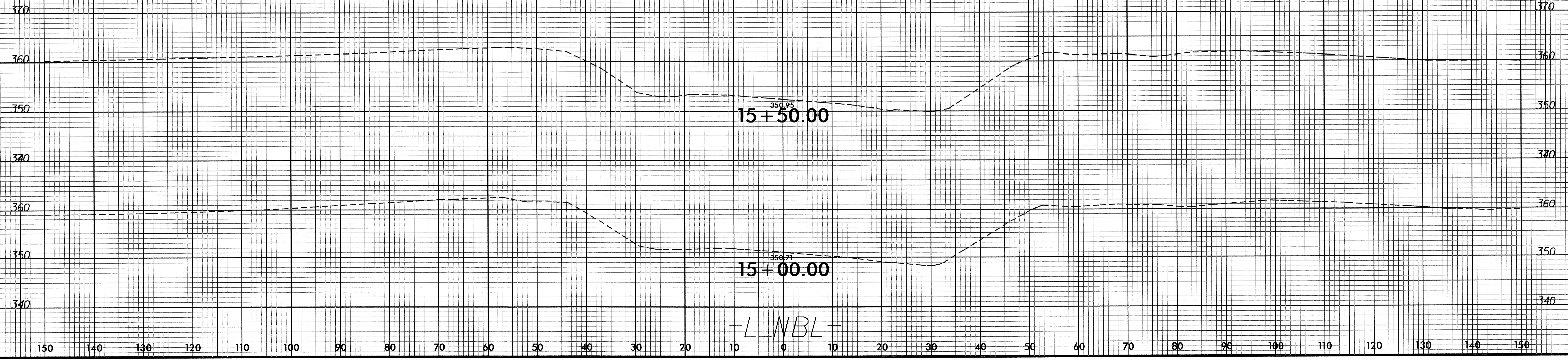

08-JAN-2013 17:07  
R:\Roadway\XSC\B4946\_Rdy\_Xpl\_1\_nbl.dgn  
\$\$\$\$\$USERNAME\$\$\$\$\$