

CROSS-SECTION INDEX

CROSS-SECTION SUMMARY SHEET	X-1A
-L-	X-2 TO X-5

STATE OF NORTH CAROLINA
DIVISION OF HIGHWAYS

PROJ. REFERENCE NO.
B-4561

SHEET NO.
X-1A

NOTE: EMBANKMENT COLUMN DOES NOT INCLUDE BACKFILL FOR UNDERCUT

CROSS-SECTION SUMMARY

Notes:

- 1) Earthwork quantities are calculated by the Roadway Design Unit. These earthwork quantities are based in part on subsurface data provided by the Geotechnical Engineering Unit.
- 2) Approximate quantities only. Unclassified excavation, borrow excavation, fine grading, clearing & grubbing, and removal of existing asphalt pavement will be paid for at the lump sum price for "Grading".

Station -L-	Uncl. Exc. (cu. yd.)	Embt (cu. yd.)
BUS TURNAROUND		
09+60.00	0	0
09+80.00	1	76
TOTALS	1	76

Station -L-	Uncl. Exc. (cu. yd.)	Embt (cu. yd.)
11+30.00	0	0
11+50.00	2	29
12+00.00	4	249
12+50.00	1	250
12+62.25	0	36
TOTALS	7	564

Station -L-	Uncl. Exc. (cu. yd.)	Embt (cu. yd.)
14+49.75	0	0
14+50.00	0	0
15+00.00	16	94
15+50.00	7	131
15+80.00	3	31
TOTALS	26	256

Station -L-	Uncl. Exc. (cu. yd.)	Embt (cu. yd.)
REMOVE BUS TURNAROUND		
09+60.00	0	0
09+80.00	95	0
TOTALS	95	0

GRAND TOTALS	129	896
--------------	-----	-----

8/23/99

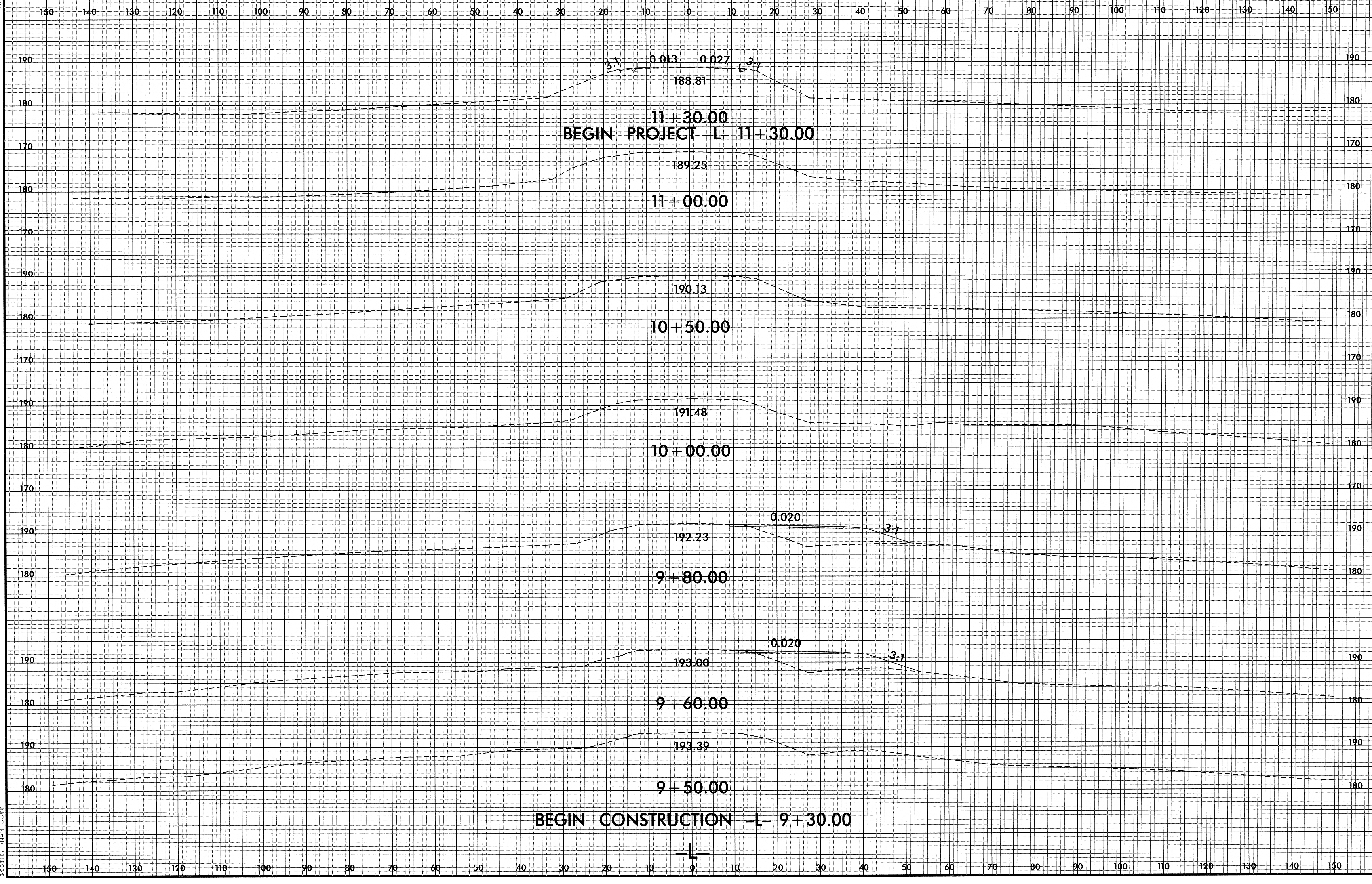

30-NOV-2012 12:10 P 4561_Pdu_xp1.dwg
S:\PROJECTS\B-4561\8/23/99

8/23/99

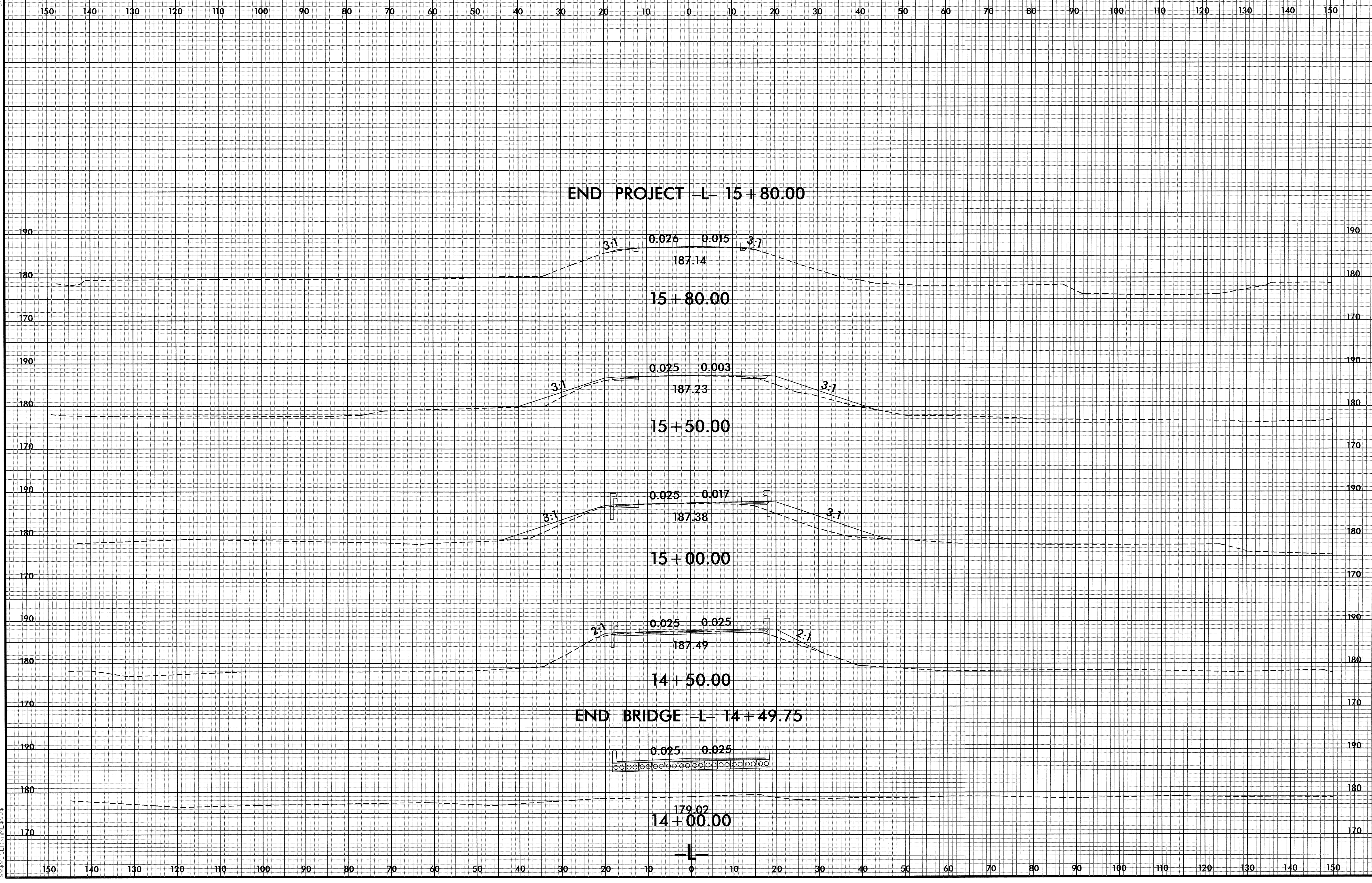

J:\JAN 2013 1019
33302\PROJECT\B-4561_Rdy.xpl_CM.dgn

8/23/99

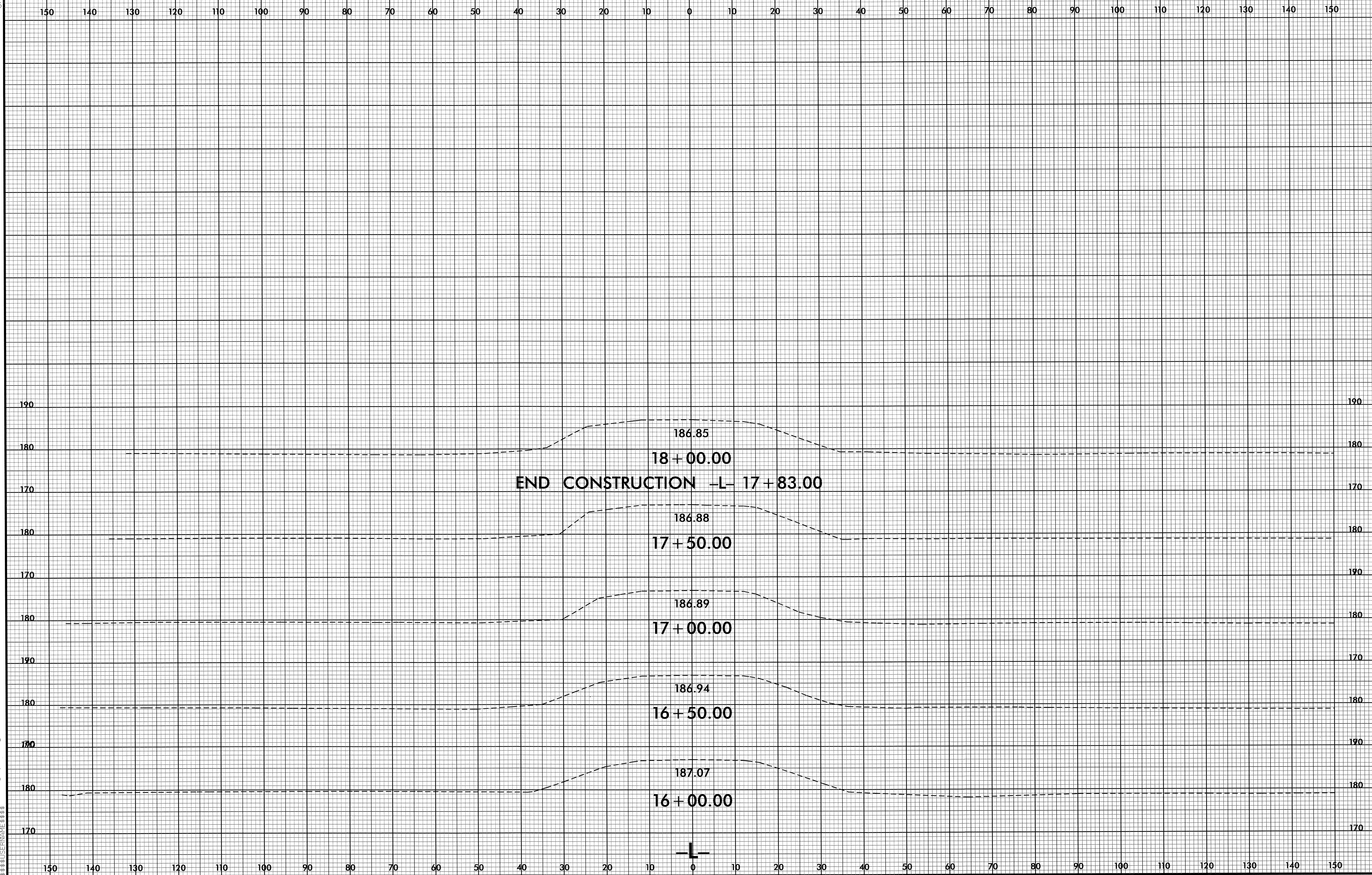

30-NOV-2012 12:10 P. 0_4561-F.dwg -xp1-DM.dgn