

**T.I.P.: P-5206A**

**CONTRACT:**

**STATE OF NORTH CAROLINA  
DEPARTMENT OF TRANSPORTATION**



<small>TIP NO.</small> P-5206A	<small>SHEET NO.</small> PMP-1
<small>APPROVED:</small> <i>Tyson A. Graves</i>	
<small>DATE:</small> 2-15-13	
	

**PAVEMENT MARKING PLAN  
ROWAN COUNTY**

**INDEX**

<u>SHEET NO.</u>	<u>DESCRIPTION</u>
PMP-1	PAVEMENT MARKING PLAN COVER SHEET
PMP-2	PAVEMENT MARKING SCHEDULE
PMP-3 - 9	PAVEMENT MARKING DETAILS

**ROADWAY STANDARD DRAWING**

THE FOLLOWING ROADWAY STANDARDS AS APPEAR IN "ROADWAY STANDARD DRAWINGS" - PROJECT SERVICES UNIT - N.C. DEPARTMENT OF TRANSPORTATION - RALEIGH, N.C., DATED JANUARY 2012 ARE APPLICABLE TO THIS PROJECT AND BY REFERENCE HEREBY ARE CONSIDERED A PART OF THESE PLANS:

<u>STD. NO.</u>	<u>TITLE</u>
1205.01	PAVEMENT MARKINGS - LINE TYPES AND OFFSETS
1205.02	PAVEMENT MARKINGS - TWO-LANE AND MULTILANE ROADWAYS
1205.04	PAVEMENT MARKINGS - INTERSECTIONS
1205.06	PAVEMENT MARKINGS - LANE DROPS
1205.12	PAVEMENT MARKINGS - BRIDGES
1205.13	PAVEMENT MARKINGS - LANE REDUCTIONS
1250.01	RAISED PAVEMENT MARKERS - INSTALLATION SPACING
1251.01	RAISED PAVEMENT MARKERS - PERMANENT AND TEMPORARY
1261.01	GUARDRAIL AND BARRIER DELINEATORS - INSTALLATION SPACING
1261.02	GUARDRAIL AND BARRIER DELINEATORS - TYPES AND MOUNTING
1262.01	GUARDRAIL END DELINEATION

**GENERAL NOTES**

THE FOLLOWING GENERAL NOTES APPLY AT ALL TIMES FOR THE DURATION OF THE CONSTRUCTION PROJECT, EXCEPT WHEN OTHERWISE NOTED IN THE PLAN, OR DIRECTED BY THE ENGINEER.

- A) INSTALL PAVEMENT MARKINGS AND PAVEMENT MARKERS ON THE FINAL SURFACE AS FOLLOWS:
 

ROAD NAME	MARKING	MARKER
ALL ROADS	THERMOPLASTIC	RAISED
BRIDGE DECKS	COLD APPLIED PLASTIC	RAISED
- B) TIE PROPOSED PAVEMENT MARKING LINES TO EXISTING PAVEMENT MARKING LINES.
- C) REMOVE/REPLACE ANY CONFLICTING/DAMAGED PAVEMENT MARKINGS AND MARKERS.
- D) PASSING ZONES WILL BE DETERMINED IN THE FIELD AND MUST BE APPROVED BY THE ENGINEER.
- E) STOP BAR LOCATION AT NON-SIGNALIZED INTERSECTIONS MAY BE ADJUSTED AS DIRECTED BY THE ENGINEER.
- F) REMOVE ALL RESIDUE AND SURFACE LAITANCE BY ACCEPTABLE METHODS ON CONCRETE BRIDGE DECKS PRIOR TO PLACING (COLD APPLIED PLASTIC TYPE II OR III) PAVEMENT MARKING MATERIAL.
- G) UNLESS OTHERWISE SPECIFIED, HEATED-IN-PLACE THERMOPLASTIC MAY BE USED IN LIEU OF EXTRUDED THERMOPLASTIC FOR STOP BARS, SYMBOLS, CHARACTERS AND DIAGONALS. IF HEATED-IN-PLACE IS USED, IT SHALL BE PAID FOR USING THE EXTRUDED THERMOPLASTIC PAY ITEM.

**N.C.D.O.T. SIGNING AND DELINEATION UNIT CONTACT**

**SUSAN KUNZ** SIGNING & DELINEATION REGIONAL ENGINEER  
**JAMES HAMBRIGHT** SIGNING & DELINEATION PROJECT DESIGN ENGINEER

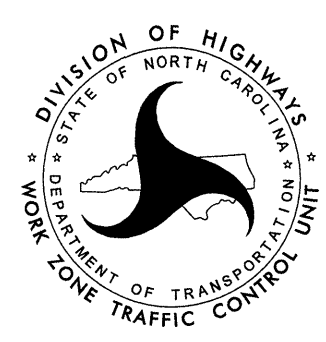

**PLAN PREPARED BY: FLORENCE & HUTCHESON**

**TYSON A. GRAVES, PE** PROJECT ENGINEER  
 \_\_\_\_\_ DESIGNER



**Florence & Hutcheson**  
 CONSULTING ENGINEERS  
5121 Kingdom Way, Suite 100 Raleigh, NC 27607  
 NC License No: F-0258



TIP NO. P - 5206A	SHEET NO. PMP - 2
APPROVED: <i>[Signature]</i>	
DATE: 2-15-13	
SEAL	

FINAL PAVEMENT MARKING SCHEDULE

SYMB	DESCRIPTION
	COLD APPLIED PLASTIC TYPE 2
CA	WHITE EDGELINE
CI	YELLOW DOUBLE CENTER
	THERMOPLASTIC(24", 120 MILS)
T2	WHITE STOPBAR
	THERMOPLASTIC(4", 120 MILS)
T8	2 FT. - 6 FT./SP WHITE MINISKIP
TC	10 FT. WHITE SKIP
TD	3 FT. - 9 FT./SP WHITE MINISKIP
TE	WHITE SOLID LANE LINE
TF	10 FT. YELLOW SKIP
TH	YELLOW SINGLE CENTER
TI	YELLOW DOUBLE CENTER
	THERMOPLASTIC(4", 90 MILS)
TA	WHITE EDGELINE
	THERMOPLASTIC PAVEMENT MARKING SYMBOLS (90 MILS)
UA	LEFT TURN ARROW
UB	RIGHT TURN ARROW
UC	STRAIGHT ARROW
	MARKERS - PERMANENT RAISED PAVEMENT MARKERS
MA	YELLOW & YELLOW
MB	CRYSTAL & RED
MD	YELLOW

2/15/2013  
 P:\TIP\5206A\5206A\Traffic\Signing\CADD\Signing Layout Plans\5206a\_pm\_schedule.dgn  
 Florence & Hutcheson

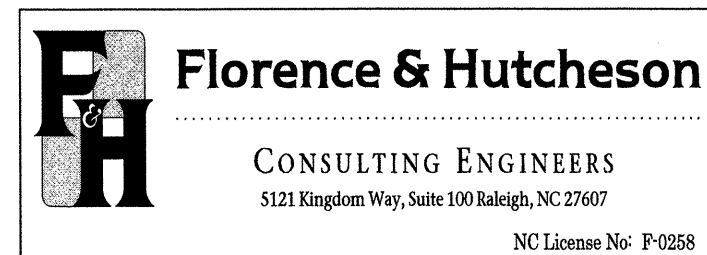

**PAVEMENT MARKING SCHEDULE**

0151DEL\_P10b1



TIP NO. P-5206A	SHEET NO. PMP-3
APPROVED: <i>[Signature]</i>	
DATE: 2-15-13	
SEAL	

-Y2- STA. 11+50.00  
BEGIN PROJECT  
TIE TO EXISTING

-Y3- STA. 10+30±

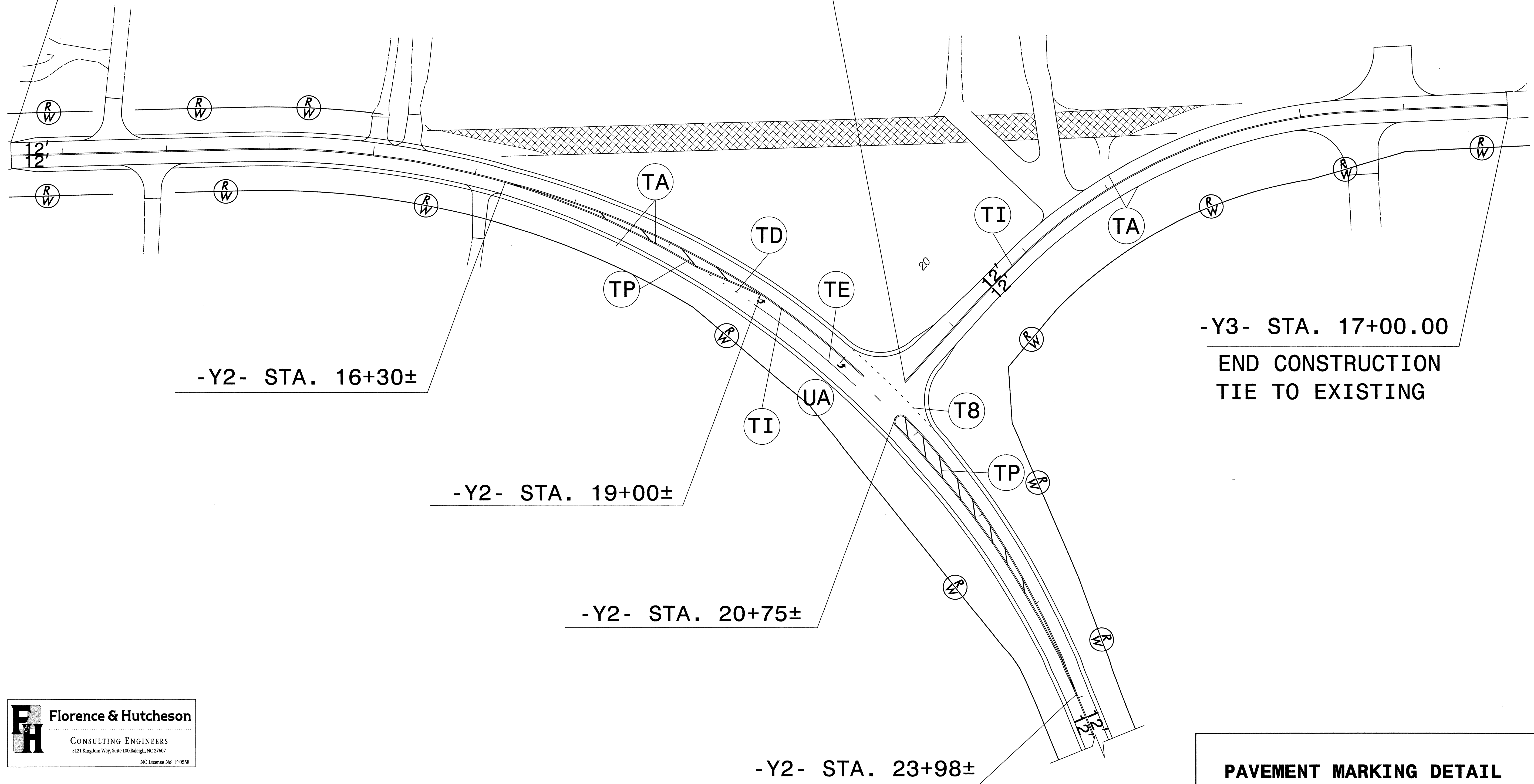

-Y3- STA. 17+00.00  
END CONSTRUCTION  
TIE TO EXISTING

**FH** Florence & Hutcheson  
CONSULTING ENGINEERS  
5121 Kingdom Way, Suite 100 Raleigh, NC 27607  
NC License No. F-0258

**PAVEMENT MARKING DETAIL**

2/15/2013 2:41:14 PM P:\5206A\5206A\Traffic\Signing\CADD\Signing Layout Plans\5206a\_PM\_dtl1.dgn Florence & Hutcheson

0151DEL\_P10b1



TIP NO. P-5206A	SHEET NO. PMP-4
APPROVED: <i>[Signature]</i>	
DATE: 2-15-13	
SEAL	

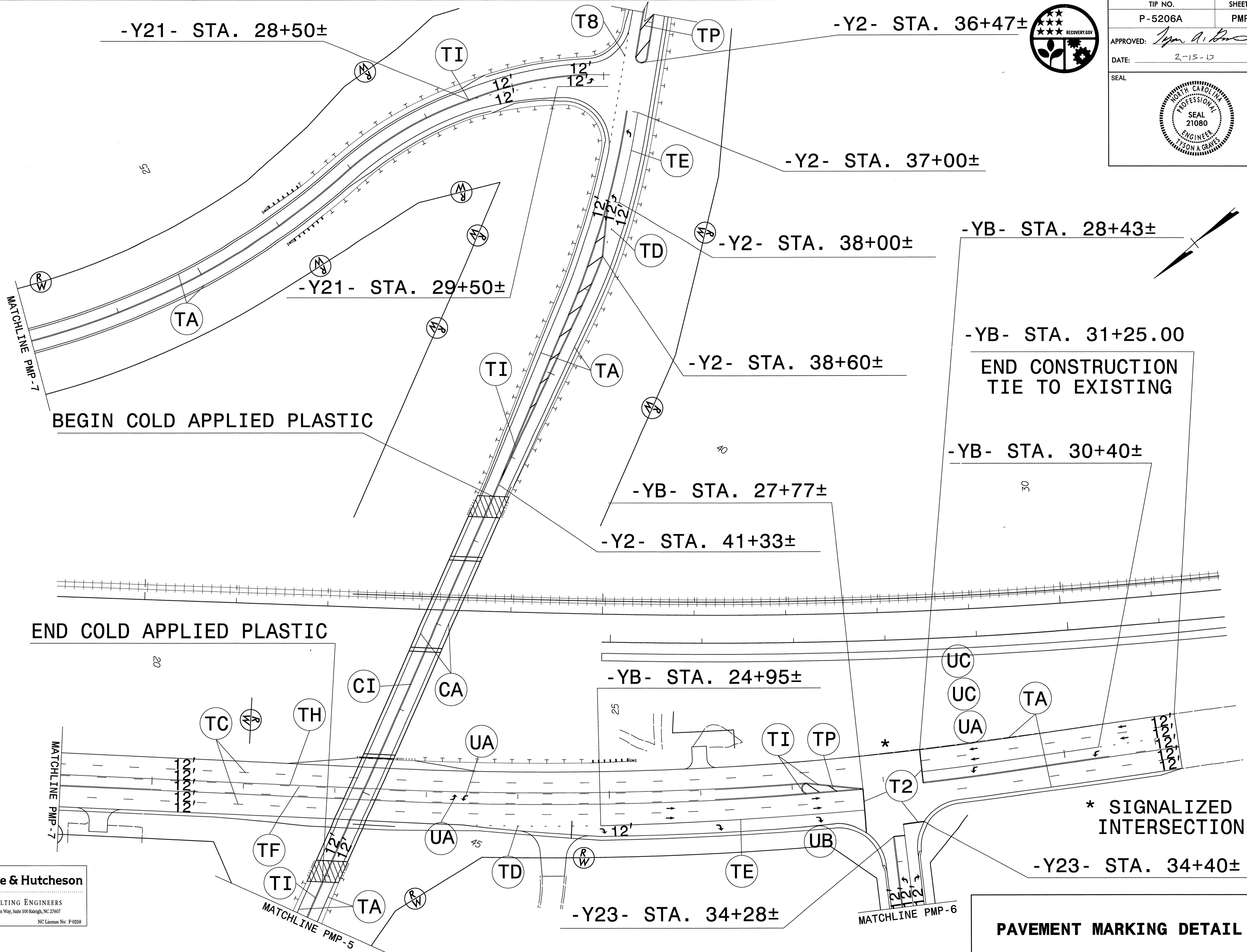

**Florence & Hutcheson**  
 CONSULTING ENGINEERS  
 5121 Kingdom Way, Suite 100 Raleigh, NC 27607  
 NC License No. P-0298

**PAVEMENT MARKING DETAIL**

2/15/2013 2:41:05 PM P:\5206A\Traffic\Signing\CADD\Signing Layout Plans\p5206a\_pm.dtl2.dgn Florence & Hutcheson

0151DEL\_P10b1



TIP NO. P-5206A	SHEET NO. PMP-5
APPROVED: <i>[Signature]</i>	
DATE: 1-16-13	
SEAL	

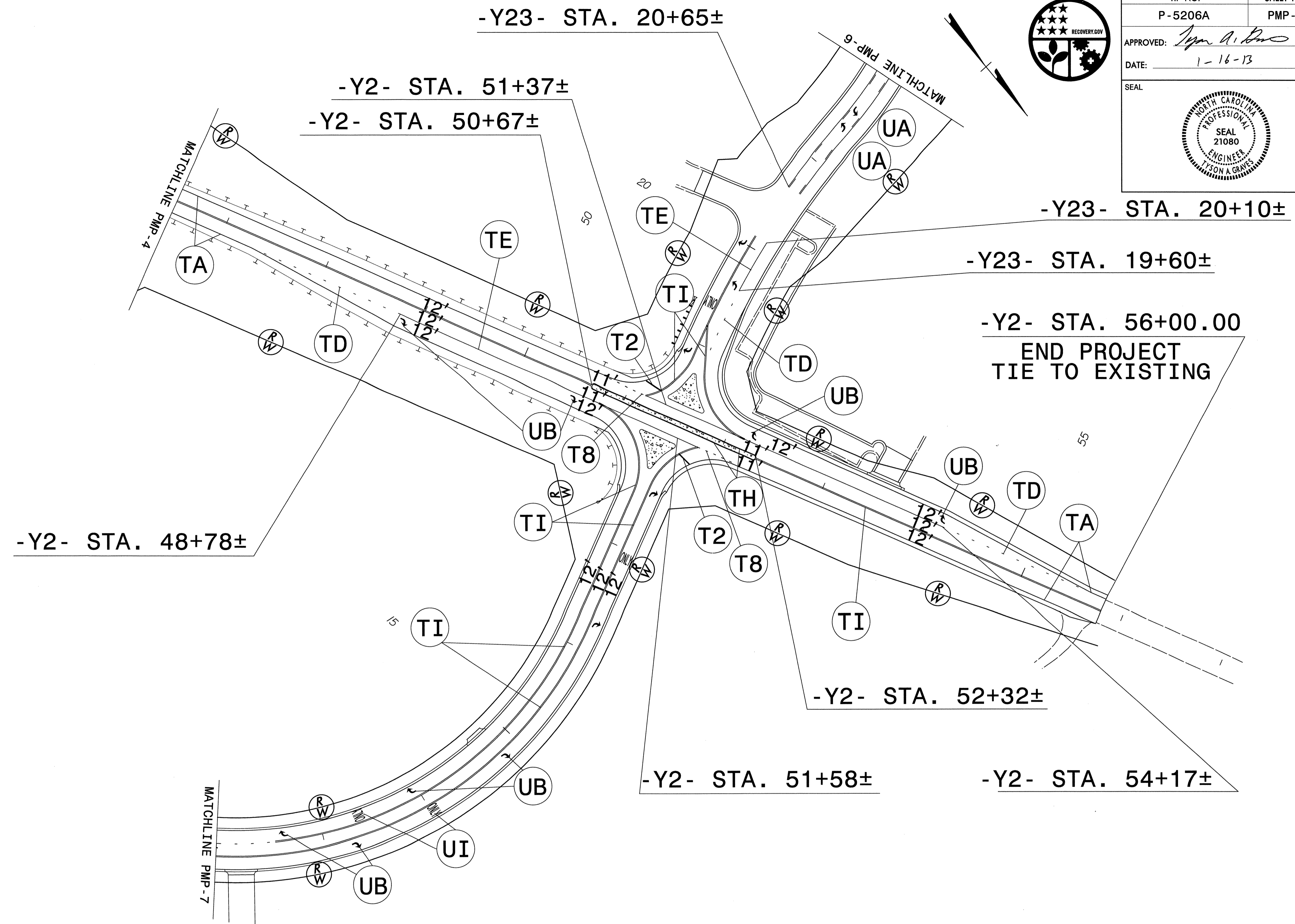

2/15/2013 2:41:14 PM P:\5206A\5206A\Traffic\Signing\CADD\Signing Layout Plans\5206a\_PM\_dtl3.dgn Florence & Hutcheson

**FH** Florence & Hutcheson  
 CONSULTING ENGINEERS  
 5121 Kingdom Way, Suite 100 Raleigh, NC 27607  
 NC License No. F-0258

**PAVEMENT MARKING DETAIL**

0151DEL\_P10b1



TIP NO. P-5206A	SHEET NO. PMP-6
APPROVED: <i>[Signature]</i>	
DATE: 2-15-13	
SEAL	

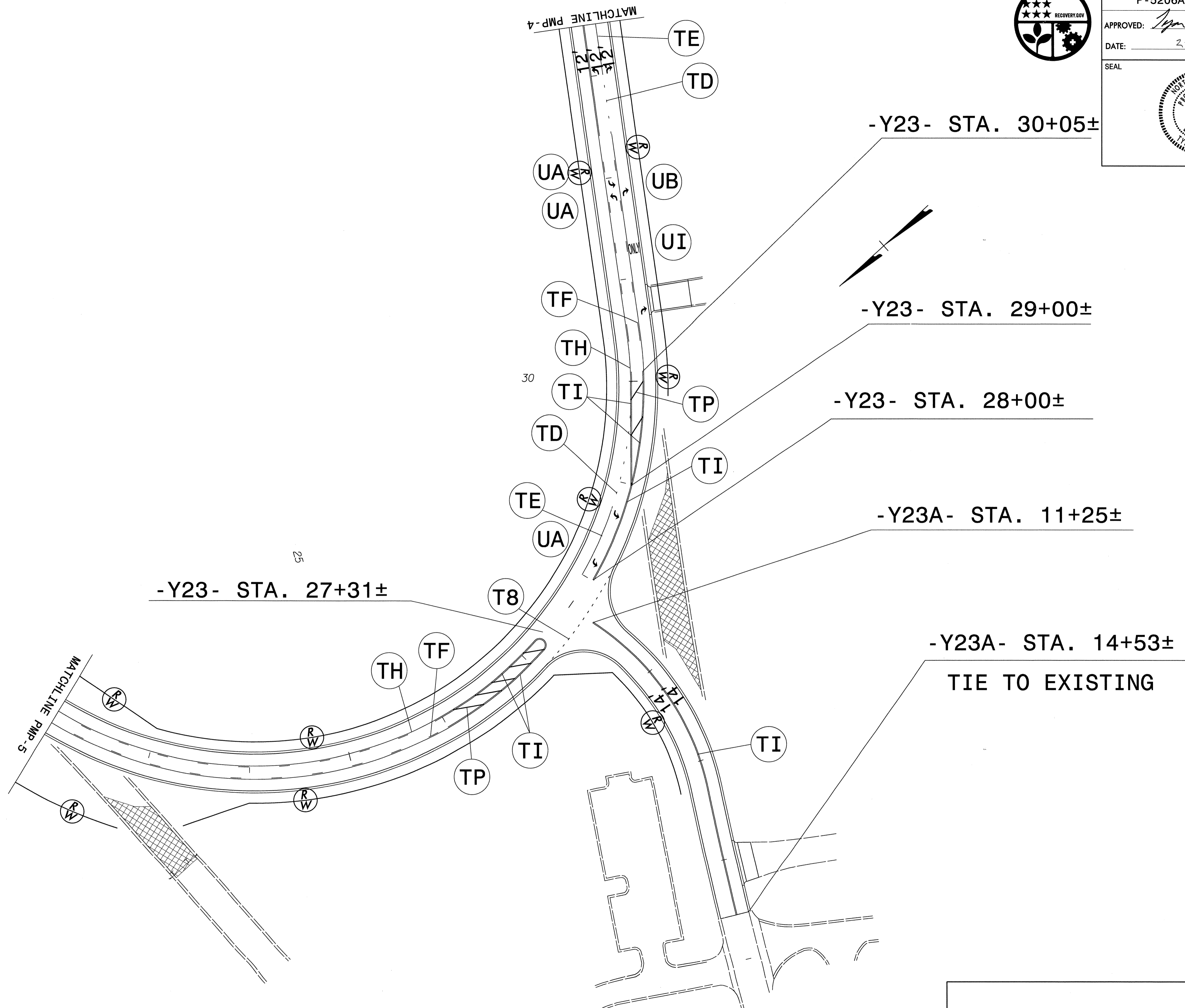

2/15/2013  
E:\TIP\5206A\5206A\Traffic\Signing\CADD\Signing Layout Plans\5206a\_PM\_d114.dgn  
Florence & Hutcheson

**FH** Florence & Hutcheson  
CONSULTING ENGINEERS  
5121 Kingdom Way, Suite 100 Raleigh, NC 27607  
NC License No. F-0258

**PAVEMENT MARKING DETAIL**

0151DEL\_P10b1



TIP NO. P-5206A	SHEET NO. PMP-7
APPROVED: <i>[Signature]</i>	
DATE: 2-15-13	
SEAL	

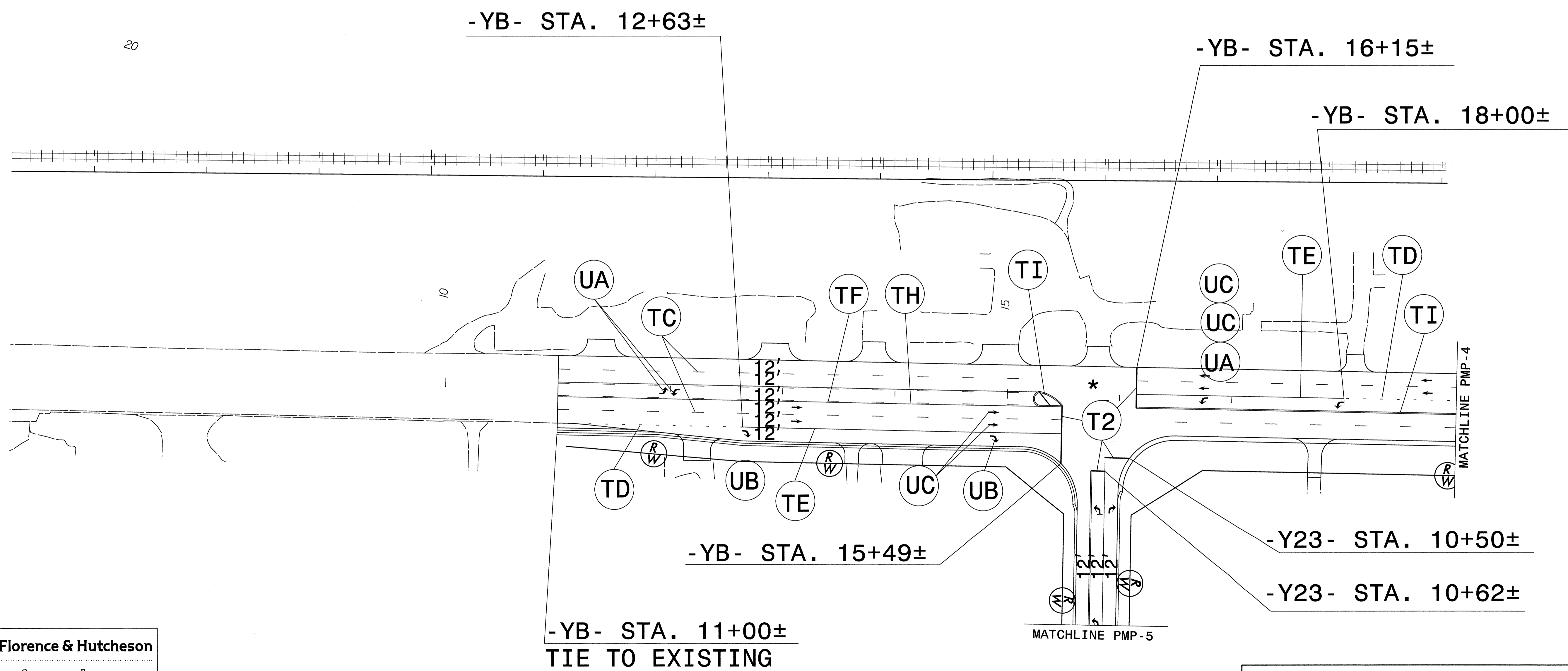
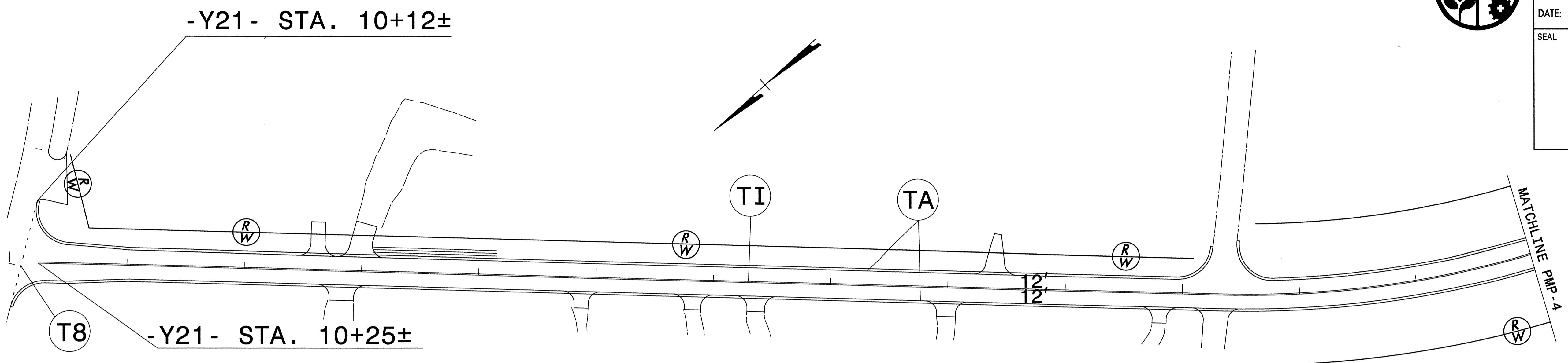

-YB- STA. 11+00±  
TIE TO EXISTING

\* SIGNALIZED INTERSECTION

PAVEMENT MARKING DETAIL

2/15/2013  
 P:\TIP\5206A\_P5206A\_Traf Fic\Signing\CADD\Signing Layout Plans\p5206a\_PM\_dtl5.dgn  
 Florence & Hutcheson

**Florence & Hutcheson**  
 CONSULTING ENGINEERS  
 5121 Kingdom Way, Suite 100 Raleigh, NC 27607  
 NC License No: P-0258

DGN  
0151DEL\_P10b1



TIP NO. P-5206A	SHEET NO. PMP-8
APPROVED: <i>Tyson A. Graves</i>	
DATE: 2-15-13	
SEAL	

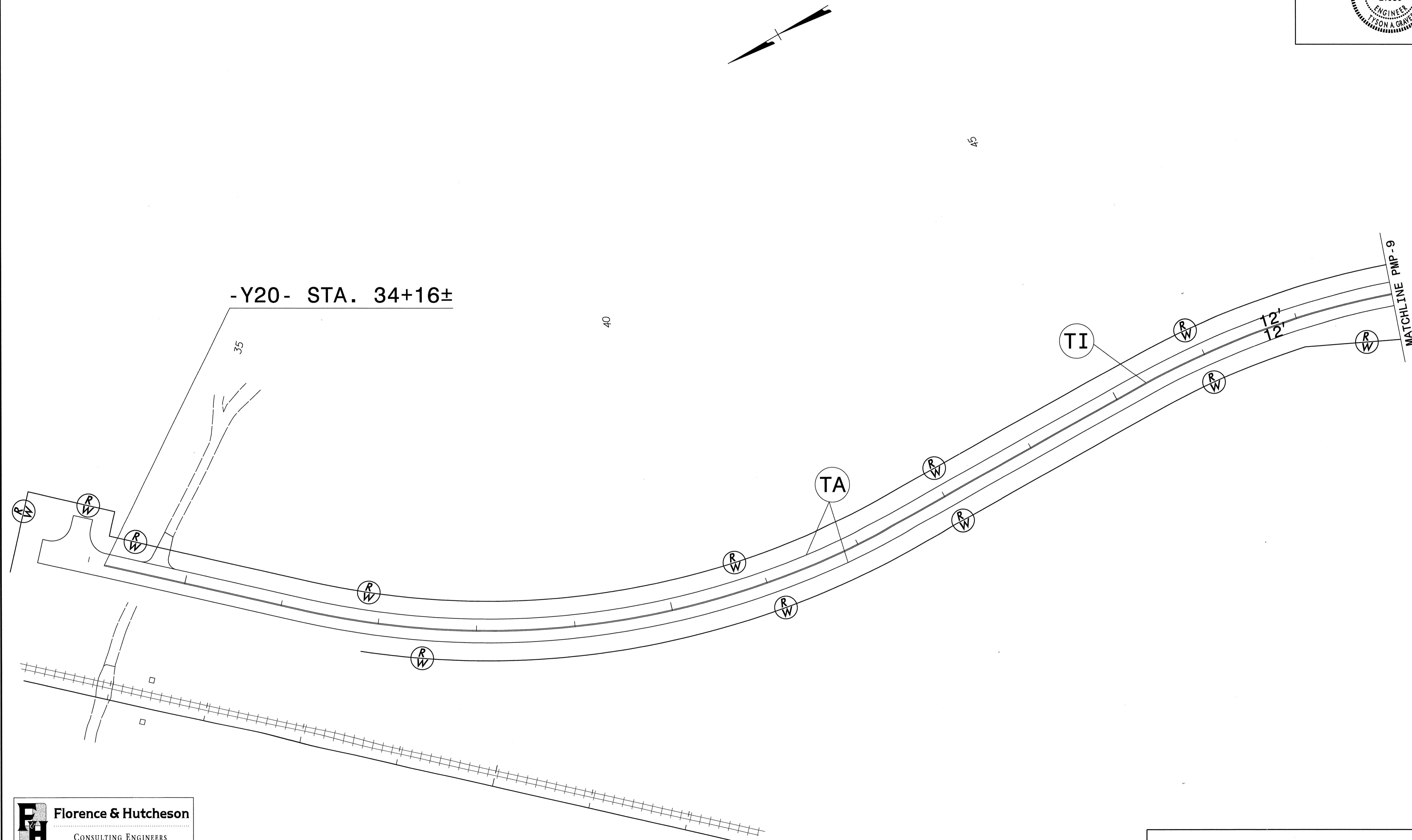

2/15/2013  
P:\TIP\5206A\5206A\_Traffic\Signing\CADD\Signing Layout Plans\p5206a\_PM.dwg  
Florence & Hutcheson

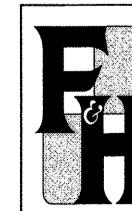
 **Florence & Hutcheson**  
CONSULTING ENGINEERS  
5121 Kingdom Way, Suite 100 Raleigh, NC 27607  
NC License No. P-0258

**PAVEMENT MARKING DETAIL**



0151DEL\_P10b1



TIP NO. P-5206A	SHEET NO. PMP-9
APPROVED: <i>[Signature]</i>	
DATE: 2-15-13	
SEAL	

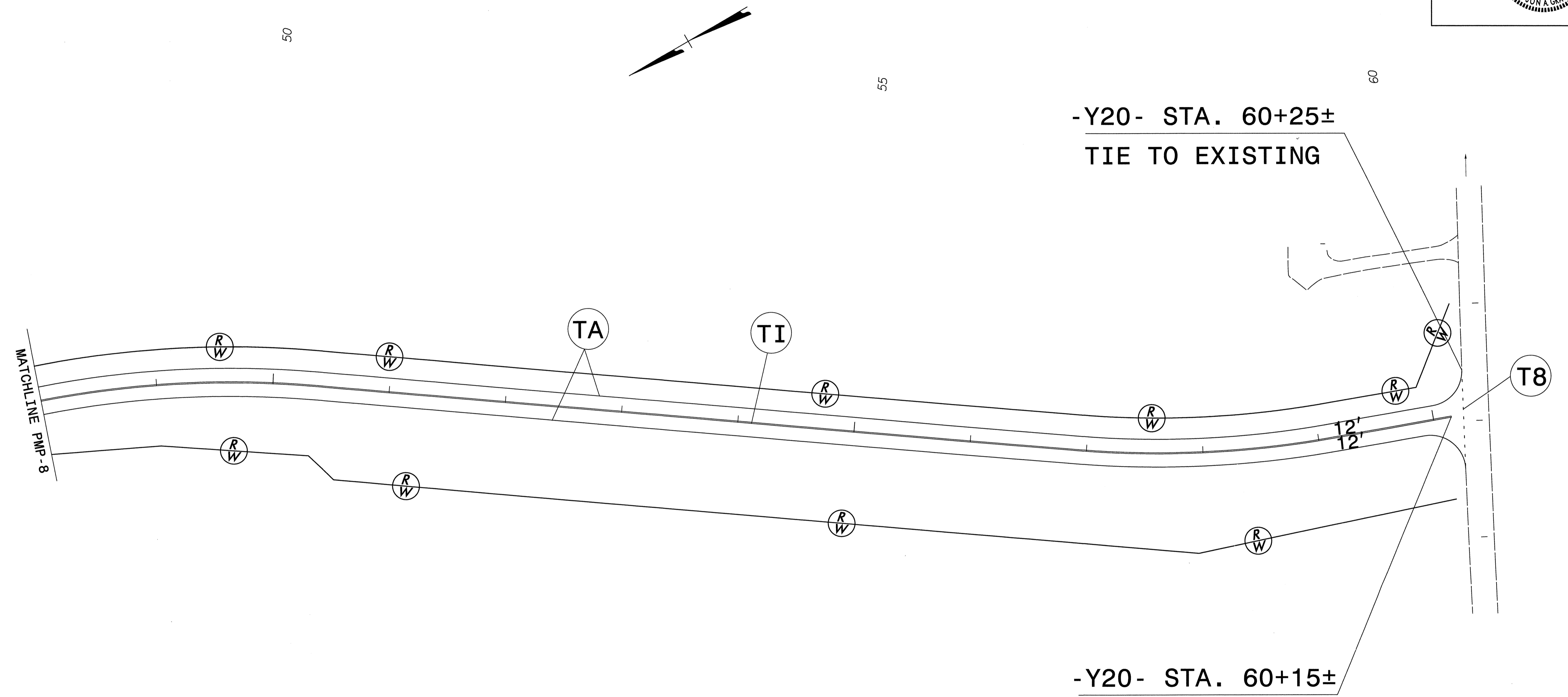

2/15/2013 2:41:15 PM P:\5206A\Traffic\Signing\CADD\Signing Layout Plans\5206a\_PM\_dtl7.dgn Florence & Hutcheson

**FH** Florence & Hutcheson  
 CONSULTING ENGINEERS  
 5121 Kingdom Way, Suite 100 Raleigh, NC 27607  
 NC License No. P-0258

**PAVEMENT MARKING DETAIL**