

PROJECT NO.	818293
DATE	8/18/29
DESIGNER	W. B. B.
CHECKED	W. B. B.
APPROVED	W. B. B.

NOTES

Loading: AA SHD H20-S16-44 and BPR Modified Loading for Military Vehicles.

Future surfacing: 20 lb. per sq ft.

Roadway width: 34'-0" curb to curb.

For other design data and general notes, see General Notes sheet.

Concrete surfaces shall be given a surface finish in accordance with the specifications.

The Contractor will be required to drive one 45' 12BP53 steel test pile in place at Bent 1. The test pile shall be paid for as linear feet of 12BP53 Steel Piles. The order lengths for all piles shall be given after the test pile has been driven.

All piles at End Bents shall be driven through the roadway fill.

Piles for all Bents and End Bents shall be driven to a minimum bearing capacity of 30 tons.

I certify that this Structure was built According to Plans Except as noted.

RESIDENT ENGINEER

Benchmark: Nail in power pole, 16' x 12' x 2" 3' up on pole.
 7147 2003.18
 Benchmark: U.S.C. & G.S. Monument, Station base of R.R. Signal, Elevation 2050.44
 ⊕ Indicates 2 1/2" cased hole boring.
 ∇ Indicates ground water.

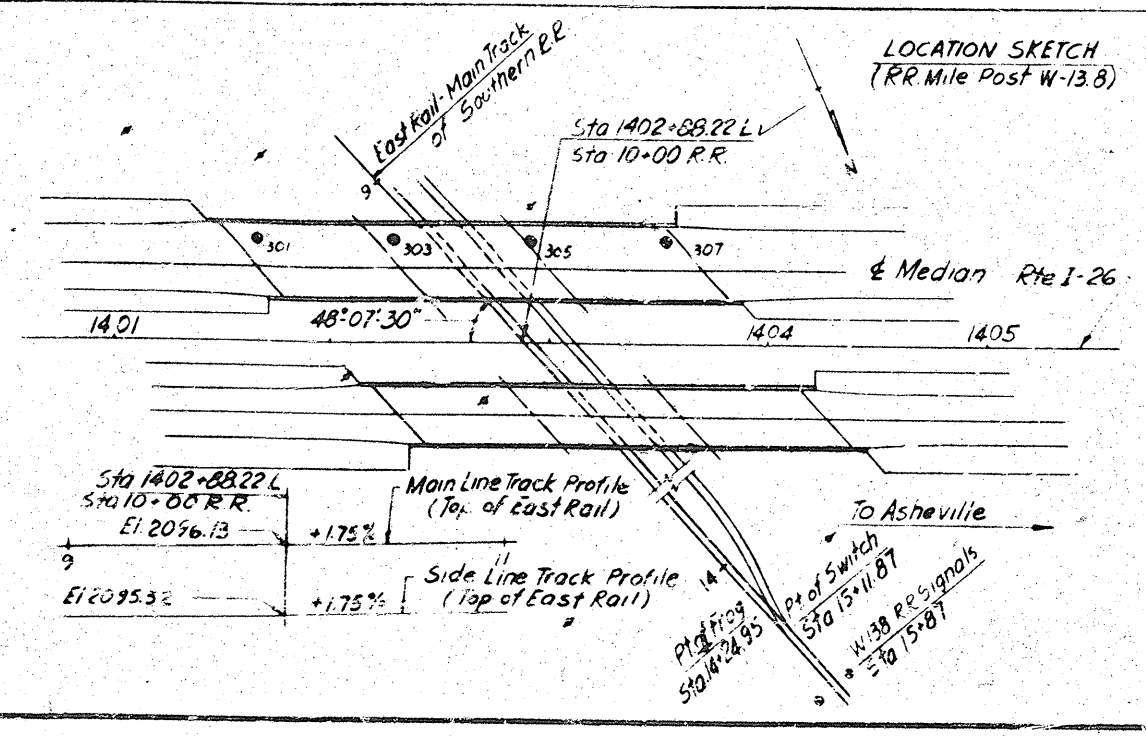

Crown of Roadway Elevations

Station	Elevation	Station	Elevation	Station	Elevation
1401+45	2124.75	1402+25	2124.43	1403+05	2123.91
	2124.74		2124.41		2123.86
	2124.73		2124.38		2123.82
	2124.71		2124.35		2123.77
	2124.70		2124.32		2123.72
	2124.69		2124.28		2123.68
	2124.67		2124.25		2123.63
	2124.66		2124.22		2123.58
	2124.64		2124.18		2123.53
	2124.62		2124.15		2123.47
	2124.60		2124.11		2123.42
	2124.58		2124.07		2123.37
	2124.56		2124.03		2123.31
	2124.54		2123.99		2123.26
	2124.51		2123.95		2123.20
1402+20	2124.49	1403+00	2123.95	1403+80	2123.14

Total Bill of Material

	Class "A" Concrete Cu. Yds.	Reinforcing Steel Lbs.	Structural Steel Approx. Lbs.	12BP53 Steel Piles No. Lin. Ft.	Unclass. Str. Excav Cu. Yds.	Single Bar Aluminum Rail Lin. Ft.
Superstructure	240.80	578,729	218,400	699-2	406.14	
End Bent #1	21.8	4,339		12		
Bent #1	57.8	9,958		18	62-50.37	
Bent #2	59.2	10,181		18	76-04.63	
End Bent #2	22.4	4,339		12	75-0	
Approach Curbs	3.2	76		70-2		
Totals:	404.80	696,773	218,400	2702-8	1510.21	406.14

Rev. #2 to change test pile length v. 081
 Rev. #3 to change Reinforcing Steel Quantities v. 081
 Revision No. 4. To change length of metal rail.

PROJECT NO. 818293
 HENDERSON COUNTY
 STATION 1402+88L
 S.B. Bridge & NB

STATE OF NORTH CAROLINA
 STATE HIGHWAY COMMISSION

GENERAL DRAWING
 BRIDGE OVER
 SOUTHERN RAILWAY
 ON PROPOSED SOUTHBOUND
 INTERSTATE ROUTE 26

SUBMITTED BY: *J. B. B.*
 APPROVED BY: *W. B. B.*
 DATE: 8/11/29

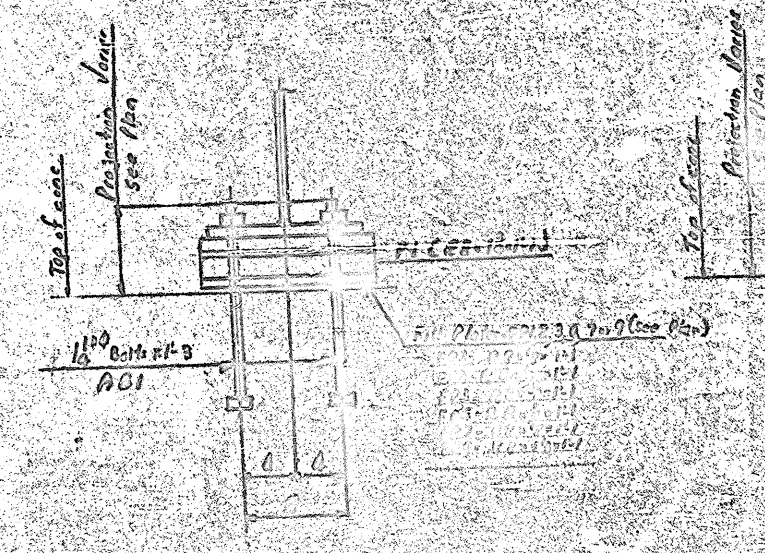
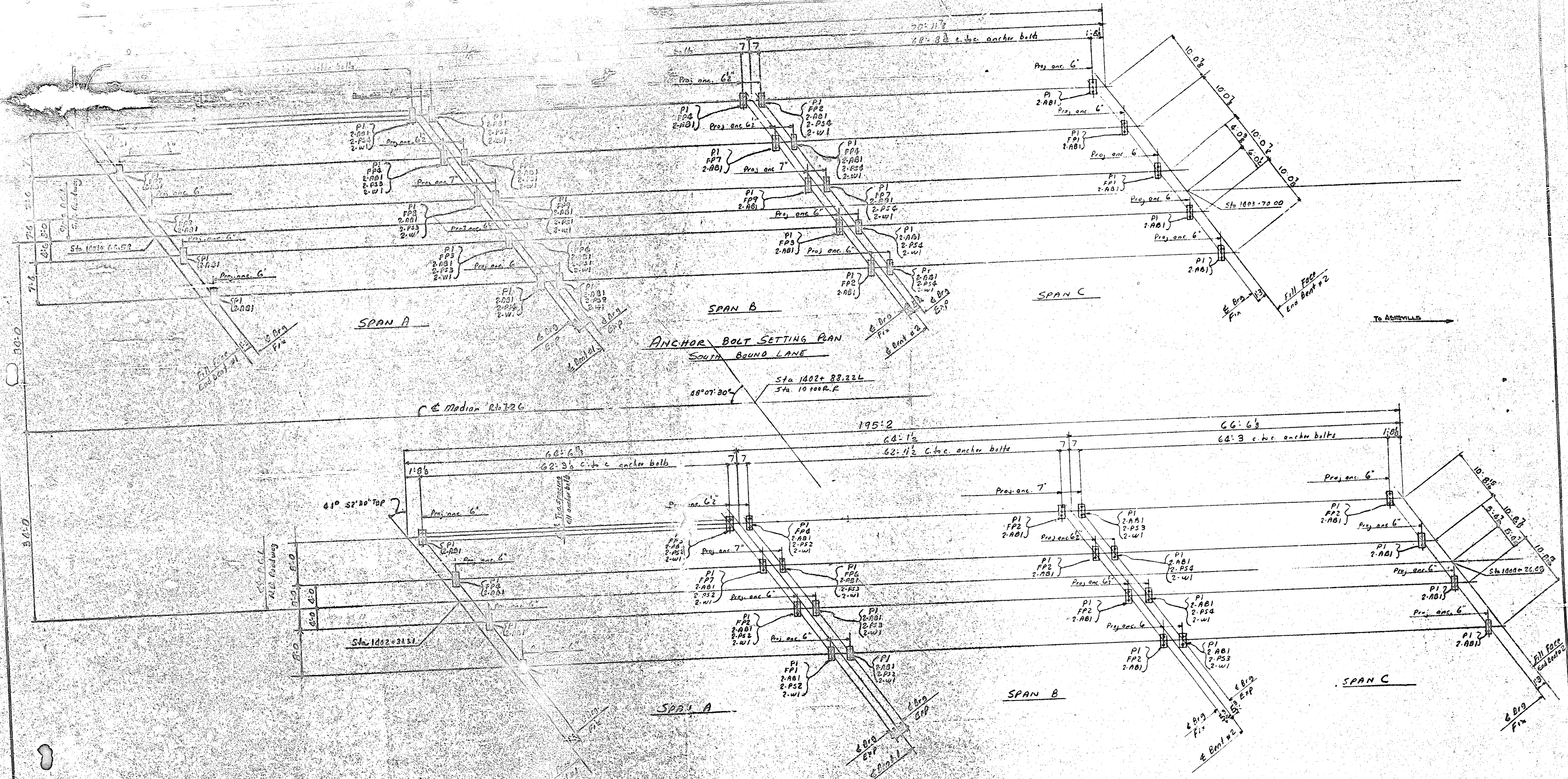

ANCHOR BOLT SETTING PLAN
NORTH BOUND LANE
 All dimensions are in a horizontal plane

NOTE: Station # appears on shipping piece in addition to erection mark.

NO.	DATE	DESCRIPTION
1	6-28-84	

STATION # 1402+88L PROJECT # 8.18293	
MARKO ENGINEERING CO. CHARLOTTE, N. C.	
SHOP PAINT	BRIDGE OVER RAILROAD RAILROAD AT 26
BOLTS OR RIVETS	UNLESS NOTED
ROLES	UNLESS NOTED
REVISIONS	LOCATION HENDERSON CO. N.C.
1	DETAILS OF ANCHOR BOLT PLAN N.A.S. 6 LANE
2	CUSTOMER Wilson Construction Co. Inc.
3	AGENT N.C. State Hwy. Comm.
CONTRACT NO. 1163-D	DESIGNED BY J.C.C. CHECKED BY R.W.

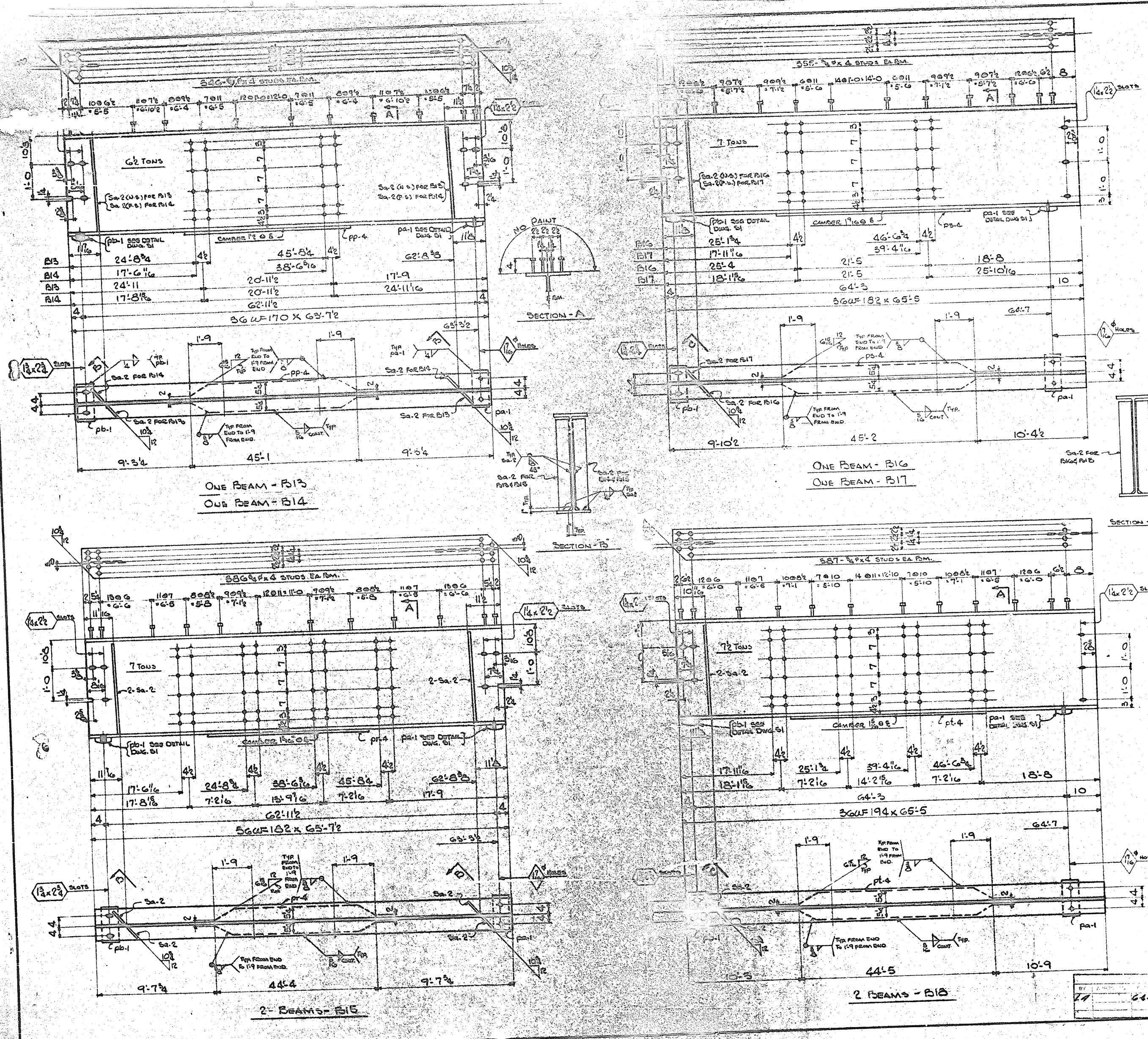

MATERIAL LIST		SHOP BILL		ORDERED								
QUANTITY	SHIPPING WEIGHT	NO. Pcs	MATERIAL	LENGTH FT. IN.	NO. MARK	REMARKS	WEIGHT PER Pcs	NO. Pcs	LENGTH FT. IN.	NOTES	ITEM	STATUS
ONE	B13	ONE	36WF170	65 7 1/2	65 7 1/2	camber					1-3	
		ONE	RC6x14	1 1	pa-1	SEE DETAIL Dwg. 51					1-7	
		ONE	RC6x14	1 1	pb-1	SEE DETAIL Dwg. 51					1-7	
		2	RC6x12	2 9	sa-2	F.I.E.					1-5	
		346	3/8 STUDS	0 4							1-5	
		ONE	RC10x24	45 1	pp-4						1-5	
ONE	B14	ONE	36WF170	65 7 1/2	65 7 1/2	camber					1-3	
		ONE	R		pa-1	SEE DETAIL Dwg. 51					1-3	
		ONE	R		pb-1	SEE DETAIL Dwg. 51					1-3	
		2	R		sa-2	F.I.E.					1-5	
		346	3/8 STUDS	0 4							1-5	
		ONE	R		pp-4						1-5	
2	B15	2	36WF182	65 7 1/2	65 7 1/2	camber					1-7	
		2	R		pa-1	SEE DETAIL Dwg. 51					1-3	
		2	R		pb-1	SEE DETAIL Dwg. 51					1-3	
		3	R		sa-2	F.I.E.					1-5	
		772	3/8 STUDS	0 4							1-5	
		2	RC10x24	44 4	pp-4						1-19	
ONE	B16	ONE	36WF182	65 5	65 5	camber					1-3	
		ONE	R		pa-1	SEE DETAIL Dwg. 51					1-3	
		ONE	R		pb-1	SEE DETAIL Dwg. 51					1-3	
		ONE	R		sa-2	F.I.E.					1-5	
		355	3/8 STUDS	0 4							1-5	
		ONE	RC10x24	45 2	pp-4						1-20	
ONE	B17	ONE	36WF182	65 5	65 5	camber					1-3	
		ONE	R		pa-1	SEE DETAIL Dwg. 51					1-3	
		ONE	R		pb-1	SEE DETAIL Dwg. 51					1-3	
		ONE	R		sa-2	F.I.E.					1-5	
		355	3/8 STUDS	0 4							1-5	
		ONE	R		pp-4						1-20	
2	B18	2	36WF194	65 5	65 5	camber					1-9	
		2	R		pa-1	SEE DETAIL Dwg. 51					1-3	
		2	R		pb-1	SEE DETAIL Dwg. 51					1-3	
		4	R		sa-2	F.I.E.					1-5	
		774	3/8 STUDS	0 4							1-5	
		2	RC10x24	44 5	pp-4						1-21	

BEAMS & COVER PLATES - ASTM-A95
 SLICE MATERIAL - ASTM-A7

NOTES: ONE COAT RED LEAD PAINT FOR ALL SURFACES EXCEPT DO NOT PAINT WITHIN 2 INCHES OF 1/8" OPEN HOLES OR AS SHOWN ON DETAILS. DO NOT PAINT SHOP CONTACT SURFACES. FLANGED OR FINISHED SURFACES TO RECEIVE A HOT MIXTURE OF WHITE LEAD TALLOW PLUMBED OIL. PAINT WEIGHT ON SHIPPING PIECES WHERE SHOWN. PAINT STATION 1402+84L ON SHIPPING PIECES IN ADDITION TO SHIPPING MARKS. SHOP INSPECTION BY FROTHING & ROBERTSON INC.

STATION 1402+84L PROJECT 8.18293

MARKO ENGINEERING CO.
 CHARLOTTE, N. C.

DESIGNED BY: [Signature]
 JOB NO. 1029 12.26

LOCATION: HENDERSON COUNTY, N.C.

DETAILS OF BEAMS (N.P. BRIDGE)

REVISIONS:

CUSTOMER: Wilson Const Co, Inc

ARCHT: J.C. STATE Highway Comm

CONTRACT NO. MGS-4
 DRAWN BY: JLD
 CKD BY: RLW

SHEET NO. K54 OF