

STATE OF NORTH CAROLINA
RAIL DIVISION

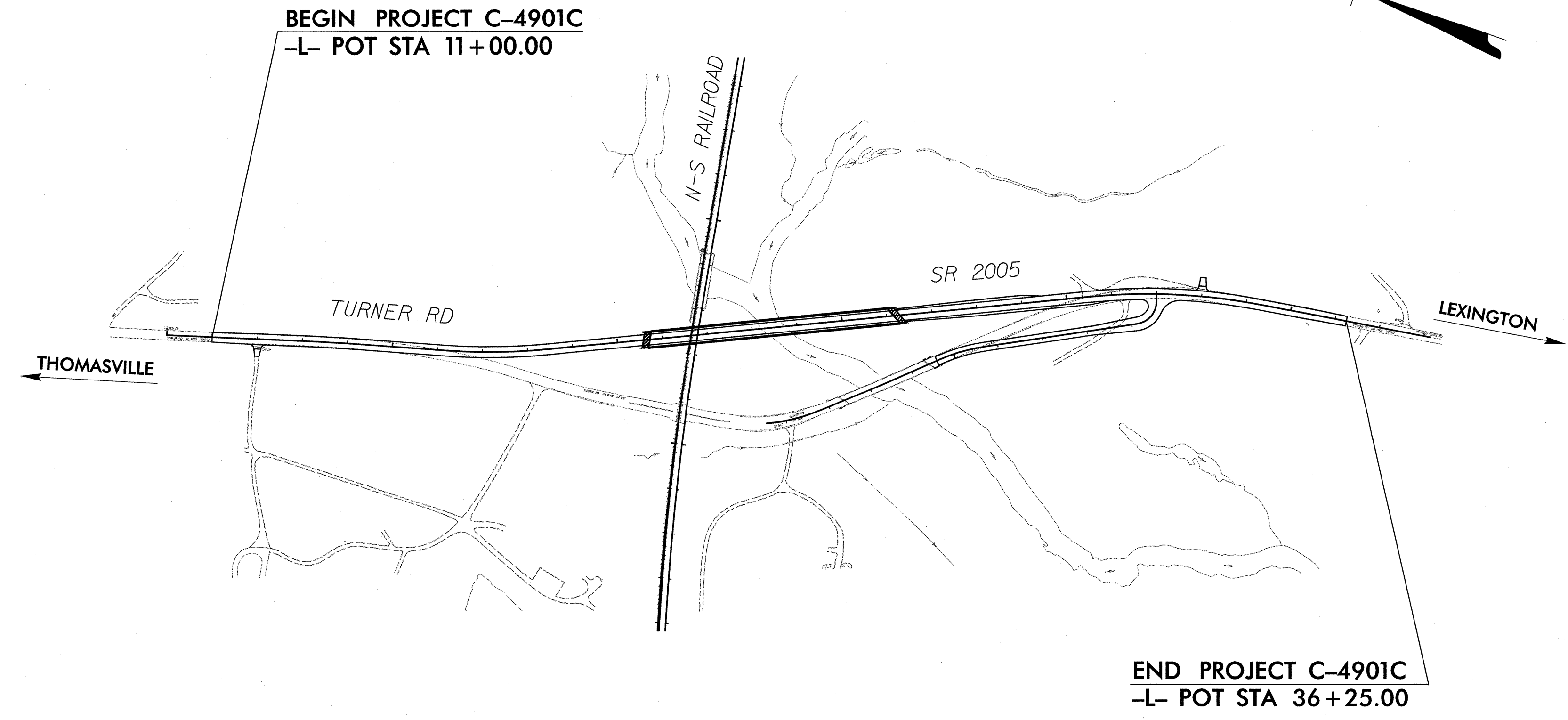

TRANSPORTATION MANAGEMENT PLAN
DAVIDSON COUNTY

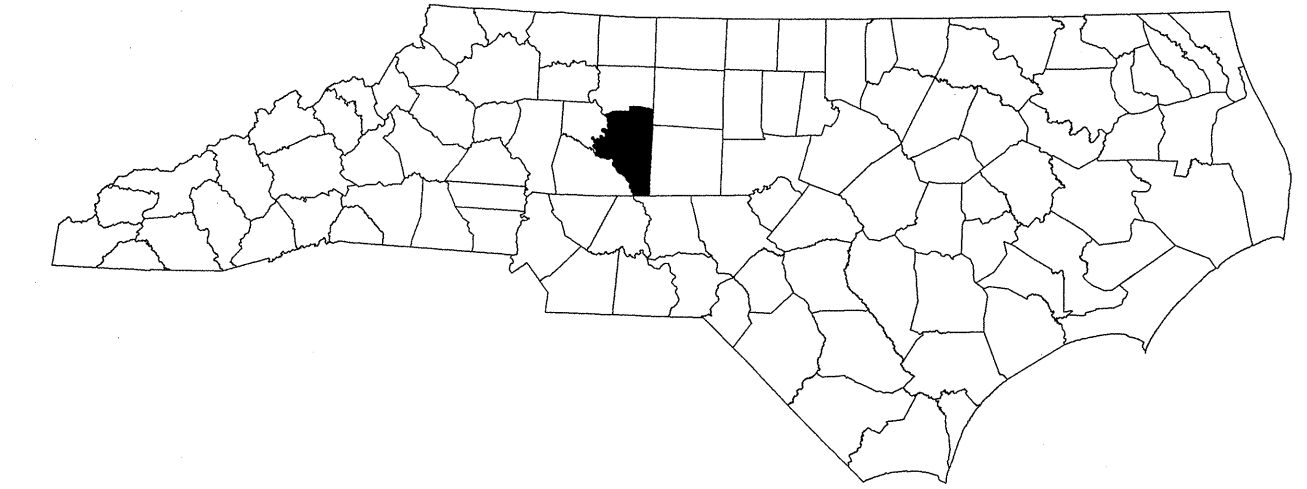

INDEX OF SHEETS

| SHEET NO. | TITLE |
|-----------|---|
| TMP-1 | TITLE SHEET, AND INDEX OF SHEETS |
| TMP-1A | TRANSPORTATION OPERATIONS PLAN: GENERAL NOTES |
| TMP-2 | TEMPORARY TRAFFIC CONTROL PHASE I OVERVIEW |
| TMP-3 | TEMPORARY TRAFFIC CONTROL PHASE II OVERVIEW |
| TMP-3A | TEMPORARY TRAFFIC CONTROL PHASE II DETOUR |

NOTE: WRITTEN PHASING FOR THE STAGING CONCEPT PLAN APPEARS ON THE OVERVIEW SHEETS

TIP PROJECT: C-4901C

10:46:32 AM R:\TrafficControl\C4901C_TCP_rsh.dgn

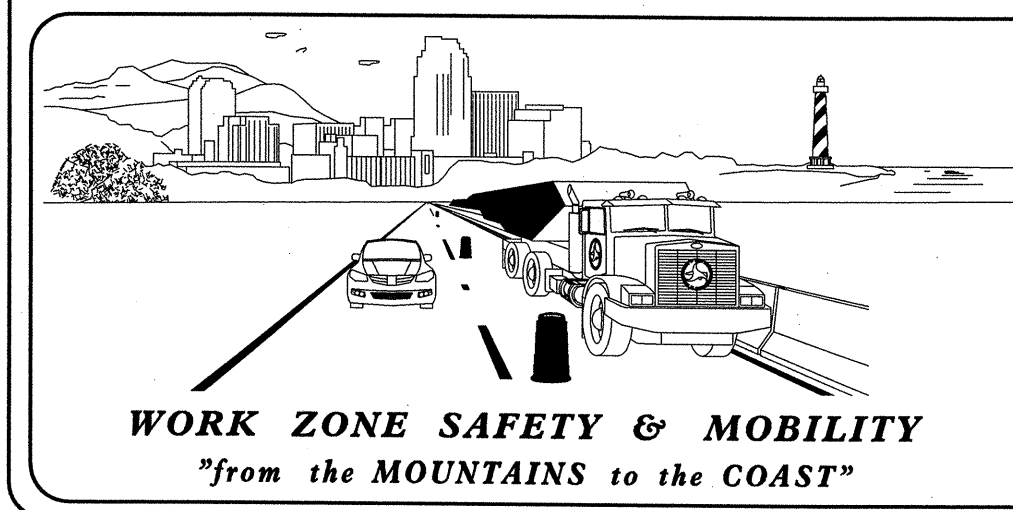

N.C.D.O.T. WORK ZONE TRAFFIC CONTROL
1561 MAIL SERVICE CENTER (MSC) RALEIGH, NC 27699-1561
750 N. GREENFIELD PARKWAY, GARNER, NC 27529 (DELIVERY)
PHONE: (919) 773-2800 FAX: (919) 771-2745

J.S. BOURNE, PE STATE TRAFFIC MANAGEMENT ENGINEER
K.J. VAN METRE, PE TRAFFIC CONTROL PROJECT ENGINEER
T.E. HILDEBRAND, PE TRAFFIC CONTROL PROJECT DESIGN ENGINEER
TRAFFIC CONTROL DESIGN ENGINEER

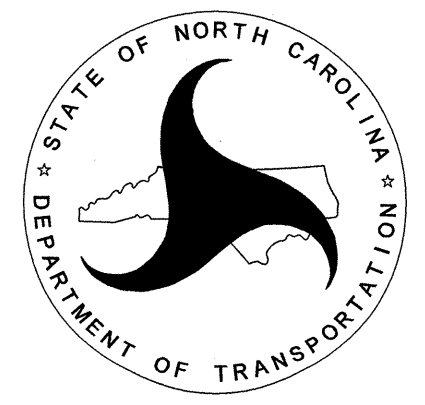

Prepared in the Office of:

AECOM

NC FIRM LICENSE No: F-0342
701 Corporate Center Drive, Suite 475
Raleigh, NC 27607
(919) 854-6200 (919) 854-6259(FAX)

APPROVED: *[Signature]*
DATE: 1/24/13

SEAL



| | |
|---------------------|-----------|
| PROJ. REFERENCE NO. | SHEET NO. |
| C-4901C | TMP-1A |

GENERAL NOTES

CHANGES MAY BE REQUIRED WHEN PHYSICAL DIMENSIONS IN THE DETAIL DRAWINGS, STANDARD DETAILS AND ROADWAY DETAILS ARE NOT ATTAINABLE TO MEET FIELD CONDITIONS, OR RESULT IN DUPLICATE, OR UNDESIRABLE OVERLAPPING OF DEVICES. MODIFICATION MAY INCLUDE: MOVING, SUPPLEMENTING, COVERING OR REMOVAL OF DEVICES, AS DIRECTED BY THE ENGINEER.

THE FOLLOWING GENERAL NOTES APPLY AT ALL TIMES FOR THE DURATION OF THE CONSTRUCTION PROJECT, EXCEPT WHEN OTHERWISE NOTED IN THE PLAN, OR DIRECTED BY THE ENGINEER.

TIME RESTRICTIONS

A) DO NOT CLOSE OR NARROW TRAVEL LANES AS FOLLOWS:

| ROAD NAME | DAY AND TIME RESTRICTION |
|-------------|--|
| TURNER ROAD | MONDAY THROUGH FRIDAY, 7:00 AM-9:00 AM & 4:00 PM-6:00 PM |

B) DO NOT CLOSE OR NARROW TRAVEL LANES DURING HOLIDAYS AND SPECIAL EVENTS AS FOLLOWS:

| ROAD NAME |
|-------------|
| TURNER ROAD |

HOLIDAY

- FOR ANY UNEXPECTED OCCURRENCE THAT CREATES UNUSUALLY HIGH TRAFFIC VOLUMES, AS DIRECTED BY THE ENGINEER.
- FOR NEW YEAR'S, BETWEEN THE HOURS OF 8:00 A.M. DECEMBER 31st TO 6:00 P.M. JANUARY 2ND. IF NEW YEAR'S DAY IS ON A FRIDAY, SATURDAY, SUNDAY, OR MONDAY THEN UNTIL 6:00 P.M. THE FOLLOWING TUESDAY.
- FOR EASTER, BETWEEN THE HOURS OF 8:00 A.M. THURSDAY AND 6:00 P.M. MONDAY.
- FOR MEMORIAL DAY, BETWEEN THE HOURS OF 8:00 A.M. FRIDAY TO 6:00 P.M. TUESDAY.
- FOR INDEPENDENCE DAY, BETWEEN THE HOURS OF 8:00 A.M. THE DAY BEFORE INDEPENDENCE DAY AND 6:00 P.M. THE DAY AFTER INDEPENDENCE DAY.

IF INDEPENDENCE DAY IS ON A FRIDAY, SATURDAY, SUNDAY OR MONDAY THEN BETWEEN THE HOURS OF 8:00 A.M. THE THURSDAY BEFORE INDEPENDENCE DAY AND 6:00 P.M. THE TUESDAY AFTER INDEPENDENCE DAY.
- FOR LABOR DAY, BETWEEN THE HOURS OF 8:00 A.M. FRIDAY AND 6:00 P.M. TUESDAY.
- FOR THANKSGIVING DAY, BETWEEN THE HOURS OF 6:00 P.M. TUESDAY TO 8:00 A.M. MONDAY.
- FOR CHRISTMAS, BETWEEN THE HOURS OF 8:00 A.M. THE FRIDAY BEFORE THE WEEK OF CHRISTMAS DAY AND 6:00 P.M. THE FOLLOWING TUESDAY AFTER THE WEEK OF CHRISTMAS.

LANE AND SHOULDER CLOSURE REQUIREMENTS

- REMOVE LANE CLOSURE DEVICES FROM THE LANE WHEN WORK IS NOT BEING PERFORMED BEHIND THE LANE CLOSURE OR WHEN A LANE CLOSURE IS NO LONGER NEEDED, OR AS DIRECTED BY THE ENGINEER.
- WHEN PERSONNEL AND/OR EQUIPMENT ARE WORKING WITHIN 15 FT OF AN OPEN TRAVEL LANE, CLOSE THE NEAREST OPEN SHOULDER USING ROADWAY STANDARD DRAWING NO. 1101.04 UNLESS THE WORK AREA IS PROTECTED BY BARRIER OR GUARDRAIL OR A LANE CLOSURE IS INSTALLED.
- WHEN PERSONNEL AND/OR EQUIPMENT ARE WORKING ON THE SHOULDER ADJACENT TO AN UNDIVIDED FACILITY AND WITHIN 5 FT OF AN OPEN TRAVEL LANE, CLOSE THE NEAREST OPEN TRAVEL LANE USING ROADWAY STANDARD DRAWING NO. 1101.02 UNLESS THE WORK AREA IS PROTECTED BY BARRIER OR GUARDRAIL.
- WHEN PERSONNEL AND/OR EQUIPMENT ARE WORKING WITHIN A LANE OF TRAVEL OF AN UNDIVIDED OR DIVIDED FACILITY, CLOSE THE LANE ACCORDING TO THE TRAFFIC CONTROL PLANS, ROADWAY STANDARD DRAWINGS OR AS DIRECTED BY THE ENGINEER. CONDUCT THE WORK SO THAT ALL PERSONNEL AND/OR EQUIPMENT REMAIN WITHIN THE CLOSED TRAVEL LANE.
- DO NOT WORK SIMULTANEOUSLY WITHIN 15 FT ON BOTH SIDES OF AN OPEN TRAVELWAY OR RAMP WITHIN THE SAME LOCATION UNLESS PROTECTED WITH GUARDRAIL OR BARRIER.
- PROVIDE TRAFFIC CONTROL FOR APPROPRIATE LANE CLOSURES FOR SURVEYING AS NECESSARY AND/OR AS DIRECTED BY THE ENGINEER.

PAVEMENT EDGE DROP OFF REQUIREMENTS

- BACKFILL AT A 6:1 SLOPE UP TO THE EDGE AND ELEVATION OF EXISTING PAVEMENT IN AREAS ADJACENT TO AN OPENED TRAVEL LANE THAT HAS AN EDGE OF PAVEMENT DROP-OFF AS FOLLOWS:

BACKFILL DROP-OFFS THAT EXCEED 2 INCHES ON ROADWAYS WITH POSTED SPEED LIMITS OF 45 MPH OR GREATER.

BACKFILL WITH SUITABLE COMPACTED MATERIAL, AS APPROVED BY THE ENGINEER, AT NO EXPENSE TO THE DEPARTMENT.
- DO NOT EXCEED A DIFFERENCE OF 2 INCHES IN ELEVATION BETWEEN OPEN LANES OF TRAFFIC FOR NOMINAL LIFTS OF 1.5 INCHES. INSTALL ADVANCE WARNING "UNEVEN LANES" SIGNS (W8-11) 200 FT IN ADVANCE AND A MINIMUM OF EVERY HALF MILE THROUGHOUT THE UNEVEN AREA.

TRAFFIC PATTERN ALTERATIONS

- NOTIFY THE ENGINEER TWENTY ONE (21) CALENDAR DAYS PRIOR TO ANY TRAFFIC PATTERN ALTERATION.

SIGNING

- INSTALL ADVANCE WORK ZONE WARNING SIGNS WHEN WORK IS WITHIN 40 FT FROM THE EDGE OF TRAVEL LANE AND NO MORE THAN THREE (3) DAYS PRIOR TO THE BEGINNING OF CONSTRUCTION.
- PROVIDE DETOUR SIGNING AS SHOWN ON TMP-3A.
- ENSURE ALL NECESSARY SIGNING IS IN PLACE PRIOR TO ALTERING ANY TRAFFIC PATTERN.

TRAFFIC CONTROL DEVICES

- SPACE CHANNELIZING DEVICES IN WORK AREAS NO GREATER THAN TWICE THE POSTED SPEED LIMIT (MPH), EXCEPT 10 FT ON-CENTER IN RADII, AND 3 FT OFF THE EDGE OF AN OPEN TRAVELWAY, WHEN LANE CLOSURES ARE NOT IN EFFECT. WHEN SKINNY DRUMS ARE ALLOWED, REFER TO SECTION 1180 OF STANDARD SPECIFICATIONS FOR ROADS AND STRUCTURES OR AS SHOWN IN THE PLANS.
- PLACE TYPE III BARRICADES, WITH "ROAD CLOSED" SIGN R11-2 ATTACHED, OF SUFFICIENT LENGTH TO CLOSE ENTIRE ROADWAY.
- PLACE ADDITIONAL SETS OF THREE CHANNELIZING DEVICES PERPENDICULAR TO THE EDGE OF TRAVELWAY ON 500 FT CENTERS WHEN UNOPENED LANES ARE CLOSED TO TRAFFIC.

PAVEMENT MARKINGS AND MARKERS

- IF NEEDED, INSTALL TEMPORARY PAVEMENT MARKINGS AND TEMPORARY PAVEMENT MARKERS ON INTERIM LAYERS OF PAVEMENT AS FOLLOWS:

ROAD NAME MARKING MARKER
ALL ROADS PAINT TEMPORARY RAISED
- PLACE ONE APPLICATION OF PAINT FOR TEMPORARY TRAFFIC PATTERNS. PLACE A SECOND APPLICATION OF PAINT SIX (6) MONTHS AFTER THE INITIAL APPLICATION AND EVERY SIX MONTHS AS DIRECTED BY THE ENGINEER.
- TIE PROPOSED PAVEMENT MARKING LINES TO EXISTING PAVEMENT MARKING LINES.
- REMOVE/REPLACE ANY CONFLICTING/DAMAGED PAVEMENT MARKINGS AND MARKERS BY THE END OF EACH DAY'S OPERATION.

MISCELLANEOUS

- IN THE EVENT A TIE-IN CANNOT BE MADE IN ONE DAYS TIME, BRING THE TIE-IN AREA TO AN APPROPRIATE ROADWAY ELEVATION, AS DETERMINED BY THE ENGINEER. PLACE BLACK ON ORANGE "LOOSE GRAVEL" SIGNS (W8-7) AND BLACK ON ORANGE "PAVEMENT ENDS" SIGNS (W8-3) 200 FT AND 200 FT RESPECTIVELY IN ADVANCE OF THE UNEVEN AREAS. USE DRUMS TO DELINEATE THE EDGE OF ROADWAY ALONG UNPAVED AREAS.

0271DEL_P10c3

2:53:54 PM R:\TrafficControl\4901C_TCP_Notes.phasing.dgn

APPROVED: *[Signature]* DATE: 1/24/13



GENERAL NOTES

| | | |
|-------------------|--|-----------|
| SCALE: NONE | | REVISIONS |
| DATE: 12 / 9 / 11 | | |
| DWG. BY: RR | | |
| DESIGN BY: KJV | | |
| REVIEWED BY: NJD | | |

Prepared in the Office of: **AECOM**
NC FIRM LICENSE No. F-0342
 701 Corporate Center Drive, Suite 415
 91060-9700, NC 27601
 (919) 854-6200 • (919) 854-6259(FAX)



| | |
|---------------------|-----------|
| PROJ. REFERENCE NO. | SHEET NO. |
| C-4901C | TMP-2 |

0271DEL_P10c3

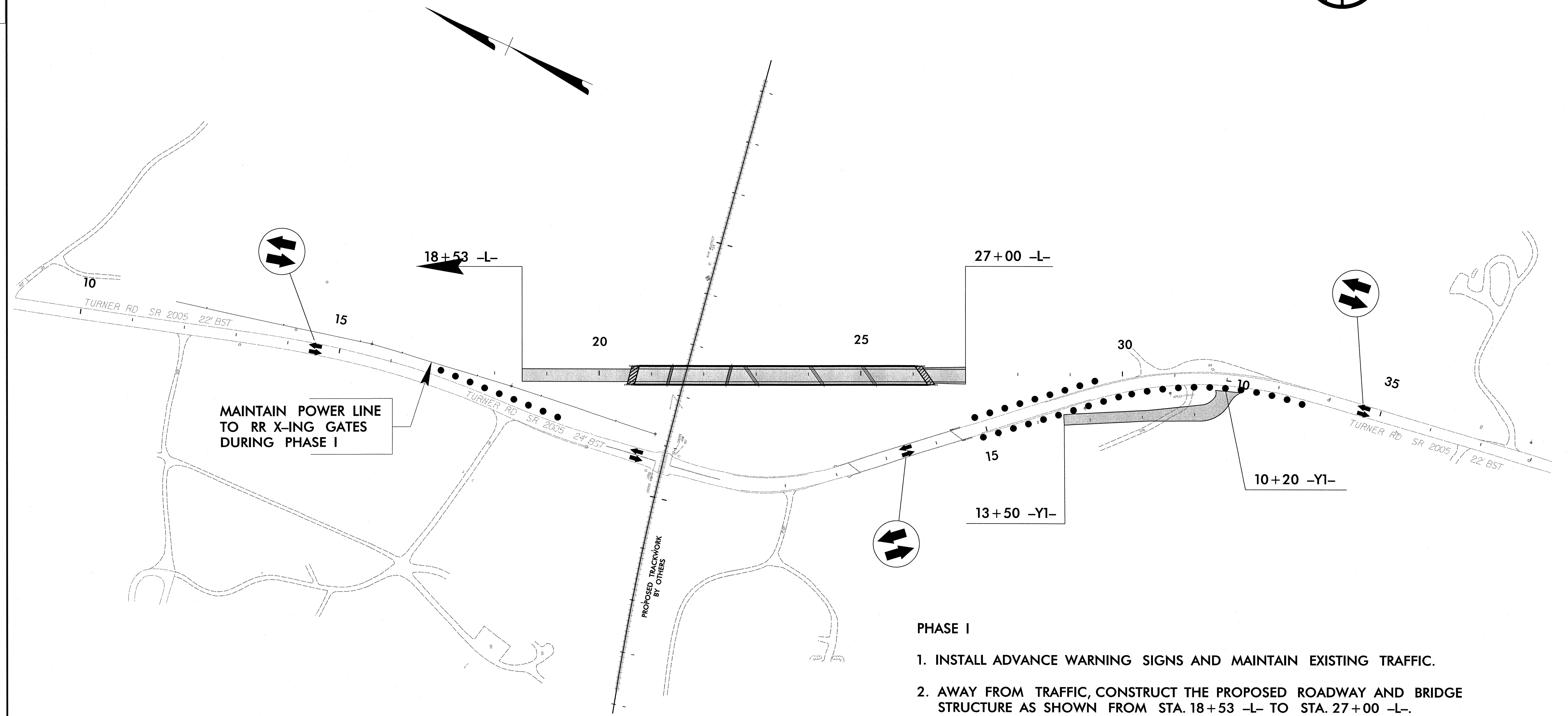

PHASE I

1. INSTALL ADVANCE WARNING SIGNS AND MAINTAIN EXISTING TRAFFIC.
2. AWAY FROM TRAFFIC, CONSTRUCT THE PROPOSED ROADWAY AND BRIDGE STRUCTURE AS SHOWN FROM STA. 18+53 -L- TO STA. 27+00 -L-. COORDINATE ALL WORK OVER THE N-S RR TRACK WITH THE RR COMPANY.
3. CONSTRUCT THE PROPOSED SERVICE ROAD FROM STA. 10+20 -Y1- TO STA. 13+50 -Y1-.

LEGEND

- EXISTING ROADWAY
- PROPOSED CONSTRUCTION
- COMPLETED ROADWAY

APPROVED: *[Signature]* DATE: 4/24/13

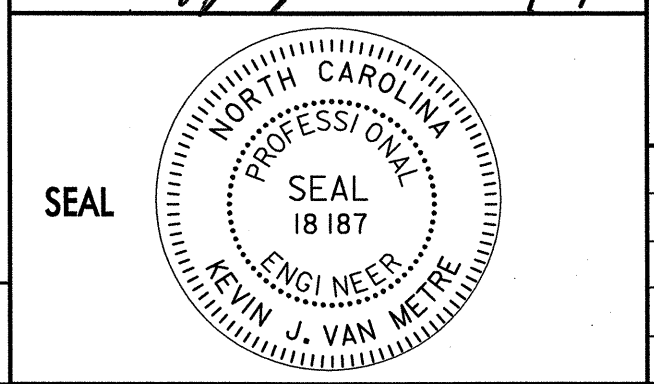

PHASE I OVERVIEW

| | | |
|-------------------|--|-----------|
| SCALE: NONE | | REVISIONS |
| DATE: 12 / 9 / 11 | | |
| DWG. BY: RR | | |
| DESIGN BY: KJV | | |
| REVIEWED BY: NJD | | |

Prepared in the Office of: **AECOM**
NC FIRM LICENSE No. F-0342
 701 Corporate Center Drive, Suite 475
 Cary, NC 27513
 (919) 854-6200 • (919) 854-6259(FAX)

2:59:49 PM R:\TrafficControl\C4901C_TCP_phase1.psh.dgn



| | |
|---------------------|-----------|
| PROJ. REFERENCE NO. | SHEET NO. |
| C-4901C | TMP-3 |

0271DEL_P10c3

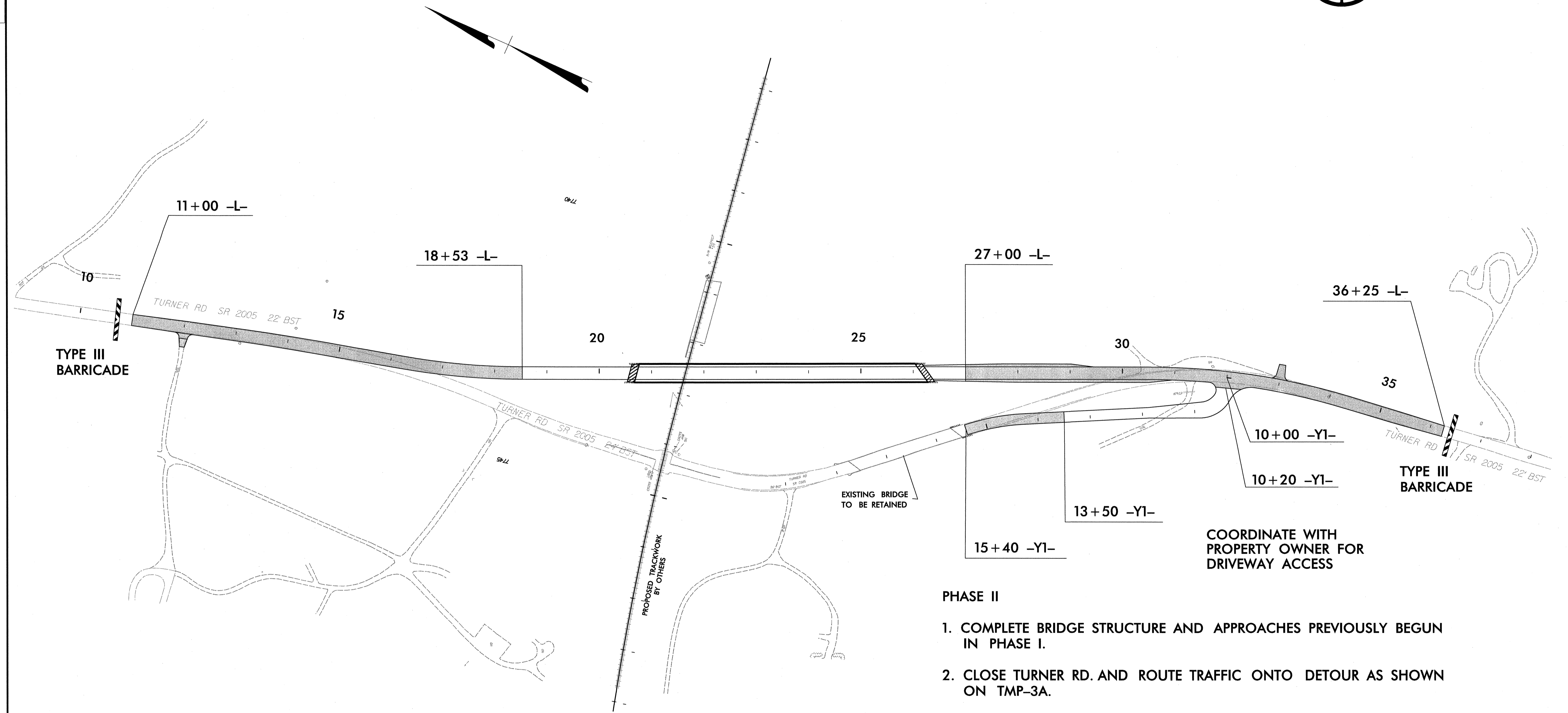

LEGEND

- EXISTING ROADWAY
- PROPOSED CONSTRUCTION
- COMPLETED ROADWAY

PHASE II

1. COMPLETE BRIDGE STRUCTURE AND APPROACHES PREVIOUSLY BEGUN IN PHASE I.
2. CLOSE TURNER RD. AND ROUTE TRAFFIC ONTO DETOUR AS SHOWN ON TMP-3A.
3. CONSTRUCT THE PROPOSE TIE-IN AS SHOWN FROM STA. 11+00 -L- TO STA. 18+53 -L-.
4. CONSTRUCT THE PROPOSE TIE-IN AS SHOWN FROM STA. 27+00 -L- TO STA. 36+25. MAINTAIN INGRESS AND EGRESS TO PROPERTY.

CONSTRUCT THE PROPOSED SERVICE ROAD FROM STA. 10+00 -Y1- TO STA. 10+20 -Y1- AND FROM STA. 13+50 -Y1- TO STA. 15+40 -Y1-. COORDINATE DRIVEWAY ACCESS WITH THE PROPERTY OWNER.

APPROVED: DATE: 12/9/13



PHASE II OVERVIEW

| | | |
|-------------------|--|-----------|
| SCALE: NONE | | REVISIONS |
| DATE: 12 / 9 / 11 | | |
| DWG. BY: RR | | |
| DESIGN BY: KJV | | |
| REVIEWED BY: NJD | | |

Prepared in the Office of: **AECOM**
NC FIRM LICENSE No. F-0342
 701 Corporate Center Drive, Suite 475
 Raleigh, NC 27607
 (919) 854-6200 • (919) 854-6259(FAX)

2:57:51PM R:\TrafficControl\4901C_TCP_phase2.psh.dgn



NOTE:
Any detour signing shall be coordinated so as to not conflict with any other detour signing for any other projects in the area.

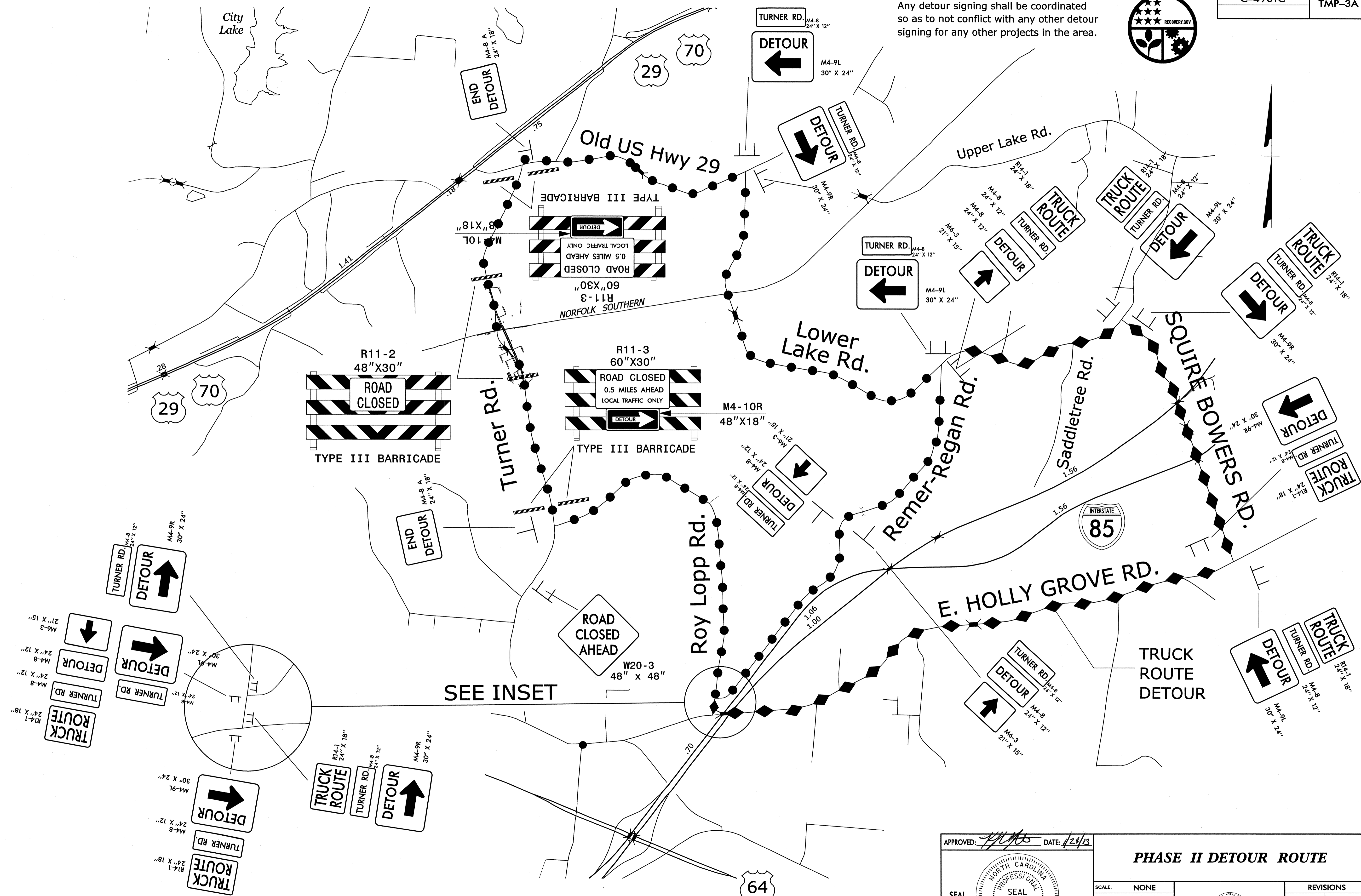

2:56:06 PM R:\Traffic\TrafficControl\C4901C_TCP_ph2_detour_psh2.dgn

Prepared in the Office of: **AECOM**
 NC FIRM LICENSE No: F-0342
 701 Corporate Center Drive, Suite 415
 Raleigh, NC 27601
 (919) 854-6200 (919) 854-6259 FAX

APPROVED: *[Signature]* DATE: 12/13
 SEAL: *[Professional Seal]*
 SEAL 18 187
 KEVIN J. VAN METRE
 ENGINEER

| | |
|------------------------------|-----------|
| PHASE II DETOUR ROUTE | |
| SCALE: NONE | REVISIONS |
| DATE: 12 / 9 / 11 | |
| DWG. BY: RR | |
| DESIGN BY: KJV | |
| REVIEWED BY: NJD | |