

STATE OF NORTH CAROLINA
DIVISION OF HIGHWAYS

PROJ. REFERENCE NO.	SHEET NO.
B-4835	X-1A

NOTE: EMBANKMENT COLUMN INCLUDES BACKFILL FOR UNDERCUT

CROSS-SECTION SUMMARY

Station	Uncl. Exc. (cu. yd.)	Embt (cu. yd.)																			
11+50.00	0	0																			
11+75.00	4	1																			
12+00.00	8	1																			
12+25.00	8	2																			
12+50.00	7	5																			
12+75.00	7	7																			
13+00.00	7	8																			
13+13.81	4	5																			
13+22.82	1	2																			
Station	Uncl. Exc.	Embt																			
L	(cu. yd.)	(cu. yd.)																			
14+07.29	0	0																			
14+16.19	1	4																			
14+25.00	1	8																			
14+50.00	0	23																			
14+75.00	0	26																			
15+00.00	0	24																			
15+25.00	1	12																			
15+50.00	3	3																			
15+75.00	6	1																			
15+90.00	2	1																			

Approximate quantities only. Unclassified excavation, borrow excavation, fine grading, clearing and grubbing, and removal of existing pavement will be paid for at the lump sum price for "Grading".

8/23/99

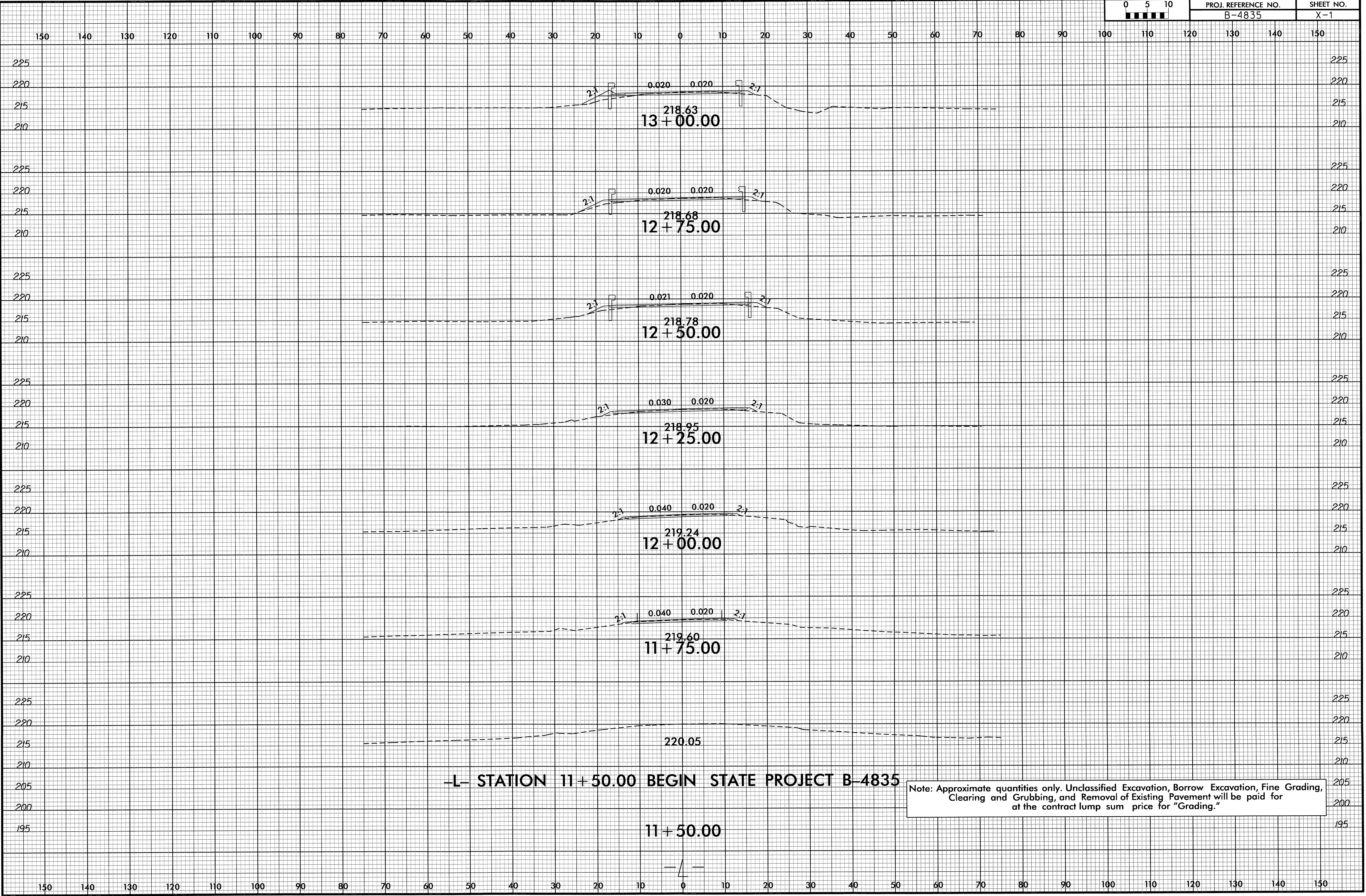

24-SEP-2012 14:53
R:\Roadway\XSC\B4835_Rdy_xp1.dgn
USER:NAME

8/23/99

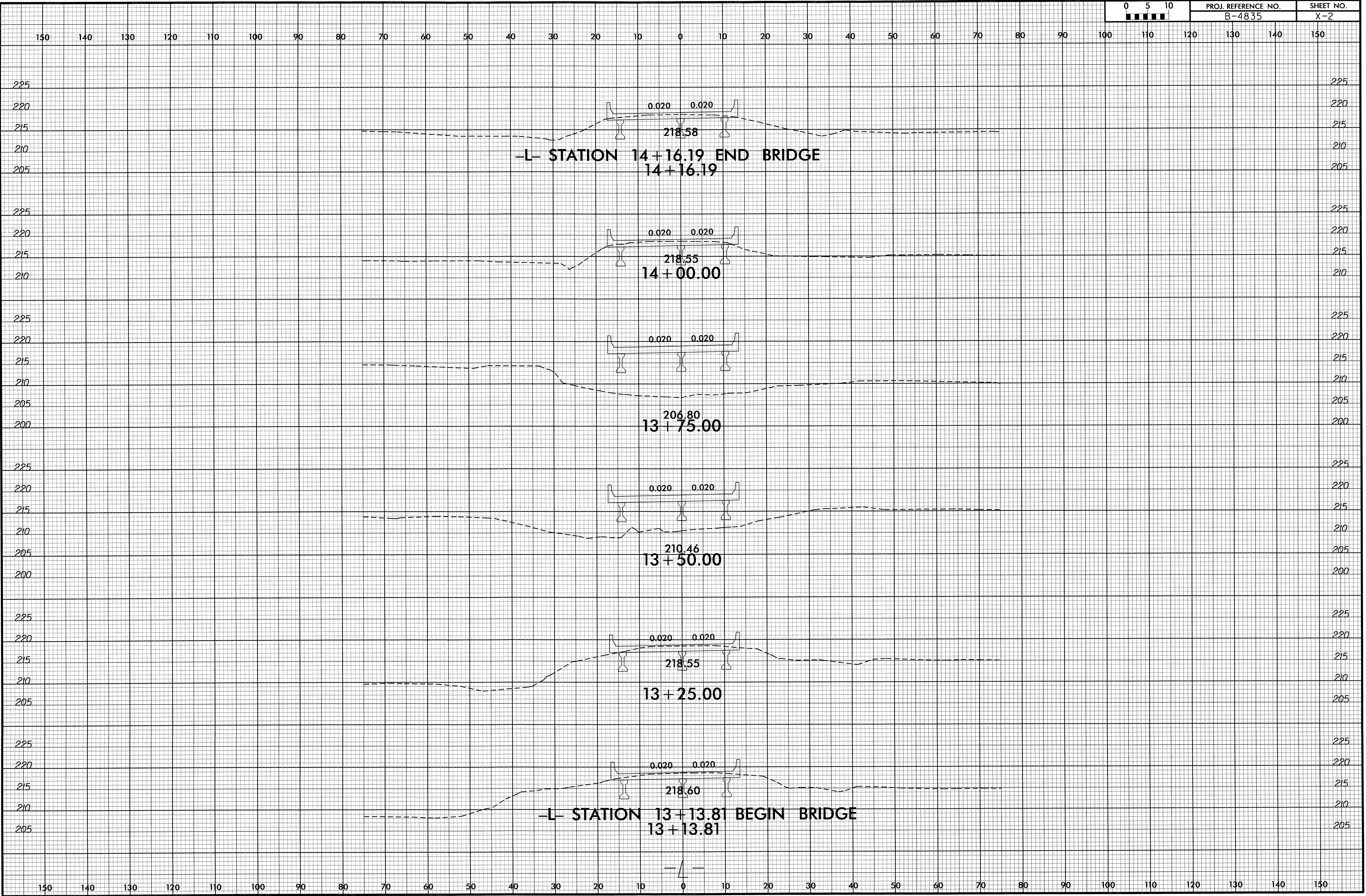

24-SEP-2012 14:52
R:\Roadwork\XSC\B4835_Rdy_xp1.dgn
\$\$\$\$USERNAME\$\$\$\$

8/23/99

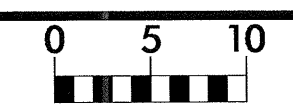

PROJ. REFERENCE NO.	SHEET NO.
B-4835	X-3

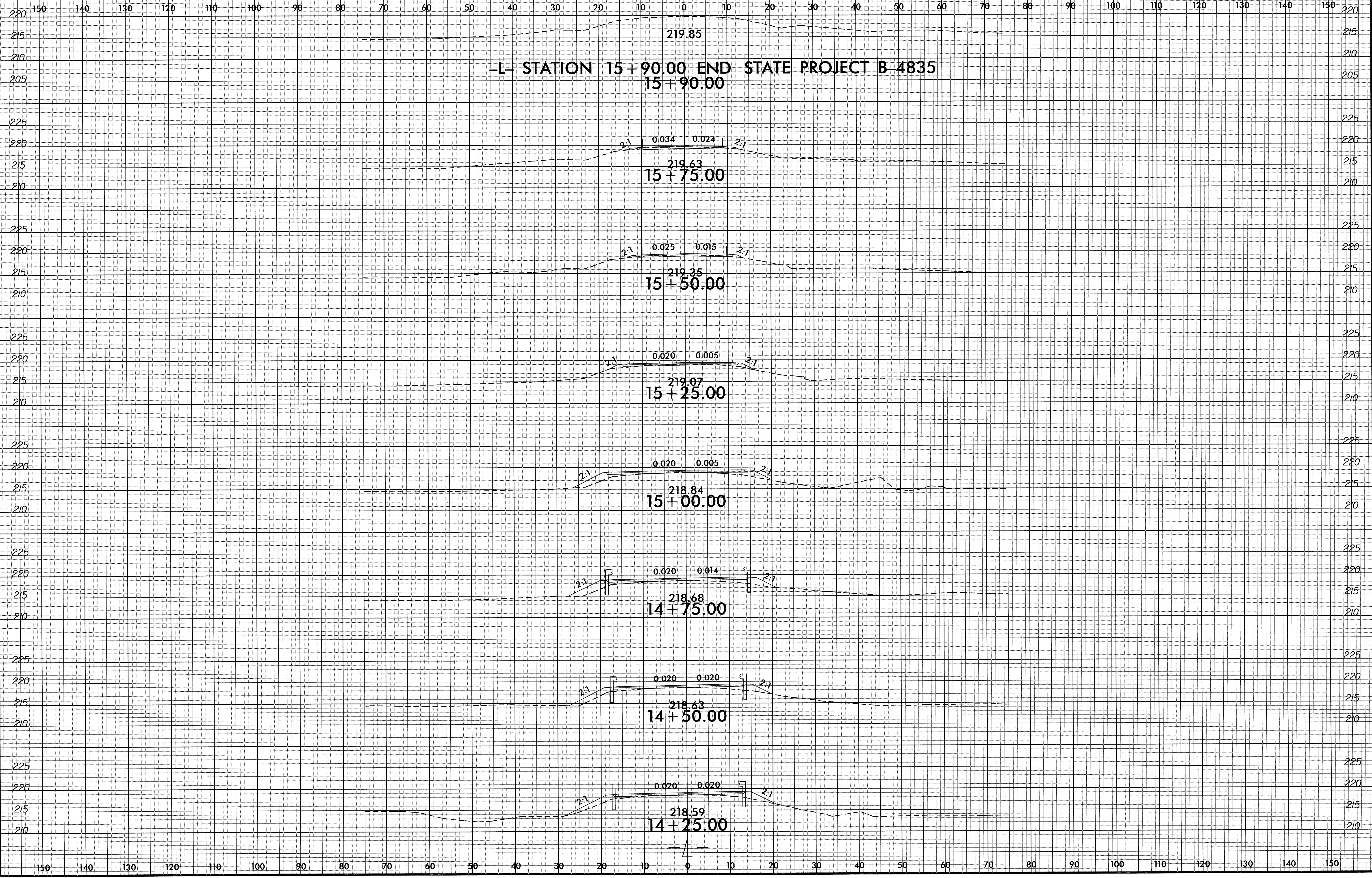

24-SEP-2002 14:52
 R:\PROJECTS\STATE\B-4835_Std\B-4835_Std.dgn
 8:33:57 AM