

TIP PROJECT: B-4804

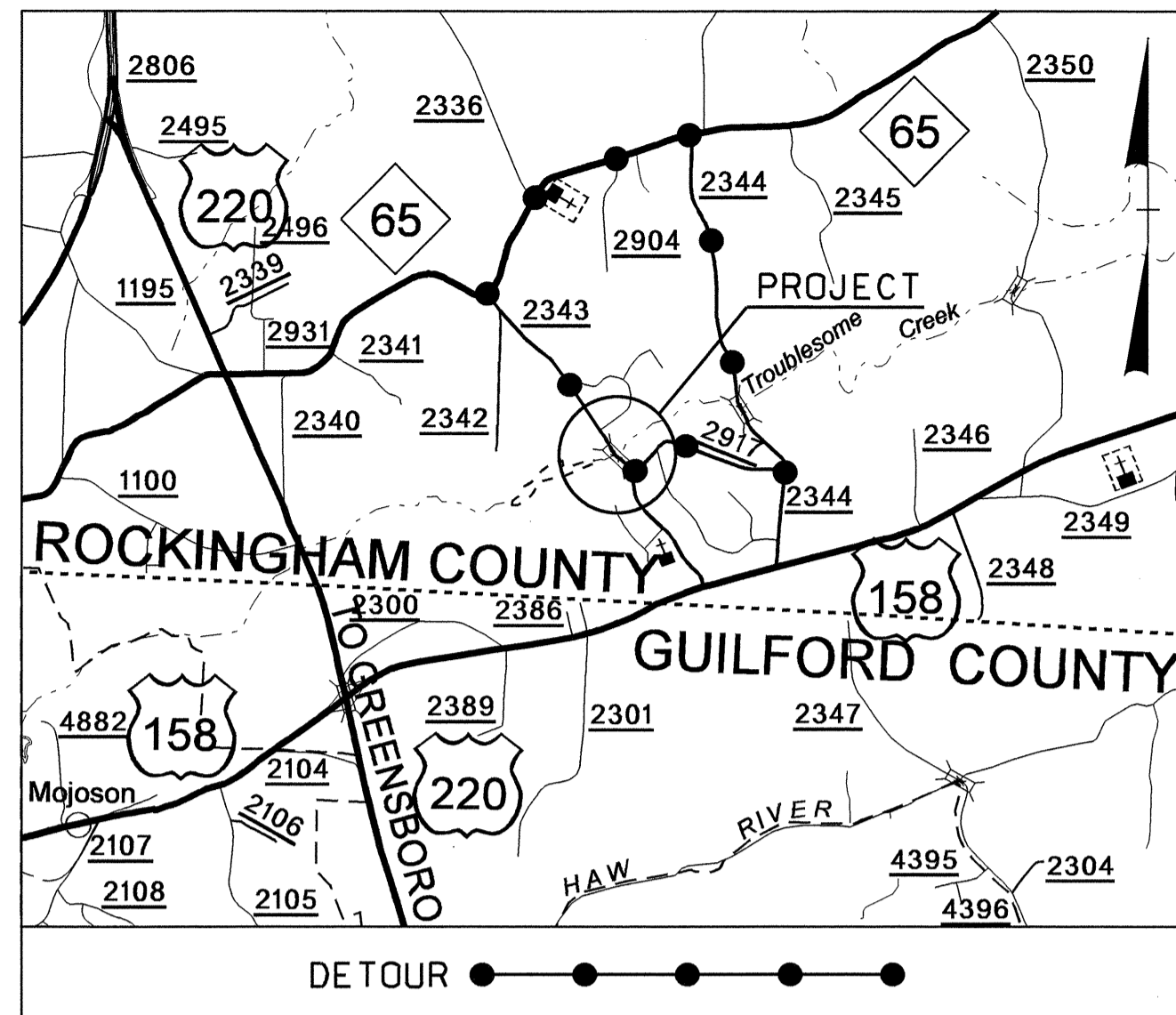

VICINITY MAP

STATE OF NORTH CAROLINA
DIVISION OF HIGHWAYS

**UTILITIES BY OTHERS PLANS
ROCKINGHAM COUNTY**

LOCATION: BRIDGE No. 12 OVER TROUBLESOME CREEK ON SR 2343

TYPE OF WORK: UTILITY RELOCATIONS

T.I.P. NO.	SHEET NO.
B-4804	UO-1

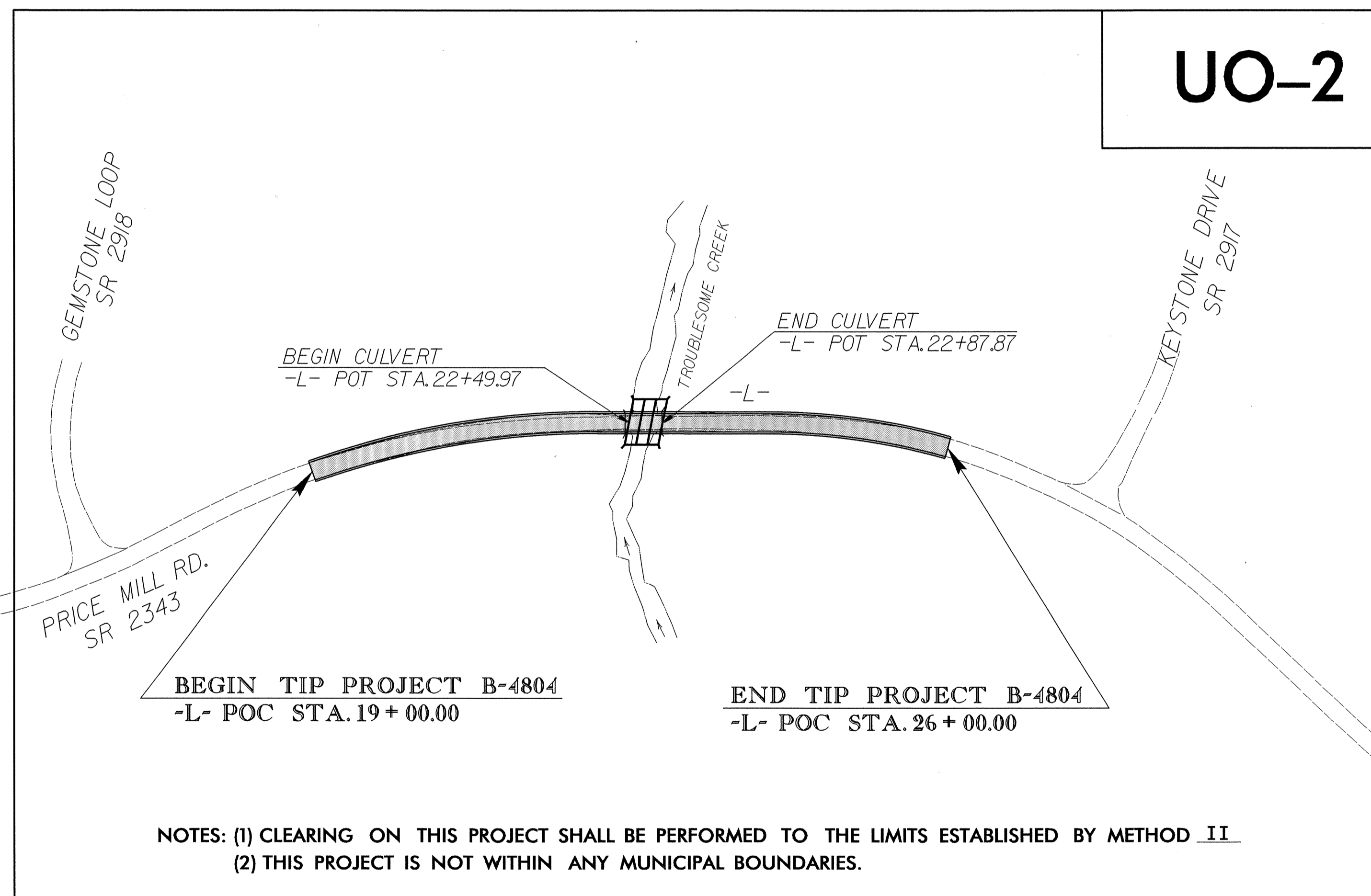

UO-2



NOTES: (1) CLEARING ON THIS PROJECT SHALL BE PERFORMED TO THE LIMITS ESTABLISHED BY METHOD II.
(2) THIS PROJECT IS NOT WITHIN ANY MUNICIPAL BOUNDARIES.

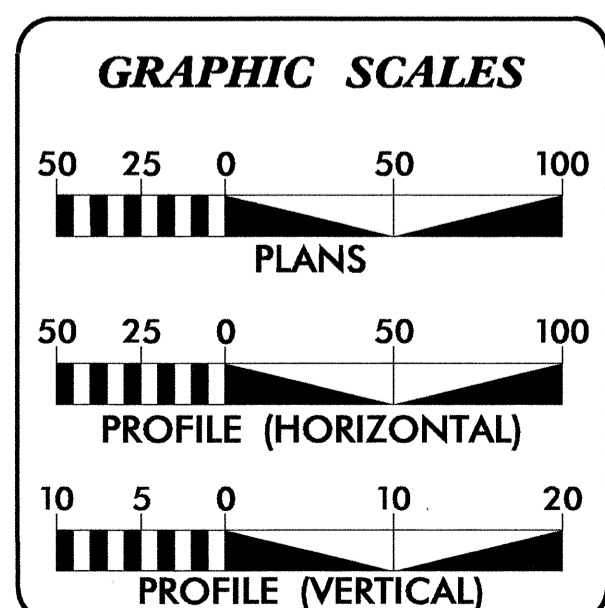

INDEX OF SHEETS	
SHEET NO.	DESCRIPTION
UO-1	TITLE SHEET
UO-2	UTILITY BY OTHERS PLAN SHEET

UTILITY OWNERS ON PROJECT
(1) DUKE ENERGY - POWER
(2) TIME WARNER CABLE - TELEVISION
(3) WILLIAMS TRANSCO - GAS (TRANSMISSION)
(4) LEVEL 3 - TELEPHONE

PREPARED IN THE OFFICE OF:
**DIVISION OF HIGHWAYS
UTILITIES UNIT
UTILITIES ENGINEERING**

1555 MAIL SERVICES CENTER
RALEIGH NC 27699-1555
PHONE (919) 707-6698
FAX (919) 250-4151

Roger Worthington, P.E. UTILITIES SECTION ENGINEER
Steve McKee, P.E. UTILITIES SQUAD LEADER PROJECT ENGINEER
Donald Proper UTILITIES PROJECT DESIGNER

