

STATE OF NORTH CAROLINA
DIVISION OF HIGHWAYS

TRANSPORTATION MANAGEMENT PLAN

RICHMOND COUNTY

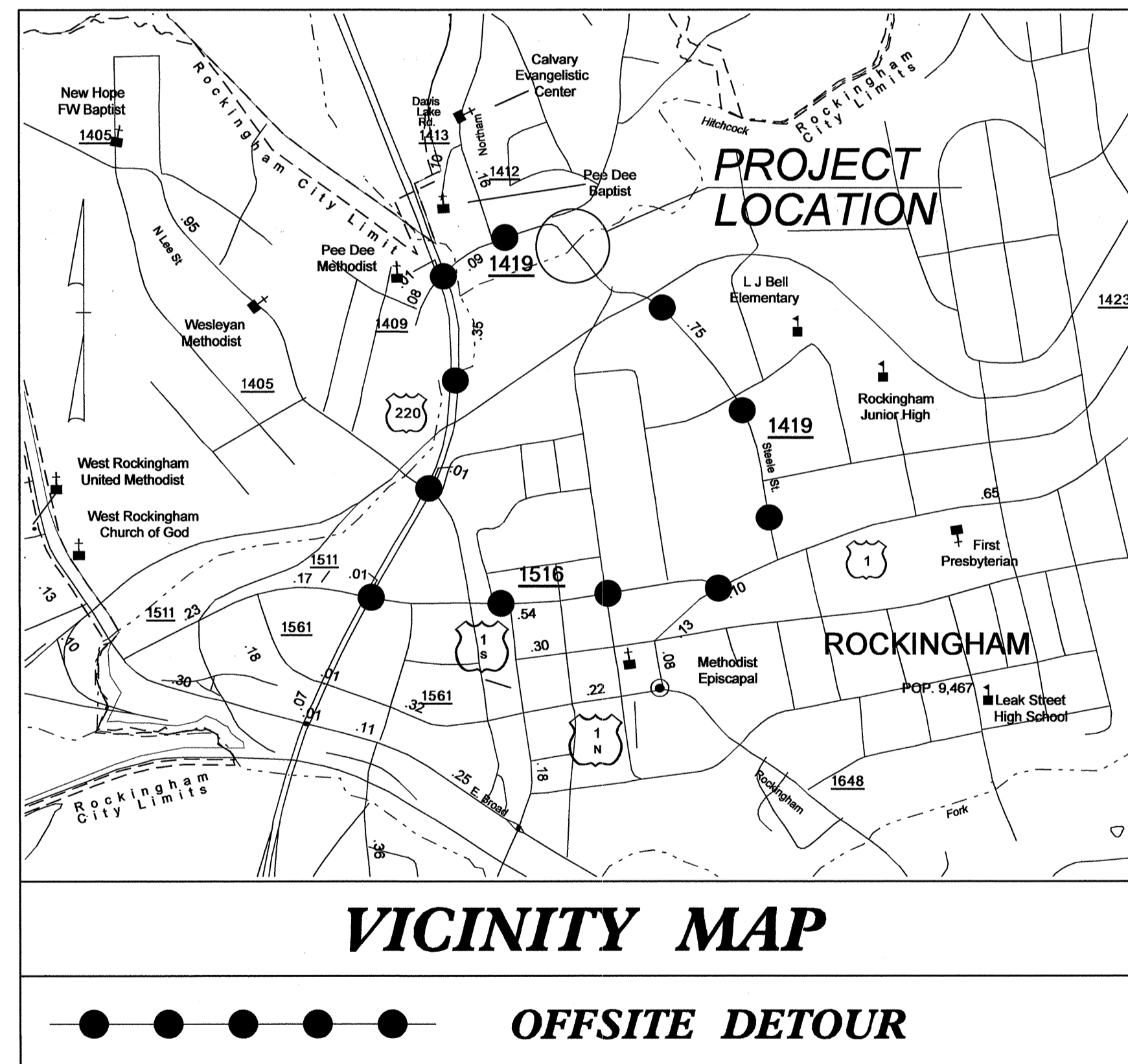
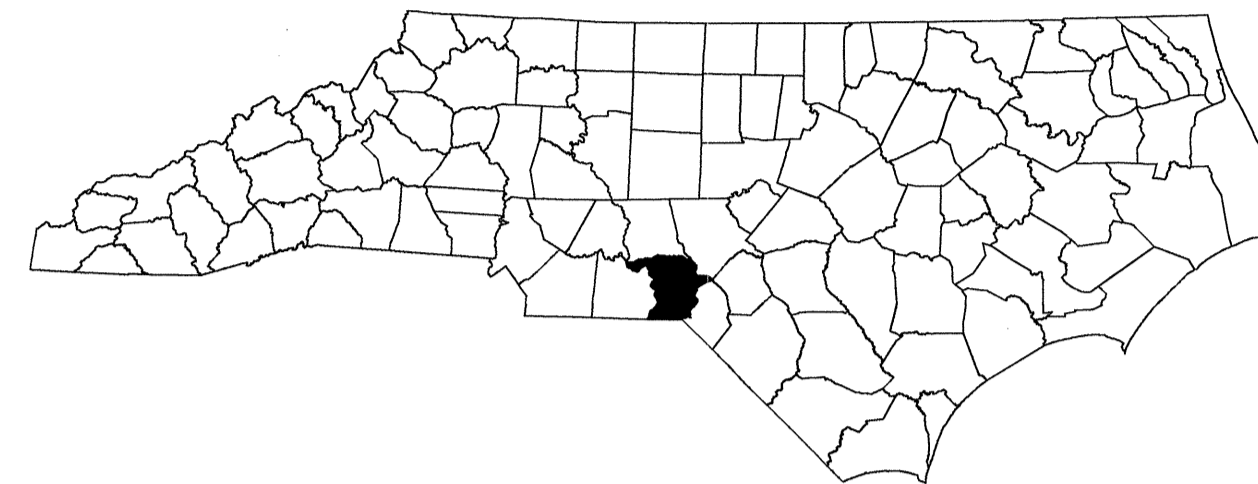

INDEX OF SHEETS

SHEET NO.	TITLE
TMP-1	TITLE SHEET AND INDEX OF SHEETS
TMP-1A	LIST OF APPLICABLE ROADWAY STANDARD DRAWINGS, LEGEND, AND TEMPORARY PAVEMENT MARKING
TMP-1B	TRANSPORTATION OPERATIONS PLAN: (MANAGEMENT STRATEGIES AND GENERAL NOTES)
TMP-2	OFF-SITE DETOUR AND BARRICADE PLACEMENT
SD-1	WORK ZONE SIGNS

SHEET NO.
TMP-1

B-4615

TIP PROJECT:

22-OCT-2012 14:42 \\dot\adfer\dot\01\Pro\TIP\Projects-B\B4615\TrafficControl\TCP\B-4615.TC.TCP.dgn shassan AT 1E265820

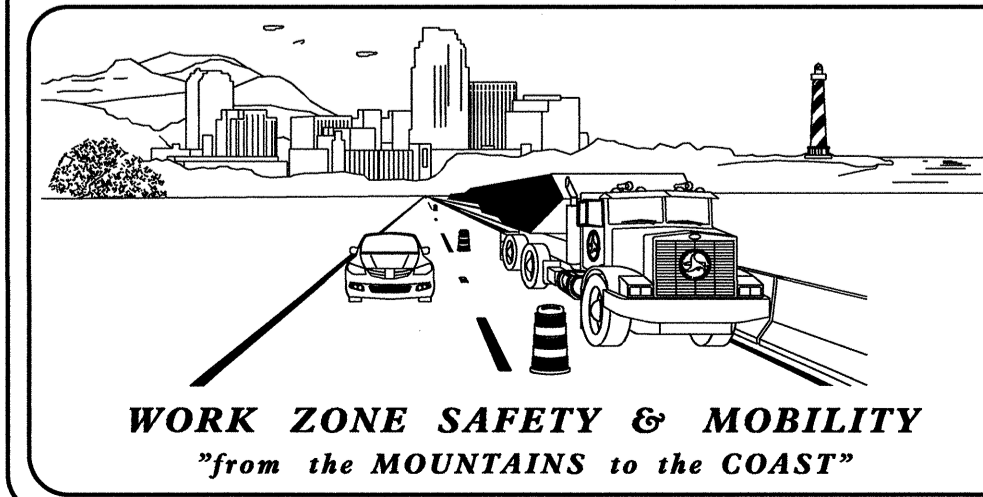

N.C.D.O.T. WORK ZONE TRAFFIC CONTROL
1580 MAIL SERVICE CENTER (MSC) RALEIGH, NC 27699-1580
1020 BIRCH RIDGE DRIVE, RALEIGH, NC 27610 (DELIVERY)
PHONE: (919) 250-4094 FAX: (919) 250-4098

J. S. BOURNE, P.E. STATE TRAFFIC MANAGEMENT ENGINEER
J. ISHAK, P.E. TRAFFIC CONTROL PROJECT ENGINEER
B. SCHOENBAUER, P.E. TRAFFIC CONTROL PROJECT DESIGN ENGINEER
S. HASSAN TRAFFIC CONTROL DESIGN ENGINEER

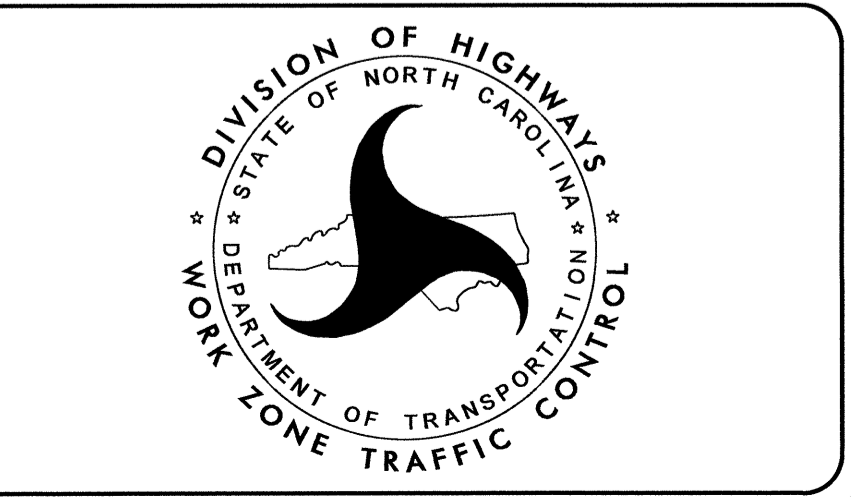

APPROVED: *Ben Schoenbauer*
DATE: *October 22, 2012*

SEAL

ROADWAY STANDARD DRAWINGS

THE FOLLOWING ROADWAY STANDARDS AS SHOWN IN "ROADWAY STANDARD DRAWINGS" - PROJECT SERVICES UNIT - N.C. DEPARTMENT OF TRANSPORTATION - RALEIGH, N.C., DATED JANUARY 2012 ARE APPLICABLE TO THIS PROJECT AND BY REFERENCE HEREBY ARE CONSIDERED A PART OF THESE PLANS:

STD. NO.	TITLE
1101.01	WORK ZONE WARNING SIGNS
1101.03	TEMPORARY ROAD CLOSURES
1101.11	TRAFFIC CONTROL DESIGN TABLES
1110.01	STATIONARY WORK ZONE SIGNS
1145.01	BARRICADES

LEGEND

GENERAL

- DIRECTION OF TRAFFIC FLOW
- DIRECTION OF PEDESTRIAN TRAFFIC FLOW
- EXIST. PVMT.
- NORTH ARROW
- PROPOSED PVMT.

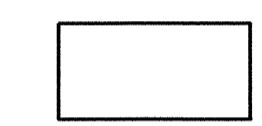
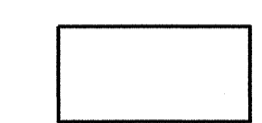
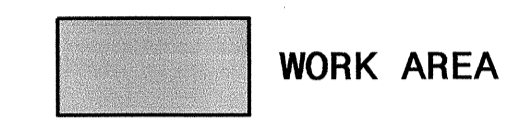

TEMPORARY PAVEMENT MARKING

N/A

TRAFFIC CONTROL DEVICES

- BARRICADE (TYPE III)
- CONE
- DRUM SKINNY DRUM TUBULAR MARKER
- TEMPORARY CRASH CUSHION
- FLASHING ARROW BOARD (TYPE C)
- FLAGGER
- LAW ENFORCEMENT
- TRUCK MOUNTED ATTENUATOR (TMA)
- CHANGEABLE MESSAGE SIGN

TEMPORARY SIGNING

- PORTABLE SIGN
- STATIONARY SIGN
- STATIONARY OR PORTABLE SIGN

SIGNALS

- EXISTING
- PROPOSED
- TEMPORARY

PAVEMENT MARKINGS

- EXISTING LINES
- TEMPORARY LINES

PAVEMENT MARKERS

- CRYSTAL/CRYSTAL
- CRYSTAL/RED
- YELLOW/YELLOW

PAVEMENT MARKING SYMBOLS

- PAVEMENT MARKING SYMBOLS

22-OCT-2012 14:42 \\dot\dfs00101\p\p\TrafficControl\TCP\B-4615.TC.TCP.dgn snussan AT 12265820

APPROVED: <i>Ben Schaubert</i> DATE: 10/22/2012		ROADWAY STANDARD DRAWINGS & LEGEND

MANAGEMENT STRATEGIES

THE FOLLOWING LISTED STRATEGIES DERIVE FROM DETAILED DESIGN LEVEL ASSESSMENTS OF THE WORK ZONE IMPACTS CONDUCTED DURING THE DEVELOPMENTAL STAGES OF THIS TRANSPORTATION MANAGEMENT PLAN (TMP).

RECOMMENDED MANAGEMENT STRATEGIES RELATIVE TO THIS TMP ARE AS FOLLOWS:

- FULL ROAD CLOSURE

TRAFFIC TO BE MAINTAINED ON THE FOLOWING OFF-SITE DETOUR ROUTE THROUGHOUT THE DURATION OF THIS PROJECT.

- SR 1419 (ASLINGTON ST.)
- US 220
- SR 1516 (W./E. GREENE ST.)
- US 1 (FAYETTEVILLE RD.)

PHASING

PHASE 1: USING TMP-2, SD-1, AND ROADWAY STANDARD DRAWING 1101.03, SHEETS 1 AND 2 OF 9, INSTALL DETOUR SIGNS. PLACE TYPE III BARRICADES TO CLOSE SR 1419 (STEELE ST.) TO THROUGH TRAFFIC, AND PLACE TRAFFIC ONTO PROPOSED DETOUR.

PHASE 2: AWAY FROM TRAFFIC:

- 1) REMOVE EXISTING STRUCTURE NO. 46 AND CONSTRUCT PROPOSED STRUCTURE. SEE ROADWAY AND STRUCTURE PLANS.
- 2) CONSTRUCT PROPOSED ROADWAY UP TO AND INCLUDING THE FINAL LAYER OF SURFACE COURSE ON -L-. SEE ROADWAY PLANS.
- 3) PLACE FINAL PAVEMENT MARKINGS AS DIRECTED BY THE ENGINEER.

PHASE 3: REMOVE ALL WORKZONE TRAFFIC CONTROL DEVICES, ALL ROAD CLOSURE SIGNING, AND ALL DETOUR SIGNING. OPEN SR 1419 (STEELE ST.) TO FINAL TRAFFIC PATTERN.

GENERAL NOTES

CHANGES MAY BE REQUIRED WHEN PHYSICAL DIMENSIONS IN THE DETAIL DRAWINGS, STANDARD DETAILS, AND ROADWAY DETAILS ARE NOT ATTAINABLE TO MEET FIELD CONDITIONS OR RESULT IN DUPLICATE OR UNDESIRED OVERLAPPING OF DEVICES. MODIFICATION MAY INCLUDE: MOVING, SUPPLEMENTING, COVERING, OR REMOVAL OF DEVICES AS DIRECTED BY THE ENGINEER.

THE FOLLOWING GENERAL NOTES APPLY AT ALL TIMES FOR THE DURATION OF THE CONSTRUCTION PROJECT EXCEPT WHEN OTHERWISE NOTED IN THE PLAN OR DIRECTED BY THE ENGINEER.

TRAFFIC PATTERN ALTERATIONS

- A) NOTIFY THE ENGINEER TWENTY ONE (21) CALENDAR DAYS PRIOR TO ANY TRAFFIC PATTERN ALTERATION.

SIGNING

- B) PROVIDE SIGNING AND DEVICES REQUIRED TO CLOSE THE ROAD ACCORDING TO THE ROADWAY STANDARD DRAWINGS AND TRAFFIC CONTROL PLANS.

PROVIDE SIGNING REQUIRED FOR THE OFF-SITE DETOUR ROUTE AS SHOWN IN THE TRAFFIC CONTROL PLANS.

- C) COVER OR REMOVE ALL SIGNS AND DEVICES REQUIRED TO CLOSE THE ROAD WHEN ROAD CLOSURE IS NOT IN OPERATION.

COVER OR REMOVE ALL SIGNS REQUIRED FOR THE OFF-SITE DETOUR WHEN THE DETOUR IS NOT IN OPERATION.

- D) ENSURE ALL NECESSARY SIGNING IS IN PLACE PRIOR TO ALTERING ANY TRAFFIC PATTERN.

TRAFFIC CONTROL DEVICES

- E) PLACE TYPE III BARRICADES, WITH "ROAD CLOSED" SIGN R11-2 ATTACHED, OF SUFFICIENT LENGTH TO CLOSE ENTIRE ROADWAY.
- F) TIE PROPOSED PAVEMENT MARKING LINES TO EXISTING PAVEMENT MARKING LINES.

APPROVED: *Joe Johnson* DATE: 10/22/12

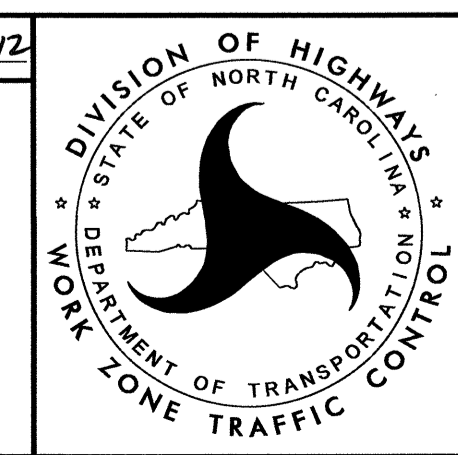
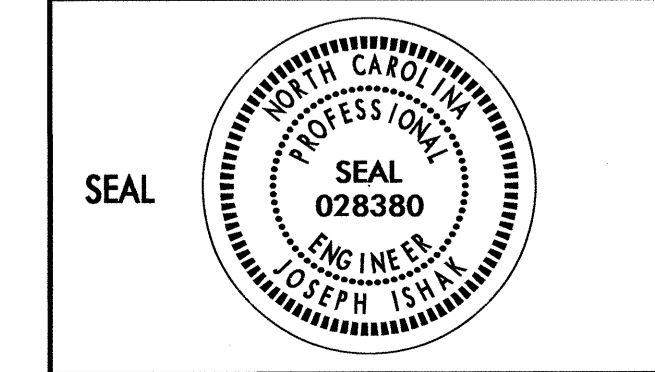

**TRANSPORTATION
OPERATIONS
PLAN**

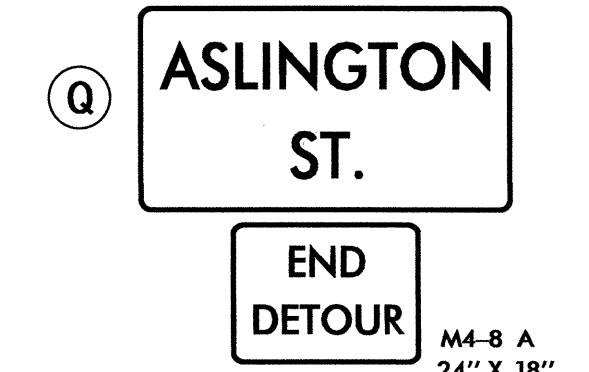
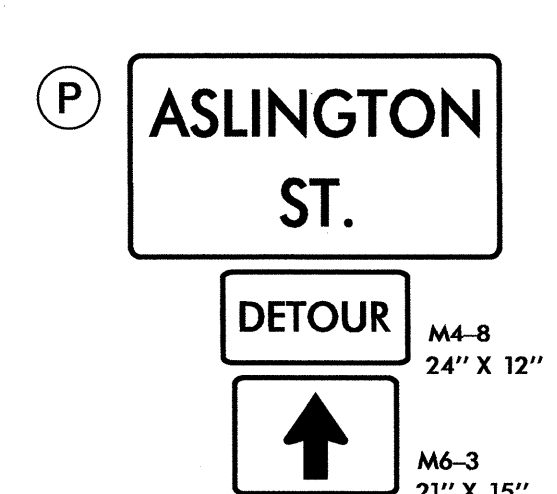
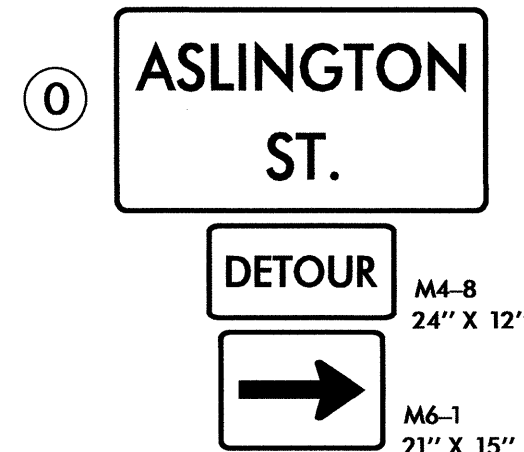
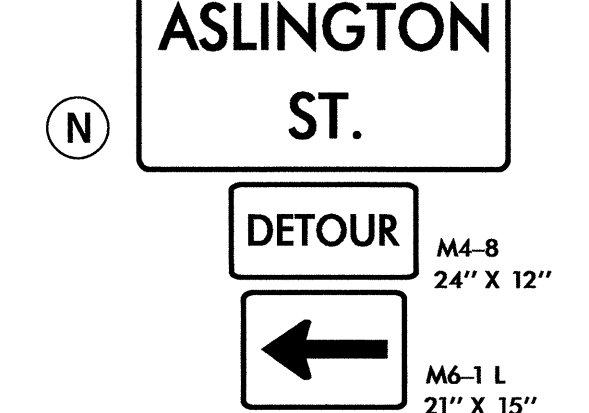
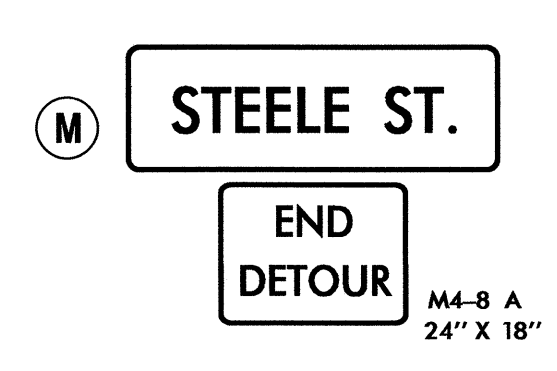
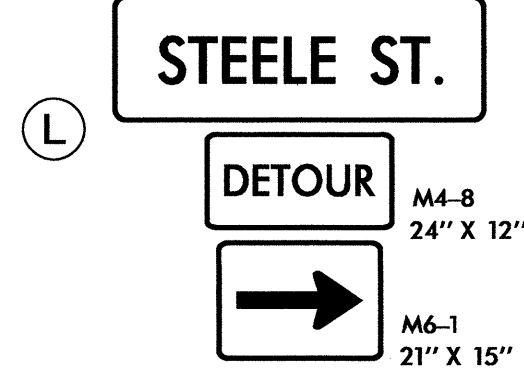
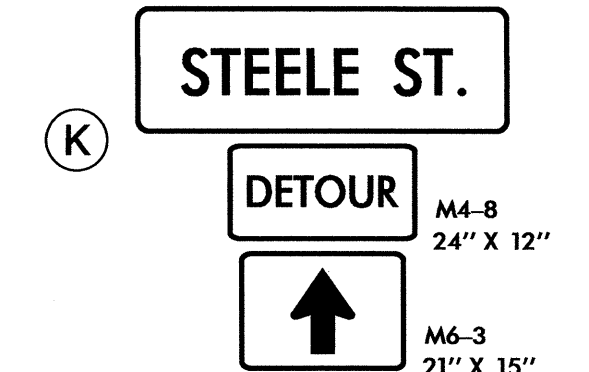
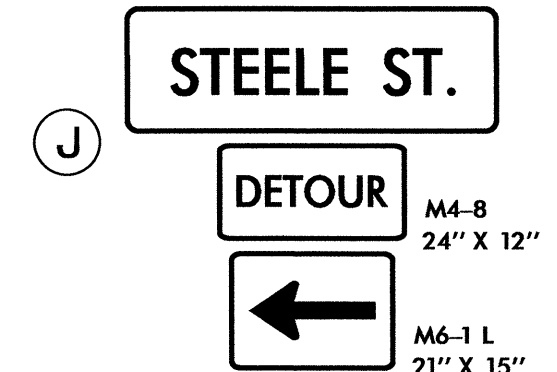
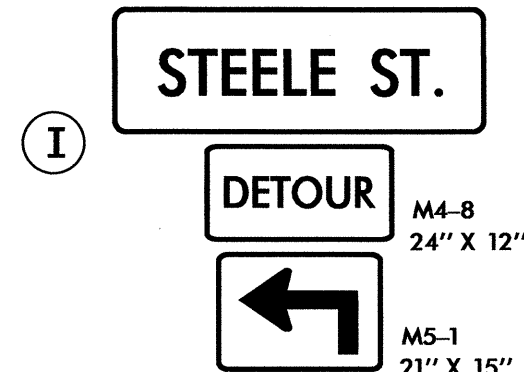
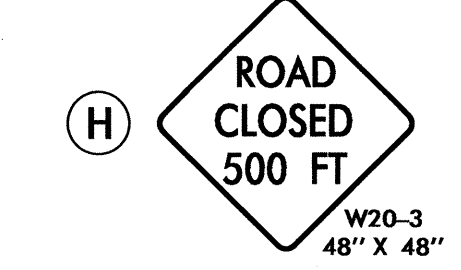
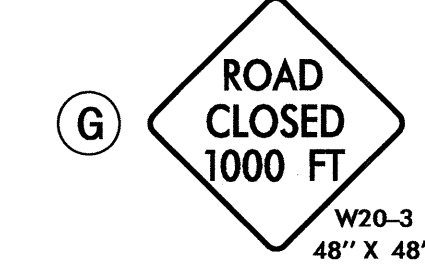
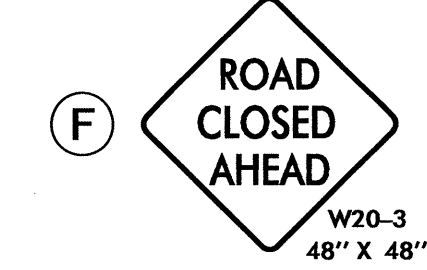
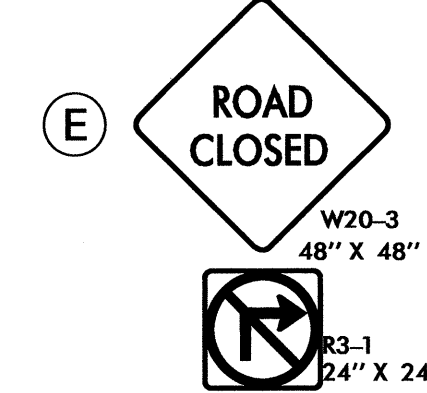
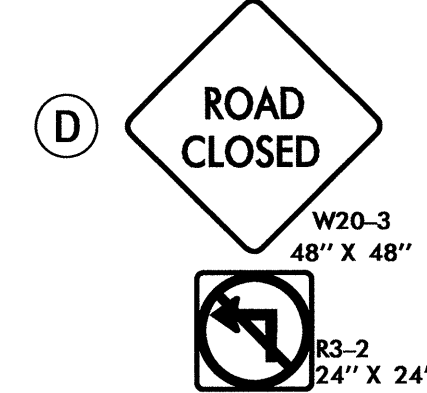
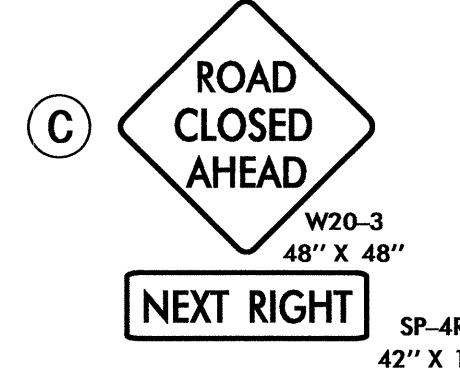
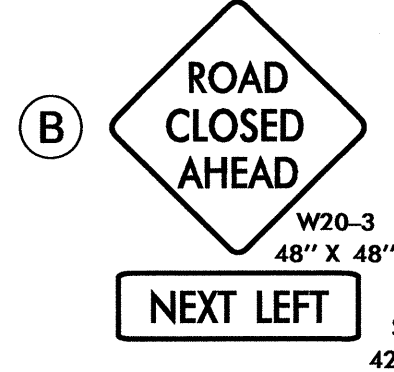
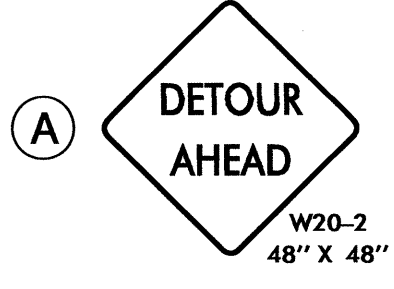
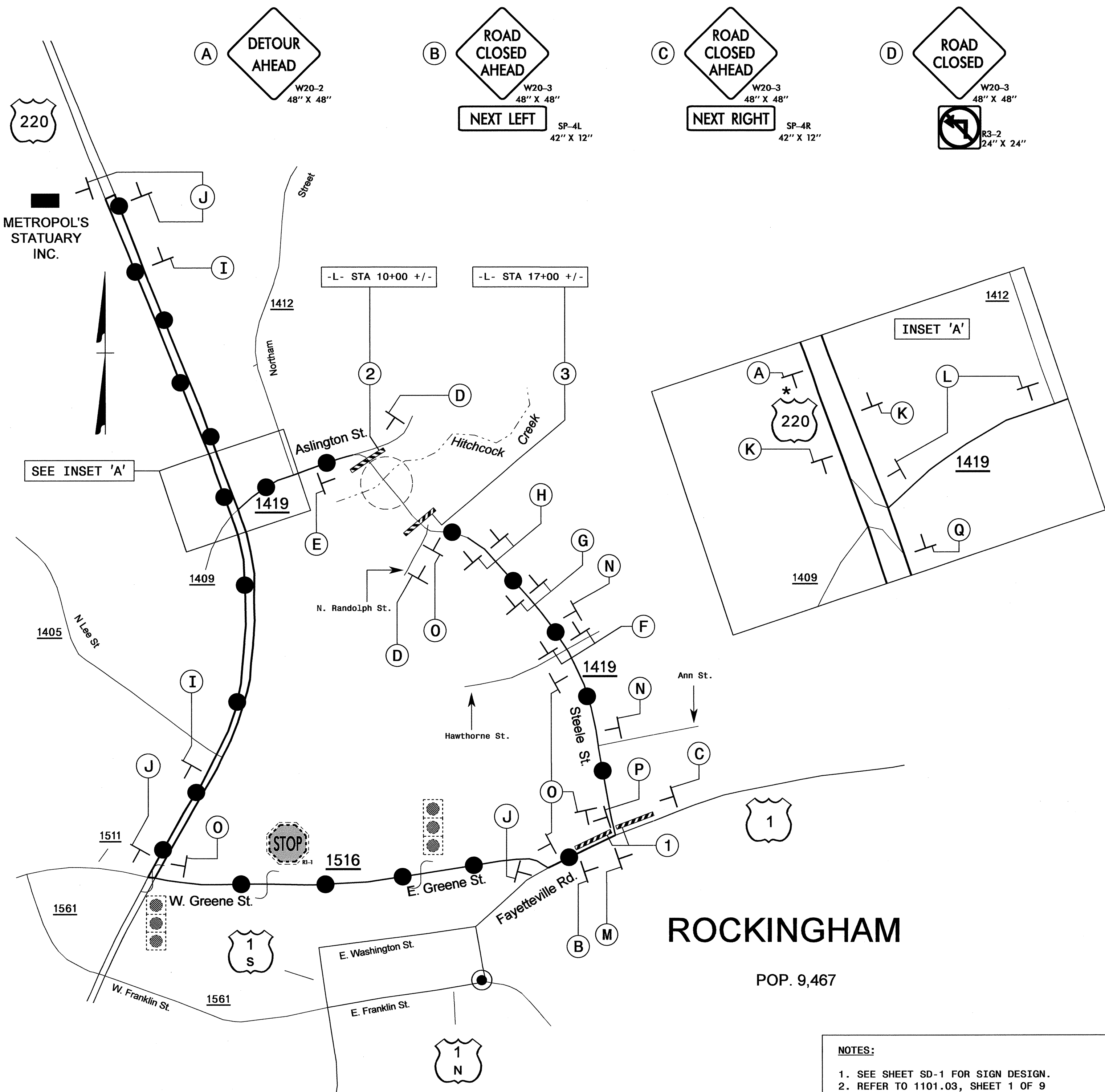
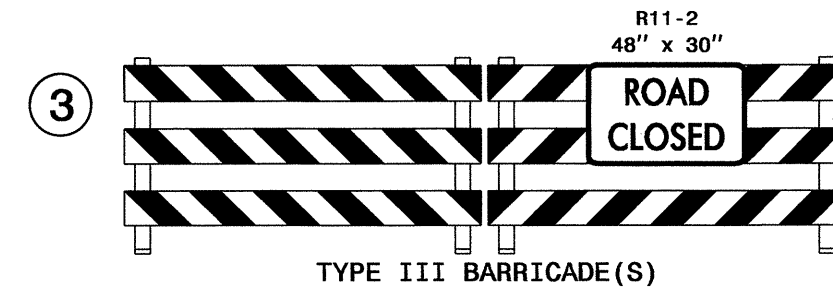
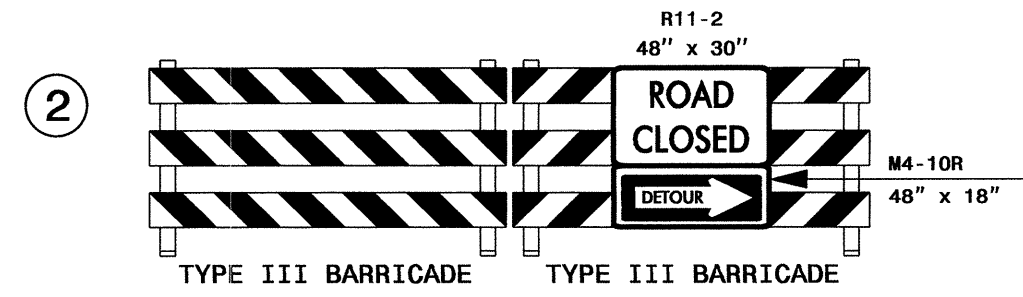
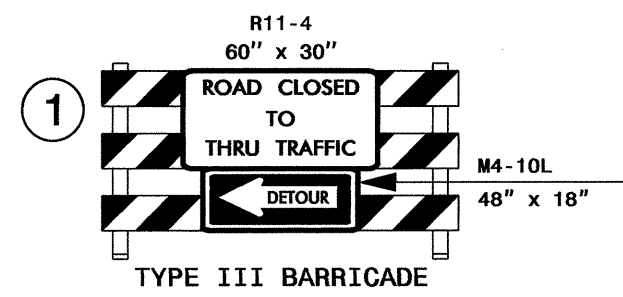

NOTES:
 1. SEE SHEET SD-1 FOR SIGN DESIGN.
 2. REFER TO 1101.03, SHEET 1 OF 9 FOR SIGN DISTANCES.
 * -INSTALL ADDITIONAL SIGN IN MEDIAN

APPROVED: *Paul Schorner* DATE: 10/22/12
 SEAL
 NORTH CAROLINA PROFESSIONAL ENGINEER
 SEAL 35496
 PAUL SCHORNER

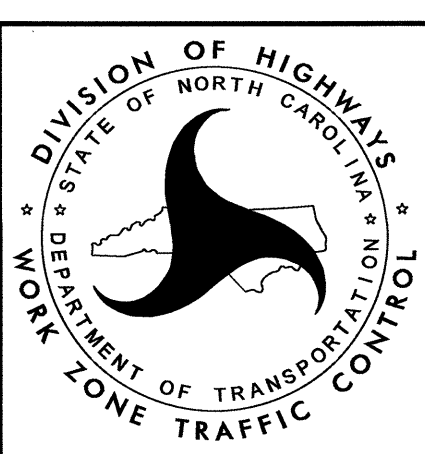

OFF-SITE DETOUR AND BARRICADE PLACEMENT

22-OCT-2012 14:42
 \\dot\dfsroot\Proj\TIPProjects-B\B4615\TrafficControl\TCP\B-4615.TC.TCP_3.dgn
 shanson AT TE265820