

STATE OF NORTH CAROLINA  
DIVISION OF HIGHWAYS

**TRANSPORTATION MANAGEMENT PLAN**

**FORSYTH COUNTY**

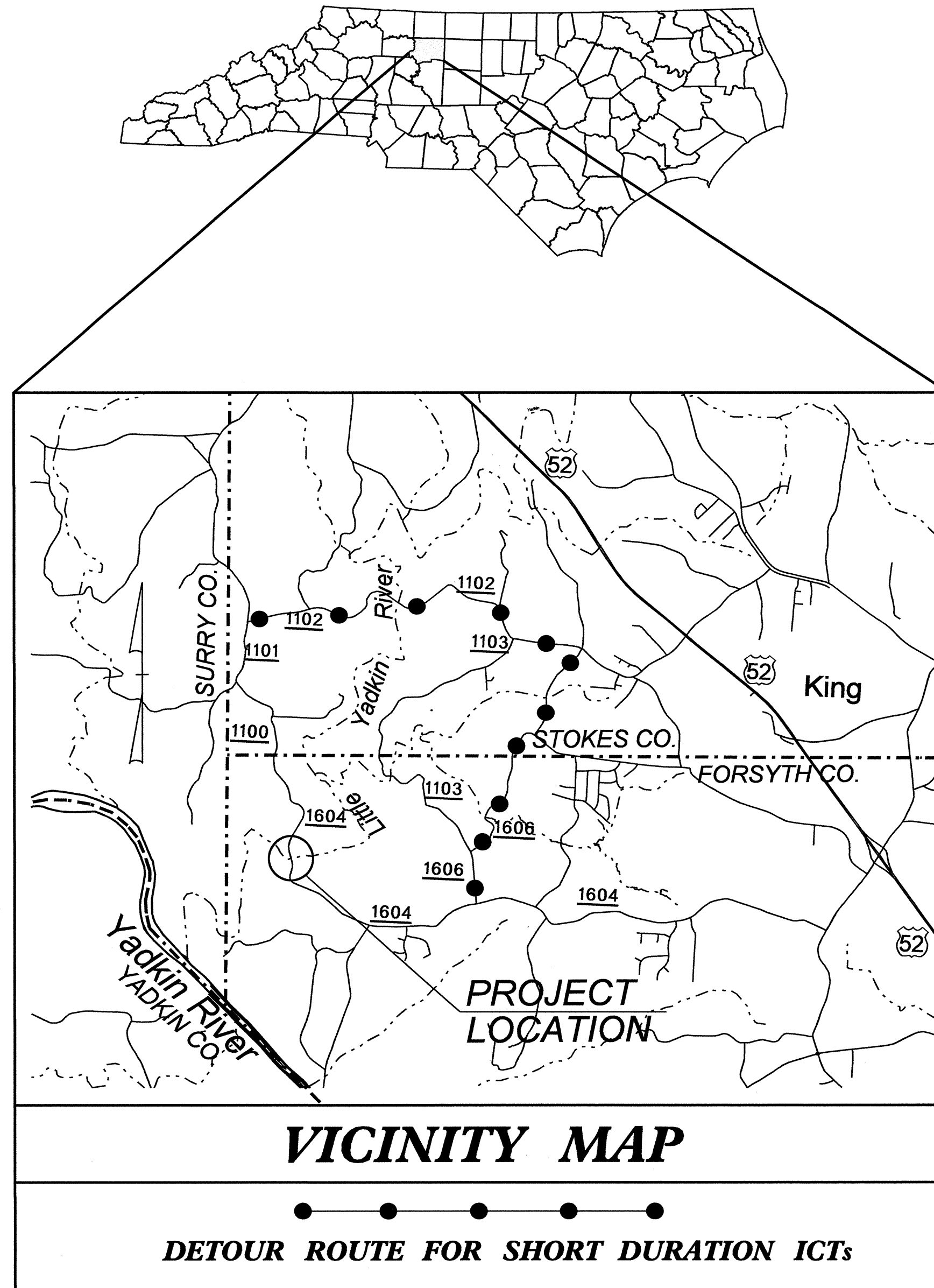

<b>INDEX OF SHEETS</b>	
SHEET NO.	TITLE
TMP-1	TITLE SHEET AND INDEX OF SHEETS
TMP-1A	LIST OF APPLICABLE ROADWAY STANDARD DRAWINGS, LEGEND AND TEMPORARY PAVEMENT MARKING
TMP-1B	TRANSPORTATION OPERATIONS PLAN: (MANAGEMENT STRATEGIES AND GENERAL NOTES)
TMP-2	SPECIAL SIGN DESIGN
TMP-2A	TEMPORARY SHORING NOTES
TMP-3	TEMPORARY TRAFFIC CONTROL PHASING
TMP-4	TEMPORARY TRAFFIC CONTROL PHASE I DETAIL
TMP-5	SPAINHOUR MILL RD. ROAD CLOSURE AND DETOUR SIGNING
TMP-6	TEMPORARY TRAFFIC CONTROL PHASE II DETAIL
TMP-7	TEMPORARY TRAFFIC CONTROL PHASE III DETAIL

O:\NOV-2012-1141\DOT\DOT\PROJ\TIP\Projects-B\B4744\TrafficControl\TCP\B-4744-TC-TMP-1.dgn  
 s.jennings AT TEL65818

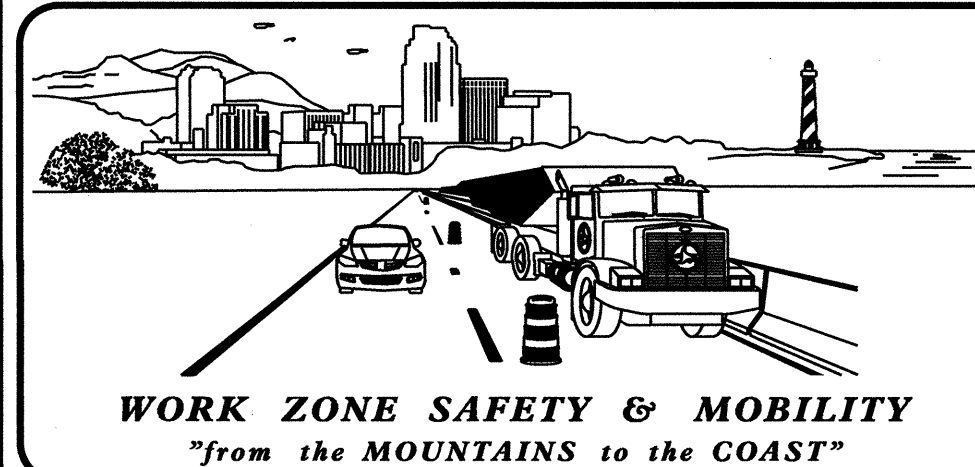

**N.C.D.O.T. WORK ZONE TRAFFIC CONTROL**  
 1561 MAIL SERVICE CENTER (MSC) RALEIGH, NC 27699-1561  
 750 N. GREENFIELD PARKWAY, GARNER, NC 27529 (DELIVERY)  
 PHONE: (919) 773-2800 FAX: (919) 771-2745

J. S. BOURNE, P.E. STATE TRAFFIC MANAGEMENT ENGINEER  
 J. ISHAK, P.E. TRAFFIC CONTROL PROJECT ENGINEER  
 BEN SCHOENBAUER, P.E. TRAFFIC CONTROL PROJECT DESIGN ENGINEER  
 S. B. JENNINGS TRAFFIC CONTROL DESIGN ENGINEER

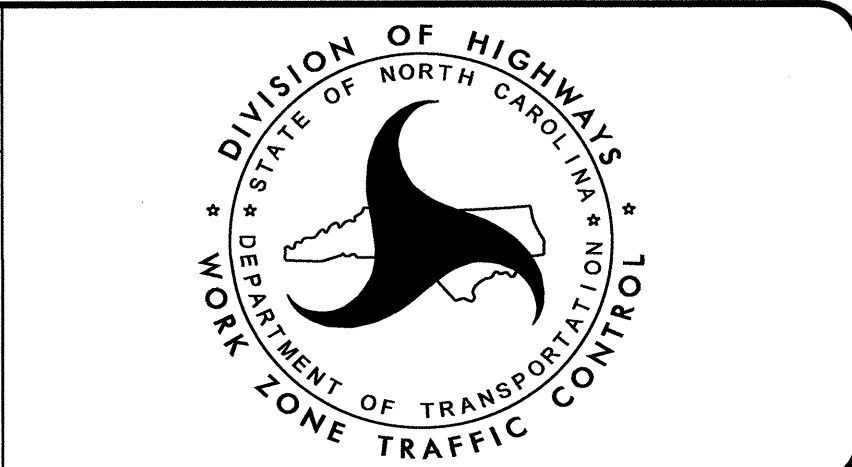

APPROVED: *Ben Schoenbauer*  
 DATE: *November 1, 2012*

**TIP PROJECT: B-4744**

## ROADWAY STANDARD DRAWINGS

THE FOLLOWING ROADWAY STANDARDS AS SHOWN IN "ROADWAY STANDARD DRAWINGS" - PROJECT SERVICES UNIT - N.C. DEPARTMENT OF TRANSPORTATION - RALEIGH, N.C., DATED JANUARY 2012 ARE APPLICABLE TO THIS PROJECT AND BY REFERENCE HEREBY ARE CONSIDERED A PART OF THESE PLANS:

STD. NO.	TITLE
1101.01	WORK ZONE WARNING SIGNS
1101.02	TEMPORARY LANE CLOSURES
1101.03	TEMPORARY ROAD CLOSURES
1101.04	TEMPORARY SHOULDER CLOSURES
1101.05	WORK ZONE VEHICLE ACCESSES
1101.11	TRAFFIC CONTROL DESIGN TABLES
1110.01	STATIONARY WORK ZONE SIGNS
1110.02	PORTABLE WORK ZONE SIGNS
1130.01	DRUMS
1135.01	CONES
1145.01	BARRICADES
1150.01	FLAGGING DEVICES
1205.01	PAVEMENT MARKINGS - LINE TYPES AND OFFSETS
1205.02	PAVEMENT MARKINGS - 2 LANE & MULTILANE ROADWAYS
1205.12	PAVEMENT MARKINGS - BRIDGES
1250.01	PAVEMENT MARKER SPACING
1251.01	RAISED PAVEMENT MARKERS - (PERMANENT AND TEMPORARY)
1261.01	GUARDRAIL AND BARRIER DELINEATOR SPACING
1261.02	GUARDRAIL AND BARRIER DELINEATOR TYPES
1262.01	GUARDRAIL END DELINEATION

## LEGEND

### GENERAL

- DIRECTION OF TRAFFIC FLOW
- DIRECTION OF PEDESTRIAN TRAFFIC FLOW
- EXIST. PVMT.
- NORTH ARROW
- PROPOSED PVMT.
- TEMP. SHORING (LOCATION PURPOSES ONLY)

WORK AREA

REMOVAL

USER DEFINED (IF NEEDED)

USER DEFINED (IF NEEDED)

### SIGNALS

- EXISTING
- PROPOSED
- TEMPORARY

### PAVEMENT MARKINGS

- EXISTING LINES
- TEMPORARY LINES

### TRAFFIC CONTROL DEVICES

- BARRICADE (TYPE III)
- CONE
- DRUM
- SKINNY DRUM
- TUBULAR MARKER
- TEMPORARY CRASH CUSHION
- FLASHING ARROW BOARD
- FLAGGER
- LAW ENFORCEMENT
- TRUCK MOUNTED ATTENUATOR (TMA)
- CHANGEABLE MESSAGE SIGN

### TEMPORARY SIGNING

- PORTABLE SIGN
- STATIONARY SIGN
- STATIONARY OR PORTABLE SIGN

### PAVEMENT MARKERS

- CRYSTAL/CRYSTAL
- CRYSTAL/RED
- YELLOW/YELLOW

### PAVEMENT MARKING SYMBOLS

- PAVEMENT MARKING SYMBOLS

### TEMPORARY PAVEMENT MARKING

- PA WHITE EDGELINE
- PI DOUBLE YELLOW CENTERLINE

### TEMPORARY MARKERS

- MH YELLOW & YELLOW

APPROVED: *Ben Schenck* DATE: 11/1/2012

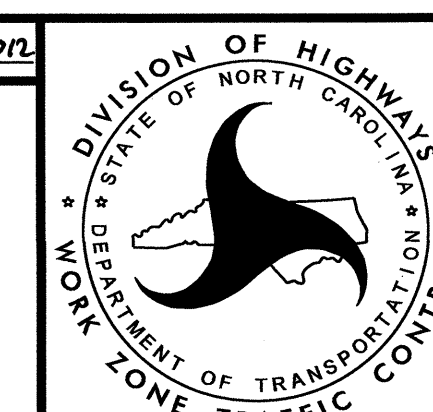
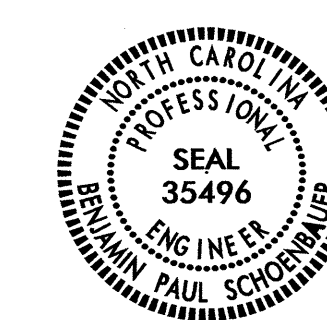

ROADWAY STANDARD  
DRAWINGS & LEGEND

## MANAGEMENT STRATEGIES

TRAFFIC ON SR 1604 (SPAINHOUR MILL RD) WILL BE MAINTAINED ON A TEMPORARY ON-SITE DETOUR WHILE THE PROPOSED ROADWAY AND STRUCTURE IS CONSTRUCTED. WHILE MOST CONSTRUCTION ACTIVITY WILL TAKE PLACE AWAY FROM TRAFFIC, FLAGGERS WILL BE UTILIZED AS NECESSARY. OFF-SITE DETOURS WILL BE USED ON TWO SEPERATE WEEKENDS TO COMPLETE TIE-INS, GUARDRAIL INSTALLATION AND TRAFFIC SHIFTS.

## GENERAL NOTES

CHANGES MAY BE REQUIRED WHEN PHYSICAL DIMENSIONS IN THE DETAIL DRAWINGS, STANDARD DETAILS, AND ROADWAY DETAILS ARE NOT ATTAINABLE TO MEET FIELD CONDITIONS OR RESULT IN DUPLICATE OR UNDESIRE OVERLAPPING OF DEVICES. MODIFICATION MAY INCLUDE: MOVING, SUPPLEMENTING, COVERING, OR REMOVAL OF DEVICES AS DIRECTED BY THE ENGINEER.

THE FOLLOWING GENERAL NOTES APPLY AT ALL TIMES FOR THE DURATION OF THE CONSTRUCTION PROJECT EXCEPT WHEN OTHERWISE NOTED IN THE PLAN OR DIRECTED BY THE ENGINEER.

- A) DO NOT CONDUCT ANY HAULING OPERATIONS AGAINST THE FLOW OF TRAFFIC OF AN OPEN TRAVELWAY UNLESS THE HAULING OPERATION IS PROTECTED BY BARRIER OR GUARDRAIL OR AS DIRECTED BY THE ENGINEER.

### LANE AND SHOULDER CLOSURE REQUIREMENTS

- B) REMOVE LANE CLOSURE DEVICES FROM THE LANE WHEN WORK IS NOT BEING PERFORMED BEHIND THE LANE CLOSURE OR WHEN A LANE CLOSURE IS NO LONGER NEEDED OR AS DIRECTED BY THE ENGINEER.
- C) WHEN PERSONNEL AND/OR EQUIPMENT ARE WORKING WITHIN 15 FT OF AN OPEN TRAVEL LANE, CLOSE THE NEAREST OPEN SHOULDER USING ROADWAY STANDARD DRAWING NO. 1101.04 UNLESS THE WORK AREA IS PROTECTED BY BARRIER OR GUARDRAIL OR A LANE CLOSURE IS INSTALLED.
- D) WHEN PERSONNEL AND/OR EQUIPMENT ARE WORKING ON THE SHOULDER ADJACENT TO AN UNDIVIDED FACILITY AND WITHIN 5 FT OF AN OPEN TRAVEL LANE, CLOSE THE NEAREST OPEN TRAVEL LANE USING ROADWAY STANDARD DRAWING NO. 1101.02 UNLESS THE WORK AREA IS PROTECTED BY BARRIER OR GUARDRAIL.
- E) WHEN PERSONNEL AND/OR EQUIPMENT ARE WORKING WITHIN A LANE OF TRAVEL OF AN UNDIVIDED OR DIVIDED FACILITY, CLOSE THE LANE ACCORDING TO THE TRAFFIC CONTROL PLANS, ROADWAY STANDARD DRAWINGS, OR AS DIRECTED BY THE ENGINEER. CONDUCT THE WORK SO THAT ALL PERSONNEL AND/OR EQUIPMENT REMAIN WITHIN THE CLOSED TRAVEL LANE.
- F) DO NOT WORK SIMULTANEOUSLY WITHIN 15 FT ON BOTH SIDES OF AN OPEN TRAVELWAY, RAMP, OR LOOP WITHIN THE SAME LOCATION UNLESS PROTECTED WITH GUARDRAIL OR BARRIER.
- G) PROVIDE TRAFFIC CONTROL FOR APPROPRIATE LANE CLOSURES FOR SURVEYING DONE BY THE DEPARTMENT.

### PAVEMENT EDGE DROP OFF REQUIREMENTS

- H) BACKFILL AT A 6:1 SLOPE UP TO THE EDGE AND ELEVATION OF EXISTING PAVEMENT IN AREAS ADJACENT TO AN OPENED TRAVEL LANE THAT HAS AN EDGE OF PAVEMENT DROP-OFF AS FOLLOWS:
- BACKFILL DROP-OFFS THAT EXCEED 2 INCHES ON ROADWAYS WITH POSTED SPEED LIMITS OF 45 MPH OR GREATER.
- BACKFILL DROP-OFFS THAT EXCEED 3 INCHES ON ROADWAYS WITH POSTED SPEED LIMITS LESS THAN 45 MPH.
- BACKFILL WITH SUITABLE COMPACTED MATERIAL, AS APPROVED BY THE ENGINEER, AT NO EXPENSE TO THE DEPARTMENT.
- I) DO NOT EXCEED A DIFFERENCE OF 2 INCHES IN ELEVATION BETWEEN OPEN LANES OF TRAFFIC FOR NOMINAL LIFTS OF 1.5 INCHES. INSTALL ADVANCE WARNING "UNEVEN LANES" SIGNS (W8-11) 500 FEET IN ADVANCE AND A MINIMUM OF EVERY HALF MILE THROUGHOUT THE UNEVEN AREA.

### TRAFFIC PATTERN ALTERATIONS

- J) NOTIFY THE ENGINEER THIRTY (30) CALENDAR DAYS PRIOR TO ANY TRAFFIC PATTERN ALTERATION.

### SIGNING

- K) INSTALL ADVANCE WORK ZONE WARNING SIGNS WHEN WORK IS WITHIN 40 FT FROM THE EDGE OF TRAVEL LANE AND NO MORE THAN THREE (3) DAYS PRIOR TO THE BEGINNING OF CONSTRUCTION.
- L) PROVIDE SIGNING AND DEVICES REQUIRED TO CLOSE THE ROAD ACCORDING TO THE ROADWAY STANDARD DRAWINGS AND TRAFFIC CONTROL PLANS.
- PROVIDE SIGNING REQUIRED FOR THE OFF-SITE DETOUR ROUTE AS SHOWN IN THE TRAFFIC CONTROL PLANS.
- M) COVER OR REMOVE ALL SIGNS AND DEVICES REQUIRED TO CLOSE THE ROAD WHEN ROAD CLOSURE IS NOT IN OPERATION.
- COVER OR REMOVE ALL SIGNS REQUIRED FOR THE OFF-SITE DETOUR WHEN THE DETOUR IS NOT IN OPERATION.
- N) ENSURE ALL NECESSARY SIGNING IS IN PLACE PRIOR TO ALTERING ANY TRAFFIC PATTERN.
- O) INSTALL BLACK ON ORANGE "DIP" SIGNS (W8-2) AND/OR "BUMP" SIGNS (W8-1) 500 FEET IN ADVANCE OF THE UNEVEN AREA, OR AS DIRECTED BY THE ENGINEER.

### TRAFFIC CONTROL DEVICES

- P) WHEN LANE CLOSURES ARE NOT IN EFFECT SPACE CHANNELIZING DEVICES IN WORK AREAS NO GREATER IN FEET THAN TWICE THE POSTED SPEED LIMIT (MPH) EXCEPT, 10 FT ON-CENTER IN RADII, AND 3 FT OFF THE EDGE OF AN OPEN TRAVELWAY. REFER TO STANDARD SPECIFICATIONS FOR ROADS AND STRUCTURES SECTIONS 1130 (DRUMS), 1135 (CONES) AND 1180 (SKINNY DRUMS) FOR ADDITIONAL REQUIREMENTS.
- Q) PLACE TYPE III BARRICADES, WITH "ROAD CLOSED" SIGN R11-2 ATTACHED, OF SUFFICIENT LENGTH TO CLOSE ENTIRE ROADWAY.
- R) PLACE ADDITIONAL SETS OF THREE CHANNELIZING DEVICES PERPENDICULAR TO THE EDGE OF TRAVELWAY ON 500 FT CENTERS WHEN UNOPENED LANES ARE CLOSED TO TRAFFIC.

### PAVEMENT MARKINGS AND MARKERS

- S) INSTALL TEMPORARY PAVEMENT MARKINGS AND TEMPORARY PAVEMENT MARKERS ON INTERIM LAYERS OF PAVEMENT AS FOLLOWS:
- | ROAD NAME | MARKING | MARKER           |
|-----------|---------|------------------|
| SR 1604   | PAINT   | TEMPORARY RAISED |
- T) PLACE ONE APPLICATION OF PAINT FOR TEMPORARY TRAFFIC PATTERNS. PLACE A SECOND APPLICATION OF PAINT SIX (6) MONTHS AFTER THE INITIAL APPLICATION AND EVERY SIX MONTHS AS DIRECTED BY THE ENGINEER.
- U) TIE PROPOSED PAVEMENT MARKING LINES TO EXISTING PAVEMENT MARKING LINES.
- V) REMOVE/REPLACE ANY CONFLICTING/DAMAGED PAVEMENT MARKINGS AND MARKERS BY THE END OF EACH DAY'S OPERATION.

APPROVED: *Paul Schorbaum* DATE: 11/1/2012

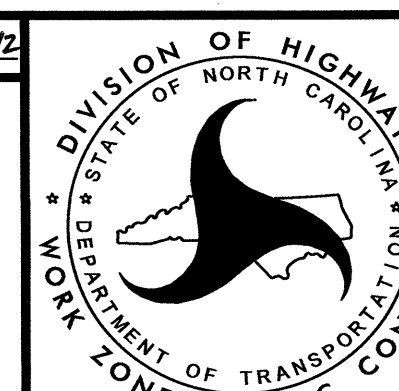
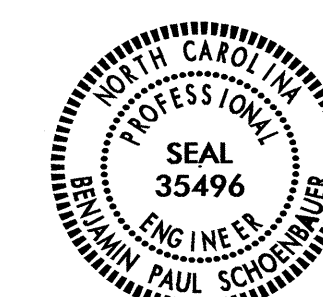

**TRANSPORTATION  
OPERATIONS  
PLAN**



TEMPORARY SHORING NO. 1

FOR TEMPORARY SHORING AND POSITIVE PROTECTION FOR TEMPORARY SHORING, SEE PLANS AND TEMPORARY SHORING PROVISION. BEFORE BEGINNING TEMPORARY SHORING DESIGN OR CONSTRUCTION, SURVEY EXISTING GROUND ELEVATIONS IN THE VICINITY OF SHORING LOCATIONS TO DETERMINE ACTUAL SHORING HEIGHTS.

DO NOT USE A TEMPORARY WALL FOR TEMPORARY SHORING FROM STATION 16+87.00 +/- -L-, 23.0 FT. RIGHT OF -L-, TO STATION 17+07.00 +/- -L-, 23.0 FT. RIGHT OF -L-.

AT THE CONTRACTOR\*S OPTION, USE STANDARD TEMPORARY SHORING FOR TEMPORARY SHORING FROM STATION 16+87.00 +/- -L-, 23.0 FT. RIGHT OF -L-, TO STATION 17+07.00 +/- -L-, 23.0 FT. RIGHT OF -L-. SEE STANDARD DRAWING NO. 1801.01 FOR STANDARD TEMPORARY SHORING.

DESIGN TEMPORARY SHORING FROM STATION 16+87.00 +/- -L-, 23.0 FT. RIGHT OF -L-, TO STATION 17+07.00 +/- -L-, 23.0 FT. RIGHT OF -L-. FOR THE FOLLOWING ASSUMED SOIL PARAMETERS AND GROUNDWATER ELEVATION:

UNIT WEIGHT ( $\gamma$ ) = 120 PCF  
 FRICTION ANGLE ( $\phi$ ) = 30 DEGREES  
 COHESION (c) = 0 PSF  
 GROUNDWATER ELEVATION = 20 FT

LIMITED SUBSURFACE INFORMATION IS AVAILABLE IN THE VICINITY OF TEMPORARY SHORING FROM STATION 16+87.00 +/- -L-, 23.0 FT. RIGHT OF -L-, TO STATION 17+07.00 +/- -L-, 23.0 FT. RIGHT OF -L-. THE INFORMATION PROVIDED FOR TEMPORARY SHORING DESIGN WAS ASSUMED AND MAY NOT BE APPLICABLE TO THE ACTUAL SITE CONDITIONS ENCOUNTERED DURING CONSTRUCTION.

TEMPORARY SHORING NO. 2

FOR TEMPORARY SHORING AND POSITIVE PROTECTION FOR TEMPORARY SHORING, SEE PLANS AND TEMPORARY SHORING PROVISION.

BEFORE BEGINNING TEMPORARY SHORING DESIGN OR CONSTRUCTION, SURVEY EXISTING GROUND ELEVATIONS IN THE VICINITY OF SHORING LOCATIONS TO DETERMINE ACTUAL SHORING HEIGHTS.

DO NOT USE A TEMPORARY WALL FOR TEMPORARY SHORING FROM STATION 18+66.00 +/- -L-, 23.0 FT. RIGHT OF -L-, TO STATION 18+86.00 +/- -L-, 23.0 FT. RIGHT OF -L-.

AT THE CONTRACTOR\*S OPTION, USE STANDARD TEMPORARY SHORING FOR TEMPORARY SHORING FROM STATION 18+66.00 +/- -L-, 23.0 FT. RIGHT OF -L-, TO STATION 18+86.00 +/- -L-, 23.0 FT. RIGHT OF -L-. SEE STANDARD DRAWING NO. 1801.01 FOR STANDARD TEMPORARY SHORING.

DESIGN TEMPORARY SHORING FROM STATION 18+66.00 +/- -L-, 23.0 FT. RIGHT OF -L-, TO STATION 18+86.00 +/- -L-, 23.0 FT. RIGHT OF -L-, FOR THE FOLLOWING ASSUMED SOIL PARAMETERS AND GROUNDWATER ELEVATION:

UNIT WEIGHT ( $\gamma$ ) = 115 PCF  
 FRICTION ANGLE ( $\phi$ ) = 20 DEGREES  
 COHESION (c) = 100 PSF  
 GROUNDWATER ELEVATION = 17 FT

LIMITED SUBSURFACE INFORMATION IS AVAILABLE IN THE VICINITY OF TEMPORARY SHORING FROM STATION 18+66.00 +/- -L-, 23.0 FT. RIGHT OF -L-, TO STATION 18+86.00 +/- -L-, 23.0 FT. RIGHT OF -L-. THE INFORMATION PROVIDED FOR TEMPORARY SHORING DESIGN WAS ASSUMED AND MAY NOT BE APPLICABLE TO THE ACTUAL SITE CONDITIONS ENCOUNTERED DURING CONSTRUCTION.

01-NOV-2012 11:43  
 \\DOT\DESR00\DOT\PROJ\TIP\Projects-B\B4744\TrafficControl\TCP\B-4744\_TC\_TMP\_2A.dgn  
 sbjennings AT TE265818

\*THE TEMPORARY SHORING NOTES SHOWN ON THIS SHEET WERE PROVIDED THROUGH A SEALED DOCUMENT FROM THE GEOTECHNICAL ENGINEERING UNIT. THE DOCUMENT WAS SUBMITTED TO THE WZTC SECTION ON 10/31/2012 AND SEALED BY A PROFESSIONAL ENGINEER, SHANE C. CLARK, LICENSE # 029869.

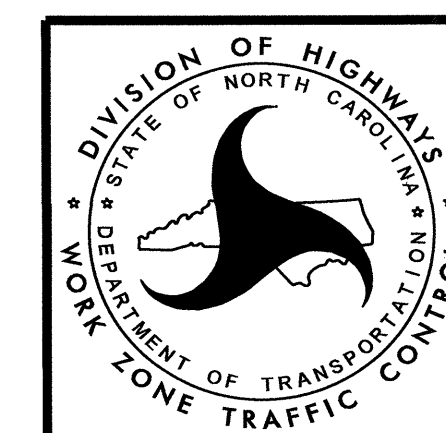

TEMPORARY SHORING NOTES

## PHASING

- NOTES: - IN THE PHASING SHOWN BELOW "FLAGGER" IS DEFINED AS RSD 1101.02, SHEET 1 OF 15.
- IN THE PHASING SHOWN BELOW "SHOULDER CLOSURE" IS DEFINED AS RSD 1101.04, SHEET 1 OF 1.
- MAINTAIN VEHICULAR ACCESS TO DRIVEWAYS AT ALL TIMES UNLESS OTHERWISE DIRECTED BY THE ENGINEER.

### PHASE I

#### STEP 1

- INSTALL ADVANCED WORK ZONE WARNING SIGNS ON EXISTING SR 1604 (SPAINHOUR MILL RD) AS REQUIRED IN PROJECT NOTES. (SEE SHEET TMP-1B)

#### STEP 2

- AWAY FROM TRAFFIC AND USING FLAGGERS AND SHOULDER CLOSURES, AS NECESSARY, CONSTRUCT TEMPORARY BRIDGE AND CONSTRUCT -DET- TO THE EDGE AND ELEVATION OF EXISTING SR 1604. (SEE SHEET TMP-4)
- AWAY FROM TRAFFIC, PERFORM THE FOLLOWING: (SEE SHEET TMP-4)
  - CONSTRUCT -DRV1- FROM EDGE AND ELEVATION OF -DET- TO -DET- STA. 11+00.
  - BEGIN INSTALLATION OF TEMPORARY GUARDRAIL ON -DET- SB.
- INSTALL ROAD CLOSURE AND DETOUR SIGNING AS SHOWN ON SHEET TMP-5. (REFER TO RSD 1101.03, SHEET 1 OF 9). COVER SIGNS UNTIL READY TO CLOSE SR 1604.

COMPLETE THE WORK REQUIRED IN PHASE I, STEPS 3 THROUGH 5, FROM A SATURDAY AT 6:00 A.M. TO THE FOLLOWING SUNDAY AT 6:00 P.M. SEE INTERMEDIATE CONTRACT TIME AND LIQUIDATED DAMAGES.

#### STEP 3

- USING RSD 1101.03, SHEET 1 OF 9, INSTALL BARRICADES, UNCOVER ROAD CLOSURE AND DETOUR SIGNING, AS SHOWN ON SHEET SHEET TMP-5. CLOSE SR 1604 AND DETOUR TRAFFIC.

#### STEP 4

- AWAY FROM TRAFFIC, CONSTRUCT TIE-INS FROM -DET- STA. 10+00 +/- TO -DET- STA. 18+98 +/--. (SEE SHEET TMP-4) REMOVE ANY CONFLICTING PAVEMENT MARKINGS AND PLACE TEMPORARY PAVEMENT MARKINGS AND MARKERS FOR TEMPORARY TRAFFIC PATTERN. (SEE SHEET TMP-6)
- COMPLETE INSTALLATION OF TEMPORARY GUARDRAIL ON -DET-. (SEE SHEET TMP-6)

#### STEP 5

- REMOVE BARRICADES, COVER ROAD CLOSURE SIGNING AND DETOUR SIGNING. OPEN -DET- TO PHASE II TRAFFIC PATTERN.

### PHASE II

#### STEP 1

- AWAY FROM TRAFFIC, AND USING FLAGGERS AND SHOULDER CLOSURES, AS NECESSARY, PERFORM THE FOLLOWING: (SEE SHEET TMP-6)
  - CONSTRUCT -L- STA. 13+20 +/- TO STA. 23+60 +/--, UP TO BUT NOT INCLUDING THE FINAL SURFACE COURSE.
  - CONSTRUCT -DRV2- AND -DRV3-.
  - BEGIN INSTALLATION OF PROPOSED GUARDRAIL AS SHOWN ON SHEET TMP-6.

COMPLETE THE WORK REQUIRED IN PHASE II, STEPS 2 THROUGH 4, FROM A SATURDAY AT 6:00 A.M. TO THE FOLLOWING SUNDAY AT 6:00 P.M. SEE INTERMEDIATE CONTRACT TIME AND LIQUIDATED DAMAGES.

#### STEP 2

- USING RSD 1101.03, SHEET 1 OF 9, INSTALL BARRICADES, UNCOVER ROAD CLOSURE AND DETOUR SIGNING, AS SHOWN ON SHEET TMP-5. CLOSE SR 1604 AND DETOUR TRAFFIC.

#### STEP 3

- AWAY FROM TRAFFIC, CONSTRUCT TIE-INS FROM -L- STA. 13+20 +/- TO -L- STA. 23+60 +/--. (SEE SHEET TMP-7) REMOVE ANY CONFLICTING PAVEMENT MARKINGS AND PLACE TEMPORARY PAVEMENT MARKINGS AND MARKERS FOR FINAL TRAFFIC PATTERN. (SEE SHEET TMP-7)
- COMPLETE INSTALLATION OF PROPOSED GUARDRAIL ON -L-. (SEE SHEET TMP-7)

#### STEP 4

- REMOVE BARRICADES, ROAD CLOSURE AND DETOUR SIGNING. OPEN -L- TO FINAL TWO LANE, TWO WAY PATTERN.

### PHASE III

#### STEP 1

- AWAY FROM TRAFFIC AND USING FLAGGERS AND SHOULDER CLOSURES, AS NECESSARY, PERFORM THE FOLLOWING: (SEE SHEET TMP-7)
  - REMOVE -DET- AND TEMPORARY BRIDGE.
  - COMPLETE -DRV1-.
  - CONSTRUCT REMAINING SHOULDER

#### STEP 2

- USING FLAGGERS, PLACE FINAL LAYER OF SURFACE COURSE AND FINAL PAVEMENT MARKINGS AND MARKERS IN FINAL PATTERN. (SEE PAVEMENT MARKING PLANS)

#### STEP 3

- REMOVE ALL REMAINING TRAFFIC CONTROL DEVICES.

36 HOUR ICT

36 HOUR ICT

APPROVED: *Paul Schoenberger* DATE: 11/1/2012

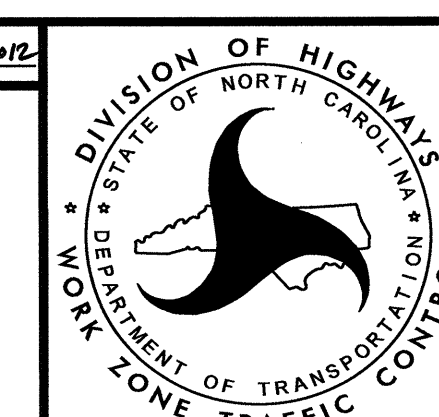
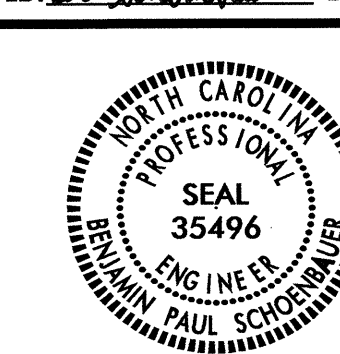

**TEMPORARY  
TRAFFIC CONTROL  
PHASING**

# FORSYTH COUNTY

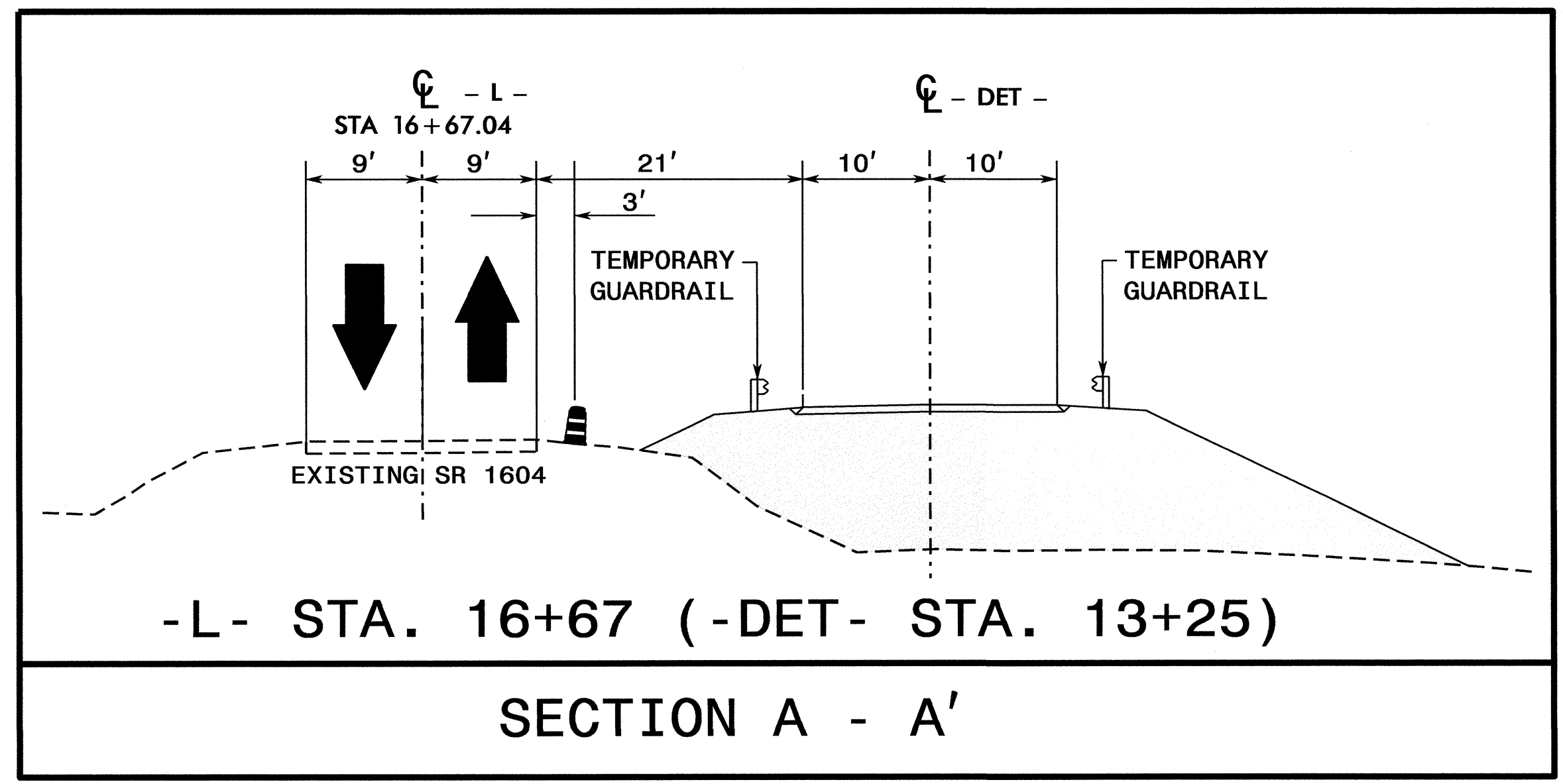
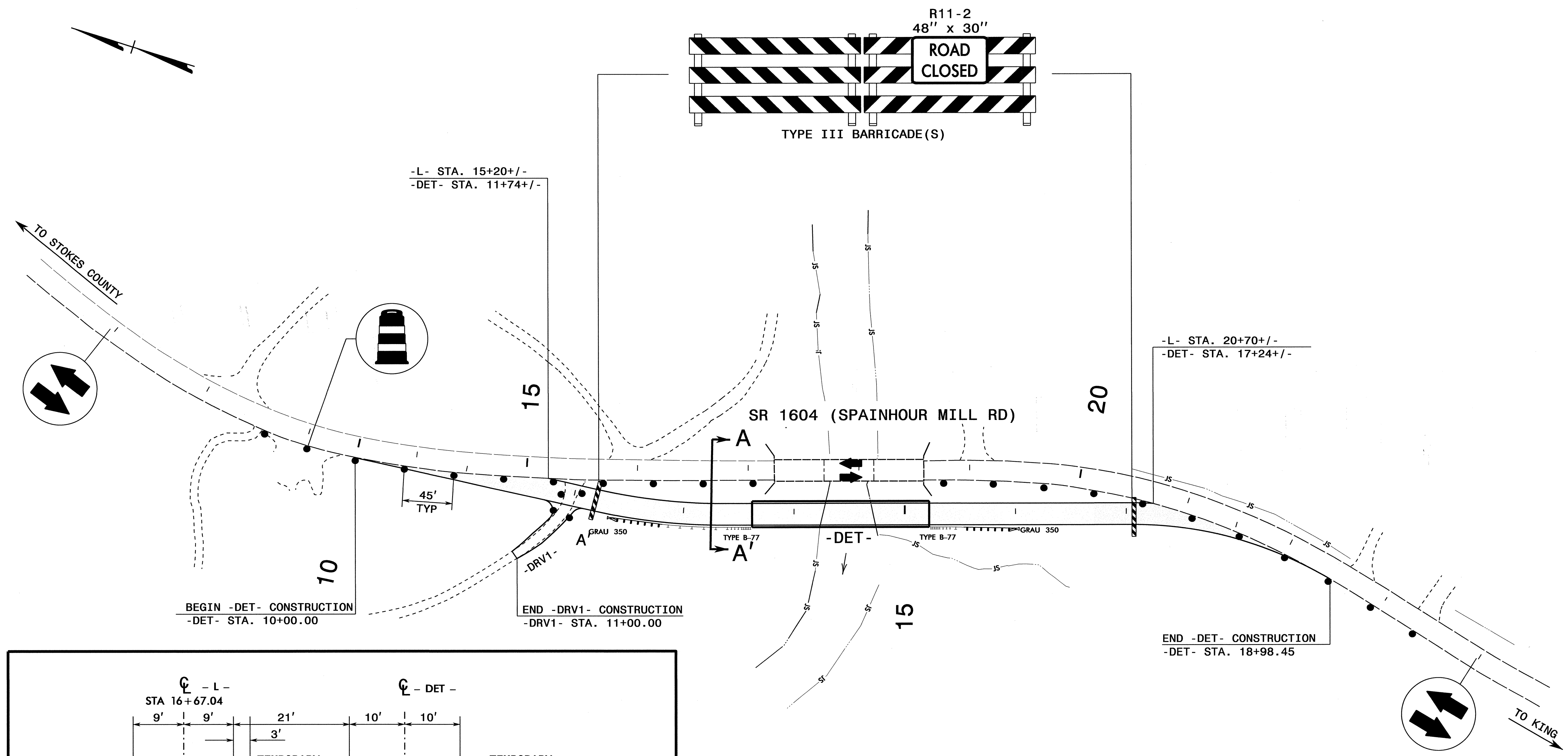

APPROVED: *ben schroeder* DATE: 11/1/2012

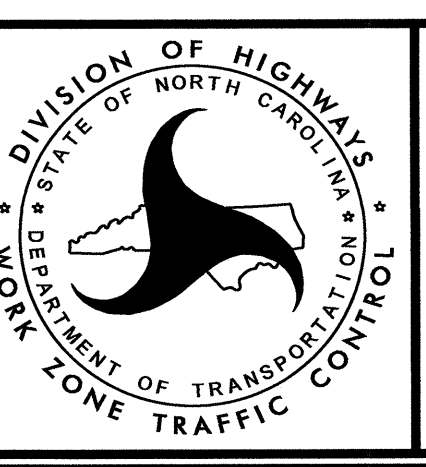

**TEMPORARY TRAFFIC CONTROL PHASE I DETAIL**

01-NOV-2012 11:45  
 \\D01V055R00701\PROJ\TIP\Projects-B\B4744\TrafficControl\TCP\B-4744-TC-TMP\_4.dgn  
 sbjennings AT

# FORSYTH COUNTY

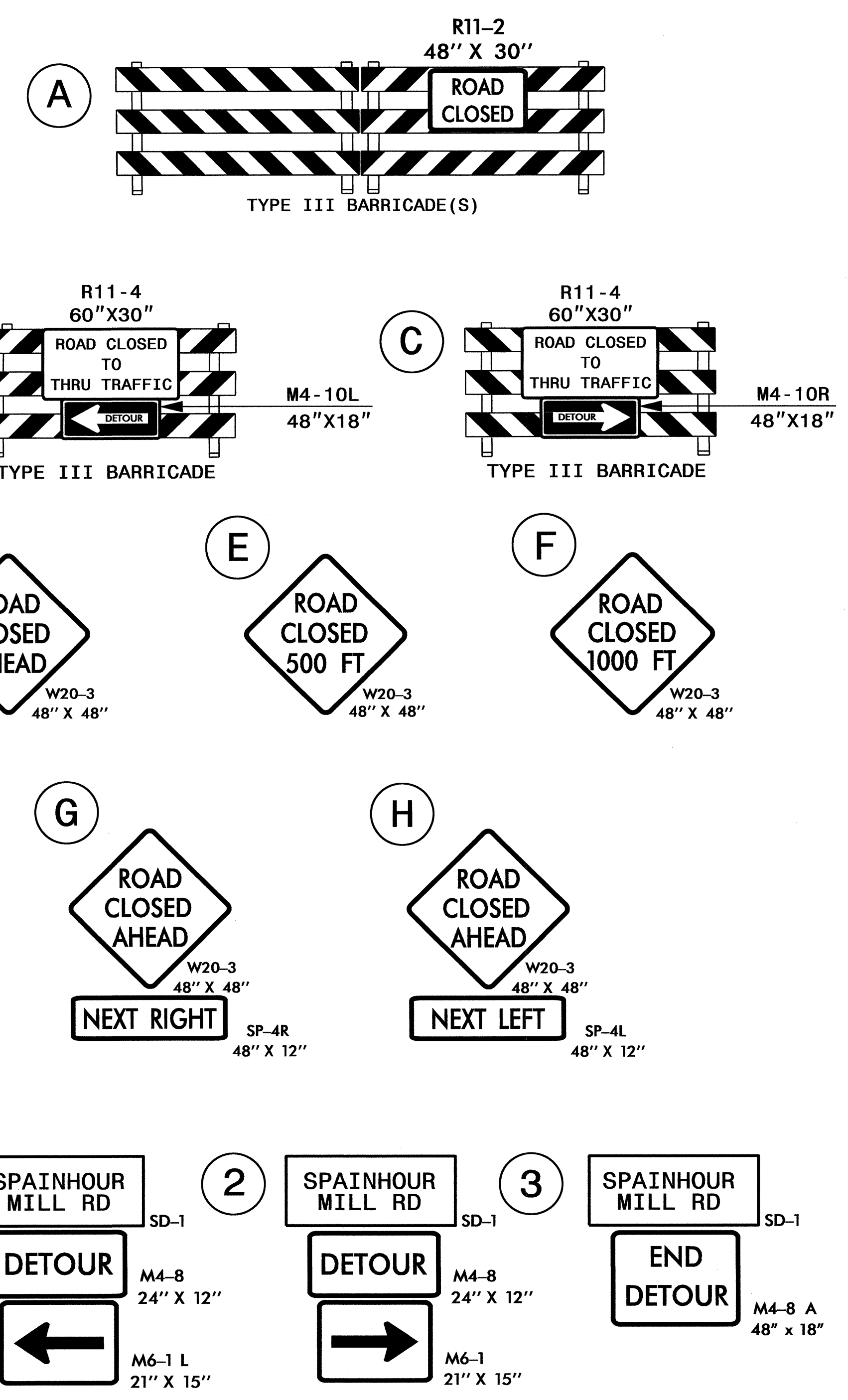
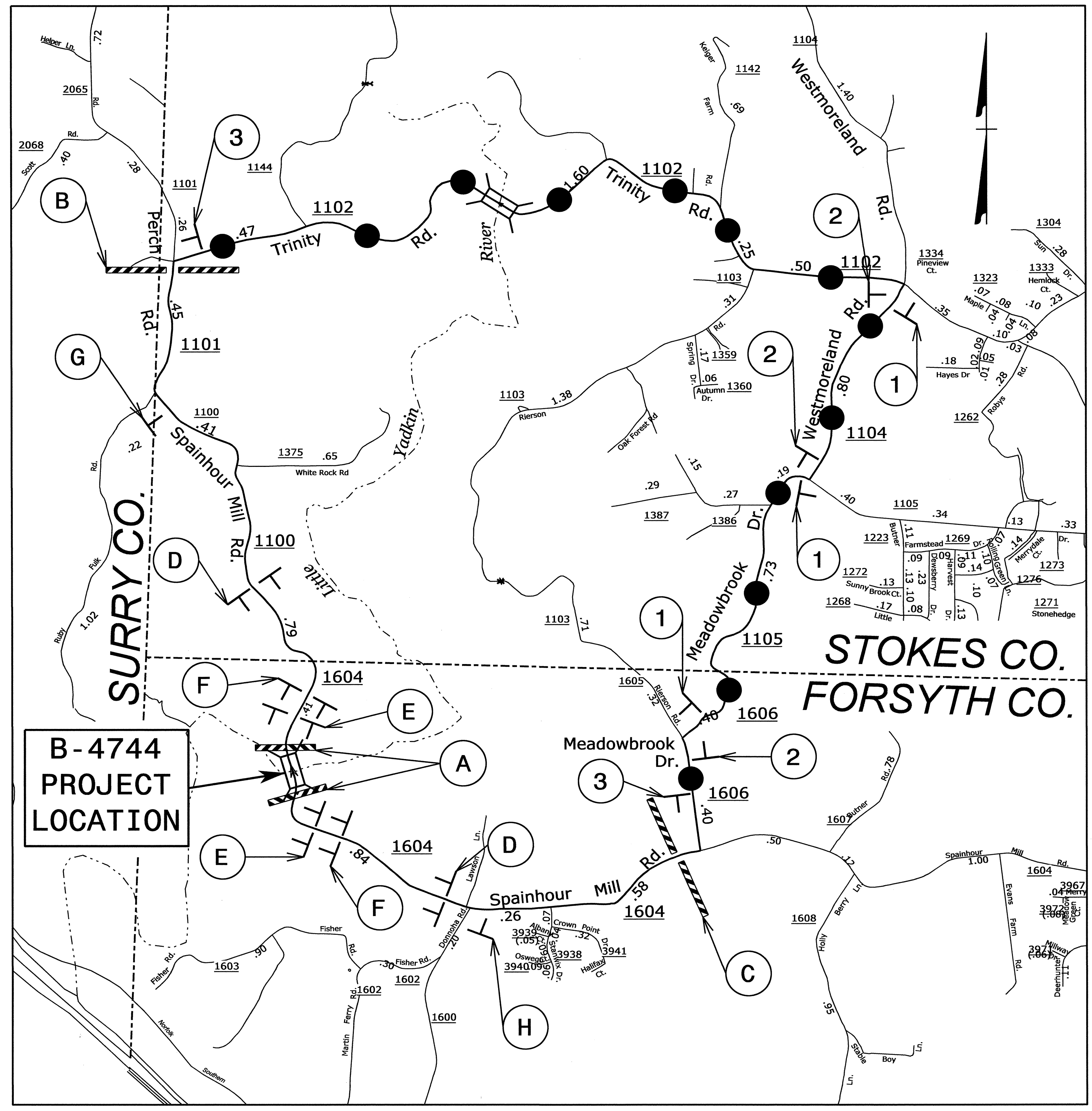

NOTES:  
 1. SEE SHEET SD-1 FOR SPECIAL SIGN DESIGN.  
 2. ALL DETOUR SIGN LOCATIONS ARE APPROXIMATE.

APPROVED: <i>Am Johnson</i> DATE: 11/1/2012			<p><b>SPAINHOUR MILL RD. ROAD CLOSURE AND DETOUR SIGNING</b></p>
---	--	--	--

C:\NOV-2012-1145  
 C:\NOV-2012-1145\01\PROJ\Traffic\TrafficControl\TCP\B-4744-TC-TMP-5.dgn  
 sbjennings AT TCE65818



# FORSYTH COUNTY

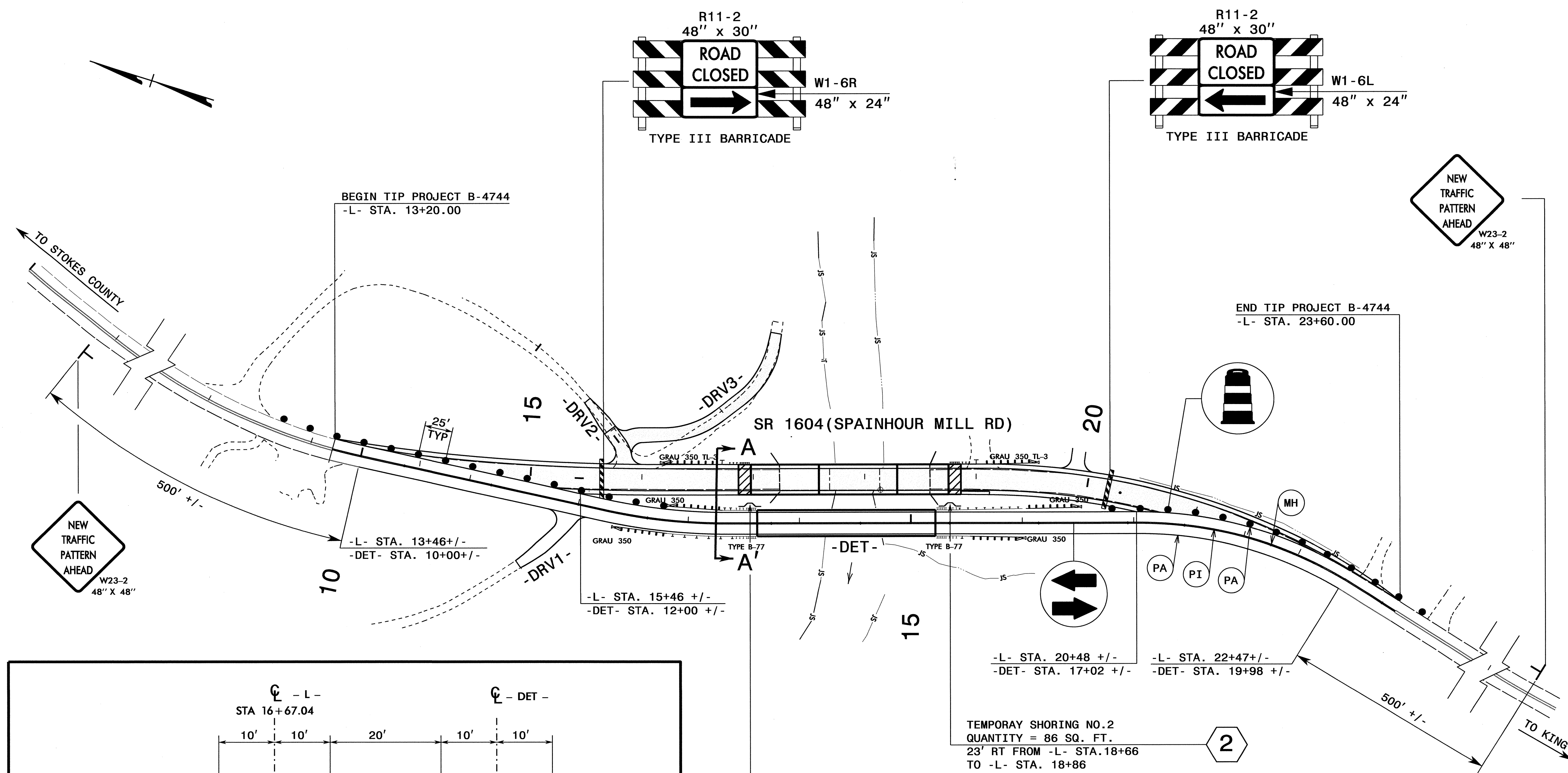

APPROVED: *ben schubert* DATE: 11/1/2012

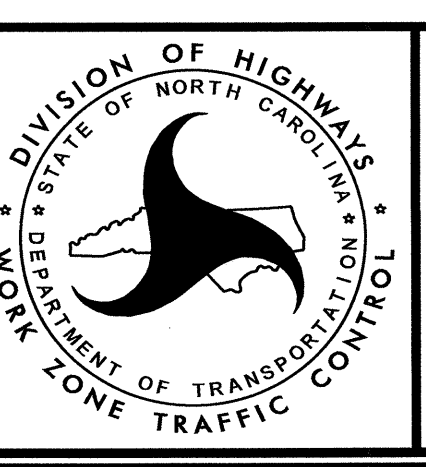

**TEMPORARY  
TRAFFIC CONTROL  
PHASE II DETAIL**

01-NOV-2012 11:45  
 \\D01\p55r00\proj\TipProjects-B\B4744\TrafficControl\TCP\B-4744-TC-TMP-6.dgn  
 sbjennings AT 12:26:38

# FORSYTH COUNTY

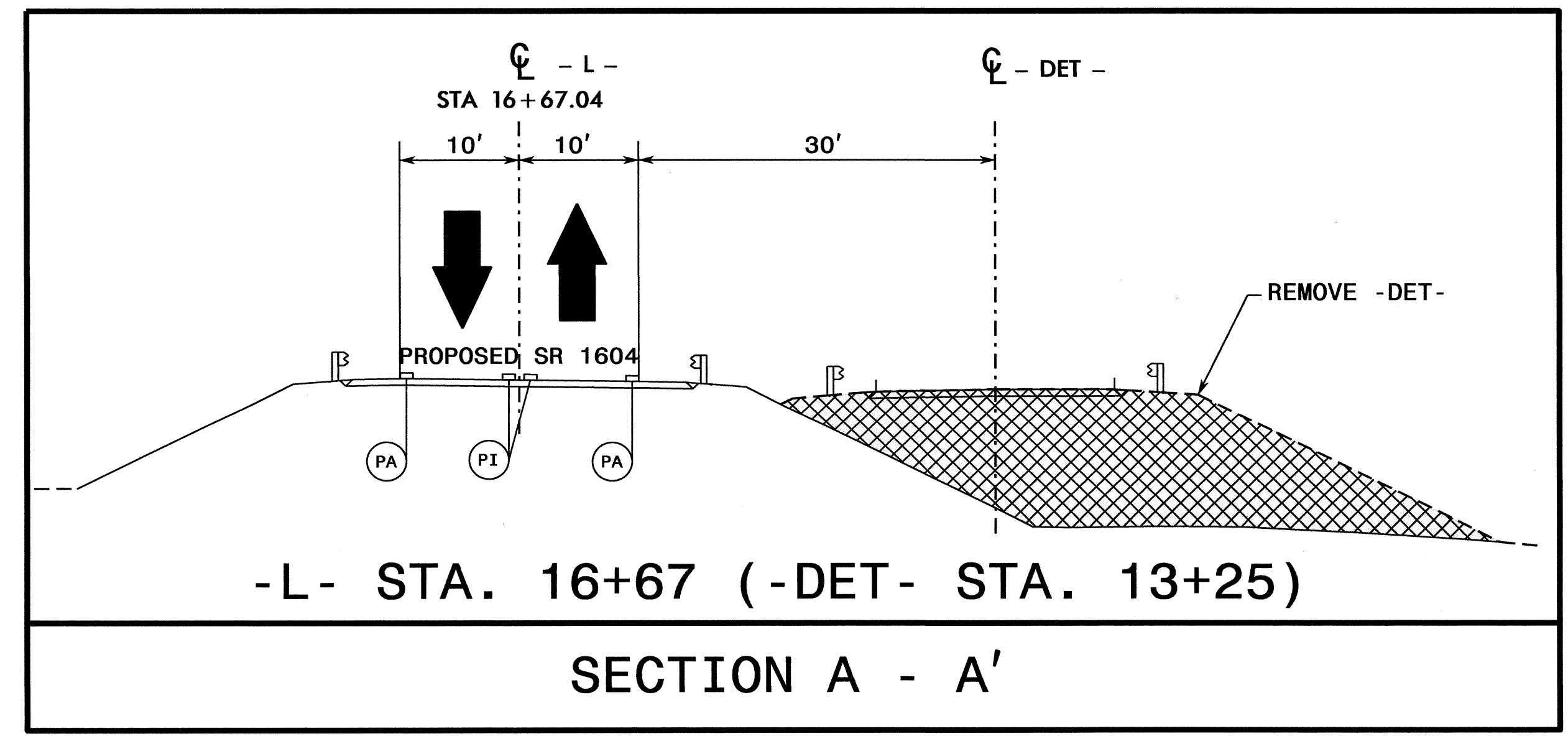
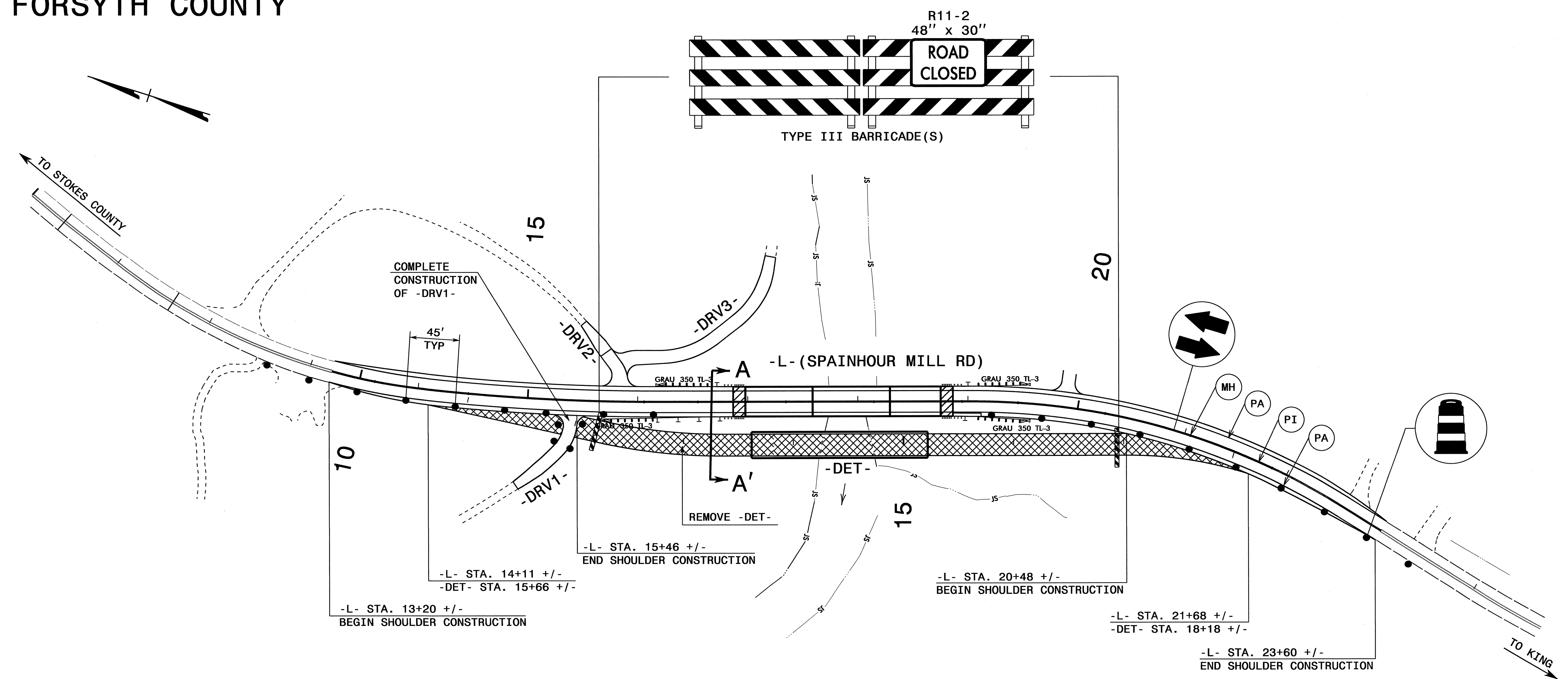

APPROVED: *Ben Schumaker* DATE: 11/1/2012



**TEMPORARY TRAFFIC CONTROL PHASE III DETAIL**

01-NOV-2012 11:45  
 \DOT\DRS800\01\PROJ\TIPProjects\B\4744\TrafficControl\TCP\B-4744-TC-TMP-7.dgn  
 sbjennings AT 122838