

STATE OF NORTH CAROLINA
DIVISION OF HIGHWAYS

TRANSPORTATION MANAGEMENT PLAN

WILKES COUNTY

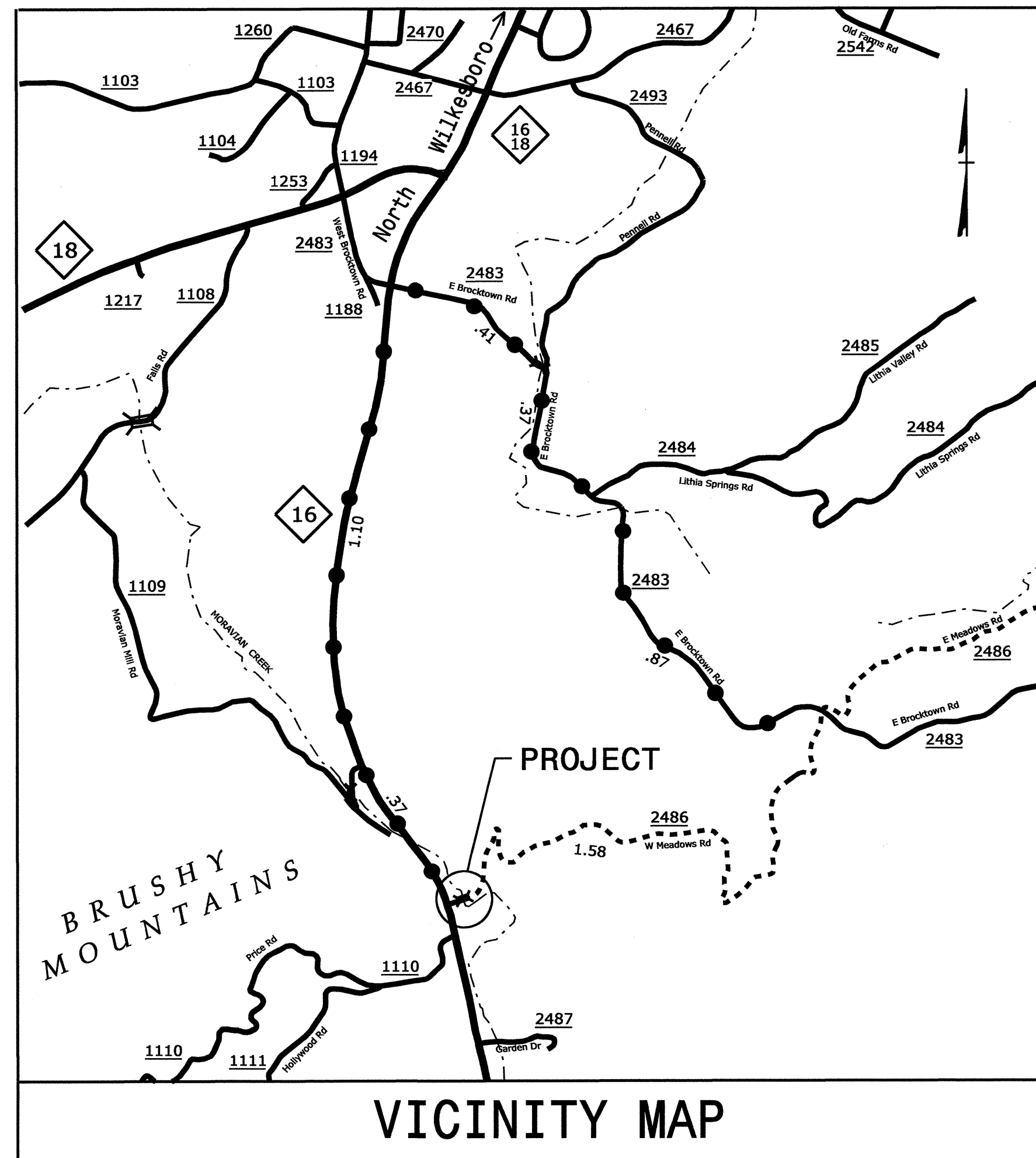

VICINITY MAP

SHEET NO.	TITLE
TMP-1	TITLE SHEET, AND INDEX OF SHEETS
TMP-1A	LIST OF APPLICABLE ROADWAY STANDARD DRAWINGS & LEGEND
TMP-1B	TRANSPORTATION OPERATIONS PLAN AND PROJECT NOTES
TMP-2	SPECIAL SIGN DETAIL
TMP-3	PHASING AND PLAN DETAILS
TMP-4	OFF-SITE DETOUR PLAN

SHEET NO.
TMP-1

B-4847

TIP PROJECT:

I7-JUL-2012 07:31 \\dot\dfs\00\Proj\TIP\Projects-B\4847\TrafficControl\TCP\B-4847_T_C_TCP_idgn Kbrodwell AT E244739

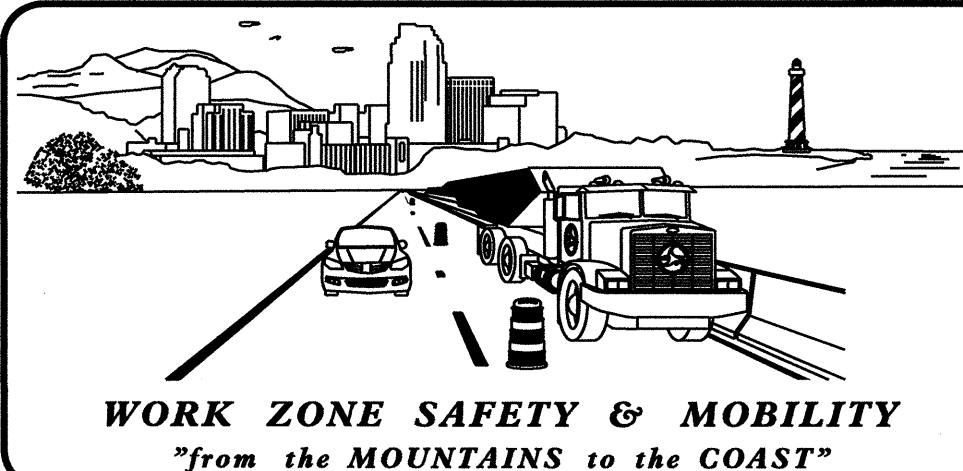

N.C.D.O.T. WORK ZONE TRAFFIC CONTROL
1561 MAIL SERVICE CENTER (MSC) RALEIGH, NC 27699-1561
750 N. GREENFIELD PARKWAY, GARNER, NC 27529 (DELIVERY)
PHONE: (919) 713-2800 FAX: (919) 771-2745

J. S. BOURNE, P.E. STATE TRAFFIC MANAGEMENT ENGINEER
G. L. GETTIER, P.E. TRAFFIC CONTROL PROJECT ENGINEER
J. W. GILSTRAP TRAFFIC CONTROL PROJECT DESIGN ENGINEER
KEN BROADWELL TRAFFIC CONTROL DESIGN ENGINEER

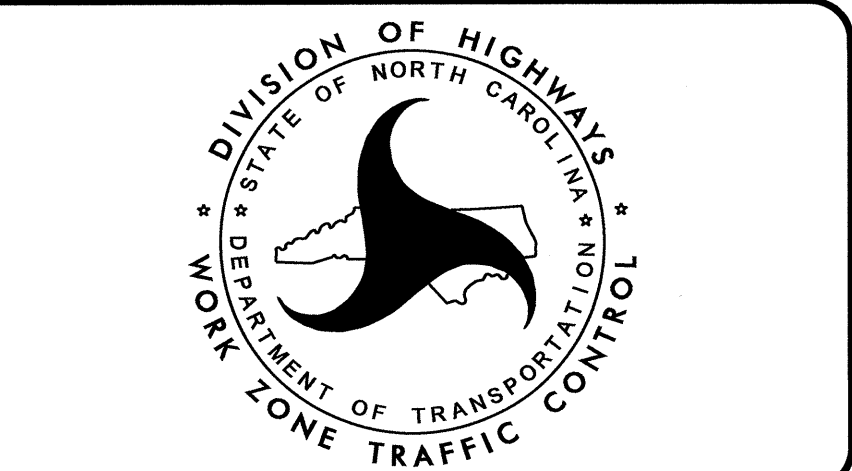

APPROVED: _____
DATE: _____

SEAL

ROADWAY STANDARD DRAWINGS

THE FOLLOWING ROADWAY STANDARDS AS SHOWN IN "ROADWAY STANDARD DRAWINGS" - PROJECT SERVICES UNIT - N.C. DEPARTMENT OF TRANSPORTATION - RALEIGH, N.C., DATED JANUARY 2012 ARE APPLICABLE TO THIS PROJECT AND BY REFERENCE HEREBY ARE CONSIDERED A PART OF THESE PLANS:



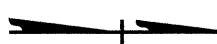

<u>STD. NO.</u>	<u>TITLE</u>
1101.03	TEMPORARY ROAD CLOSURES
1101.05	WORK ZONE VEHICLE ACCESSES
1101.11	TRAFFIC CONTROL DESIGN TABLES
1110.01	STATIONARY WORK ZONE SIGNS
1130.01	DRUMS
1145.01	BARRICADES - TYPE III

LEGEND

GENERAL

-  DIRECTION OF TRAFFIC FLOW
-  NORTH ARROW

TRAFFIC CONTROL DEVICES

-  BARRICADE (TYPE III)
-  CONE
-  DRUM  SKINNY DRUM



TEMPORARY SIGNING

-  STATIONARY SIGN

TEMPORARY PAVEMENT MARKING

N/A

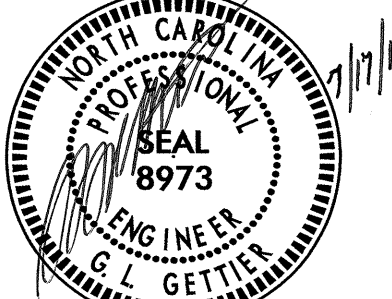
17-JUL-2012 07:32 \\dot\dfsroot\Proj\IP\Projects-B\B4847\TrafficControl\TCP\B-4847_TC_TCP.i.dgn kbroodwell AT TE244739

APPROVED: _____ DATE: _____ 		ROADWAY STANDARD DRAWINGS & LEGEND
--	---	---

TRANSPORTATION OPERATIONS

CONSTRUCTION

REMOVE AND REPLACE EXISTING STRUCTURE AND APPROACHES ALONG THE EXISTING ROADWAY ALIGNMENT AS SHOWN IN THE CONSTRUCTION PLANS.

TMP DESIGN PARAMETERS

TRAFFIC WILL BE DETOURED OFFSITE DURING THE CONSTRUCTION PERIOD.

THE OFFSITE DETOUR WILL INCLUDE NC 16 AND SR 2483. (SEE SHEET TMP-4).

TRAFFIC WILL NEED TO BE MAINTAINED TO THE EXISTING DRIVEWAYS LOCATED WITHIN THE PROJECT LIMITS. (SEE SHEET TMP-3).

GENERAL NOTES

CHANGES MAY BE REQUIRED WHEN PHYSICAL DIMENSIONS IN THE DETAIL DRAWINGS, STANDARD DETAILS AND ROADWAY DETAILS ARE NOT ATTAINABLE TO MEET FIELD CONDITIONS, OR RESULT IN DUPLICATE, OR UNDESIRED OVERLAPPING OF DEVICES. MODIFICATION MAY INCLUDE: MOVING, SUPPLEMENTING, COVERING, OF REMOVAL OF DEVICES, AS DIRECTED BY THE ENGINEER.

THE FOLLOWING GENERAL NOTES APPLY AT ALL TIMES FOR THE DURATION OF THE CONSTRUCTION PROJECT EXCEPT WHEN OTHERWISE NOTED IN THE PLAN OR AS DIRECTED BY THE ENGINEER.

PAVEMENT EDGE DROP OFF REQUIREMENTS

- A) BACKFILL AT A 6:1 SLOPE UP TO THE EDGE AND ELEVATION OF EXISTING PAVEMENT IN AREAS ADJACENT TO AN OPENED TRAVEL LANE THAT HAS A DROP-OFF AS FOLLOWS:

BACKFILL DROP-OFFS THAT EXCEED 2 INCHES ON ROADWAYS WITH POSTED SPEED LIMITS OF 45 MPH OR GREATER.

BACKFILL DROP-OFFS THAT EXCEED 3 INCHES ON ROADWAYS WITH POSTED SPEED LIMITS LESS THAN 45 MPH.

BACKFILL WITH SUITABLE COMPACTED MATERIAL, AS APPROVED BY THE ENGINEER, AT NO EXPENSE TO THE DEPARTMENT

TRAFFIC PATTERN ALTERATIONS

- B) NOTIFY THE ENGINEER A MINIMUM OF THIRTY (30) CALENDAR DAYS PRIOR TO ANY TRAFFIC PATTERN ALTERATION.

SIGNING

- C) PROVIDE SIGNING AND DEVICES REQUIRED TO CLOSE THE ROAD ACCORDING TO THE ROADWAY STANDARD DRAWINGS AND TRAFFIC CONTROL PLANS.

PROVIDE SIGNING REQUIRED FOR THE OFF-SITE DETOUR ROUTE AS SHOWN IN THE TRAFFIC CONTROL PLANS.

- D) COVER OR REMOVE ALL SIGNS AND DEVICES REQUIRED TO CLOSE THE ROAD WHEN ROAD CLOSURE IS NOT IN OPERATION.

COVER OR REMOVE ALL SIGNS REQUIRED FOR THE OFF-SITE DETOUR WHEN THE DETOUR IS NOT IN OPERATION.

- E) ENSURE ALL NECESSARY SIGNING IS IN PLACE PRIOR TO ALTERING ANY TRAFFIC PATTERN.

TRAFFIC CONTROL DEVICES

- F) PLACE TYPE III BARRICADES WITH "ROAD CLOSED" SIGN R-11-2 ATTACHED OF SUFFICIENT LENGTH TO CLOSE ENTIRE ROADWAY.

I:\7-JUL-2012 07:33
K:\dot\GIS\DOT\TIP\Projects\B\B4847\TrafficControl\TCP\B-4847-TC-TCP-1.dgn
K:\dot\GIS\DOT\TIP\Projects\B\B4847\TrafficControl\TCP\B-4847-TC-TCP-1.dgn

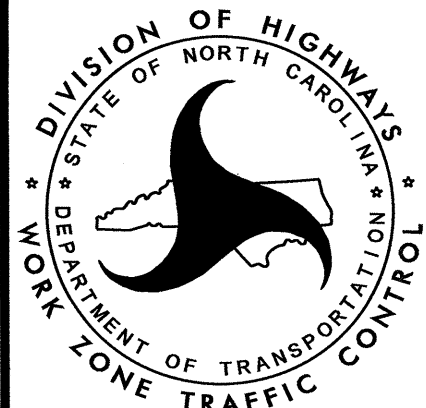
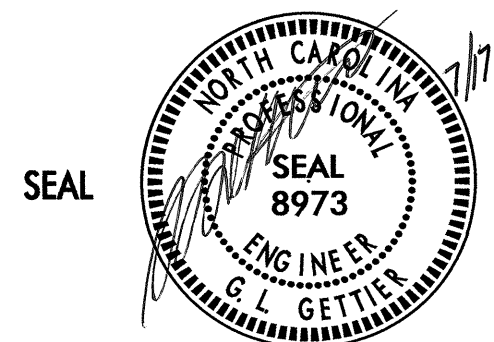
APPROVED: _____ DATE: _____		TRANSPORTATION OPERATIONS & PROJECT NOTES
		

PHASING

- STEP 1: - INSTALL OFF-SITE DETOUR ROUTE SIGN ASSEMBLIES FOR THE CLOSING OF SR 2486 (WEST MEADOWS RD., -L-). SEE SHEETS TMP-2 AND TMP-4.
- USING ROADWAY STANDARD DRAWING NO. 1101.03, SHEETS 1 & 2 OF 9 AND SHEETS TMP-3 AND TMP-4 CLOSE SR 2486 (WEST MEADOWS RD., -L-) TO THRU TRAFFIC.
- STEP 2: - REMOVE THE EXISTING STRUCTURE AND CONSTRUCT THE PROPOSED STRUCTURE AND ROADWAY UP TO AND INCLUDING THE FINAL LAYER OF SURFACE COURSE AND PLACE FINAL PAVEMENT MARKINGS ON SR 2486 (WEST MEADOWS RD., -L-). SEE CONSTRUCTION PLANS AND FINAL PAVEMENT MARKING PLANS.
- STEP 3: - REMOVE ALL TRAFFIC CONTROL DEVICES, SIGNING AND DETOUR ROUTE SIGNING.
- OPEN TO FINAL TRAFFIC PATTERN.

NOTES:
1. TYPE III BARRICADE LOCATIONS ARE APPROXIMATE. FIELD ADJUST AS REQUIRED.

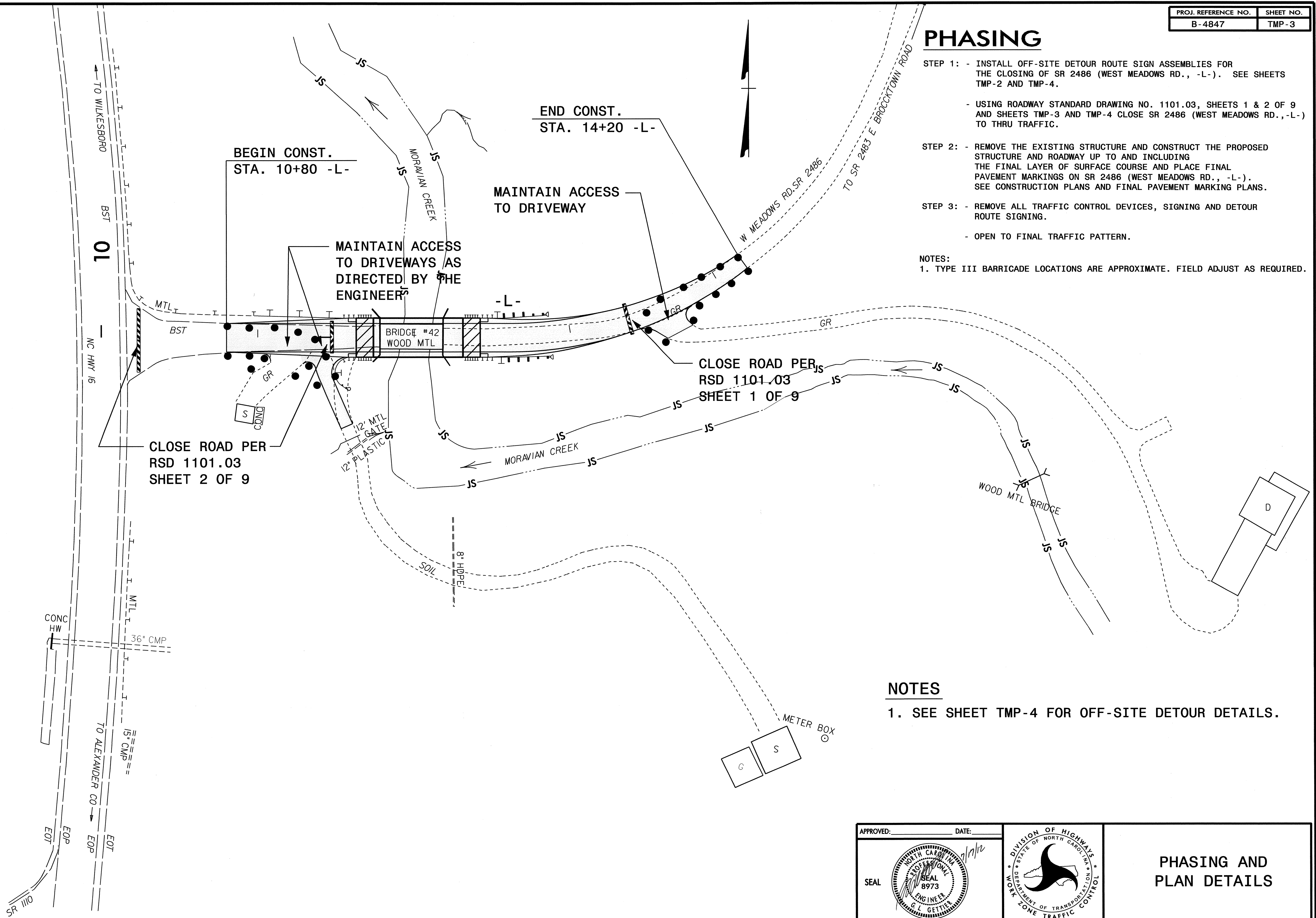

NOTES

1. SEE SHEET TMP-4 FOR OFF-SITE DETOUR DETAILS.

I:\7-JUL-2012 07:30
 \dot\gfrs\09\1\TIP\Projects-B\B4847\TrafficControl\TCP\B-4847-TC-TCP-1.dgn
 kbr\ocdwell AT 12244739

APPROVED: _____ DATE: _____

SEAL

PHASING AND PLAN DETAILS

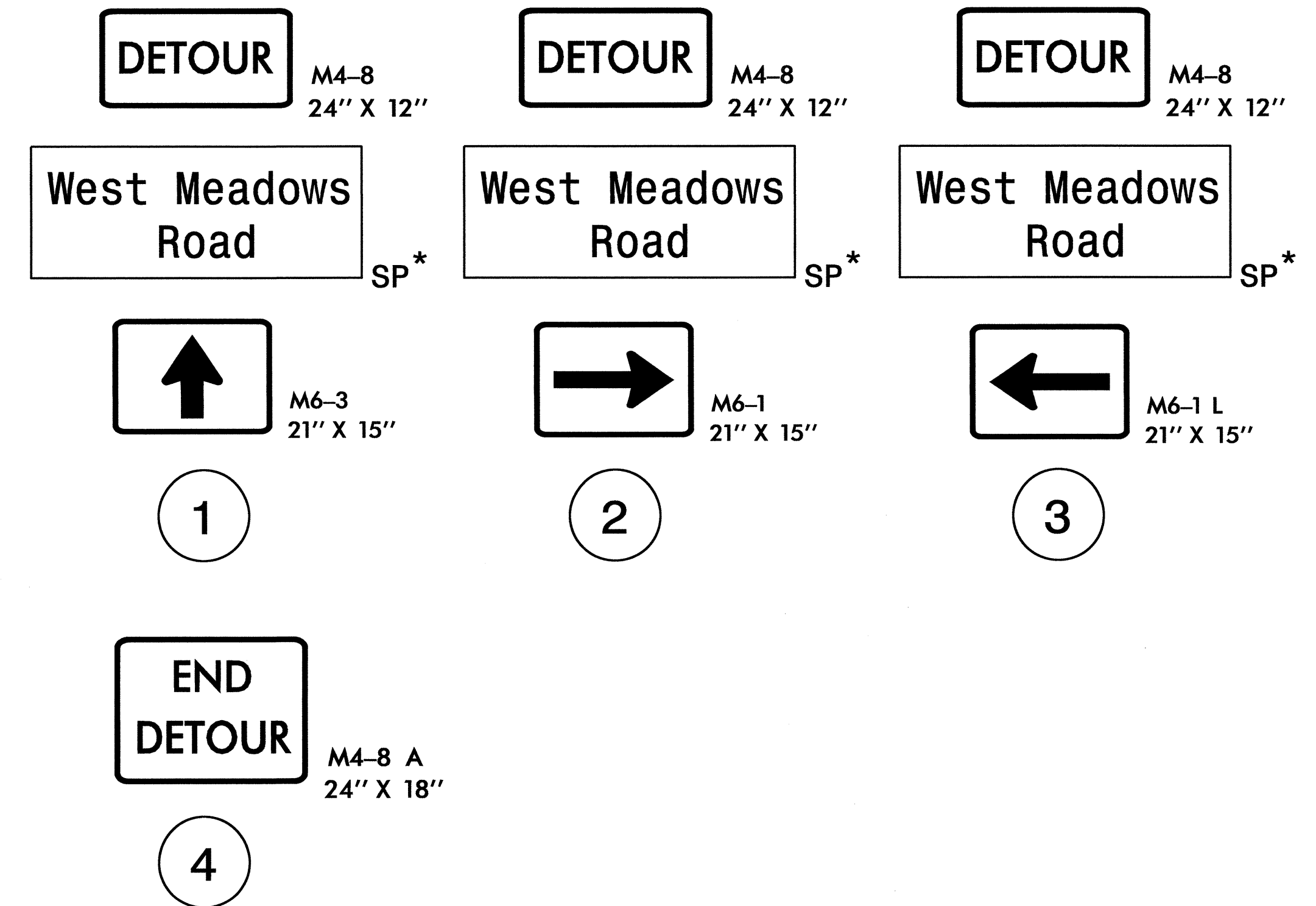
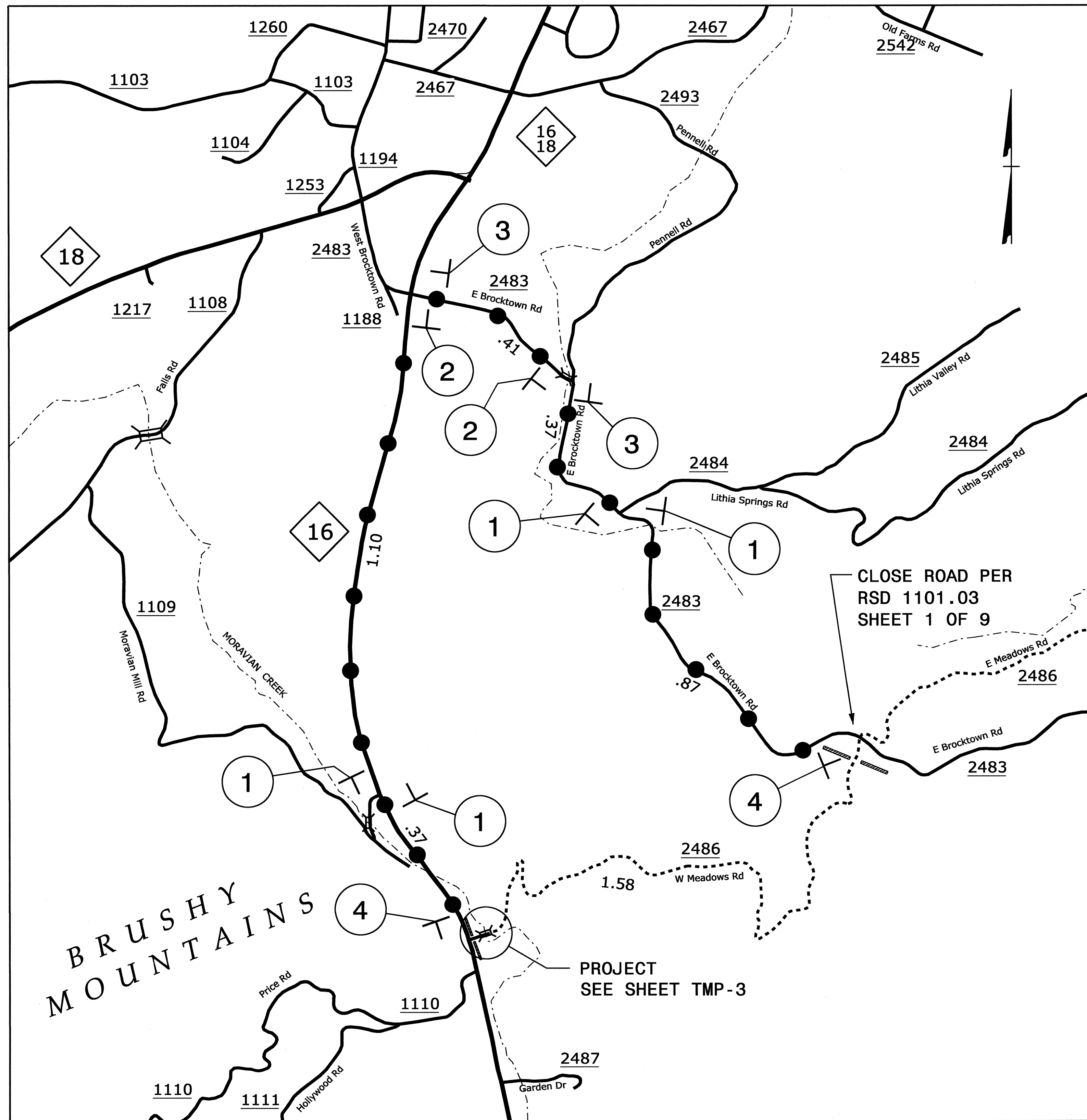

* — SEE SHEET TMP-2 FOR SPECIAL SIGN DESIGN.

17-JUL-2012 07:30
 X:\dot\ofis-00\1211\TIPProjects-B\B4847\Traffic\TrafficControl\TCP\WILKES_MS_ENG.dgn
 K:\odswell\AT\12244739

APPROVED: _____ DATE: _____		OFF-SITE DETOUR PLAN