

STATE OF NORTH CAROLINA
DIVISION OF HIGHWAYS

TRANSPORTATION MANAGEMENT PLAN

GRAHAM COUNTY

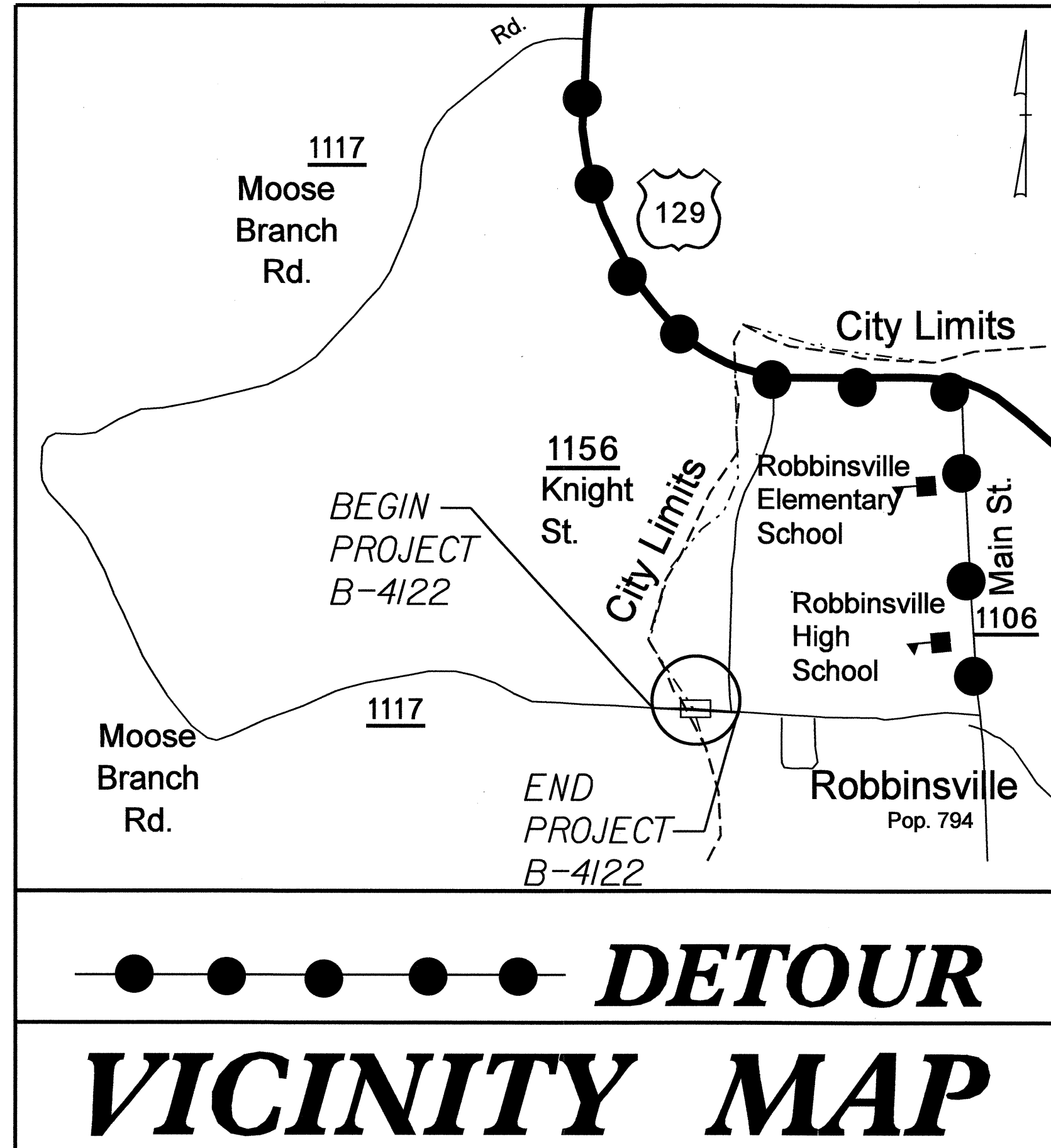
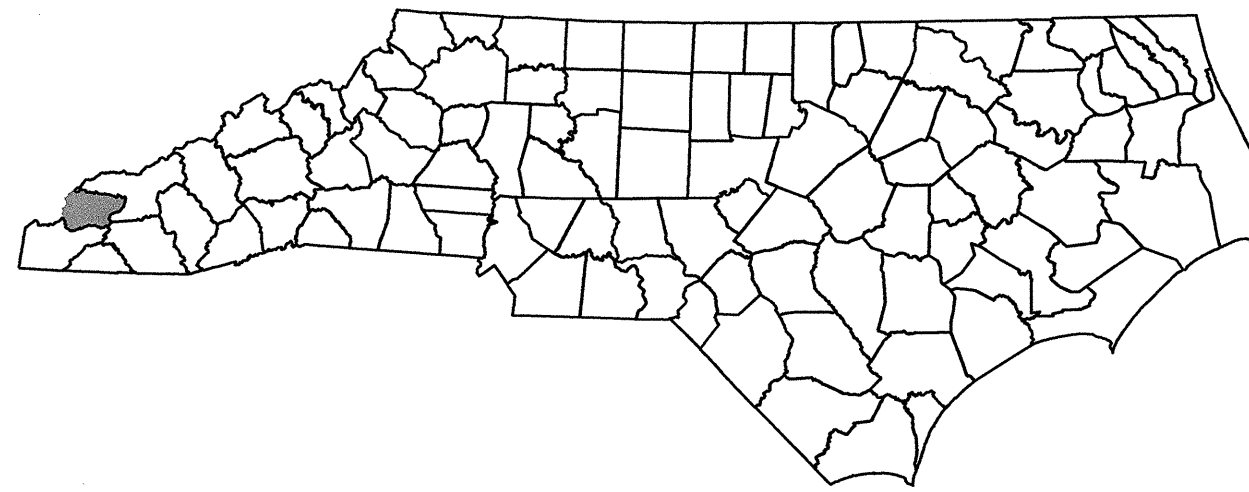

INDEX OF SHEETS

SHEET NO.	TITLE
TMP-1	TITLE SHEET AND INDEX OF SHEETS
TMP-2	ROADWAY STANDARD DRAWINGS & LEGEND
TMP-3	GENERAL NOTES, LOCAL NOTES AND PHASING
TMP-4	MOOSE BRANCH RD. ROAD CLOSURE AND DETOUR SIGNING
TMP-5	TEMPORARY TRAFFIC CONTROL DETAIL
SD-1	SPECIAL SIGN DESIGN

SHEET NO.
TMP-1

B-4122

TIP PROJECT:

24-JAN-2012 07:45
\\DOT\DRSROOT\PROJ\TIP\Projects-B\B4122\TrafficControl\Top\B-4122_TC_TMP.dgn
sblennings AT 1E244731

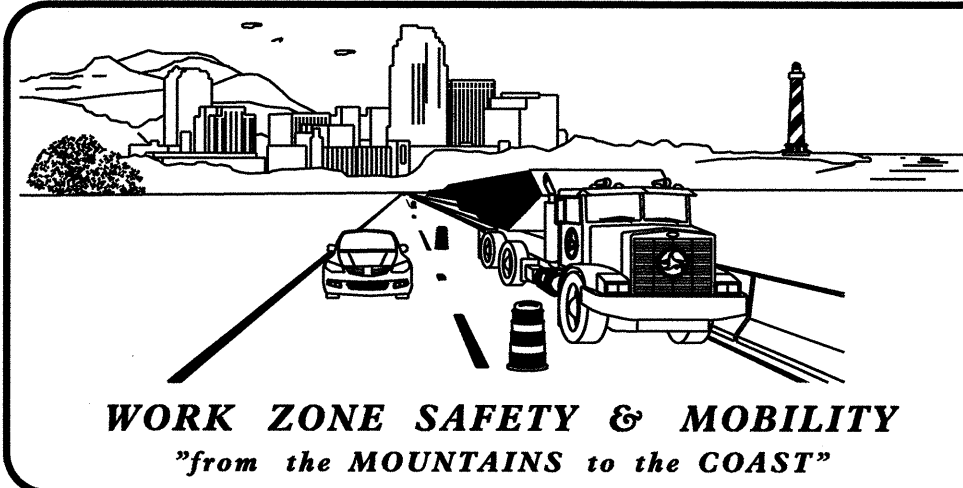

N.C.D.O.T. WORK ZONE TRAFFIC CONTROL
1580 MAIL SERVICE CENTER (MSC) RALEIGH, NC 27699-1580
1020 BIRCH RIDGE DRIVE, RALEIGH, NC 27610 (DELIVERY)
PHONE: (919) 250-4094 FAX: (919) 250-4098

J. S. BOURNE, P.E. STATE TRAFFIC MANAGEMENT ENGINEER
J. ISHAK, P.E. TRAFFIC CONTROL PROJECT ENGINEER
TRAFFIC CONTROL PROJECT DESIGN ENGINEER
S. B. JENNINGS TRAFFIC CONTROL DESIGN ENGINEER

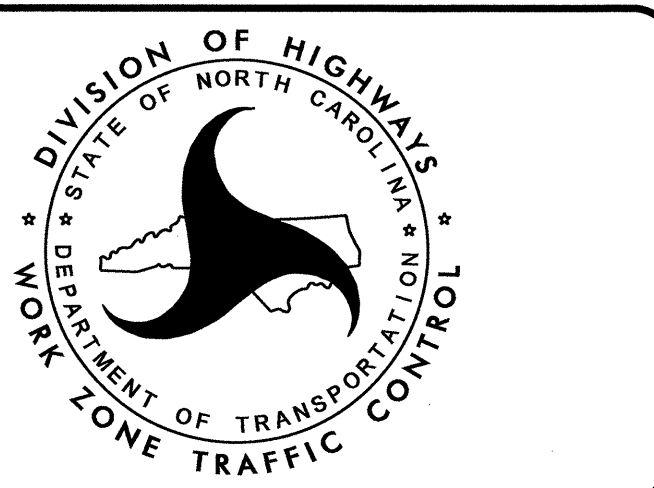

APPROVED:
DATE: *January 24, 2012*

ROADWAY STANDARD DRAWINGS

THE FOLLOWING ROADWAY STANDARDS AS SHOWN IN "ROADWAY STANDARD DRAWINGS" - PROJECT SERVICES UNIT - N.C. DEPARTMENT OF TRANSPORTATION - RALEIGH, N.C., DATED JANUARY 2012 ARE APPLICABLE TO THIS PROJECT AND BY REFERENCE HEREBY ARE CONSIDERED A PART OF THESE PLANS:

<u>STD. NO.</u>	<u>TITLE</u>
1101.01	WORK ZONE WARNING SIGNS
1101.03	TEMPORARY ROAD CLOSURES
1101.11	TRAFFIC CONTROL DESIGN TABLES
1110.01	STATIONARY WORK ZONE SIGNS
1130.01	DRUMS
1135.01	CONES
1145.01	BARRICADES
1150.01	FLAGGING DEVICES

LEGEND

GENERAL

- DIRECTION OF TRAFFIC FLOW
- DIRECTION OF PEDESTRIAN TRAFFIC FLOW
- EXIST. PVMT.
- NORTH ARROW
- PROPOSED PVMT.

WORK AREA

REMOVAL

USER DEFINED (IF NEEDED)

USER DEFINED (IF NEEDED)

TRAFFIC CONTROL DEVICES

- BARRICADE (TYPE III)
- CONE
- DRUM SKINNY DRUM TUBULAR MARKER
- TEMPORARY CRASH CUSHION
- FLASHING ARROW PANEL (TYPE C)
- FLAGGER
- LAW ENFORCEMENT
- TRUCK MOUNTED IMPACT ATTENUATOR (TMIA)
- CHANGEABLE MESSAGE SIGN

TEMPORARY SIGNING

- PORTABLE SIGN
- STATIONARY SIGN
- STATIONARY OR PORTABLE SIGN

SIGNALS

- EXISTING
- PROPOSED
- TEMPORARY

PAVEMENT MARKINGS

- EXISTING LINES
- TEMPORARY LINES

PAVEMENT MARKERS

- CRYSTAL/CRYSTAL
- CRYSTAL/RED
- YELLOW/YELLOW

PAVEMENT MARKING SYMBOLS

- PAVEMENT MARKING SYMBOLS

TEMPORARY PAVEMENT MARKING

- PA WHITE EDGELINE (4")
- PI DOUBLE YELLOW CENTERLINE (4")

24-JAN-2012 07:46 \\DOT\DFSROOT\PROJ\TIP\Projects-B\B4122\TrafficControl\top\B-4122-TC-TMP-2.dgn sblennings AT 1E244731

APPROVED:	DATE: <i>January 24, 2012</i>		ROADWAY STANDARD DRAWINGS & LEGEND
-----------	-------------------------------	--	---

GENERAL NOTES / LOCAL NOTES

PHASING

CHANGES MAY BE REQUIRED WHEN PHYSICAL DIMENSIONS IN THE DETAIL DRAWINGS, STANDARD DETAILS, AND ROADWAY DETAILS ARE NOT ATTAINABLE TO MEET FIELD CONDITIONS OR RESULT IN DUPLICATE OR UNDESIRED OVERLAPPING OF DEVICES. MODIFICATION MAY INCLUDE: MOVING, SUPPLEMENTING, COVERING, OR REMOVAL OF DEVICES AS DIRECTED BY THE ENGINEER.

THE FOLLOWING GENERAL NOTES APPLY AT ALL TIMES FOR THE DURATION OF THE CONSTRUCTION PROJECT EXCEPT WHEN OTHERWISE NOTED IN THE PLAN OR DIRECTED BY THE ENGINEER.

LANE AND SHOULDER CLOSURE REQUIREMENTS

- A) REMOVE LANE CLOSURE DEVICES FROM THE LANE WHEN WORK IS NOT BEING PERFORMED BEHIND THE LANE CLOSURE OR WHEN A LANE CLOSURE IS NO LONGER NEEDED OR AS DIRECTED BY THE ENGINEER.
- B) WHEN PERSONNEL AND/OR EQUIPMENT ARE WORKING ON THE SHOULDER ADJACENT TO AN UNDIVIDED FACILITY AND WITHIN 5 FT OF AN OPEN TRAVEL LANE, CLOSE THE NEAREST OPEN TRAVEL LANE USING ROADWAY STANDARD DRAWING NO. 1101.02 UNLESS THE WORK AREA IS PROTECTED BY BARRIER OR GUARDRAIL.

WHEN PERSONNEL AND/OR EQUIPMENT ARE WORKING ON THE SHOULDER ADJACENT TO A DIVIDED FACILITY AND WITHIN 10 FT OF AN OPEN TRAVEL LANE, CLOSE THE NEAREST OPEN TRAVEL LANE USING ROADWAY STANDARD DRAWING NO. 1101.02 UNLESS THE WORK AREA IS PROTECTED BY BARRIER OR GUARDRAIL.

- C) WHEN PERSONNEL AND/OR EQUIPMENT ARE WORKING WITHIN A LANE OF TRAVEL OF AN UNDIVIDED OR DIVIDED FACILITY, CLOSE THE LANE ACCORDING TO THE TRAFFIC CONTROL PLANS, ROADWAY STANDARD DRAWINGS, OR AS DIRECTED BY THE ENGINEER. CONDUCT THE WORK SO THAT ALL PERSONNEL AND/OR EQUIPMENT REMAIN WITHIN THE CLOSED TRAVEL LANE.

PAVEMENT EDGE DROP OFF REQUIREMENTS

- D) BACKFILL AT A 6:1 SLOPE UP TO THE EDGE AND ELEVATION OF EXISTING PAVEMENT IN AREAS ADJACENT TO AN OPENED TRAVEL LANE THAT HAS AN EDGE OF PAVEMENT DROP-OFF AS FOLLOWS:

BACKFILL DROP-OFFS THAT EXCEED 2 INCHES ON ROADWAYS WITH POSTED SPEED LIMITS OF 45 MPH OR GREATER.

BACKFILL DROP-OFFS THAT EXCEED 3 INCHES ON ROADWAYS WITH POSTED SPEED LIMITS LESS THAN 45 MPH.

BACKFILL WITH SUITABLE COMPACTED MATERIAL, AS APPROVED BY THE ENGINEER, AT NO EXPENSE TO THE DEPARTMENT.

TRAFFIC PATTERN ALTERATIONS

- E) NOTIFY THE ENGINEER THIRTY (30) CALENDAR DAYS PRIOR TO ANY TRAFFIC PATTERN ALTERATION.

SIGNING

- F) INSTALL ADVANCE WORK ZONE WARNING SIGNS WHEN WORK IS WITHIN 40 FT FROM THE EDGE OF TRAVEL LANE AND NO MORE THAN THREE (3) DAYS PRIOR TO THE BEGINNING OF CONSTRUCTION.
- G) PROVIDE SIGNING AND DEVICES REQUIRED TO CLOSE THE ROAD ACCORDING TO THE ROADWAY STANDARD DRAWINGS AND TRAFFIC CONTROL PLANS.

PROVIDE SIGNING REQUIRED FOR THE OFF-SITE DETOUR ROUTE AS SHOWN IN THE TRAFFIC CONTROL PLANS.

- H) COVER OR REMOVE ALL SIGNS AND DEVICES REQUIRED TO CLOSE THE ROAD WHEN ROAD CLOSURE IS NOT IN OPERATION.

COVER OR REMOVE ALL SIGNS REQUIRED FOR THE OFF-SITE DETOUR WHEN THE DETOUR IS NOT IN OPERATION.

- I) ENSURE ALL NECESSARY SIGNING IS IN PLACE PRIOR TO ALTERING ANY TRAFFIC PATTERN.

TRAFFIC CONTROL DEVICES

- J) WHEN LANE CLOSURES ARE NOT IN EFFECT SPACE CHANNELIZING DEVICES IN WORK AREAS NO GREATER IN FEET THAN TWICE THE POSTED SPEED LIMIT (MPH) EXCEPT, 10 FT ON-CENTER IN RADII, AND 3 FT OFF THE EDGE OF AN OPEN TRAVELWAY. REFER TO STANDARD SPECIFICATIONS FOR ROADS AND STRUCTURES SECTIONS 1130 (DRUMS), 1135 (CONES) AND 1180 (SKINNY DRUMS) FOR ADDITIONAL REQUIREMENTS.

- K) PLACE TYPE III BARRICADES, WITH "ROAD CLOSED" SIGN R11-2 ATTACHED, OF SUFFICIENT LENGTH TO CLOSE ENTIRE ROADWAY.

- L) INSTALL TEMPORARY PAVEMENT MARKINGS AND TEMPORARY PAVEMENT MARKERS ON INTERIM LAYERS OF PAVEMENT AS FOLLOWS:

ROAD NAME	MARKING	MARKER
SR 1117 (MOOSE BRANCH RD)	PAINT	N/A

- M) PLACE ONE APPLICATION OF PAINT FOR TEMPORARY TRAFFIC PATTERNS. PLACE A SECOND APPLICATION OF PAINT SIX (6) MONTHS AFTER THE INITIAL APPLICATION AND EVERY SIX MONTHS AS DIRECTED BY THE ENGINEER.

- N) TIE PROPOSED PAVEMENT MARKING LINES TO EXISTING PAVEMENT MARKING LINES.

- O) REMOVE/REPLACE ANY CONFLICTING/DAMAGED PAVEMENT MARKINGS AND MARKERS BY THE END OF EACH DAY'S OPERATION.

LOCAL NOTES

- A) NCDOT TO NOTIFY GRAHAM COUNTY EMERGENCY MANAGEMENT SERVICES (EMS) AT (828) 479-7971, THIRTY (30) DAYS PRIOR TO ROAD CLOSURE.
- B) NCDOT TO NOTIFY THE TRANSPORTATION DIRECTOR FOR GRAHAM COUNTY DIVISION OF SCHOOL TRANSPORTATION AT (828) 479-3339, THIRTY (30) DAYS PRIOR TO ROAD CLOSURE.

NOTE: MAINTAIN VEHICULAR ACCESS TO DRIVEWAYS AT ALL TIMES DURING CONSTRUCTION UNLESS OTHERWISE DIRECTED BY THE ENGINEER.

STEP 1: INSTALL ADVANCED WORK ZONE WARNING SIGNS ON -L- (SR-1117) EAST OF PROJECT AND -Y- (SR-1156) AS REQUIRED IN PROJECT NOTES.

STEP 2: USING RSD 1101.02, SHEET 1 OF 15, AS NEEDED, CONSTRUCT PROPOSED -DRIVE- AT -L- STA 11+65+/- AND DRIVEWAY ENTRANCE AT -Y1- STA 13+00+/- . (SEE TMP-5 AND ROADWAY PLANS)

STEP 3: USING RSD 1101.03, SHEET 2 OF 15, CLOSE SR-1117 (MOOSE BRANCH RD) TO THROUGH TRAFFIC AND DETOUR TRAFFIC ONTO PROPOSED DETOUR ROUTE. (SEE SHEETS TMP-4 AND SD-1)



STEP 4: AWAY FROM TRAFFIC AND USING RSD 1101.02 SHEET 1 OF 15, AS NEEDED, COMPLETE THE FOLLOWING: (SEE SHEET TMP-4 AND ROADWAY PLANS)

- 1) REMOVE EXISTING STRUCTURE NO. 81, AND CONSTRUCT PROPOSED STRUCTURE.
- 2) CONSTRUCT PROPOSED ROADWAY UP TO AND INCLUDING FINAL SURFACE COURSE LAYER FROM -L- STA 10+00 TO STA 15+45 AND -Y1- INTERSECTION.
- 3) PLACE FINAL PAVEMENT MARKINGS IN FINAL PATTERN AS SHOWN ON PAVEMENT MARKING PLANS.

NOTE: ALL STATIONS APPROXIMATE, VERIFY WITH ENGINEER.

STEP 5: REMOVE ALL WORK ZONE TRAFFIC CONTROL DEVICES AND ALL DETOUR SIGNING, AND OPEN SR-1117 (MOOSE BRANCH RD) TO 2-LANE, 2-WAY TRAFFIC.

24-JAN-2012 07:47
\\DOT\DFS\ROOT\PROJ\TIP\Projects-B\B4122\TrafficControl\Top\B-4122-TC-TMP-3.dgn
sblennings AT 12:24:73

APPROVED:	DATE:		<h2>GENERAL NOTES, LOCAL NOTES AND PHASING</h2>
 JOSEPH ISHAK ENGINEER 028380 PROFESSIONAL SEAL NORTH CAROLINA	January 24, 2012		

GRAHAM COUNTY

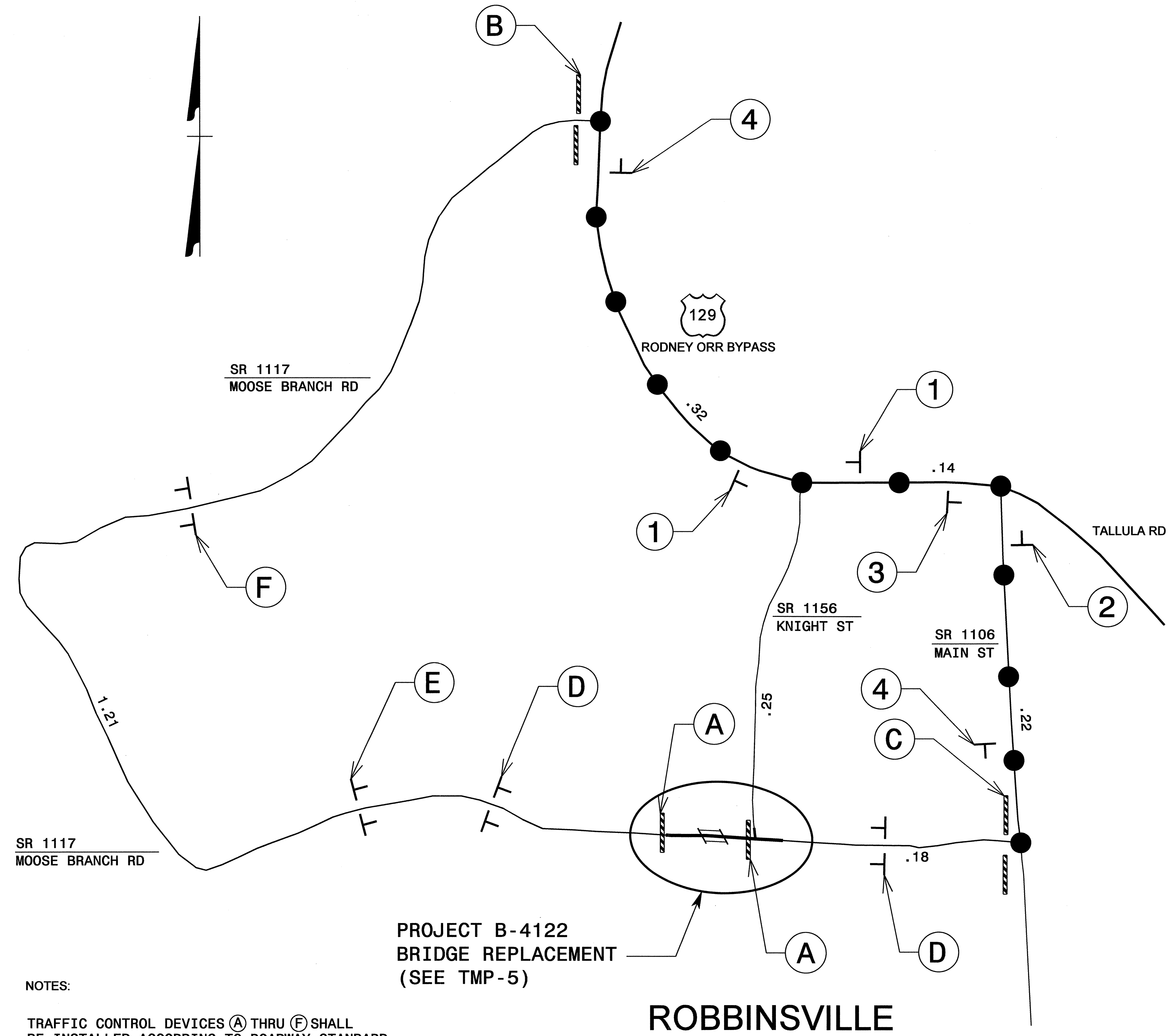

PROJECT B-4122
BRIDGE REPLACEMENT
(SEE TMP-5)

ROBBINSVILLE

NOTES:
TRAFFIC CONTROL DEVICES (A) THRU (F) SHALL BE INSTALLED ACCORDING TO ROADWAY STANDARD DRAWING NO. 1101.03, SHEET 1 OF 9
TRAFFIC CONTROL DEVICES (1) THRU (4) SHALL BE INSTALLED AS PER ENGINEER'S INSTRUCTION

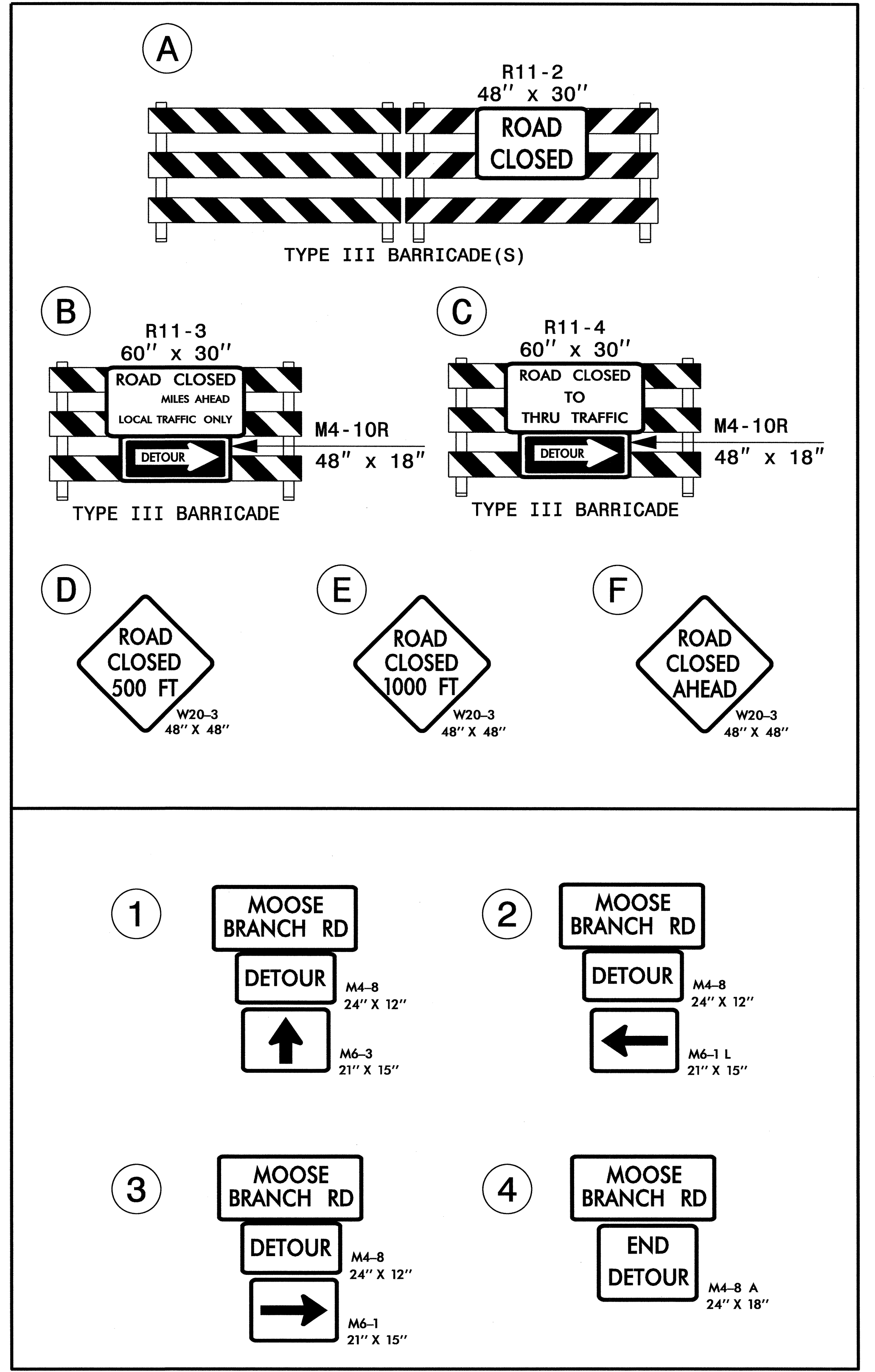

APPROVED: *Joseph Ishak* DATE: *January 24, 2012*

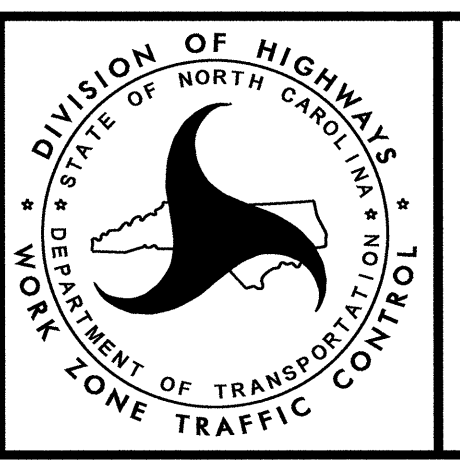

DIVISION OF HIGHWAYS
STATE OF NORTH CAROLINA
DEPARTMENT OF TRANSPORTATION
WORK ZONE TRAFFIC CONTROL

**MOOSE BRANCH RD.
ROAD CLOSURE
AND DETOUR SIGNING**

24-JAN-2012 07:49 \\DOT\DFS\0070\PROJ\TIP\Projects-B\B4122\TrafficControl\B-4122-TC-TMP-4.dgn sblennings AT 1224731

GRAHAM COUNTY

NOTE: MAINTAIN VEHICULAR ACCESS TO DRIVEWAYS AT ALL TIMES DURING CONSTRUCTION UNLESS OTHERWISE DIRECTED BY THE ENGINEER.

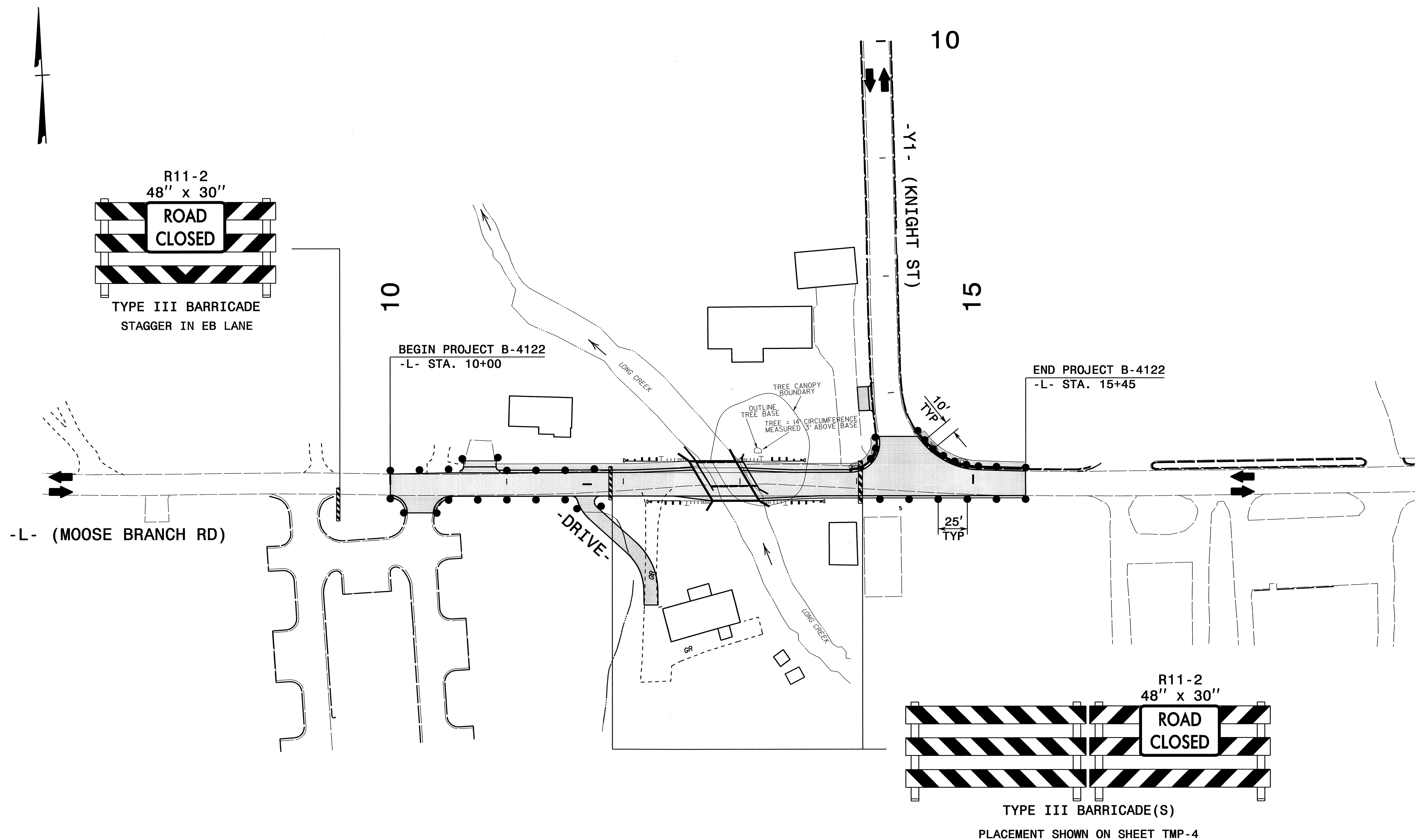

24-JAN-2012 07:50
 \DOT\DFSROOT\PROJ\TIP\Projects-B\B4122\TrafficControl\Top\B-4122.TC-TMP-5.dgn
 sblennings AT TE24473

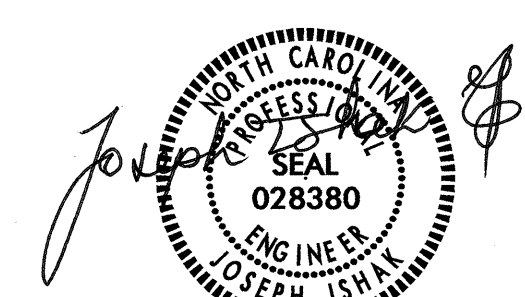
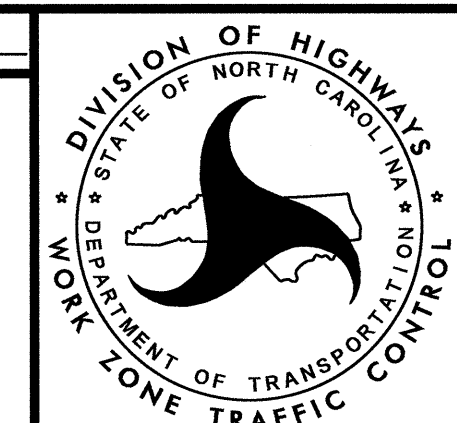
APPROVED: 	DATE: January 24, 2012		<h2>TEMPORARY TRAFFIC CONTROL DETAIL</h2>
--	---------------------------	---	---