

Approximate quantities only. Unclassified excavation, fine grading, clearing and grubbing, and removal of existing pavement will be paid for at the lump sum price for "Grading". (See Project Special Provision)

STATE OF NORTH CAROLINA DIVISION OF HIGHWAYS

PROJ. REFERENCE NO. B-2948	SHEET NO. X-0
-------------------------------	------------------

CROSS-SECTION SUMMARY

NOTE: EMBANKMENT COLUMN DOES NOT INCLUDE BACKFILL FOR UNDERCUT

Station	Uncl. Exc. (cu. yd.)	Embt (cu. yd.)																				
19+25.00	0	0																				
19+50.00	3	1																				
20+00.00	6	60																				
20+50.00	1	123																				
20+79.25	0	81																				
21+00.00	0	49																				
21+50.00	0	99																				
21+93.25	0	131																				
22+34.50	0	146																				
22+50.00	0	54																				
22+88.81	0	129																				
Station	Uncl. Exc.	Embt																				
L	(cu. yd.)	(cu. yd.)																				
23+91.19	0	0																				
24+45.14	28	91																				
25+00.00	16	60																				
25+50.00	3	13																				
Station	Uncl. Exc.	Embt																				
Y	(cu. yd.)	(cu. yd.)																				
10+23.00	0	0																				
10+50.00	3	3																				
10+73.81	1	13																				
11+00.00	0	27																				
11+15.74	0	9																				
Note: Earthwork quantities are calculated by the Roadway Design Unit. These earthwork quantities are based in part on subsurface data provided by the Geotechnical Engineering Unit.																						

8/23/99

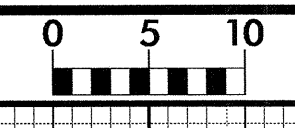

PROJ. REFERENCE NO.	SHEET NO.
B-2948	X-1

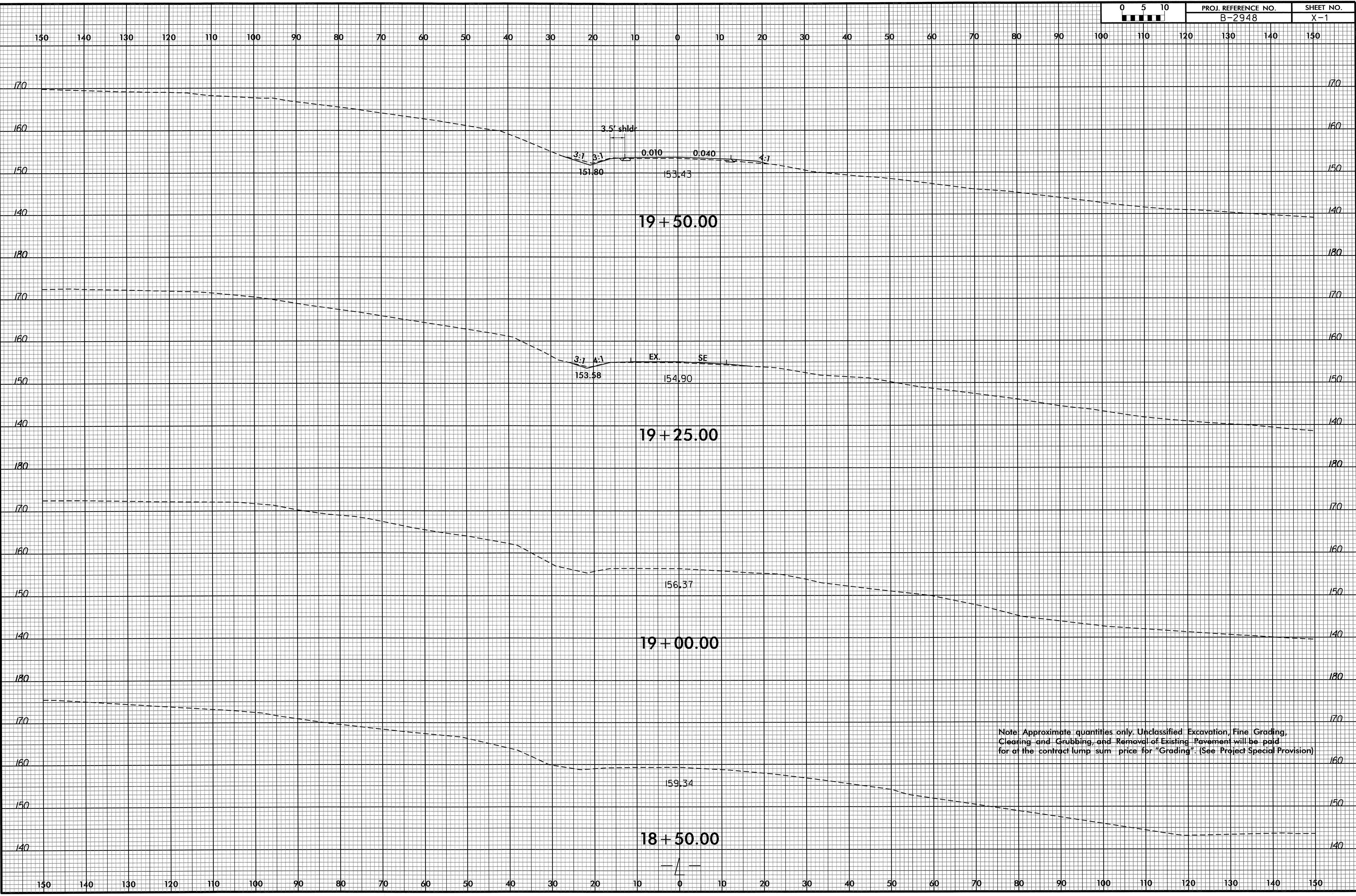

Note: Approximate quantities only. Unclassified Excavation, Fine Grading, Cleaning and Grubbing, and Removal of Existing Pavement will be paid for at the contract lump sum price for "Grading". (See Project Special Provision)

31-AUG-2012 14:47
 R:\Roadway\XSC\B2948_Rdy-XP.L.dgn
 \$\$\$USERNAME\$\$\$

8/23/99

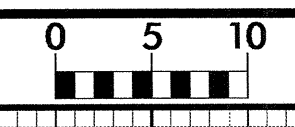

PROJ. REFERENCE NO.	SHEET NO.
B-2948	X-2

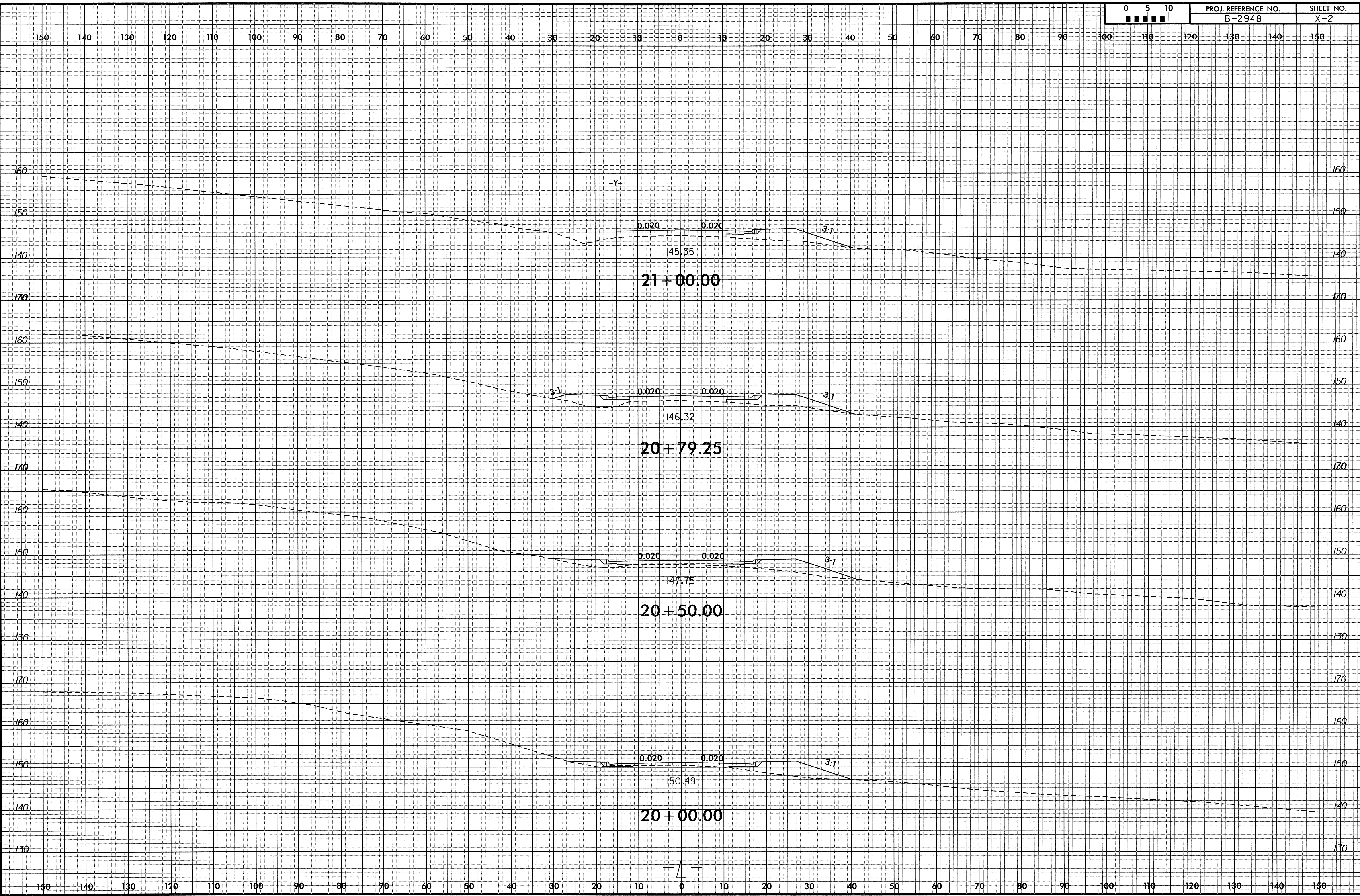

31-AUG-2002 14:17
R:\Roadway\XSC\B2948_Pduj_xp1.L.dgn
SSS\STRIVE \$\$\$

8/23/99



PROJ. REFERENCE NO.	SHEET NO.
B-2948	X-3

150 140 130 120 110 100 90 80 70 60 50 40 30 20 10 0 10 20 30 40 50 60 70 80 90 100 110 120 130 140 150

BEGIN BRIDGE -L- STA. 22+88.81

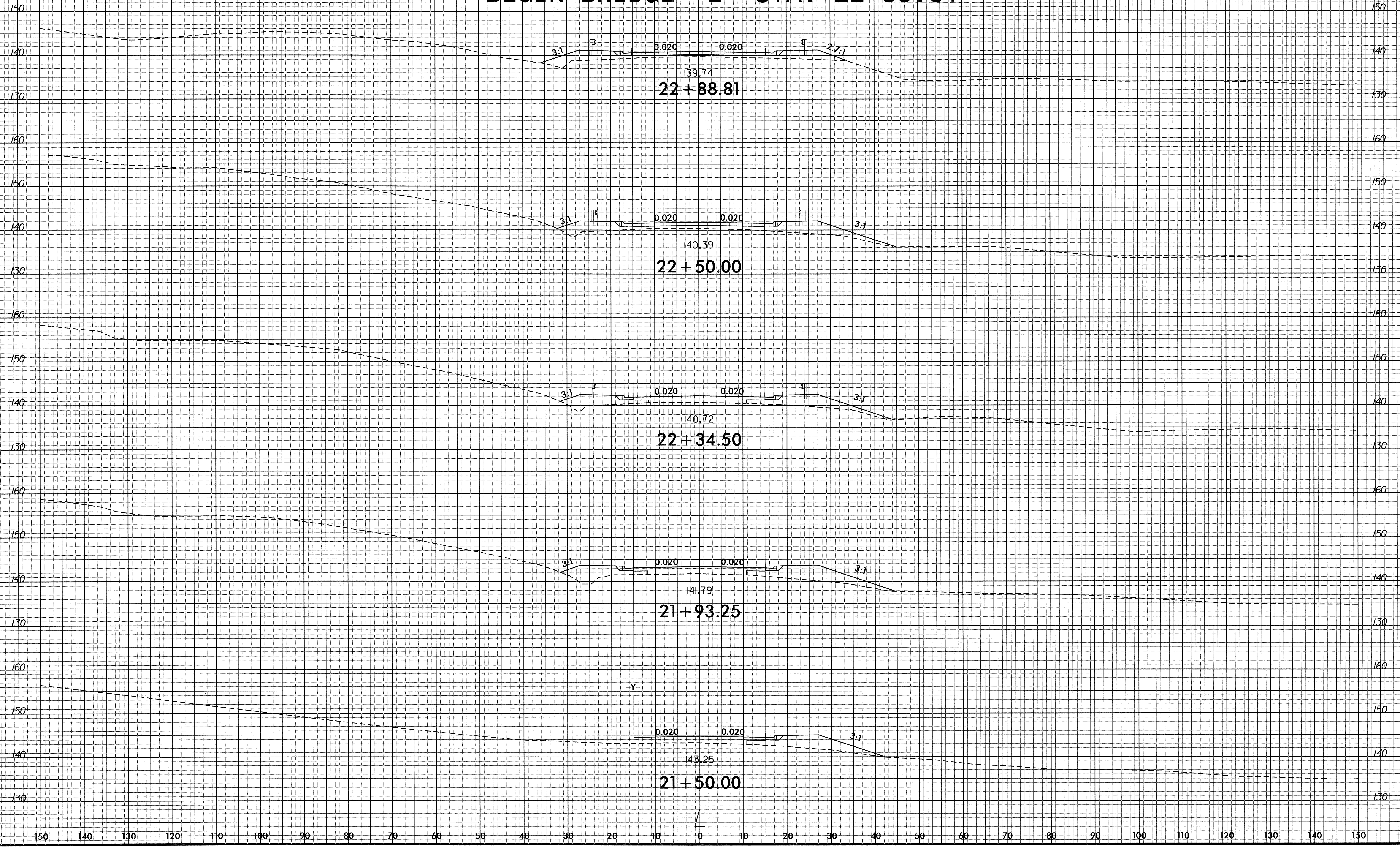

31-AUG-2002 14:17
R:\Roadway\XSC\AB2948_Pdy-xpl.L.dgn
\$\$\$\$USFRAN\$\$\$\$

8/23/98

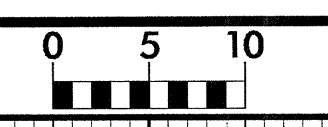

PROJ. REFERENCE NO.	SHEET NO.
B-2948	X-4

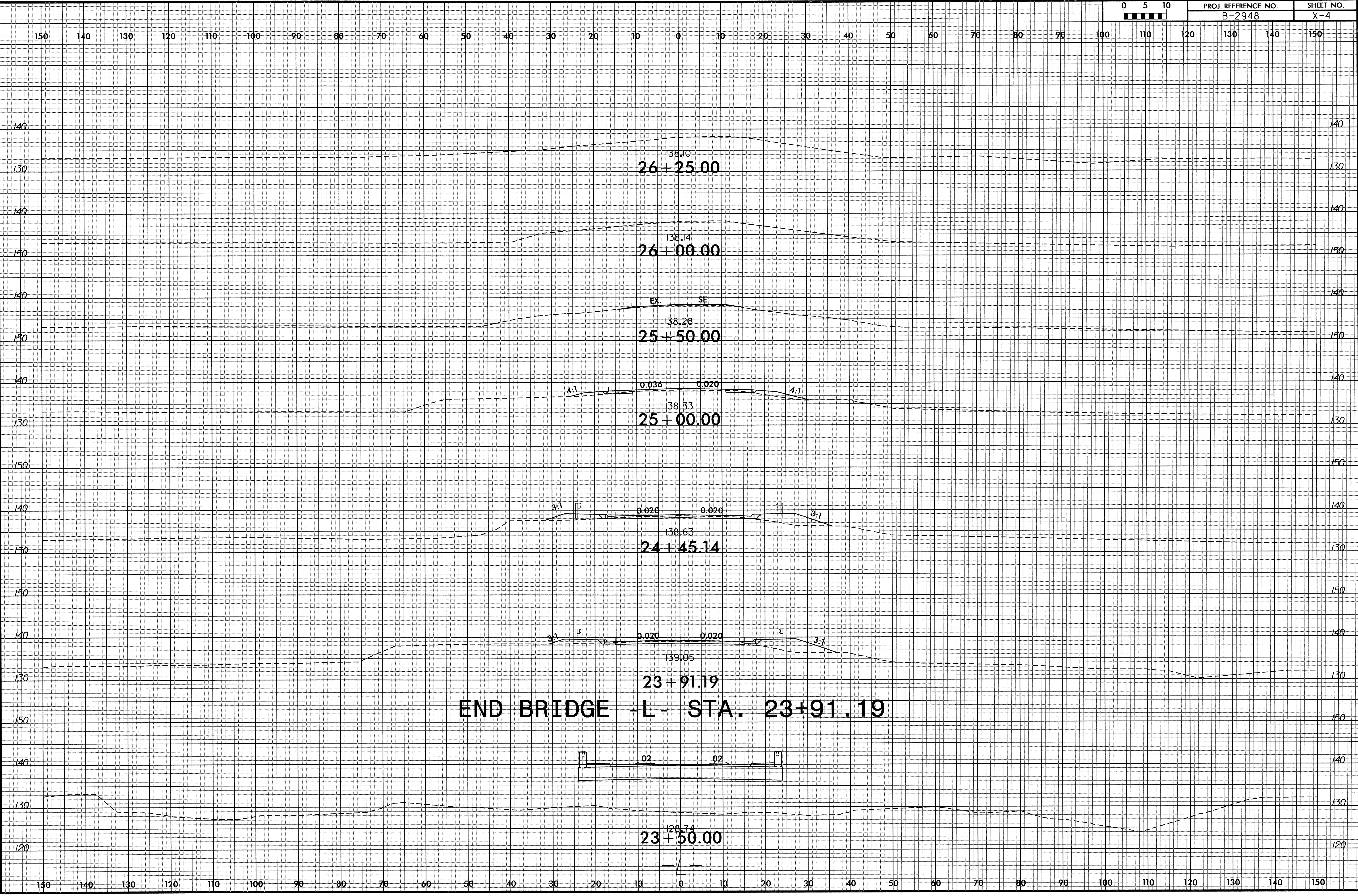

END BRIDGE - L - STA. 23+91.19

31-AUG-2012 14:16
 R:\Roadway\XSC\B2948_Rdy_xp1.L.dgn
 \$\$\$USERNAME\$\$\$

8/23/99

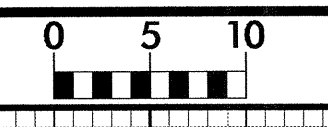

PROJ. REFERENCE NO. B-2948	SHEET NO. X-5
-------------------------------	------------------

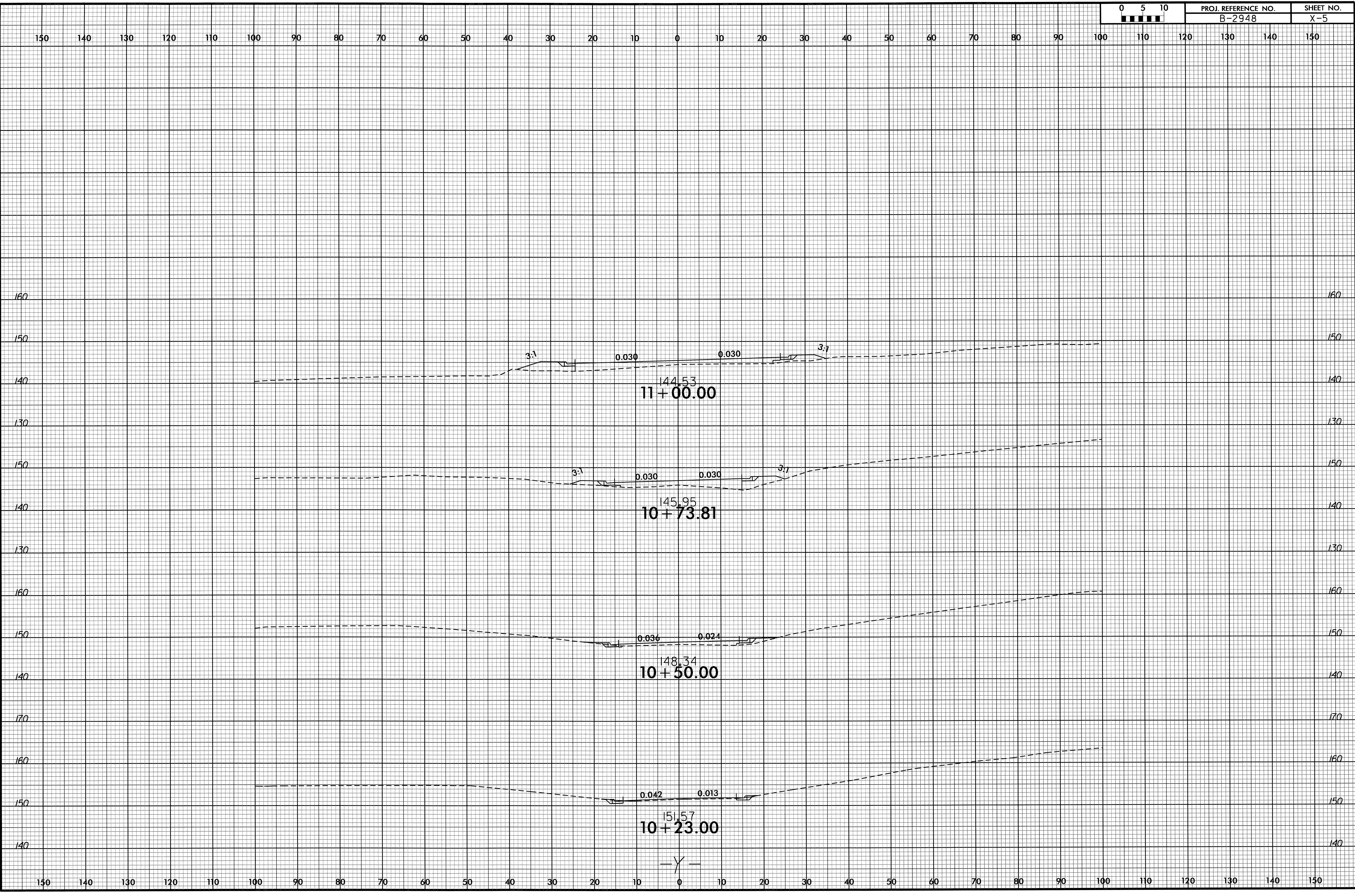

31-AUG-2012 14:46
 R:\Roadway\XSC\B2948_Rdy_xpl_Y.dgn
 \$\$\$USERNAME\$\$\$