

09/08/99

TIP PROJECT: B-4711

|            |           |
|------------|-----------|
| T.I.P. NO. | SHEET NO. |
| B-4711     | UO-1      |

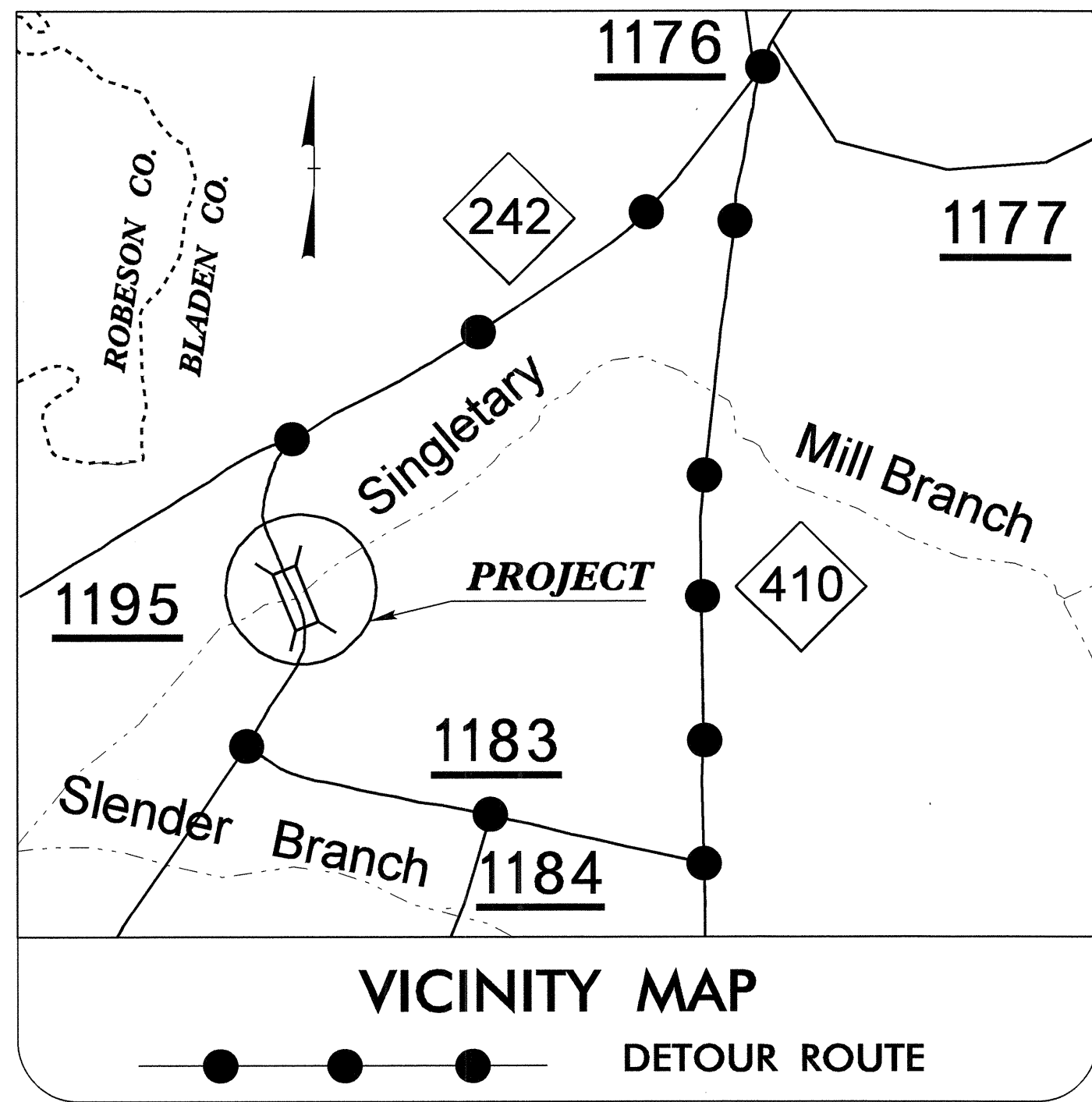

STATE OF NORTH CAROLINA  
DIVISION OF HIGHWAYS

**UTILITIES BY OTHERS PLANS  
BLADEN COUNTY**

LOCATION: BRIDGE NO. 5 OVER SINGLETARY MILL  
BRANCH ON NC 242

TYPE OF WORK: RELOCATE POWER AND TELEPHONE

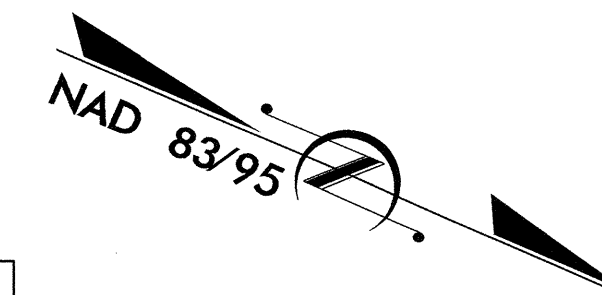

(UO-2) 4

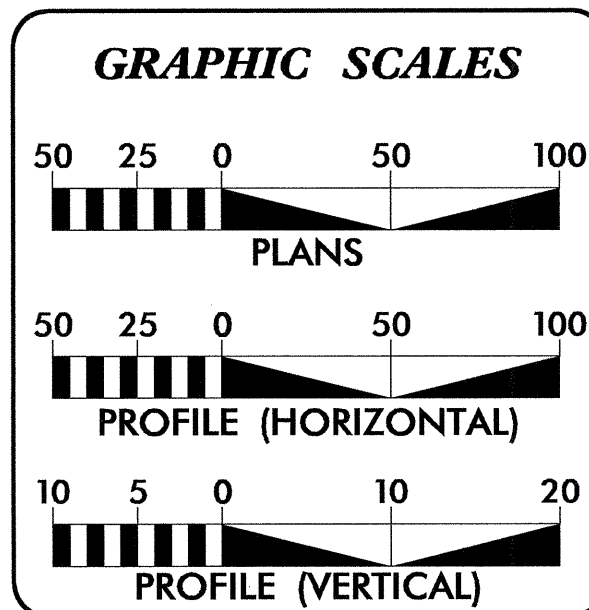
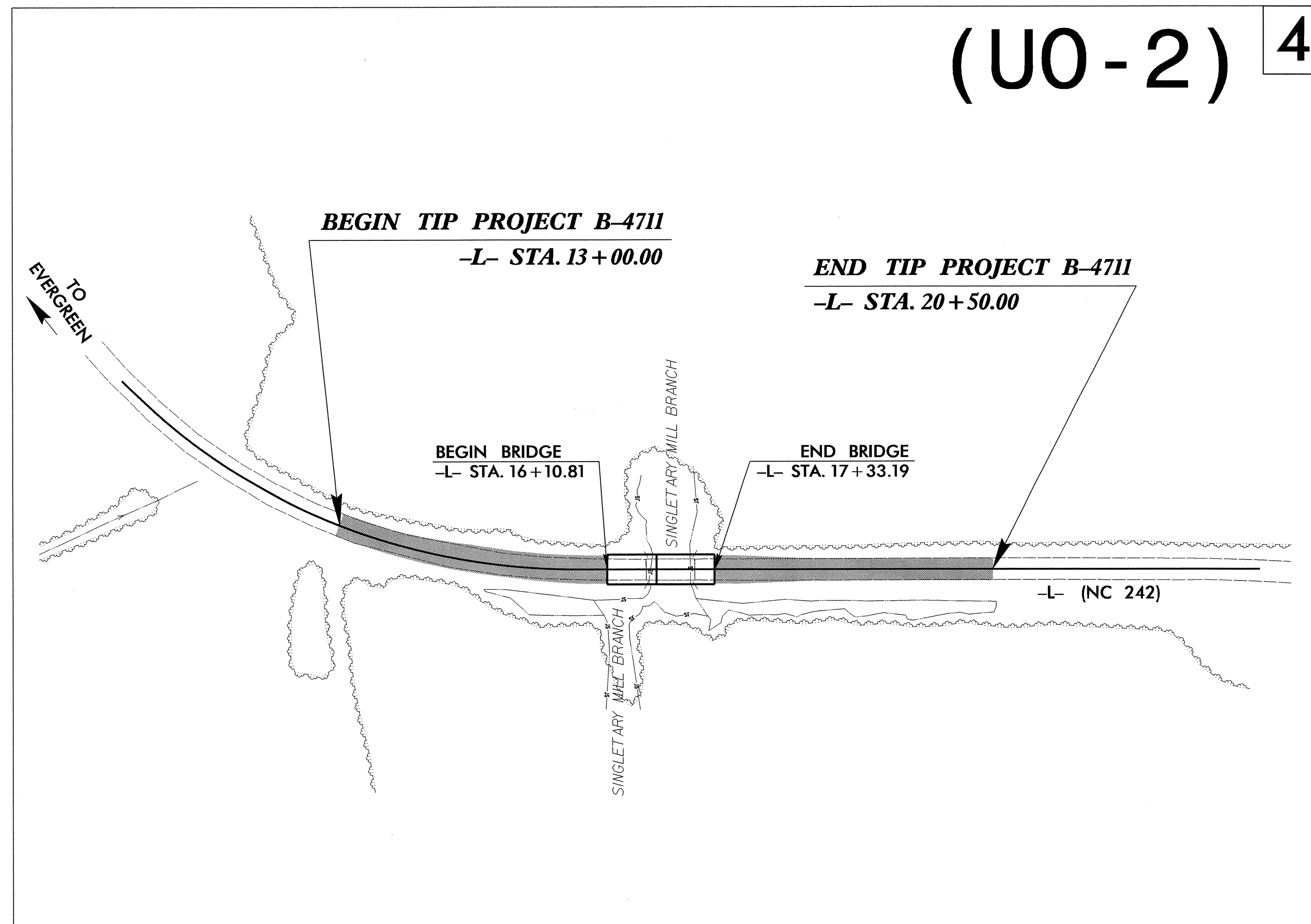

| INDEX OF SHEETS |             |
|-----------------|-------------|
| SHEET NO.       | DESCRIPTION |
| UO-1            | TITLE SHEET |
| UO-2            | PLAN SHEET  |

| UTILITY OWNERS ON PROJECT      |
|--------------------------------|
| (1) PROGRESS ENERGY - POWER    |
| (2) STAR TELEPHONE - TELEPHONE |



PREPARED IN THE OFFICE OF:  
DIVISION OF HIGHWAYS  
UTILITIES ENGINEERING  
SECTION

1591 MAIL SERVICES CENTER  
RALEIGH NC 27699-1591  
PHONE (919) 707-6690  
FAX (919) 250-4151

Roger Worthington, P.E. UTILITIES SECTION ENGINEER  
Corey Bousquet, P.E. UTILITIES SQUAD LEADER PROJECT ENGINEER  
Nabil Hamdan UTILITIES PROJECT DESIGNER

06-AUG-2012 11:28  
R:\Utilities\RGY\_UH\Proj\b4711\_rdy\_u01\_tsh.dgn  
\$\$\$\$\$USERNAME\$\$\$\$\$

**UTILITIES BY OTHERS**

**NOTE:**  
ALL PROPOSED UTILITY WORK  
SHOWN ON THIS SHEET WILL  
BE DONE BY OTHERS

5/14/99

04-OCT-2012 11:26  
R:\Utilities\Projects\B-4711\U0-2\U02-psh.v1.dgn

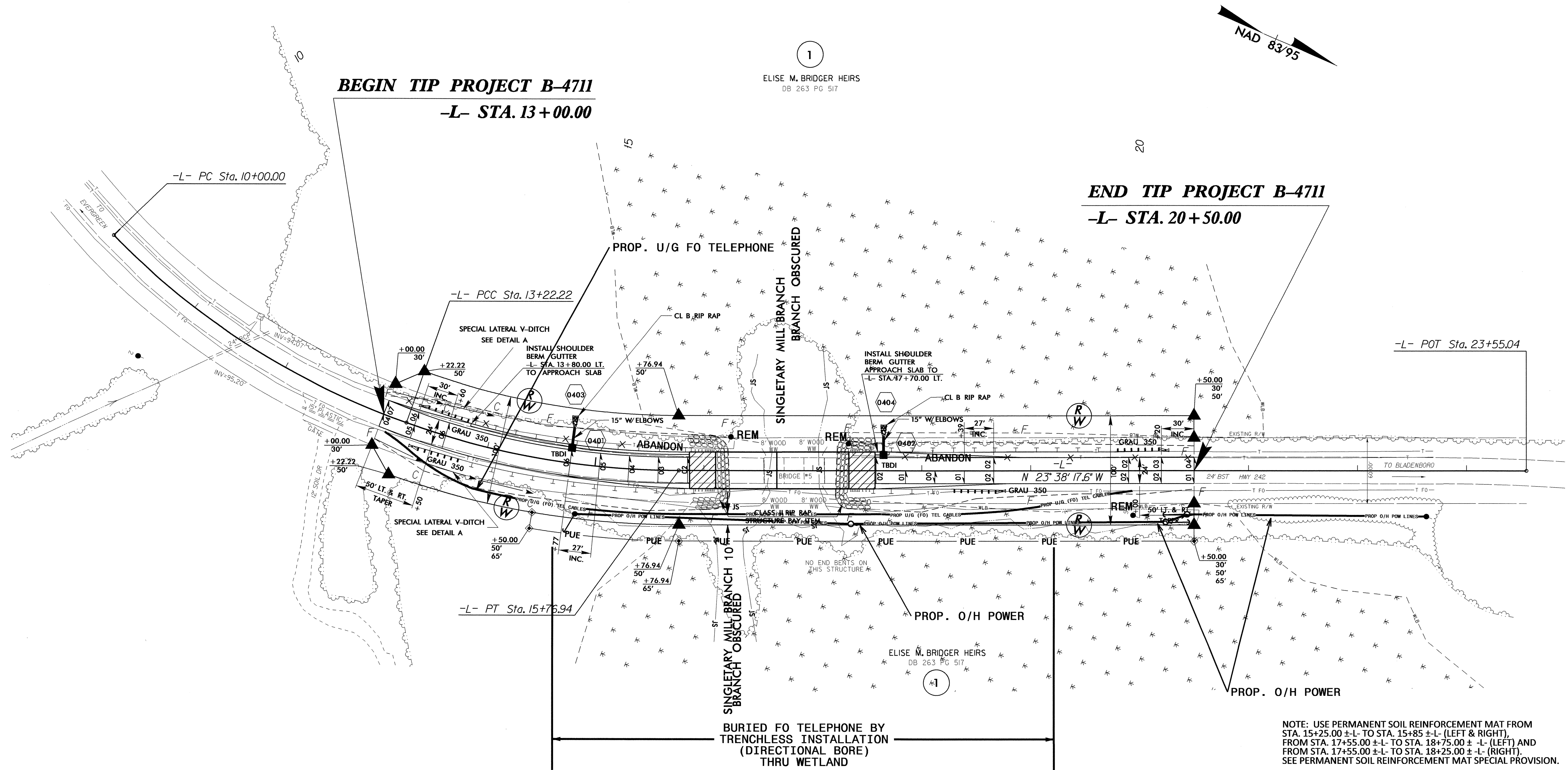

1  
ELISE M. BRIDGER HEIRS  
DB 263 PG 517

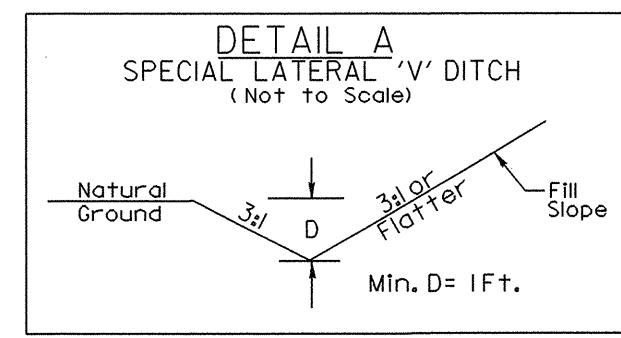
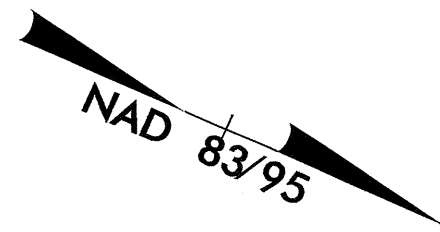

FROM -L- STA. 13+00 TO -L- STA. 14+50 (RT.)  
FROM -L- STA. 13+00 TO -L- STA. 14+00 (LT.)

NOTE: USE PERMANENT SOIL REINFORCEMENT MAT FROM STA. 15+25.00 ±L- TO STA. 15+85 ±L- (LEFT & RIGHT), FROM STA. 17+55.00 ±L- TO STA. 18+75.00 ±L- (LEFT) AND FROM STA. 17+55.00 ±L- TO STA. 18+25.00 ±L- (RIGHT). SEE PERMANENT SOIL REINFORCEMENT MAT SPECIAL PROVISION.