

IREDELL RESURFACING 2013

12CRJ049I.J4

1

12CR.2049I.J4

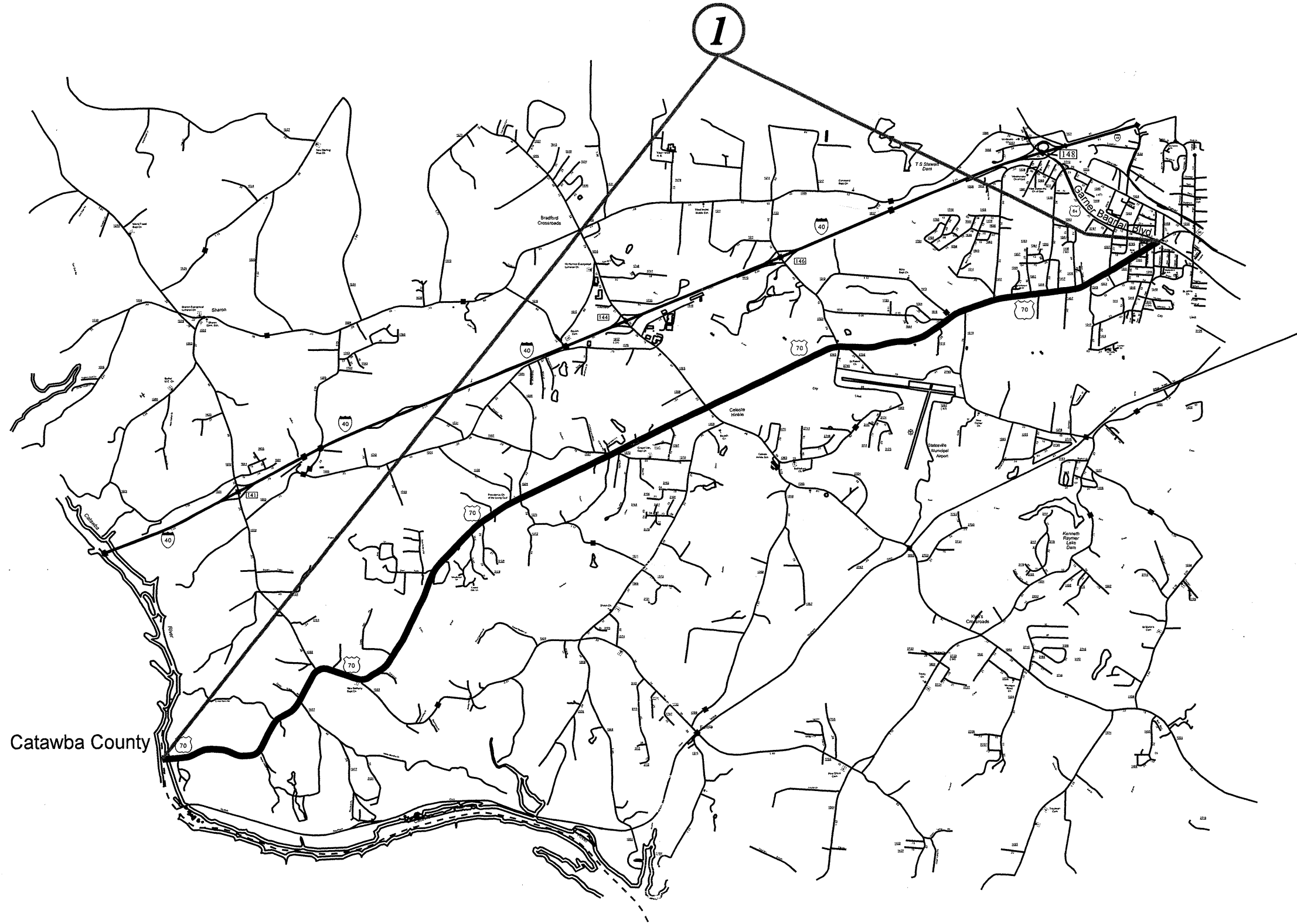

Catawba County

5/14/99

IREDELL RESURFACING 2013

PROJECT REFERENCE ID	SHEET NO.
12CR.10491.J4	2
12CR.20491.J4	

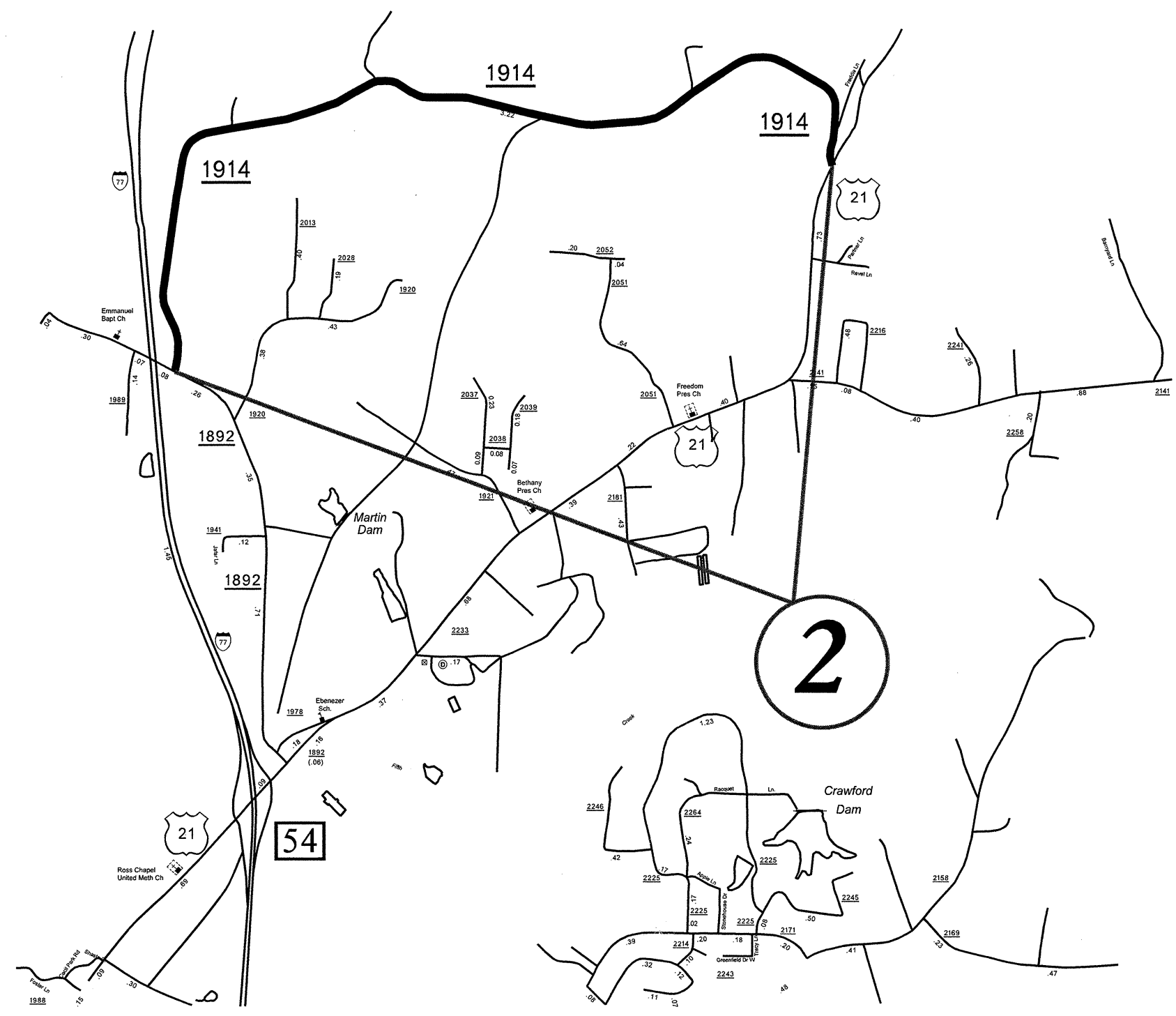

DATE PLOTTED: 5/14/99
DRAWN BY: JUS
CHECKED BY: JUS

5.14/99

IREDELL RESURFACING 2013

12CR.10491J4	3
12CR.20491J4	

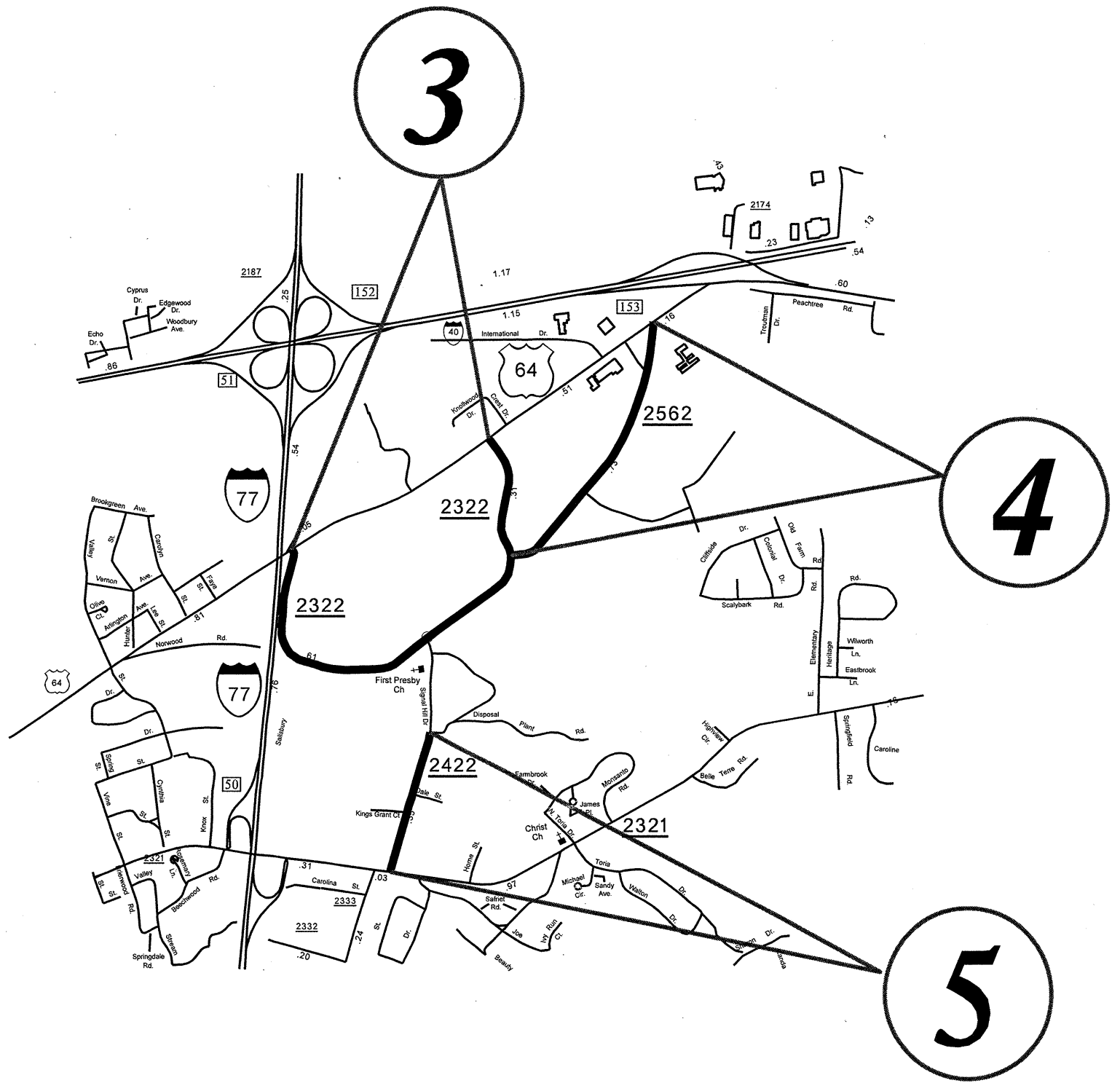

SYTIME
KREMER
MADE

IREDELL RESURFACING 2013

PROJECT REFERENCE (1-3)	SHEET 4 OF 4
12CR.10491.14	4
12CR.20491.14	

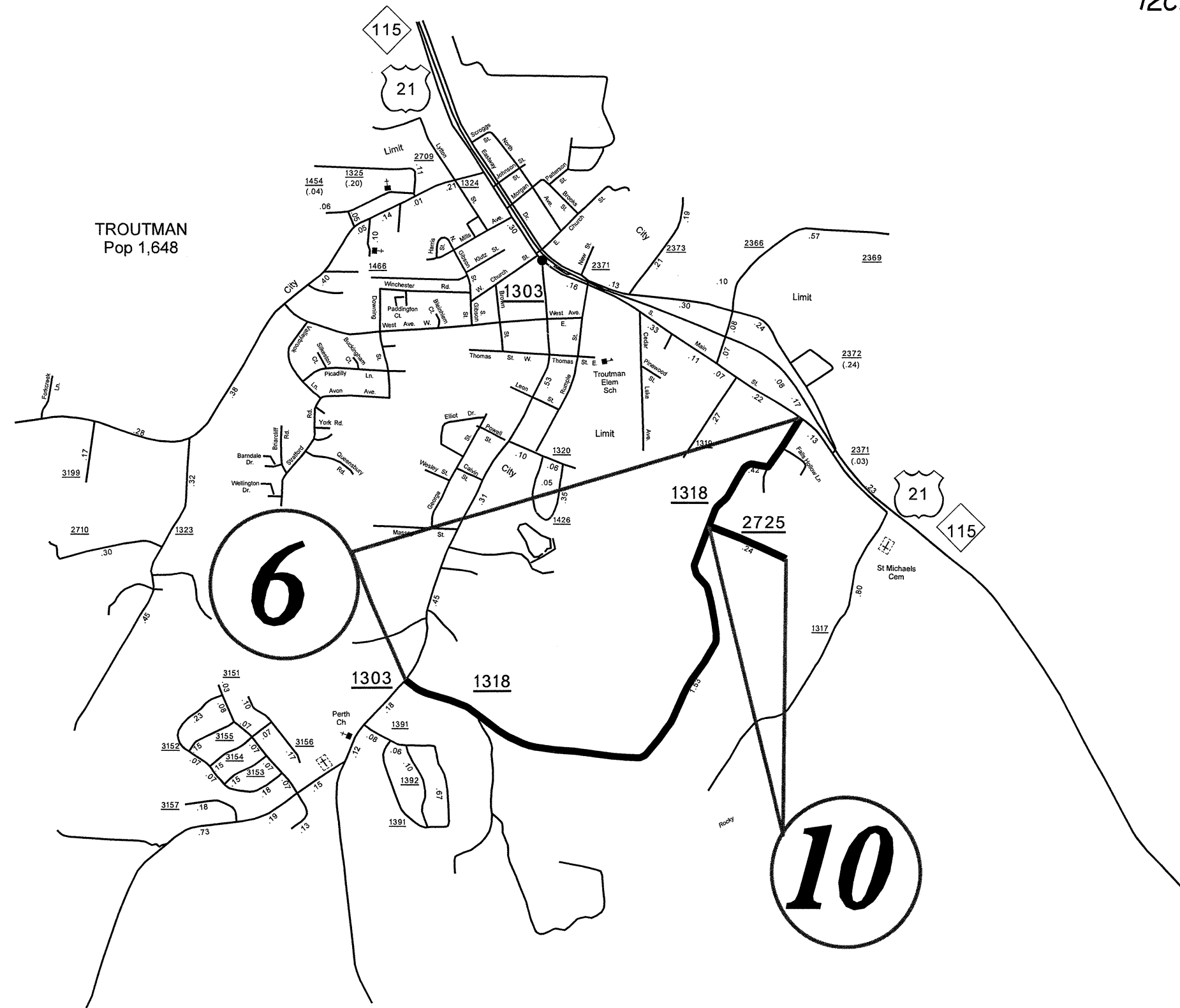

IREDELL RESURFACING 2013

12CR.10491.J4

5

12CR.20491.J4

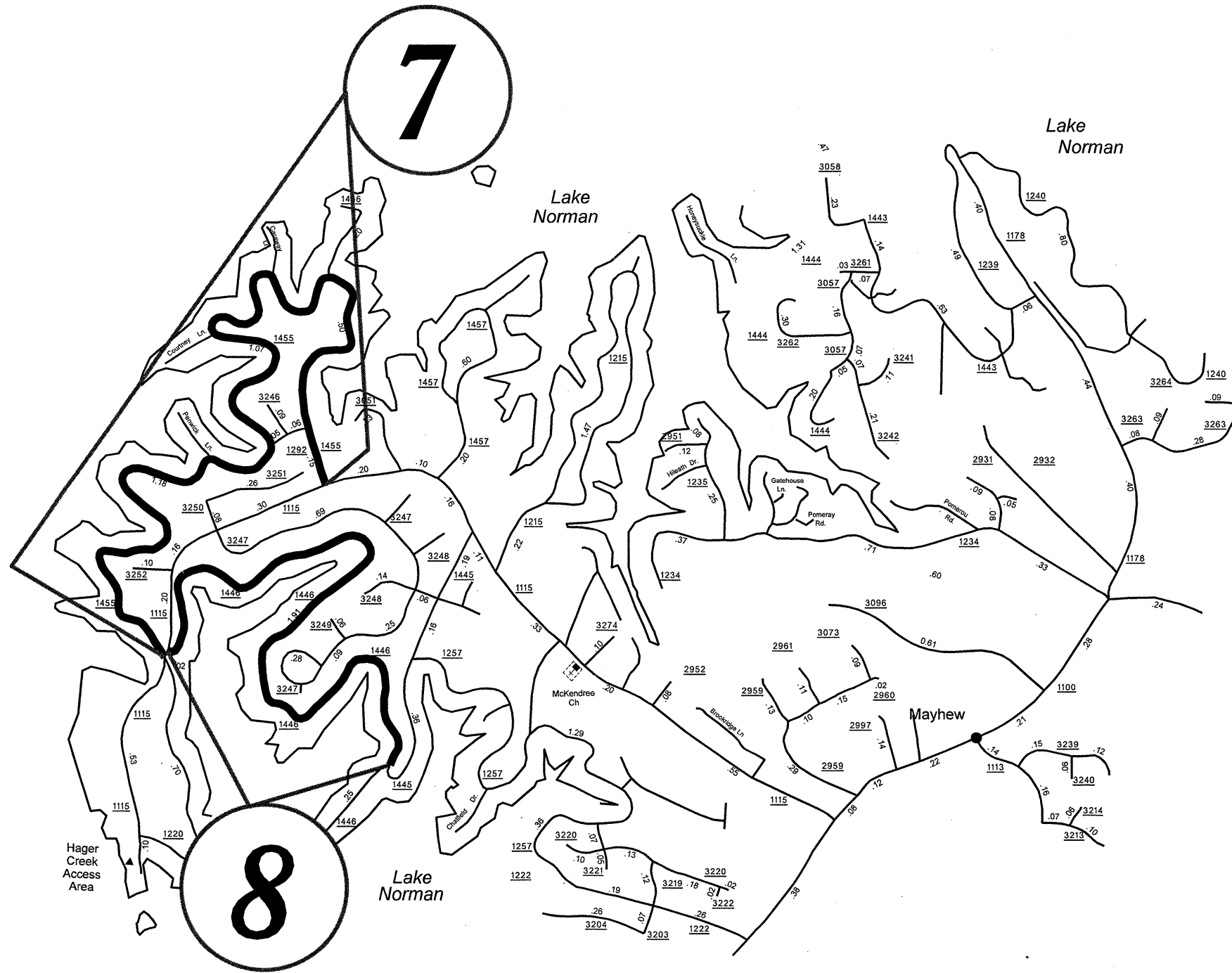

5/14/99

IREDELL RESURFACING 2013

PROJECT REFERENCE NO.	SHEET NO.
12CR.10491.14	6
12CR.20491.14	

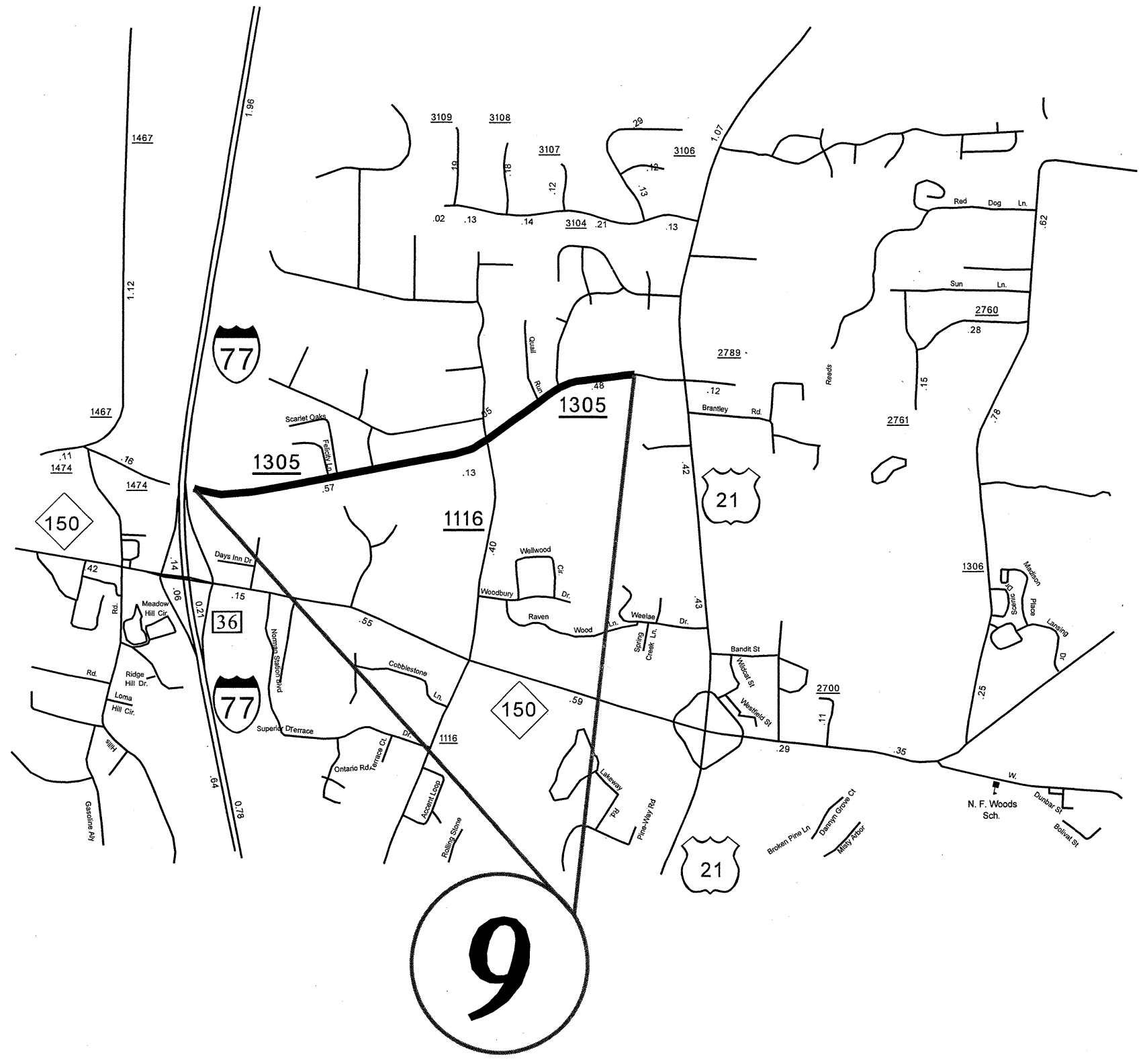

\$\$\$\$\$USER\$NAME\$\$\$\$\$

IREDELL RESURFACING 2013

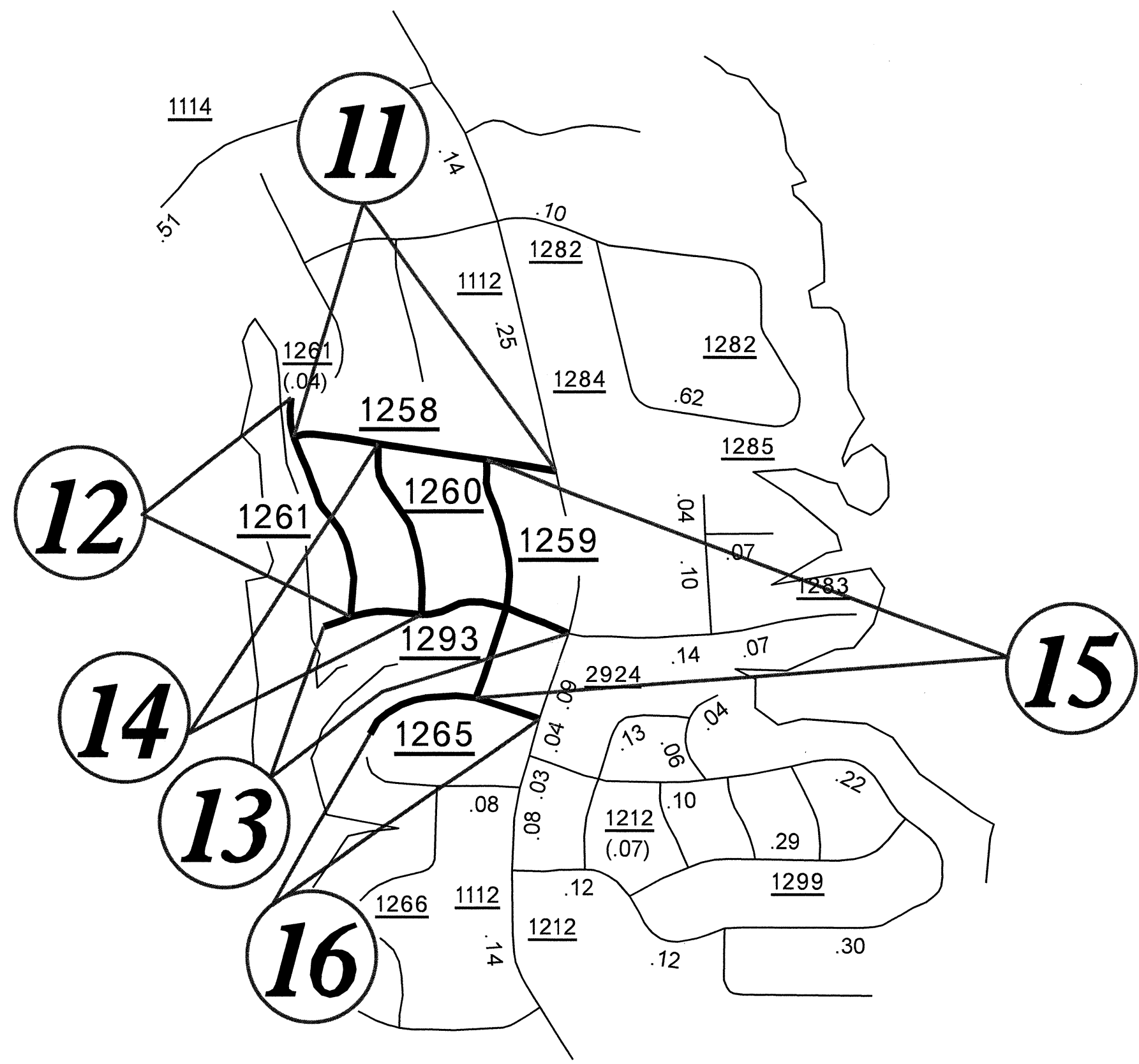

IREDELL RESURFACING 2013

PROJECT DESCRIPTION: 12CR.10491.14

SHEET NO. 8

12CR.20491.14

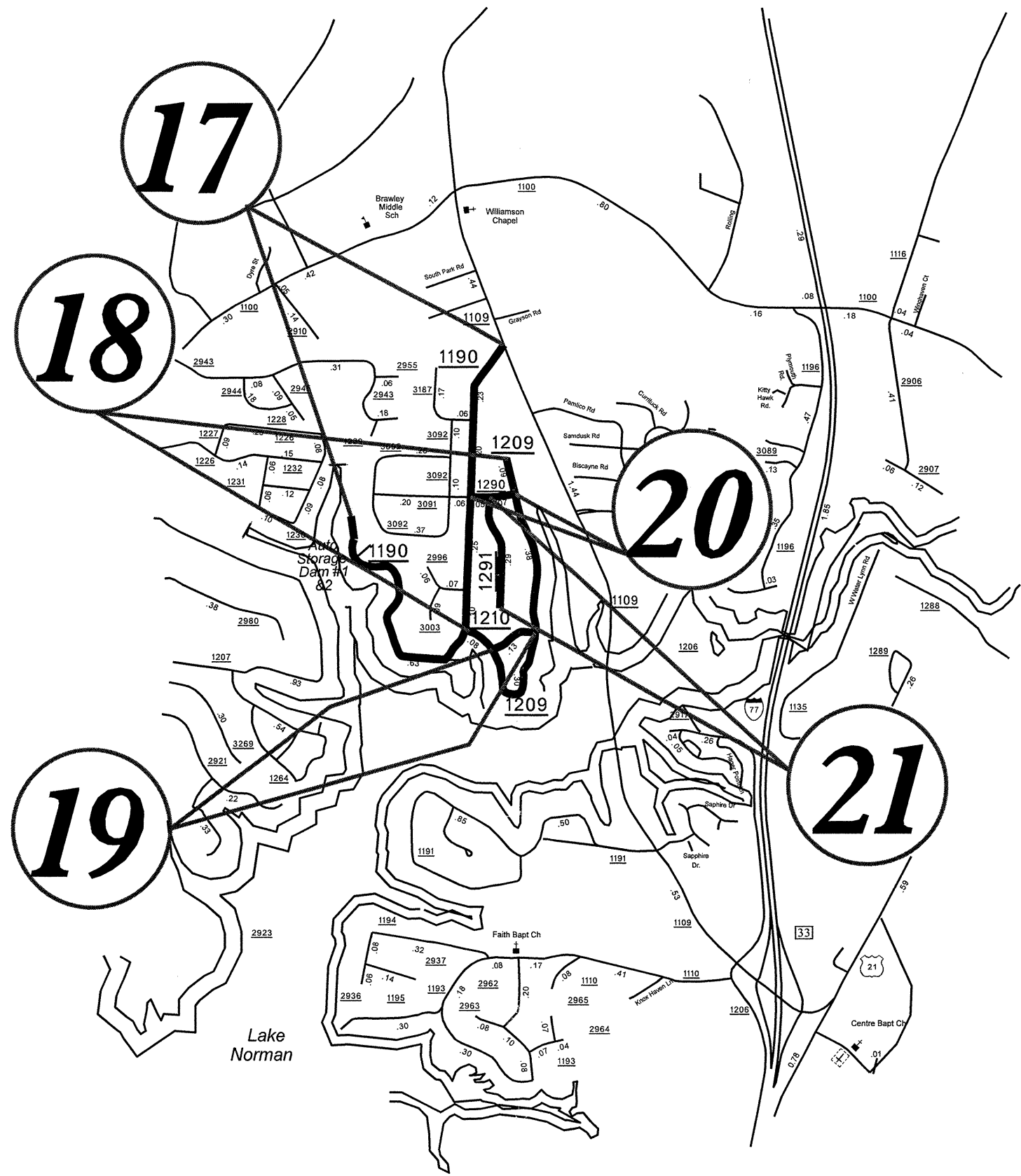

5/14/99

\$USER\$

5/14/09

IREDELL RESURFACING 2013

12CR.10491.14

9

12CR.20491.14

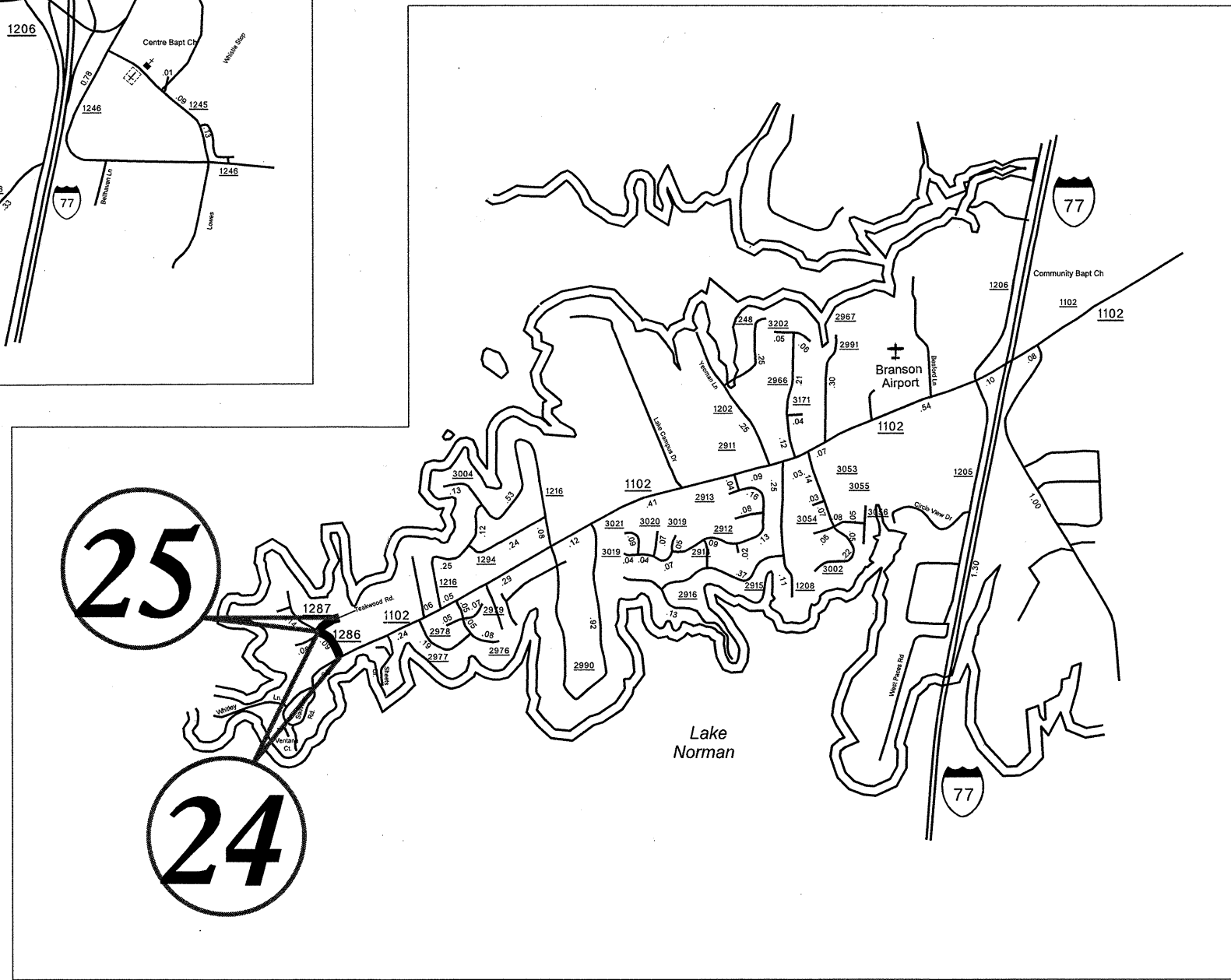
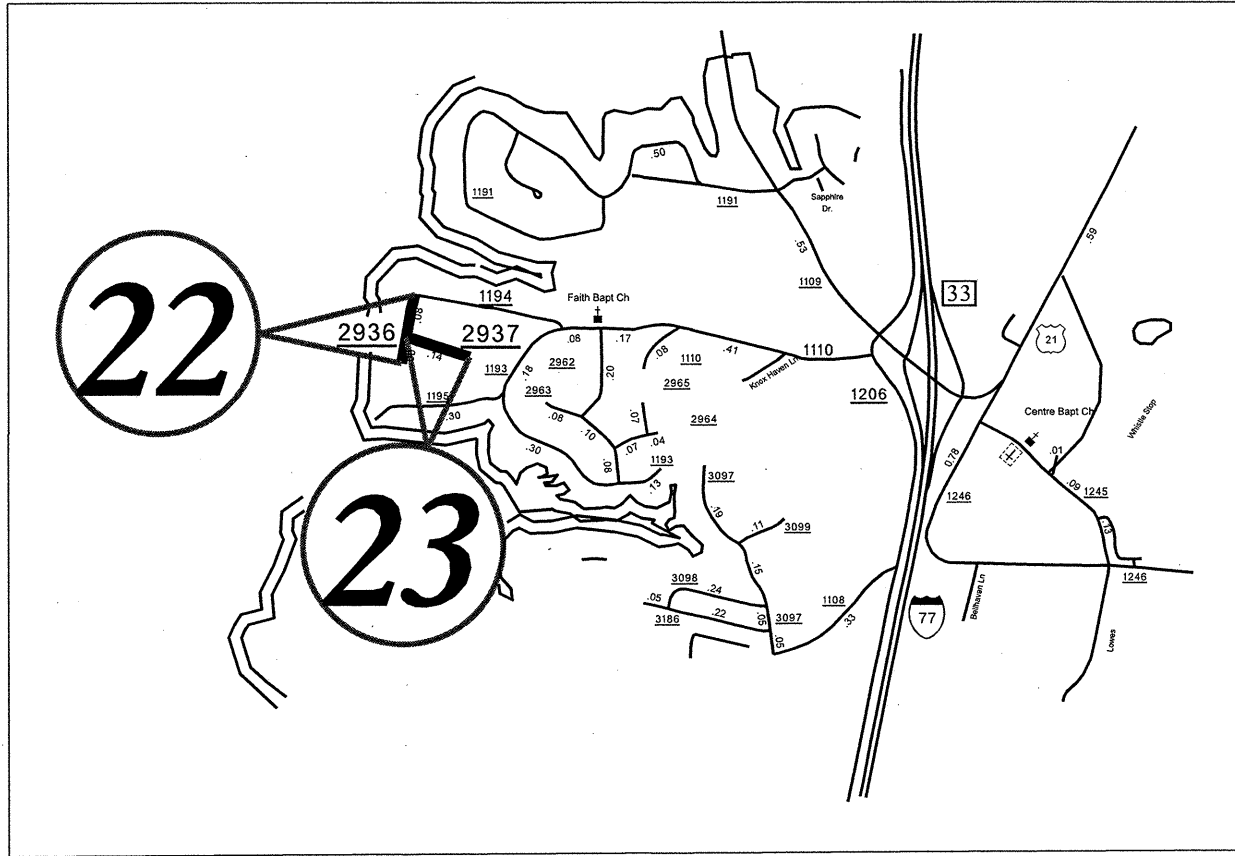

*****USERNAM*****

PAVEMENT SCHEDULE	
C1	PROP. APPROX. 1.5" ASPHALT CONCRETE SURFACE COURSE, TYPE S9.5B, AT AN AVERAGE RATE OF 168 LBS. PER SQ. YD.
C2	PROP. APPROX. 1.0" ASPHALT CONCRETE SURFACE COURSE, TYPE SF9.5A, AT AN AVERAGE RATE OF 110 LBS. PER SQ. YD.
E	PROP. APPROX. 5" ASPHALT CONCRETE BASE COURSE, TYPE B25.0B, AT AN AVERAGE RATE OF 570 LBS. PER SQ. YD.
Y	SHOULDER RECONSTRUCTION
Z	¾ INCH MILLING

NOTE: PAVEMENT EDGE SLOPES ARE 1:1 UNLESS SHOWN OTHERWISE.
MILL BRIDGE APPROACHES 100' TO PROVIDE A SMOOTH TRANSITION AS DIRECTED, THIS WILL BE PAID FOR AS INCIDENTAL MILLING.

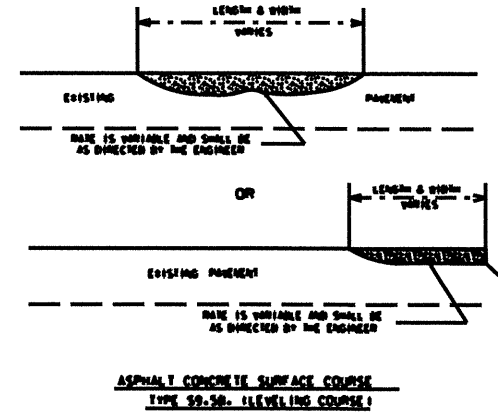
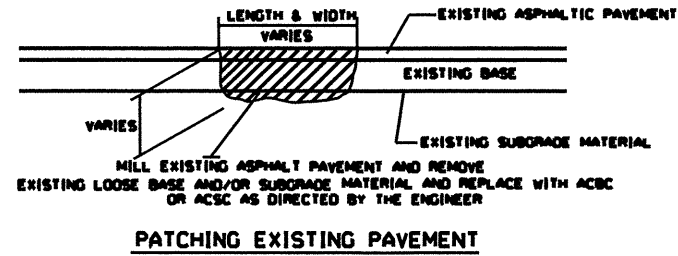

PROJ. REFERENCE NO.	SHEET NO.	TOTAL SHEETS
IREDELL COUNTY	10	
STATE PROJ. NO.	F.A. P-114	DESCRIPTION
12CR.10491.14		
12CR.20491.14		

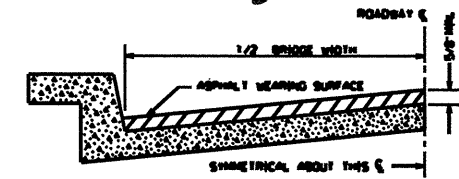

FOR BRIDGES WITH FLOOR DRAINS, CARE SHALL BE EXERCISED IN PLACING THE WEARING SURFACE AROUND FLOOR DRAINS SO AS NOT TO IMPAIR EFFECTIVE DRAINAGE. ALL DRAINS SHALL BE LEFT OPEN.
THE PROPOSED WEARING SURFACE SHALL VARY IN THICKNESS AS NECESSARY TO PROVIDE A SMOOTH RIDING SURFACE. A THICKNESS OF NOT LESS THAN 5/8" SHALL BE PROVIDED, THE MINIMUM THICKNESS SHALL, PREFERABLY, BE 1 1/2" UNLESS IT IS IMPRACTICAL TO PROVIDE A SMOOTH RIDING SURFACE OTHERWISE.

NOTES
ALL UNPAVED S.P. ROADS TO BE SURFACED 50' FROM EDGE OF PAVEMENT OF MAIN PROJECT.
ALL PAVED S.P. ROADS TO BE RESURFACED TO THE ENDS OF THE ROAD, OR AS DIRECTED BY THE ENGINEER.
EDGES, PAVEMENT WIDENING, INTERSECTIONS AND BRIDGE FLARES ARE INCLUDED IN THE TABLE OF QUANTITIES.
SHOULDERS AND DITCHES ARE TO BE CONSTRUCTED BY OTHERS UNLESS OTHERWISE NOTED.
BRIDGES TO BE RESURFACED AT LOCATIONS AND TO DEPTH AS DIRECTED BY THE ENGINEER.

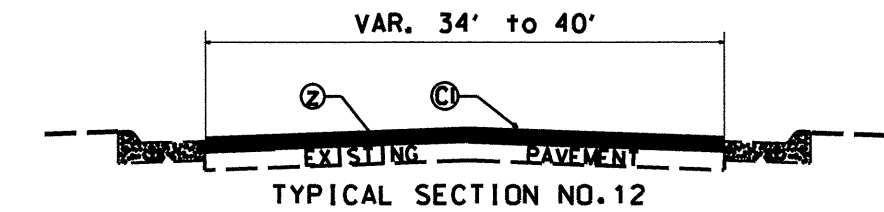
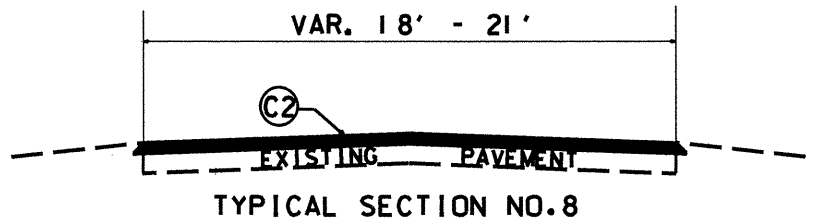
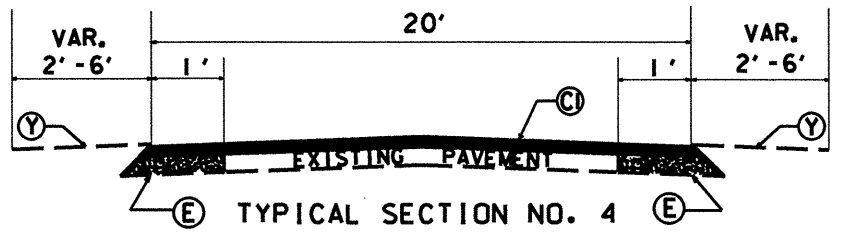
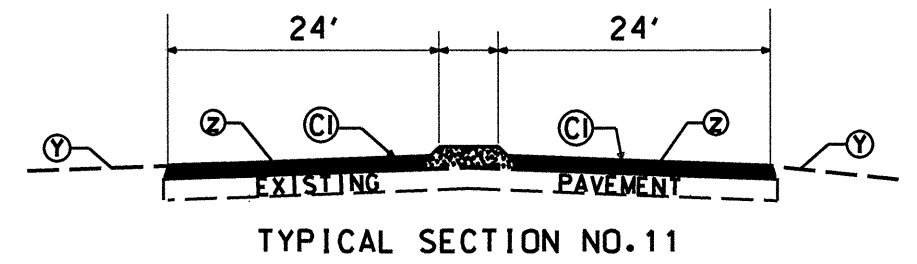
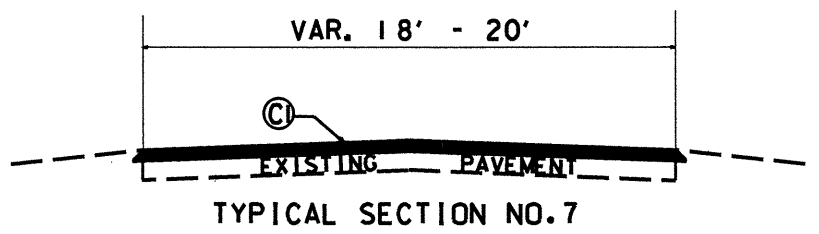
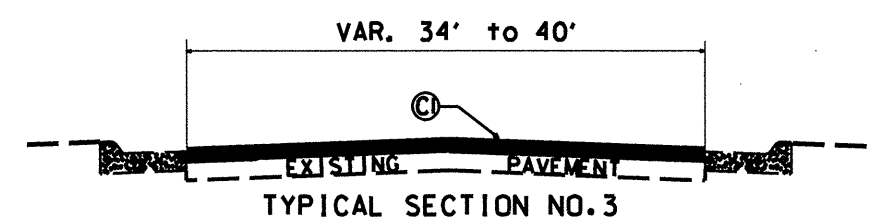
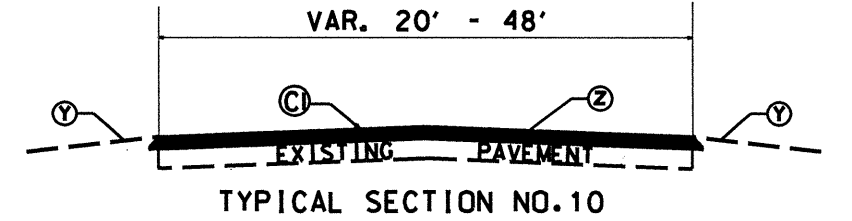
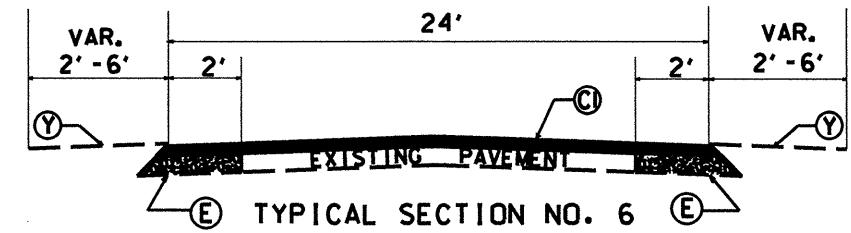
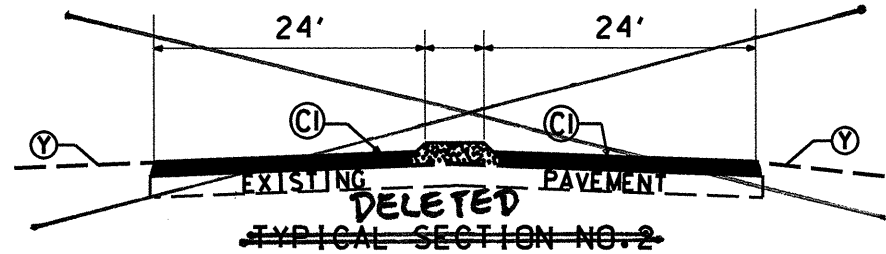
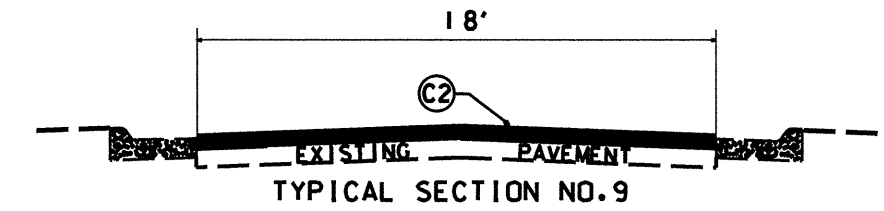
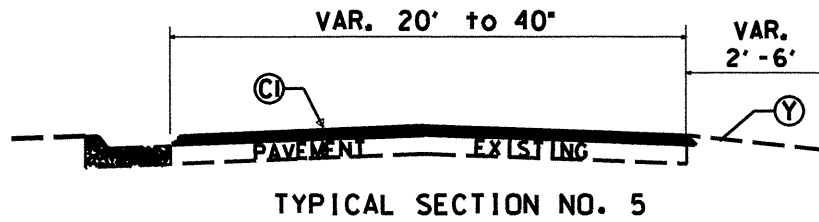
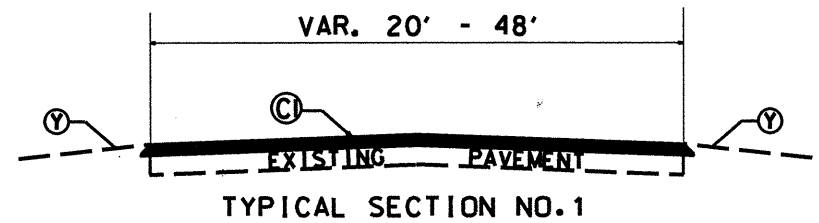

PROJECT NO.	SHEET NO.	TOTAL NO.
12CR.10491.14, 12CR.20491.14	11	

SUMMARY OF QUANTITIES

PROJECT NO	COUNTY	MAP NO	ROUTE	DESCRIPTION	TYP NO	FINAL SURFACE TESTING REQUIRED	LENGTH MI	WIDTH FT	AGGREGATE SHOULDER BORROW TON	INCIDENTAL STONE BASE TONS	SHOULDER RECONSTRUCTION SMI	INCIDENTAL MILLING SY	3/4 INCH MILLING SY	BASE COURSE, B25.0B TONS	SURFACE COURSE, S9.5B TONS	LEVELING COURSE, S9.5B TONS	SURFACE COURSE, SF9.5A TONS	ASPHALT BINDER FOR PLANT MIX TONS	PATCHING EXISTING PAVEMENT TONS	PORTABLE LIGHTING LS	ADJ. OF MANHOLES EA	ADJ. OF METER OR VALVE BOX EA	
12CR.10491.14	Iredell	1	US 70	FROM CATAWBA COUNTY LINE TO GARNER BAGNAL BLVD	10 11 12	NO	9.54 0.15 0.22	20 to 48 24 34 to 40	1,938	912	19.38	1,000	136,340		13,739	1,400		915	1,400		5	3	
TOTAL FOR PROJ NO. 12CR.10491.14							9.91		1,938	912	19.38	1,000	136,340		13,739	1,400		915	1,400		5	3	
12CR.20491.14	Iredell	2	SR-1914 BLACKWELDER RD	FROM US 21 TO SR-1892 JENNINGS RD	1 4	NO	2.84 0.32	20 to 48 20	632	150	6.32			2,400	3,700	370		352	600				
		3	SR-2322 SIMONTON/SIGNAL HILL EXT	FROM US 64 TO US 64	1 5	NO	1.05 0.24	20 to 48 20 to 40	105	50	1.05	645			1,593	240		111	300	1	3	1	
		4	SR-2562 SIMONTON DR	FROM SR-2322 SIGNAL HILL DR EXT TO US 64	1 3 6	NO	0.22 0.18 0.31	20 to 48 34 to 40 24	62	75	0.62			227	1,140	120		86	120	*	5		
		5	SR-2422 SIGNAL HILL DR	FROM SR-2321 TO PAVEMENT CHANGE	3	NO	0.36	34 to 40							795	60		52	100	*	9	5	
		6	SR-1318 AUTUMN LEAF RD	FROM SR-1303 PERTH RD TO US 21	1	NO	1.91	20 to 48	382	100	3.82				2,200	920		192	500				
		7	SR-1455 LAKEVIEW SHORES LP	FROM SR-1115 MCKENDREE RD TO SR-1115 MCKENDREE RD	7	NO	2.91	18 to 20		150					3,217	200		206	500				
		8	SR-1446 E.KEMP RD	FROM SR-1115 MCKENDREE RD TO SR 1445 KEMP RD	7	NO	1.76	18 to 20		150					1,750	200		118	300				
		9	SR-1305 OATES RD	FROM START OF NEW PAVEMENT TO DEAD END	1	NO	0.89	20 to 48	178	100	1.78				1,001	100		67	200				
		10	SR-2725 TRELIS LN	FROM SR-1318 AUTUMN LEAF RD TO DEAD END	1	NO	0.24	20 to 48	47	30	0.47				275	100		23	100				
		11	SR-1258 COVE VIEW RD	FROM SR-1112 STUTTS RD TO DEAD END	8	NO	0.25	18 to 21		84							244	16					
		12	SR-1261 GONDOLA RD	FROM SR-1293 BLUE WING RD TO DEAD END	8	NO	0.22	18 to 21		33							203	14					
		13	SR-1293 BLUEWING RD	FROM SR-1112 STUTTS RD TO DEAD END	8	NO	0.25	18 to 21		72							229	15					
		14	SR-1260 ENSIGN RD	FROM SR-1293 TO SR-1258 COVE VIEW RD	8	NO	0.17	18 to 21		36							155	10					
		15	SR-1259 DRIFTWOOD RD	FROM SR-1265 MARINA LN TO SR-1258 COVE VIEW RD	8	NO	0.23	18 to 21		39							215	14					
		16	SR-1265 MARINA LN	FROM SR-1112 STUTTS RD TO DEAD END	8	NO	0.19	18 to 21		63							178	12					
		17	SR-1190 SUNDOWN RD	FROM SR-1109 WILLIAMSON RD TO DEAD END	8	NO	1.4	18 to 21		180							1,225	82					
		18	SR-1209 ELYSIAN DR	FROM SR-1190 SUNDOWN RD TO DEAD END	8	NO	0.91	18 to 21		138							800	54					
		19	SR-1210 ZEPHYR RD	FROM SR-1209 ELYSIAN DR TO SR-1209 ELYSIAN DR	8	NO	0.13	18 to 21		30							107	7					
		20	SR-1290 BROCKWAY DR	FROM SR-1209 ELYSIAN DR TO SR-1190 SUNDOWN RD	8	NO	0.11	18 to 21		12							105	7					
		21	SR-1291 MOORELAND DR	FROM SR-1290 BROCKWAY DR TO DEAD END	8	NO	0.31	18 to 21		66							285	19					
		22	SR 2936 BEACH LN	FROM SR-1194 MALIBU RD TO DEAD END	9	NO	0.15	18									126	8					
		23	SR-2937 SPORT COURT WAY	FROM SR-2936 BEACH LN TO DEAD END	9	NO	0.16	18									132	9					
		24	SR-1286 SCHOONER RD	FROM SR-1102 LANGTREE RD TO START NEW PAVEMENT	8	NO	0.09	18 to 21		20							84	6					
		25	SR-1287 TEAKWOOD LN	FROM SR-1286 SCHOONER RD TO DEAD END	8	NO	0.09	18 to 21		20							79	5					
TOTAL FOR PROJ NO. 12CR.20491.14							17.89		1,406	1,598	14.06	645		2,627	15,671	2,310	4,167	1,485	2,720	1	17	6	
GRAND TOTAL							27.8		3,344	2,510	33.44	1,645	136,340		2,627	29,410	3,710	4,167	2,400	4,120	1	22	9

PROJECT NO.	SHEET NO.	TOTAL NO.
12CR.10491.14, 12CR.20491.14	12	

THERMOPLASTIC AND PAINT QUANTITIES

PROJECT NO	COUNTY	MAP NO	ROUTE	DESCRIPTION	LENGTH	WIDTH	468600000-E		471000000-E	472500000-E					481000000-E		482000000-E	490500000-N	
							4" X 120 M WHITE THERMO LF	4" X 120 M YELLOW THERMO LF	24" X 120 M WHITE THERMO LF	THERMO LT ARROW 90 M EA	THERMO STR ARROW 90 M EA	THERMO RT ARROW 90 M EA	THERMO STR & LT ARROW 90 M EA	THERMO STR & RT ARROW 90 M EA	4" WHITE PAINT LF	4" YELLOW PAINT LF	8" YELLOW PAINT LF	SNOW PLOWABLE MARKERS EA	
12CR.10491.14	Iredell	1	US 70	FROM CATAWBA COUNTY LINE TO GARNER BAGNAL BLVD	9.91	22	104,640	104,640	100	6	4	2					104,460	660	
TOTAL FOR PROJ NO. 12CR.10491.14					9.91		104,640	104,640	100	6	4	2					104,460	660	
							209,280			12					104,460				
12CR.20491.14	Iredell	2	SR-1914 BLACKWELDER RD	FROM US 21 TO SR-1892 JENNINGS RD	3.16	21										66,800	66,800		
		3	SR-2322 SIMONTON/SIGNAL HILL EXT	FROM US 64 TO US 64	1.29	19				1		1				27,120	27,120	150	
		4	SR-2562 SIMONTON DR	FROM SR-2322 SIGNAL HILL DR EXT TO US 64	0.71	22			50	7						15,100	15,100		
		5	SR-2422 SIGNAL HILL DR	FROM SR-2321 TO PAVEMENT CHANGE	0.36	40			40			2	5	3		3,800	7,600		
		6	SR-1318 AUTUMN LEAF RD	FROM SR-1303 PERTH RD TO US 21	1.91	20										40,240	40,240		
		7	SR-1455 LAKEVIEW SHORES LP	FROM SR-1115 MCKENDREE RD TO SR-1115 MCKENDREE RD	2.91	20										61,500	61,500		
		8	SR-1446 E.KEMP RD	FROM SR-1115 MCKENDREE RD TO SR 1445 KEMP RD	1.76	18										37,200	37,200		
		9	SR-1305 OATES RD	FROM START OF NEW PAVEMENT TO DEAD END	0.89	20						1				18,840	18,840		
		10	SR-2725 TRELIS LN	FROM SR-1318 AUTUMN LEAF RD TO DEAD END	0.24	21													
		11	SR-1258 COVE VIEW RD	FROM SR-1112 STUTTS RD TO DEAD END	0.25	21													
		12	SR-1261 GONDOLA RD	FROM SR-1293 BLUE WING RD TO DEAD END	0.22	20													
		13	SR-1293 BLUEWING RD	FROM SR-1112 STUTTS RD TO DEAD END	0.25	20													
		14	SR-1260 ENSIGN RD	FROM SR-1293 TO SR-1258 COVE VIEW RD	0.17	20													
		15	SR-1259 DRIFTWOOD RD	FROM SR-1265 MARINA LN TO SR-1258 COVE VIEW RD	0.23	20													
		16	SR-1265 MARINA LN	FROM SR-1112 STUTTS RD TO DEAD END	0.19	20													
		17	SR-1190 SUNDOWN RD	FROM SR-1109 WILLIAMSON RD TO DEAD END	1.4	20													
		18	SR-1209 ELYSIAN DR	FROM SR-1190 SUNDOWN RD TO DEAD END	0.91	20													
		19	SR-1210 ZEPHYR RD	FROM SR-1209 ELYSIAN DR TO SR 1209 ELYSIAN DR	0.13	18													
		20	SR-1290 BROCKWAY DR	FROM SR-1209 ELYSIAN DR TO SR 1190 SUNDOWN RD	0.11	20													
		21	SR-1291 MOORELAND DR	FROM SR-1290 BROCKWAY DR TO DEAD END	0.31	20													
		22	SR 2936 BEACH LN	FROM SR-1194 MALIBU RD TO DEAD END	0.15	18													
		23	SR-2937 SPORT COURT WAY	FROM SR-2936 BEACH LN TO DEAD END	0.16	18													
		24	SR-1286 SCHOONER RD	FROM SR-1102 LANGTREE RD TO START NEW PAVEMENT	0.09	20													
		25	SR-1287 TEAKWOOD LN	FROM SR-1286 SCHOONER RD TO DEAD END	0.09	20													
TOTAL FOR PROJ NO. 12CR.20491.14					17.89				90	8		4	5	3		270,600	274,400	150	
							209,280			20					545,000				
GRAND TOTAL					27.8		104,640	104,640	190	14	4	6	5	3		270,600	378,860	150	660
							209,280			32					649,460				