

GASTON COUNTY
NORTH CAROLINA

12CR.10361.14
12CR.20361.19

SHEET 4

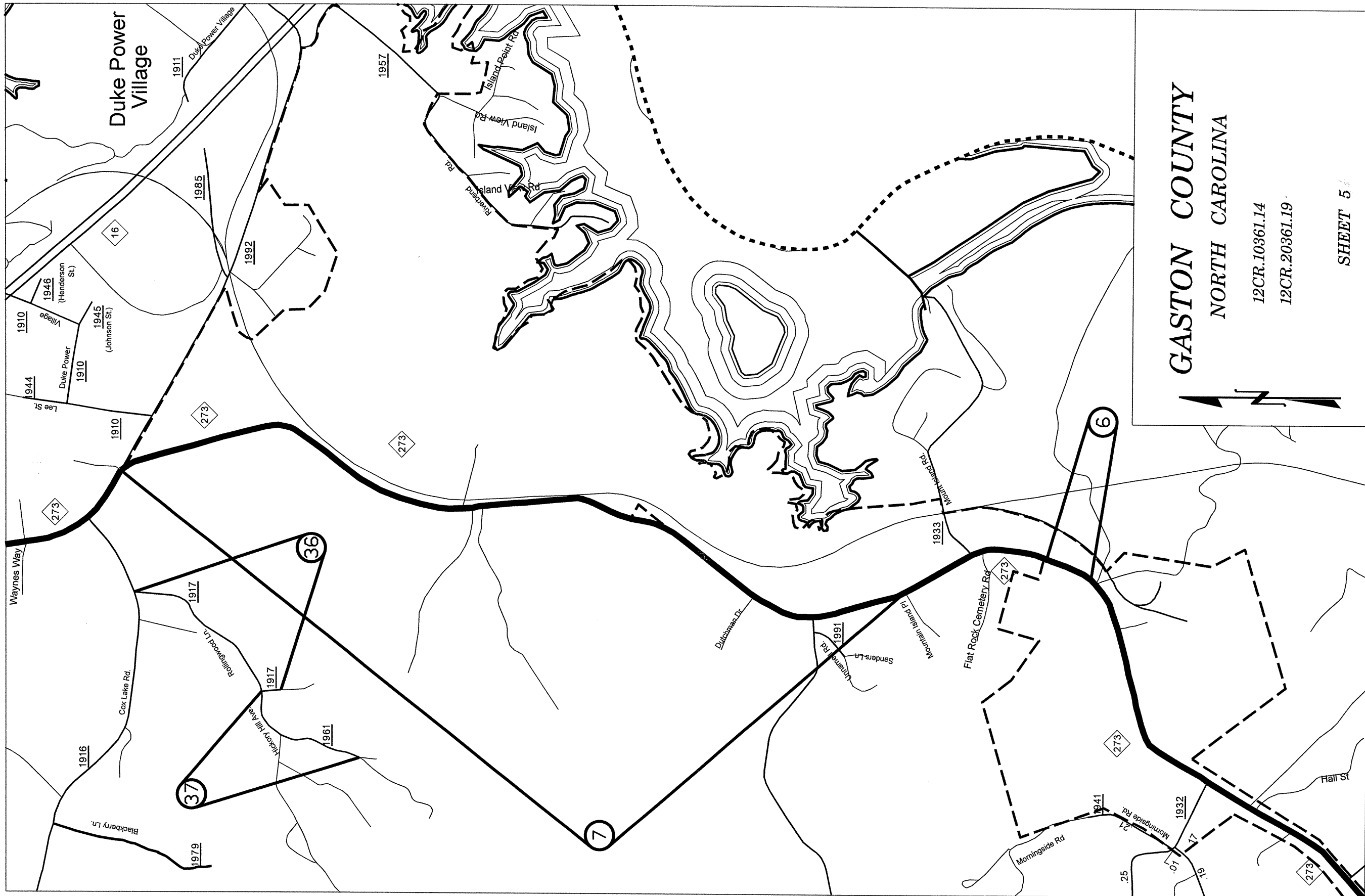





GASTON COUNTY
NORTH CAROLINA

12CR.10361.14
12CR.20361.19

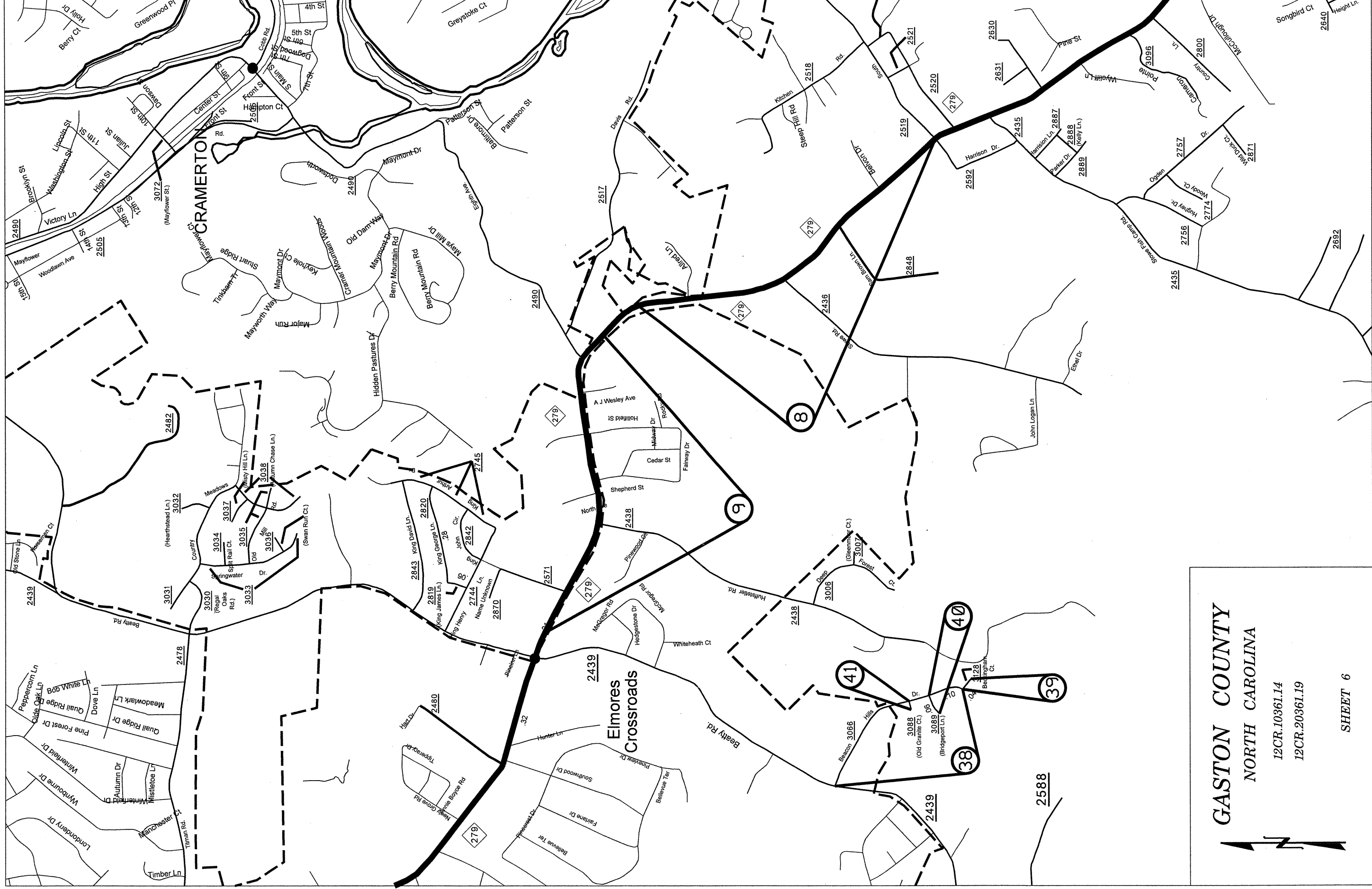
SHEET 5



GASTON COUNTY
 NORTH CAROLINA
 12CR.10361.14
 12CR.20361.19
SHEET 6

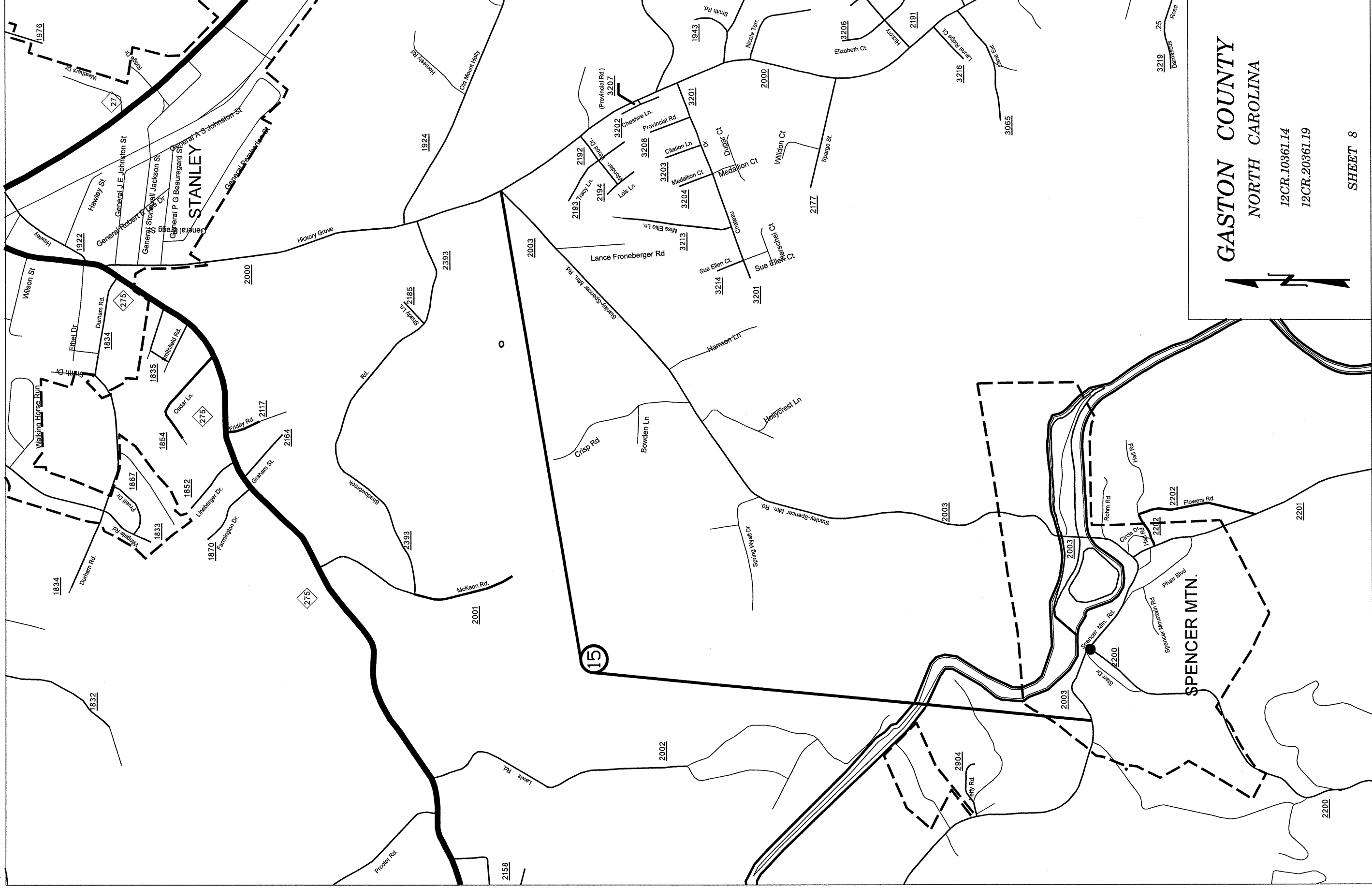

GASTON COUNTY
NORTH CAROLINA

12CR.10361.14
12CR.20361.19

SHEET 8



3219
0.25
Damascus
Road

15

STANLEY

SPENCER MTN.

1976

1922

1834

1834

1834

1834

1834

1834

1834

1922

1834

1834

1834

1834

1834

1834

1834

1834

1922

1834

1834

1834

1834

1834

1834

1834

1834

1922

1834

1834

1834

1834

1834

1834

1834

1834

1922

1834

1834

1834

1834

1834

1834

1834

1834

1922

1834

1834

1834

1834

1834

1834

1834

1834

1922

1834

1834

1834

1834

1834

1834

1834

1834

1922

1834

1834

1834

1834

1834

1834

1834

1834

1922

1834

1834

1834

1834

1834

1834

1834

1834

1922

1834

1834

1834

1834

1834

1834

1834

1834

1922

1834

1834

1834

1834

1834

1834

1834

1834

1922

1834

1834

1834

1834

1834

1834

1834

1834

1922

1834

1834

1834

1834

1834

1834

1834

1834

1922

1834

1834

1834

1834

1834

1834

1834

1834

1922

1834

1834

1834

1834

1834

1834

1834

1834

1922

1834

1834

1834

1834

1834

1834

1834

1834

1922

1834

1834

1834

1834

1834

1834

1834

1834

1922

1834

1834

1834

1834

1834

1834

1834

1834

1922

1834

1834

1834

1834

1834

1834

1834

1834

1922

1834

1834

1834

1834

1834

1834

1834

1834

1922

1834

1834

1834

1834

1834

1834

1834

1834

1922

1834

1834

1834

1834

1834

1834

1834

1834

1922

1834

1834

1834

1834

1834

1834

1834

1834

1922

1834

1834

1834

1834

1834

1834

1834

1834

1922

1834

1834

1834

1834

1834

1834

1834

1834

1922

1834

1834

1834

1834

1834

1834

1834

1834

1922

1834

1834

1834

1834

1834

1834

1834

1834

1922

1834

1834

1834

1834

1834

1834

1834

1834

1922

1834

1834

1834

1834

1834

1834

1834

1834

1922

1834

1834

1834

1834

1834

1834

1834

1834

1922

1834

1834

1834

1834

1834

1834

1834

1834

1922

1834

1834

1834

1834

1834

1834

1834

1834

1922

1834

1834

1834

1834

1834

1834

1834

1834

1922

1834

1834

1834

1834

1834

1834

1834

1834

1922

1834

1834

1834

1834

1834

1834

1834

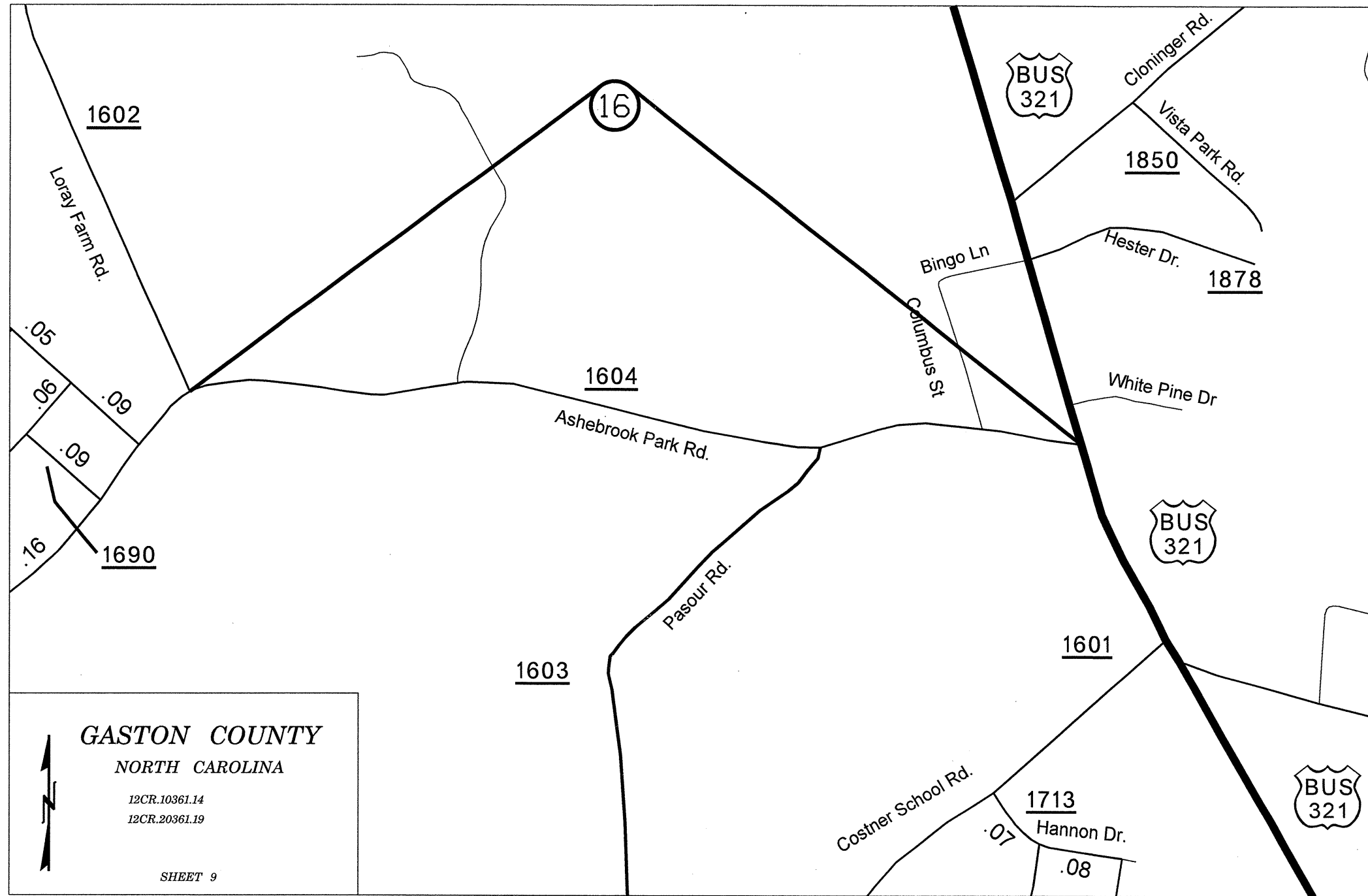

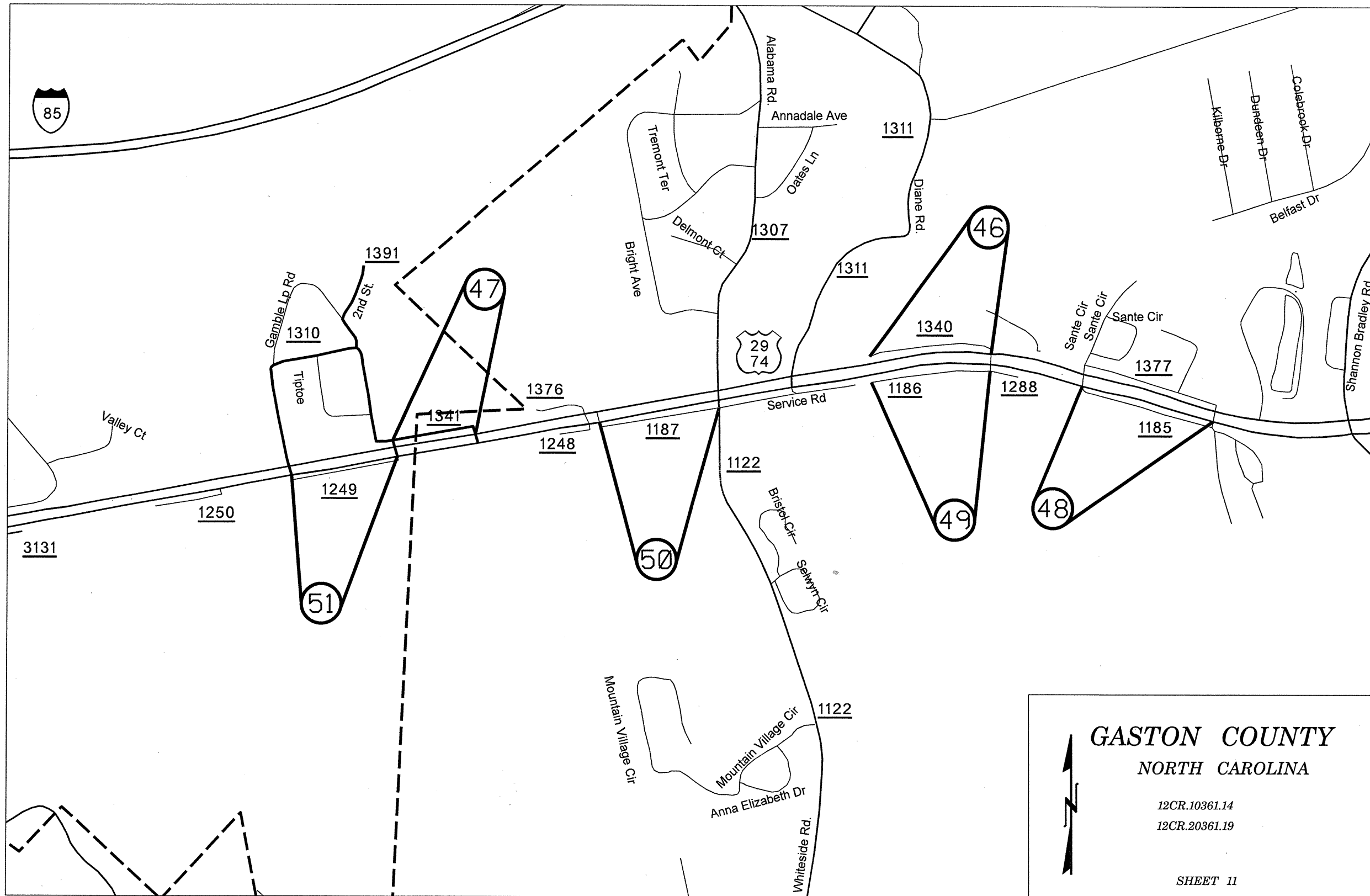

85

Alabama Rd

Annadale Ave

1311

1307

1311

1340

1186

1288

1377

1185

1122

1122

1187

1248

1376

1341

1249

1250

3131

1122

1122

46

47

48

49

50

51

Valley Ct

Gamble Ln Rd

2nd St

1391

1310

Tiptoe

Bright Ave

Delmont Ct

Oates Ln

Service Rd

Shannon Bradley Rd

Belfast Dr

Dundeen Dr

Colabrook Dr

Kilbarrne Dr

Sante Cir

Sante Cir

Sante Cir

Mountain Village Cir

Mountain Village Cir

Anna Elizabeth Dr

Whiteside Rd

Bristol Cir

Selwyn Cir

Tremont Ter

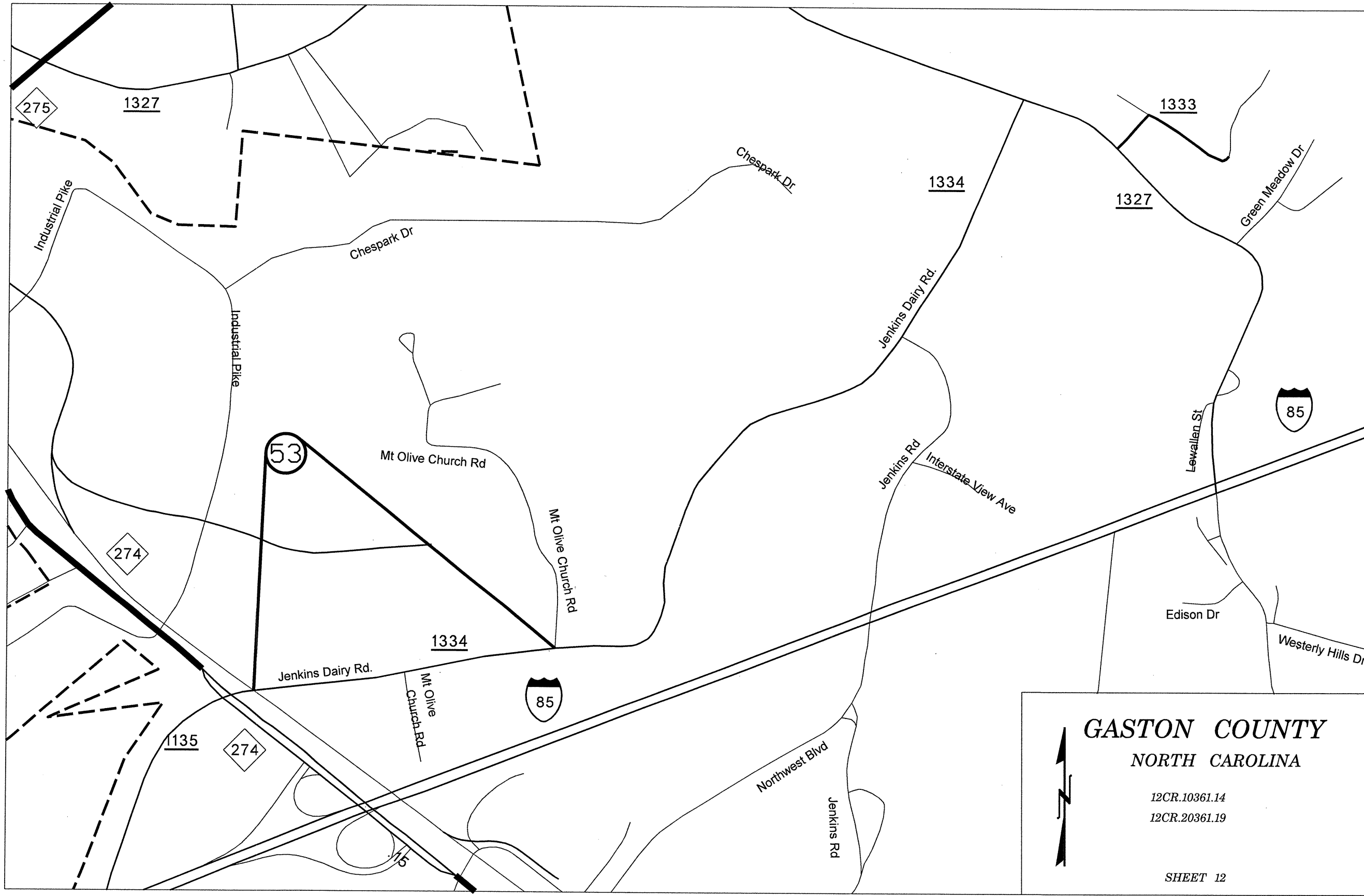

GASTON COUNTY
NORTH CAROLINA

12CR.10361.14
12CR.20361.19

SHEET 12

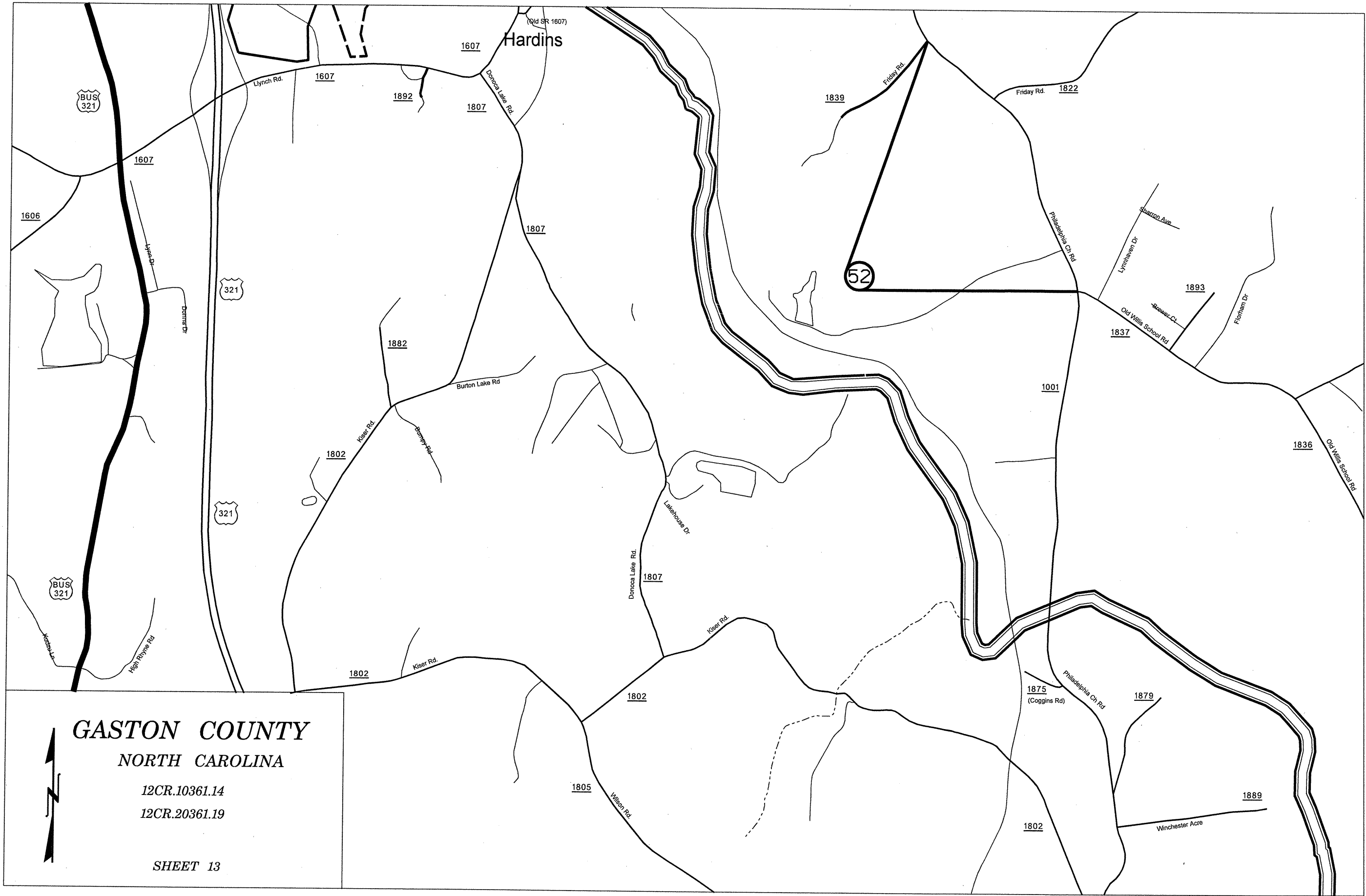

Hardins

BUS 321

321

BUS 321

321

GASTON COUNTY
NORTH CAROLINA

12CR.10361.14
12CR.20361.19

SHEET 13



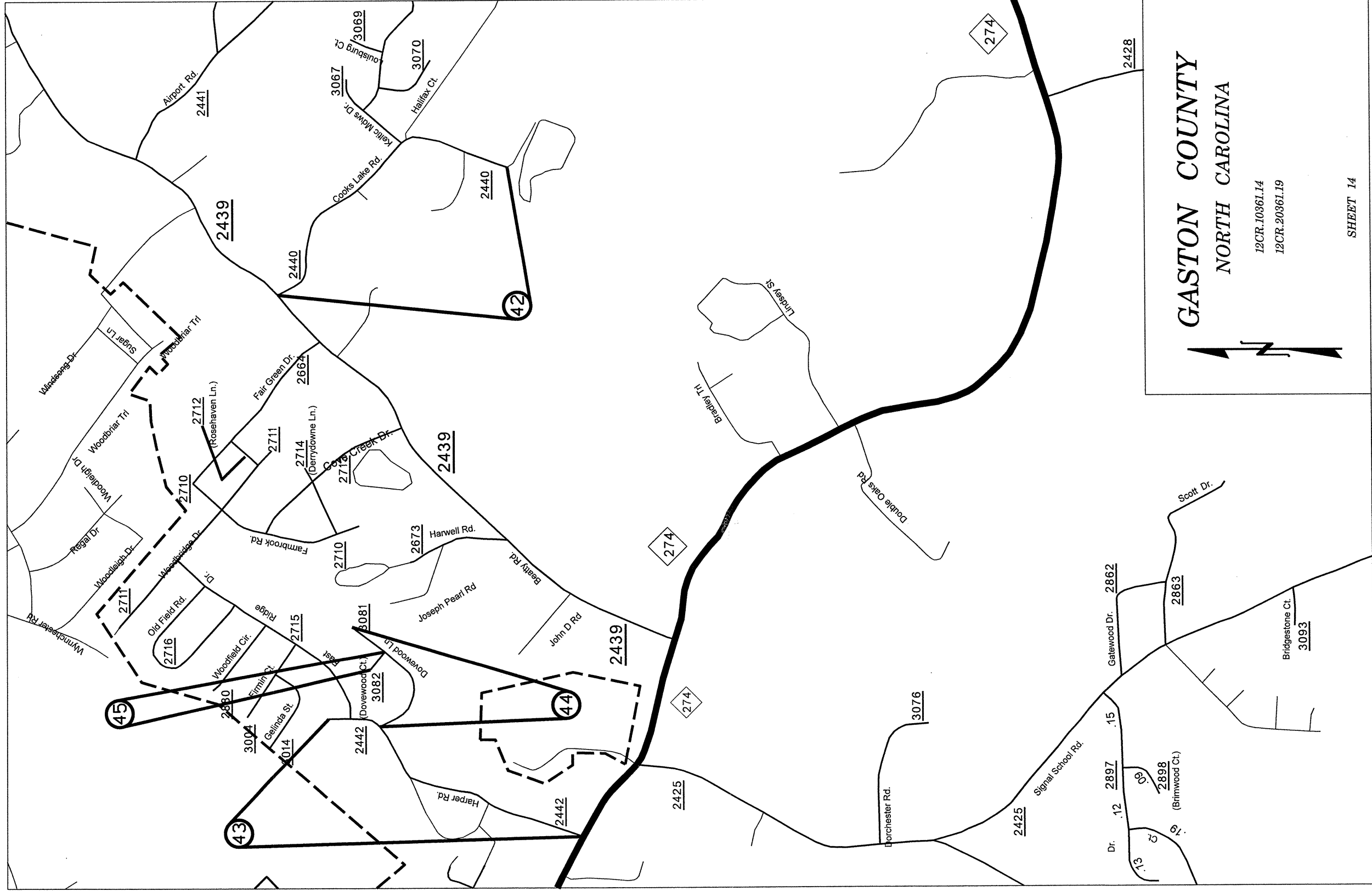

GASTON COUNTY
NORTH CAROLINA

12CR.10361.14
 12CR.20361.19



PAVEMENT SCHEDULE	
E1	PROP. APPROX. 5.5" ASPHALT CONCRETE BASE COURSE, TYPE B25.0B, AT AN AVERAGE RATE OF 627 LBS. PER SQ. YD.
C1	PROP. APPROX. 1½" ASPHALT CONCRETE SURFACE COURSE, TYPE S9.5B, AT AN AVERAGE RATE OF 168 LBS. PER SQ. YD.
C2	PROP. APPROX. 1½" ASPHALT CONCRETE SURFACE COURSE, TYPE S9.5C, AT AN AVERAGE RATE OF 168 LBS. PER SQ. YD.
Y	SHOULDER RECONSTRUCTION
V1	MILL ASPHALT PAVEMENT APPROX. 1½" AS DIRECTED BY ENGINEER
V2	MILL ASPHALT PAVEMENT APPROX. 1½" - 3" AS DIRECTED BY ENGINEER
V3	MILL ASPHALT PAVEMENT APPROX. 0" TO 1½" (LANE WIDTH FROM C & G)
V4	MILL ASPHALT PAVEMENT APPROX. 0" TO 3" (LANE WIDTH FROM C & G)

NOTE: PAVEMENT EDGE SLOPES ARE 1:1 UNLESS SHOWN OTHERWISE.
MILL BRIDGE APPROACHES 100' TO PROVIDE A SMOOTH TRANSITION AS DIRECTED.
MILL INTO GUTTER LINE WHERE SHOWN AND AS DIRECTED.
MAINTAIN PROPER CROWN FOR DRAINAGE OF THE ROAD SURFACE.

PROJ. REFERENCE NO.	SHEET NO.	TOTAL SHEETS
GASTON COUNTY 2012-2013	15	
STATE PROJ. NO.	F. A. PROJ. NO.	DESCRIPTION
12CR.10361.14		
12CR.20361.19		

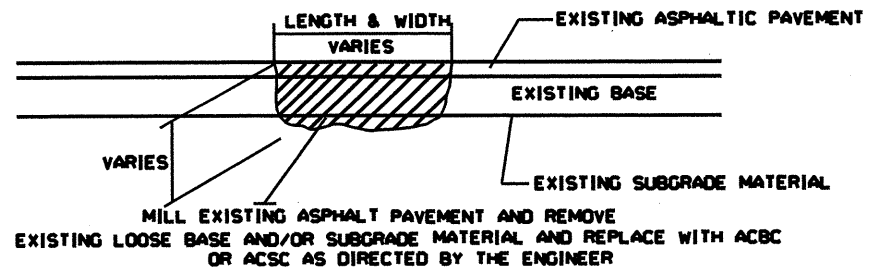

MILL EXISTING ASPHALT PAVEMENT AND REMOVE EXISTING LOOSE BASE AND/OR SUBGRADE MATERIAL AND REPLACE WITH ACBC OR ACSC AS DIRECTED BY THE ENGINEER

PATCHING EXISTING PAVEMENT

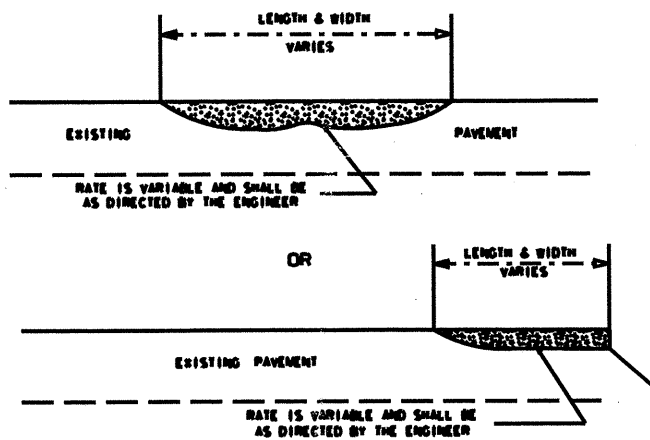

ASPHALT CONCRETE SURFACE COURSE
TYPE S9.5B & C (LEVELING COURSE)

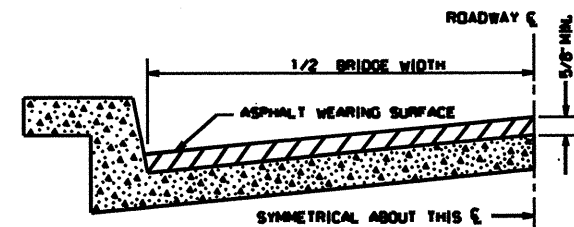

BRIDGE HALF TYPICAL SECTION

FOR BRIDGES WITH FLOOR DRAINS, CARE SHALL BE EXERCISED IN PLACING THE WEARING SURFACE AROUND FLOOR DRAINS SO AS NOT TO HINDER EFFECTIVE DRAINAGE. ALL DRAINS SHALL BE LEFT OPEN.

THE PROPOSED WEARING SURFACE SHALL VARY IN THICKNESS AS NECESSARY TO PROVIDE A SMOOTH RIDING SURFACE. A THICKNESS OF NOT LESS THAN 5/8" SHALL BE PROVIDED. THE MAXIMUM THICKNESS SHALL PREFERABLY BE 1-1/2" UNLESS IT IS IMPRACTICAL TO PROVIDE A SMOOTH RIDING SURFACE OTHERWISE.

NOTES

ALL UNPAVED S.R. ROADS TO BE SURFACED 50' FROM EDGE OF PAVEMENT OF MAIN PROJECT.
ALL PAVED S.R. ROADS TO BE RESURFACED TO THE ENDS OF THE ROAD, OR AS DIRECTED BY THE ENGINEER.
EDGES, PAVEMENT WIDENING, INTERSECTIONS AND BRIDGE FLARES ARE INCLUDED IN THE TABLE OF QUANTITIES.
SHOULDERS AND DITCHES ARE TO BE CONSTRUCTED BY OTHERS UNLESS OTHERWISE NOTED.
BRIDGES TO BE RESURFACED AT LOCATIONS AND TO DEPTH AS DIRECTED BY THE ENGINEER.



BRIDGE PROFILE



RAILROAD PROFILE

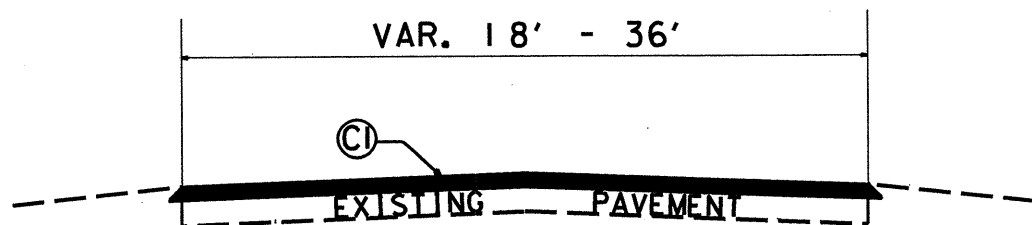

TYPICAL SECTION NO. 1
(MAPS 12, 17-23, 25, 28-41, 43-51, 54, 56-59)

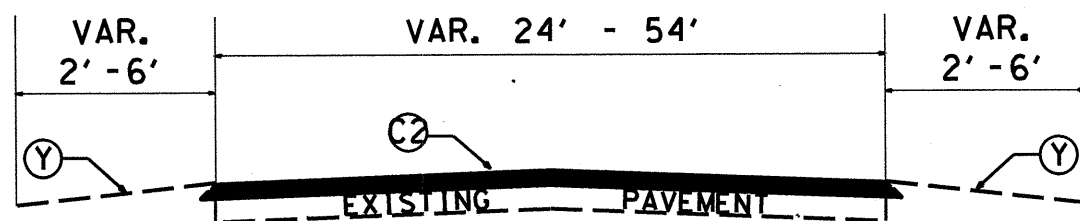

TYPICAL SECTION NO. 2
(MAP 2, 6, 7, 8, 9, 11)

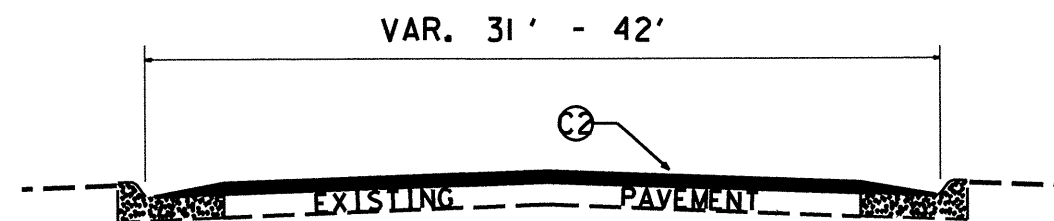

TYPICAL SECTION NO. 3
(MAP 1)

PROJ. REFERENCE NO.	SHEET NO.	TOTAL SHEETS
GASTON COUNTY 2012-2013	16	
STATE PROJ. NO.	F.A. PROJ. NO.	DESCRIPTION
12CR.10361.14		
12CR.20361.19		

PAVEMENT SCHEDULE	
E1	PROP. APPROX. 5.5" ASPHALT CONCRETE BASE COURSE, TYPE B25.0B, AT AN AVERAGE RATE OF 627 LBS. PER SQ. YD.
C1	PROP. APPROX. 1½" ASPHALT CONCRETE SURFACE COURSE, TYPE S9.5B, AT AN AVERAGE RATE OF 168 LBS. PER SQ. YD.
C2	PROP. APPROX. 1½" ASPHALT CONCRETE SURFACE COURSE, TYPE S9.5C, AT AN AVERAGE RATE OF 168 LBS. PER SQ. YD.
Y	SHOULDER RECONSTRUCTION
V1	MILL ASPHALT PAVEMENT APPROX. 1½" AS DIRECTED BY ENGINEER
V2	MILL ASPHALT PAVEMENT APPROX. 1½" - 3" AS DIRECTED BY ENGINEER
V3	MILL ASPHALT PAVEMENT APPROX. 1½" TAPERED TO 0" (LANE WIDTH FROM C & G)
V4	MILL ASPHALT PAVEMENT APPROX. 1½" - 3" TAPERED TO 0" (LANE WIDTH FROM C & G)

NOTE: PAVEMENT EDGE SLOPES ARE 1:1 UNLESS SHOWN OTHERWISE.
MILL BRIDGE APPROACHES 100' TO PROVIDE A SMOOTH TRANSITION AS DIRECTED.
MILL INTO GUTTER LINE WHERE SHOWN AND AS DIRECTED.
MAINTAIN PROPER CROWN FOR DRAINAGE OF THE ROAD SURFACE.

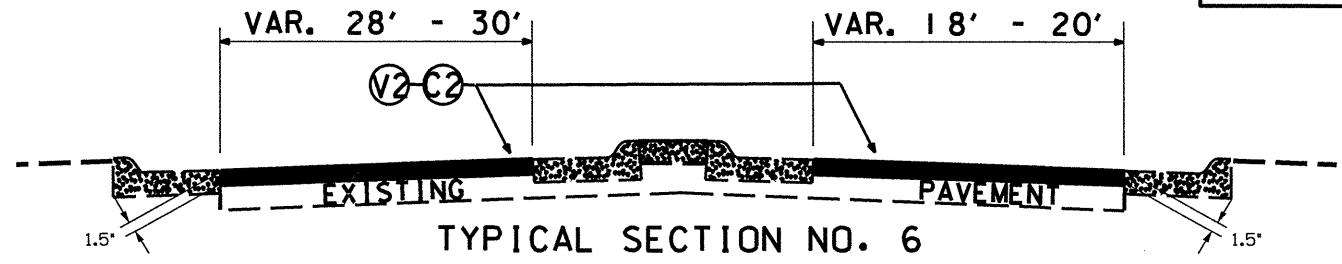

(MAP 1)

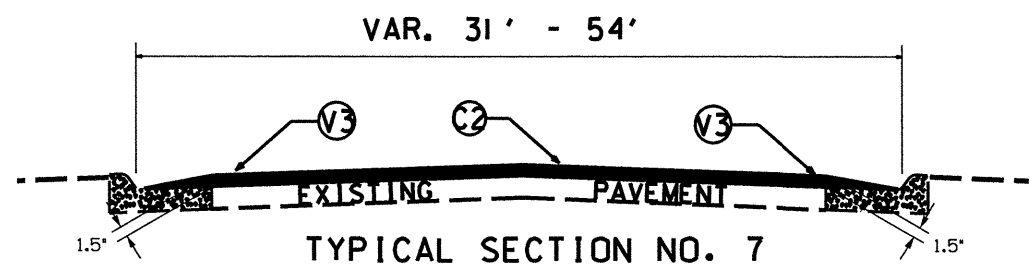

(MAP 2, 10, 11)

(OUTSIDE LANE WIDTH IS APPROXIMATELY 12' FOR TAPERED LANE MILLING)

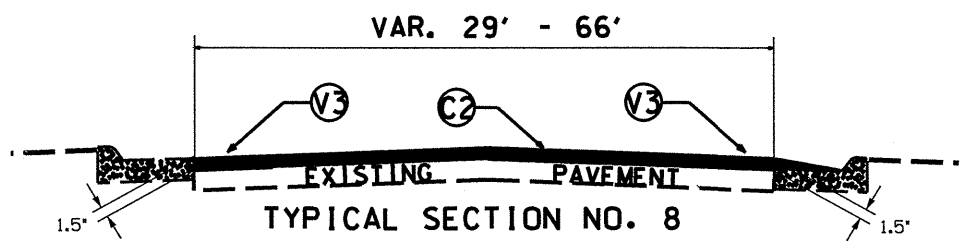

(MAP 2, 10)

(OUTSIDE LANE WIDTH IS APPROXIMATELY 11' FOR TAPERED LANE MILLING)

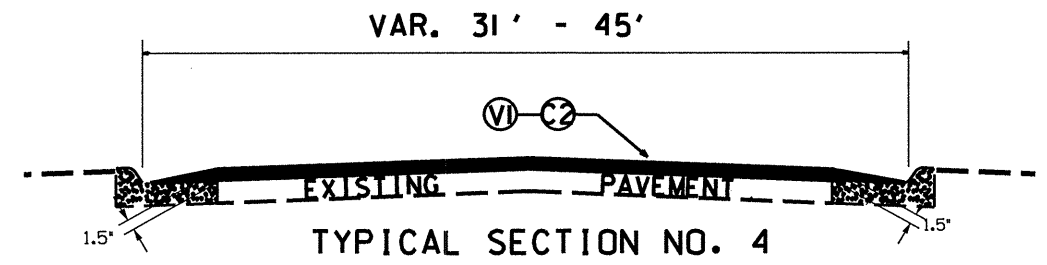

(MAP 1, 4, 11)

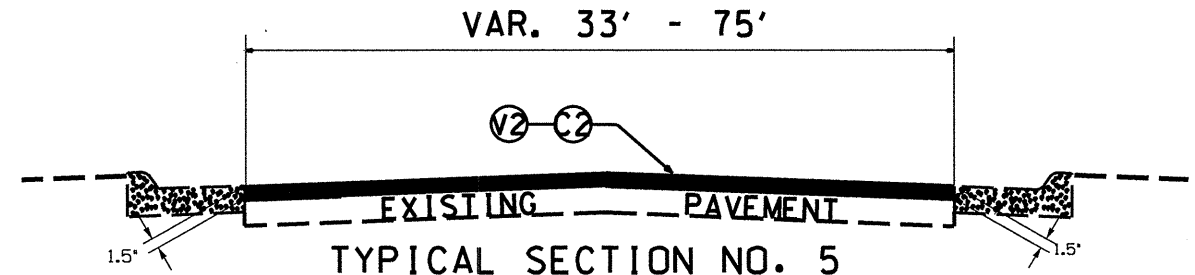

(MAP 1)

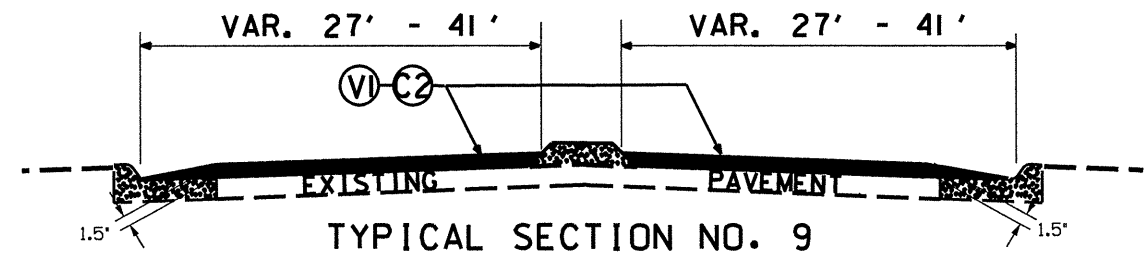

(MAP 2)

PROJ. REFERENCE NO.	SHEET NO.	TOTAL SHEETS
GASTON COUNTY 2012-2013	17	
STATE PROJ. NO.	F.A. PROJ. NO.	DESCRIPTION
12CR.10361.14		
12CR.20361.19		

PAVEMENT SCHEDULE	
E1	PROP. APPROX. 5.5" ASPHALT CONCRETE BASE COURSE, TYPE B25.0B, AT AN AVERAGE RATE OF 627 LBS. PER SQ. YD.
C1	PROP. APPROX. 1½" ASPHALT CONCRETE SURFACE COURSE, TYPE S9.5B, AT AN AVERAGE RATE OF 168 LBS. PER SQ. YD.
C2	PROP. APPROX. 1½" ASPHALT CONCRETE SURFACE COURSE, TYPE S9.5C, AT AN AVERAGE RATE OF 168 LBS. PER SQ. YD.
Y	SHOULDER RECONSTRUCTION
V1	MILL ASPHALT PAVEMENT APPROX. 1½" AS DIRECTED BY ENGINEER
V2	MILL ASPHALT PAVEMENT APPROX. 1½" - 3" AS DIRECTED BY ENGINEER
V3	MILL ASPHALT PAVEMENT APPROX. 1½" TAPERED TO 0" (LANE WIDTH FROM C & G)
V4	MILL ASPHALT PAVEMENT APPROX. 1½" - 3" TAPERED TO 0" (LANE WIDTH FROM C & G)

NOTE: PAVEMENT EDGE SLOPES ARE 1:1 UNLESS SHOWN OTHERWISE.
MILL BRIDGE APPROACHES 100' TO PROVIDE A SMOOTH TRANSITION AS DIRECTED.
MILL INTO GUTTER LINE WHERE SHOWN AND AS DIRECTED.
MAINTAIN PROPER CROWN FOR DRAINAGE OF THE ROAD SURFACE.

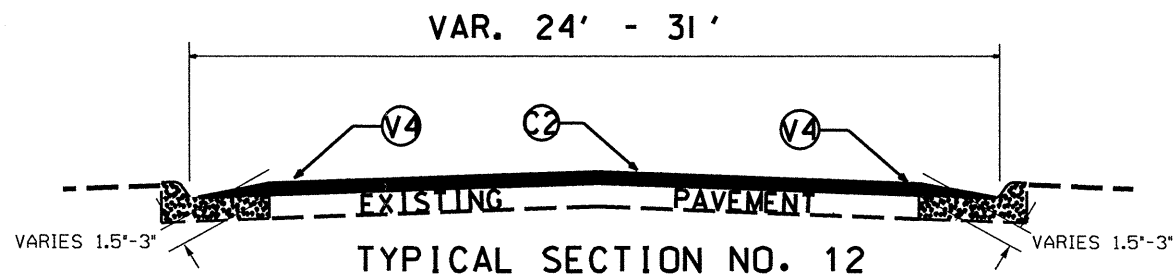

TYPICAL SECTION NO. 12

(MAP 3)

(OUTSIDE LANE WIDTH IS APPROXIMATELY 12' FOR TAPERED LANE MILLING)

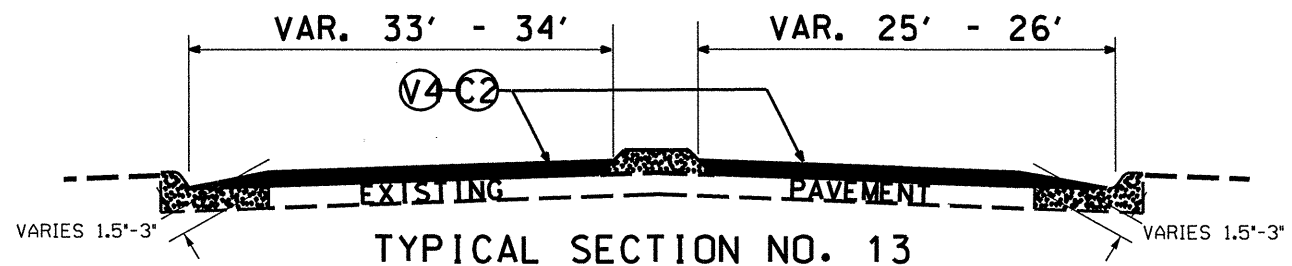

TYPICAL SECTION NO. 13

(MAP 5)

(OUTSIDE LANE WIDTH IS APPROXIMATELY 12' FOR TAPERED LANE MILLING)

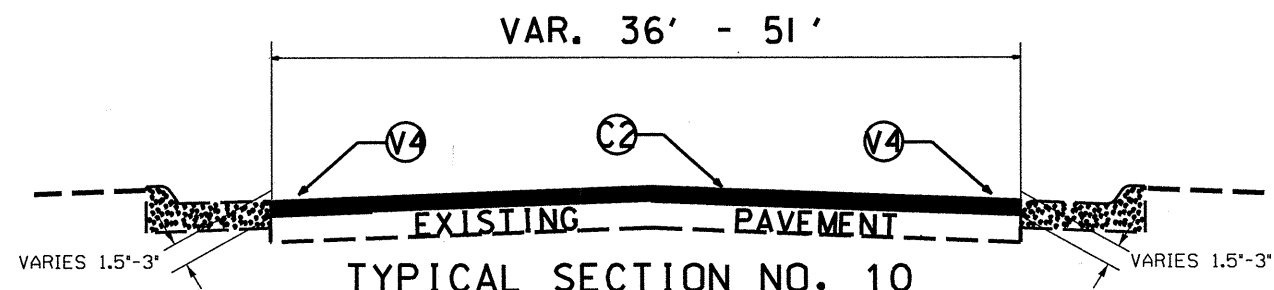

TYPICAL SECTION NO. 10

(MAP 3, 5)

(OUTSIDE LANE WIDTH IS APPROXIMATELY 12' FOR TAPERED LANE MILLING)

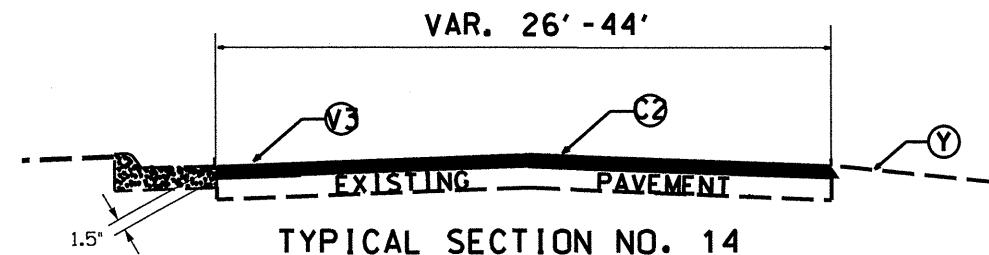

TYPICAL SECTION NO. 14

(MAP 6, 11)

(OUTSIDE LANE WIDTH IS APPROXIMATELY 11' FOR TAPERED LANE MILLING)

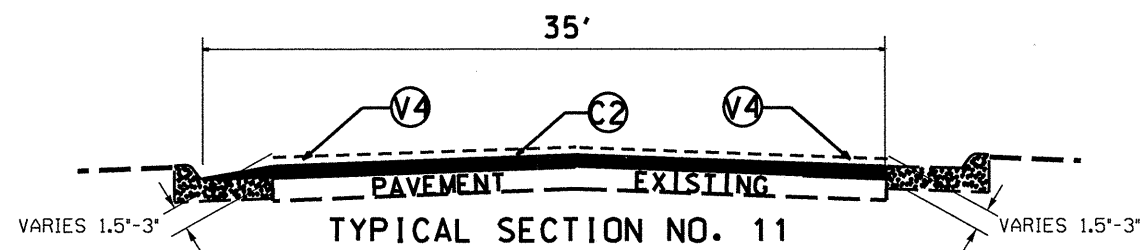

TYPICAL SECTION NO. 11

(MAP 3)

(OUTSIDE LANE WIDTH IS APPROXIMATELY 12' FOR TAPERED LANE MILLING)

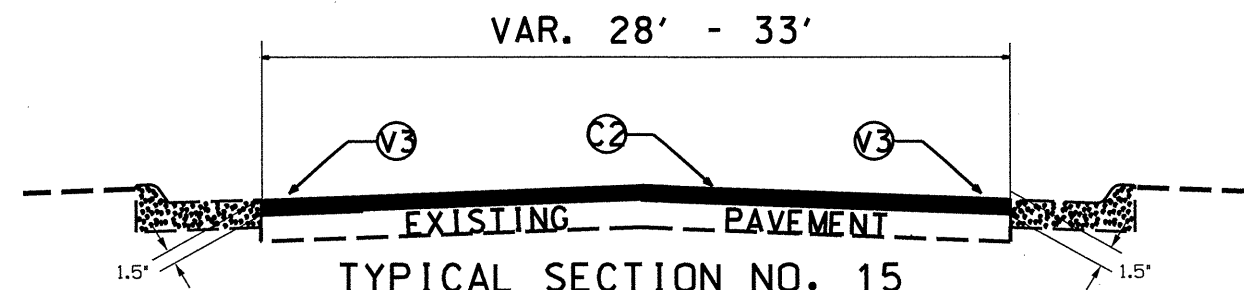

TYPICAL SECTION NO. 15

(MAP 10)

(OUTSIDE LANE WIDTH IS APPROXIMATELY 11' FOR TAPERED LANE MILLING)

PROJ. REFERENCE NO.	SHEET NO.	TOTAL SHEETS
GASTON COUNTY 2012-2013	18	
STATE PROJ. NO.	F. A. PROJ. NO.	DESCRIPTION
12CR.10361.14		
12CR.20361.19		

PAVEMENT SCHEDULE	
E1	PROP. APPROX. 5.5" ASPHALT CONCRETE BASE COURSE, TYPE B25.0B, AT AN AVERAGE RATE OF 627 LBS. PER SQ. YD.
C1	PROP. APPROX. 1½" ASPHALT CONCRETE SURFACE COURSE, TYPE S9.5B, AT AN AVERAGE RATE OF 168 LBS. PER SQ. YD.
C2	PROP. APPROX. 1½" ASPHALT CONCRETE SURFACE COURSE, TYPE S9.5C, AT AN AVERAGE RATE OF 168 LBS. PER SQ. YD.
Y	SHOULDER RECONSTRUCTION
V1	MILL ASPHALT PAVEMENT APPROX. 1½" AS DIRECTED BY ENGINEER
V2	MILL ASPHALT PAVEMENT APPROX. 1½" - 3" AS DIRECTED BY ENGINEER
V3	MILL ASPHALT PAVEMENT APPROX. 1½" TAPERED TO 0" (LANE WIDTH FROM C & G)
V4	MILL ASPHALT PAVEMENT APPROX. 1½" - 3" TAPERED TO 0" (LANE WIDTH FROM C & G)

NOTE: PAVEMENT EDGE SLOPES ARE 1:1 UNLESS SHOWN OTHERWISE.

MILL BRIDGE APPROACHES 100' TO PROVIDE A SMOOTH TRANSITION AS DIRECTED.

MILL INTO GUTTER LINE WHERE SHOWN AND AS DIRECTED.

MAINTAIN PROPER CROWN FOR DRAINAGE OF THE ROAD SURFACE.

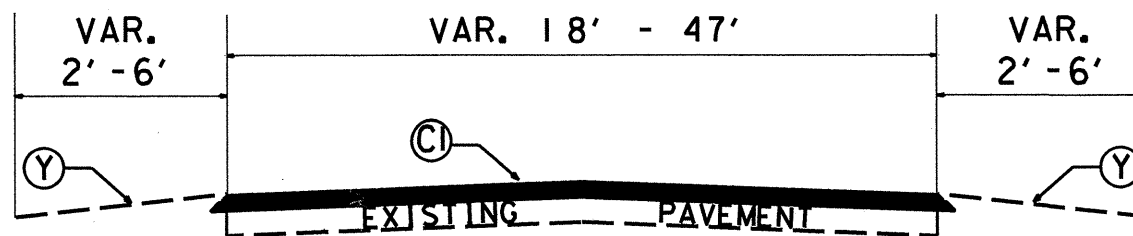

TYPICAL SECTION NO. 17

(MAP 15, 24, 26, 27, 42, 52, 53, 55)

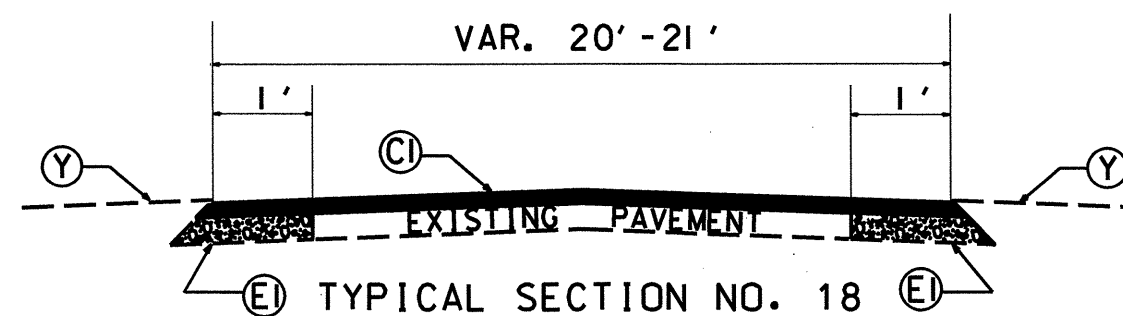

TYPICAL SECTION NO. 18

(MAP 16, 18)

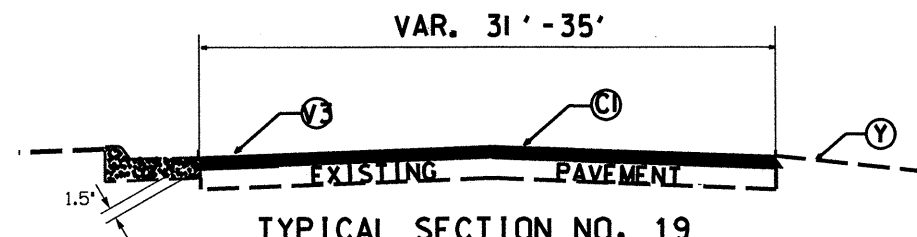

TYPICAL SECTION NO. 19

(MAP 52)

(OUTSIDE LANE WIDTH IS APPROXIMATELY 11' FOR TAPERED LANE MILLING)

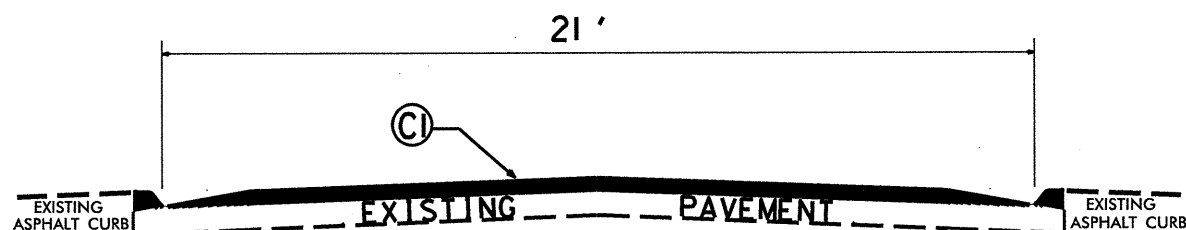

TYPICAL SECTION NO. 16

(MAPS 13, 14)

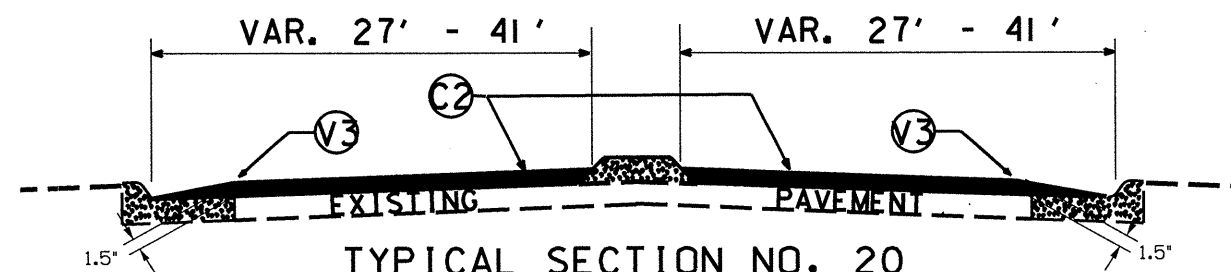

TYPICAL SECTION NO. 20

(MAP 9)

(OUTSIDE LANE WIDTH IS APPROXIMATELY 13' FOR TAPERED LANE MILLING)

PROJECT NO.	SHEET NO.	TOTAL NO.
12CR.10361.14, 12CR.20361.19	19	

SUMMARY OF QUANTITIES

PROJECT NO	COUNTY	MAP NO	ROUTE	DESCRIPTION	TYP NO	FINAL SURFACE TESTING REQUIRED	LENGTH MI	WIDTH FT	AGGREGATE SHOULDER BORROW TON	INCIDENTAL STONE BASE TONS	SHOULDER RECONSTRUCTION SMI	1-1/2" MILLING SY	1.5" TO 3" MILLING SY	0" TO 1-1/2" MILLING (LANE WIDTH FROM C&G) SY	INCIDENTAL MILLING SY	0" TO 3" MILLING (LANE WIDTH FROM C&G) SY	BASE COURSE, B25.0B TONS	SURFACE COURSE, S9.5B TONS	LEVELING COURSE, S9.5B TONS	SURFACE COURSE, S9.5C TONS	LEVELING COURSE, S9.5C TONS	ASPHALT BINDER FOR PLANT MIX TONS	PATCHING EXISTING PAVEMENT TONS	ADJ. OF CATCH BASIN EA	ADJ. OF DROP INLET EA	ADJ. OF MANHOLES EA	ADJ. OF METER OR VALVE BOX EA	PORTABLE LIGHTING LS					
12CR.10361.14	Gaston	1	NC 150 (CHURCH ST)	SR 1651 TO 450' W OF NC 279	3	NO	0.48	VAR. 31-42				2,960	18,540							2,805	206	179	766	7	4	25	11						
					4		0.14	36																									
					5		0.78	VAR. 33-75																									
				2	NC 279 (DALLAS-CHERRYVILLE HWY)	US321 BRIDGE TO CHG IN PVMT	6	NO	0.05	VAR. 46-50																							
		7	0.31				VAR. 47-54		41	0.62	2,793		2,816	70					1,849	122	117	187		3									
		8	0.15				VAR. 53-54																										
				3	US321 S (CHESTER ST)	NC 7 TO SR 2466	9	NO	0.07	VAR. 36-37																							
		10	0.11				35						80	11,200					1,355	70	85	366		1	16	5	1						
				4	US321 N (YORK ST)	3RD STREET TO 2ND STREET	11	NO	0.12	VAR. 24-31																							
							12		0.61	VAR. 41-45							3,027																
				5	NC 273 (PARK ST)	US29/74 TO NC 7	13	NO	0.08	VAR. 58-60																							
		10	0.52				VAR. 49-51																										
		6	NC 273 (MOUNTAIN ISLAND HWY)	PINEWOOD ELEMENTARY SCH (CHG PVMT TO CHG PVMT)	14	NO	0.15	37	20	5	0.29			1,000	70																		
					2		0.07	VAR. 24-37																									
		7	NC 273 (MOUNTAIN ISLAND HWY)	CHG PVMT (MOUNTAIN ISL PLACE) TO SR 1992	2	NO	1.94	VAR. 25-27	256	100	3.88				70																		
					2		0.15	VAR. 25-27																									
		8	NC 279 (NEW HOPE RD)	SR 2519 TO 0.44MI S OF SR 2490	14	NO	0.82	VAR. 31-38	109	96	1.64				80																		
					2		0.73	VAR. 32-51																									
		9	NC 279 (NEW HOPE RD)	0.17MI S OF SR 2490 TO 0.11MI S OF SR 2439	2	NO	0.23	44	112	60	1.69			3,510	100																		
					20		0.06	VAR. 28-33																									
		10	NC 7 (CATAWBA ST)	N. MAIN ST. TO THIRD ST.	7	NO	0.42	VAR. 31-35						6,583	734																		
					8		0.03	29																									
		11	NC 7 (CATAWBA ST)	FOURTH ST. TO US 29/74	7	NO	0.12	VAR. 39-40																									
					4		0.52	31	53	15	0.79	9,457																					
					14		0.17	26																									
					2		0.31	VAR. 25-26																									
TOTAL FOR PROJ NO. 12CR.10361.14							9.16		591	276	8.91	18,237	18,540	16,555	1,468	19,700				17,386	962	1,085	3,754	19	8	70	34	1					

PROJECT NO.	SHEET NO.	TOTAL NO.
12CR.10361.14, 12CR.20361.19	20	

SUMMARY OF QUANTITIES

PROJECT NO	COUNTY	MAP NO	ROUTE	DESCRIPTION	TYP NO	FINAL SURFACE TESTING REQUIRED	LENGTH MI	WIDTH FT	AGGREGATE SHOULDER BORROW TON	INCIDENTAL STONE BASE TONS	SHOULDER RECONSTRUCTION SMI	1-1/2" MILLING SY	1.5" TO 3" MILLING SY	0" TO 1-1/2" MILLING (LANE WIDTH FROM C&G) SY	INCIDENTAL MILLING SY	0" TO 3" MILLING (LANE WIDTH FROM C&G) SY	BASE COURSE, B25.0B TONS	SURFACE COURSE, S9.5B TONS	LEVELING COURSE, S9.5B TONS	SURFACE COURSE, S9.5C TONS	LEVELING COURSE, S9.5C TONS	ASPHALT BINDER FOR PLANT MIX TONS	PATCHING EXISTING PAVEMENT TONS	ADJ. OF CATCH BASIN EA	ADJ. OF DROP INLET EA	ADJ. OF MANHOLES EA	ADJ. OF METER OR VALVE BOX EA	PORTABLE LIGHTING LS
12CR.20361.19	Gaston	12	SR 1116 (MOUNTAIN CREST RD)	CLEVELAND CL TO CLEVELAND CL	1	NO	0.67	VAR. 18-19		80								695	92			48	143					
		13	SR 3042 (HUNTING RIDGE DR)	SR 2532 TO SR 3043	16	NO	0.27	21		6								309	15			20	62					
		14	SR 3043 (FALLINGBROOK CT)	CULDESAC TO CULDESAC	16	NO	0.14	21		3								160	8			10	32					
		15	SR 2003 (STANLEY-SPENCER MTN RD)	SR 2000 TO 0.21 MILE NW OF SR 2200	17	NO	2.84	VAR. 20-47	375	150	5.68				908			3,452	315			228	877					
		16	SR 1604 (ASHEBROOK PARK RD)	SR 1602 TO US321B	18	NO	0.88	VAR. 20-21	116	95	1.76						398	1,008	182			90	245					
		17	SR 1801 (EASON RD)	SR 1001 TO DE	1	NO	0.42	VAR. 20-26		40								527	35			34	56					
		18	SR 1390 (FRIDAY PARK RD)	SR 1336 TO DE	1	NO	0.04	VAR. 20-36		40							140	355	64			32	79					
		19	SR 2276 (BRIARWOOD DR)	SR 2275 TO 370 FT S OF SR 2275	1	NO	0.16	VAR. 19-20	21	35	0.32							170	20			12	51				4	4
		20	SR 2276 (BRIARWOOD DR)	SR 2275 TO SR 2395	1	NO	0.11	VAR. 20-21		12								121	7			8	31				2	
		21	SR 2397 (WOODDALE CT)	SR 2395 TO CULDESAC	1	NO	0.06	20		6								65	5			4	23				1	
		22	SR 2395 (WOODDALE DR)	SR 2276 TO DE	1	NO	0.14	20		16								153	10			10	33				1	
		23	SR 2396 (CLOVERDALE DR)	SR 2395 TO SR 2275	1	NO	0.1	VAR. 20-21										112	6			7	25				1	
		24	SR 2269 (EAST MAIN ST)	NC 279 TO 422 FT W OF NC 279	17	NO	0.66	VAR. 20-21	88	55	1.32				60			756	160			56	132					
		25	SR 2270 (STILLWELL ST)	SR 2269 TO DE	1	NO	0.14	VAR. 19-20		18								149	14			10	30					
		26	SR 2094 (BROWN DR)	NC 273 TO SR 2070	17	NO	0.11	VAR. 20-26	15	8	0.22							129	7			8	22					
		27	SR 2070 (BROWNTOWN RD)	SR 2111 TO US 29/74	17	NO	0.41	VAR. 18-21	45	40	0.82							470	20			29	91					
		28	SR 2491 (VALE ST/8TH AVE EXT.)	SR 2209 TO US 29/74	1	NO	0.79	VAR. 16-20		35								785	123			55	134					
		29	SR 2593 (FORD ST)	US 29/74 TO SR 2491	1	NO	0.19	VAR. 16-17		10								176	9			11	22					
		30	SR 2496 (LOWELL AVE)	SR 2491 TO US 29/74	1	NO	0.2	VAR. 18-19		15								207	11			13	23					
		31	SR 2494 (HIGHLAND ST)	SR 2496 TO US 29/74	1	NO	0.42	VAR. 18-19		25								435	25			28	89					
		32	SR 2498 (MCALLISTER RD)	SR 2494 TO US 29/74	1	NO	0.06	VAR. 18-19		5								62	3			4	7					
		33	SR 2497 (ABBEY ST)	SR 2494 TO US 29/74	1	NO	0.06	VAR. 18-19		8								62	4			4	8					
		34	SR 2493 (CHURCH ST)	SR 2496 TO US 29/74	1	NO	0.3	VAR. 17-19		15								303	16			19	55					
		35	SR 2495 (CHESTER ST)	SR 2496 TO SR 2493	1	NO	0.06	VAR. 14-16		2								52	3			3	6					
		36	SR 1917 (ROLLINGWOOD LN)	SR 1916 TO DE	1	NO	0.55	20		30								600	72			41	162					
		37	SR 1961 (HICKORY HILL AVE)	SR 1917 TO CULDESAC	1	NO	0.36	20		15								393	119			31	67					
		38	SR 3066 (BEACONHILL)	SR 2439 TO CULDESAC	1	NO	0.59	20		9								644	163			49	97					
		39	SR 3128 (BECKINGHAM CT)	SR 3066 TO CULDESAC	1	NO	0.06	20		3								65	3			4	8				2	1
		40	SR 3089 (BRIDGEPORT LN)	SR 3066 TO CULDESAC	1	NO	0.08	20		3								87	11			6	25				2	
		41	SR 3088 (OLD GRANITE CT)	SR 3066 TO CULDESAC	1	NO	0.04	20		3								44	2			3	5				1	
		42	SR 2440 (COOKS LAKE RD)	SR 2439 TO DE	17	NO	0.64	20	85	70	1.28							698	50			45	119					
		43	SR 2442 (HARPER RD)	NC 274 TO CULDESAC	1	NO	0.58	20		70								633	51			41	171					
		44	SR 3081 (DOVEWOOD LN)	SR 2442 TO DE	1	NO	0.29	20		20								316	32			21	79					
		45	SR 3082 (DOVEWIND CT)	SR 3081 TO CULDESAC	1	NO	0.07	20		5								76	4			5	10					
		46	SR 1340 (SERVICE RD)	US 29/74 TO DE	1	NO	0.2	VAR. 16-18		50								186	10			12	38					
		47	SR 1341 (SERVICE RD)	US 29/74 TO SR 1310	1	NO	0.16	VAR. 16-20		23								175	14			11	20					
		48	SR 1185 (SERVICE RD)	US 29/74 TO US 29/74	1	NO	0.2	VAR. 16-18		15								186	9			12	35					
		49	SR 1186 (SERVICE RD)	US 29/74 TO END PVMT	1	NO	0.19	VAR. 16-18		45								176	17			12	20					
		50	SR 1187 (VICTORY LN)	US 29/74 TO SR 1122	1	NO	0.19	VAR. 18-19		28								192	12			12	25					
		51	SR 1249 (SERVICE RD)	US 29/74 TO US 29/74	1	NO	0.18	20		35								167	13			11	20					
		52	SR 1837 (OLD WILLIS SCH RD) TO SR 1819	SR 1837 (OLD WILLIS SCH RD) TO SR 1819	17	NO	1.72	VAR. 23-32		85	3.60	1,127			335			575	35			37	97					
		53	SR 1001 (PHILADELPHIA CH RD)	NC 275/274 TO MT OLIVE CH RD	19	NO	0.16	VAR. 31-35	360	85	3.60	1,127						575	35			37	97					
		54	SR 1334 (JENKINS DAIRY RD)	SR 2265 TO DE	17	NO	0.44	VAR. 23-24	88	40	0.88							572	34			34	97					
		55	SR 2266 (FAIRLANE DR)	SR 2265 TO DE	1	NO	0.12	VAR. 18-20		28								131	8			8	28					
		56	SR 2534 (NIXON RD)	NC 273 TO END PVMT	9	NO	0.02	VAR. 36-38		45					50			1,000	46			63	120					
		57	SR 3000 (RAWHIDE DR)	SR 2531 TO SR 3003	1	NO	0.14	20		15								153	7			10	16					
		58	SR 3001 (WISHBONE DR)	SR 3000 TO DE	1	NO	0.16	20		7								175	8			11	18					
		59	SR 3002 (WAGONWHEEL CT)	SR 3000 TO CULDESAC	1	NO	0.15	20		5								164	8			10	18					
		59	SR 3003 (LONGHORN DR)	SR 3000 TO DE	1	NO	0.06	20		2								65	3			4	7					
SR PROJ NO. 12CR.20361.19							16.83		1,193	1,370	15.88	1,127			1,353		538	18,186	1,885			1,236	3,578			30	5	
GRAND TOTAL							25.99		1784	1646	24.79	19364	18540	16555	2821	19700	538	18186	1885	17386	962	2321	7332	19	8	100	39	1

PROJECT NO.	SHEET NO.	TOTAL NO.
12CR.10361.14, 12CR.20361.19	21	

THERMOPLASTIC AND PAINT QUANTITIES

PROJECT NO	COUNTY	MAP NO	ROUTE	DESCRIPTION	4685000000-E		4686000000-E		4697000000-E		4695000000-E		4705000000-E		4710000000-E		4721000000-E			4725000000-E			4810000000-E		4905000000-N
					4" X 90 M YELLOW THERMO	4" X 90 M WHITE THERMO	4" X 120 M YELLOW THERMO	4" X 120 M WHITE THERMO	8" X 120 M WHITE THERMO	8" X 90 M WHITE THERMO	8" X 90 M YELLOW THERMO	16" X 120 M WHITE THERMO	24" X 120 M WHITE THERMO	THERMO MSG ONLY 120 M	THERMO MSG SCHOOL 120 M	THERMO RXR 120 M	THERMO LT ARROW 90 M	THERMO STR ARROW 90 M	THERMO STR & RT ARROW 90 M	THERMO RT ARROW 90 M	THERMO STR & LT ARROW 90 M	4" WHITE PAINT	4" YELLOW PAINT	SNOW PLOWABLE MARKERS	
NO		NO			LF	LF	LF	LF	LF	LF	LF	LF	LF	EA	EA	EA	EA	EA	EA	EA	EA	EA	EA	EA	EA
12CR.10361.14	Gaston	1	NC 150 (CHURCH ST)	SR 1651 TO 450' W OF NC 279	530		18,070	1,416		300			228				43								344
		2	NC 279 (DALLAS-CHERRYVILLE HWY)	US321 BRIDGE TO CHG IN PVMT	3,274		6,310	2,363					170				14	13	7	3					275
		3	US321 S (CHESTER ST)	NC 7 TO SR 2466				1,281	710				150					18	11	5	16				130
		4						490	85				42					2	2		2				40
		5	NC 273 (PARK ST)	US29/74 TO NC 7			5,500	2,000	200	300							3	5	5	5	6				230
		6	NC 273 (MOUNTAIN ISLAND HWY)	PINEWOOD ELEMENTARY SCH (CHG PVMT TO CHG PVMT)			2,324	200								4		4							40
		7	NC 273 (MOUNTAIN ISLAND HWY)	CHG PVMT (MOUNTAIN ISL PLACE) TO SR 1992		20,874	17,804																		140
		8	NC 279 (NEW HOPE RD)	SR 2519 TO 0.44MI S OF SR 2490		8,823	8,823	300					30					3							60
		9	NC 279 (NEW HOPE RD)	0.17MI S OF SR 2490 TO 0.11MI S OF SR 2439		9,115	12,330	280				50		130		12		13			2				100
		10	NC 7 (CATAWBA ST)	N. MAIN ST. TO THIRD ST.			5,488	100	66				100			4		3					500		80
		11	NC 7 (CATAWBA ST)	FOURTH ST. TO US 29/74		4,172	12,051						30										1,000		160
TOTAL FOR PROJ NO. 12CR.10361.14					3,804	42,984	88,700	8,430	1,061	600	50	100	1,041	4	12	4	83	38	25	15	24	1,500			1,599
					46,788		97,130			650				20			185					1,500			

PROJECT NO.	SHEET NO.	TOTAL NO.
12CR.10361.14, 12CR.20361.19	22	

THERMOPLASTIC AND PAINT QUANTITIES

PROJECT NO	COUNTY	MAP NO	ROUTE	DESCRIPTION	4685000000-E		4686000000-E		4697000000-E	4695000000-E		4705000000-E	4710000000-E	4721000000-E			4725000000-E			4810000000-E		4905000000-N					
					4" X 90 M YELLOW THERMO	4" X 90 M WHITE THERMO	4" X 120 M YELLOW THERMO	4" X 120 M WHITE THERMO	8" X 120 M WHITE THERMO	8" X 90 M WHITE THERMO	8" X 90 M YELLOW THERMO	16" X 120 M WHITE THERMO	24" X 120 M WHITE THERMO	THERMO MSG ONLY 120 M	THERMO MSG SCHOOL 120 M	THERMO RXR 120 M	THERMO LT ARROW 90 M	THERMO STR ARROW 90 M	THERMO STR & RT ARROW 90 M	THERMO RT ARROW 90 M	THERMO STR & LT ARROW 90 M	4" WHITE PAINT	4" YELLOW PAINT	SNOW PLOWABLE MARKERS			
					LF	LF	LF	LF	LF	LF	LF	LF	LF	EA	EA	EA	EA	EA	EA	EA	EA	EA					
12CR.20361.19	Gaston	12	SR 1116 (MOUNTAIN CREST DR)	SR TO CLEVELAND CL																	14,418	14,418					
		13	SR 3042 (HUNTING RIDGE DR)	SR 2532 TO SR 3043																							
		14	SR 3043 (FALLINGBROOK CT)	CULDESAC TO CULDESAC																							
		15	SR 2003 (STANLEY-SPENCER MTN RD)	SR 2000 TO 0.21 MILE NW OF SR 2200				100				25					1		1		61,117	59,217	200				
		16	SR 1604 (ASHEBROOK PARK RD)	SR 1602 TO US321B																	18,938	18,938					
		17	SR 1801 (EASON RD)	SR 1001 TO DE																	6,671	6,671					
		18	SR 1390 (FRIDAY PARK RD)	SR 1336 TO DE																							
		19	SR 2276 (BRIARWOOD DR)	SR 2275 TO 370 FT S OF SR 2275																							
		20	SR 2276 (BRIARWOOD DR)	SR 2275 TO SR 2395																							
		21	SR 2397 (WOODDALE CT)	SR 2395 TO CULDESAC																							
		22	SR 2395 (WOODDALE DR)	SR 2276 TO DE																							
		23	SR 2396 (CLOVERDALE DR)	SR 2395 TO SR 2275																							
		24	SR 2269 (EAST MAIN ST)	NC 279 TO 422 FT W OF NC 279																	14,203	14,203					
		25	SR 2270 (STILLWELL ST)	SR 2269 TO DE																							
		26	SR 2094 (BROWN DR)	NC 273 TO SR 2070																	2,367	2,367					
		27	SR 2070 (BROWNTOWN RD)	SR 2094 TO US 29/74																	7,317	7,317					
		28	SR 2491 (VALE ST/8TH AVE)	SR 2209 TO US 29/74																							
		29	SR 2593 (FORD ST)	US 29/74 TO SR 2491																							
		30	SR 2496 (LOWELL AVE)	SR 2491 TO US 29/74																							
		31	SR 2494 (HIGHLAND ST)	SR 2496 TO US 29/74																							
		32	SR 2498 (MCALLISTER RD)	SR 2494 TO US 29/74																							
		33	SR 2497 (ABBAY ST)	SR 2494 TO US 29/74																							
		34	SR 2493 (CHURCH ST)	SR 2496 TO US 29/74																							
		35	SR 2495 (CHESTER ST)	SR 2496 TO SR 2493																							
		36	SR 1917 (ROLLINGWOOD LN)	SR 1916 TO DE																	11,836	11,836					
		37	SR 1961 (HICKORY HILL AVE)	SR 1917 TO CULDESAC																	7,747	7,747					
		38	SR 3066 (BEACONHILL)	SR 2439 TO CULDESAC																							
		39	SR 3128 (BECKINGHAM CT)	SR 3066 TO CULDESAC																							
		40	SR 3089 (BRIDGEPORT LN)	SR 3066 TO CULDESAC																							
		41	SR 3088 (OLD GRANITE CT)	SR 3066 TO CULDESAC																							
		42	SR 2440 (COOKS LAKE RD)	SR 2439 TO DE																	13,773	13,776					
		43	SR 2442 (HARPER RD)	NC 274 TO CULDESAC																	12,482	12,482					
		44	SR 3081 (DOVEWOOD LN)	SR 2442 TO DE																							
		45	SR 3082 (DOVEWIND CT)	SR 3081 TO CULDESAC																							
		46	SR 1340 (SERVICE RD)	US 29/74 TO DE																							
		47	SR 1341 (SERVICE RD)	US 29/74 TO SR 1310																							
		48	SR 1185 (SERVICE RD)	US 29/74 TO US 29/74																							
		49	SR 1186 (SERVICE RD)	US 29/74 TO END PVMT																							
		50	SR 1187 (VICTORY LN)	US 29/74 TO SR 1122																							
		51	SR 1249 (SERVICE RD)	US 29/74 TO US 29/74																							
		52	SR 1001 (PHILADELPHIA CH RD)	SR 1837 (OLD WILLIS SCH RD) TO SR 1819																	40,458	40,458					
		53	SR 1334 (JENKINS DAIRY RD)	NC 275/274 TO MT OLIVE CH RD								50	37				2				9,469	9,469					
		54	SR 2266 (FAIRLANE DR)	SR 2265 TO DE																							
		55	SR 2534 (NIXON RD)	NC 273 TO END PVMT				200					76		6						15,494	15,494					
		56	SR 3000 (RAWHIDE DR)	SR 2531 TO SR 3003																							
		57	SR 3001 (WISHBONE DR)	SR 3000 TO DE																							
		58	SR 3002 (WAGONWHEEL CT)	SR 3000 TO CULDESAC																							
		59	SR 3003 (LONGHORN DR)	SR 3000 TO DE																							
TOTAL FOR PROJ NO. 12CR.20361.19								300				50	138		6	2		4			1		236,290	234,393	200		
								300							8								470,683				
GRAND TOTAL								3,804	42,984	88,700	8,730	1,061	600	50	150	1,179	4	18	6	87	38	25	16	24	237,790	234,393	1,799
								46,788						650										472,183			