

TIP PROJECT: B-4200

CONTRACT:

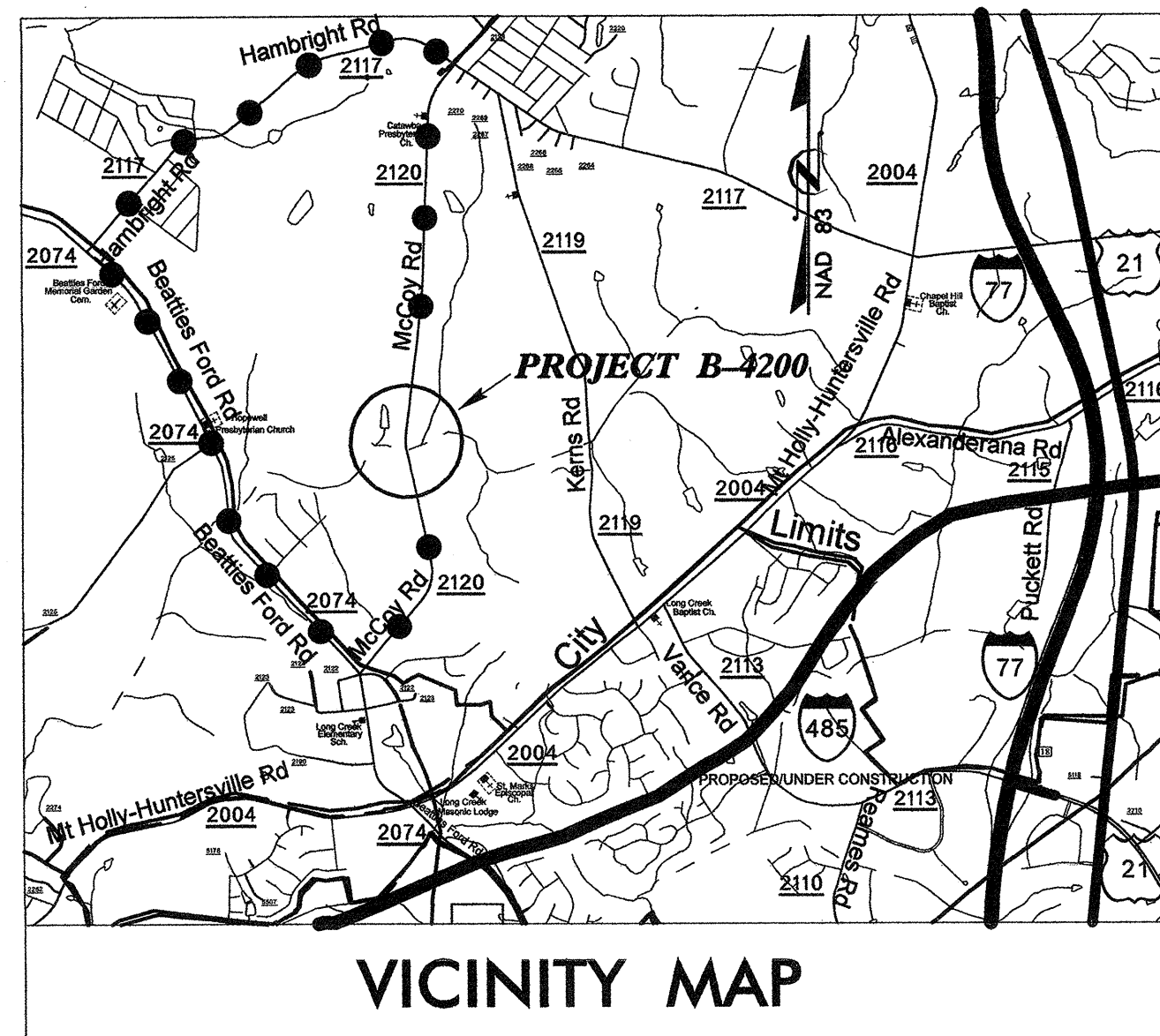

VICINITY MAP

●●●● DETOUR ROUTE

STATE OF NORTH CAROLINA  
DIVISION OF HIGHWAYS

UTILITY CONSTRUCTION PLANS  
MECKLENBURG COUNTY

LOCATION: BRIDGE #100 OVER GAR CREEK  
ON SR 2120 (McCOY ROAD)

TYPE OF WORK: UTILITY CONSTRUCTION

T.I.P. NO.	SHEET NO.
B-4200	UC-1

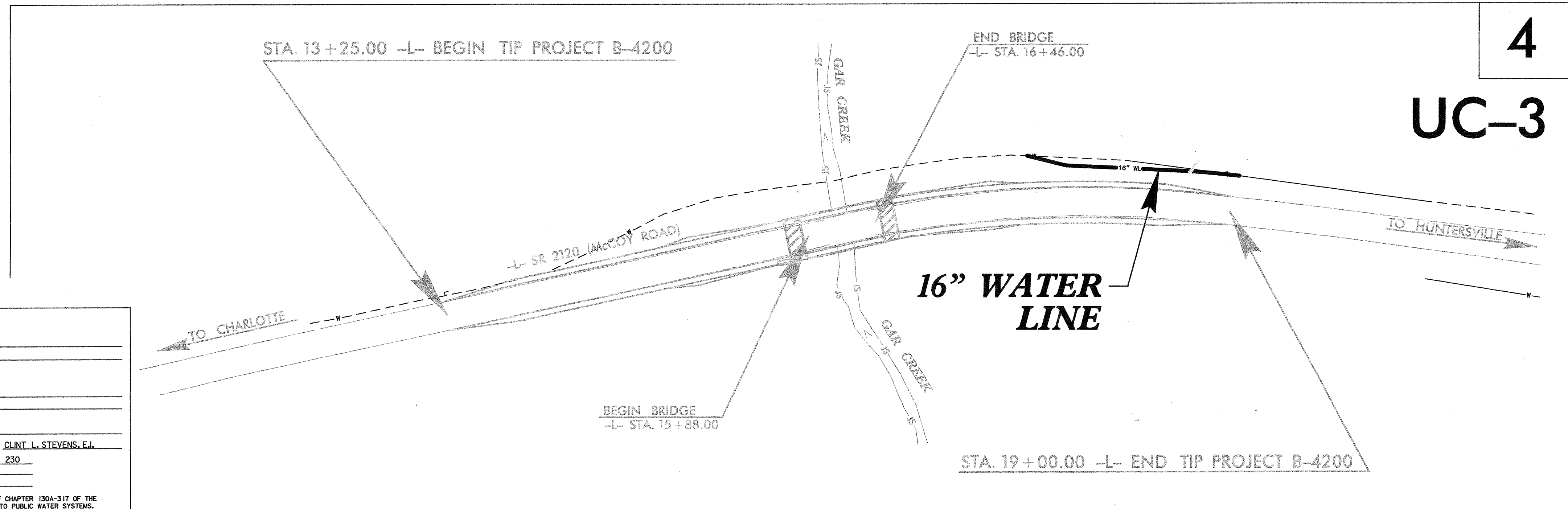
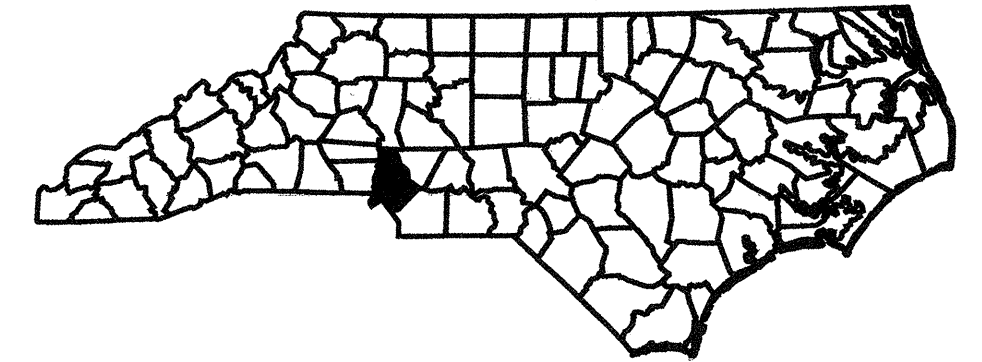

APPLICATION FOR PERMIT FOR WATER MAIN EXTENSION

PROJECT NAME: BRIDGE #100 OVER GAR CREEK  
ON SR 2120 (McCOY ROAD)

CMJ PROJECT NO.: 529-11-102

PROJECT DESCRIPTION: 155 LF 16" WATER MAIN & FITTINGS

DESIGNED BY: FIRM: HINDE ENGINEERING, INC.  
ENGINEER: KEVIN S. HINDE, P.E. DESIGNED BY: CLINT L. STEVENS, E.I.  
ADDRESS: 7520 EAST INDEPENDENCE BLVD., SUITE 230  
CHARLOTTE, NORTH CAROLINA 28227  
PHONE: 704-814-4407

THIS APPLICATION IS MADE UNDER AND IN FULL ACCORD WITH THE PROVISIONS OF CHAPTER 130A-317 OF THE NORTH CAROLINA GENERAL STATUTES, AND SUCH OTHER STATUTES AS RELATED TO PUBLIC WATER SYSTEMS. CMJ HAS BEEN GRANTED AUTHORITY TO ISSUE PERMITS FOR EXTENSION OF WATER MAINS PURSUANT TO ISA NCAC 18C.1801. THE APPLICANT AGREES THAT NO SIGNIFICANT CHANGE OR DEVIATION FROM THE PLANS AND SPECIFICATIONS APPROVED BY CMJ WILL BE MADE WITHOUT THE WRITTEN CONSENT AND APPROVAL OF CMJ OR ITS AUTHORIZED REPRESENTATIVE. A PROFESSIONAL ENGINEER LICENSED TO PRACTICE IN THE STATE OF NORTH CAROLINA SHALL SUBMIT A STATEMENT REFLECTING THAT ADEQUATE OBSERVATIONS DURING AND UPON COMPLETION OF CONSTRUCTION INDICATES THAT CONSTRUCTION WAS COMPLETED IN ACCORDANCE WITH APPROVED PLANS AND SPECIFICATIONS.

PERMIT NO. 411-063  
APPROVED: *Barry Shearin* DATE 10/17/11  
BARRY SHEARIN, P.E., CHIEF ENGINEER

CHARLOTTE MECKLENBURG UTILITIES  
5100 BROOKSHIRE BLVD.  
CHARLOTTE, NORTH CAROLINA 28216  
*Ronald C. DeHaven 10/17/11*

Topo 687  
796 Gar Creek Basin

INDEX OF SHEETS

SHEET NO.	DESCRIPTION
UC-1	TITLE SHEET
UC-2	SYMBOLGY SHEET
UC-3	UTILITY PLAN AND PROFILE SHEET

WATER AND SEWER OWNERS ON PROJECT

(1) WATER - CHARLOTTE MECKLENBURG UTILITIES

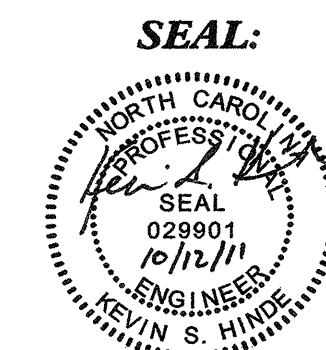

**HINDE ENGINEERING**  
License No. C-2639  
7520 E. Independence Blvd., Suite 230 Charlotte, NC 28227

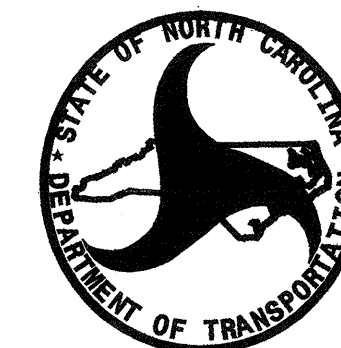

DIVISION OF HIGHWAYS  
PROJECT SERVICES  
UTILITY SECTION

1591 MAIL SERVICES CENTER  
RALEIGH NC 27699-1591  
PHONE (919) 256-4128  
FAX (919) 256-4119

*Roger Worthington, P.E.* UTILITIES SECTION ENGINEER  
*Carl Barclay, P.E.* UTILITIES SQUAD LEADER PROJECT ENGINEER  
*Kevin S. Hinde, P.E.* UTILITIES PROJECT DESIGNER

Note: Not to Scale

\*S.U.E. = Subsurface Utility Engineering

STATE OF NORTH CAROLINA  
DIVISION OF HIGHWAYS

UTILITIES PLAN SHEET SYMBOLS

PROJECT REFERENCE NO. B-4200	SHEET NO. UC-2
DESIGNED BY: CLS	
DRAWN BY: JNA	
CHECKED BY: KSH	
APPROVED BY:	
REVISED:	
NORTH CAROLINA DEPARTMENT OF TRANSPORTATION	
PROJECT SERVICES UNIT PHONE: (919) 250-4128 FAX: (919) 250-4119	
UTILITY CONSTRUCTION PLANS ONLY	

UTILITY CONSTRUCTION

Water

Proposed Back Flow Preventor	
Relocate Back Flow Preventor	
Existing Water Valve	
Proposed Valve	
Proposed Tapping Valve	
Existing Water Meter	
Proposed Water Meter	
Proposed Water Meter/Vault	
Relocate Water Meter	
Remove Water Meter	REM WM
Existing Hydrant	
Prop Hydrant	
Relocate Hydrant	
Remove Hydrant	REM FH

Proposed RPZ Back Flow Preventor	
Relocate RPZ Back Flow Preventor	
Water Cross	
Water Plug	
Water Reducer	
Water Tee	
Water Pump Station	
Water Thrust Block	
Blow Off Valve	
Air Release Valve	
Water Line Stop	
Water Line Stop w Bypass	

Utility By Other Symbols

Proposed Tel Pole	
Proposed Power Pole	
Proposed Joint Use Power, Tel Pole	
Proposed Joint Use Power, CATV Pole	
Proposed Joint Use Power, Tel, CATV Pole	
Proposed Joint Use Tel, CATV Pole	

Sewer

Existing Manhole	
Proposed UT Manhole	
Remove UT Manhole	REM UT MH
Abandon Utility Manhole	ABAND MH
Sewer Line Stop	
Sewer Line Stop w Bypass	

Sewer Cross	
Sewer Plug	
Sewer Reducer	
Sewer Tee	
Sewer Pump Station	
Sewer Thrust Block	

PUE Monument	
Concrete Pier	
Steel Pile Pier	
Test Hole (SUE)	
Prop Utility Vault	

NORTH CAROLINA  
DEPT. OF TRANSPORTATION  
ENGINEERING DIVISION  
RALEIGH, NORTH CAROLINA

BRIDGE NO. 100 OVER GAR CREEK  
ON SR 2120 (MCCOY ROAD)

Designed By:	Checked By:	Date:	Sheet:	Of:
CLS	KSH	10-12-11	UC-2	UC-3

**HINDE ENGINEERING**  
License No. C-2639  
7520 E. Independence Blvd., Suite 230 Charlotte, NC 28227

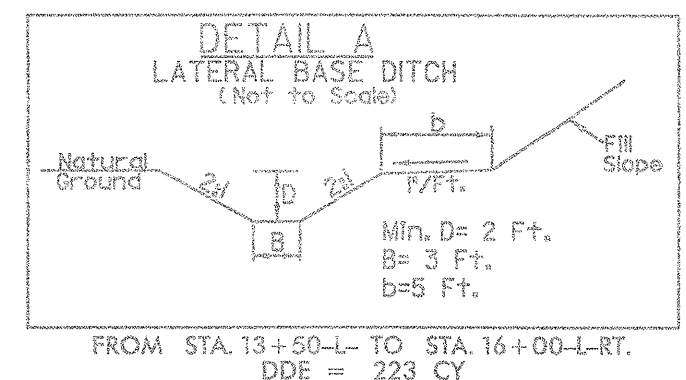
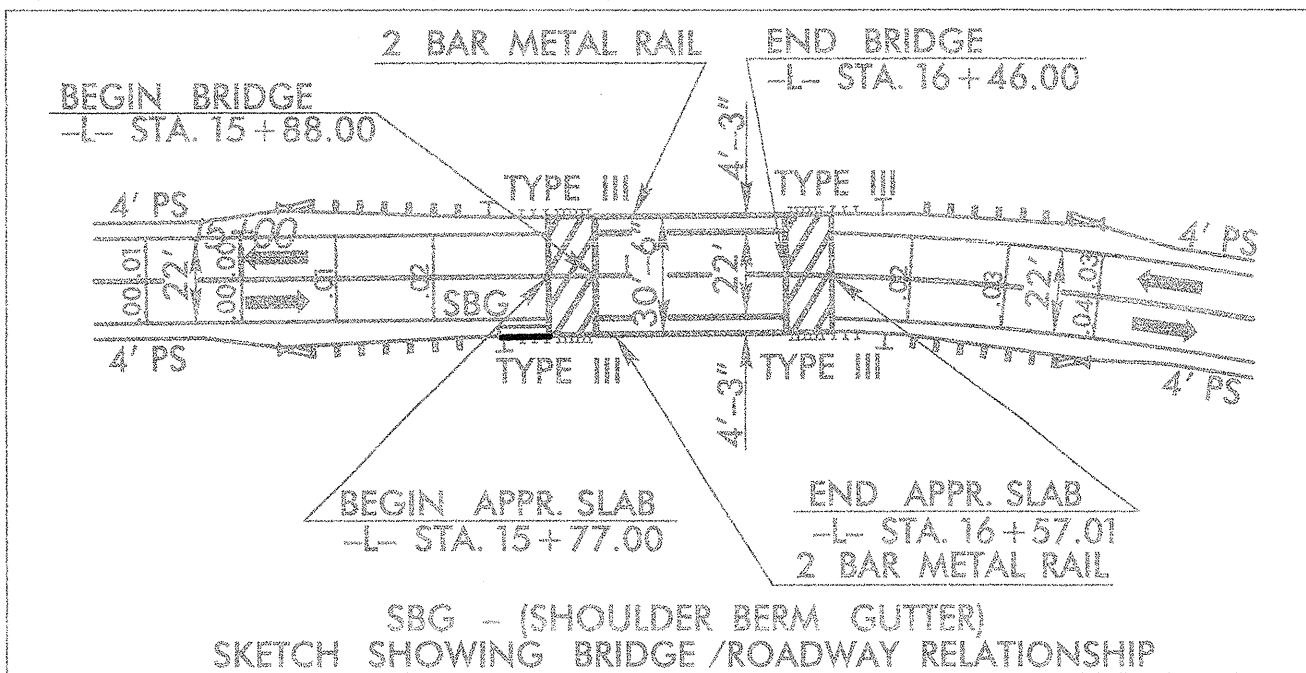

-L-  
 PI Sta 17+55.57  
 $\Delta = 19^{\circ}06'00.0''$  (RT)  
 $D = 7^{\circ}09'43.1''$   
 $L = 266.69'$   
 $T = 134.59'$   
 $R = 800.00'$   
 SE = SEE PLANS

SCALE: 0 50 100

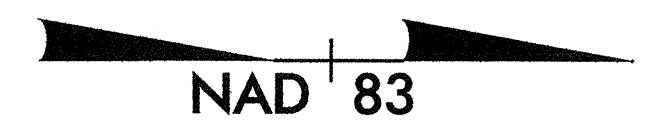

PROJECT REFERENCE NO.	B-4200	SHEET NO.	UC-3
DESIGNED BY:	CLS		
DRAWN BY:	JNA		
CHECKED BY:	KSH		
APPROVED BY:			
REVISED:			
NORTH CAROLINA DEPARTMENT OF TRANSPORTATION		UTILITY CONSTRUCTION PLANS ONLY	
PROJECT SERVICES UNIT		PHONE: (919)250-4128	
FAX: (919)250-4119			

**UTILITY CONSTRUCTION**

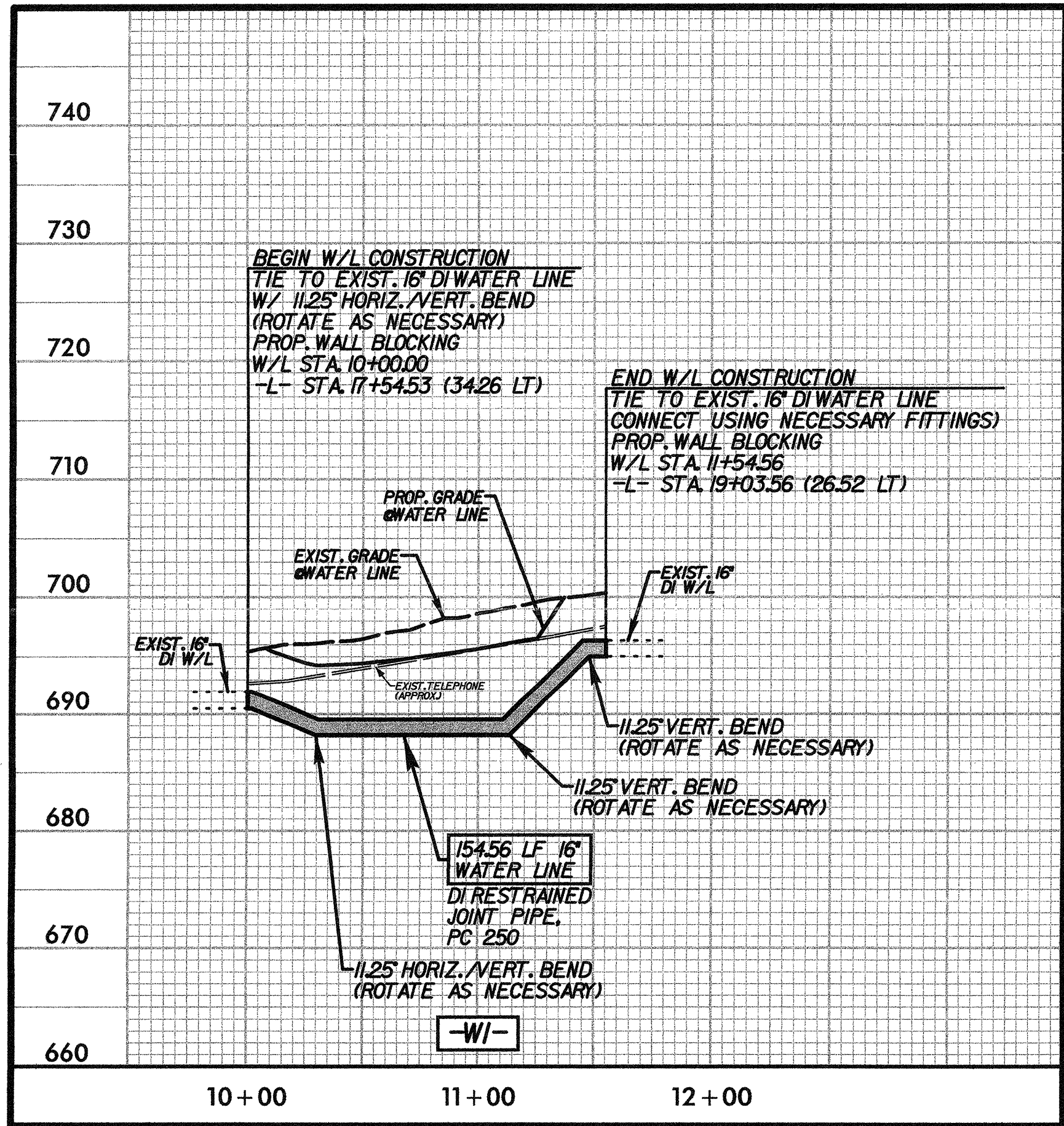
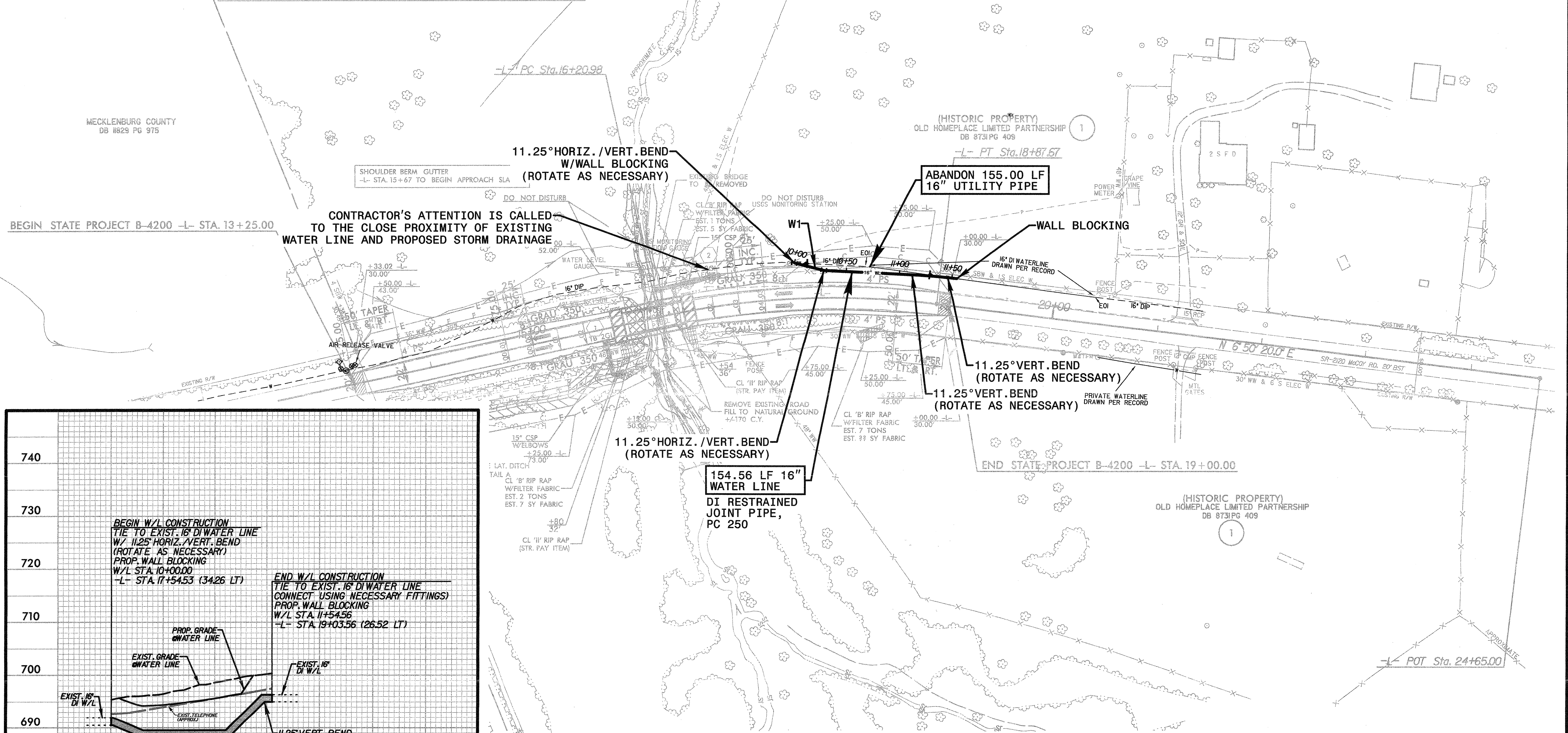

- GENERAL NOTES:**
1. THE PROPOSED UTILITY CONSTRUCTION SHALL MEET THE APPLICABLE REQUIREMENTS OF THE NC DEPARTMENT OF TRANSPORTATION'S "STANDARD SPECIFICATIONS FOR ROADS AND STRUCTURES" DATED JANUARY 2012, THE STANDARDS DETAILS AS SHOWN ON PLANS, AND THE PROJECT SPECIAL PROVISIONS FOR UTILITY CONSTRUCTION.
  2. ALL 16-INCH AND LARGER DIAMETER PIPE SHALL BE DUCTILE IRON PRESSURE CLASS 250, UNLESS OTHERWISE NOTED ON UTILITY CONSTRUCTION PLANS.
  3. VALVES ON WATER MAINS 16-INCH AND LARGER IN DIAMETER SHALL BE DIRECT BURY BUTTERFLY VALVES, UNLESS OTHERWISE NOTED ON UTILITY CONSTRUCTION PLANS.
  4. DUCTILE IRON RESTRAINED JOINT PIPE SHALL BE USED IN LIEU OF THRUST BLOCKING ON PROPOSED WATER LINE RELOCATIONS.
  5. WALL BLOCKING SHALL BE USED ON EXISTING WATER LINES AT THE PROPOSED RELOCATION TIE IN POINTS.
  6. CONTRACTOR SHALL CONNECT ALL WATER LINES AND SERVICE CONNECTIONS USING NECESSARY FITTINGS.

NORTH CAROLINA DEPT. OF TRANSPORTATION ENGINEERING DIVISION RALEIGH, NORTH CAROLINA

BRIDGE NO. 100 OVER GAR CREEK ON SR 2120 (MCCOY ROAD)

Designed By:	Checked By:	Date:	Sheet:	Of:
CLS	KSH	10-12-11	UC-3	UC-3

**HINDE ENGINEERING**  
 License No. C-2636  
 7520 E. Independence Blvd., Suite 230 Charlotte, NC 28227

09/08/99

See Sheet 1-A For Index of Sheets  
See Sheet 1-B For Conventional Symbols  
See Sheet 1-C For Survey Control Sheet

T.I.P. NO.	SHEET NO.
B-4200	UO-1

STATE OF NORTH CAROLINA  
DIVISION OF HIGHWAYS

**UTILITIES BY OTHERS PLANS  
MECKLENBURG COUNTY**

**LOCATION: BRIDGE NO. 100 OVER GAR CREEK ON  
SR 2120 (McCOY ROAD)**

**TYPE OF WORK: ELECTRIC POWER DISTRIBUTION**

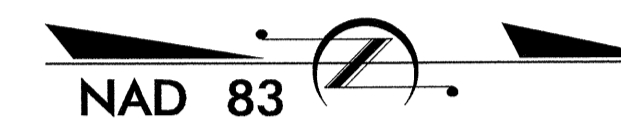

**TIP PROJECT: B-4200**

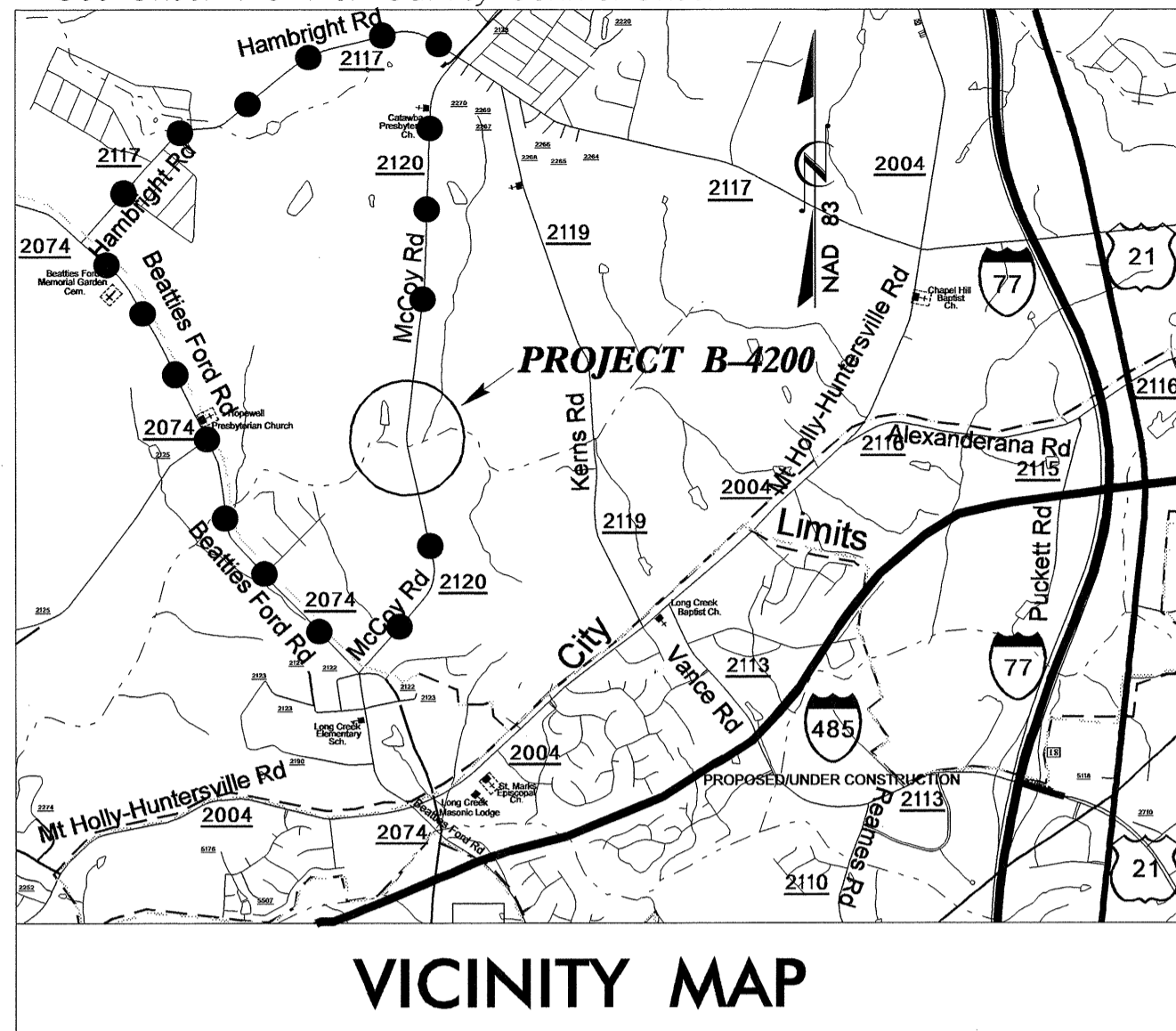

● ● ● ● DETOUR ROUTE

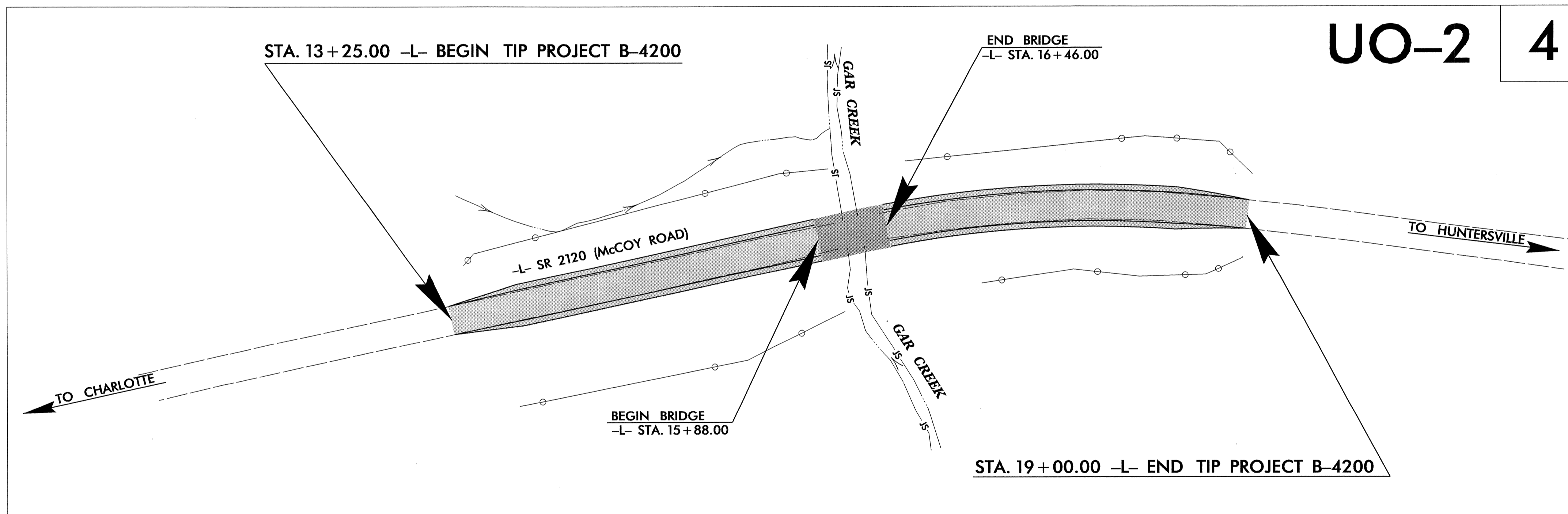

**GRAPHIC SCALES**

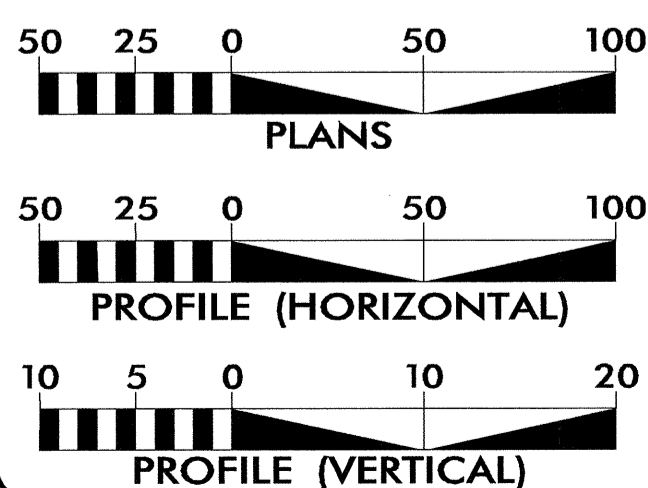

**INDEX OF SHEETS**

SHEET NO.	DESCRIPTION
UO-1	TITLE SHEET
UO-2	UTILITIES BY OTHERS PLAN SHEETS

**UTILITY OWNERS ON PROJECT**

(1) ELECTRIC POWER - DUKE ENERGY



PREPARED IN THE OFFICE OF:  
**DIVISION OF HIGHWAYS  
UTILITIES ENGINEERING  
SECTION**

1591 MAIL SERVICES CENTER  
RALEIGH NC 27699-1591  
PHONE (919) 707-6690  
FAX (919) 250-4151

**Roger Worthington, P.E.** UTILITIES SECTION ENGINEER  
**Carl Barclay, P.E.** UTILITIES SQUAD LEADER PROJECT ENGINEER  
**Bo Hemphill, P.E.** UTILITIES PROJECT DESIGNER

18-NOV-2011 12:55  
R:\Utilities\RDY\_Ut\Proj\B4200\_Ut\_title\_uol\_psh.dgn  
\$\$\$\$\$USERNAME\$\$\$\$\$

UTILITIES BY OTHERS

NOTE:  
 ALL PROPOSED UTILITY WORK  
 SHOWN ON THIS SHEET WILL  
 BE DONE BY OTHERS

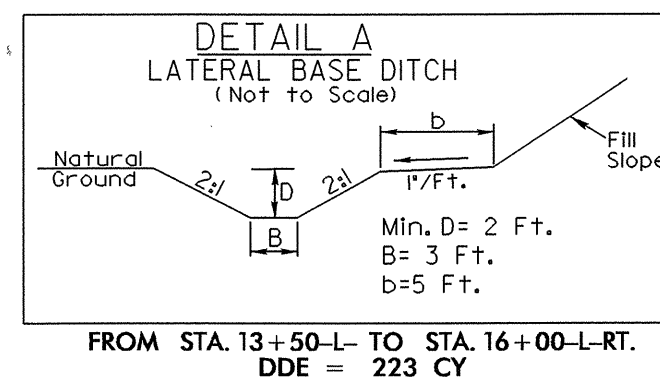

-L-  
 PI Sta 17+55.57  
 $\Delta = 19^{\circ} 06' 00.0''$  (RT)  
 $D = 7^{\circ} 09' 43.1''$   
 $L = 266.69'$   
 $T = 134.59'$   
 $R = 800.00'$   
 SE = SEE PLANS

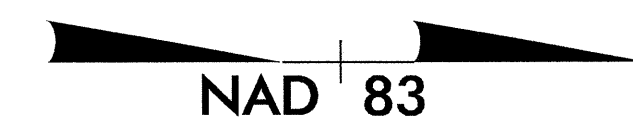

5/14/09

MECKLENBURG COUNTY  
 DB 11829 PG 975

BEGIN STATE PROJECT B-4200 -L- STA. 13+25.00

SHOULDER BERM GUTTER  
 -L- STA. 15+67 TO BEGIN APPROACH SLAB RT.

-L- PC Sta. 16+20.98  
 END WOVEN WIRE FENCE  
 -L- STA. 16+10.00

(HISTORIC PROPERTY)  
 THOMAS H. McCOY & ROBIN THORP McCOY  
 DB 20863 PG 199

-L- PT Sta. 18+87.67

TIE TO EXISTING FENCE  
 END WOVEN WIRE FENCE  
 -L- STA. 19+00.00

END STATE PROJECT B-4200 -L- STA. 19+00.00

(HISTORIC PROPERTY)  
 THOMAS H. McCOY & ROBIN THORP McCOY  
 DB 20863 PG 199

-L- POT Sta. 10+00.00

MECKLENBURG COUNTY  
 DB 11829 PG 975

-L- POT Sta. 24+65.00

08-NOV-2011 14:04  
 C:\Users\pshdgn\Documents\Projects\B4200\ut\_04\_uo2\_pshdgn  
 \$\$\$\$\$\$