

STATE	STATE PROJECT REFERENCE NO.	SHEET NO.	TOTAL SHEETS
N.C.	B-4201	EC-1	
STATE PROJ. NO.	F.A. PROJ. NO.	DESCRIPTION	

TIP PROJECT: B-4201

STATE OF NORTH CAROLINA
DIVISION OF HIGHWAYS

PLAN FOR PROPOSED
HIGHWAY EROSION CONTROL

MECKLENBURG COUNTY



**LOCATION: BRIDGE NO. 38 OVER IRVINS CREEK
ON SR 3168 (SAM NEWELL ROAD)**

**TYPE OF WORK: GRADING, DRAINAGE, PAVING, CURB & GUTTER,
AND STRUCTURE**

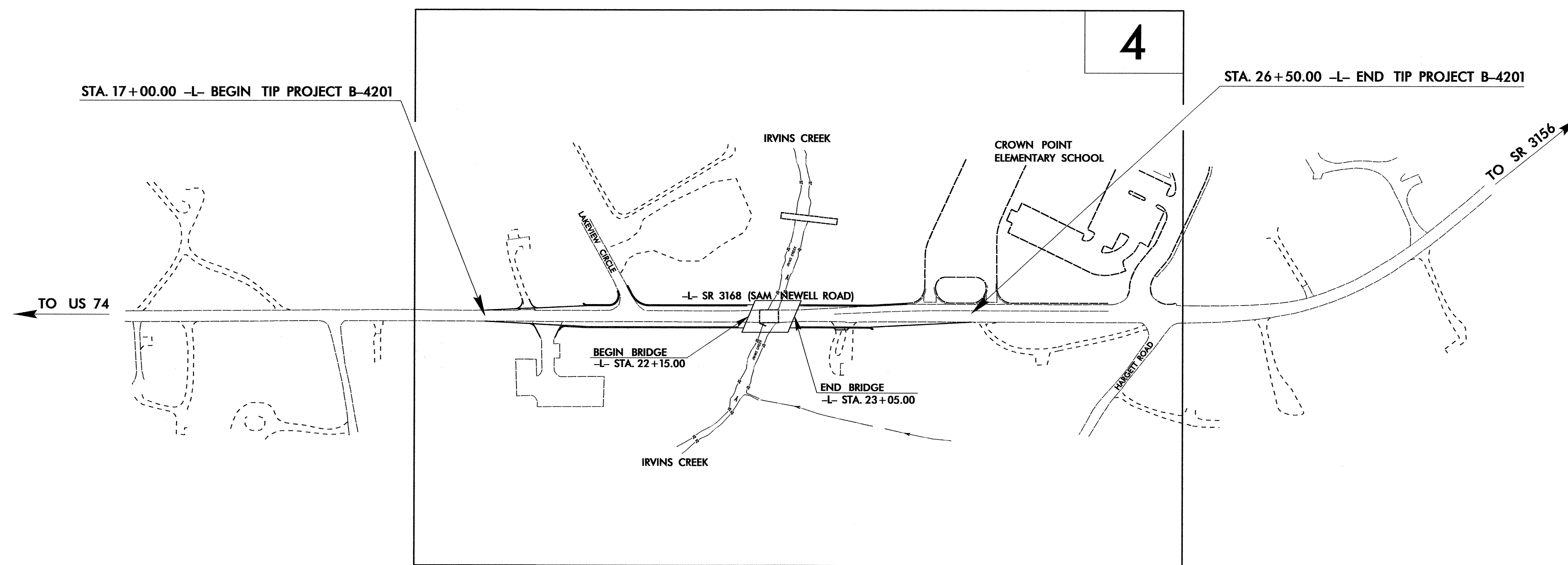

EROSION AND SEDIMENT CONTROL MEASURES

Std. #	Description	Symbol
1630.05	Temporary Silt Ditch	--- TSD ---
1630.05	Temporary Diversion	--- TD ---
1605.01	Temporary Silt Fence	--- TSF ---
1606.01	Special Sediment Control Fence	--- SSF ---
1622.01	Temporary Berms and Slope Drains	--- TBSD ---
1630.02	Silt Basin Type B	--- SIB ---
1633.01	Temporary Rock Silt Check Type-A	--- TRSCTA ---
	Temporary Rock Silt Check Type-A with Matting and Polyacrylamide (PAM)	--- TRSCTA-PAM ---
1633.02	Temporary Rock Silt Check Type-B	--- TRSCTB ---
	Wattle / Coir Fiber Wattle	--- W ---
	Wattle / Coir Fiber Wattle with Polyacrylamide (PAM)	--- W-PAM ---
1634.01	Temporary Rock Sediment Dam Type-A	--- TRSDA ---
1634.02	Temporary Rock Sediment Dam Type-B	--- TRSDA-B ---
1635.01	Rock Pipe Inlet Sediment Trap Type-A	--- RPISDTA ---
1635.02	Rock Pipe Inlet Sediment Trap Type-B	--- RPISDTB ---
1630.04	Stilling Basin	--- SB ---
1630.06	Special Stilling Basin	--- SSB ---
	Rock Inlet Sediment Trap:	
1632.01	Type A	--- RISA ---
1632.02	Type B	--- RISB ---
1632.03	Type C	--- RISC ---
	Skimmer Basin	--- SKB ---
	Tiered Skimmer Basin	--- TSKB ---
	Infiltration Basin	--- IB ---

**THIS PROJECT CONTAINS
EROSION CONTROL PLANS
FOR CLEARING AND
GRUBBING PHASE OF
CONSTRUCTION.**

GRAPHIC SCALE

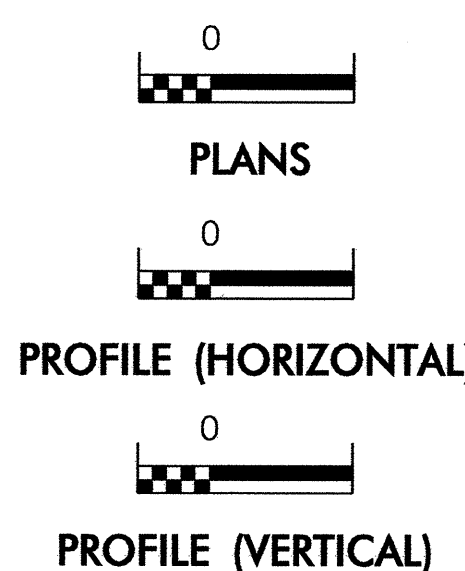

ROADSIDE ENVIRONMENTAL UNIT
DIVISION OF HIGHWAYS
STATE OF NORTH CAROLINA

THESE EROSION AND SEDIMENT CONTROL PLANS COMPLY
WITH THE REGULATIONS SET FORTH BY THE
NCG-010000 GENERAL CONSTRUCTION PERMIT EFFECTIVE AUGUST 3, 2011
ISSUED BY THE NORTH CAROLINA DEPARTMENT OF ENVIRONMENT AND
NATURAL RESOURCES DIVISION OF WATER QUALITY.

Prepared In the Office of:
ROADSIDE ENVIRONMENTAL UNIT
1 South Wilmington St.
Raleigh, NC 27611
2012 STANDARD SPECIFICATIONS

Roadway Standard Drawings

The following roadway english standards as appear in "Roadway Standard Drawings"- Roadway Design Unit - N. C. Department of Transportation - Raleigh, N. C., dated January 2012 and the latest revision thereto are applicable to this project and by reference hereby are considered a part of these plans.

1604.01 Railroad Erosion Control Detail	1632.01 Rock Inlet Sediment Trap Type A
1605.01 Temporary Silt Fence	1632.02 Rock Inlet Sediment Trap Type B
1606.01 Special Sediment Control Fence	1632.03 Rock Inlet Sediment Trap Type C
1607.01 Gravel Construction Entrance	1633.01 Temporary Rock Silt Check Type A
1622.01 Temporary Berms and Slope Drains	1633.02 Temporary Rock Silt Check Type B
1630.01 Riser Basin	1634.01 Temporary Rock Sediment Dam Type A
1630.02 Silt Basin Type B	1634.02 Temporary Rock Sediment Dam Type B
1630.03 Temporary Silt Ditch	1635.01 Rock Pipe Inlet Sediment Trap Type A
1630.04 Stilling Basin	1635.02 Rock Pipe Inlet Sediment Trap Type B
1630.05 Temporary Diversion	1640.01 Coir Fiber Baffle
1630.06 Special Stilling Basin	1645.01 Temporary Stream Crossing
1631.01 Matting Installation	

PROJECT REFERENCE NO. B-4201	SHEET NO. EC-2
RW SHEET NO.	
ROADWAY DESIGN ENGINEER	HYDRAULICS ENGINEER

SKIMMER BASIN WITH BAFFLES DETAIL

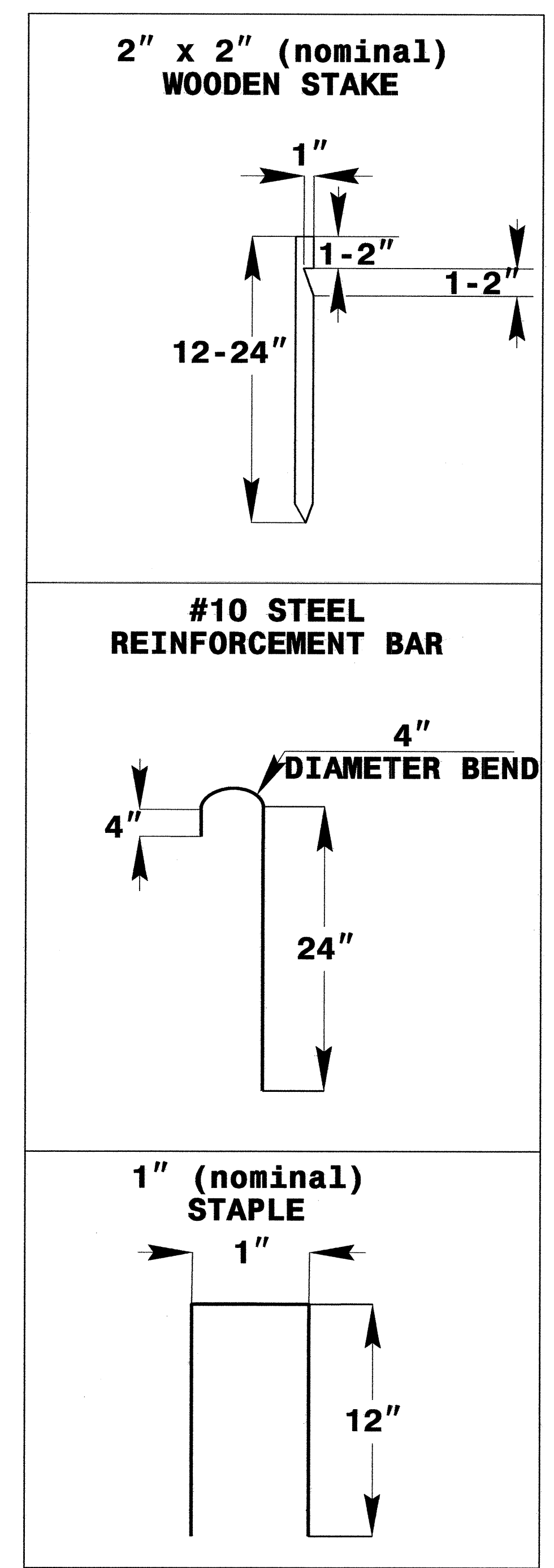
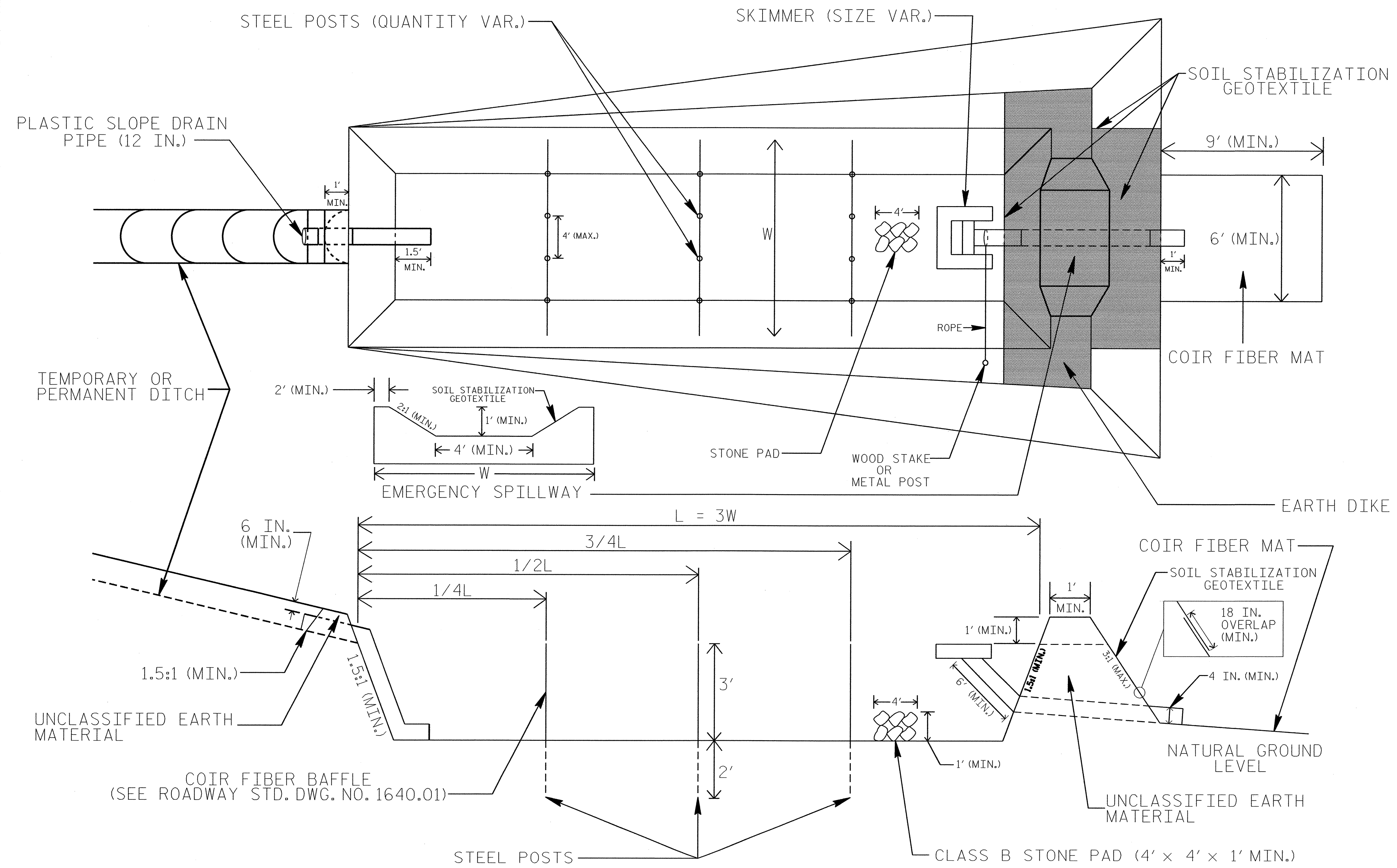

NOTES

1. SEED AND PLACE MATTING FOR EROSION CONTROL ON INTERIOR AND EXTERIOR SIDESLOPES.
2. LIMIT EARTH DIKE HEIGHT TO 5 FT.
3. FOR BASIN DEPTH OF 3 FT., THE MINIMUM BASIN WIDTH SHALL BE 9 FT.
4. DETERMINE EMERGENCY SPILLWAY LENGTH (FT.) USING $Q/0.8$, WHERE Q IS FLOW RATE (CFS) INTO BASIN.
5. PLASTIC SLOPE DRAIN PIPE AT INLET OF BASIN MAY BE REPLACED BY FILTRATION GEOTEXTILE AS DIRECTED.
6. SOIL STABILIZATION GEOTEXTILE FOR EMERGENCY SPILLWAY SHALL BE ONE CONTINUOUS PIECE OF MATERIAL OR OVERLAPPED 18 IN. (MIN.)

NOT TO SCALE

DIVISION OF HIGHWAYS
STATE OF NORTH CAROLINA

PROJECT REFERENCE NO. <i>B-4201</i>	SHEET NO. <i>EC-3A</i>
ROADWAY DESIGN ENGINEER	HYDRAULICS ENGINEER

SOIL STABILIZATION TIMEFRAMES

<i>SITE DESCRIPTION</i>	<i>STABILIZATION TIME</i>	<i>TIMEFRAME EXCEPTIONS</i>
PERIMETER DIKES, SWALES, DITCHES AND SLOPES	7 DAYS	NONE
HIGH QUALITY WATER (HQW) ZONES	7 DAYS	NONE
SLOPES STEEPER THAN 3:1	7 DAYS	IF SLOPES ARE 10' OR LESS IN LENGTH AND ARE NOT STEEPER THAN 2:1, 14 DAYS ARE ALLOWED.
SLOPES 3:1 OR FLATTER	14 DAYS	7 DAYS FOR SLOPES GREATER THAN 50' IN LENGTH.
ALL OTHER AREAS WITH SLOPES FLATTER THAN 4:1	14 DAYS	NONE, EXCEPT FOR PERIMETERS AND HQW ZONES.

PROJECT REFERENCE NO.	SHEET NO.
B-4201	EC-05/CONST.04
RW SHEET NO.	
ROADWAY DESIGN ENGINEER	HYDRAULICS ENGINEER

-L-
 PI Sta 18+58.05
 $\Delta = 0'06"48.2" (LT)$
 $D = 0'08"35.7"$
 $L = 79.15'$
 $T = 39.58'$
 $R = 40,000.00'$
 SE = SEE PLANS

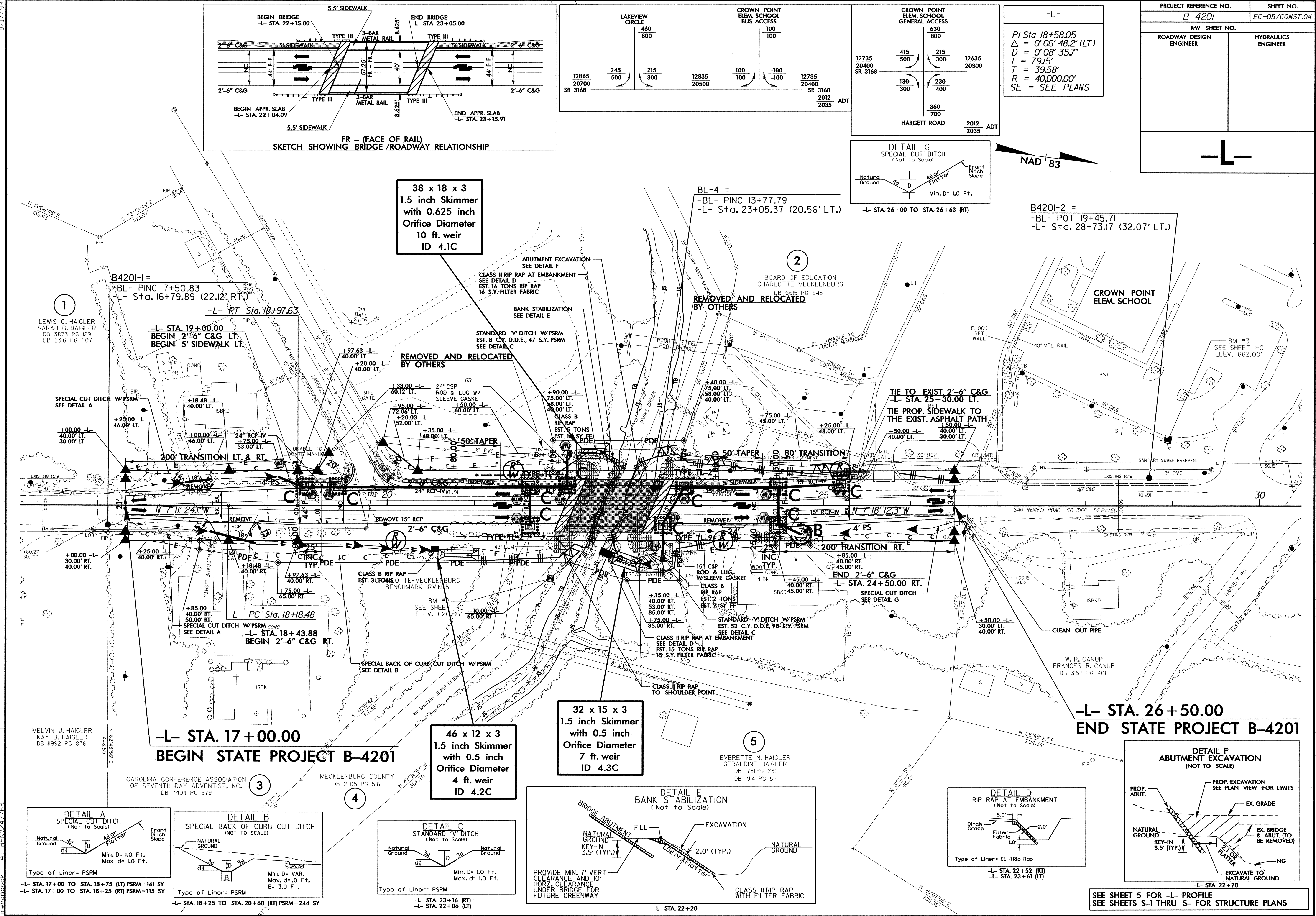
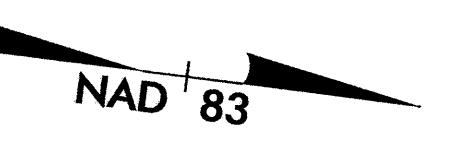
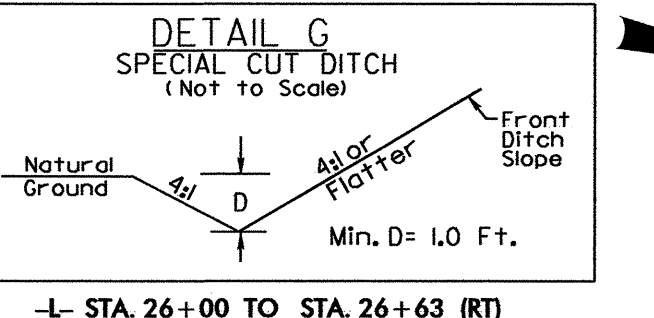
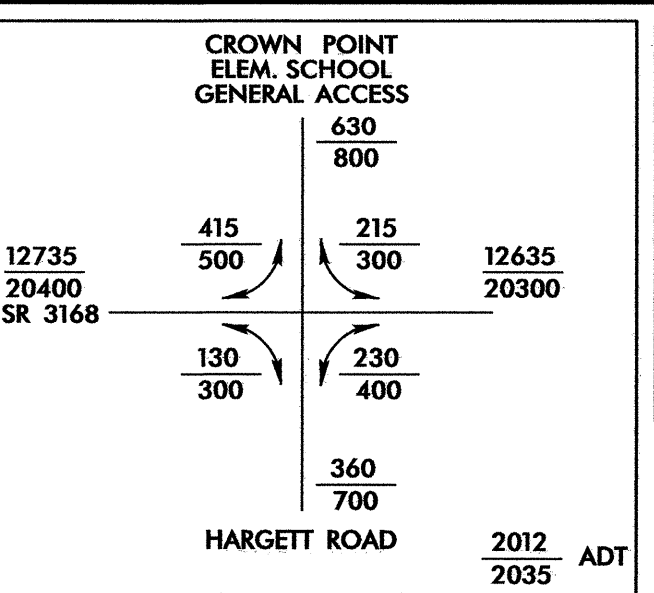
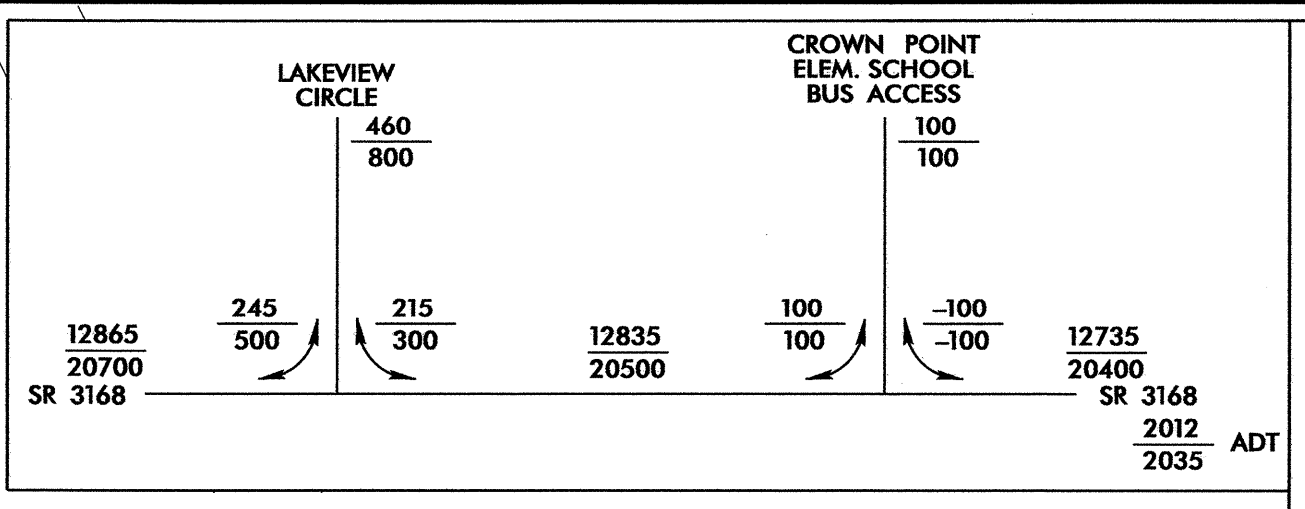
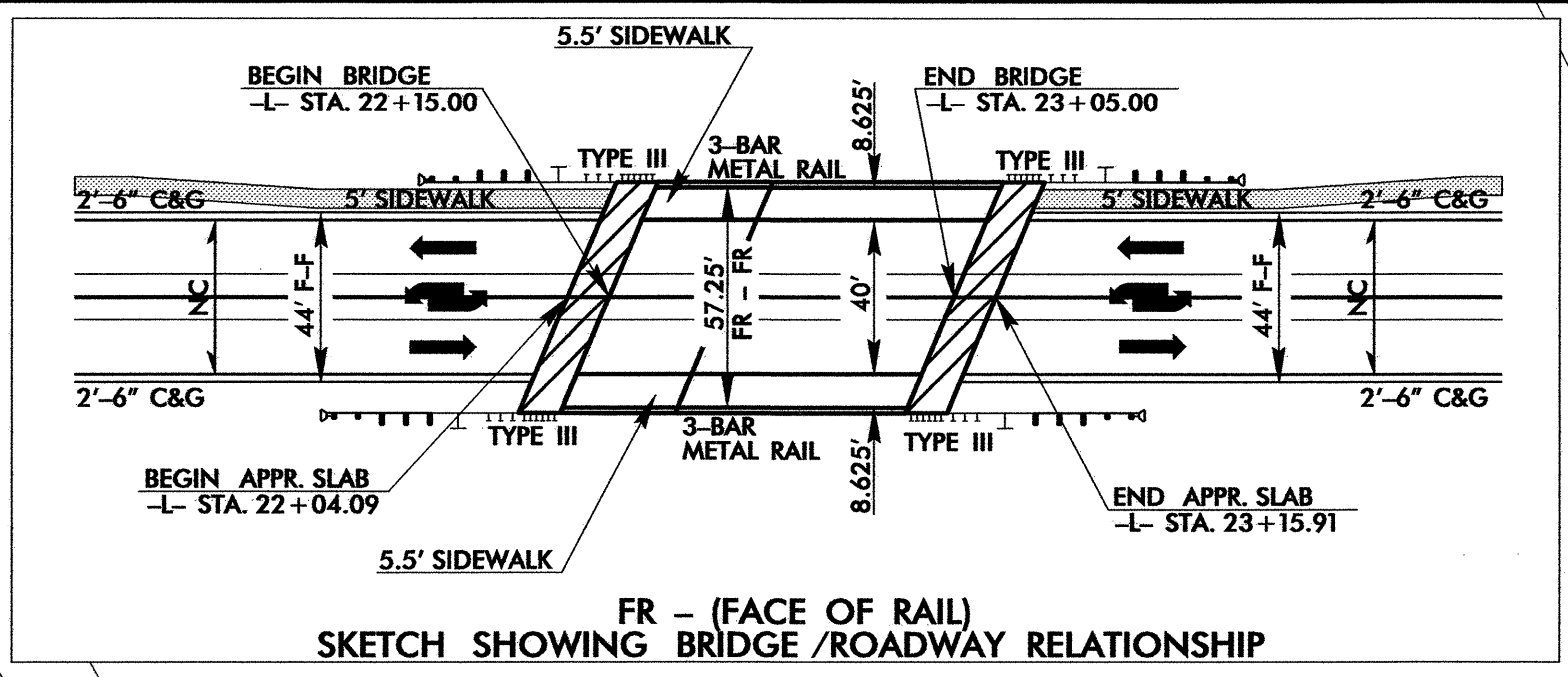

1
 LEWIS C. HAIGLER
 SARAH B. HAIGLER
 DB 3873 PG 129
 DB 2316 PG 607

MELVIN J. HAIGLER
 KAY B. HAIGLER
 DB #1992 PG 876

3
 CAROLINA CONFERENCE ASSOCIATION
 OF SEVENTH DAY ADVENTIST, INC.
 DB 7404 PG 579

5
 EVERETTE N. HAIGLER
 GERALDINE HAIGLER
 DB 1781 PG 281
 DB 1914 PG 511

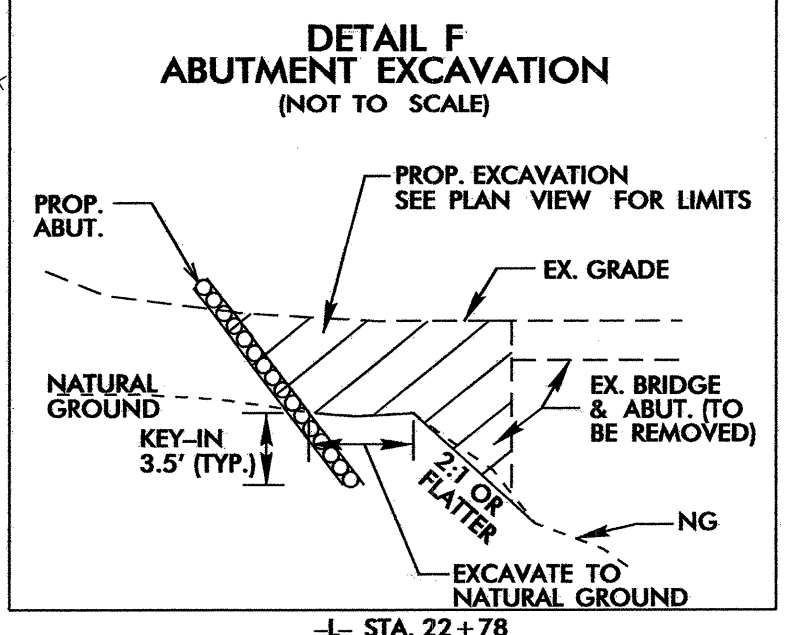
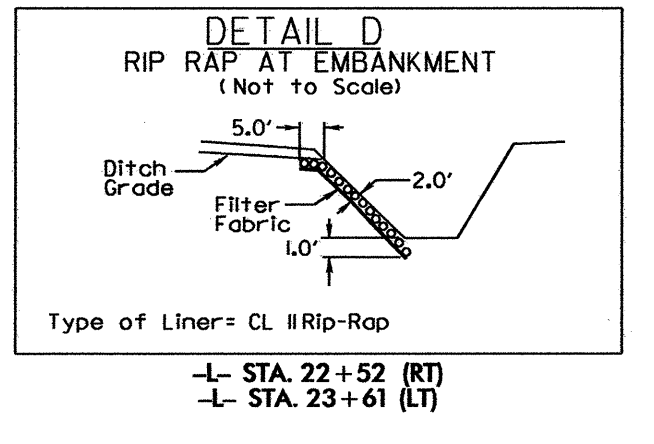
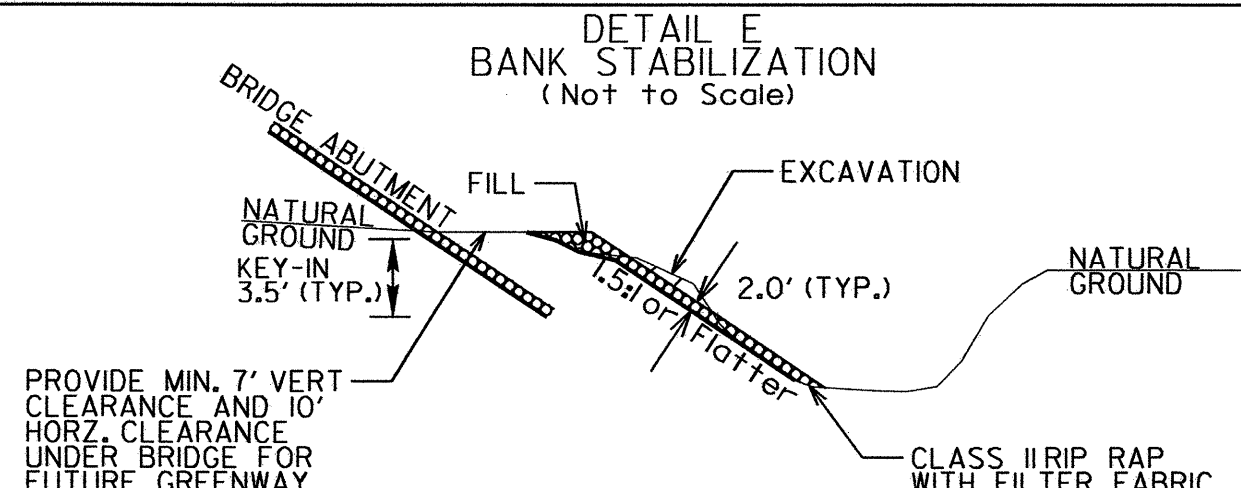
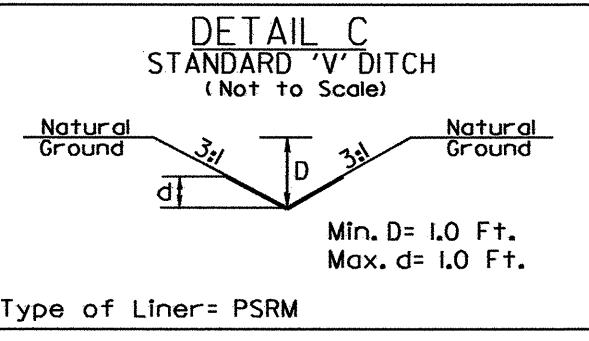
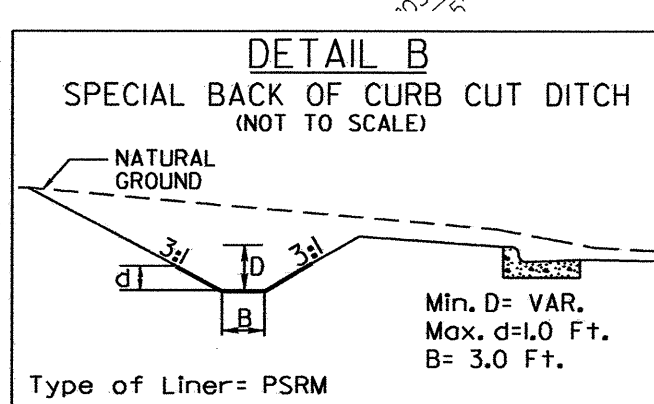
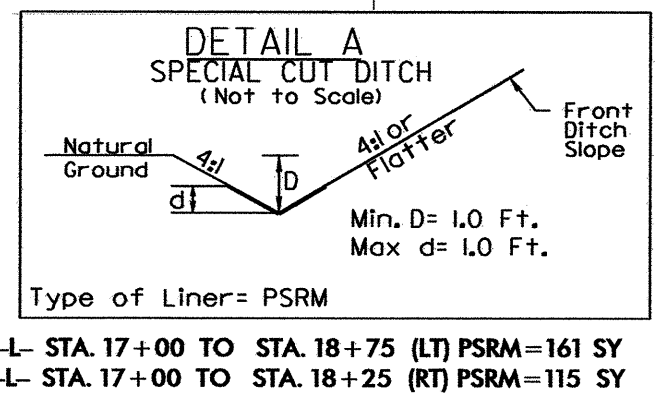

SEE SHEET 5 FOR -L- PROFILE
 SEE SHEETS S-1 THRU S- FOR STRUCTURE PLANS

REVISIONS

8/17/99

PROJECT: 20111137
 REVISED: 20111137
 DRAWN: J. HIGLER
 CHECKED: J. HIGLER
 DATE: 11/13/11