

CONTRACT NO.: C202932 WBS ELEMENT: IC.028036, ETC.

STATE OF NORTH CAROLINA  
DIVISION OF HIGHWAYS

**DARE COUNTY**

STATE	STATE PROJECT REFERENCE NO.	SHEET NO.	TOTAL SHEETS
N.C.	IC.028036 ETC	1	9
STATE PROJ. NO.	P.A. PROJ. NO.	DESCRIPTION	
1C.028036		MAP 1	
1C.028039		MAP 2	
1C.028040		MAP 3	
1C.028048		MAP 7	
1CR.20281.78		MAP 12	
1CR.20281.80		MAP 14	
1CR.20281.82		MAP 16	
1CR.20281.84		MAP 18	

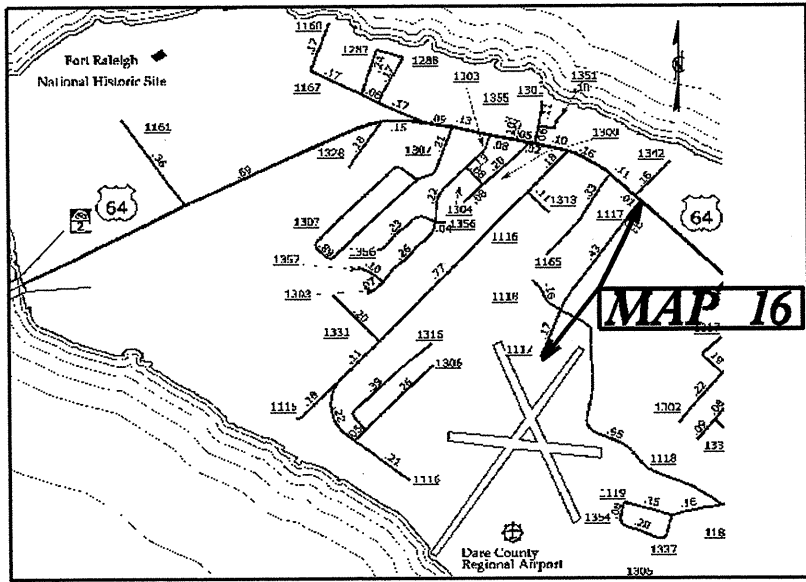

MANTEO

**LOCATION:** MAP 1 SR 1536 FROM SR 1276 TO END MAINTENANCE  
 MAP 2 SR 1498 FROM SEA OATS DR. TO END MAINTENANCE  
 MAP 3 SR 1453 FROM SR 1452 TO END MAINTENANCE  
 MAP 7 SR 1509 FROM SR 1508 TO END MAINTENANCE  
 MAP 12 SR 1208 FROM SR 1210 TO END OF PAVEMENT  
 MAP 14 SR 1208 FROM SR 1210 TO SR 1206  
 MAP 16 SR 1117 FROM US 64 TO THE DEAD END  
 MAP 18 SR 1207 FROM SR 1208 TO SR 1206

**TYPE OF WORK: PAVING, RESURFACING & PAVEMENT MARKINGS**

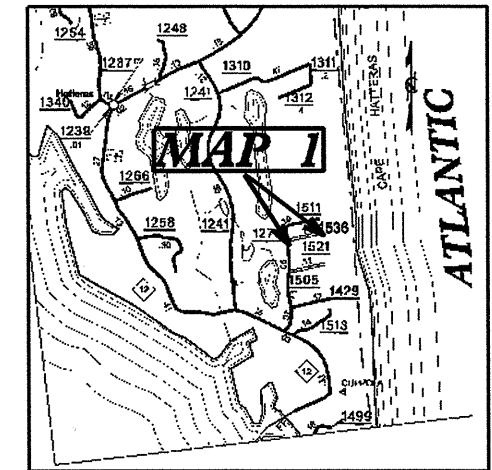

HATTERAS

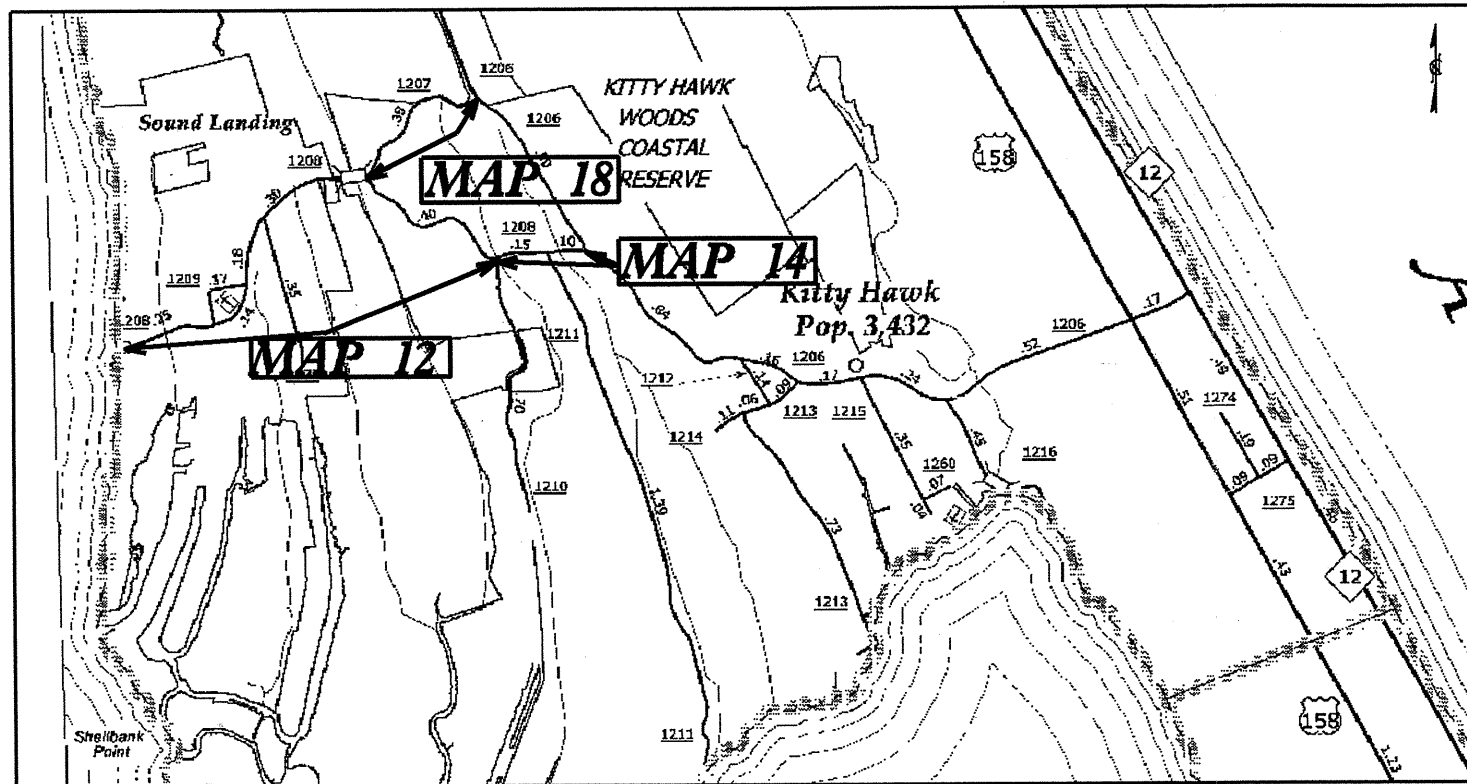

KITTY HAWK

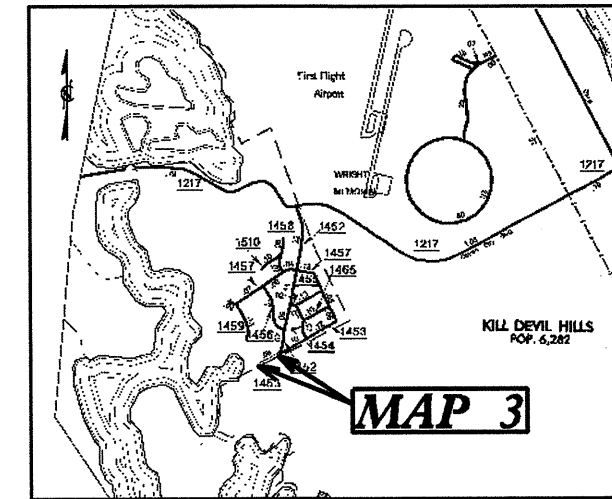

KILL DEVIL HILLS

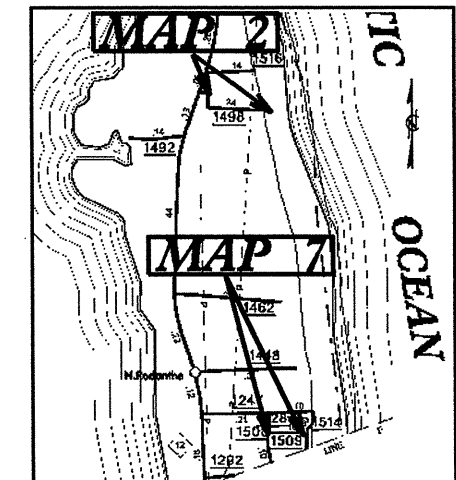

NORTH RODANTHE

**NTS**

**PROJECT LENGTH**

LENGTH OF ROADWAY PROJECT	MAP 1	0.12 MI.
LENGTH OF ROADWAY PROJECT	MAP 2	0.20 MI.
LENGTH OF ROADWAY PROJECT	MAP 3	0.07 MI.
LENGTH OF ROADWAY PROJECT	MAP 7	0.11 MI.
LENGTH OF ROADWAY PROJECT	MAP 12	1.10 MI.
LENGTH OF ROADWAY PROJECT	MAP 14	0.17 MI.
LENGTH OF ROADWAY PROJECT	MAP 16	0.59 MI.
LENGTH OF ROADWAY PROJECT	MAP 18	0.39 MI.

Prepared in the Office of:  
**DIVISION OF HIGHWAYS**  
113 Airport Dr., Edenton NC, 27932

2012 STANDARD SPECIFICATIONS

LETTING DATE:  
February 21, 2012

W.B. HOBBS, P.E.  
DIVISION PROJECT MANAGER

C.E. SLACHTA  
DIVISION PROPOSALS ENGINEER

**DIVISION OF HIGHWAYS**  
STATE OF NORTH CAROLINA

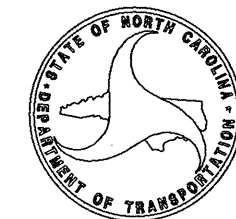

STATE	STATE PROJECT REFERENCE NO.	SHEET NO.	TOTAL SHEETS
N.C.	1C.028036 ETC	2	9
STATE PROJ. NO.	P.A. PROJ. NO.	DESCRIPTION	
1C.028041		MAP 4	
1C.028045		MAP 5	
1C.028047		MAP 6	
1C.028049		MAP 8	
1C.028050		MAP 9	
1C.028051		MAP 10	
1CR.10281.18		MAP 11	
1CR.20281.79		MAP 13	
1CR.20281.81		MAP 15	
1CR.20281.83		MAP 17	
1CR.20281.85		MAP 19	

STATE OF NORTH CAROLINA  
DIVISION OF HIGHWAYS  
**DARE COUNTY**

**LOCATION:** MAP 4 SR 1135 FROM END PAVEMENT TO END MAINTENANCE  
 MAP 5 SR 1224 FROM NC 12 TO SR 1226  
 MAP 6 SR 1286 FROM NC 12 TO END MAINTENANCE  
 MAP 8 SR 1421 FROM NC 12 TO END MAINTENANCE  
 MAP 9 SR 1228 FROM SR 1229 TO SR 1227  
 MAP 10 SR 1227 FROM SR 1224 TO SR 1226  
 MAP 11 NC 12 FROM NEW PAVEMENT TO SR 1467  
 MAP 13 SR 1145 FROM NC 345 TO SR 1168  
 MAP 15 SR 1146 FROM SR 1145 TO SR 1320  
 MAP 17 SR 1146 FROM SR 1320 TO SR 1147  
 MAP 19 SR 1148 FROM SR 1168 TO SR 1146

**TYPE OF WORK: WIDENING, PAVING, RESURFACING & PAVEMENT MARKINGS**

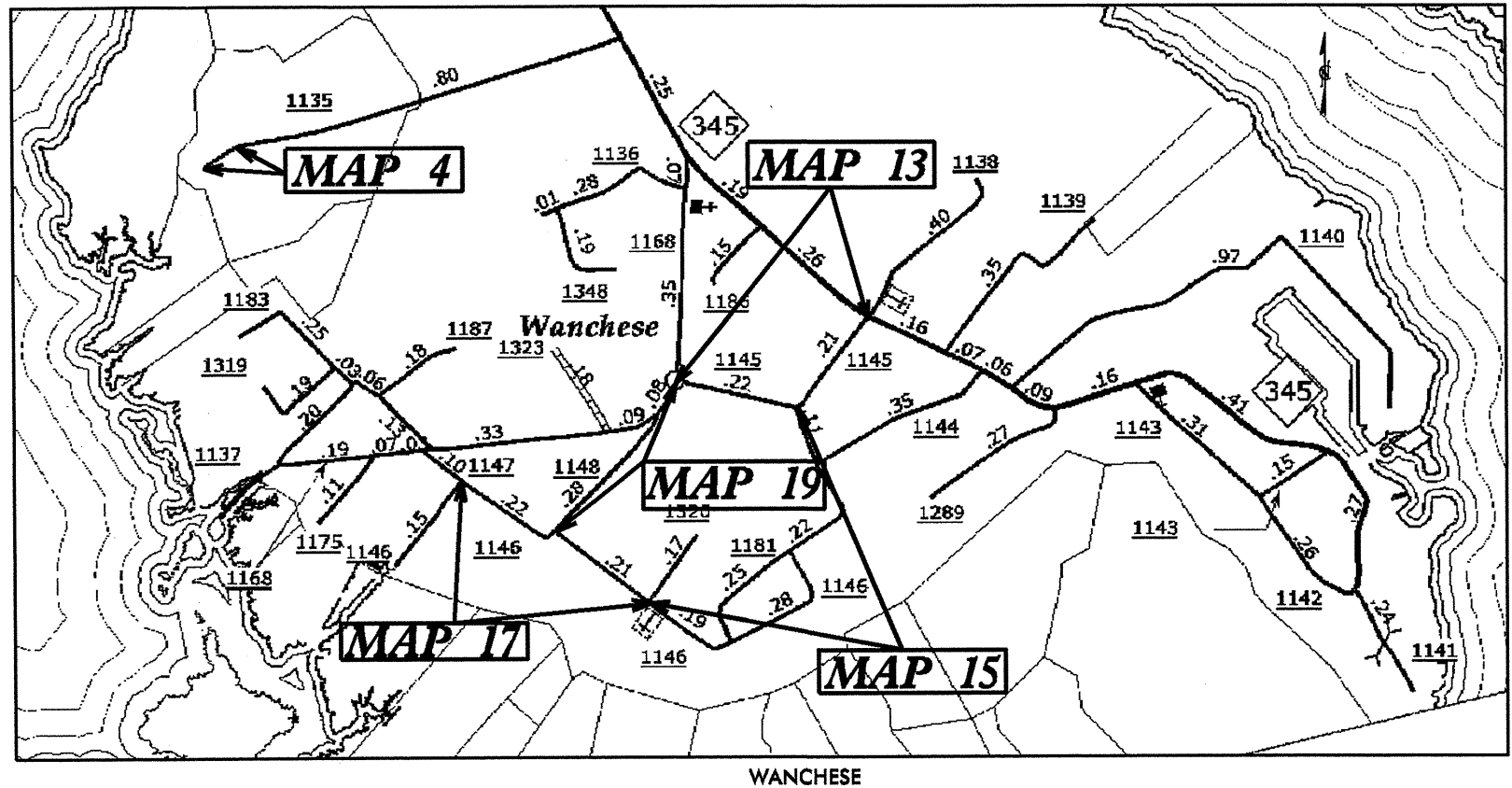
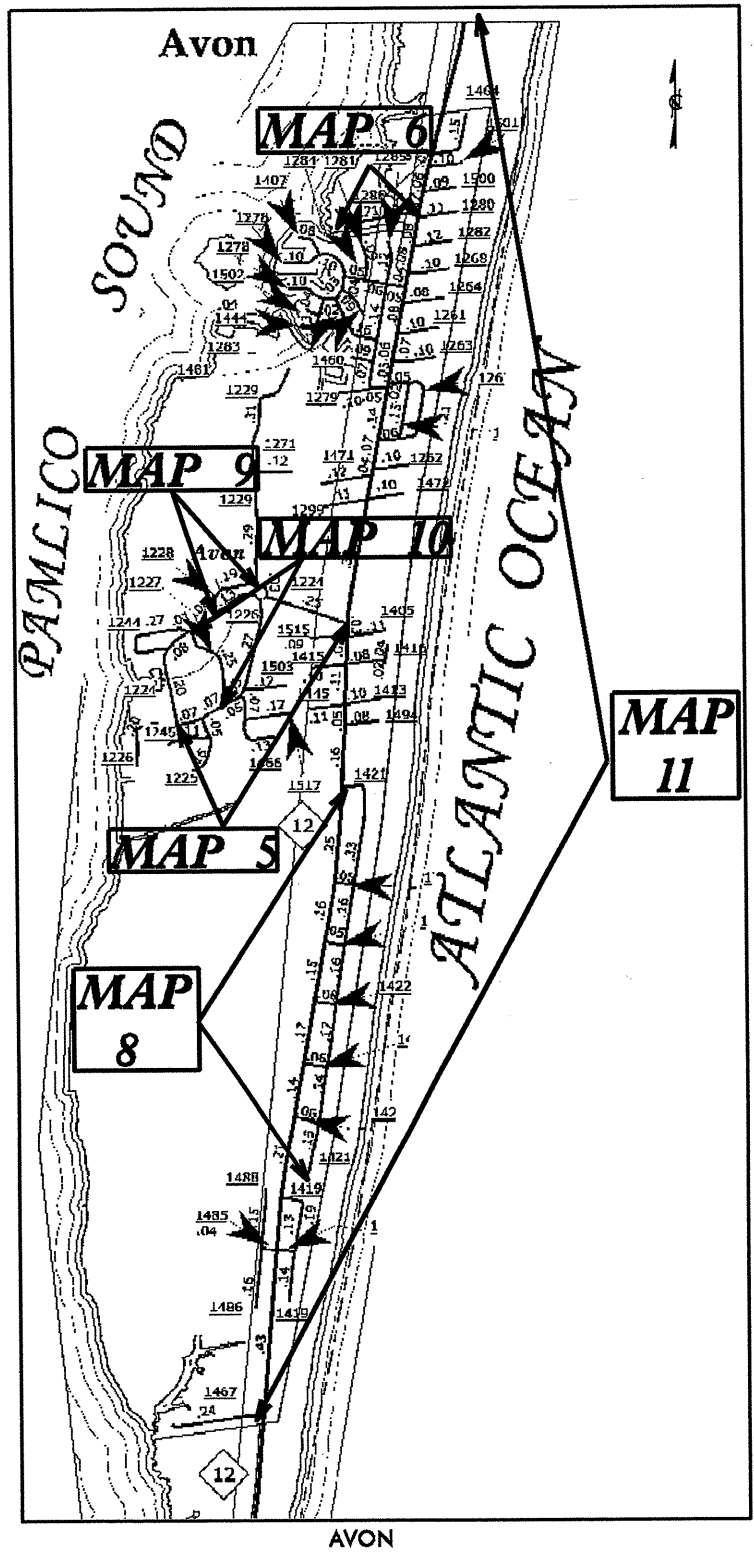

CONTRACT NO.: C202932 WBS ELEMENT: 1C.028036, ETC.

**NTS**

PROJECT LENGTH	
LENGTH OF ROADWAY PROJECT	MAP 4 0.13 MI.
LENGTH OF ROADWAY PROJECT	MAP 5 0.76 MI.
LENGTH OF ROADWAY PROJECT	MAP 6 0.23 MI.
LENGTH OF ROADWAY PROJECT	MAP 8 1.14 MI.
LENGTH OF ROADWAY PROJECT	MAP 9 0.19 MI.
LENGTH OF ROADWAY PROJECT	MAP 10 0.25 MI.
LENGTH OF ROADWAY PROJECT	MAP 11 4.04 MI.
LENGTH OF ROADWAY PROJECT	MAP 13 0.43 MI.
LENGTH OF ROADWAY PROJECT	MAP 15 0.80 MI.
LENGTH OF ROADWAY PROJECT	MAP 17 0.42 MI.
LENGTH OF ROADWAY PROJECT	MAP 19 0.29 MI.

Prepared in the Office of:  
**DIVISION OF HIGHWAYS**  
113 Airport Dr., Edenton NC, 27932

2012 STANDARD SPECIFICATIONS

**LETTING DATE:**  
February 21, 2012

**W.B. HOBBS, P.E.**  
DIVISION PROJECT MANAGER

**C.E. SLACHTA**  
DIVISION PROPOSALS ENGINEER

**DIVISION OF HIGHWAYS**  
**STATE OF NORTH CAROLINA**

PAVEMENT SCHEDULE

PROJECT REFERENCE NO.	SHEET NO.
1C.028036, ETC	3

C1	PROP. APPROX. 2" ASPHALT CONCRETE SURFACE COURSE, TYPE SF9.5A, AT AN AVERAGE RATE OF 110 LBS. PER SQ. YD. PER INCH. IN EACH OF TWO LAYERS.
P	PRIME COAT TO BE APPLIED AT AN AVERAGE RATE 0.35 GAL. PER SQ YD
T	EARTH MATERIAL.
U	EXISTING AGGREGATE BASE COURSE

NOTES:

- \*ALL PAVED S.R. ROADS TO BE RESURFACED TO THE ENDS OF THE RADI., OR AS DIRECTED BY THE ENGINEER
- \*EDGES, PAVEMENT WIDENING, INTERSECTIONS, AND BRIDGE FLARES ARE INCLUDED IN THE TABLE OF QUANTITIES
- \*PAVEMENT EDGE SLOPES ARE 1:1 UNLESS SHOWN OTHERWISE

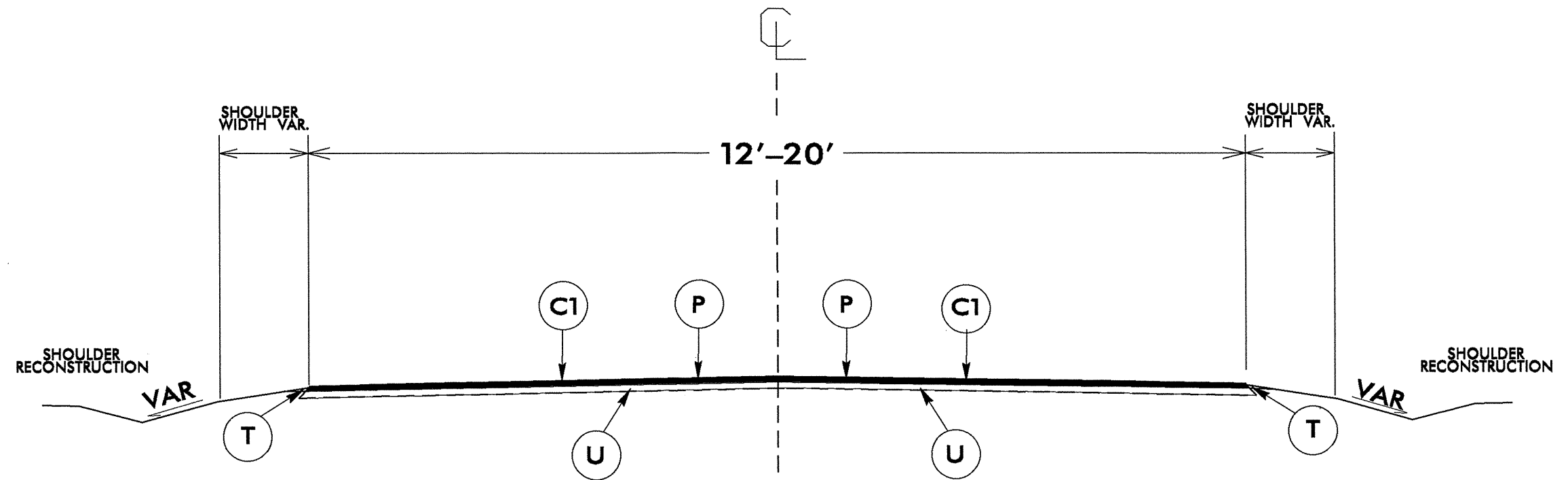

**TYPICAL SECTION NO.1**

USE WITH MAPS 1-4,&7

NTS

20-JAN-2019 07:34  
 S:\Contracts\Resurfacing Projects\Division 1\dare\Revised Files\Prime Coat Revisions\1C.028036, ETC, Title & Typicals.dgn  
 \$\$\$USERNAME\$\$\$

PAVEMENT SCHEDULE

C2	PROP. APPROX. 1½" ASPHALT CONCRETE SURFACE COURSE, TYPE SF9.5A, AT AN AVERAGE RATE OF 165 LBS. PER SQ. YD.
T	EARTH MATERIAL.
U	EXISTING PAVEMENT.

PROJECT REFERENCE NO.	SHEET NO.
1C.028036, ETC	4

NOTES:

\*ALL PAVED S.R. ROADS TO BE RESURFACED TO THE ENDS OF THE RADII., OR AS DIRECTED BY THE ENGINEER

\*EDGES, PAVEMENT WIDENING, INTERSECTIONS, AND BRIDGE FLARES ARE INCLUDED IN THE TABLE OF QUANTITIES

\*PAVEMENT EDGE SLOPES ARE 1:1 UNLESS SHOWN OTHERWISE

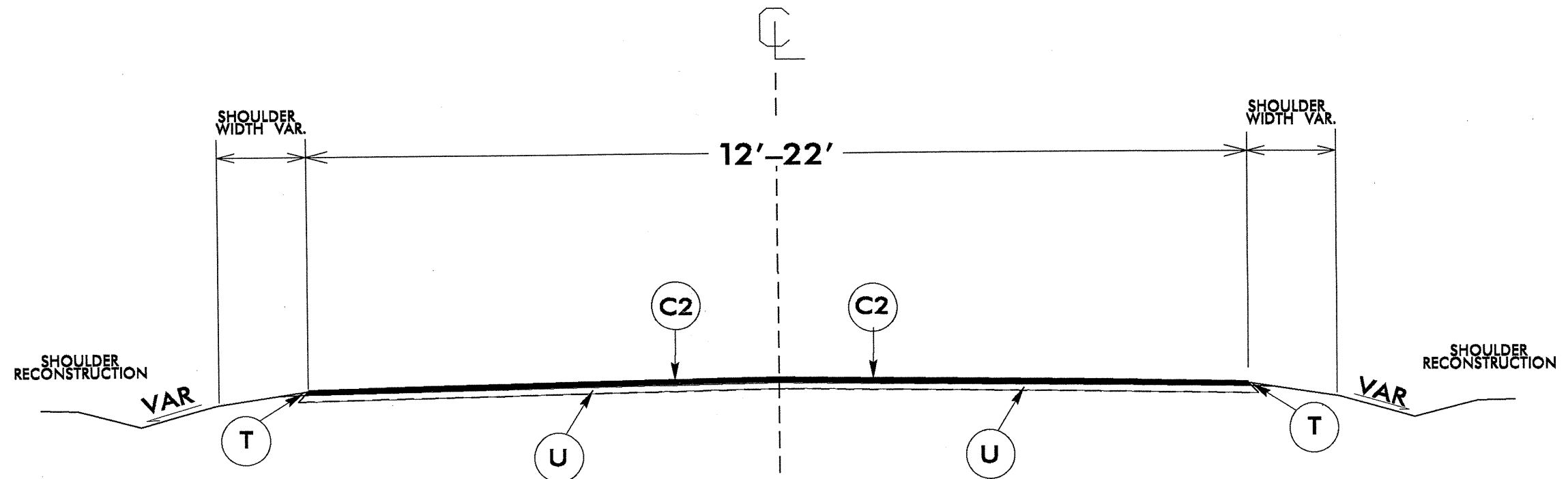

TYPICAL SECTION NO.2

USE WITH MAP 5,6,8-18

NTS

I:\DEC-2011\0917-15-11\contracts\Resurfacing Projects\Division 1\dere\Revised Files\1C.028036, ETC, Title & Typical.dgn  
 15-DEC-2011 09:17  
 15-11-11 10:11:11 AM

PAVEMENT SCHEDULE

PROJECT REFERENCE NO.	SHEET NO.
1C.028036, ETC	5

C2	PROP. APPROX. 1½" ASPHALT CONCRETE SURFACE COURSE, TYPE SF9.5A, AT AN AVERAGE RATE OF 165 LBS. PER SQ. YD.
E1	PROP. APPROX. 5½" ASPHALT CONCRETE BASE COURSE, TYPE B25.0B, AT AN AVERAGE RATE OF 627 LBS. PER SQ. YD.
T	EARTH MATERIAL.
U	EXISTING PAVEMENT.

NOTES:

\*ALL PAVED S.R. ROADS TO BE RESURFACED TO THE ENDS OF THE RADI., OR AS DIRECTED BY THE ENGINEER

\*EDGES, PAVEMENT WIDENING, INTERSECTIONS, AND BRIDGE FLARES ARE INCLUDED IN THE TABLE OF QUANTITIES

\*PAVEMENT EDGE SLOPES ARE 1:1 UNLESS SHOWN OTHERWISE

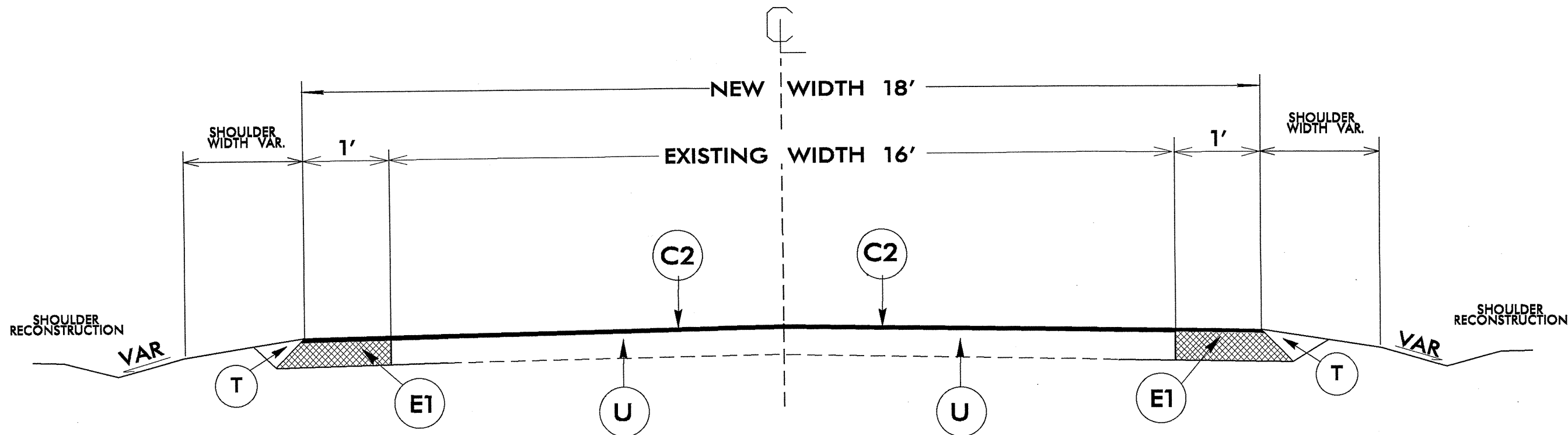

TYPICAL SECTION NO.3

USE WITH MAP 19

NTS

NOTES: Less than 5' - 10' undisturbed buffer from ROW, ditchline, water feature, or drainage inlet, add BMP.

BMP Options: Wattle or Silt Fence

# EROSION CONTROL DETAIL

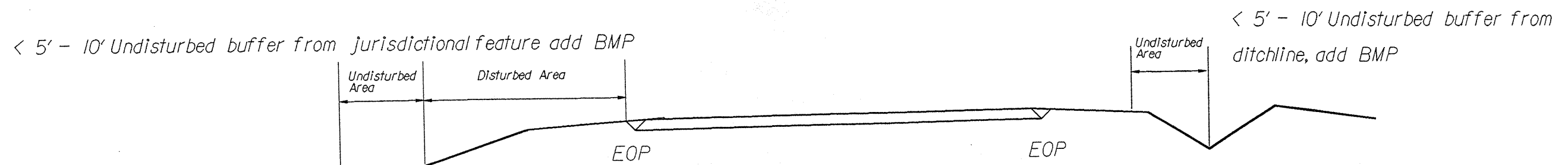
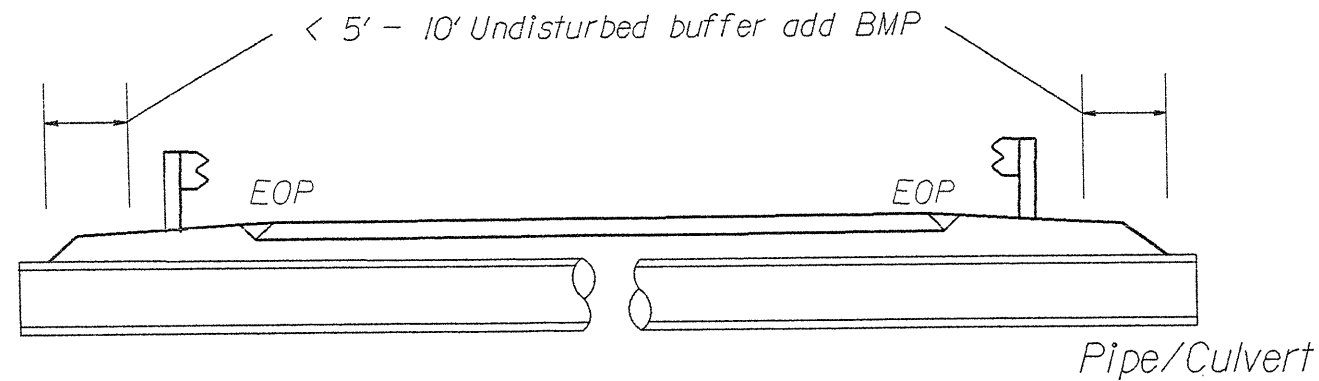

Jurisdictional Feature

Use BMP's if shoulders and/or frontslopes and/or ditchline and/or backslopes are disturbed

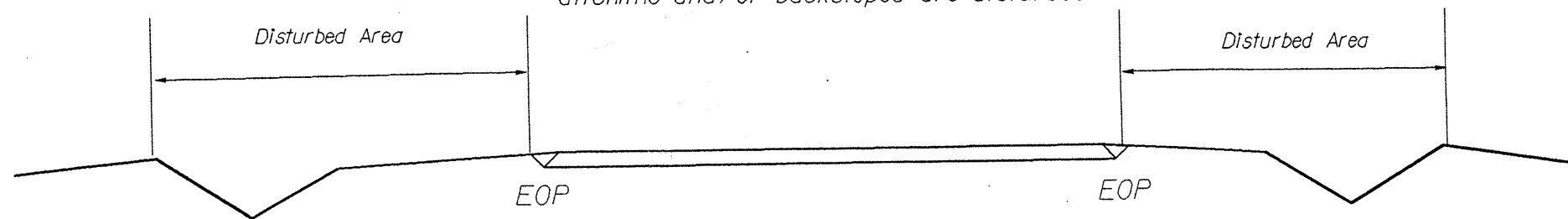

< 5' - 10' Undisturbed buffer from inlet, add wattle

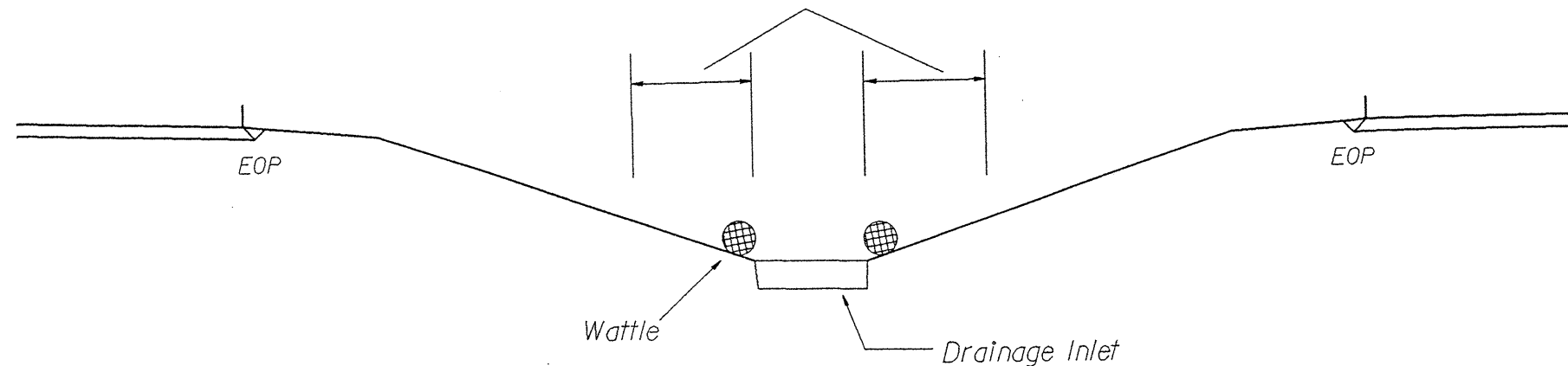

NOT TO SCALE

PROJECT REFERENCE NO. <b>1C.028036, etc.</b>	SHEET NO. <b>7</b>
BY SHEET NO.	
ROADWAY DESIGN ENGINEER	HYDRAULICS ENGINEER

# WATTLE WITH POLYACRYLAMIDE (PAM) DETAIL

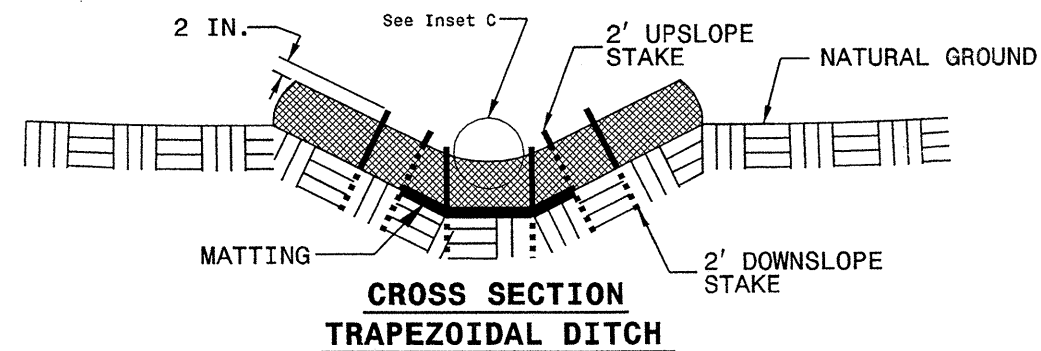
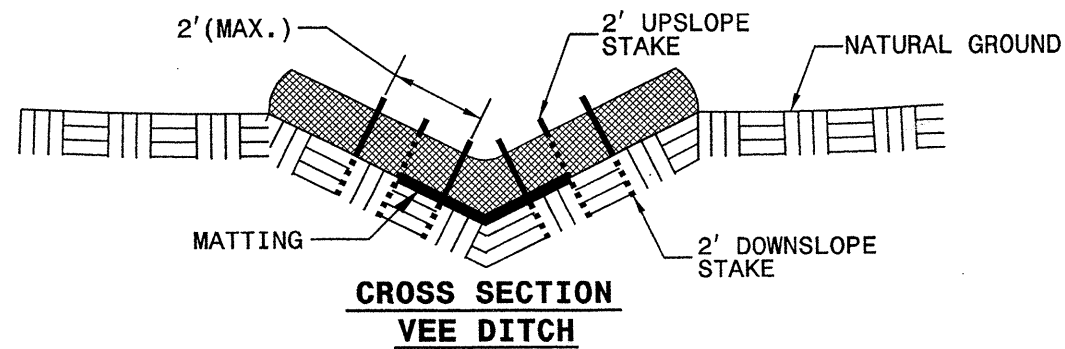
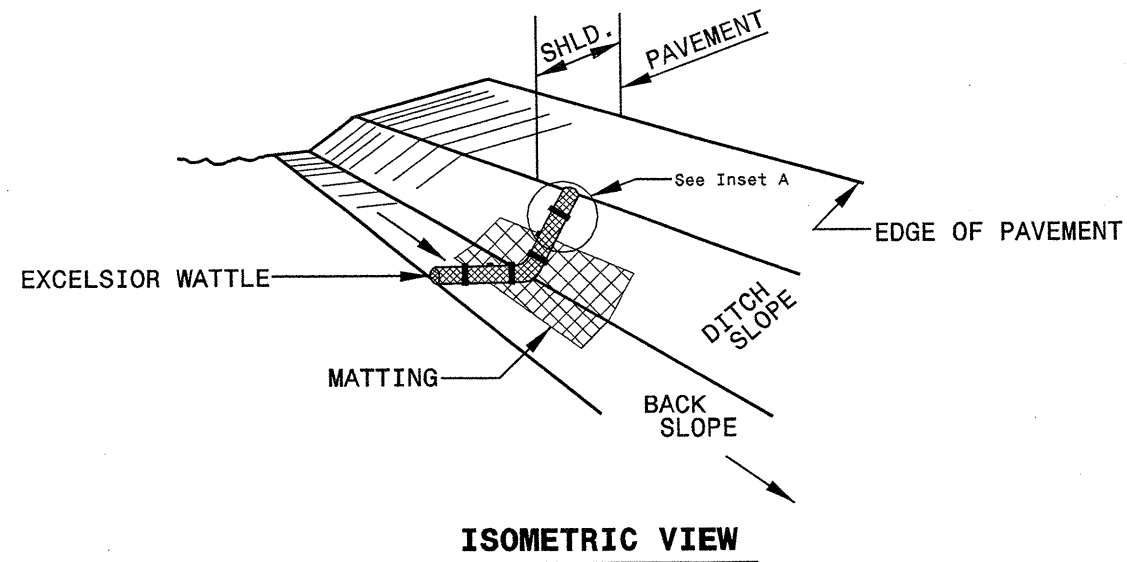

**NOTES:**

USE MINIMUM 12 IN. DIAMETER EXCELSIOR WATTLE.

USE 2 FT. WOODEN STAKES WITH A 2 IN. BY 2 IN. NOMINAL CROSS SECTION.

ONLY INSTALL WATTLE(S) TO A HEIGHT IN DITCH SO FLOW WILL NOT WASH AROUND WATTLE AND SCOUR DITCH SLOPES AND AS DIRECTED.

INSTALL A MINIMUM OF 2 UPSLOPE STAKES AND 4 DOWNSLOPE STAKES AT AN ANGLE TO WEDGE WATTLE TO BOTTOM OF DITCH.

PROVIDE STAPLES MADE OF 0.125 IN. DIAMETER STEEL WIRE FORMED INTO A U SHAPE NOT LESS THAN 12" IN LENGTH.

INSTALL STAPLES APPROXIMATELY EVERY 1 LINEAR FOOT ON BOTH SIDES OF WATTLE AND AT EACH END TO SECURE IT TO THE SOIL.

INSTALL MATTING IN ACCORDANCE WITH SECTION 1631 OF THE STANDARD SPECIFICATIONS.

PRIOR TO POLYACRYLAMIDE (PAM) APPLICATION, OBTAIN A SOIL SAMPLE FROM PROJECT LOCATION, AND FROM OFFSITE MATERIAL, AND ANALYZE FOR APPROPRIATE PAM FLOCCULANT TO BE APPLIED TO EACH WATTLE.

INITIALLY APPLY 2 OUNCES OF ANIONIC OR NEUTRALLY CHARGED PAM OVER WATTLE WHERE WATER WILL FLOW AND 1 OUNCE OF PAM ON MATTING ON EACH SIDE OF WATTLE. REAPPLY PAM AFTER EVERY RAINFALL EVENT THAT IS EQUAL TO OR EXCEEDS 0.50 IN.

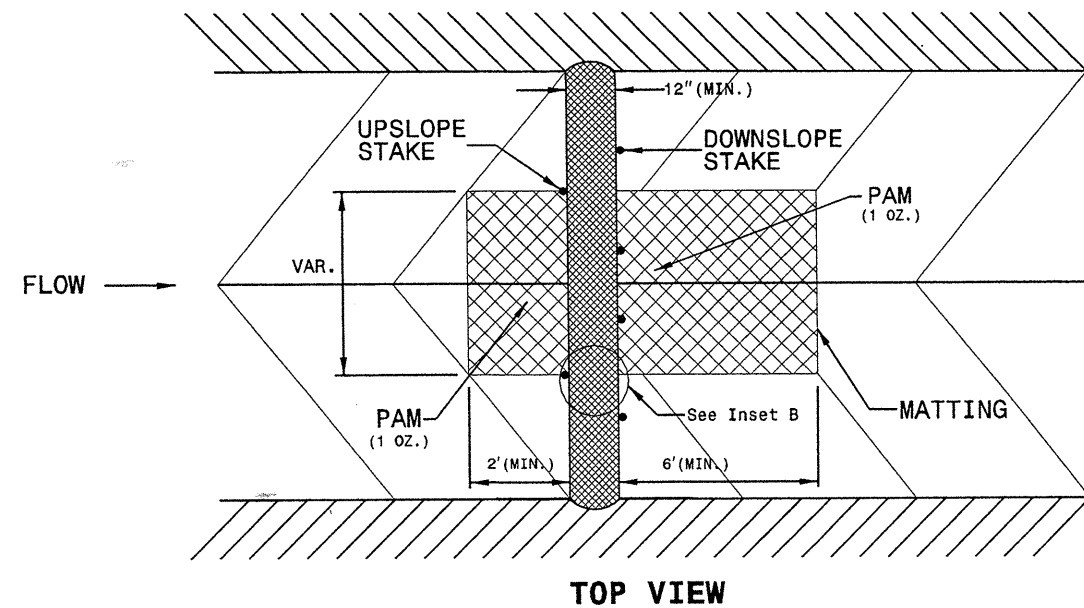
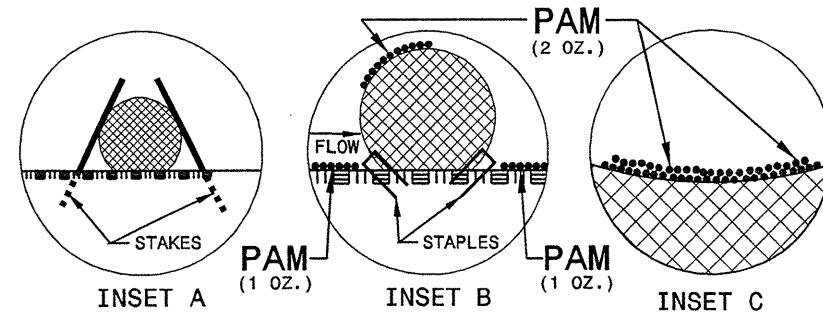

PROJECT REFERENCE NO. <b>1C.028036, ETL</b>	SHEET NO. <b>8</b>
R/W SHEET NO.	
ROADWAY DESIGN ENGINEER	HYDRAULICS ENGINEER

# MATTING INSTALLATION DETAIL

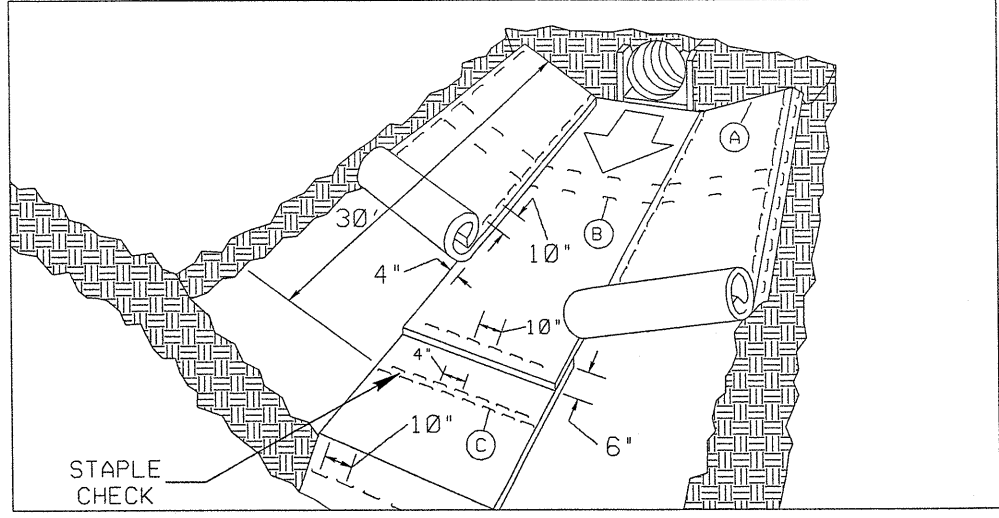

**MATTING IN DITCHES**

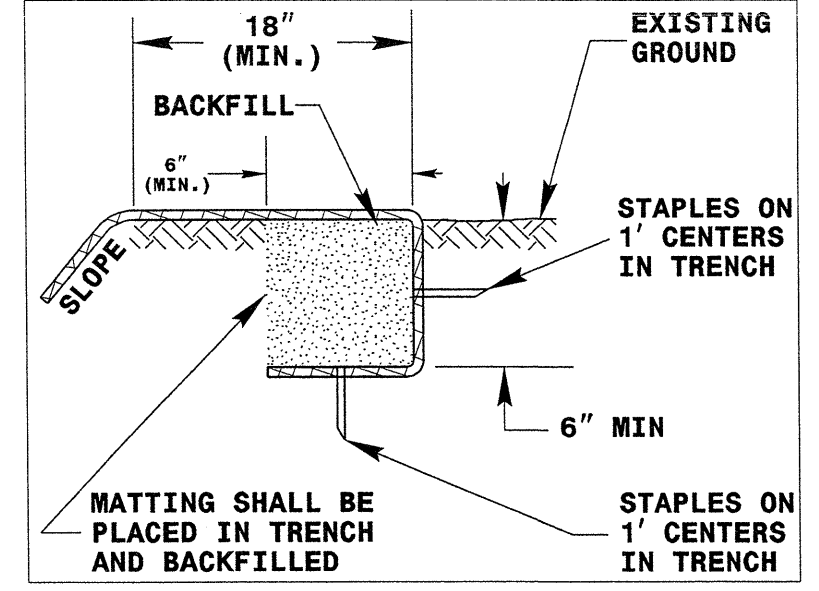
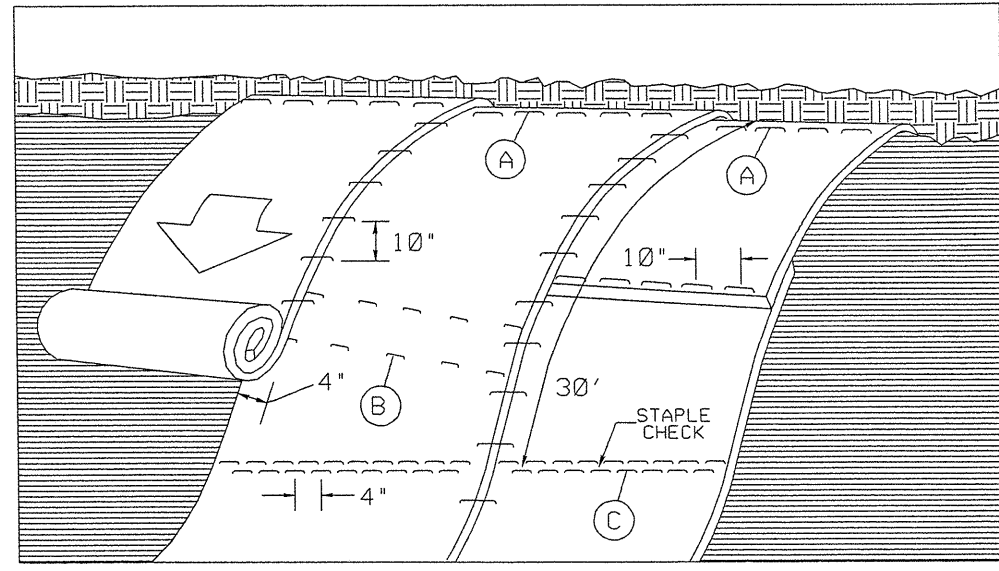

DIAGRAM (A)



**MATTING ON SLOPES**

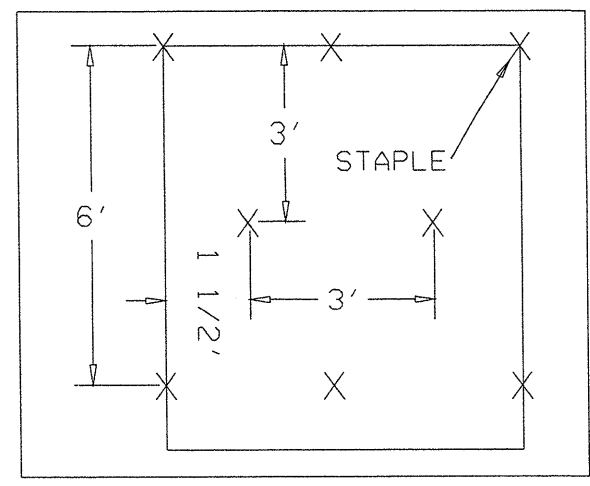

DIAGRAM (B)

STAPLE CHECK PATTERN

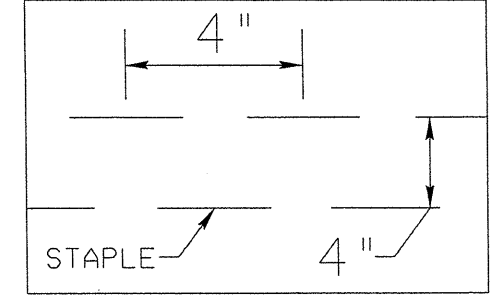

DIAGRAM (C)

NOTES:  
 THIS DETAIL APPLIES TO STRAW, EXCELSIOR, AND PERMANENT SOIL REINFORCEMENT MAT (PSRM) INSTALLATION.  
 STAPLES SHALL BE NO. 11 GAUGE STEEL WIRE FORMED INTO A "U" SHAPE WITH A MINIMUM THROAT WIDTH OF 1 INCH AND NOT LESS THAN 6 INCHES IN LENGTH.

NOT TO SCALE



PROJECT NO.	SHEET NO.	TOTAL NO.
1C.028036, ETC.	9 •	9

### SUMMARY OF QUANTITIES

PROJECT NO	COUNTY	MAP NO	ROUTE	DESCRIPTION	TYP NO	FINAL SURFACE TESTING REQUIRED	LENGTH MI	WIDTH FT	MOBILIZATION LS	BORROW CY	CONDITIONING EXISTING BASE MSY	INCIDENTAL STONE BASE TONS	SHOULDER RECONSTRUCTION SMI	INCIDENTAL MILLING SY	BASE COURSE, B25.0B TONS	SURFACE COURSE, SF9.5A TONS	ASPHALT BINDER PLANT MIX TONS	ADJ. OF METER OR VALVE BOX EA	TEMPORARY SILT FENCE LF	MATTING FOR EROSION CONTROL SY	WATTLE LF	POLYACRYLAMIDE (PAM) LB	SEED & MULCHING AC	PRIME COAT GAL
1C.028036	Dare	1	SR 1536	FROM SR 1276 TO END MAINTENANCE	1	NO	0.124	18	1	10	1	1	0.25			159	11	1					0.25	444
1C.028039	Dare	2	SR 1498	FROM SEA OATS DR. TO END MAINTENANCE	1	NO	0.199	20	*	10	2	1	0.40			254	17	2					0.25	822
1C.028040	Dare	3	SR 1453	FROM SR 1452 TO END MAINTENANCE	1	NO	0.070	16	*	10	1	1	0.14			105	7						0.25	230
1C.028041	Dare	4	SR 1135	FROM END PAVEMENT TO END MAINTENANCE	1	NO	0.130	12	*	10	1	1	0.26			96	6		700	32	8	7	0.25	320
1C.028045	Dare	5	SR 1224	FROM NC 12 TO SR 1226	2	NO	0.760	19	*	10		1	1.52			803	54						2	
1C.028047	Dare	6	SR 1286	FROM NC 12 TO END MAINTENANCE	2	NO	0.230	18	*	10		1	0.46			222	15						0.25	
1C.028048	Dare	7	SR 1509	FROM SR 1508 TO END MAINTENANCE	1	NO	0.110	18	*	10	1	1	0.22			121	8	2					0.25	407
1C.028049	Dare	8	SR 1421	FROM SR NC 12 TO END OF MAINT	2	NO	1.140	21	*	50		10	2.3			1266	85		20				1	
1C.028050	Dare	9	SR 1228	FROM SR 1229 TO SR 1226	2	NO	0.190	12	*	10		1	0.38			212	14						0.25	
1C.028051	Dare	10	SR 1227	FROM SR 1224 TO SR 1226	2	NO	0.250	20	*	10		1	0.50			264	18	1					0.50	
1CR.10281.18	Dare	11	NC 12	New Pavement to SR 1467	2	NO	4.040	22	*	200		25	8.08			5191	348	1	200	32	8	7	3	
1CR.20281.78	Dare	12	SR 1208	SR 1210 TO END OF PAVEMENT	2	NO	1.098	19	*	50		10	2.20	444		1,250	84		1,000	32	8	7	1	
1CR.20281.79	Dare	13	SR 1145	NC 345 TO SR 1168	2	NO	0.425	17	*	10		1	0.85			500	34						0.75	
1CR.20281.80	Dare	14	SR 1208	SR 1210 TO SR 1206	2	NO	0.170	22	*	10		1	0.34			300	20						0.25	
1CR.20281.81	Dare	15	SR 1146	SR 1145 TO SR 1320	2	NO	0.795	17	*	10		1	1.59			750	50						1	
1CR.20281.82	Dare	16	SR 1117	US 64 TO THE DEAD END	2	NO	0.587	20	*	10		1	1.17			601	40						1	
1CR.20281.83	Dare	17	SR 1146	SR 1320 TO SR 1147	2	NO	0.420	17	*	10		1	0.84			348	23						0.50	
1CR.20281.84	Dare	18	SR 1207	FROM SR 1208 TO SR 1206	2	NO	0.390	18	*	10		1	0.78			400	27		650	32	8	7	0.50	
1CR.20281.85	Dare	19	SR 1148	SR 1168 TO SR 1146	3	NO	0.290	18	*	10		1	0.58		151	304	27						0.50	
<b>GRAND TOTAL</b>							<b>11.418</b>		<b>1</b>	<b>460</b>	<b>6</b>	<b>61</b>	<b>22.86</b>	<b>444</b>	<b>151</b>	<b>13,146</b>	<b>888</b>	<b>7</b>	<b>2,570</b>	<b>128</b>	<b>32</b>	<b>28</b>	<b>13.75</b>	<b>2,223.00</b>

### THERMOPLASTIC AND PAINT QUANTITIES

PROJECT NO	COUNTY	MAP NO	ROUTE	DESCRIPTION	LENGTH	WIDTH	TEMPORARY TRAFFIC CONTROL LS	4" X 90 M WHITE THERMO LF	4" X 120 M YELLOW THERMO LF	24" X 120 M WHITE THERMO LF	THERMO STR & RT ARROW 90M EA	THERMO STR ARROW 90M EA	THERMO LT ARROW 90M EA	4" WHITE PAINT LF	4" YELLOW PAINT LF	24" WHITE PAINT LF	YELLOW & YELLOW MARKERS EA
1C.028036	Dare	1	SR 1536	FROM SR 1276 TO END MAINTENANCE	0.12	18	1										
1C.028039	Dare	2	SR 1498	FROM SEA OATS DR. TO END MAINTENANCE	0.20	20	*										
1C.028040	Dare	3	SR 1453	FROM SR 1452 TO END OF MAINTENANCE	0.07	16	*										
1C.028041	Dare	4	SR 1135	FROM END PAVEMENT TO END MAINTENANCE	0.13	12	*										
1C.028045	Dare	5	SR 1224	FROM NC 12 TO SR 1226	0.76	19	*	8,178	8,000					8,178	8,000		
1C.028047	Dare	6	SR 1286	FROM NC 12 TO END MAINTENANCE	0.23	18	*										
1C.028048	Dare	7	SR 1509	FROM SR 1508 TO END MAINTENANCE	0.11	18	*										
1C.028049	Dare	8	SR 1421	FROM NC 12 TO END MAINTENANCE	1.14	21	*	12,266	12,275					12,266	12,275		
1C.028050	Dare	9	SR 1228	FROM SR 1229 TO SR 1226	0.19	12	*										
1C.028051	Dare	10	SR 1227	FROM SR 1224 TO SR 1226	0.25		*										
1CR.10281.18	Dare	11	NC 12	New Pavement to SR 1417	4.04	22	*	43,470	26,664	410	6	2	10	43,470	26,664	200	125
1CR.20281.78	Dare	12	SR 1208	SR 1210 TO END OF PAVEMENT	1.10	19	*	11,814	11,814					11,814	11,814		
1CR.20281.79	Dare	13	SR 1145	NC 345 TO SR 1168	0.43	17	*	4,573	2,805					4,573	2,805		
1CR.20281.80	Dare	14	SR 1208	SR 1210 TO SR 1206	0.17	22	*	1,829	1,829					1,829	1,829		
1CR.20281.81	Dare	15	SR 1146	SR 1145 TO SR 1320	0.80	17	*	5,600	5,600					5,600	5,600		
1CR.20281.82	Dare	16	SR 1117	US 64 TO THE DEAD END	0.59	20	*	6,316	2,822					6,316	2,822		
1CR.20281.83	Dare	17	SR 1146	SR 1320 TO SR 1147	0.42	17	*	4,519	2,772					4,519	2,772		
1CR.20281.84	Dare	18	SR 1207	FROM SR 1208 TO SR 1206	0.39	18	*	4,196	4,196					4,196	4,196		
1CR.20281.85	Dare	19	SR 1148	SR 1168 TO SR 1146	0.29	18	*	3,120	1,914					3,120	1,914		
<b>GRAND TOTAL</b>					<b>11.42</b>		<b>1</b>	<b>105,881</b>	<b>80,691</b>	<b>410</b>	<b>6</b>	<b>2</b>	<b>10</b>	<b>105,881</b>	<b>80,691</b>	<b>200</b>	<b>125</b>