

STATE OF NORTH CAROLINA
DIVISION OF HIGHWAYS

TRANSPORTATION MANAGEMENT PLAN

NASH COUNTY

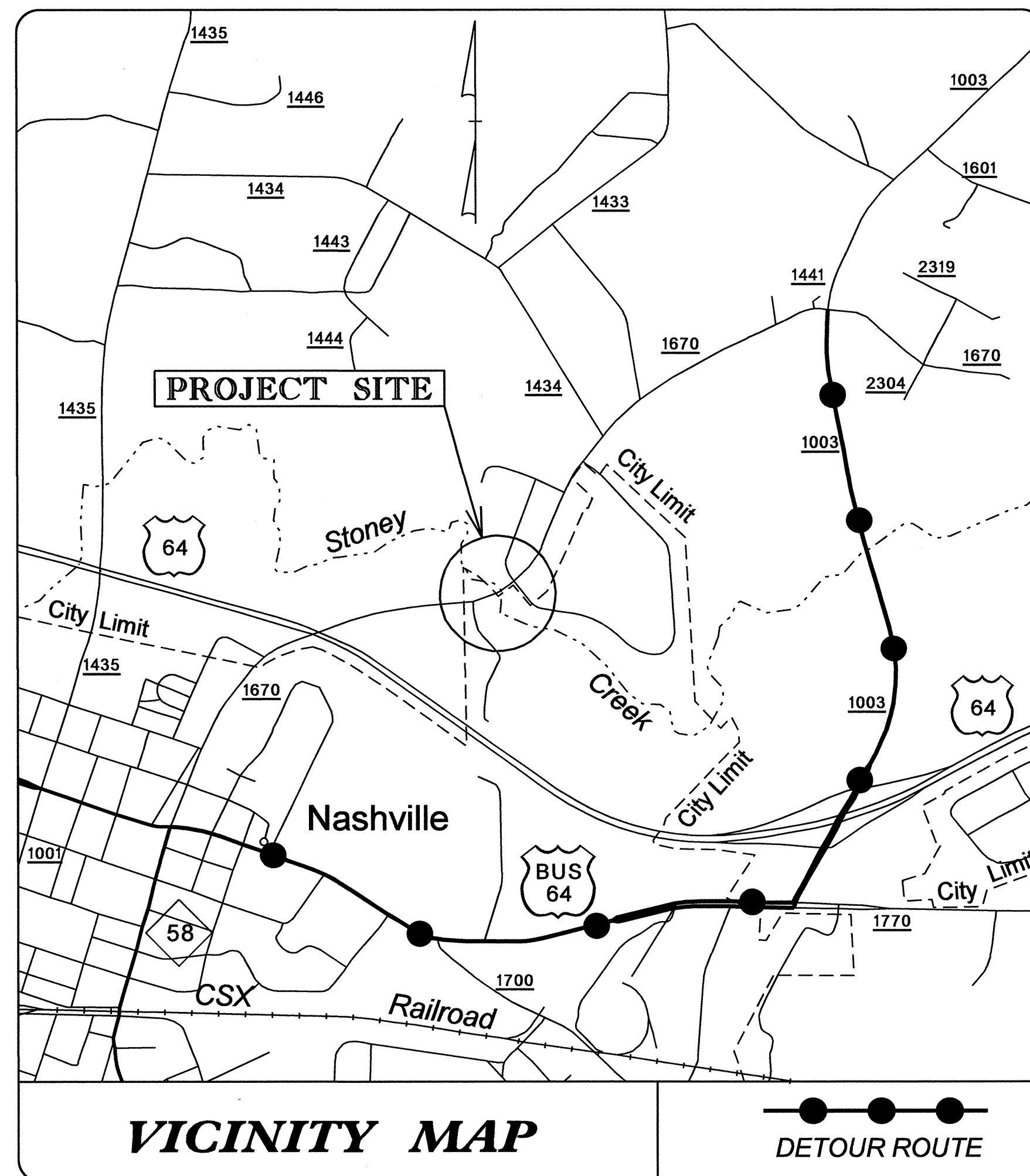
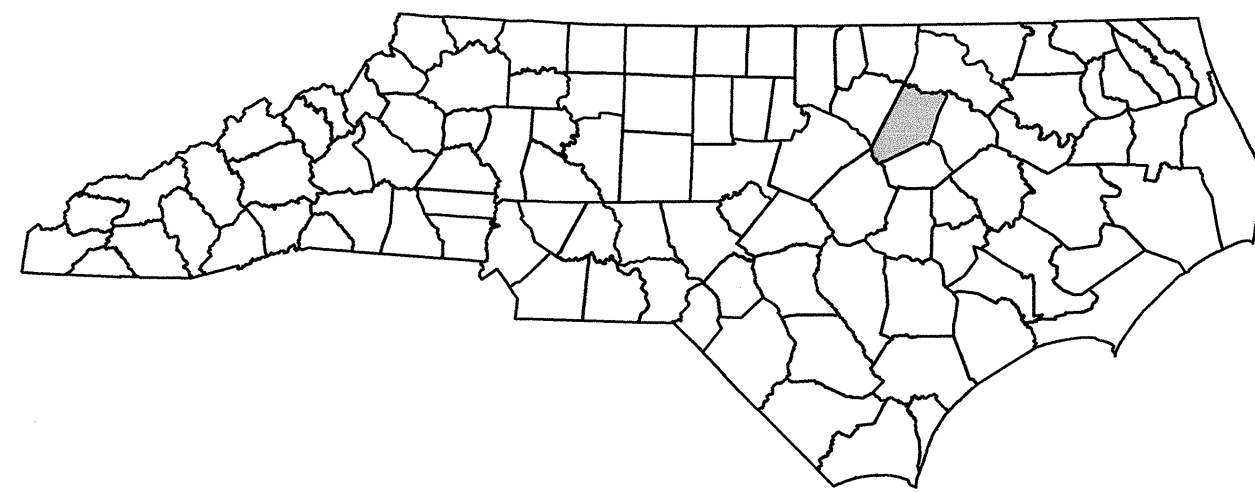

INDEX OF SHEETS

SHEET NO.	TITLE
TMP-1	TITLE SHEET, LEGEND AND INDEX OF SHEETS
TMP-1A	LIST OF APPLICABLE ROADWAY STANDARD DRAWINGS, TRANSPORTATION OPERATIONS PLAN (CONSISTS OF GENERAL NOTES) AND PROJECT PHASING
TMP-2	DETOUR ROUTE AND SIGNING FOR SR 1502

LEGEND

GENERAL

—+— NORTH ARROW

■ WORK AREA

TRAFFIC CONTROL DEVICES

▨ BARRICADE (TYPE III)

TEMPORARY SIGNING

⊥ STATIONARY SIGN

03-0CT-2011\420\dot\dfs\root\01\proj\TIP\proj\TrafficControl\TCP\b4588.tc.tmp_01.dgn
AT TE24749
dougjoyner

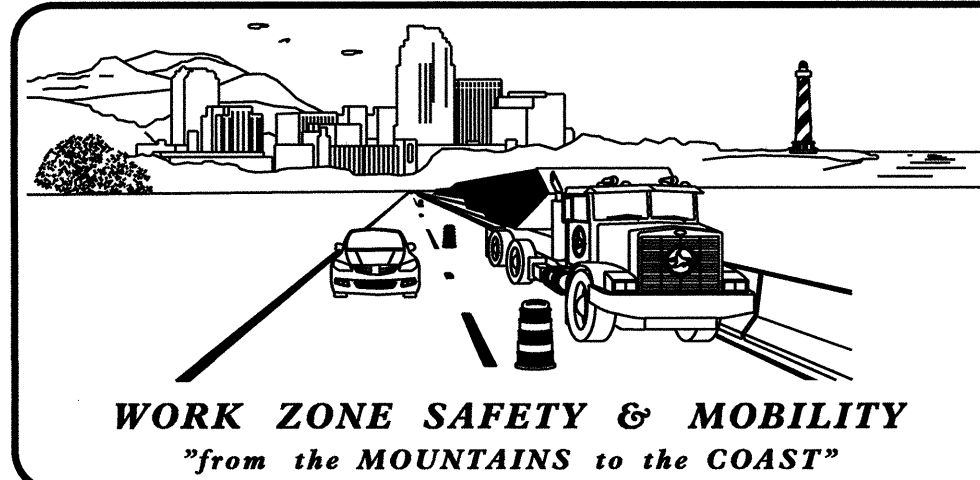

N.C.D.O.T. WORK ZONE TRAFFIC CONTROL
1561 MAIL SERVICE CENTER (MSC) RALEIGH, NC 27699-1561
750 N. GREENFIELD PARKWAY, GARNER, NC 27529 (DELIVERY)
PHONE: (919) 773-2800 FAX: (919) 771-2745

J. S. BOURNE, P.E. STATE TRAFFIC MANAGEMENT ENGINEER
STEVE KITE, P.E. TRAFFIC CONTROL PROJECT ENGINEER
DON PARKER TRAFFIC CONTROL PROJECT DESIGN ENGINEER
DOUG JOYNER TRAFFIC CONTROL DESIGN ENGINEER / TECHNICIAN

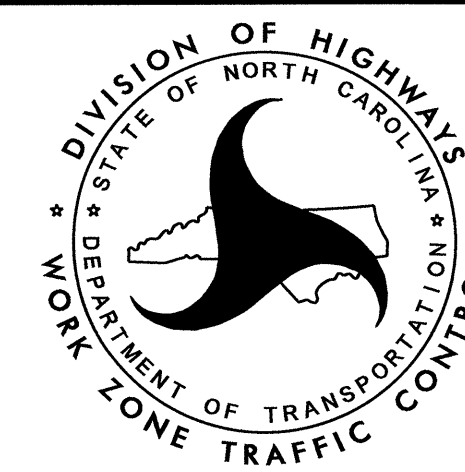

APPROVED: *[Signature]*
DATE: October 6, 2011

SEAL

B-4588

TIP PROJECT:

SHEET NO.
TMP-1

ROADWAY STANDARD DRAWINGS

THE FOLLOWING ROADWAY STANDARDS AS SHOWN IN "ROADWAY STANDARD DRAWINGS" - PROJECT SERVICES UNIT - N.C. DEPARTMENT OF TRANSPORTATION - RALEIGH, N.C., DATED JULY 2006 ARE APPLICABLE TO THIS PROJECT AND BY REFERENCE HEREBY ARE CONSIDERED A PART OF THESE PLANS:

<u>STD. NO.</u>	<u>TITLE</u>
1101.03	TEMPORARY ROAD CLOSURES
1110.01	STATIONARY WORK ZONE SIGNS
1145.01	BARRICADES
1261.01	GUARDRAIL & BARRIER DELINEATOR SPACING
1261.02	GUARDRAIL & BARRIER DELINEATOR TYPES
1262.01	GUARDRAIL END DELINEATION
1264.01	OBJECT MARKERS
1264.02	PLACEMENT OF OBJECT MARKERS

GENERAL NOTES

CHANGES MAY BE REQUIRED WHEN PHYSICAL DIMENSIONS IN THE DETAIL DRAWINGS, STANDARD DETAILS, AND ROADWAY DETAILS ARE NOT ATTAINABLE TO MEET FIELD CONDITIONS OR RESULT IN DUPLICATE OR UNDESIRABLE OVERLAPPING OF DEVICES. MODIFICATION MAY INCLUDE: MOVING, SUPPLEMENTING, COVERING, OR REMOVAL OF DEVICES AS DIRECTED BY THE ENGINEER.

THE FOLLOWING GENERAL NOTES APPLY AT ALL TIMES FOR THE DURATION OF THE CONSTRUCTION PROJECT EXCEPT WHEN OTHERWISE NOTED IN THE PLAN OR DIRECTED BY THE ENGINEER.

TRAFFIC PATTERN ALTERATIONS

A) NOTIFY THE ENGINEER THIRTY (30) CALENDAR DAYS PRIOR TO ANY TRAFFIC PATTERN ALTERATION.

SIGNING

B) CONTRACTOR WILL BE RESPONSIBLE FOR PROVIDING PERMANENT SIGNING.

C) PROVIDE SIGNING AND DEVICES REQUIRED TO CLOSE THE ROAD ACCORDING TO THE ROADWAY STANDARD DRAWINGS AND TRAFFIC CONTROL PLANS.

PROVIDE SIGNING REQUIRED FOR THE OFF-SITE DETOUR ROUTE AS SHOWN IN THE TRAFFIC CONTROL PLANS.

D) COVER OR REMOVE ALL SIGNS AND DEVICES REQUIRED TO CLOSE THE ROAD WHEN ROAD CLOSURE IS NOT IN OPERATION.

COVER OR REMOVE ALL SIGNS REQUIRED FOR THE OFF-SITE DETOUR WHEN THE DETOUR IS NOT IN OPERATION.

E) ENSURE ALL NECESSARY SIGNING IS IN PLACE PRIOR TO ALTERING ANY TRAFFIC PATTERN.

TRAFFIC CONTROL DEVICES

F) PLACE TYPE III BARRICADES, WITH "ROAD CLOSED" SIGN R11-2 ATTACHED, OF SUFFICIENT LENGTH TO CLOSE ENTIRE ROADWAY.



PAVEMENT MARKINGS AND MARKERS

G) INSTALL PAVEMENT MARKINGS AND PAVEMENT MARKERS ON THE FINAL SURFACE AS SHOWN IN THE PAVEMENT MARKING PLAN.

PROJECT PHASING

- 1) USING ROADWAY STANDARD DRAWING 1101.03, SHEET 1 OF 9 & TMP-2, CLOSE SR 1670 AND DETOUR TRAFFIC.
- 2) REMOVE EXISTING BRIDGE AND CONSTRUCT PROPOSED BRIDGE AND APPROACHES, UP TO AND INCLUDING THE FINAL LAYER OF SURFACE COURSE.
- 3) PLACE FINAL PAVEMENT MARKINGS/MARKERS AS PER FINAL PAVEMENT MARKING PLANS. REMOVE ALL TRAFFIC CONTROL DEVICES AND RE-OPEN SR 1670 TO TRAFFIC.

03-OCT-2011 14:22
 \\dot\dfsroot\proj\proj\Tpp\Projects-B\B4588\Traffic\TrafficControl\TCP\b4588.tc.tmp.0l.dgn
 dougjoynes AT 1E24743

APPROVED:  DATE: 10/3/11 		TRANSPORTATION OPERATIONS PLAN, ROADWAY STANDARD DRAWINGS AND PROJECT PHASING
--	---	--

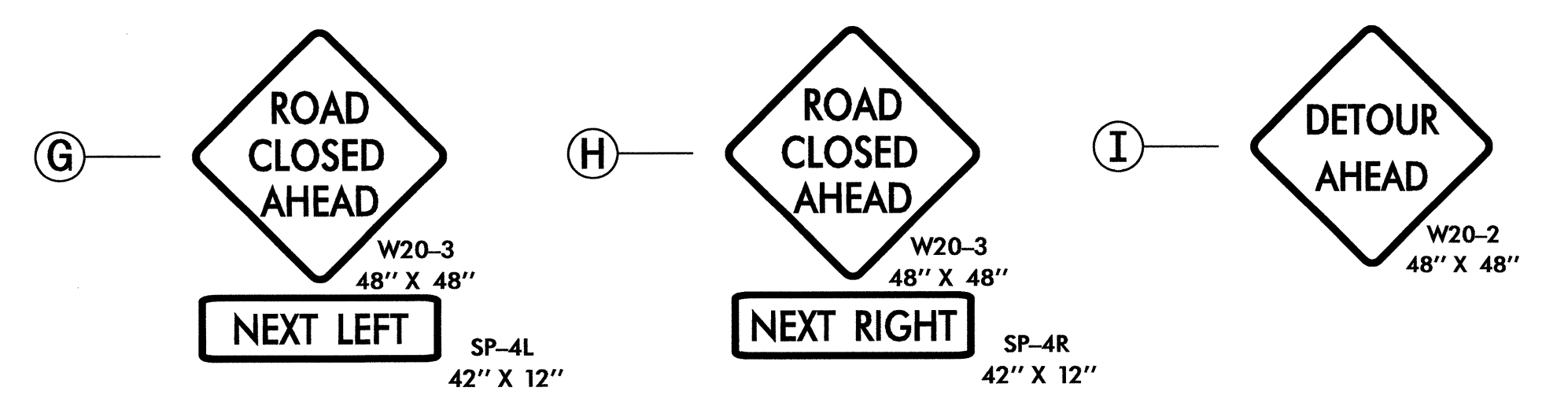
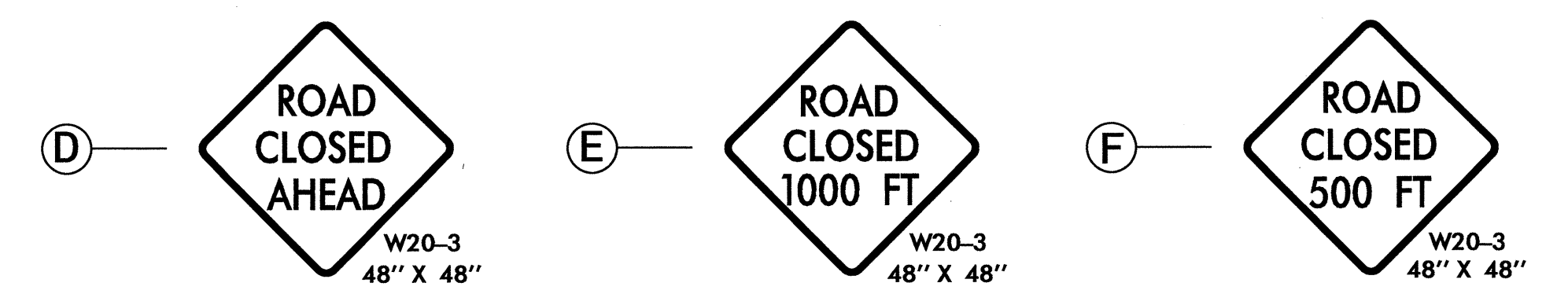
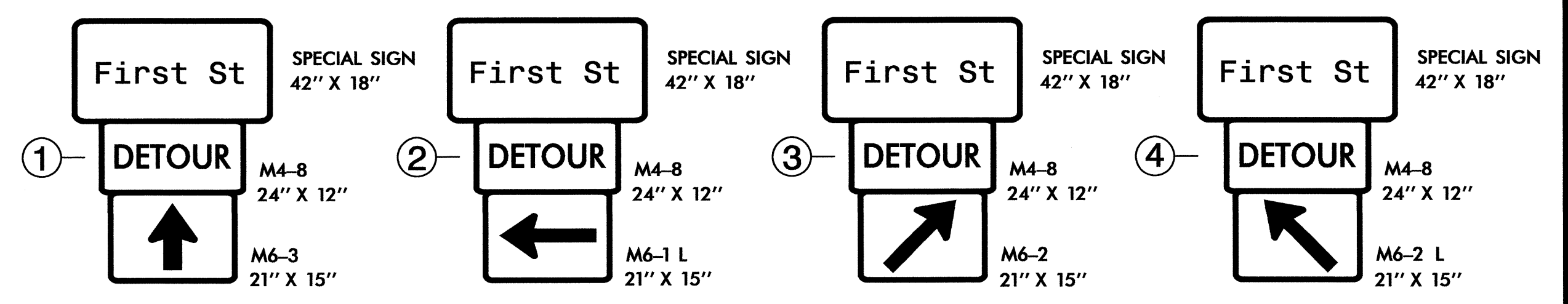
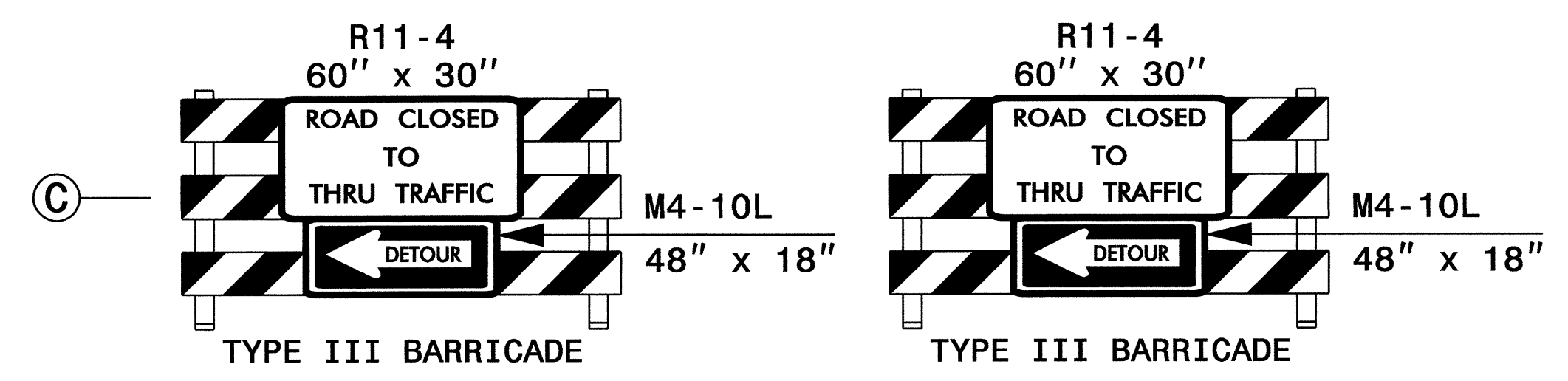
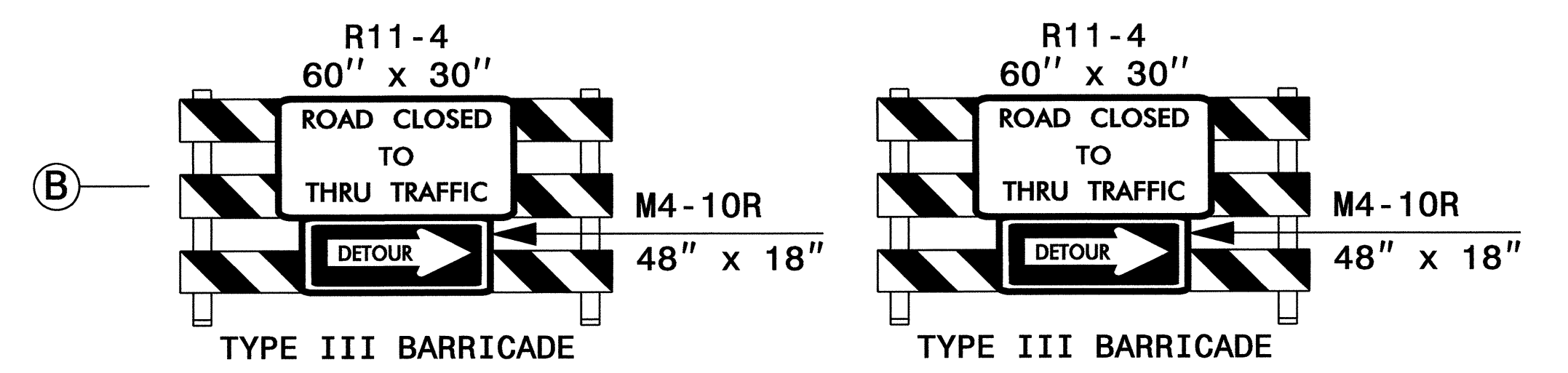
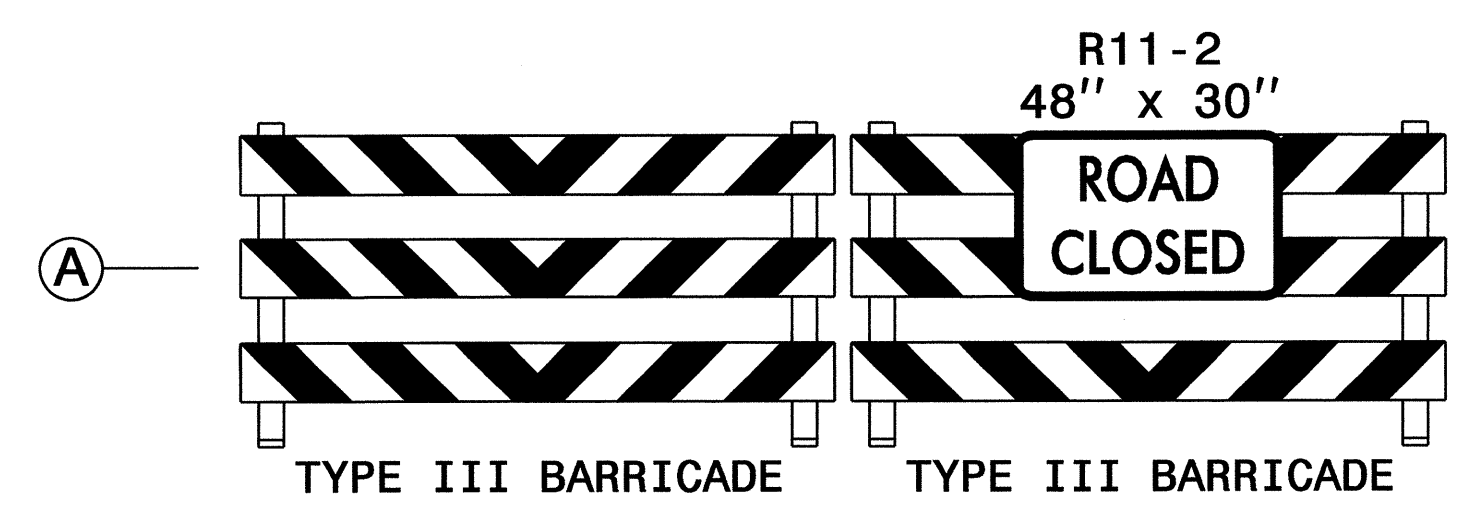
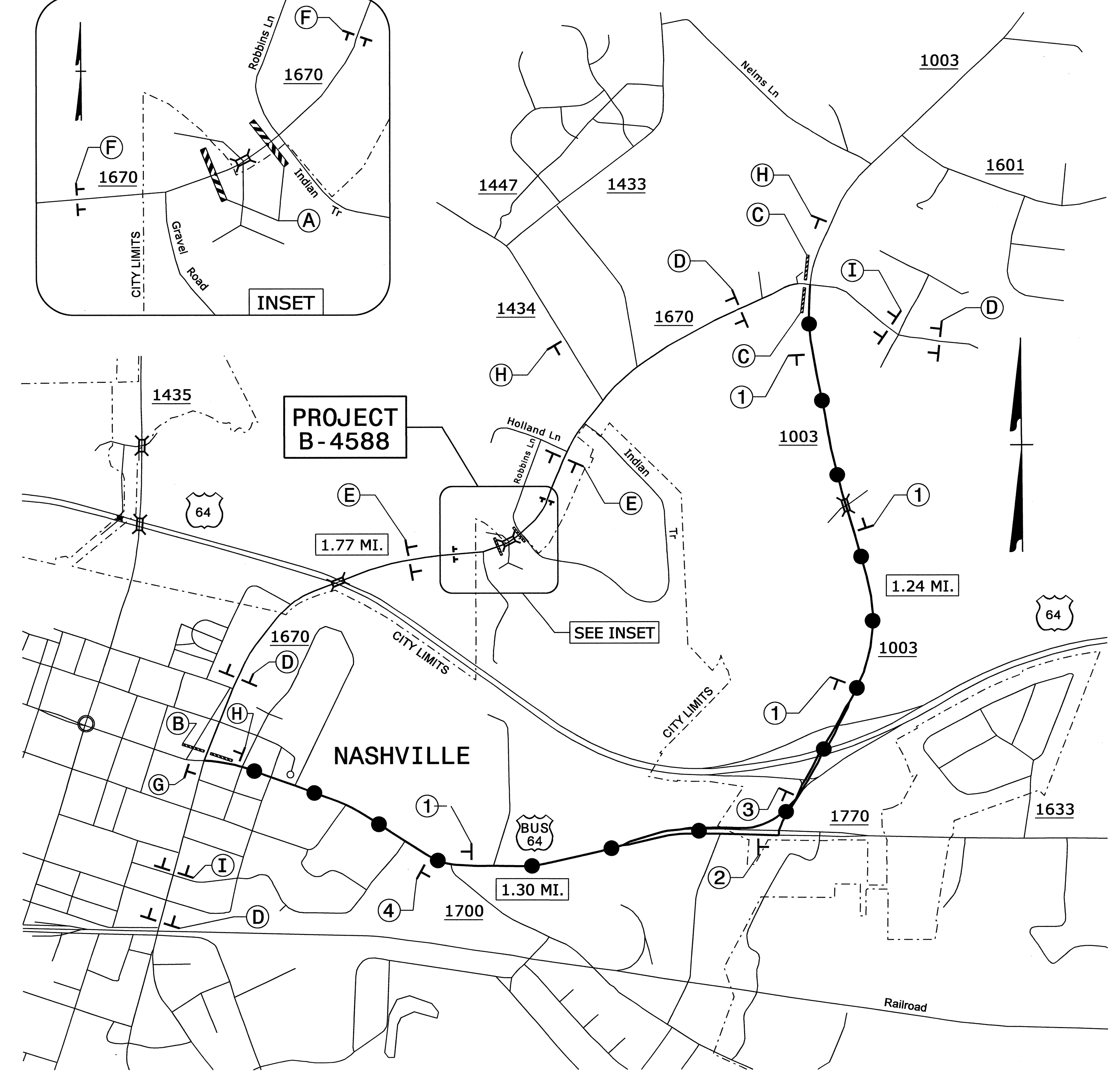
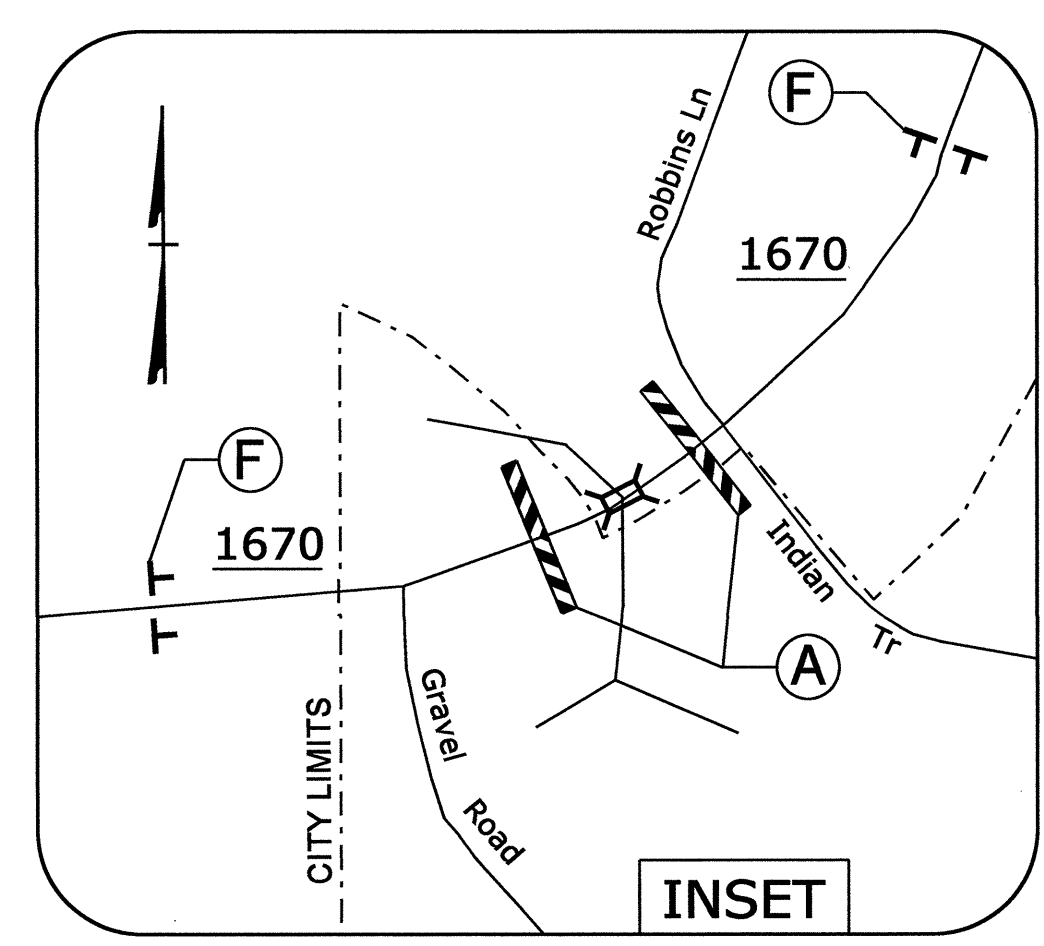

● ● ● ●
DENOTES DETOUR

NOTE: SEE RSD 1101.03, SHEET 1 OF 9 FOR ADVANCE WARNING SIGNAGE AND BARRICADE PLACEMENT

APPROVED: <i>[Signature]</i> DATE: 10/3/11		DETOUR ROUTE AND SIGNING

03-OCT-2011 14:24
 \\dot.vfsr001\pco\lppr-projects-B\B4588-TrafficControl\CP\B4588.tc.tmp_02.dgn
 dougjoynes AT 12:47:49