

**STATE OF NORTH CAROLINA  
DEPARTMENT OF TRANSPORTATION**

**PAVEMENT MARKING PLAN  
NASH COUNTY**

**LOCATION: BRIDGE NO.1 OVER STONEY CREEK ON SR 1670**

TIP NO. B-4588	SHEET NO. PMP-1
APPROVED: <i>Ayman Alqudwah</i>	
DATE: 11-4-11	
SEAL	



**T.I.P.: B-4588**

**CONTRACT: C202749**

**ROADWAY STANDARD DRAWING**

THE FOLLOWING ROADWAY STANDARDS AS APPEAR IN "ROADWAY STANDARD DRAWINGS" - PROJECT SERVICES UNIT - N.C. DEPARTMENT OF TRANSPORTATION - RALEIGH, N.C., DATED JULY 2006 ARE APPLICABLE TO THIS PROJECT AND BY REFERENCE HEREBY ARE CONSIDERED A PART OF THESE PLANS:

STD. NO.	TITLE
1205.01	PAVEMENT MARKINGS - LINE TYPES AND OFFSETS
1205.02	PAVEMENT MARKINGS - 2 LANE AND MULTILANE ROADWAYS
1205.12	PAVEMENT MARKINGS - BRIDGES
1261.01	GUARDRAIL AND BARRIER DELINEATOR SPACING
1261.02	GUARDRAIL AND BARRIER DELINEATOR TYPES
1262.01	GUARDRAIL END DELINEATION

**GENERAL NOTES**

THE FOLLOWING GENERAL NOTES APPLY AT ALL TIMES FOR THE DURATION OF THE CONSTRUCTION PROJECT, EXCEPT WHEN OTHERWISE NOTED IN THE PLAN, OR DIRECTED BY THE ENGINEER.

- A) INSTALL PAVEMENT MARKINGS AND PAVEMENT MARKERS ON THE FINAL SURFACE AS FOLLOWS:
- | ROAD NAME | MARKING | MARKER |
|-----------|---------|--------|
| SR 1670   | PAINT   | NONE   |
- B) TIE PROPOSED PAVEMENT MARKING LINES TO EXISTING PAVEMENT MARKING LINES.
  - C) REMOVE/REPLACE ANY CONFLICTING/DAMAGED PAVEMENT MARKINGS AND MARKERS.
  - D) PASSING ZONES WILL BE DETERMINED IN THE FIELD AND MUST BE APPROVED BY THE ENGINEER.

**PAVEMENT  
MARKING SCHEDULE**

SYMBOL	DESCRIPTION
PA WHITE EDGELINE	PAINT
PD 2 FT. - 6 FT./SP WHITE MINISKIP	PAINT
PI YELLOW DOUBLE CENTER	PAINT

PLAN PREPARED BY: N.C.D.O.T. SIGNING AND DELINEATION UNIT

AYMAN ALQUDWAH, P.E. SIGNING & DELINEATION REGIONAL ENGINEER

ERIC WARD SIGNING & DELINEATION DESIGN ENGINEER

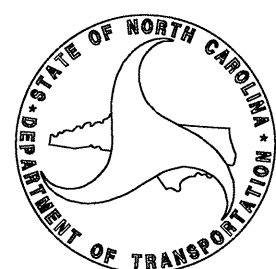

**INDEX**

SHEET NO.	DESCRIPTION
PMP-1	PAVEMENT MARKING PLAN TITLE AND SCHEDULE SHEET
PMP-2	PAVEMENT MARKING DETAIL

TIP NO. B-4588	SHEET NO. PMP-2
APPROVED: <i>[Signature]</i>	
DATE: 9-20-11	
SEAL	

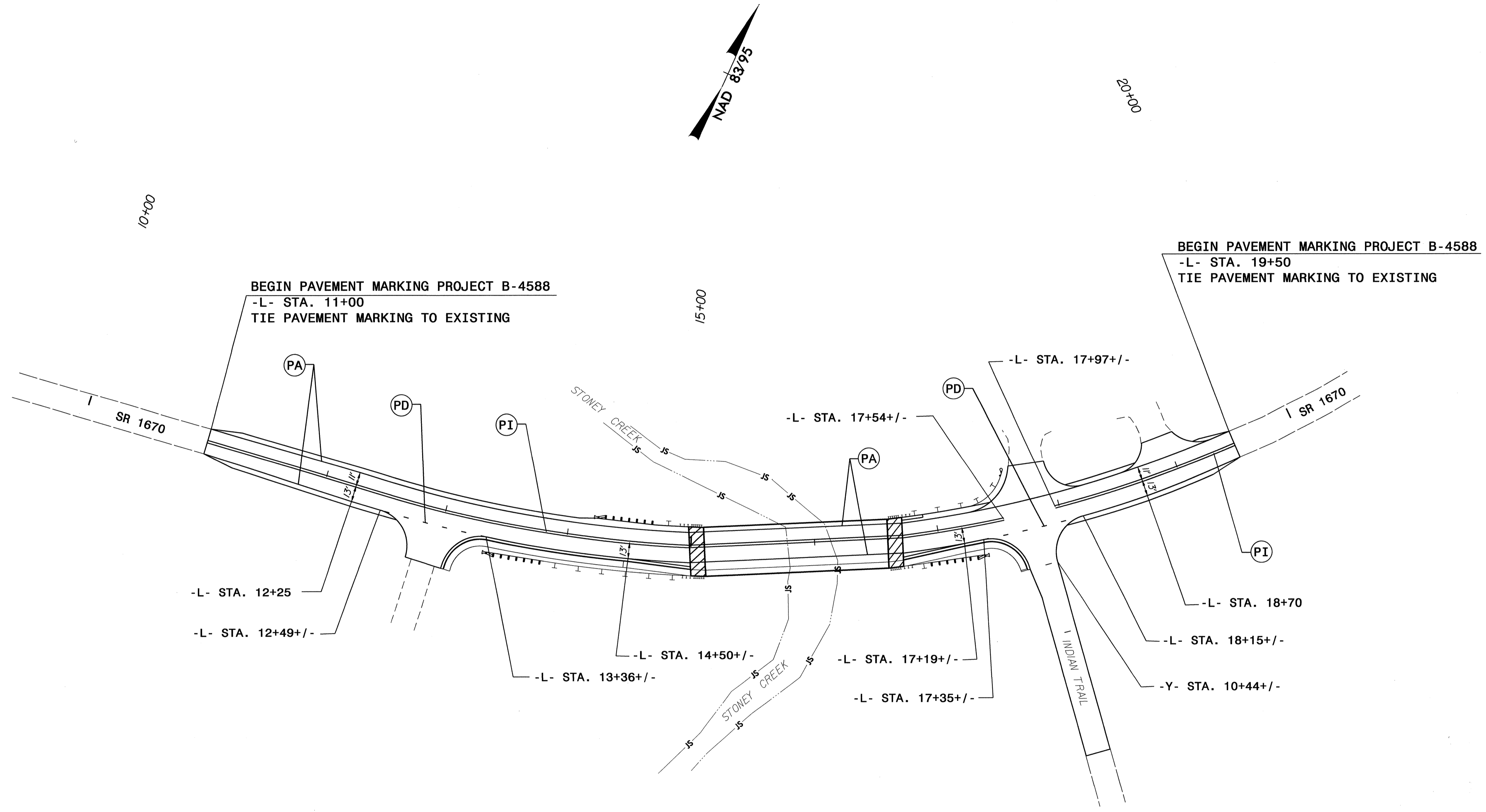

**PAVEMENT MARKING DETAIL**

19-SEP-2011 16:16  
 P:\TIP\Projects-B\B4588\Traffic\Signing\CADD\MP\B4588\_pmp\_sgn.dgn  
 ericward AT 12/27/05