

T.I.P.: B-4183

CONTRACT:

STATE OF NORTH CAROLINA
DEPARTMENT OF TRANSPORTATION

SIGNING PLAN
MADISON COUNTY

LOCATION: BRIDGE NO. 29 OVER MIDDLE FORK CREEK ON SR 1526 AND
BRIDGE NO. 28 OVER CROOKED CREEK ON SR 1526.

TIP NO. B-4183	SHEET NO. SIGN-1
APPROVED: <i>[Signature]</i>	
DATE: 8/25/11	
SEAL	

SUMMARY OF QUANTITIES

ITEM NO.		ITEM DESCRIPTION	QUANTITY	UNIT
DESC. NO.	SECT. NO.			
4102000000	904	SIGN ERECTION, TYPE E	2	EA.
4072000000	903	SUPPORTS, 4.5 kg STEEL U-CHANNEL	9	M
4155000000	907	DISPOSAL OF SIGN SYSTEM, U-CHANNEL	2	EA.
4158000000	907	DISPOSAL OF SIGN SYSTEM, WOOD	10	EA.

PROJECT NOTES

- DISPOSAL OF SIGN SYSTEM, U-CHANNEL
- DISPOSAL OF SIGN SYSTEM, WOOD

ROADWAY STANDARD DRAWING

THE FOLLOWING ROADWAY STANDARDS AS APPEAR IN "ROADWAY STANDARD DRAWINGS" - PROJECT SERVICES UNIT - N.C. DEPARTMENT OF TRANSPORTATION - RALEIGH, N.C., DATED JULY 2006 ARE APPLICABLE TO THIS PROJECT AND BY REFERENCE HEREBY ARE CONSIDERED A PART OF THESE PLANS:

STD. NO.	TITLE
904.50	MOUNTING OF TYPE 'D', 'E' AND 'F' SIGNS ON 'U' CHANNEL POSTS

GENERAL NOTES

- SIGNS FURNISHED BY STATE
- WHEN NOT STATIONED OR DIMENSIONED ON PLANS, ALL 'E' AND 'F' SIGNS SHALL BE FIELD LOCATED BY THE ENGINEER
- ALL EXISTING SIGNS ON "U" CHANNEL POST WITHIN THE PROJECT LIMITS SHALL BE REMOVED AND DISPOSED OF UNLESS OTHERWISE NOTED ON PLANS.
- THE BACKGROUND FOR TYPE E & F SIGNS SHALL BE TYPE C REFLECTIVE SHEETING.

INDEX

SHEET NO.	DESCRIPTION
SIGN-1	TITLE SHEET
SIGN-2	E SHEET
SIGN-3	SIGN DETAIL SHEET

PLAN PREPARED BY: N.C.D.O.T. SIGNING AND DELINEATION UNIT

K. JORDAN SIGNING & DELINEATION REGIONAL ENGINEER
M. TRACEY SIGNING & DELINEATION PROJECT DESIGN ENGINEER

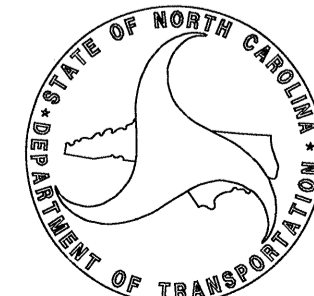

APPROVED: *RW King*
 DATE: 8/25/11

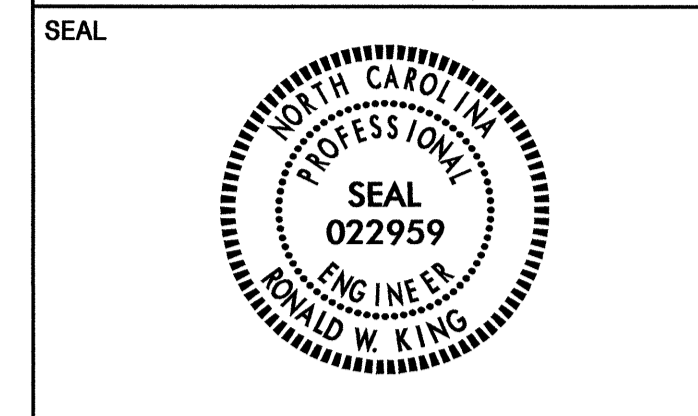

401 QUANTITY REQ'D 1



900 X 900
R1-1

ONE "U" POST PER SIGN

402 QUANTITY REQ'D 1



900 X 900
W1-4R

ONE "U" POST PER SIGN

TYPE "E" or "F" SIGNS

TIP NO. B-4183	SHEET NO. SIGN-3
APPROVED: <i>R.W.K.</i>	
DATE: 8/25/11	
SEAL	

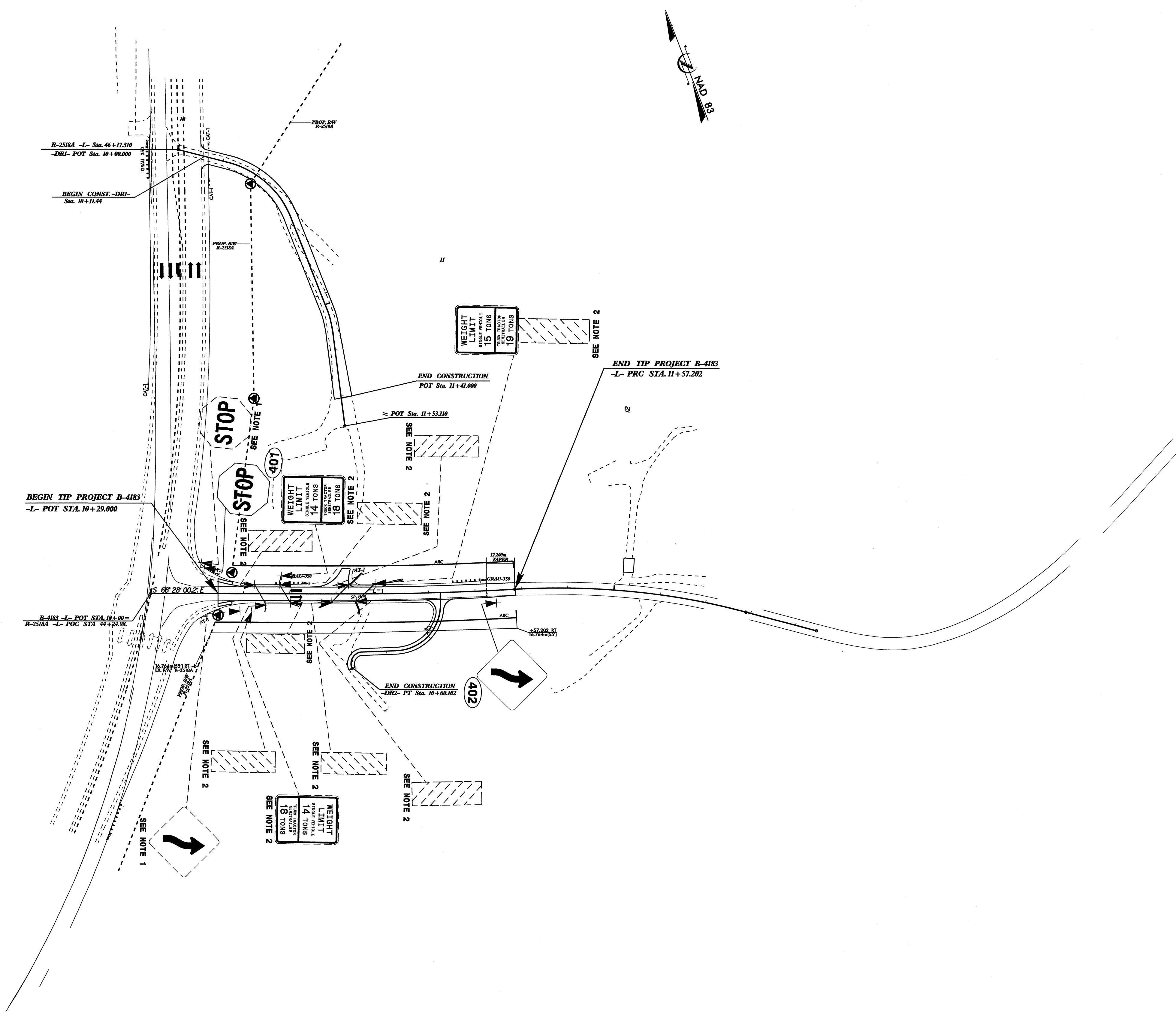

SIGN DETAIL SHEET